

waterpik®

Waterpik® Water Flosser plus Sonic Toothbrush Model WP-950/952

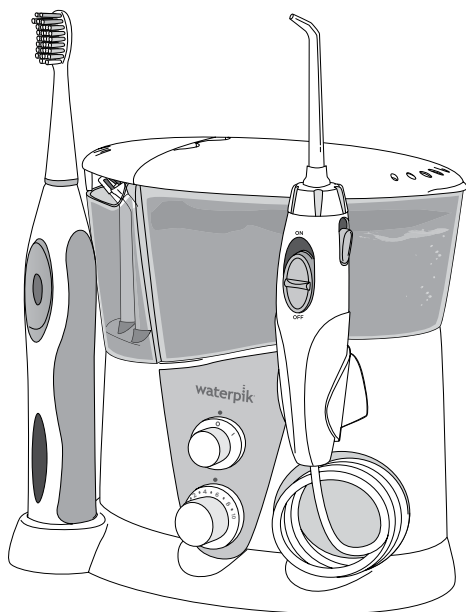

.....
www.waterpik.co.uk

TABLE OF CONTENTS

Important Safeguards	3
Product Description	5
Getting Started With Your Water Flosser	6
Cleaning and Troubleshooting Your Waterpik® Water Flosser	8
Getting Started With Your Sensonic® Professional Plus Toothbrush	9
Care of Your Sensonic® Professional Plus Toothbrush	10
Water Flosser and Sensonic® Professional Plus Toothbrush Limited Two-Year Warranty	11

IMPORTANT SAFEGUARDS

When using electrical products, especially when children are present, basic safety precautions should always be followed, including the following:

READ ALL INSTRUCTIONS BEFORE USING.

DANGER:

To reduce the risk of electrocution:

- Do not handle plug with wet hands.
- Do not place in or drop into water or other liquid.
- Do not use while bathing.
- Do not place or store product where it can fall or be pulled into a tub or sink.
- Do not reach for a product that has fallen into water. Unplug immediately.
- Check the power supply cord for damage before the first use and during the life of the product.



WARNING:

To reduce the risk of burns, electrocution, fire, or injury to persons:

- Do not plug this device into a voltage system that is different from the voltage system specified on the device or charger.
- If product is opened/disassembled for ANY reason warranty is VOID.
- Do not use this product if it has a damaged cord or plug, if it is not working properly, if it has been dropped or damaged, or dropped into water. Contact Waterpik International, Inc. UK service center on +44 (0) 333 123 5677
- Do not direct water from the Water Flosser under the tongue, into the ear, nose or other delicate areas. This product is capable of producing pressures that may cause serious damage in these areas.
- Use this product only as indicated in these instructions or as recommended by your dental professional.
- Only use tips and accessories recommended by Water Pik, Inc.
- Do not drop or insert any foreign object into any opening or hose.
- Keep electrical cord away from heated surfaces.
- Do not use either the Water Flosser or Sonic Toothbrush where oxygen or aerosol sprays are being used.

- Do not use iodine, or water insoluble concentrated essential oils in the Water Flosser. Use of these can reduce product performance and will shorten the life of the product.
- Do not use either the Water Flosser or Sonic Toothbrush while wearing any oral jewelry. Remove prior to use.
- Do not use either the Water Flosser or Sonic Toothbrush if you have an open wound on your tongue or in your mouth.
- If your physician or cardiologist has advised you to receive antibiotic premedication before dental procedures, you should consult your dentist and/or medical professional before using the Water Flosser or Sonic Toothbrush or any other oral hygiene aid.
- This product complies with the safety standards for electromagnetic devices. If you have a pacemaker or other implanted device containing magnets or electronics, contact your physician or the device manufacturer prior to using the Sonic Toothbrush.
- For household use only. Do not use the Water Flosser or Sonic Toothbrush outdoors.
- If the Pik Pocket™ tip (not included in all models) separates from the shaft for any reason, discard tip and shaft and replace with new Pik Pocket™ tip.
- Do not use the Water Flosser for more than 5 minutes in each two-hour period.
- Be sure only the bristles of the toothbrush touch your teeth and gums when using the sonic toothbrush.
- This product does not contain any user serviceable parts in the toothbrush handle or Water Flosser unit. Do not attempt to open either component except for battery disposal. See Battery Removal section.
- Using toothpastes containing baking soda or peroxide, abrasive or chemical cleaners may damage the plastic housing of this product.
- Closely instruct and supervise children 6 years and above and individuals with special needs in the proper use of this product.
- Children should be supervised to ensure that they do not play with the appliance.
- There are no consumer serviceable parts in this appliance and it does not require maintenance.
- Fill Water Flosser reservoir with warm water or other dental professional recommended solutions only.



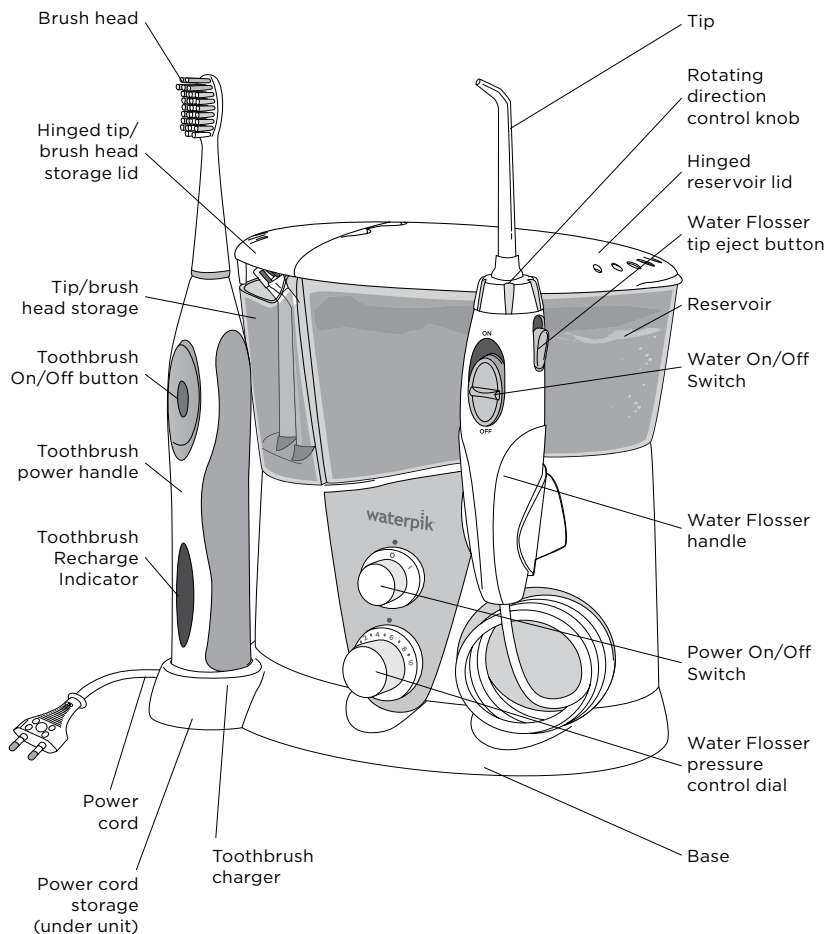

SAVE THESE INSTRUCTIONS.

PRODUCT DESCRIPTION



GETTING STARTED WITH YOUR WATER FLOSSER

NOTE: All tips and brush heads not included in all models.

Replace Every 3 Months	
Orthodontic Tip	BEST FOR
	<input checked="" type="checkbox"/> Braces <input checked="" type="checkbox"/> General Use
Pik Pocket™ Tip	BEST FOR
	<input checked="" type="checkbox"/> Periodontal Pockets <input checked="" type="checkbox"/> Furcations
Plaque Seeker® Tip	BEST FOR
	<input checked="" type="checkbox"/> Implants <input checked="" type="checkbox"/> Retainers <input checked="" type="checkbox"/> Crowns <input checked="" type="checkbox"/> General Use <input checked="" type="checkbox"/> Bridges
Sensonic® Large Brush Head	BEST FOR
	<input checked="" type="checkbox"/> Plaque Removal
Sensonic® Small Brush Head	BEST FOR
	<input checked="" type="checkbox"/> Plaque Removal

Replace Every 6 Months	
Classic Jet Tip	BEST FOR
	<input checked="" type="checkbox"/> General Use
Tongue Cleaner	BEST FOR
	<input checked="" type="checkbox"/> Fresher Breath

Replacement tips/attachments may be purchased directly from Waterpik International, Inc. +44 (0) 333 123 5677 or from your local Water Pik stockist.

Powering the Unit

Plug the cord into an electrical outlet. If the outlet is controlled by a wall switch, be sure it is turned on.

Preparing the Reservoir

Lift the reservoir lid, remove the reservoir, and fill with lukewarm water. Replace the reservoir over the base and **press down firmly** and close the lid.

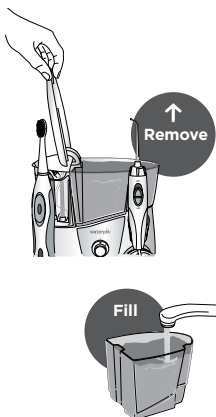

Inserting and Removing Tips

Insert tip into the center of the Water Flosser handle, pressing down firmly until tip clicks into place. The colored ring will be flush with the top of the handle if the tip is correctly locked into place.

To remove tip from the handle push the tip eject button on the handle.

CAUTION: Do not press tip eject button while unit is running.

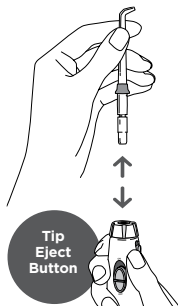
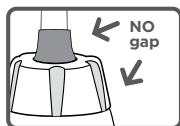

Prime Unit (First Time Use Only)

Set pressure control dial on base to high (pressure setting No. 10), point the handle and tip into sink. Turn unit ON (I) until water flows from the tip. Turn unit OFF (O).

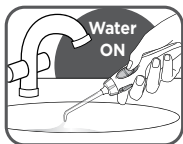

Adjusting the Pressure Setting

Turn the pressure control dial on the base of the unit to the lowest setting (pressure setting No. 1) for first-time use.

Gradually increase pressure over time to the setting you prefer – or as instructed by your dental professional.

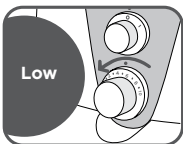

Recommended Technique

For best results, start with the back teeth and work toward the front teeth.



Glide tip along gumline and pause briefly between teeth. Continue until you have cleaned the inside and outside of both the upper and lower teeth.

Lean over sink. Direct the stream at a 90-degree angle to your gumline with tip in mouth.

Slightly close lips to avoid splashing, but allow water to flow freely from mouth. Set pressure at desired setting and turn water ON (I). Begin cleaning.

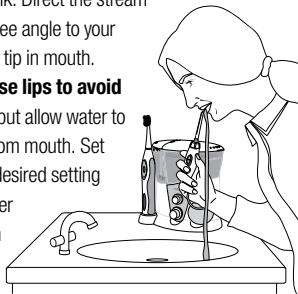

When Finished

Turn the unit OFF (O). Empty any liquid left in the reservoir. Unplug the unit.

NOTE: If you used mouthwash or other solution besides water, see "Using Mouthwash and Other Solutions" section.

TIP USAGE

Pik Pocket™ Tip

The Pik Pocket™ tip is specifically designed to deliver water or anti-bacterial solutions deep into periodontal pockets.



To use the Pik Pocket™ tip, **set the unit to the lowest pressure**

setting only. Place the soft tip against a tooth at a 45-degree angle and gently place the tip under the gumline, into the pocket. Turn the unit on and continue tracing along the gumline.



Tongue Cleaner Tip

To use the tongue cleaner tip, set to lowest pressure setting, place tip in the center/middle of your tongue about half way back and start the Water Flosser. Pull forward with light pressure. Increase pressure as you prefer.



CLEANING AND TROUBLESHOOTING YOUR WATERPIK® WATER FLOSSER

Orthodontic Tip

To use the orthodontic tip, gently glide tip along gumline, pausing briefly to lightly brush area

between teeth and all around orthodontic bracket, before proceeding to the next tooth.

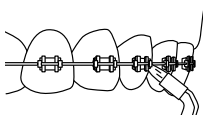

Plaque Seeker® Tip

To use the Plaque Seeker® tip, place the tip close to the teeth so that the

bristles are gently touching the teeth. Gently glide tip along gumline, pausing briefly between teeth to gently brush and allow the water to flow between the teeth.



Using Mouthwash and Other Solutions

Your Waterpik® Water Flosser can be used to deliver mouthwash and antibacterial solutions. After using any special solution, rinse unit to prevent clogging by partially filling reservoir with warm water and running unit with tip pointed into sink until unit is empty.

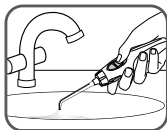

Cleaning

Before cleaning, unplug from the electrical outlet. Clean the product when necessary by using a soft cloth and mild non-abrasive cleanser.

The accessory storage container and the water reservoir are removable for easy cleaning and are top rack dishwasher safe.

Removing Hard Water Deposits / General Cleaning

Hard water deposits may build up in your unit, depending on the mineral content of your water. If left unattended, it can hinder performance. Cleaning internal parts: add 2 tablespoons of white vinegar to a full reservoir of warm water. Point the handle and tip into sink. Turn unit ON and run until reservoir is empty. Rinse by repeating with a full reservoir of clean warm water.

This process should be done every 1 to 3 months to ensure optimal performance.

Leakage

If leaking due to a damaged hose, replacement hoses and handles can be purchased from your local distributor, which can be found at www.waterpik.co.uk.

GETTING STARTED WITH YOUR SENSONIC® PROFESSIONAL PLUS TOOTHBRUSH

Excess Power Cord Storage

After determining the length of power cord necessary, push extra cord into the cavity on the bottom of the unit and insert cord into the retention slots.

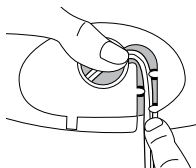

Service Maintenance

Waterpik® Water Flossers have no consumer serviceable electrical items and do not require routine service maintenance. For all your service needs please call the Waterpik International, Inc. UK Customer Service Center at +44 (0) 333 123 5677. Some replacement parts and accessories for the Water Flossers are also available at www.waterpik.co.uk.

For questions or problems please call the customer service centre before returning the product. Please do not send your unit to the Waterpik International, Inc. address as this can cause lengthy delays.

Refer to the serial and model numbers in all correspondence. These numbers are located on the bottom of your unit.

Still have questions? Go to www.waterpik.co.uk.

Charging the Sensonic® Professional Plus Toothbrush

Charge for 24 hours before first use. All 3 charge indicator lights will stay on continuously when the unit is fully charged. A full charge will last for approximately 1 week of typical use (2 minutes of brushing twice a day).

If the toothbrush is to be stored for an extended period of time (six months or more), be sure to fully charge it prior to storage.

Recharge Indicator Lights

Charge indicator lights will indicate level of battery charge for approximately 10 seconds after use and after removal from the charging base, and will then turn off.

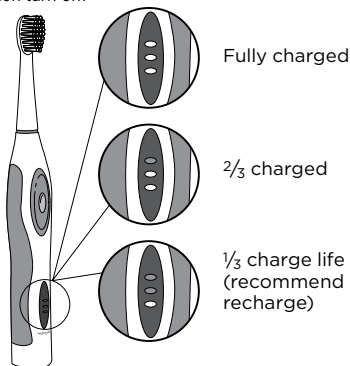

Unit will not operate if the bottom LED begins to blink rapidly.

In order for the toothbrush to begin to work again, it must be placed on the charger for approximately 1 hour.

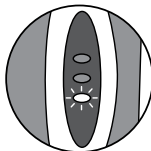

CARE OF YOUR SENSONIC® PROFESSIONAL PLUS TOOTHBRUSH

Sonic brushing

- Slide the brush head onto handle and push it down firmly.
- Place the brush head into your mouth before turning the unit on.
- Press button once for low speed, and twice for high speed.
- If you hold the on/off button down briefly while in the low speed position the brush will shut off.
- For best results, position brush along gumline at a 45-degree angle.
- Use light pressure with a small, slow back and forth motion covering one or two teeth at a time.



- **Quad Timer:** Your Sensonic® Professional Plus Toothbrush will create a short pause every 30 seconds, to remind you to move to the next quadrant of your mouth.

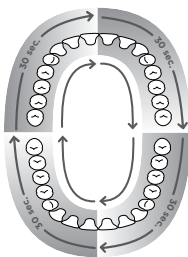

- **2-Minute Timer:**

The brush will automatically shut off after 2 minutes of run time.

Cleaning

1. **After each use,**

turn off unit, remove the brush head from the handle and rinse brush head under running water.

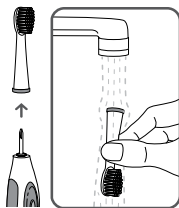

2. Wipe the handle dry after each use.

Service

Waterpik® toothbrushes have no consumer serviceable or replaceable electrical items and do not require routine service maintenance. For all accessories go to waterpik.co.uk

You may also call our toll-free customer service number at +44 (0) 333 123 5677.

Refer to the serial and model numbers in all correspondence. These numbers are located on the bottom of your unit.

Disposal

This product contains rechargeable Nickel Metal Hydride batteries. The batteries are not replaceable. Please do not dispose of the unit in the household waste. Remove the batteries per the instructions below and recycle at your local recycling center.

Battery Removal

Note: This process is not reversible

Remove the battery only at the end of the product's life for recycling. Doing so earlier will destroy the product. Deplete the battery charge until the brush no longer operates. Observe basic safety precautions. Remove the batteries as shown and recycle them and the rest of the product according to local regulations.

WATER FLOSSER AND SENSONIC® PROFESSIONAL PLUS TOOTHBRUSH LIMITED TWO-YEAR WARRANTY

1. Use coin or washer to rotate cap counter-clockwise until cap protrudes.

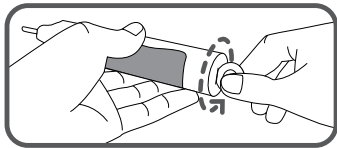

2. Push down hard with shaft on hard surface.

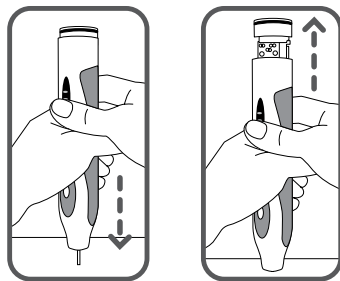

3. Remove cap and pull internal body out.
Cut tape and remove.

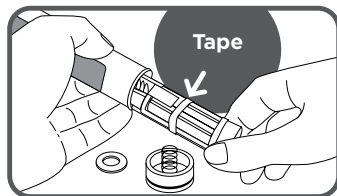

4. Lift battery pack up and cut battery wires, one at a time, to free from circuit board.

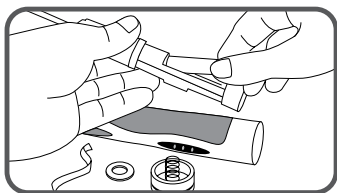

Water Pik, Inc. warrants to the original purchaser/owner of this product that it is free from defects in materials and workmanship for two years from date of purchase. **Save your receipt as your proof of purchase date.** Water Pik, Inc. reserves the right to request the product to be returned for analysis to confirm the claim falls within our warranty policy. We will replace any part of the product, which in our opinion is defective, provided the product has not been abused, misused, altered or damaged after purchase and was used according to these instructions, and was used only with accessories or consumable parts approved by Water Pik, Inc. Installation is the responsibility of the consumer and is not covered by the warranty. This limited warranty excludes accessories or consumable parts such as tips and brush heads.

This warranty gives you specific legal rights. You may also have other rights that vary, depending on the law in your place residence.

**Water Pik, Inc.**

1730 East Prospect Road
Fort Collins, CO 80553-0001 USA
www.waterpik.com

Waterpik International, Inc.

Castle Court, 41 London Road
Reigate, Surrey RH2 9RJ
United Kingdom
www.waterpik.co.uk

Waterpik International, Inc.

UK Customer Service Centre
+44 (0) 333 123 5677

Waterpik® is a trademark of Water Pik, Inc. registered in Argentina, Australia, Benelux, Brazil, Canada, Chile, China, Czech Republic, Denmark, EU, Finland, France, Germany, Hong Kong, Hungary, India, Israel, Italy, Japan, Kazakhstan, Korea, Malaysia, Mexico, New Zealand, Norway, Pakistan, Philippines, Poland, Russian Federation, Saudi Arabia, Singapore, South Africa, Spain, Sweden, Switzerland, Taiwan, Turkey, Ukraine, United Kingdom, and the United States.

Waterpik® (stylized) is a trademark of Water Pik, Inc. registered in Australia, Brazil, Canada, China, EU, Hong Kong, Israel, Japan, Korea, Malaysia, Mexico, Philippines, Russian Federation, Saudi Arabia, South Africa, Switzerland, Taiwan, Trinidad & Tobago, Ukraine and the United States.

waterflosser® (stylized) is a trademark of Water Pik, Inc. registered in Brazil, Canada, China, Mexico, Switzerland and the United States.

Pik Pocket™ is a trademark of Water Pik, Inc.

Plaque Seeker® is a trademark of Water Pik, Inc. registered in Canada, China, EU, and the United States.

Sensonic® is a trademark of Water Pik, Inc. registered in Canada, China, EU, Japan, Switzerland, and the United States.

Made in China.

