

iScooter

TC3 *User Manual*

Before using the product, please read this manual.
Read carefully and keep for future reference.

Illustrations of product and accessories in the user manual are for reference purposes only. Actual product and functions may vary due to product enhancements.

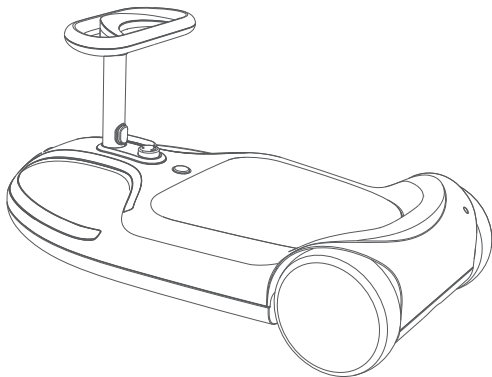

Table of Contents

| | |
|---------------------------|---|
| Safety Instructions ----- | 1 |
| Package Contents ----- | 2 |
| Product Overview----- | 3 |
| Product Assembly ----- | 4 |
| Buttons & Controls ----- | 5 |
| Start Riding----- | 6 |
| Carrying ----- | 7 |
| About Charging ----- | 8 |
| Specifications ----- | 9 |



Safety Instructions

This manual contains essential safety information. For your child's safety, it is important that you review this manual with your children and ensure they understand all warnings, cautions, and instructions. Children should always ride under adult supervision. We recommend regularly reviewing this manual and performing inspections and maintenance on the electric go kart to ensure safe riding.



WARNING

Riding is both a sport and a form of entertainment, but there may be dangers such as loss of control and falling while riding. Therefore, safety precautions should be taken before riding, and the safety requirements for riders in this manual must be strictly followed. We do not assume any direct or shared liability for property damage, personal injury, accidents, legal disputes, or any other adverse events arising from the misuse or violation of the recommended usage provided in this manual.

- This product is only suitable for children above 3 years old, not for adults.
- No passengers are allowed.
- A helmet and other protective equipment are required during riding.
- Do not ride it in unsafe or illegal places.
- Practice in an open area first and ride only after the rider has mastered the skills.
- Do not make dangerous movements or ride with one hand while riding.
- Avoid riding on steps, as this may cause the product to tip over, resulting in potential injury or damage.
- The maximum speed of this product is 5 mph (8 km/h).
- Avoid using this product in extreme temperatures.
- If uneven or poor road conditions are encountered, please ride slowly or get off.
- Do not ride this product on oily or icy surfaces.
- Do not immerse the product in water or spray water on the vehicle body directly.
- The maximum load is 110 lbs (50 kg). Do not exceed this limit.



ALWAYS INSPECT THE PRODUCT BEFORE RIDING

- Always inspect before riding and perform regular maintenance.
- Check and secure all fasteners before each ride.
- Replace worn or damaged parts immediately.
- Use caution when riding, as skill is required to avoid falls or collisions, which could result in injury to the rider or others.



Package Contents



①



②

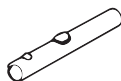

③

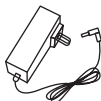

④



⑤



⑥



⑦

① Vehicle Body

② Handlebar

③ Support Column

④ Charger

⑤ Fixing Screws

⑥ Pull Rope

⑦ User Manual



Product Overview

- ① Handlebar
- ② Support Column
- ③ Hole for Support Column
- ④ Colorful Lights
- ⑤ Seat Board
- ⑥ Seat Switch
- ⑦ Multifunction Button*
- ⑧ Support Column Release Button
- ⑨ Foot Pedal (Throttle)

*The Multifunction Button is a 3-in-1 control, serving as the Power Switch, Speed Control Button, and Light Control Knob.

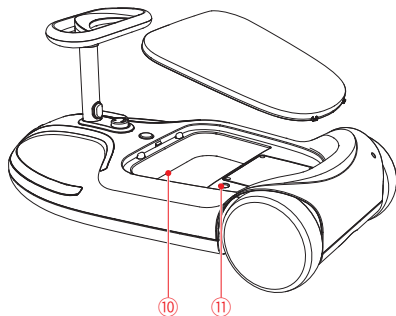
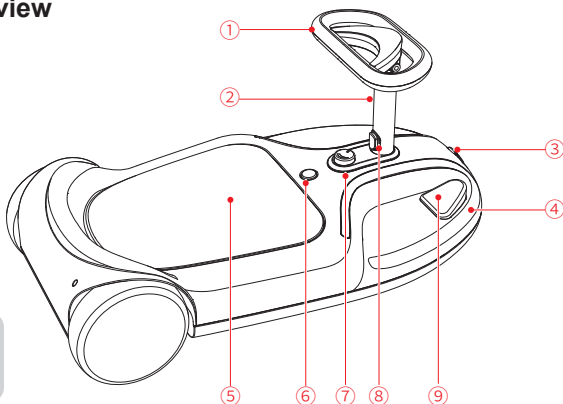

- ⑩ Storage Space
- ⑪ Charging Port

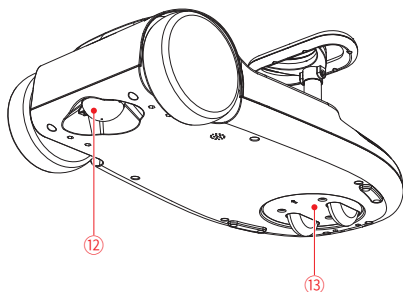

- ⑫ Colorful Lights
- ⑬ Rotatable Wheels



Product Assembly

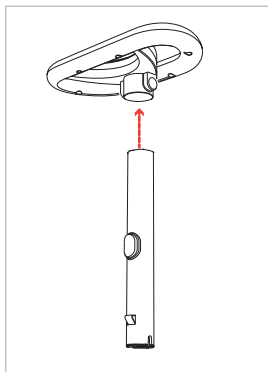

Insert the support column into the handlebar, aligning the groove with the limit position.

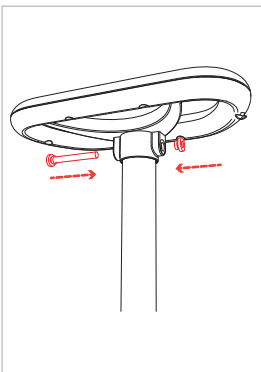

Secure the support column and handlebar with the provided fixing screws.

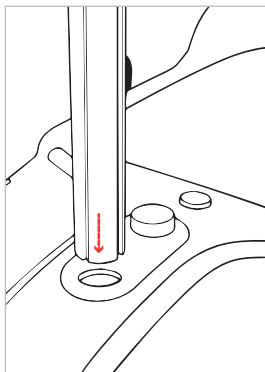

Insert the support column into the hole in the vehicle body, aligning the groove with the limit position.



Buttons & Controls

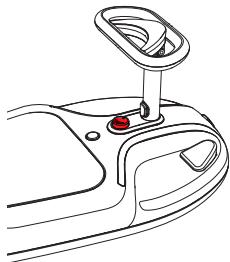

Multifunction Button

- **Turn on/off:**

Press and hold the button to power on/off.

Tip: It can be paired with a phone after turning on, but the effective range of Bluetooth is limited. Please pair them within the effective range.

- **Speed Switching:**

After being powered on, each press of the button switches the speed among low, medium, and high.



- **Light ON/OFF:**

After being powered on, rotate the knob in any direction to turn on the light, and rotate it in the opposite direction to turn it off.

- **Light Switching:**

After the light is turned on, keep rotating the knob in the same direction to cycle through various light options.

Seat Button

Press this button to detach the seat board and access the storage space underneath.

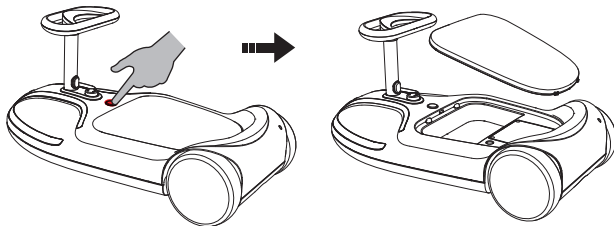

Foot Pedal (Throttle)

Step on it to accelerate. Release it to slow down and eventually stop.

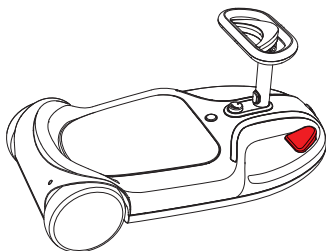

Start Riding

• Throttle Mode

Sit on the seat board.
Power on the electric go kart, and select your desired riding speed, then hold the handlebar and step on the foot pedal (throttle) to accelerate.

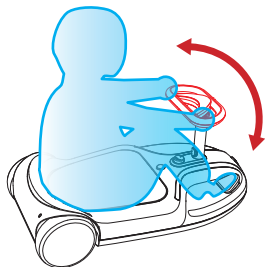
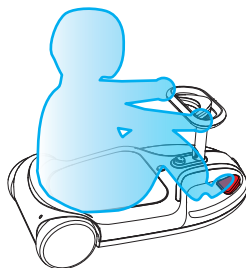

• Manual Riding Mode

Sit on the seat board, then turn the handlebar left or right to move forward.



Carrying

- 1** Press and hold the Support Column Release button to remove the support column.

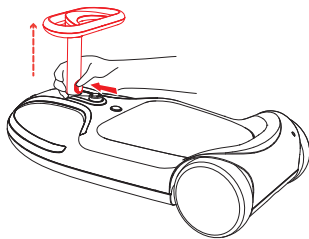

- 2** Uncover the hole for the support column at the front of the vehicle body, then insert the support column into it. Make sure that the groove is aligned with the limit position.

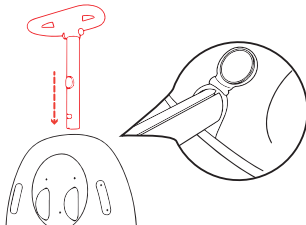

- 3** You can now pull it with your hand.

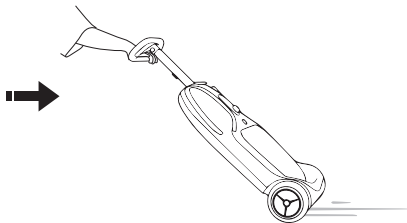



About Charging

- The electric go kart is fully charged when the charger indicator changes from red to green.
- With charging protection, the electric go kart will cut off charging automatically after a full charge. However, we still do not recommend leaving it overcharging.
- Keep the charging port cover closed when not charging.

Note:

- Only use the original charger to charge the battery!
- The electric go kart cannot be turned on during the charging period.
- Do not connect the charger if the charging port is wet.

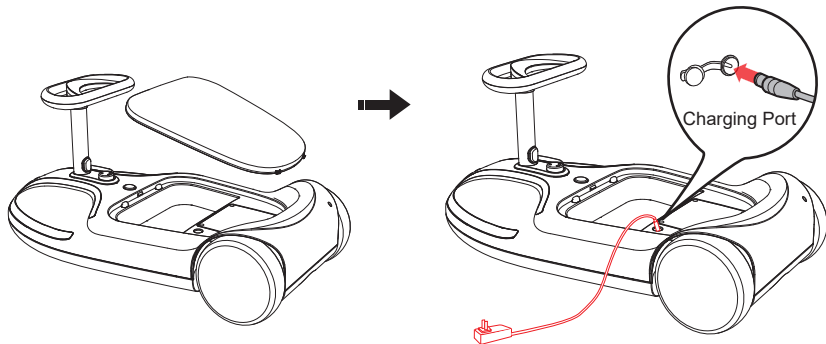



Specifications

| | |
|---------------------------|------------------------|
| Model: | TC3 |
| Net Weight: | 15.87 lbs (7.2 kg) |
| Battery Capacity: | 21.6 V, 2.6 Ah |
| Motor Power: | 180 W |
| Max Speed: | 5 mph (8 km/h) |
| Max Load Capacity: | 110 lbs (50 kg) |
| Recommended Age: | 3+ |
| Charger Input: | AC 100–240 V, 50/60 Hz |
| Charger Output: | DC 25.2 V, 0.7 A |
| Charging Time: | 3–4 h |
| Range: | 1–2 h |

Note:

- The actual range will vary due to factors such as load, temperature, wind speed, road conditions, and operating habits. Data and references vary with different models and are subject to change without notice.

FCC ID: 2BBGK-TC3

NOTE: This equipment has been tested and found to comply with the limits for Class B digital devices, in alignment with section 15 of the FCC Rules. These limits are designed to provide reasonable protection against harmful interference in a residential installation. This equipment generates uses and can radiate radio frequency energy and, if not installed and used in accordance with the instructions, may cause harmful interference to radio communications. However, there is no guarantee that interference will not occur in a particular installation. If this equipment does cause harmful interference to radio or television reception, which can be determined by turning the equipment off and on, the user is encouraged to try to correct the interference by one or more of the following measures:

- Reorient or relocate the receiving antenna.
- Increase the separation between the equipment and receiver.
- Connect the equipment into an outlet on a circuit different from that to which the receiver is connected.
- Consult the dealer or an experienced radio/TV technician for help.

Changes or modifications not expressly approved by the party responsible for compliance could void the user's authority to operate the equipment.

This device complies with Part 15 of the FCC Rules. Operation is subject to the following two conditions:

- (1) this device may not cause harmful interference, and
- (2) this device must accept any interference received, including interference that may cause undesired operation.

FCC Statement

Note: This equipment has been tested and found to comply with the limits for a Class B digital device, pursuant to part 15 of the FCC Rules. These limits are designed to provide reasonable protection against harmful interference in a residential installation. This equipment generates, uses and can radiate radio frequency energy and, if not installed and used in accordance with the instructions, may cause harmful interference to radio communications. However, there is no guarantee that interference will not occur in a particular installation. If this equipment does cause harmful interference to radio or television reception, which can be determined by turning the equipment off and on, the user is encouraged to try to correct the interference by one or more of the following measures:

- Reorient or relocate the receiving antenna.
- Increase the separation between the equipment and receiver.
- Connect the equipment into an outlet on a circuit different from that to which the receiver is connected.
- Consult the dealer or an experienced radio/TV technician for help.

This device complies with part 15 of the FCC Rules. Operation is subject to the following two conditions: (1) This device may not cause harmful interference, and (2) this device must accept any interference received, including interference that may cause undesired operation.

Any changes or modifications not expressly approved by the party responsible for compliance could void the user's authority to operate the equipment.

The device has evaluated to meet general RF exposure requirement. The device can be used be in portable exposure without restriction.

Customer Service:

Contact us if you experience issues relating to assembly, riding, maintenance and safety.

 www.iscooterglobal.com

 support@iscooterglobal.com

 +1 888 4968123

MANUFACTURER:

Shenzhen Xincheng Times Technology Co., Ltd
Add: 104-105, Block C, Donghai Wang Building, No.369
Bulong Road, Ma'antang Community, Bantian Street,
Longgang District, Shenzhen



FCC ID: 2BBGK-TC3

| | | | | | | | | |
|-------|-------------|------|-------|-------|------------|-----|------|--------|
| 物料名称: | TC3 说明书(北美) | | | 成品尺寸: | 130*130 mm | 版本号 | 变更时间 | 版本变更记录 |
| 品 牌: | iScooter | 语 种: | EN | 材 质: | 157g双铜纸 | | | |
| 时 间: | 2024-10-23 | 版 本: | EN_V1 | 工 艺: | 骑马订, 封面过哑膜 | | | |
| 备 注: | | | | | | | | |