



kogan.com

kogan | Tizen OS

Kogan QLED 86" LED 4K SMART TV
SERIES 9 T96Q (KAQL86T96QA)

COMPONENTS

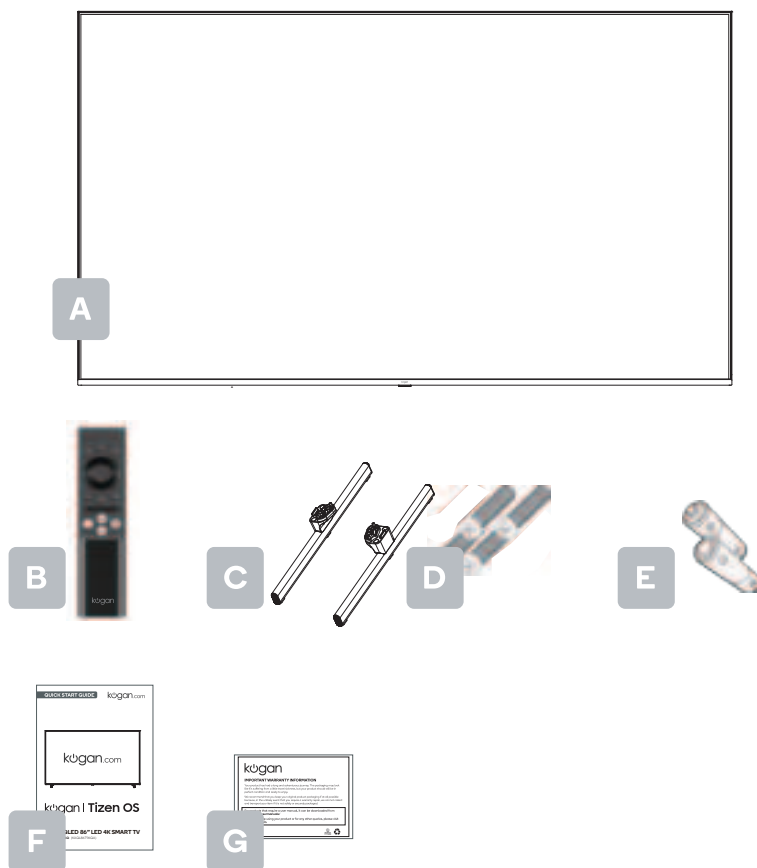

A Kogan QLED 86" LED 4K SMART TV

B Remote Control

C Stand (x2)

D BM5x25mm screw (x4)

E AAA battery (x2)

F Quick start guide

G Warranty card

NOT INCLUDED

Phillips head screwdriver, antenna cable, broadband internet connection.

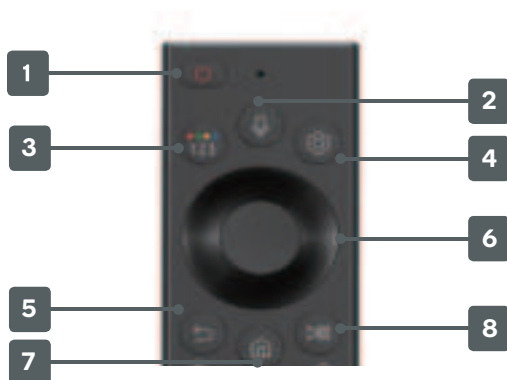

REMOTE CONTROL

- You can control TV operations with your Smart Remote (Bluetooth).
- Smart Remote (Bluetooth) may not be supported depending on the model or geographical area.



- 1** **Power** Press to turn the TV on or off.
- 2** **Voice Assistant** Runs Voice Assistant. Press and hold the button, say a command, and then release the button to run Voice Assistant.
- 3** **Colour / Number button** Each time you press this button, virtual numeric pad / Option pad with Colour buttons are displayed alternately.
- 4** **Settings** Press to display Settings menu.
- 5** **Back** Press to return to the previous menu. When pressed for 1 second or more, the running function is terminated. When pressed while you are watching a programme, the previous channel appears.
- 6** **up/down/left/right** Press the up, down, left or right button to scroll the menu.
- 7** **Home** Press to switch to the Home Screen.
- 8** **Play/Pause** When pressed, the playback controls appear. Using these controls, you can control the media content that is playing.



- 9**  **Channel** Move the button up or down to change the channel. To see the Guide screen, press the button. When pressed for 1 second or more, the Channel List screen appears. Press and hold the button up or down to quickly change the channel..
- 10**  **Volume** Move the button up or down to adjust the volume. To mute the sound, press the button. When pressed for 2 seconds or more, the Accessibility Shortcuts appears.
- 11** **Hot Keys** Launch the app indicated by the button.

USING THE REMOTE

The descriptions in this manual are based on the buttons on the remote control. Please read this manual carefully and use the TV correctly.

How to register the Remote Control

To use the Remote, first pair it with your TV.

1. Put batteries into the Remote and turn the TV on.
2. Point the Remote at your TV and then press and hold the ↶ and ► buttons simultaneously for 3 seconds or more.

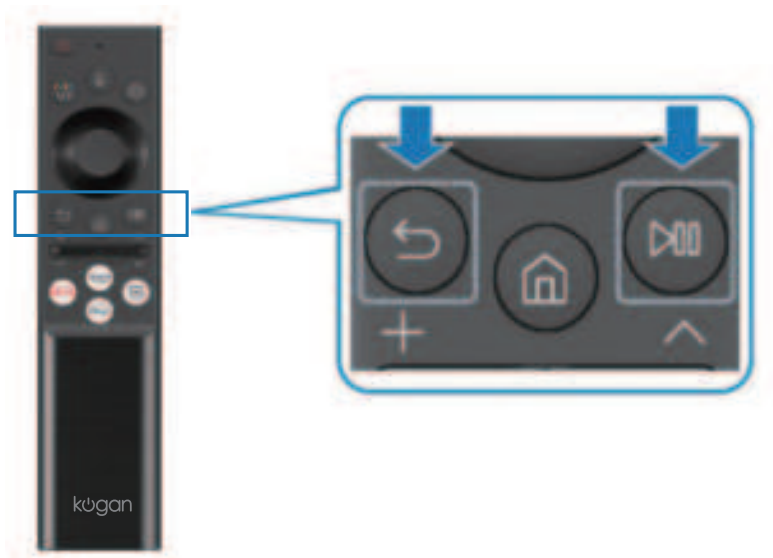

ASSEMBLY AND INSTALLATION

BEFORE YOU GET STARTED

Spread cushioning flat to lay the TV on. This will help to prevent damage.

1. Stand assembly

- Attach stands to base of TV.
- Insert four BM5x25mm screws and use Phillips head screwdriver (not supplied) to tighten.

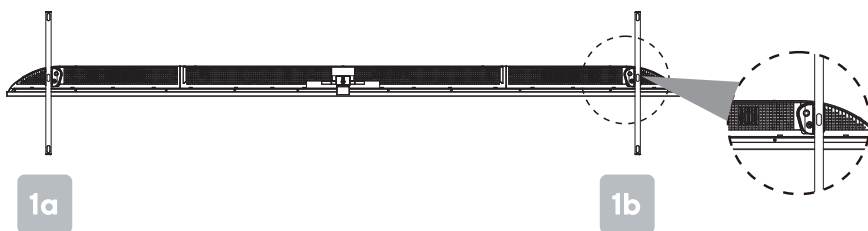

2. Remote control assembly

- Open the battery compartment cover on the back side.
- Insert batteries (x2 1.5V AAA size for the remote) making sure to match the polarity markings (+ / -) of the batteries with the diagram inside the compartment.
- Replace battery compartment cover.

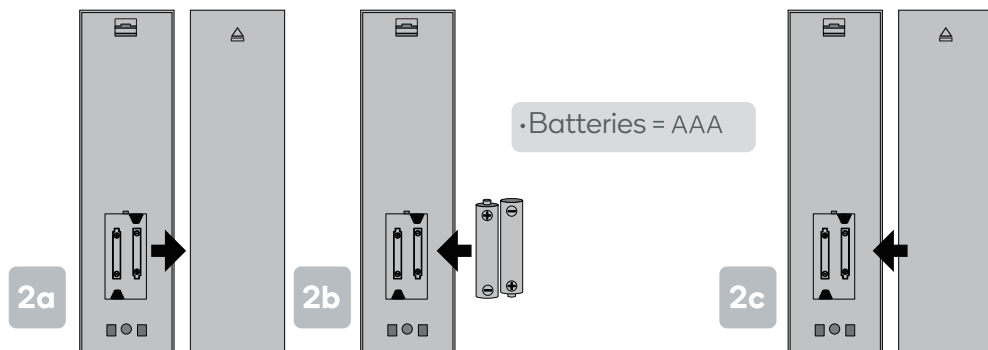

3. Connect to antenna

- a. Connect an antenna cable (not supplied) via the 'ANT' input port at the back of the TV.
- b. Ensure the antenna cable is also connected to a working antenna, either via an antenna wall socket in your home, or directly.

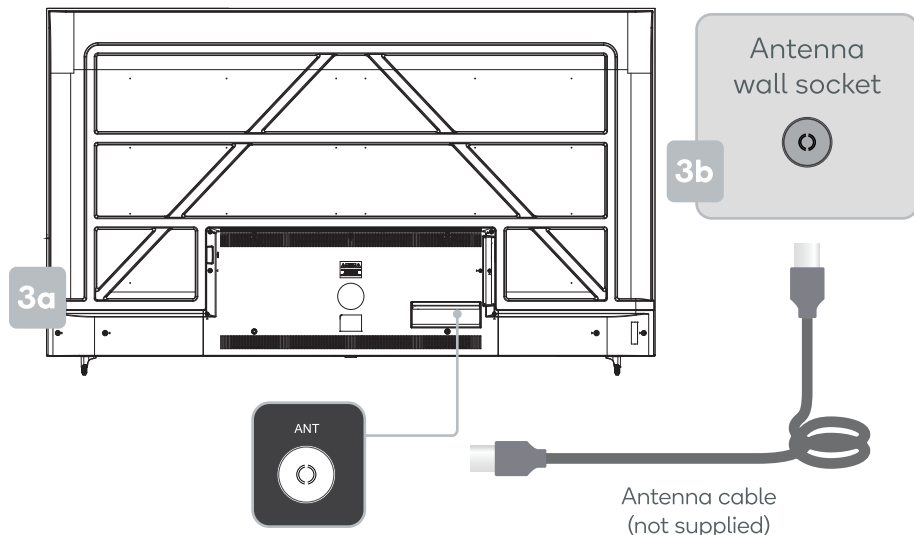

4. Turning TV on

Plug the power cord into a suitable power outlet, then press the POWER (⏻) button on the remote control, making sure to aim it at the sensor at the front of the TV. Alternatively, you can press the power button on the lower side of the back panel on the TV.

TURNING TV OFF

Press the POWER (⏻) button on the remote control to enter standby mode. To power down the TV completely, unplug the power cord from the power outlet.

Do not leave your set in standby mode for long periods of time. If you will not use the TV for a long time, it is recommended to unplug the set from both the power outlet and aerial.

INPUTS AND PORTS

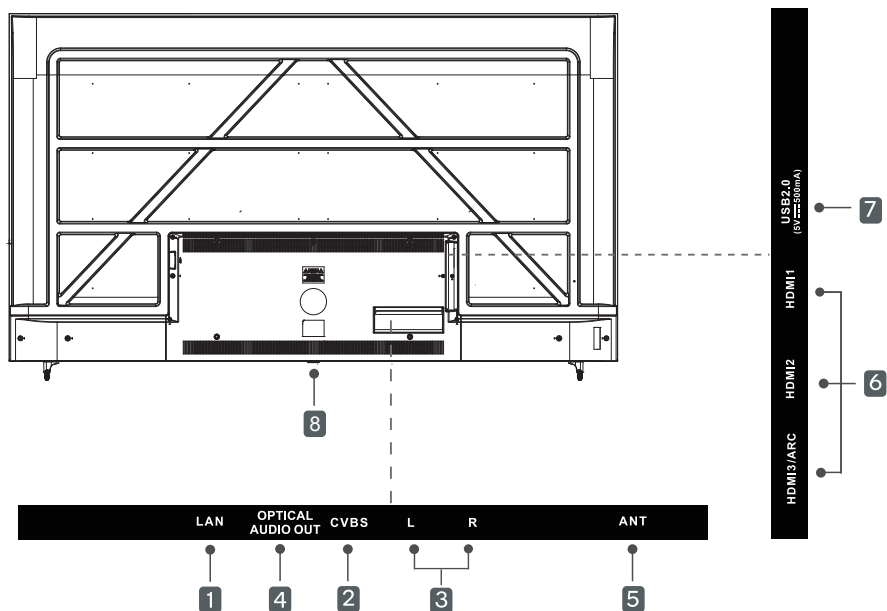

- | | |
|---|-----------------------------------|
| 1 Ethernet port (LAN) | 5 Antenna |
| 2 Composite video (RCA) | 6 HDMI (x3; ARC support on HDMI3) |
| 3 Composite audio (RCA, left and right) | 7 USB 2.0 (x2; 5v 500mA) |
| 4 Digital audio (Optical out) | 8 Power button |

FIRST TIME SETUP

The system setting will appear when you open the TV on the first time. Please set according to the on-screen guide. Press OK button to start the setup.

Press ▼/▲ button to select your language, press OK button to confirm and proceed to the next step.

Press ◀/▶ button to setup and choose to connect your devices to the screen then start setup.

Press ◀/▶ button to select the signal setup page. Select the connected aerial that you want to use to get channels, and select each item and choose the correct setting. Then select Next to search for channels.

Press ◀/▶ button to select Network and press OK button to turn to next page.

Select "OK" to agree to the Terms & Conditions and Privacy Notice, and then choose to enable specific additional service above by individually selecting.

Choose sign in the Samsung account or skip to next step.

Press ◀/▶/▼/▲ button to select TV source and scan channel

Check the settings below to make sure everything's how you want it, then enter the next step.

Press ◀/▶/▼/▲ button to select favourite services below, then simply sign up or sign in using your mobile device or PC.

HOME MENU

(Available options may vary depending on the actual model)

Enter the Home page after First Time install.



Privacy Choices

Press ▼/▲/◀/▶ button to select Privacy Choices, then press <OK> to enter. You can easily manage your personal information and read our data policies in Terms & Conditions, Privacy Policy. You can also find out how we use your data to power services on your device and protect your privacy in Privacy Centre.

Search

Press ▼/▲/◀/▶ button to select Search, then press <OK> to enter. You can search for channels, programs, movie titles and apps from Smart Hub. (Note:It only available when connected to the Internet.)

Media

Press ▼/▲/◀/▶ button to select to select Media, then press <OK> to enter. You can also press ▼/▲/◀/▶ button to select Connected Devices on Source mode on the home page. Play media content stored on your TV, USB devices, mobile devices, cameras, PCs, etc.

Filter By

Press ◀/▶ button to select Filter By.
It can filters the media content by type of media.

Sort By

Press ◀/▶ button to select Sort By.
It can sorts the content list.

Options

Press ◀/▶ button to select Options.
It can plays the selected media content in the media content list. When you select Refresh, the content list is reloaded.

Source

Press ▼/▲/◀/▶ button to select Connected Devices, then press <OK>/▶ to enter.
You can select an external device connected to the TV. (Optional:TV/HDMI1/HDMI2/HDMI3/AV/Connection Guide)

Settings

Press ▼/▲/◀/▶ button to select Settings, then press <OK>/▶ to enter. (Optional: Sound Output/Sleep Timer/Picture Mode/Picture Setup/Sound Mode/LAN/Power and Energy Saving/Subtitle/Picture Clarity/Audio Language/Digital Output Audio Format/Colour Tone/Picture Size/Support/All Settings)

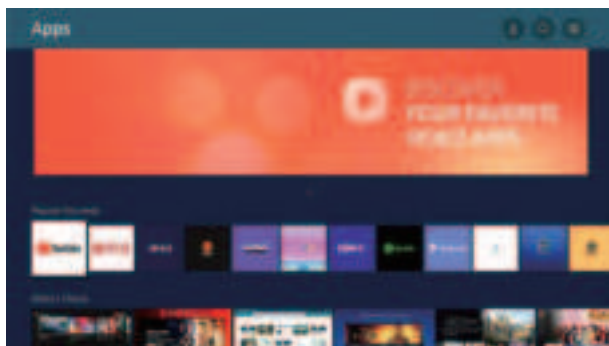

Apps

Press ▼/▲/◀/▶ button to select Apps, then press <OK> to enter.
You can enjoy a wide range of contents including news, sports, weather and games by installing the corresponding apps on your TV. (Note: It only available when connected to the Internet.)

SETTINGS MENU

(Available options may vary depending on the actual model)

Press SETTINGS button and select all Settings to enter the TV Setting. Press ▼/▲ button to highlight the desired menu icon , and press OK button to select. (Optional:Picture/Sound/Connection/Broadcasting/General&Privacy/Support)

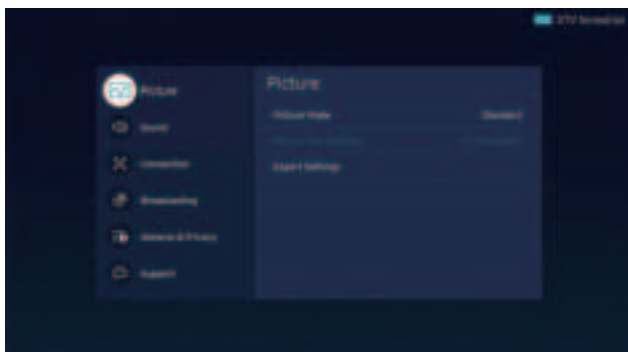

Picture

Press SETTINGS button and select all Settings to enter the main menu. Press ▼/▲ button to select the Picture. Press OK button to enter the sub-menu. Press ▼/▲ button to select Picture Mode/Picture Size Settings/Expert Settings. Press SETTINGS or Back button to quit.

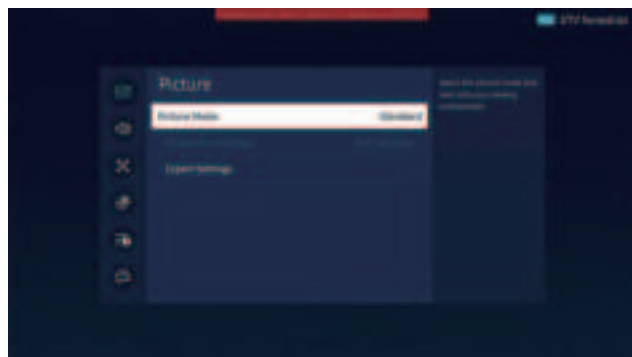

Sound

Press SETTINGS button and select all Settings to enter the main menu. Press ▼/▲ button to select the Sound. Press OK button to enter the sub-menu. Press ▼/▲ button to select Sound Output/Sound Mode/Expert Settings. Press SETTINGS or Back button to quit.

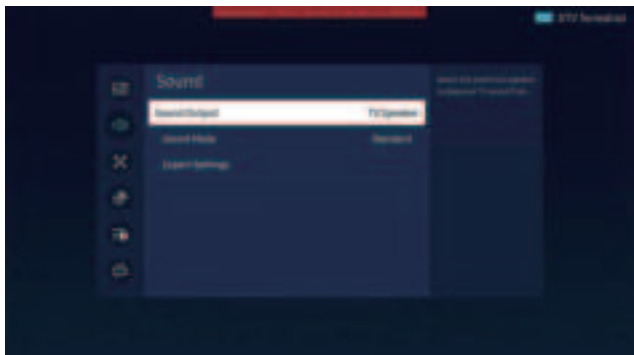

Connection

Press SETTINGS button and select all Settings to enter the main menu. Press ▼/▲ button to select the Connection. Press OK button to enter the sub-menu. Press ▼/▲ button to select Device Name/Network/Bluetooth Device List/External Device Manager. Press SETTINGS or back button to quit.

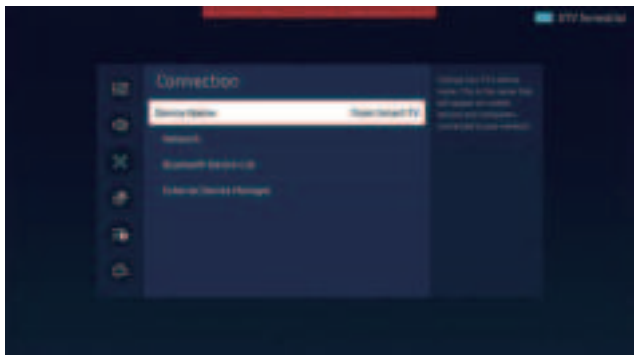

Broadcasting

Press SETTINGS button and select all Settings to enter the main menu. Press ▼/▲ button to select the Broadcasting. Press OK button to enter the sub-menu. Press ▼/▲ button to select Auto Tuning Settings/Dual Sound/Expert Settings. Press SETTINGS or back button to quit.

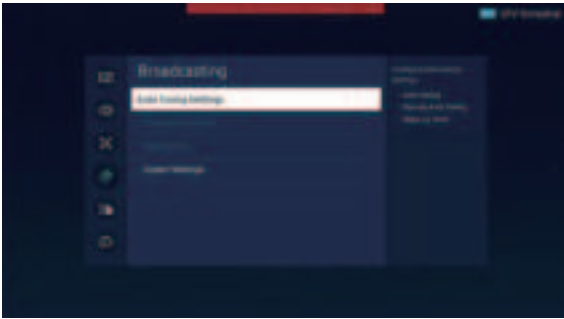

General & Privacy

Press SETTINGS button and select all Settings to enter the main menu. Press ▼/▲ button to select General&Privacy. Press OK button to enter the sub-menu. Press ▼/▲ button to select Accessibility/Terms & Privacy/System Manager/Parental Settings/Power and Energy Saving/Start Screen Options/Reset.

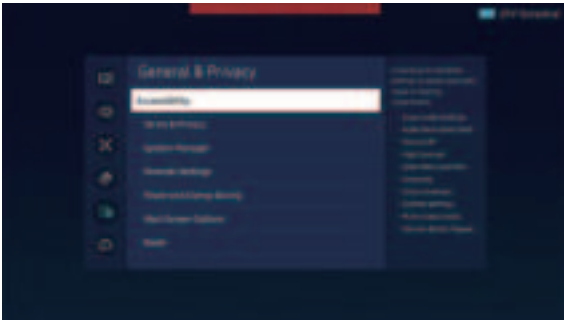

Support

Press SETTINGS button and select all Settings to enter the main menu. Press ▼/▲ button to select Support. Press OK button to enter the sub-menu.

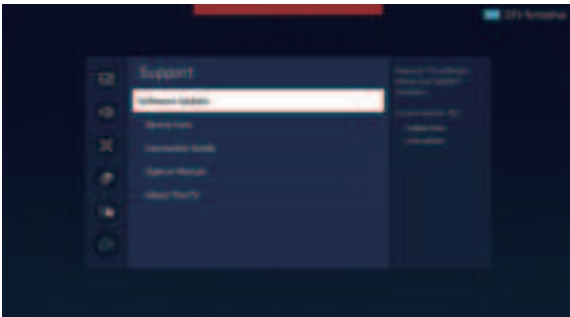

BASIC TROUBLESHOOTING

Many minor issues can be resolved by hard resetting, or power cycling the unit or upgrading the firmware.

To perform a hard reset, or power cycle, please use the following steps.

- Unplug it from the main power socket and leave it for 10-15 minutes.
- Press and hold the power button on the TV for 5 seconds.
- Connect the TV back to the power and turn it on.

USB device is not recognised

- This TV requires a minimum of 64GB storage for Live Playback and Recording functions.
- Ensure the drive is formatted for FAT32 before using with this TV. Use a computer to format the drive beforehand.

Poor picture and sound quality

- Try a different channel
- Adjust the antenna
- Check all connections

No picture or sound in TV status

- Try another channel
- Press the TV/AV button
- Make sure TV is plugged in
- Check the antenna connection

No sound or sound is too low at maximum volume

- Check the volume settings on any external speakers connected to your television
- Check another channel or input
- Check that MUTE hasn't been turned on

No colour, wrong colour or tints

- Make sure the program itself is broadcast in colour
- Select the picture menu, then adjust the colour and tint submenus

Picture rolls vertically

- Check all connections

Blurred or snowy picture, distorted sound

- Check direction, location and connections to your antenna
- Issues may be caused by the use of an indoor antenna (poor signal)

Remote control malfunctions

- Replace remote control batteries
- Check battery polarity (+/-)
- Remote is out of range, move closer to TV
- Remove any obstructions between remote and IR sensor of TV
- Make sure the power cord to your TV is plugged in and turned on

Image is not centred on the screen

- Adjust the horizontal and vertical position

“No Signal” on HDMI source

- Test the device with a different HDMI cable or port
- Try a different device connected to the same cable and port
- Perform a factory reset on your TV

For our full TV troubleshooting guide and extended User Manual for this TV, head online to help.kogan.com

SPECIFICATIONS

Dimensions

Without Stand	1918x1099x85mm
With Stand	1918x1155x401mm
VESA Wall Mount Pattern	600 x 300
Wall Mount Screw Size	M8x20mm (x4)
Weight	27.9kg
Gross weight	46.5kg

Audio

Speakers	2 x 8W
----------	--------

Connectivity

Ethernet (RJ45)	Yes
HDMI	2.0(x3)
HDMI-ARC	Yes HDMI 3
HDMI-CEC	Yes HDMI 1, HDMI 2, HDMI 3
USB	2.0 (x2)

This is a quick specifications list. For a complete guide, refer to the full User Guide for this model at help.kogan.com

Note:

- Design and specifications are subject to change without notice.
- Weight and dimension shown are approximate.

NOTES

[illegible]

Need more information?

This is a **Quick Start Guide**, and while we hope that this has given you the assistance needed for a simple set-up, a full user guide outlining all of this product's instructions and features can be found online at **help.kogan.com**

kogan.com