

# CP500

## Quick User Manual

### Product Introduction

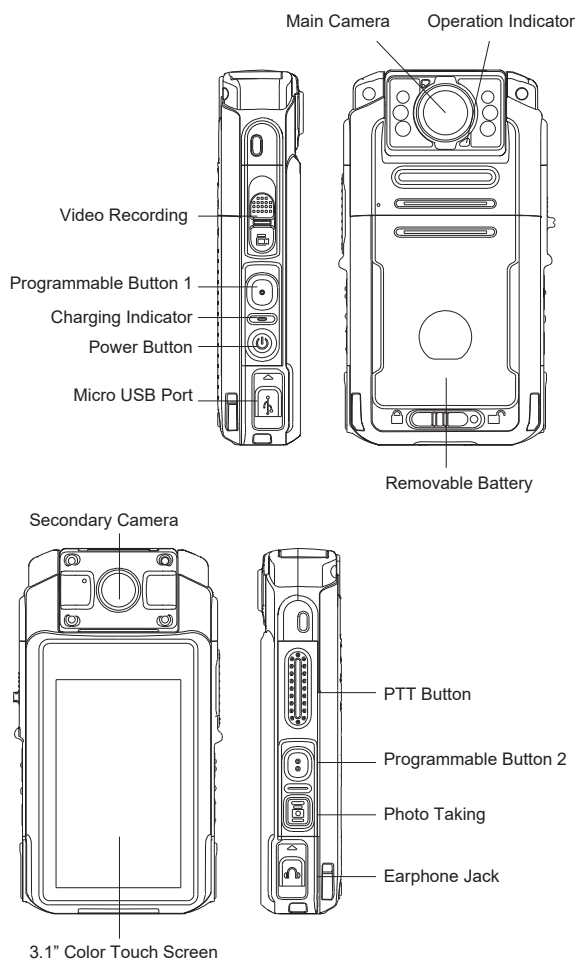

### Status Indicator

Item	Icon View	Definition
Battery Status		Full charged
		Low power
		In charging
Data Network		WiFi connected but no Internet error
		WiFi connected access to the internet
	3G/4G	3G/4G
		Bluetooth On
		GPS On
Signal Indicator		Flight Mode
		Signal Bars
		TF card indicator

### LED Operation Indicator Light

Item	Definition
Green light	1.Camera Preview 2.Screen Off and Standby
Red light flashing	In Videoing
Amber light flashing	In Recording
One-time Red light flashing	In Photo Taking

### LED Charging Indicator Light

Indicator Light	Definition
Red light	In Charging
Green light	Full Charged

## Unpacking and Checking

### Install a Nano SIM Card

As shown below, please take off the cover and unlock the SIM card slot, and put Nano SIM card into it and then lock it again.

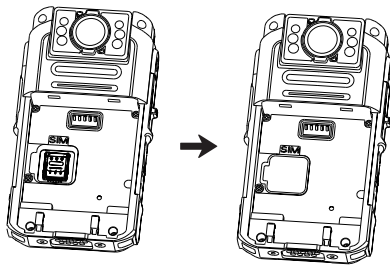

### Install and Remove the Battery

Prior to assembly, please aim at the slot on the device, make the battery protruded contact portion to accommodate the device by pressing the bottom of the battery and then lock the battery by sliding the locking button as the shown operation in sequence in the following figure.

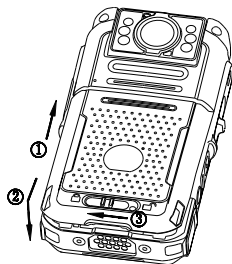

As shown below, please take off the cover and unlock the SIM card slot, and put Nano SIM card into it and then lock it again.

### Caution

Please be sure to use our original battery. Danger of fire or explosion may be caused if Non-original battery is used or the positive and negative poles are swapped over.

## Battery Charging

### Method 1: by USB cable

- 1.Plug the adaptor into the power socket.
- 2.Connect the device with the adaptor by Mini USB cable and then enter into the charging mode if the indicator light turns red.
- 3.The indicator will light green when the device is full charged.

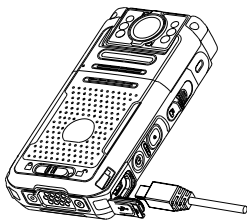

### Method 2: by Specified Charger (Optional)

- 1.Connect the charger with the power supply by the Type-C cable, make the cable loop with a counterclockwise rotation and then connect the adaptor through the lead groove as the following shown, and the indicators of both terminal slot and battery slot on the charger light green.
- 2.Put the device with the battery into the terminal slot as shown below, and then the indicator turns red to be in charging.
- 3.An extra battery could be put into the battery slot concurrently, and charged if the indicator turns red.
- 4.The indicators would light green when the charging is completed.

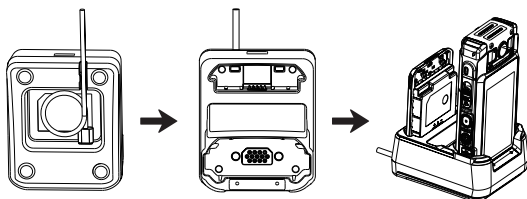

## Getting Started

### Switch On

Press the power button for 3 seconds under shutdown to power on.

### Switch Off

Press the power button for 3 seconds, enter into the shutdown interface and then tap the shutdown option to power off.

## Install and Remove the Belt Clip Bracket

1. Align the slot on the top of device with the clamp on the bracket, and push the device down with a click to complete the installation as shown below.

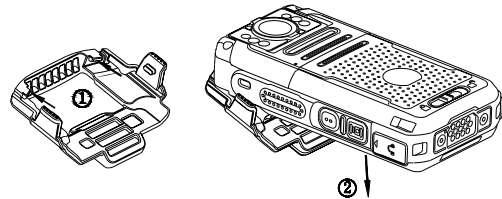

2. Insert the belt clip from left to right as shown in figure 3 and fasten it to the undercuts. 360° rotatable design of the belt clip makes a high wearable satisfaction.

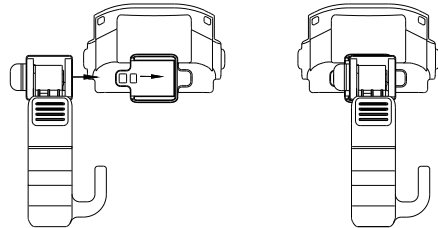

3. Hold the device with one hand, push the right undercut of the bracket with the other hand, and take the bracket off with the arrow direction as shown below.



## Video Recording

In the camera preview, slide the video recording switch downward to start the video recording and upward the switch to stop it.

## Photo Taking

In the camera preview, short press the photo taking button to enable it.

## Platform Login

The registration on Intelligence dispatch Network server is necessary to make this product to have the multiple functions like PoC PTT calling, Video Uploading, Position Transmitting, and Instant Messaging.

- 1.Click on the icons as Logout, Worktable, PoC Trunking, Message, Address Book, to log on the platform.
- 2.Click the button More to set up the server IP, communication port and data port.
- 3.Click the button Confirm to save the settings and return to the login interface.
- 4.Please make sure 4G and WiFi connection is working, input the account and password to login. The members ID, groups and online status will be shown on the homepage.

### Caution

Account and password will be provided by the system administrator. PoC PTT calling, Video uploading, Position Transmitting, Instant Messaging, Job Ticketing, Alarming and Geo-fencing could be enabled after a successful login.

## PoC PTT calling

- 1.Enter into groups, and press PTT button to make a call on the current group. Release the PTT button to make the call over.
- 2.Or, Click PoC trunking, and then press PTT to have a group call.
- 3.Or, Click on the icon as shown on the top right corner and select different groups to call.
- 4.Or, Click Address Book, and tick the user/users to make the individual call or dynamic group call.

## Video Upload

- 1.Click on the icon on the homepage to upload the current video information to the dispatcher.
- 2.Or, the video could be uploaded by an upward pulling with a silent transmission command on the dispatcher.

## Enable the Emergency Alarm

Long press the programmable button which is programmed as the Emergency button (the default orange one), to enable all the on-site information including real-time audio and video, location, and terminal ID to be uploaded to the dispatcher automatically, and send a beep alarm to the dispatcher and all the members in the same group.

## Disable the Emergency Alarm

Long Press the Emergency button to cancel it in the Emergency Alarm status.

To get more features and operation details, please contact us sales@aintel.cn !

# **FCC Warning**

## **15.19 Labeling requirements.**

This device complies with part 15 of the FCC Rules. Operation is subject to the following two conditions: (1) This device may not cause harmful interference, and (2) this device must accept any interference received, including interference that may cause undesired operation.

## **15.21 Information to user.**

Any Changes or modifications not expressly approved by the party responsible for compliance could void the user's authority to operate the equipment.

### **15.105 Information to the user.**

Note: This equipment has been tested and found to comply with the limits for a Class B digital device, pursuant to part 15 of the FCC Rules. These limits are designed to provide reasonable protection against harmful interference in a residential installation. This equipment generates uses and can radiate radio frequency energy and, if not installed and used in accordance with the instructions, may cause harmful interference to radio communications. However, there is no guarantee that interference will not occur in a particular installation. If this equipment does cause harmful interference to radio or television reception, which can be determined by turning the equipment off and on, the user is encouraged to try to correct the interference by one or more of the following measures:

- Reorient or relocate the receiving antenna.
- Increase the separation between the equipment and receiver.
- Connect the equipment into an outlet on a circuit different from that to which the receiver is connected.
- Consult the dealer or an experienced radio/TV technician for help.

**Absorption Rate (SAR) information:**

This device meets the government's requirements for exposure to radio waves. The guidelines are based on standards that were developed by independent scientific organizations through periodic and thorough evaluation of scientific studies. The standards include a substantial safety margin designed to assure the safety of all persons regardless of age or health.

FCC RF Exposure Information and Statement The SAR limit of USA (FCC) is 1.6 W/kg averaged over one gram of tissue. This device was tested for typical body-worn operations with the back of the device kept 10mm from the body without belt-clips, 0mm from the body with the belt-clips, 25mm from the face. To maintain compliance with FCC RF exposure requirements, use accessories that maintain an appropriate separation distance between the user's body and the back of the device. The use of belt clips, holsters and similar accessories should not contain metallic components in its assembly. The use of accessories that do not satisfy these requirements may not comply with FCC RF exposure requirements, and should be avoided. Use only the supplied or an approved antenna.