

# User Manual

## WIRELESS 2-IN-1 ADAPTER

### BA020

## Product Overview

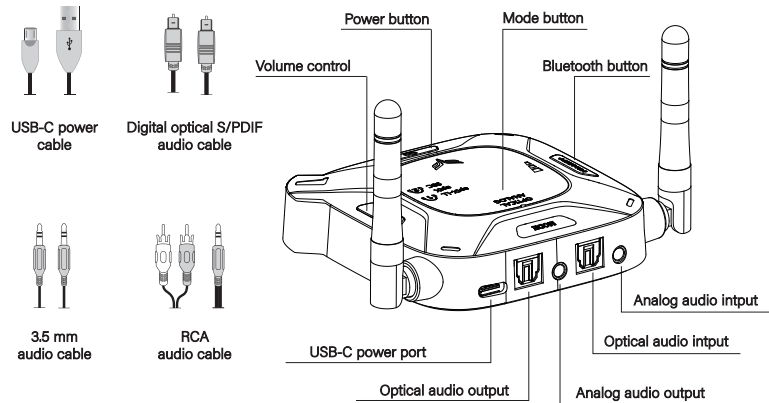

## Buttons & Light Indicators

BUTTON	OPERATION	FUNCTION	INDICATOR	BA020 STATUS
	Press	Power on / off		Powered on
	Press and hold for 4 seconds	Bluetooth connection		Flashing red and blue alternatively: Ready to pair
	Press and hold for 4 seconds			Solid blue: The 1st Bluetooth device connected
	Press	Connect to the last paired device		Flashing red and blue alternatively: Ready to pair the 2nd device
	Press			Solid blue: The 2nd Bluetooth device connected
MODE	/	/		Audio codec currently in use
	Press	Switch audio mode		Optical audio mode
	Press	Switch audio mode		Analog audio mode
VOLUME+	Press	Volume up		Current volume level
	Press and hold for 7 seconds	Disable / enable audio prompt	/	/

## Use In TX (Transmitter) Mode:

### STEP 1 Power On

1. Ensure the **USB-C** power cable is plugged into the **USB-C** power port of the BA020.

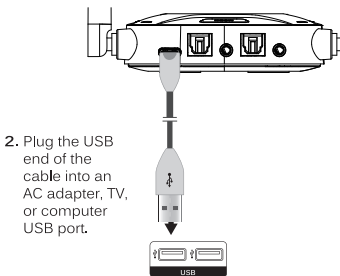

2. Plug the USB end of the cable into an AC adapter, TV, or computer USB port.

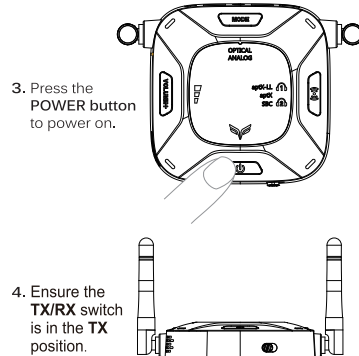

### STEP 2 Pair with Bluetooth Headphones

1. Put your Bluetooth headphones in pairing mode.

2. Once the headphones are in pairing mode, press and hold the Bluetooth button for 4 seconds to turn BA020 into pairing mode with the indicator flashing red and blue alternatively.

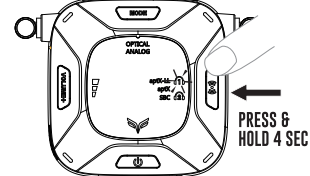

3. Once connected, the indicator will turn solid blue.

### OPTIONAL: PAIRING WITH A SECOND SET OF BLUETOOTH HEADPHONES

Use the procedure above to pair a second headphone after one is already connected.

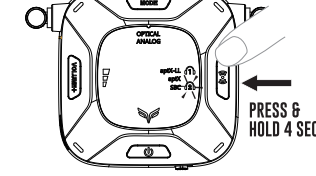

1. Turn on a second set of headphones and set it into pairing mode.  
2. Press and hold the Bluetooth button for 4 seconds to enter pairing mode.  
3. Once successfully connected, the indicator will turn solid blue.

### STEP 3 Choose ONLY ONE Audio Cable Supported by Your TV

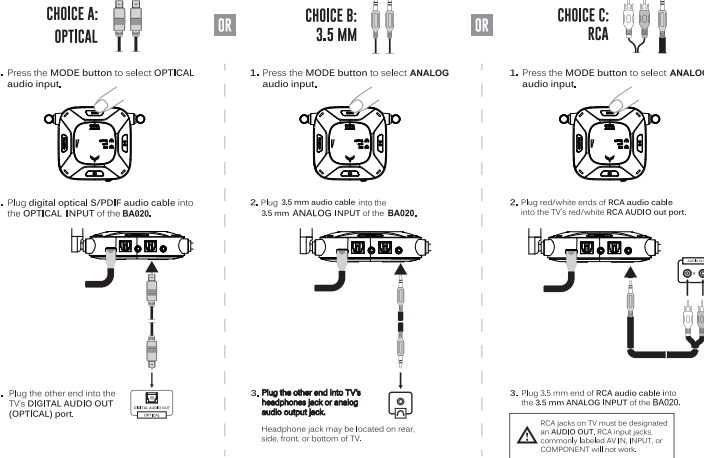

\* Test for sound. Make sure the volume on both your TV and headphones are turned up.

## Volume Control

Use volume controls on the device you are streaming from (such as your phone) to adjust the volume. If there is a volume control on your speaker or soundbar, you may use it to further adjust the volume.

## Subsequent Use

### Disable Audio Prompts

Press and hold the Volume control (VOLUME+) button for 7 seconds

### Enable Audio Prompts

Press and hold the Volume control (VOLUME+) button for 7 seconds

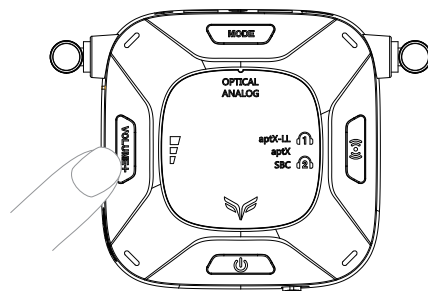

## Trouble Shooting

### No Sound: Optical

1. Check your TV setting. Change Sound Output to "Optical"

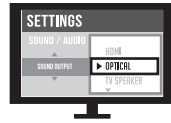

2. Change Digital Audio Output Format to "STEREO" or "DOLBY"

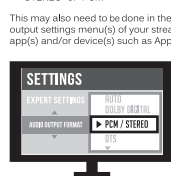

\*Exact menu and item names may vary with TV. On newer TV settings, it may be located in "Advanced settings" or "Expert settings" submenus.

### No Sound: RCA

1. Check your TV setting. Change audio output settings to "VARIABLE."

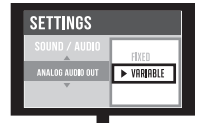

2. Set TV's internal speakers to "OFF."

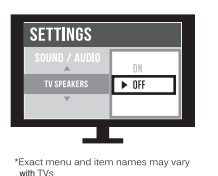

\*Exact menu and item names may vary with TV.

### Reset/Clear Memory

Hold the MODE button for 5 seconds, until the voice prompt "Memory cleared" is heard.

All previously paired devices will be deleted from memory, and new pairing will need to be created by procedure in STEP 2.

### Pass-Through

When speakers used in TX mode, the audio outputs of the BA020 can pass the TV's sound through a soundbar or other audio devices. This makes it possible to plug both the BA020 and a speaker into a TV with only one audio output.

Complete STEP 1 - STEP 2 in this setup guide. Pass-through only works when the input and output connections match. If you connect your TV via optical in STEP 1, then use optical to connect your soundbar. If you connect your TV via 3.5mm or RCA in STEP 1, then use 3.5mm to connect your soundbar.

## FCC Caution

### Compliance Information

This device complies with Part 15 of the FCC Rules. Operation is subject to the following two conditions:  
(1) This device may not cause harmful interference.  
(2) This device must not cause any interference received, including interference that may cause undesired operation.

### Disposal & Recycling

Dispose of this product in accordance with all local laws and regulations. Because this product contains electronic components and a battery, it must be disposed of separately from household waste. Contact local authorities to learn about disposal and recycling options.

## Warranty & Service

This product is covered with Alaisda product and labor warranty for 12 months from the date of its original purchase.

Any questions welcome to contact us: support@alaisda.com

## Extend 2 years warranty:

www.warranty-hub.com



## Use In RX (Receiver) Mode:

### STEP 1 Power On

1. Ensure the **USB-C** power cable is plugged into the **USB-C** power port of the BA020.

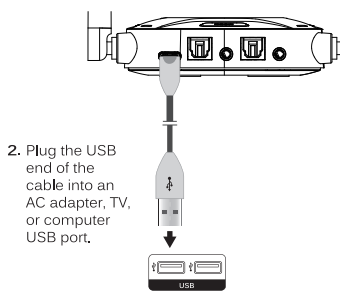

2. Plug the USB end of the cable into an AC adapter, TV, or computer USB port.

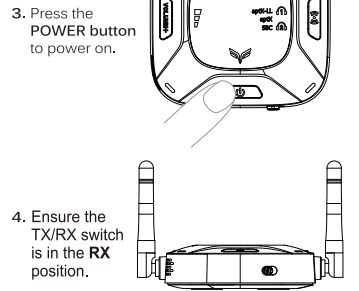

### STEP 2 Pair with Phone or Tablet

1. Press and hold the Bluetooth button for 4 seconds to set BA020 into pairing mode, there will be a voice prompt "Pairing" with the indicator flashing red and blue alternatively.

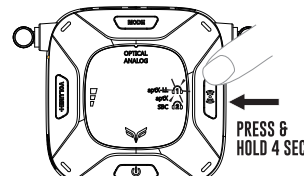

2. Open the Bluetooth menu on your phone, tablet, or other devices you wish to pair, usually located in Settings > Bluetooth. If needed, select "search for devices", "add new device", or "refresh".

3. Select "BA020" and allow pairing to complete. Use "0000" if a pin is required.

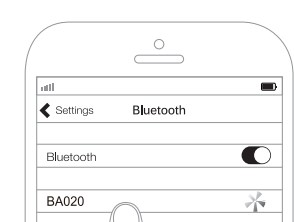

4. Once successfully paired, the flashing light will turn solid blue.

\* In RX mode, only one Bluetooth device can be used with the BA020 at a time.

### STEP 3 Connect to Speakers or Other Audio Devices

Choose one of the audio connection below, then connect with BA020.

