



# Desk Monitor Arm

## モニターアーム

Instruction Manual

取扱説明書

**EGDS15B/EGDS15W**

Rev01

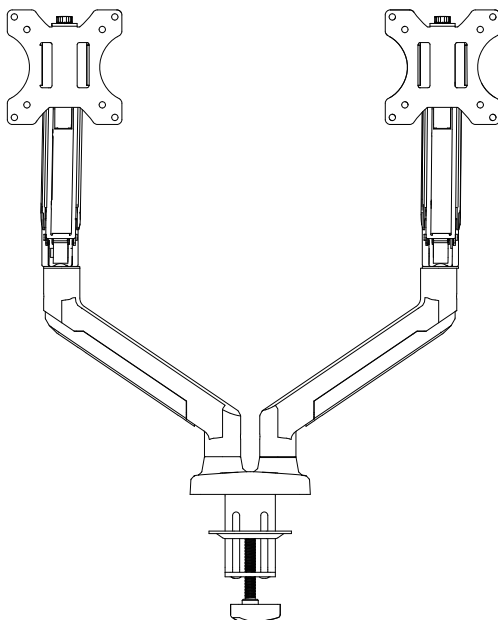
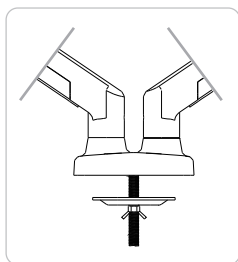

English	01-13
日本語	14-25

☎ 1-800-651-9525 (US/CA) Mon-Fri, 8am-8pm (CST)  
44-808-196-3875 (UK) Mon-Fri, 2pm-10pm (UTC)

🌐 <https://ergear.com>

✉ support@ergear.com  
supportjp@ergear.com (JP)

# Before getting started, let's make sure this mount is compatible.

- 1** Is the VESA pattern of your monitor 75 x 75mm (3 x 3") or 100 x 100mm (3.9 x 3.9")?

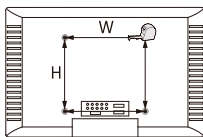

- ☐ Yes – Perfect!
- ☐ No – This mount is NOT compatible.

- 2** Does your monitor (including accessories) weigh less than 22 lbs (10kg)?



- ☐ Yes – Perfect!
- ☐ No – This mount is NOT compatible.

- 3** Tools Needed (not included)

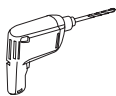

Electric Drill  
(optional)



7/16-7/8" (11-22mm)  
Drill Bit  
(optional)

## NOTE

- Please carefully read all instructions before attempting installation. If you DO NOT understand the instructions or have any questions or concerns, please call technical support or email customer service.
- Not all hardware included in this package will be used.

## CAUTION

Avoid potential injuries and property damage!

- DO NOT use this product for any purpose that is NOT explicitly specified in this manual. DO NOT exceed weight capacity. We are NOT liable for damage or injury caused by improper mounting, incorrect assembly or inappropriate use.
- Before starting assembly, verify all parts are included and undamaged. DO NOT use damaged or defective parts. If you require replacement parts, please call technical support or email customer service.

## ⚠ WARNING

- This product contains small parts that may pose a choking hazard.
- This product contains gas spring arms which are under high pressure. Do not puncture these arms or expose the arms to fire or flame. If product is defective, please call technical support or email customer service.
- Do not use this product on desks made of particle board or other soft woods.
- The information contained in this manual does not cover all possible conditions or variables in relation to the installation of this product.

- 4** Important Safety Information

# Product Features

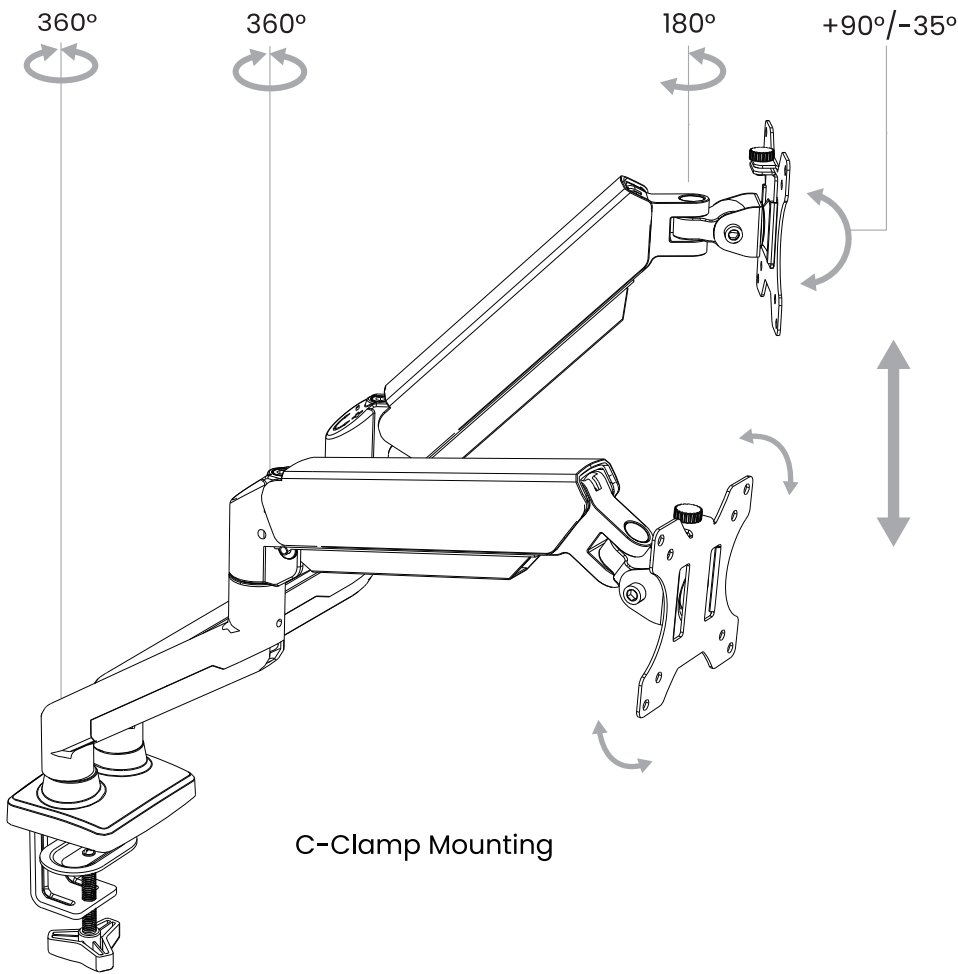

C-Clamp Mounting

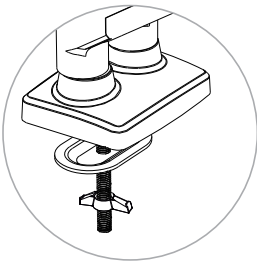

Grommet Mounting

# TENSION ADJUSTMENT SHOULD ONLY BE DONE AFTER MONITOR INSTALLATION



## Attention

**DO NOT adjust tension without monitor attached.**

1. Verify the weight of your monitor (including accessories) is between 4.4-22 lbs (2-10kg). Monitor weight information can be found in the monitor instruction manual or by contacting the manufacturer.
2. Ensure monitor has been securely attached to the mount.



### WARNING:

- Gas spring arm is under pressure and should be handled with care.
- Failure to follow the instructions may result in damage to the mount and/or personal injury.

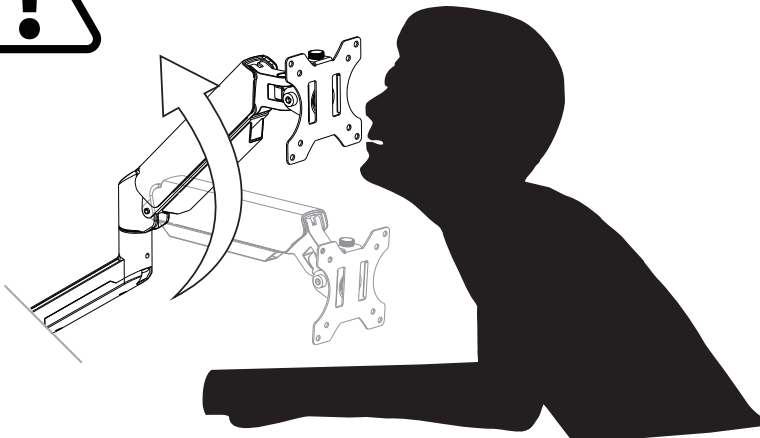



# Step 1

## Supplied Parts and Hardware

**03** x 1

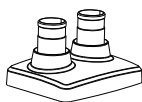

Base

**05** x 1

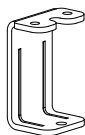

C-Clamp Brace

**06** x 1



C-Clamp

**A** x 2



Bolt

**B** x 1



Nut

**C** x 1



Grommet Bolt

**D** x 1



5/32" (4mm)  
Small Allen Key

**E** x 1



1/4" (6mm)  
Large Allen Key

# Step 2

## Supplied Parts and Hardware

**01** x 2

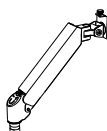

Upper  
Arm Section

**02** x 2

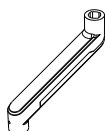

Lower  
Arm Section

**D** x 1



5/32" (4mm)  
Small Allen Key

# Step 3

## Supplied Parts and Hardware

**04** x 2

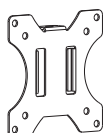

Monitor Plate

**M-A** x 8

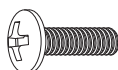

M4 x 12mm  
Bolt

**M-B** x 8

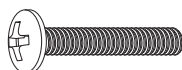

M4 x 30mm  
Bolt

**M-C** x 8



Washer

**M-D x 8**



L13mm  
Spacer

**E x 1**



1/4" (6mm)  
Large Allen Key

## Step 5/7

### Supplied Parts and Hardware

**E x 1**



1/4" (6mm)  
Large Allen Key

## Step 9

### Supplied Parts and Hardware

**07 x 2**

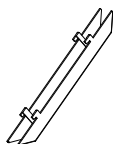

Cable Cover

**E x 1**



1/4" (6mm)  
Large Allen Key

## Step 1 Install the Base

### For C-Clamp Mounting

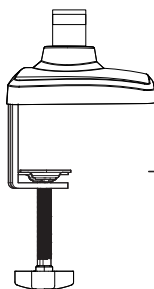

For desk thickness:  
0.39-2.56"  
(10-65mm)

OR

### For Grommet Mounting Skip to Page 08

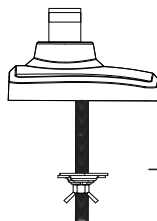

For desk thickness:  
0.39-2.17"  
(10-55mm)

### Option A For C-Clamp Mounting

1

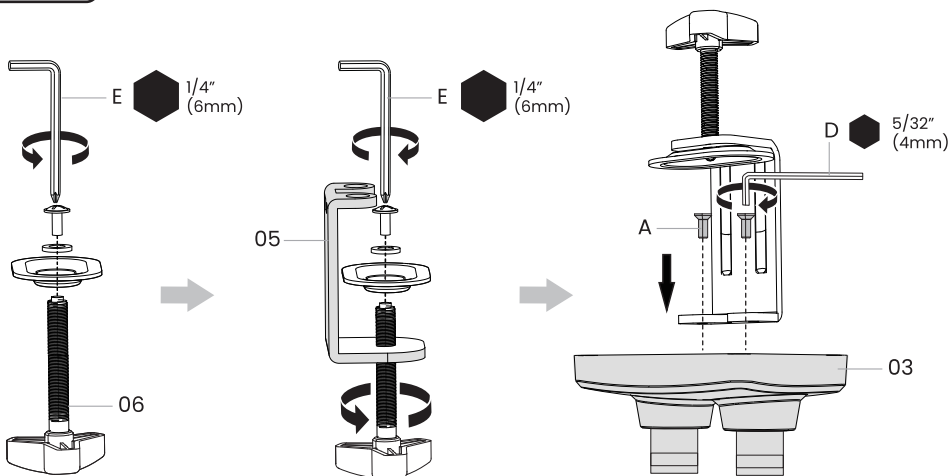

2

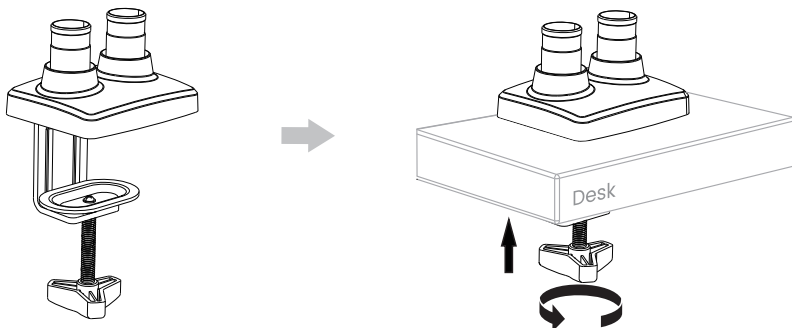

If your desktop is too thin, you may be able to use a wood board or block as a spacer. Please note that the C-clamp plate must make full contact with the desk and/or wood spacer.

### Example 1

If there is a crossbar underneath the desk, you need to use a spacer that is the same height as the crossbar.

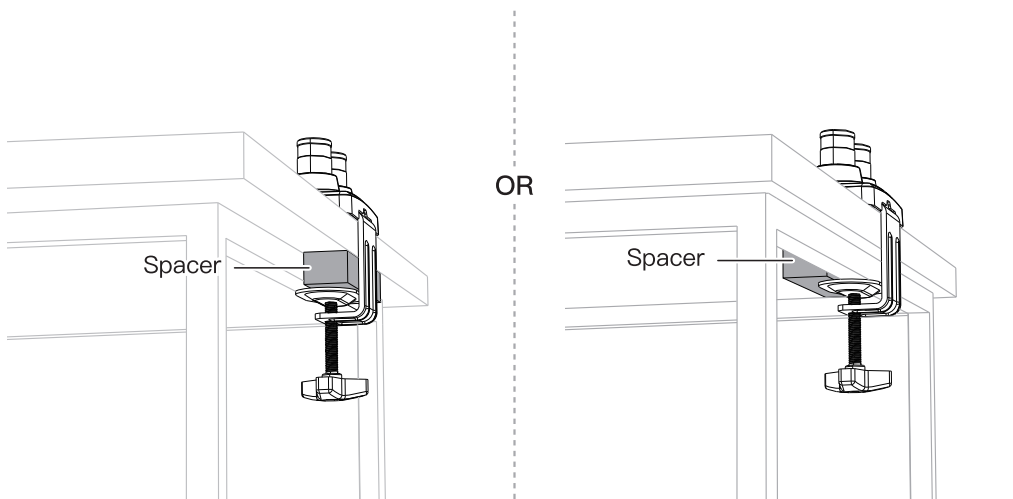

### Example 2

A spacer can be placed on top of the desk to fulfill the required dimensions.

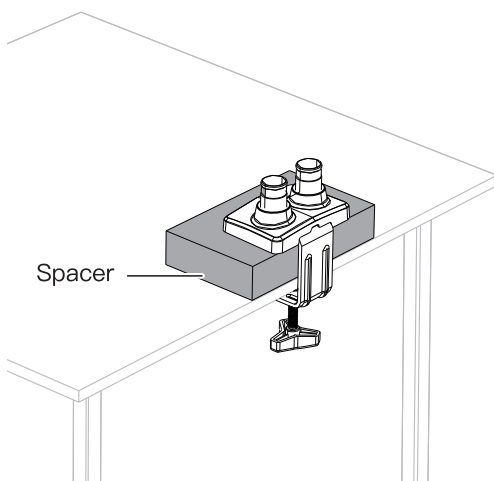

### Example 3

A spacer can also be placed on top of the desk to maximize installation height.

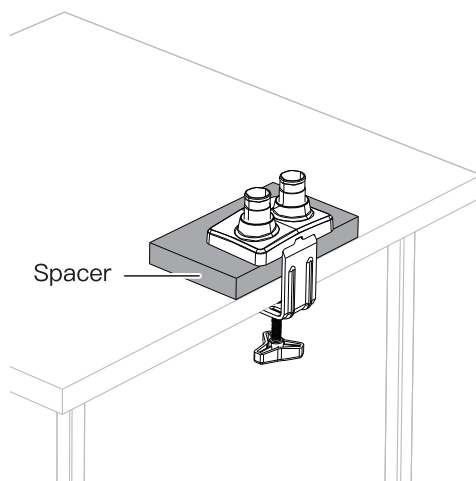

## Option B For Grommet Mounting

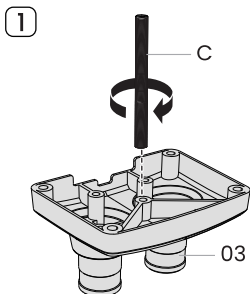

**CAUTION:**  Ensure the grommet bolt is screwed securely into the base.

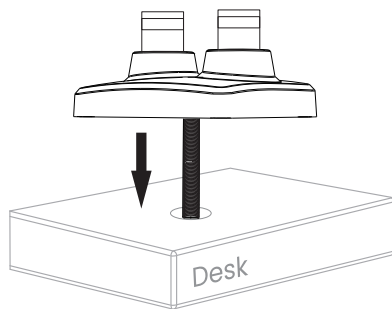

2 Separate the C-clamp and keep the locking plate [06a] for later use.

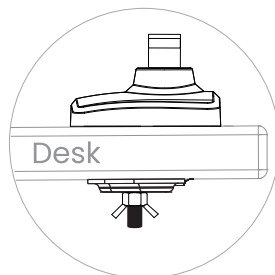
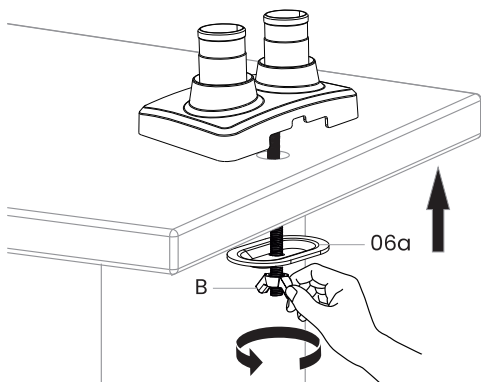
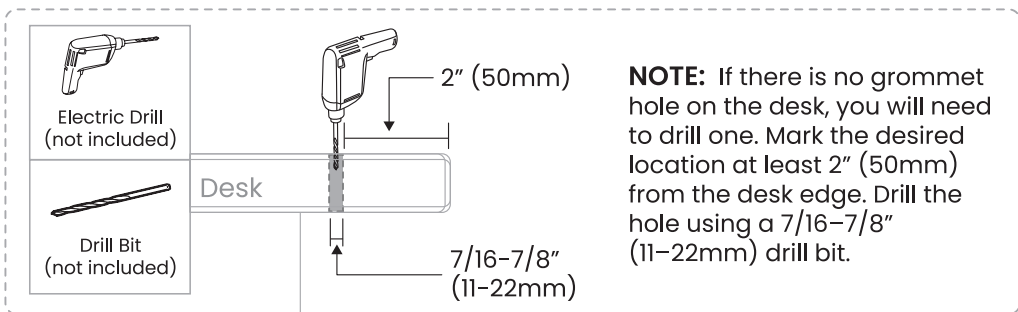
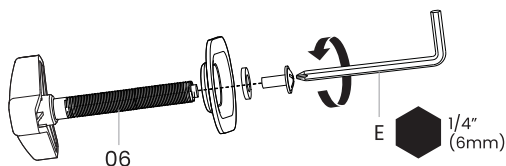

## Step 2 Attach the Lower and Upper Arm Sections

Attach the upper and lower arm sections [01] and [02], then tighten the set screws. Do not overtighten, as this may affect the rotation of the arm.

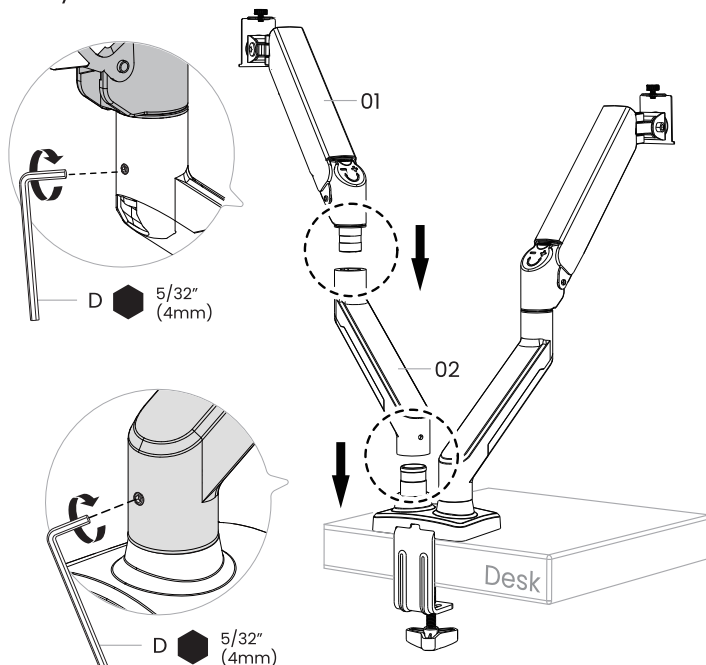
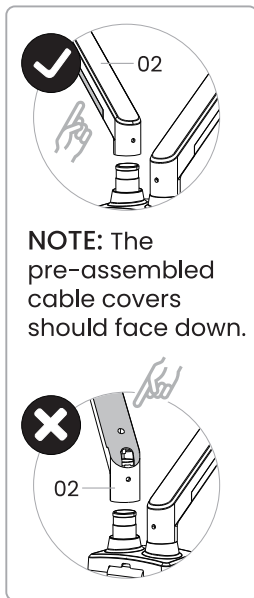

## Step 3 Attach the Monitor Plates to the Monitors

Hand thread bolts into the threaded inserts on the back of your monitor to determine which bolt (M4 x 12mm or M4 x 30mm) to use. A minimum of 4-5 turns into the threading is required. Do not turn past the bottom of the hole.

Only one bolt size fits the monitor.

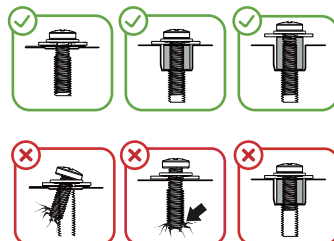
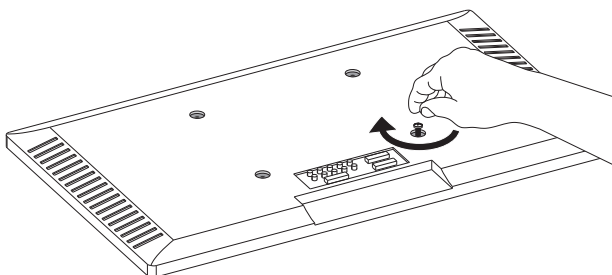
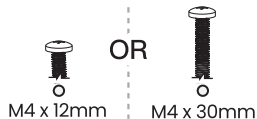

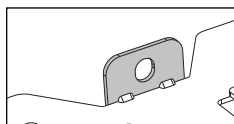

The hanging tab should be directed toward the top of the monitor.



## For Flat Back Monitor

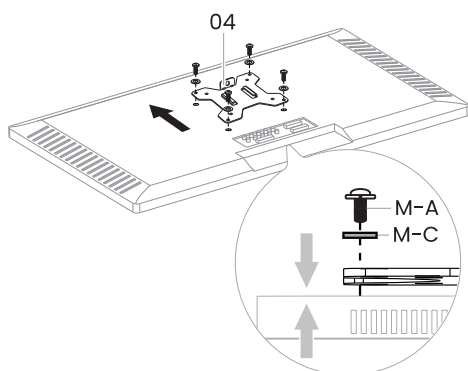

OR

## For Curved Back Monitor

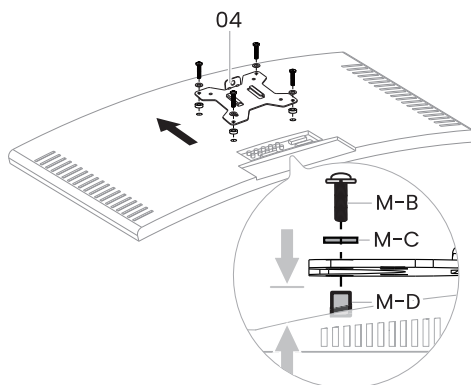

# Step 4 Hang the Monitors on the Mount

Remove the knobs [S] from the monitor plate connectors, then hang the monitors and secure them by tightening the knobs [S].



**HEAVY!** You may need assistance with this step.

**NOTE:** Gas spring tension is preset at 11-13.2 lbs (5-6kg). After hanging the monitor on the mount, release the monitor slowly so it doesn't sink down too quickly.

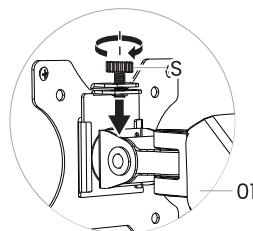
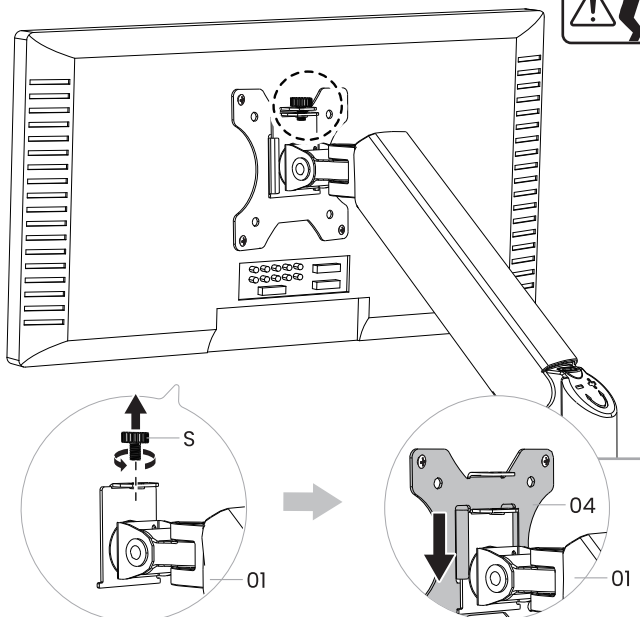

## Step 5 Adjust Gas Spring Tension

- 1 Hold the upper arm in a horizontal position. In this position, you can access the gas spring tension adjustment bolt to increase or decrease tension until the arm stays in position by itself.



### CAUTION:

To avoid damage to monitor or mount, always keep the arm in a horizontal position while making adjustments. You may need assistance with this step.

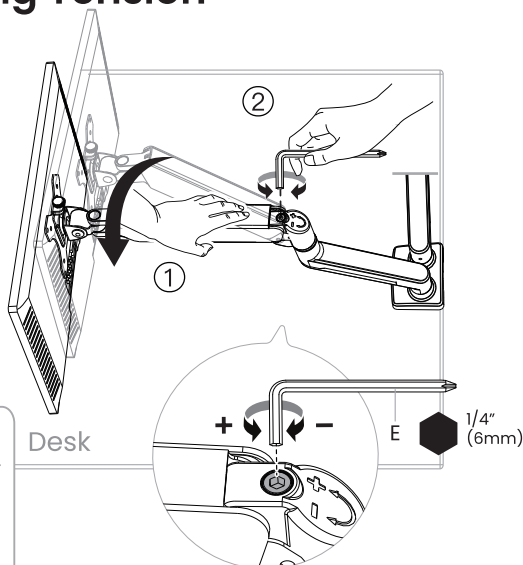

- 2 Use the large Allen key to adjust gas spring tension until the arm stays in position by itself. Once correctly adjusted, you can raise and lower your monitor and it will stay in position.

Scan the QR code to watch the arm adjustment video.

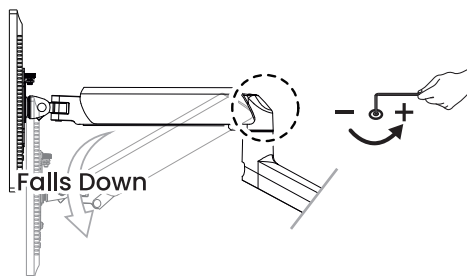

**If the monitor falls below the desired height:**

Turn counter-clockwise (+) to increase gas spring tension until the monitor can stay at the desired height by itself.

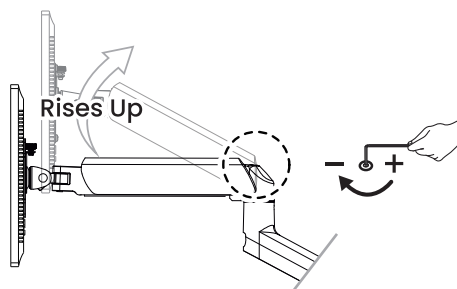

**If the monitor rises up above the desired height:**

Turn clockwise (-) to reduce gas spring tension until the monitor can stay at the desired height by itself.



## Step 6 Swivel Restriction

Incorrect

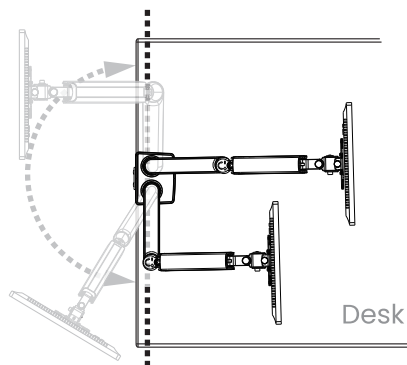
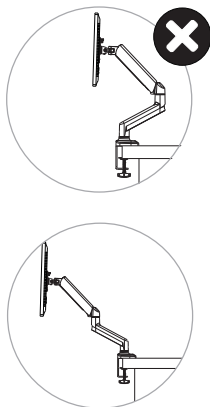

Correct

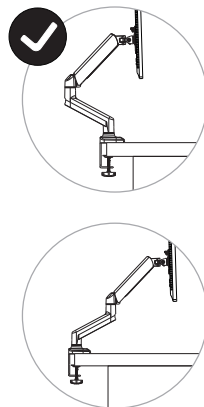

### WARNING:

Do not position or swivel the monitor beyond the edge of the desktop. Doing so may cause the unit to tip over and fall.



## Step 7 Tilt Adjustment



Adjust your monitor by gripping the monitor edges. Do not press on the screen itself. If it is difficult to adjust, loosen the tilt-lock bolt [T] on the monitor plate connector. Adjust the monitor to the desired angle, then fully tighten the bolt to lock the tilt angle.

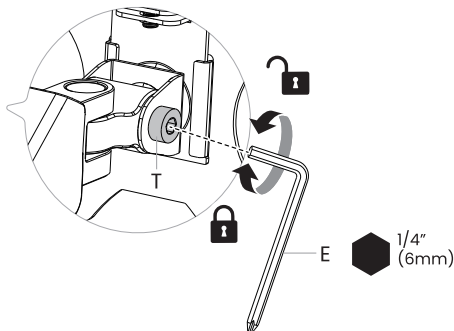
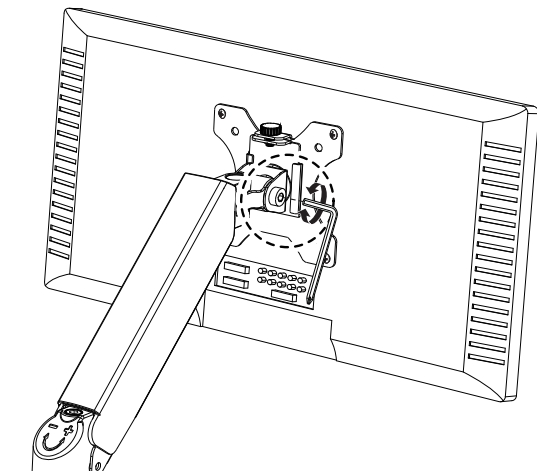

## Step 8 Monitor Rotation

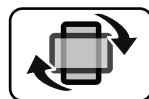
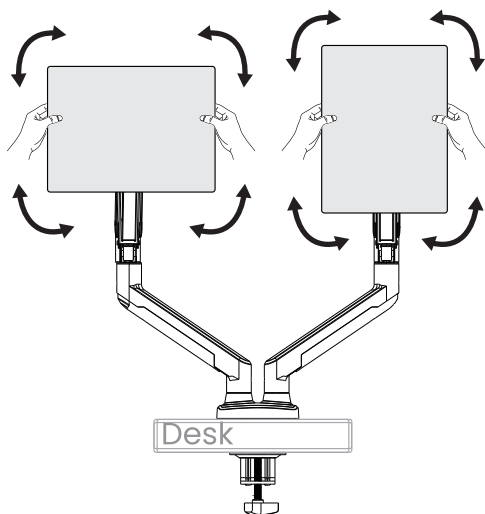

360°  
Rotation

## Step 9 Route Cables Down the Arm

