

**DREO**

# Smart Tower Fan

## USER MANUAL

[www.dreo.com](http://www.dreo.com)

DR-HTF001S

### Looking for help?

Contact us to get expert support.



[support@dreo.com](mailto:support@dreo.com)



(888) 290-1688



[www.dreo.com](http://www.dreo.com)

Mon - Fri, 9:00 am-5:00 pm PST/PDT

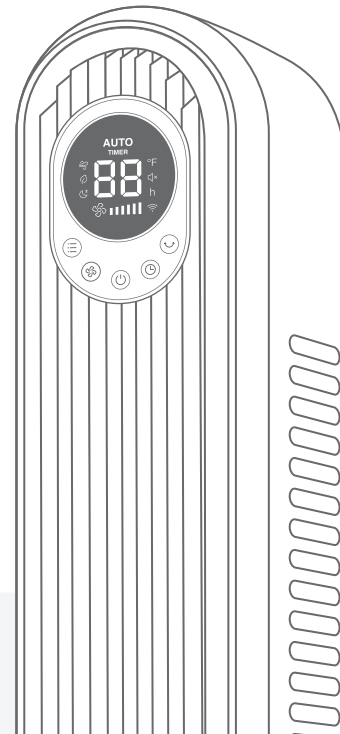

//

# Thanks for Choosing DREO!

Your support means the world to us. We hope you enjoy our product as much as we did creating it.



## CONTENTS

1

IMPORTANT SAFETY  
INSTRUCTIONS

1-2

3

CONNECTING TO  
YOUR TOWER FAN

6

5

USING YOUR TOWER  
FAN

9-12

7

TROUBLESHOOTING

15

2

ASSEMBLING YOUR  
TOWER FAN

3-5

4

KNOWING YOUR  
TOWER TOWER  
FAN

7-8

6

CLEANING  
AND MAINTENANCE

13-14

8

FCC STATEMENT

16

# IMPORTANT SAFETY INSTRUCTIONS



READ ALL CAUTIONARY MARKINGS ON THE APPLIANCE AND SAFETY INSTRUCTIONS IN THE USER MANUAL BEFORE USE.



**Do not** cover the air inlet and outlet while in operation.



**Do not** use the fan near flammables and combustibles.

## General Safety

1. Children shall not play with the appliance. Cleaning and maintenance shall not be performed by children without supervision.
2. Use the appliance as described in the user manual only. Any other use not recommended in the user manual may cause fire, electrical shock, or personal injury.
3. This appliance can be used by children aged above 8 years and persons with reduced physical, sensory or mental capabilities or lack of experience and knowledge if they have been given supervision or instruction concerning use of this appliance in a safe way and understand the hazards involved.

## Operation Safety

1. Place the appliance on a flat, dry surface before use.
2. **Do not** immerse in water and any other liquids.
3. **Do not** use the appliance until the base is installed.
4. **Do not** insert your fingers, pencil and any other objects into the grilles while in operation.
5. **Do not** dismantle, repair, or modify. All servicing should be performed by qualified personnel.

## Electricity Safety

1. Make sure that the voltage of your electricity supply is the same as that indicated on the appliance.
2. Always unplug before cleaning or leaving the appliance unused for a long period of time. Keep your hands dry when plugging/unplugging.
3. Do not operate any fan with a damaged cord or plug. Discard fan or return to an authorized service facility for examination and/or repair.
4. Do not run cord under carpeting. Do not cover cord with throw rugs, runners, or similar coverings. Do not route cord under furniture or appliances. Arrange cord away from traffic area and where it will not be tripped over.
5. **WARNING:** To reduce the risk of fire or electric shock, do not use this Fan with any solid-state speed control device.
6. This appliance employs overload protection (fuse). A blown fuse indicates an overload or short-circuit situation. If the fuse blows, unplug the product from the outlet. Replace the fuse as per the user servicing instructions and check the appliance. If the replacement fuse blows, a short-circuit may be present and the appliance should be discarded or returned to an authorized service facility for examination and/or repair.
7. This appliance has a polarized plug (one blade is wider than the other). To reduce the risk of electric shock, this plug is intended to fit in a polarized outlet only one way. If the plug does not fit fully in the outlet, reverse the plug. If it still does not fit, contact a qualified electrician. Do not attempt to defeat this safety feature.

## FOR HOUSEHOLD USE ONLY READ AND SAVE THESE INSTRUCTIONS

### Gentle Reminder:



Check the appliance regularly and refer to TROUBLESHOOTING or contact our customer support if it shows any of the following signs:

- Power cord or plug is damaged.
- Loud noise, unusual smell or excessive heat.

### Specifications

Model	DR-HTF001S
Input	AC 120V 60Hz
Rated Power	50W
Battery Type	CR2025 3V

# ASSEMBLING YOUR TOWER FAN

## 2

### Assembly Instructions

When using the appliance for the first time, remove the wraps and attach the parts by following the steps below.

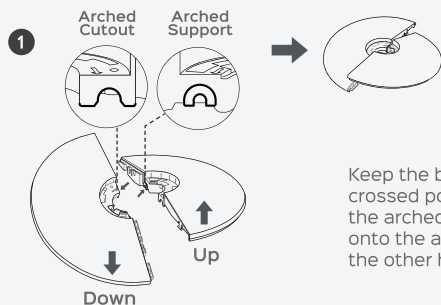

Keep the base halves in a crossed position, then hook the arched cutout on one half onto the arched support on the other half.

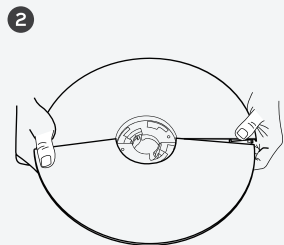

Press down on edges to click two base halves together.

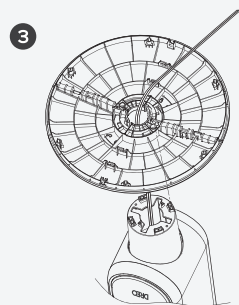

Run the cord through the center hole.

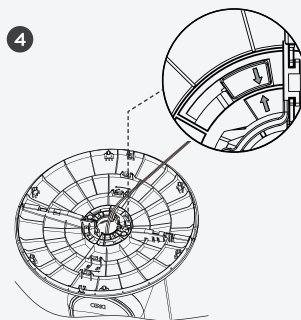

Fit the base onto the bottom of the fan by aligning the arrows on the underside.

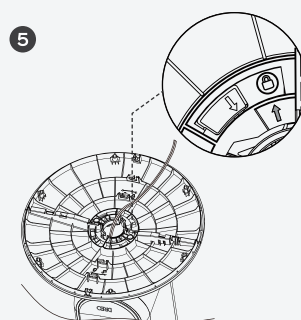

Rotate the base counterclockwise to lock in place.

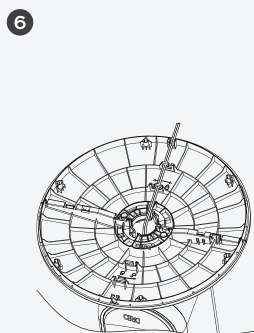

Thread the cord through all REAR cord keepers and put the fan upright.

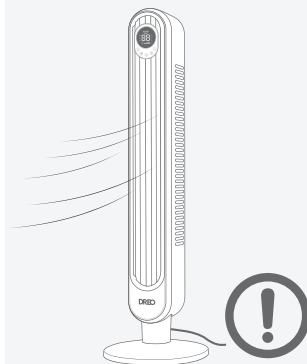

### CAUTION

- Do not operate the tower fan if the base has not been installed.
- Make sure to thread the cord through all rear cord keepers.

## Package Contents

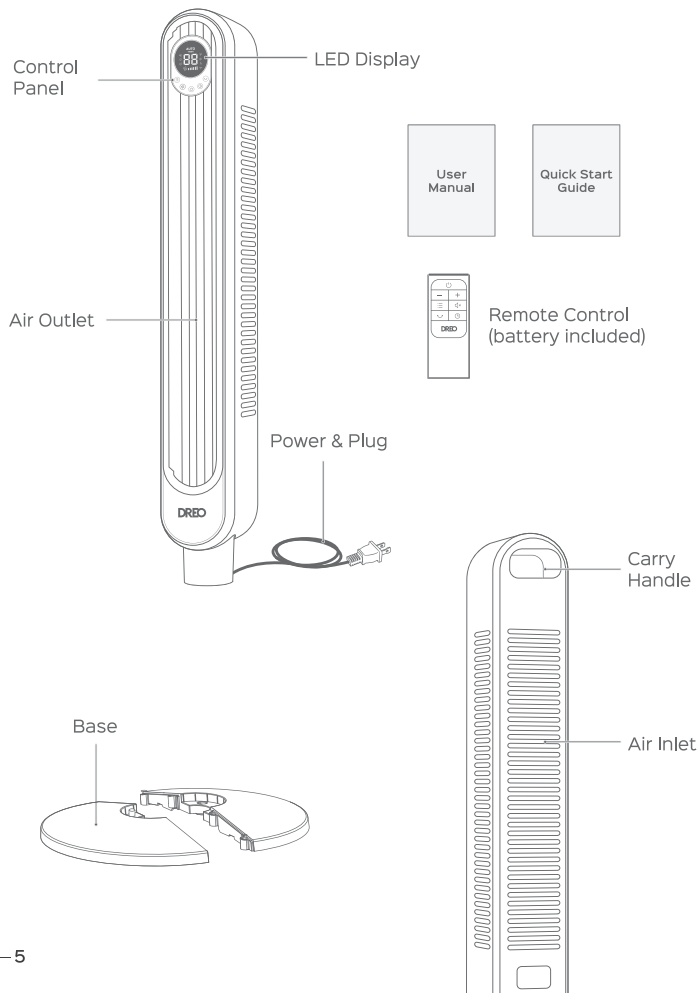

## CONNECTING TO YOUR TOWER FAN

# 3



Before connecting the appliance to your mobile device, please scan the QR code on the left or go to the app store and search “Dreo”, then select and download the app.



You can use the Dreo app to connect your smart tower fan to **Amazon Alexa** or **Google Home**. Please follow the in-app instructions to set up your voice assistant.

*NOTE: You must create a Dreo account to access voice assistants.*

- 1 Launch Dreo and sign in or create account by following in-app instructions.
- 2 Enable Bluetooth on your mobile device and plug in your tower fan.
- 3 Tap **+ Add Device** and select the tower fan you want to link.
- 4 Hold the Oscillation button (⌂) for 5 seconds to start WiFi connection settings.  
(Tip: The WiFi icon (📶) will keep flashing when pairing.)
- 5 Follow in-app instructions to complete WiFi connection.
- 6 You're now ready to control the appliance on your app.  
(Tip: To restart connection settings, hold the Oscillation button (⌂) again for 5 seconds.)

# KNOWING YOUR TOWER FAN

## Control Panel



### Power Button

- Turn power on/off
- Long press 10s to reset to factory settings



### Mode Button

Switch between Normal/Natural/Sleep/Auto Mode



### Fan Speed Button

Adjust airflow volume (1-6 levels)



### Timer Button

Select to set a timer (0-12h)



### Oscillation Button

- Adjust airflow direction
- Long press 5s to start network settings and device pairing

## LED Display



Normal Mode



Natural Mode



Sleep Mode

AUTO

AUTO Mode



Fan Speed



Temperature



Mute



WiFi Connection

TIMER  
00 00 h

Fan Speed/ Timer Hour

TIMER

Timer

# USING YOUR TOWER FAN

## General Operations

# 5



- 1 Press to turn on, and to choose a working mode.
- 2 Press to adjust the airflow volume.
- 3 Press to change the airflow direction.
- 4 Press to set a timer.
- 5 Press to turn off the tower fan.

## Working Modes

### Sleep Mode (Mute Auto On)

Fan speed decreases every 30 minutes.

Speed decreases by two levels at most and will remain constant if at level 1:

For level 6: 6→5→4

For level 5: 5→4→3

For level 3: 3→2→1

For level 2: 2→1

For level 1: 1

### Auto Mode Fan speed adapts to the ambient temperature.

### Normal Mode Fan runs at the constant speed.

### Natural Mode Fan runs at alternating speeds.

## Additional Features



**Mute** (remote control only)  
Press to turn on/off the button sounds.



**Speed/Temp Switch** (long press)  
The display shows the fan speed by default. Long press the Mode button to switch speed to temperature.



**Firmware Update**  
Check the firmware version on the Dreco app and update regularly for the fan to work more efficiently.  
 Display will show "UP" during the update process. Do not operate until the update is completed.



**Timer**  
When the fan is ON, press the Timer button repeatedly to set a timer (1-12h). When the timer ends, the fan will stop running automatically. To cancel, set the timer to 0 hour.  
**Note:** Display will return to fan speed/temperature after 10 seconds.



**Memory**  
If the fan stays connected to the electrical outlet after turning OFF, the fan will operate under the previous settings (except timer setting) when turned ON again.



**Display Auto Off**  
- Display turns off after 1 minute (after 5 seconds in sleep mode).  
- Wake up the display with any button.

## Getting the Most out of Your Tower Fan

1. Remove any tall obstacles that might block the airflow from the fan.
2. Combine with your AC unit to get cooler air throughout the room.
3. Position the tower fan closer to you to get more direct airflow.
4. Place a bucket of ice in front of the fan for an extra cooling boost.

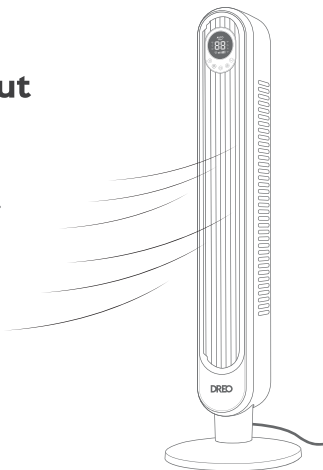

## Remote Control

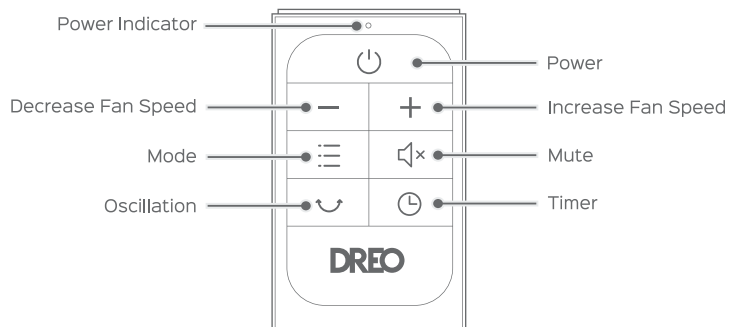

## Battery Replacement

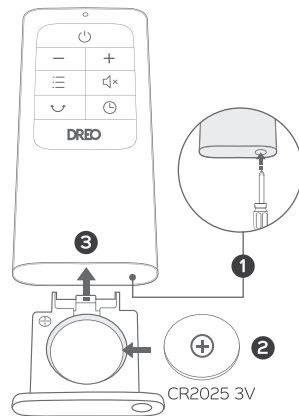

- 1 Press the locking button to pop out the battery holder.
- 2 Replace with the same battery type with the (+) side facing up.
- 3 Push in the holder until securely locked into place.

**Note:** If the indicator on the remote control doesn't turn on any more, please consider replacing the battery.



### WARNING

Chemical Burn Hazard. Keep batteries away from children.

This product contains a lithium button/coin cell battery. If a new or used lithium button/coin cell battery is swallowed or enters the body, it can cause severe internal burns and can lead to death in as little as 2 hours. Always completely secure the battery compartment. If the battery compartment does not close securely, stop using the product, remove the battery, and keep it away from children. If you think batteries might have been swallowed or placed inside any part of the body, seek immediate medical attention.

The cells must be disposed of properly, including keeping them away from children. Even used cells may cause injury.



# CLEANING AND MAINTENANCE

## 6

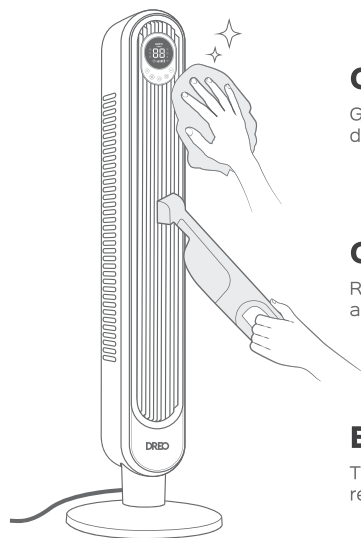

### Outer Surface

Gently wipe off the dust with a soft, dry cloth.

### Grilles & Blades

Remove the dust using a vacuum or air duster.

### Base

The base can be disassembled in reverse order of assembly.

### CAUTION



1. Always unplug the fan before any cleaning or maintenance to avoid the risk of fire, electric shock, or injury to persons.
2. Do not immerse in water or get water inside the motor housing.
3. Do not use any chemical agents when cleaning the fan.
4. Store in a cool, dry place and cover it to protect from dust.

## User Servicing Instructions (Fuse)

This appliance features a fused safety plug that protects against overload or short-circuit situations. If the fuse blows, please cut off power and follow the below instructions or consult a qualified electrician.

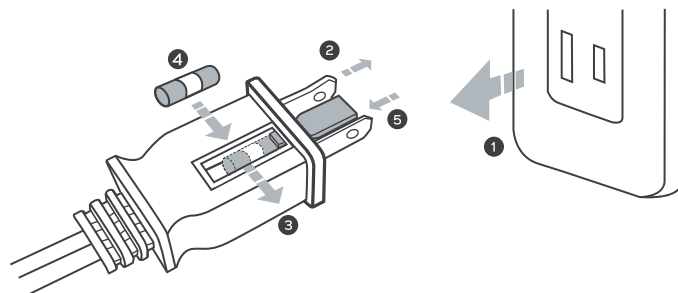

- 1 Grasp plug and remove from the receptacle or other outlet device. Do not unplug by pulling on cord.
- 2 Open fuse cover. Slide open fuse access cover on top of attachment plug towards blades.
- 3 Remove fuse carefully. Push the fuse from the other side to remove the fuse.
- 4 Risk of fire. Replace fuse only with 2.5 Amp, 125 Volt fuse.
- 5 Close fuse cover. Slide closed the fuse access cover on top of attachment plug.



### WARNING

Risk of fire. Do not replace attachment plug. Contains a safety device(fuse) that should not be removed. Discard product if the attachment plug is damaged.

# TROUBLESHOOTING



## My fan won't turn on!

1. Make sure that the cord is connected to a powered outlet and the mains voltage corresponds with the voltage indicated on the fan.
2. Check if the fuse has blown. If the fuse has blown, please refer to **page 14**.

## My fan is shaky and wobbling!

1. Place the fan on a flat, level surface.
2. Incorrect installation might also cause shakiness. Please refer to the assembly instructions in **page 3-4**. Note that the power cord must be run through all three keepers.

## My fan is making vibration and noise!

1. Place the fan on a flat, level surface.
2. Be sure not to insert anything into the air inlet and outlet.

If your problem is not listed or still persists, please feel free to contact us. This appliance is covered with 12-month warranty by default. Extend your warranty for free by registering your product at [dreocom.com/warranty](https://dreocom.com/warranty)

# FCC STATEMENT



This device complies with Part 15 of the FCC Rules.

This equipment has been tested and found to comply with the limits for a Consumer ISM equipment, pursuant to Part 15 of the FCC Rules. These limits are designed to provide reasonable protection against harmful interference in a residential installation. This equipment generates, uses and can radiate radio frequency energy and, if not installed and used in accordance with the instructions, may cause harmful interference to radio communications. However, there is no guarantee that interference will not occur in a particular installation.

"Please note that changes or modifications of this product is not expressly approved by the party responsible for compliance could void the user's authority to operate the equipment."

"If this equipment does cause harmful interference to radio or television reception, which can be determined by turning the equipment off and on, the user is encouraged to try to correct the interference by one or more of the following measures:

- Reorient or relocate the receiving antenna.
- Increase the separation between the equipment and receiver.
- Connect the equipment into an outlet on a circuit different from that to which the receiver is connected.
- Consult the dealer or an experienced radio/TV technician for help.

 [www.dreocom.com](https://www.dreocom.com)

 Shenzhen Hesung Innovation Technology Co., LTD

 26F, Bldg A7, Creative City, Shenzhen, China



MADE IN CHINA



Intertek  
5020677