

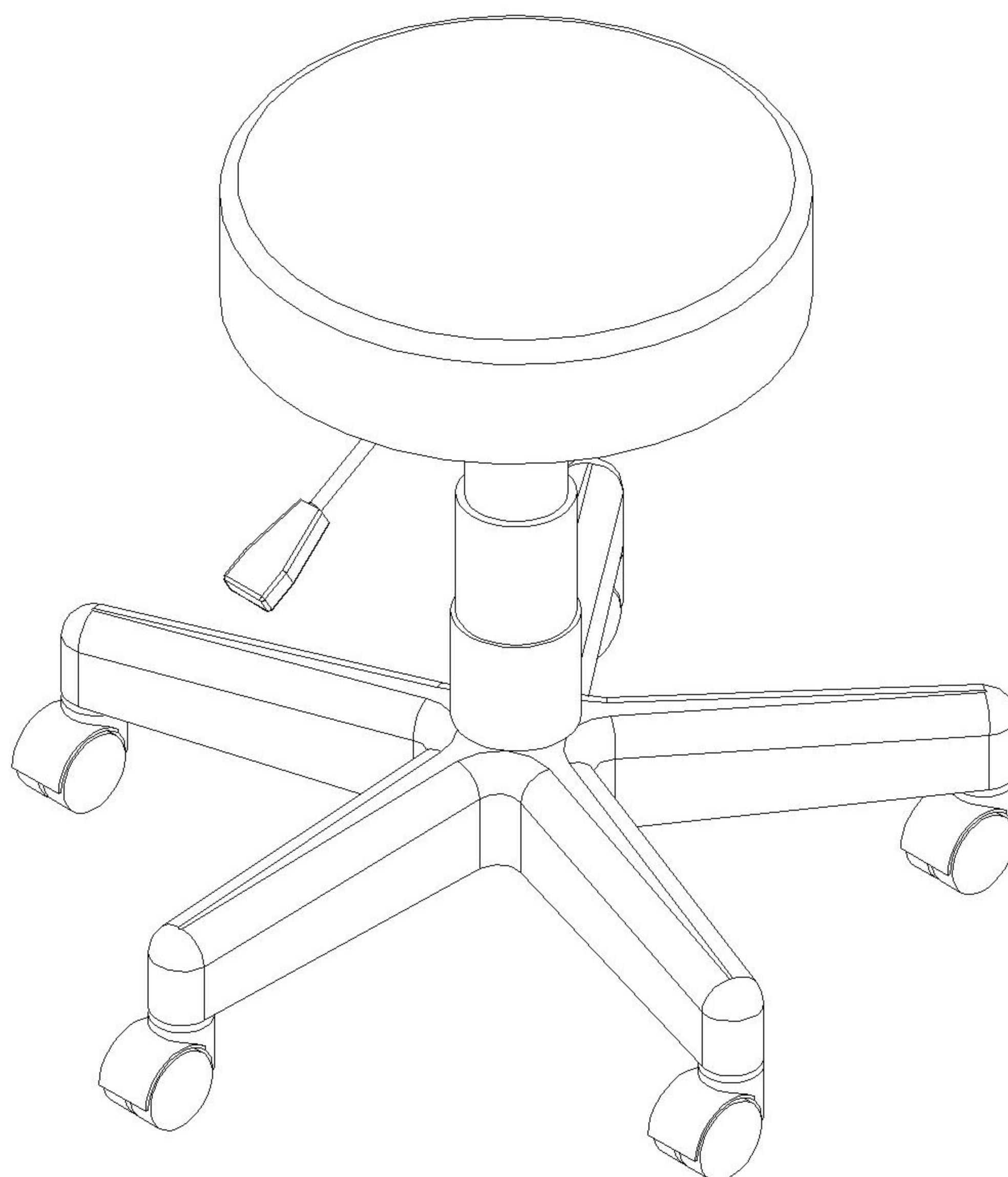

1-800-477-6655  
buyritebeauty.com

**ROUND STOOL  
SY-7080  
INSTRUCTION MANUAL**



# List of Parts & Tools

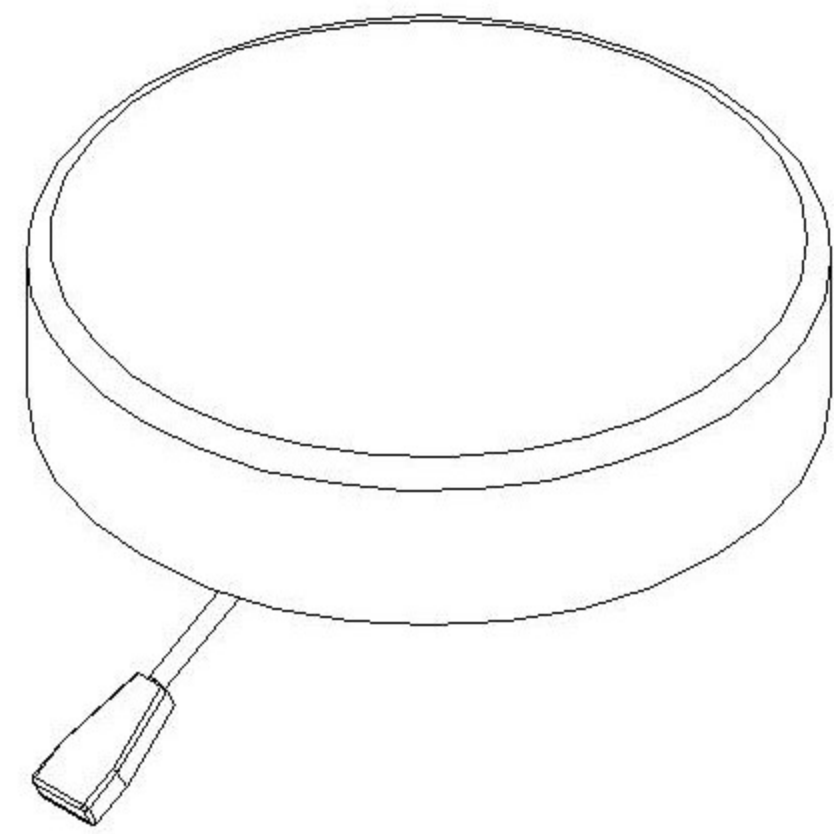

**X1**

Cushion



Gas Lift

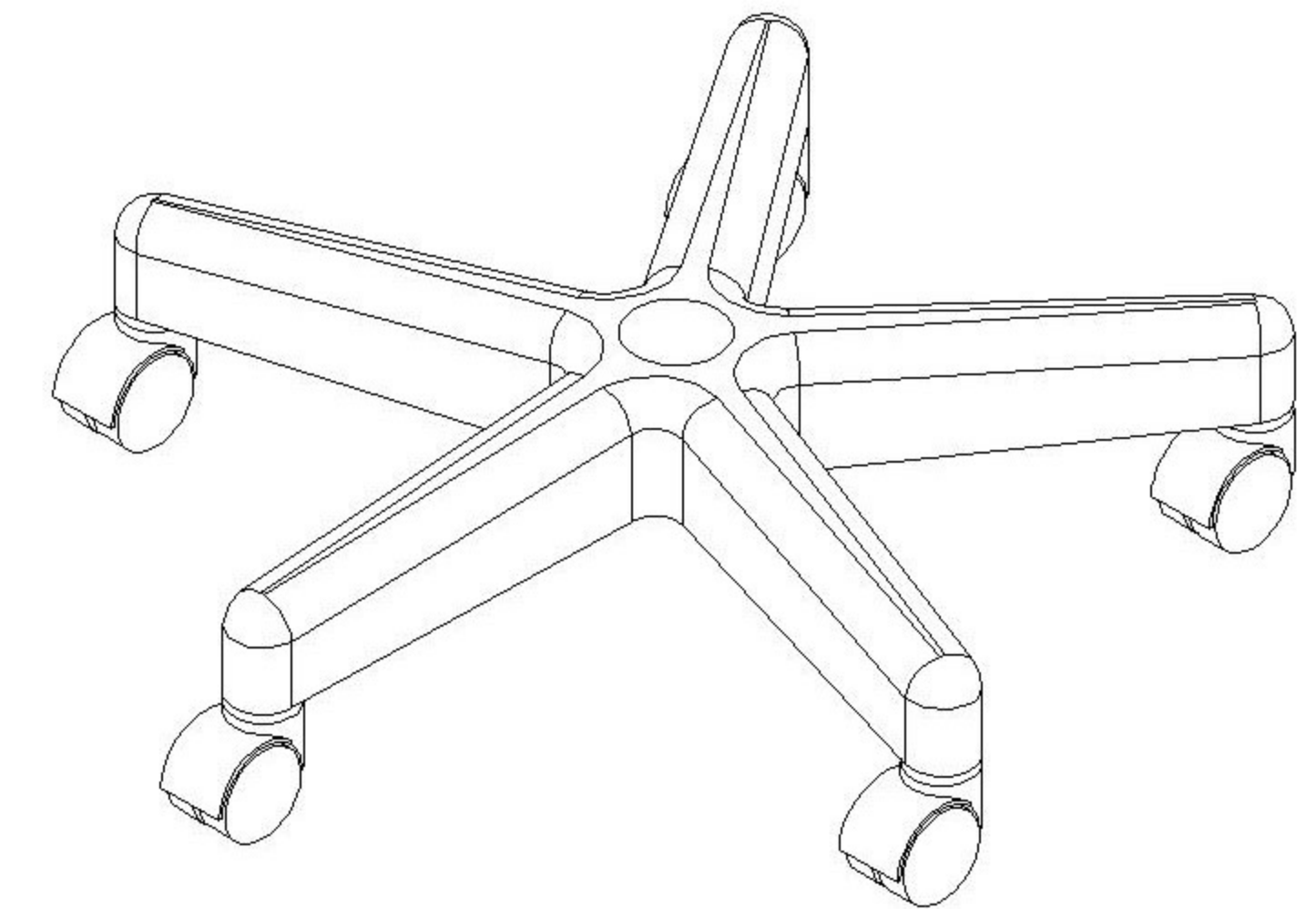

**X1**

Base

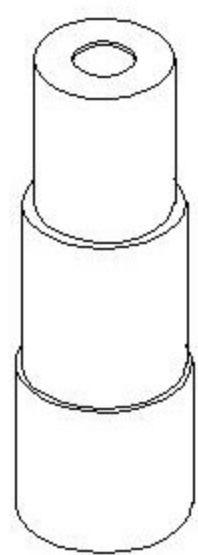

**X1**

Cover



## Step 1

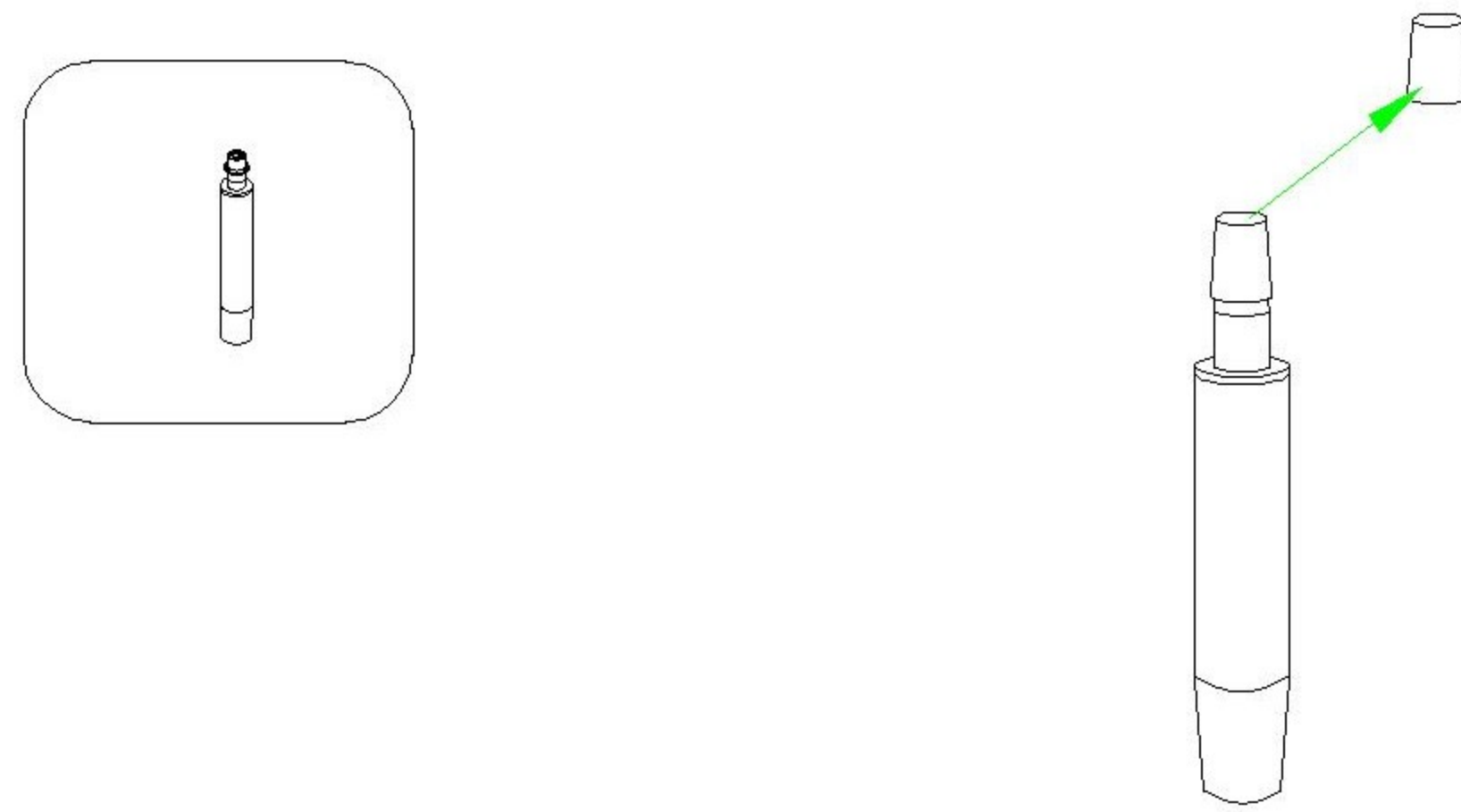

1. Remove the protective black plastic cap from the gas lift and discard after removal.

## Step 2

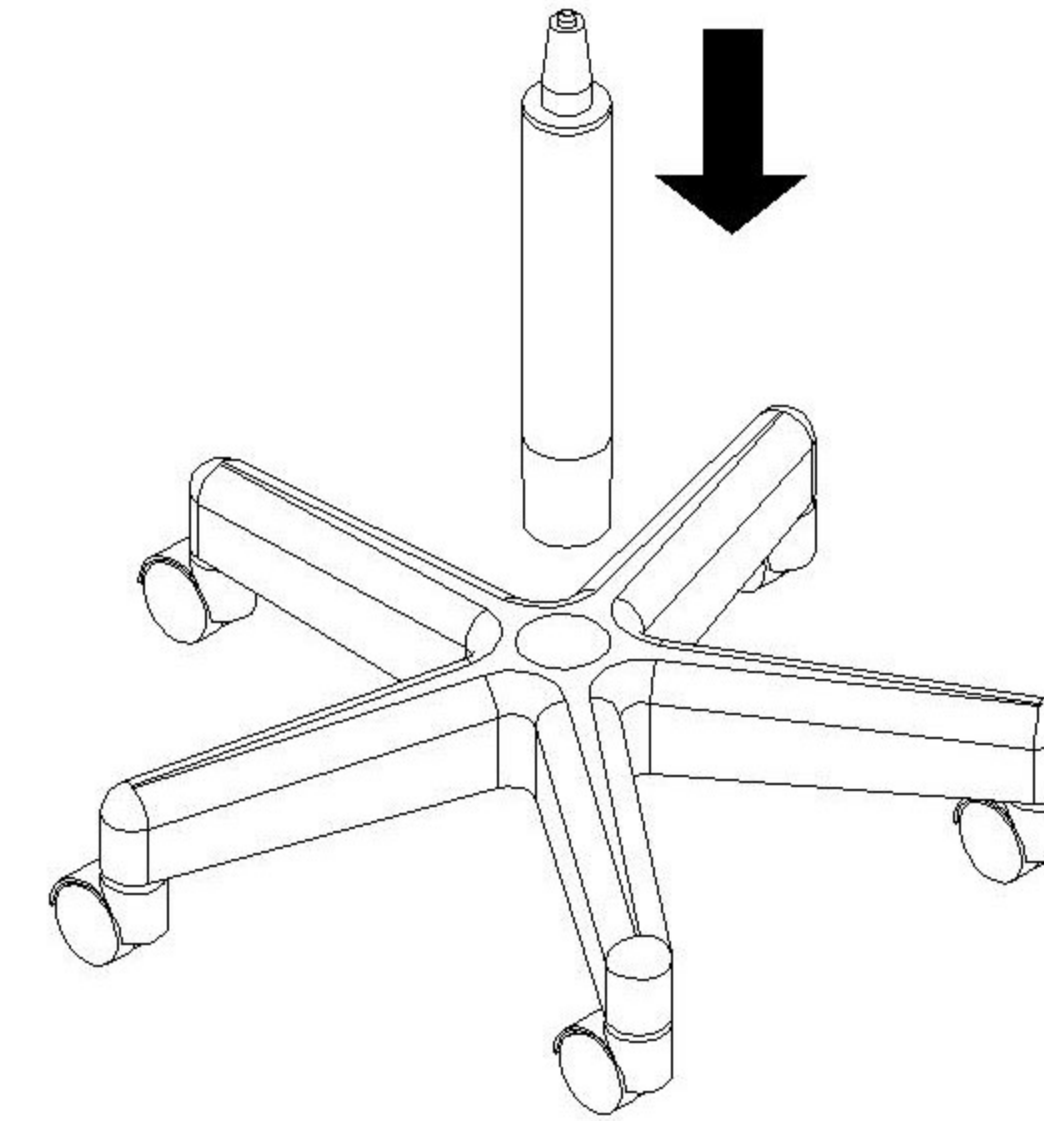

1. Insert the gas lift into the stool base, ensuring the larger end is pointing downward.

## Step 3

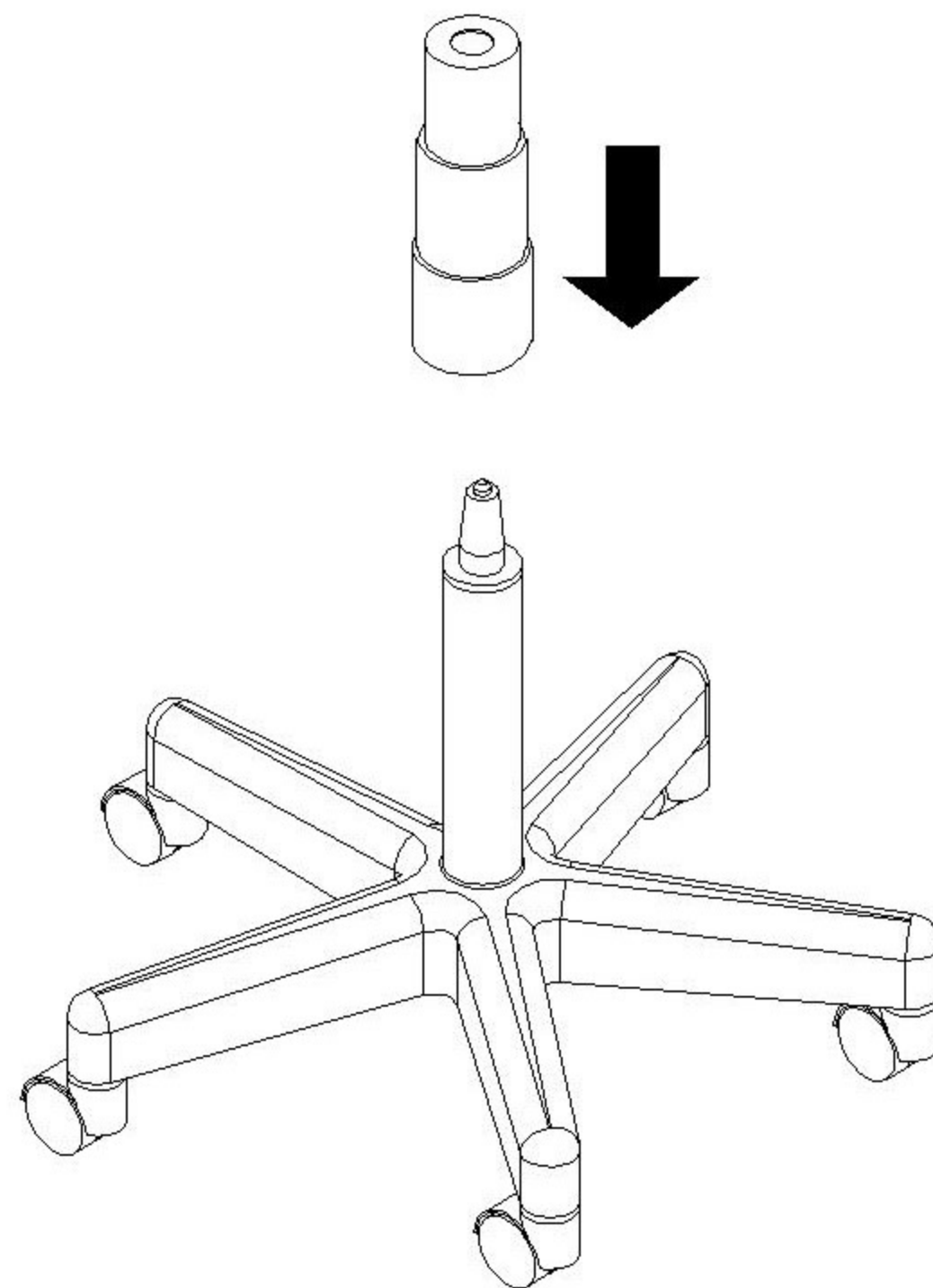

1. Carefully slide the protective cover over the gas lift from the top until it is fully secure.

## Step 4

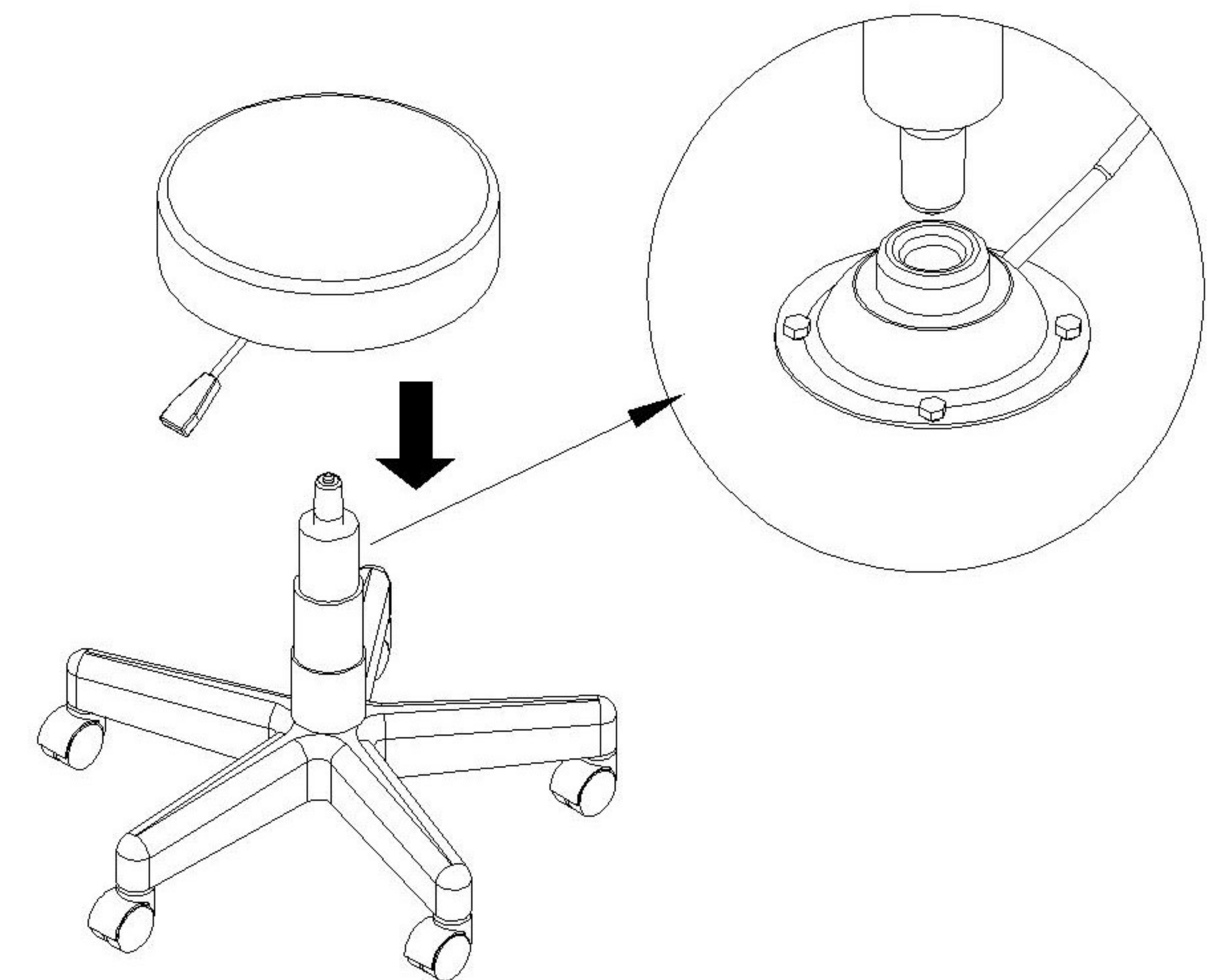

1. Align the top of the gas lift with the center hole on the underside of the seat cushion, then press down to attach the cushion.

## Product care

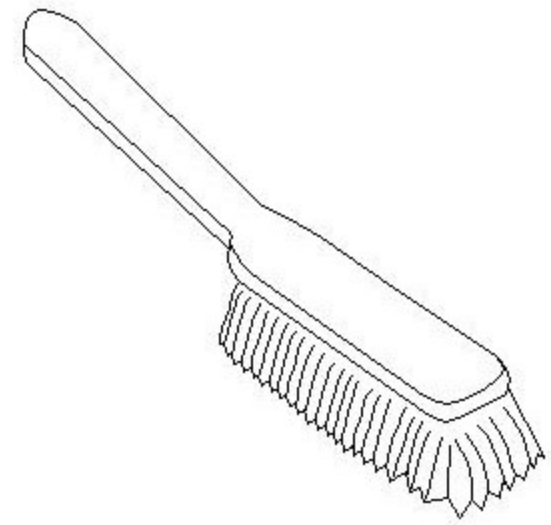

**Brush away excess hair**

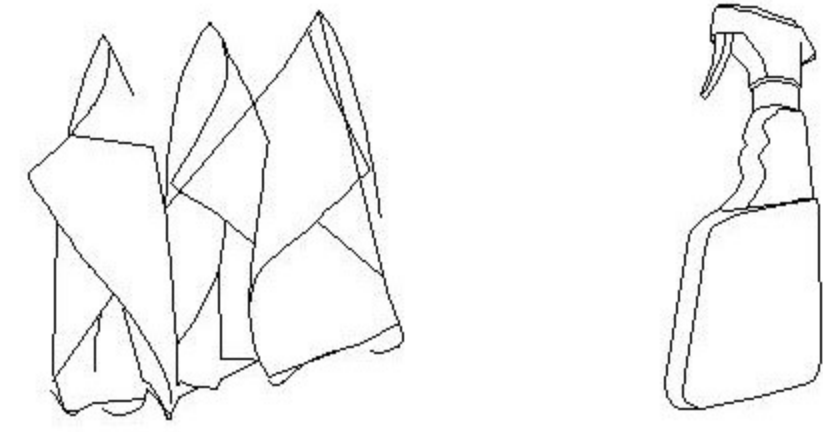

**Clean surface with damp cloth or use simple soap & water solution.**

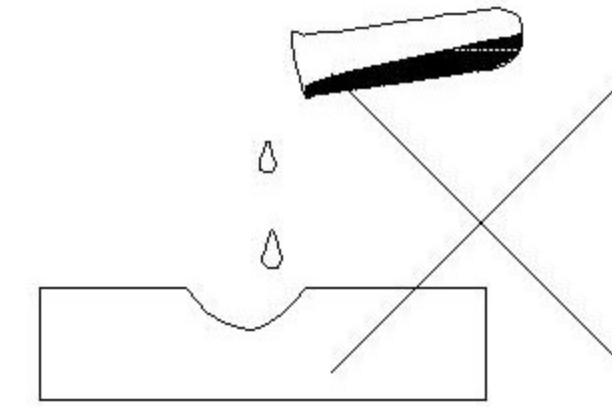

**Avoid using corrosive cleaning agents such as bleaches.**

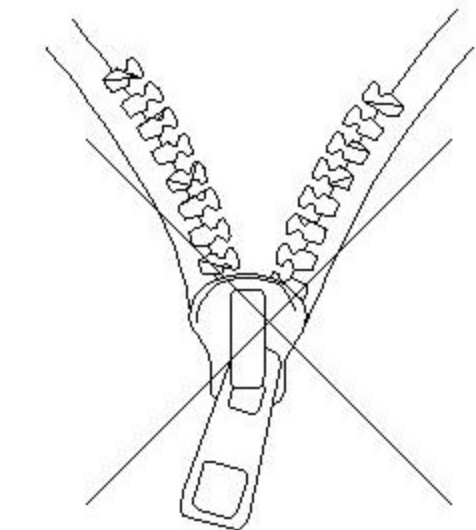

**Do not remove upholstery for cleaning**

## Product Information

1. Enjoy your new chair!
2. After assembly and before use, we suggest extending the gas cylinder to full height and back down several times to prime the cylinder.
3. If you have any questions or concerns. Please contact our customer experience team at 912-335-4445