

KAIWEETS

DC Power Supply

PS-3010F

User Manual

CE  **RoHS**
Made in China



Table of Contents

Introduction.....- 3 -

Intended use.....- 3 -

Controls and Indicators.....- 4 -

Operation.....- 6 -

 Constant Voltage Mode (C.V. Mode).....- 6 -

 Constant Current Mode (C.C. Mode).....- 9 -

Technical parameters.....- 12 -

Maintenance.....- 13 -

 Repair.....- 13 -

 Replacing the Fuse.....- 13 -

 Cleaning.....- 13 -

Three Years Warranty.....- 14 -

Introduction

Dear customer,

Thank you for purchasing this product.

This product complies with the statutory national and European requirements. To maintain this status and to ensure safe operation, you as the user must observe these operating instructions!



These operating instructions contain important notes on commissioning and handling. Retain these operating instructions for reference!

Intended use

This power supply is DC regulated power supply. It can output and display constant voltage and constant current, combined with a 5V voltage output with USB interface, equipped with cooling fan, over temperature protection, overload protection.

Controls and Indicators

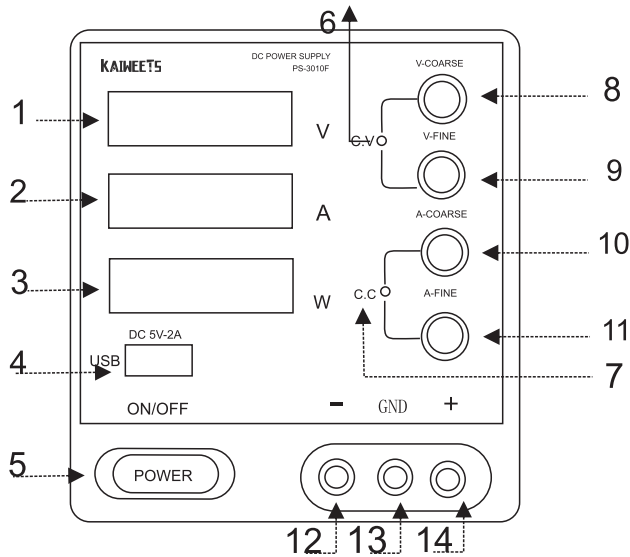

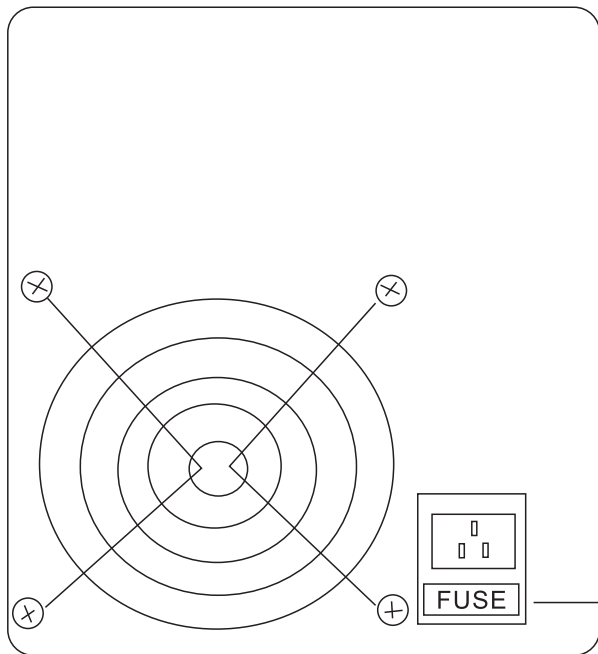

13. Ground output terminal

14. Positive output terminal

15. Concealed fuse box



→ Open the back cover to get to the fuse.

Operation



Please strictly follow the instruction to avoid machine malfunction or possible injury caused by electricity.

Constant Voltage Mode (C.V. Mode)

- (1) Connect the three-wire power cord with a US AC outlet.
- (2)  Turn all 4 knobs (Coarse Voltage Regulator, Fine Voltage Regulator, Coarse Current Regulator, Fine Current Regulator) anti-clockwise **to minimum position** before using.
- (3) Press the power switch. The power indicator (red LED) on the front panel will automatically light.
- (4) Turn the Coarse Current Regulator clockwise **to maximum position** until the C.V. indicator lights up.
- (5) Turn the Coarse Voltage Regulator and Fine Voltage Regulator clockwise to that you are desirous of output voltage value.
- (6)  Always press the power switch and shut it off **before** connecting the positive output terminal and negative output terminal with a load or similar component. Then switch it on.
- (7) The output voltage will be displayed. Current can't be changed in C.V. Mode.

NOTE: The working mode is decided by the load current and the traction current.

In Constant Voltage Mode, the current is determined by the load. Large Load, small current.

In Constant Current Mode, the voltage is determined by the load. Small load, small voltage.

If you assume there is big difference between the output voltage and the set value, use a multimeter to check it.

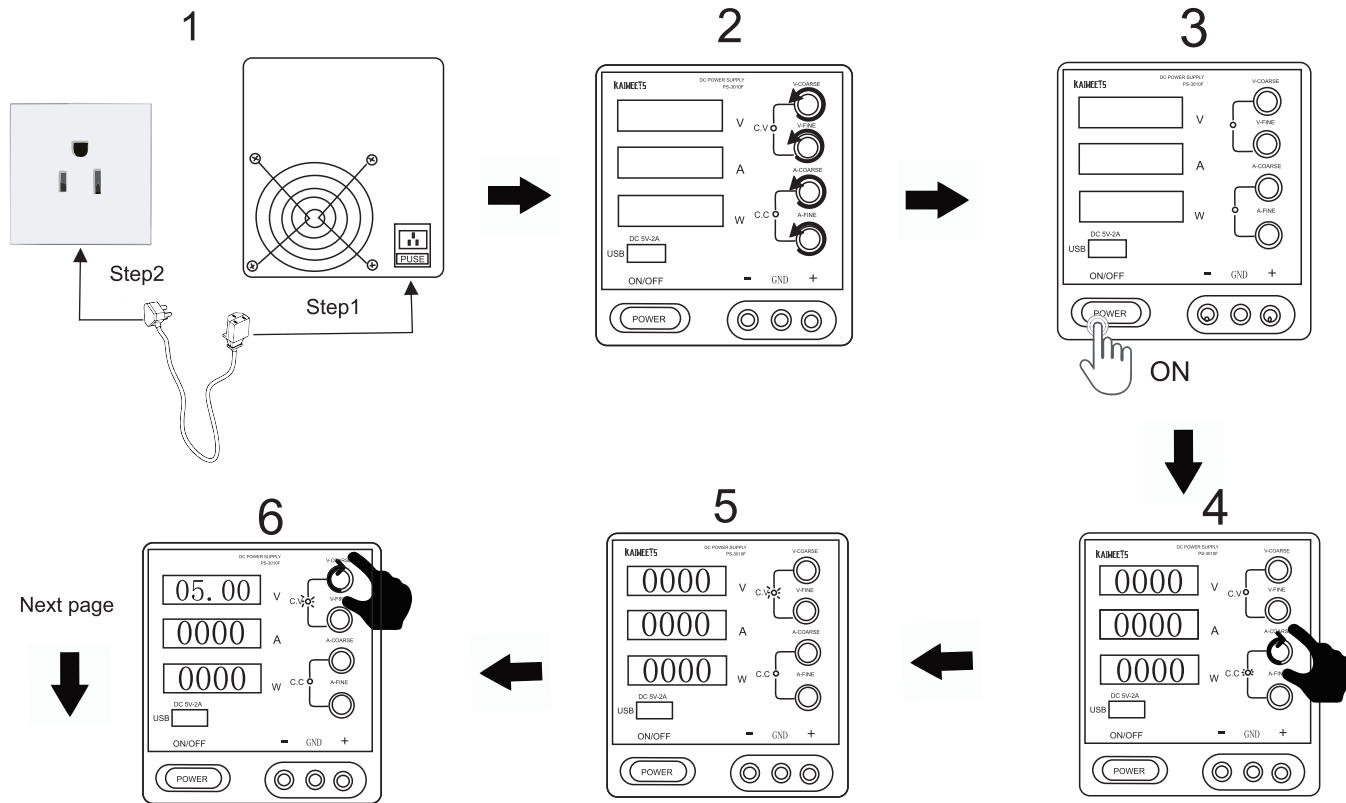

7

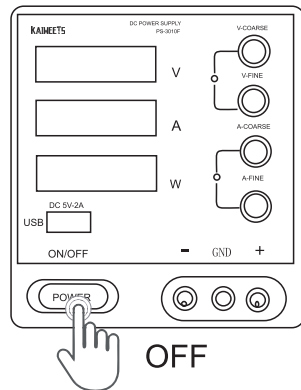

8

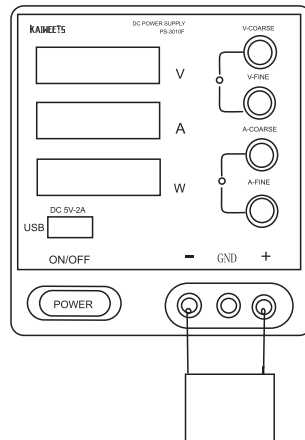

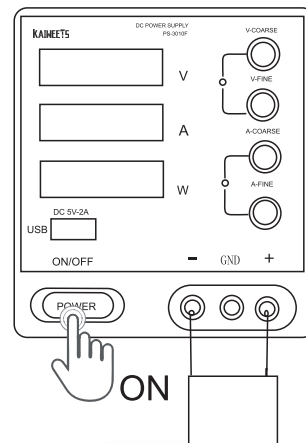

9

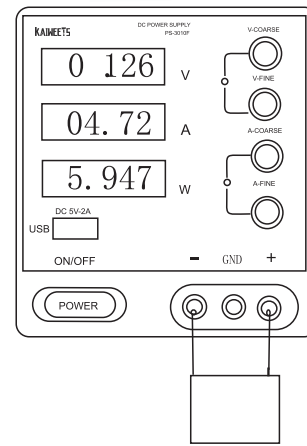

10



Constant Current Mode (C.C. Mode)

- (1) Connect the three-wire power cord with a US AC outlet.
- (2)  Turn the Coarse Voltage Regulator clockwise to maximum position and the Coarse Current Regulator and Fine Current Regulator anti-clockwise to minimum position.
- (3)  Connect the positive output terminal and the negative output terminal with a wire (one included) and bring it to a short circuit.
- (4)  Press the power switch to turn it on. The C.C. indicator lights up, which means it's on C.C. Mode.
- (5) Turn the Coarse Current Regulator and Fine Current Regulator clockwise to that you are desirous of output current value.
- (6) The output current will be displayed. Voltage can't be changed in C.C. Mode.

NOTE: The working mode is decided by the load current and the traction current.

In Constant Voltage Mode, the current is determined by the load. The larger the load, the smaller the current.

In Constant Current Mode, the voltage is determined by the load. The smaller the load, the smaller the voltage.

If you assume there is big difference between the output voltage and the set value, use a multimeter to check it.

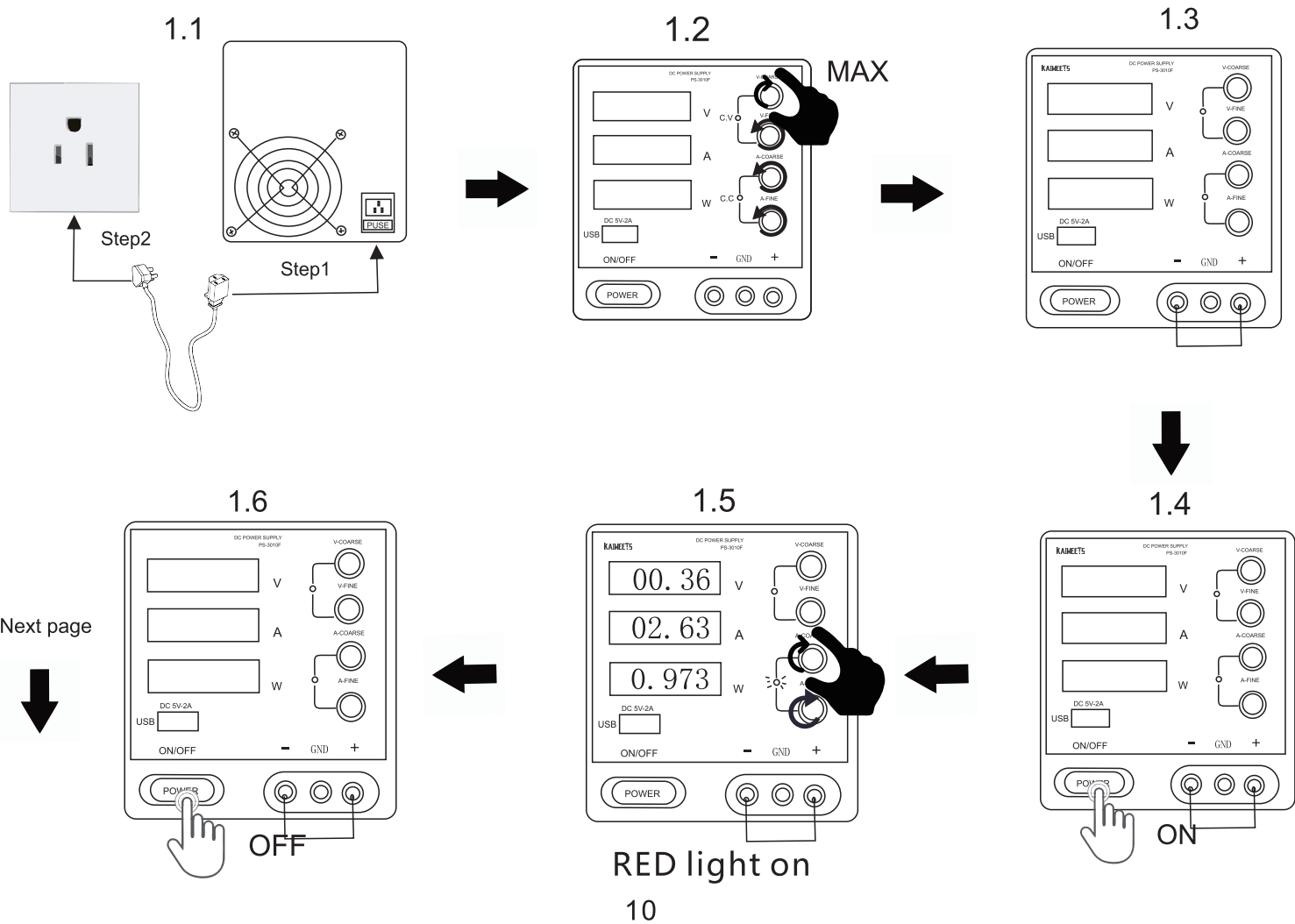

1.7

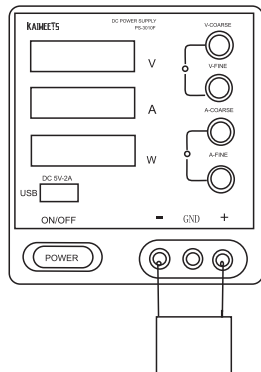

1.8

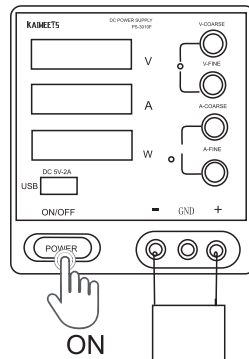

Technical parameters

Rated working conditions	110V±10%@60Hz
Output Current Range.....	0-10A
Output Voltage Range.....	0-30V
USB interface	5V, 2A
Power supply effect	CV≤0.1%+10mV, CC≤0.1%+10mA
Load effect	CV≤0.1%+5mV, CC≤0.1%+10mV
Ripple and noise	CV≤20mV r.m.s., CC≤20mA r.m.s.
Display mode	digit LED digital display, 4 digits
Display accuracy	± 0.1% ± 1
Working conditions	-10 °C ~ 40 °C, Relative humidity: <80%
Storage conditions	-20 °C ~ 80 °C, Relative humidity: <70%
Dimensions	285x128x145mm

Maintenance

Repair



Do not attempt to repair or service your instrument unless you are qualified to do so and have the relevant calibration, performance test and service information.

Replacing the Fuse

Turn off the power switch, remove the power line cord from the power socket and disconnect the test leads at output terminals before replacing the fuse. Replace it only with same type of fuse.

Cleaning

To clean the DC Power Supply, use a soft cloth dampened in a solution of mild detergent and water. Do not spray cleaner directly onto the device, since it may leak into the cabinet and cause damage. Do not use chemicals containing benzene, toluene, xylene, acetone, or similar solvents. Do not use abrasive cleaners on any portion of the power supply.

Three Years Warranty

KAIWEETS will repair, without charge, any defects due to faulty materials or workmanship for three years from the date of purchase provided that:

- Proof of purchase is produced.
- Service/repairs have not been attempted by unauthorized persons;
- The product has been subject to fair wear and tear;
- The product has not been misused;

Defective products will be repaired or replaced, free of charge or at our discretion, if sent together with proof of purchase to our customer service or authorized distributor(s). For the fastest way of product solution, further detail of warranty coverage and warranty repair information, send email to support@Kaiweets.com.

Connect with us

Email: support@Kaiweets.com

Facebook: [@kaiweetstools](#)