

Luxury Bath Lift

USER MANUAL



CONTENTS

Preface _____	3	The manual control _____	16
Service life _____	3	Operation during bathing _____	17
Identification Plate _____	4	Taking the lift out of _____	19
Reuse _____	4	the bathtub	
Warranty _____	4	Maintenance and care _____	20
Parts of the product _____	5	Cleaning _____	21
Product description _____	6	Care of the covers _____	21
Indication _____	6	Assembly of new cushion _____	22
Bath lifts _____	7	plugs for the cover	
For your safety _____	7	Maintenance of the _____	22
Important safety rules _____	9	power supply unit	
Electromagnetic _____	10	Charging the battery _____	22
compatibility (EMC)		Transport / Mobile use _____	24
Installation and use _____	10	Technical data _____	25
Initial installation in the bathtub ____	11	Environmental conditions for _____	25
Secure bath lift to the _____	12	operation	
bottom of the tub		Environmental conditions for _____	26
Putting on/taking off covers _____	15	transport and storage	
		Disposal _____	26
		Side Flap Protectors _____	27

PREFACE

Thank you for choosing a product from CareCo.

You will not be disappointed by the design, functionality and quality of this product.

Please read these operating instructions carefully prior to initial use. They contain important safety information and valuable tips for the proper use and care. If you have questions or need additional information, contact your CareCo specialist dealer who supplied your product.

These operating instructions contain all of the important information for adjustment and operation. The most current operating instructions are available as a PDF online or can be requested from customer service.

Enlarged formats for visually impaired persons can be displayed. Blind patients must be instructed by their attendant. Repairs as well as some adjustments require special technical training and must therefore be made by the medical supplies dealer.

SERVICE LIFE

Our company assumes a service life of five years for this product as long as the product is used as intended and all maintenance and service requirements are observed.

This service life may be significantly exceeded if the product is carefully handled, repaired, maintained and used and there are no technical limits based on the further development of science and technology.

The service life may also be significantly shortened through extreme and improper use, however. Determination of the service life by our company does not represent any additional guarantee.

IDENTIFICATION PLATE

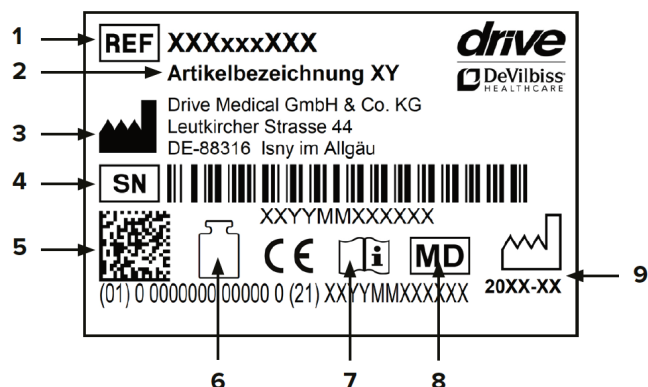

- | | |
|--------------------|-------------------------------------|
| 1 - Article number | 6 - Max. load |
| 2 - Article name | 7 - Follow the instructions for use |
| 3 - Manufacturer | 8 - Medical device |
| 4 - Serial number | 9 - Production date (year-month) |
| 5 - UDI code | |

REUSE

This product can be reused. Please note that all technical documents needed for safe handling must also be given to the new user.

The product must be checked by the specialist dealer, cleaned, and restored to optimum condition.

Always follow the manufacturer's instructions during preparation; these are made available on request.

Accessories are available from your specialist dealer.

WARRANTY

Your CareCo branded product is warranted to be free of defects in materials and workmanship for one year from the date of purchase.

This warranty does not cover device failure due to owner misuse or negligence, or normal wear and tear. The warranty does not extend to non-durable components, such as rubber accessories, casters, and grips, which are subject to normal wear and need periodic replacement.

If you have a question about your CareCo device or this warranty, please contact your dealer.

PARTS OF THE PRODUCT

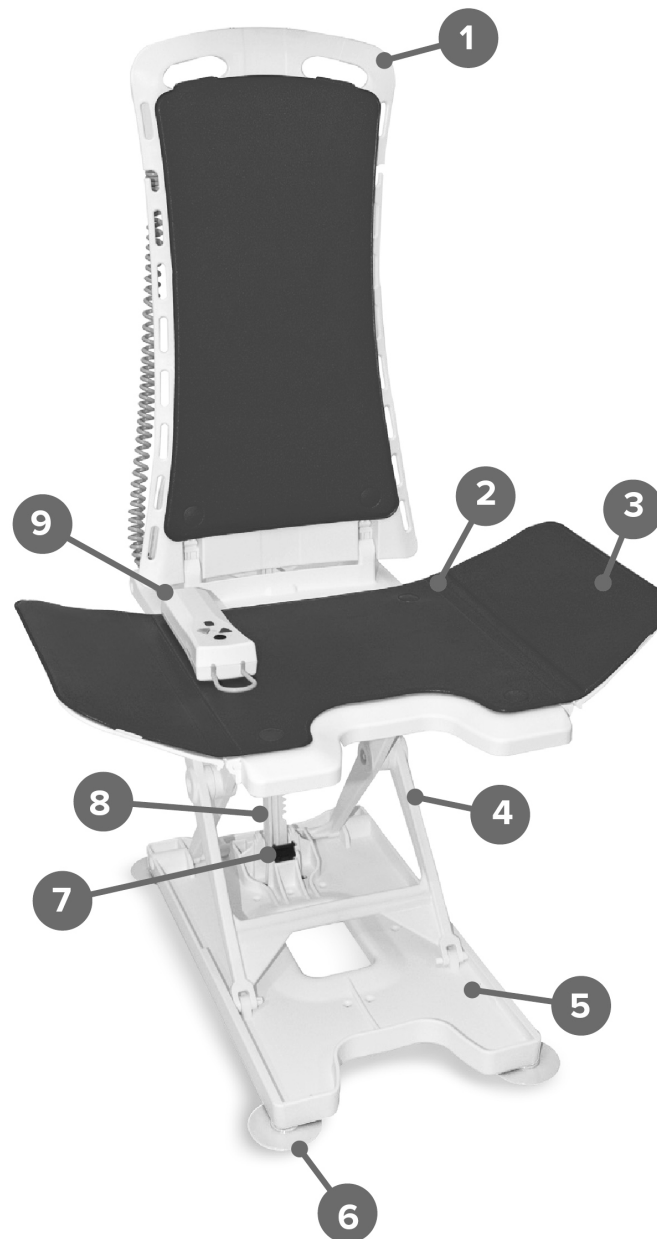

1 - Backrest

2 - Seat surface

3 - Side flaps

4 - Scissor lift mechanism

5 - Base plate

6 - Suction feet

7 - Locking lever

8 - Toothed rack

9 - Manual control

PRODUCT DESCRIPTION

Thank you for choosing a product from CareCo. This sturdy and high-quality product will make it easier for you from now on to get into and out of the bathtub for bathing.

The Luxury bath lift meets the valid standards DIN EN ISO 10535 : 2006 and DIN EN 60601-1:1996.

The Luxury bath lift mainly consists of high-quality, recyclable plastic in a lightweight design. As a result, it can be easily transported and stowed and is suitable for use at home as well as in a nursing home or while traveling.

The manual control contains a lithium ion battery.

The floating manual control allows convenient raising and lowering in the normal seated position. It is also possible to move the lift into intermediate positions. The drive motor and control electronics have watertight housing. The lift can thus also be used when showering in the bathtub.

The sturdy adjustable-height frame allows raising and lowering from 6.5 to 48 cm in height. When the up/down buttons are pressed, the lifting rod raises/lowers the seat surface.

The removable power unit which can be folded forward and which has an integrated backrest clicks into place in the seat surface and automatically locks upon being raised. This prevents the backrest from being inadvertently folded.

As a result of the integrated energy control, the lift lowers only if enough energy is available to fully raise it.

At an average frequency of use (once daily), it is recommended to replace the product after 5 years (depending on the overall condition of the product).

INDICATION

Bath aids are products which enable the user to independently perform daily body care. They compensate in whole or in part for limited or absent body functions. The objective of using corresponding aids is to enable ill or handicapped persons to be as independent of outside help as possible in the area of hygiene.

BATH LIFTS

Bath lifts are used for lowering from the height of the edge of the tub towards the bottom of the tub and vice-versa. It is appropriate for users who have significant functional limitations of the upper and/or lower extremity which make it impossible to independently get into and out of the bathtub or to sit down/sit up and for whom use of the lift once again enables primarily independent bathing.



FOR YOUR SAFETY

Information which must be observed!

Safe bathing with the bath lift is only possible if the instructions for use are read carefully and the information they contain is closely followed!

Important information

- The bath lift should not be used as a ladder, a device to facilitate entry and exit outside of the bathtub, an aid for ascending or descending, a support, a lifting platform, or the like. It should be used only for bathing persons inside the bathtub.
- Children and animals must be kept away from the bath lift.
- In the event of malfunction or damage, please contact your dealer promptly. Do not make any unauthorized modifications or conversions. Repairs must be performed only by authorized workshops or by the manufacturer. Failure to observe this invalidates any warranty claim.
- Extend the lifting rod only when the backrest is lowered!
- Operation on height adapters is not permitted for the Luxury bath lift.
- Do not store the product in the direct vicinity of heat sources.

Please store these instructions for use carefully!

- If the bath lift is transported, the manual control must be unplugged beforehand.
- If the lift was exposed for a long period to low temperatures (such as long storage in the winter in a vehicle), it must be able to be brought back to room temperature before use to avoid damage.
- When using bath oils or bath salts, observe the recommended dosage. The additives can impair the sliding behaviour of the scissor lift mechanism.
- Do not use any cleaners containing vinegar to clean the bath lift.

Information on the battery, power supply unit and manual control:

- Use the manual control only to operate the bath lift.
- The bath lift may be operated only with an original CareCo manual control.
- Never throw the manual control into a fire and do not store the manual control near fire or intense heat sources.
- Do not open the manual control. Opening the manual control invalidates any warranty.
- Use only the power supply unit provided to charge the battery in the manual control.
- If the housing of the manual control is damaged, it should no longer be used.
- For your safety, the power supply unit should be used only outside of the bathroom in dry areas. The power supply unit should only be used for charging the manual control provided.
- The battery must be charged prior to the initial use and after every time the bath lift is used. If there are longer periods during which the bath lift is not used, the battery should be recharged every 3 months to extend its service life.
- Do not insert any conductive objects (such as a knitting needle, metal pin, etc.) in the jack socket of the manual control.

-
- Always take the plug out of the outlet before cleaning the power supply unit.
 - Clean the power supply unit only with a dry cloth.
 - The bath lift, power supply unit and battery feature sturdy construction, however they should not be dropped. If there is any externally visible and/or audible damage, the bath lift should not be used. In this case, contact your dealer. We recommend entering the address at the end of these instructions for use!
 - For more information, technical details and addresses, please read the entire instructions for use.
 - In the event of a malfunction, first consult the section entitled “Troubleshooting” in the annex to these instructions for use. Make sure to follow the information and instructions there. For your own safety, you should not use the bath lift until the malfunction has been corrected.

IMPORTANT SAFETY RULES

- Always sit in the middle of the lift, with your back against the backrest, slightly extend your legs and place your free hand either on the edge of the tub or in your lap. Use your other hand to control the lift downwards or upwards.
- During raising or lowering, do not grasp between the edge of the tub and the lift or underneath the seat surface since doing so can lead to injuries.
- Persons with serious physical handicaps or mental confusion should never be left in the bathtub unsupervised. Bathe independently only if your state of health permits this. Otherwise bathe only under supervision.
- Before using the bath lift, perform a test run (move it up and down with hold and check the EMERGENCY STOP function).
- In the event of a breakdown, do not continue using the bath lift; instead have it repaired by the dealer.
- Do not bring any objects (such as brushes, etc.) along into the bathtub!

ELECTROMAGNETIC COMPATIBILITY (EMC)



NOTE This product meets the protection requirements listed in the council directive on the approximation of the laws of the member states on electromagnetic compatibility (EMC, IEC 60601-1-2) (89/336/EEC).

However, mutual interference between electrical devices, particularly when mobile telephones are used, cannot be completely ruled out under certain conditions. Do not operate near the bath lift any life-preserving, life-supporting devices or devices which could pose a risk to users in the event of a malfunction.

These could malfunction under certain conditions or impair the proper operation of the bath lift. If you notice malfunctions or unusual behaviour of the bath lift or of electrical devices operated in the vicinity, take the bath lift out of service and contact the dealer.

INSTALLATION AND USE

Unpacking

The following parts must be present in the box upon delivery:

- • Drive unit with integrated backrest and manual control
- • Seat unit with side flaps
- • Power supply unit
- • Instructions for use
- • 4 x suction cups, diameter 75 mm, for mounting on the base plate

If one of the parts listed is missing or damaged, please contact your dealer.
The box can be reused for transport and to store the bath lift.

The battery must be charged prior to initial use. To do this, the instructions in the section "Charging the battery" must be followed.

INITIAL INSTALLATION IN THE BATHTUB

- First insert the rear suction cups with the movable plugs in the underside of the base plate (photo 1).

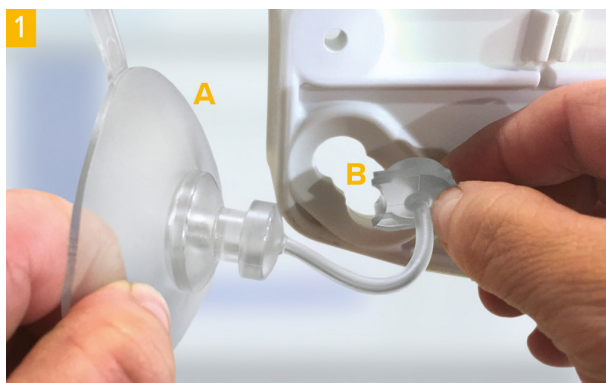

A) Mushroom head | B) Plug

- Push the mushroom head of the suction cup through the small opening by gently rotating it into its final position. Ensure that the vent tabs face backwards (photo 2)



C) Vent tab

- Push the plug from the upper side into the plate opening until it is flush (photo 3).



-
- Insert the front suction cup in the same way, however in this case, additionally push the vent tabs into the recesses of the base plate. As a result, the front suction cups are automatically vented during removal (photo 4).



SECURE BATH LIFT TO THE BOTTOM OF THE TUB

Information which must be observed:

The suction cups secure the bath lift to the bottom of the tub. The suction cups on the underside of the bath lift must therefore be clean and dry when the bath lift is used in the bathtub which is also clean and dry. We recommend regularly cleaning the suction cups and the bathtub with commercially available cleansers to ensure the best possible grip.

- Ensure that the bottom of the empty bathtub is clean and that there are no non-slip mats in the tub.
- Place the seat unit with the suction cups mounted on the base plate in the empty bathtub such that the rear suction cups are at the start of the slope at the rear wall of the bathtub.
- Then insert the drive unit with integrated backrest, as shown in photo 5 - 6, with its locking catches into the bearing blocks of the seat unit.



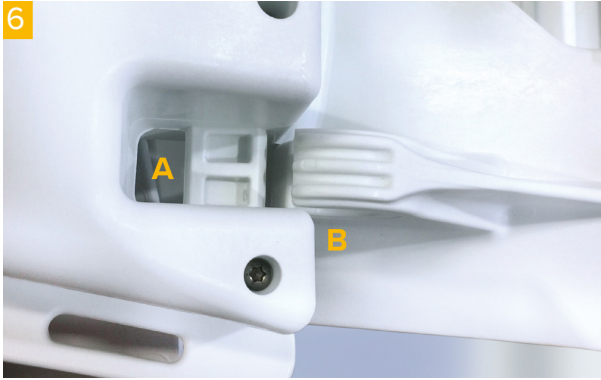

A) Bearing block | B) Locking catch

Important! It must be ensured that both locking catches were inserted into the bearing blocks.

- Now use your other hand to pivot the backrest upwards at the hand grips (photo 7-8) and move it as far back until the drive unit rests on the stop on the base plate.



C) Hand grip

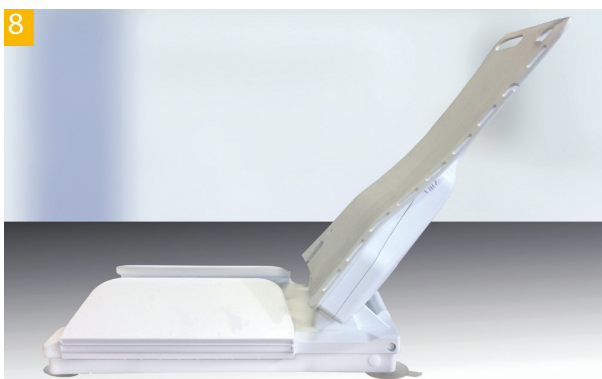



NOTE If the wall of the bathtub is vertical on the side of the backrest and thus the backrest could hit the wall of the tub, the lift must be set up outside of the tub and brought into the highest position before it is placed in the tub. When used during a bath, it may no longer be possible to tilt the backrest under certain circumstances since there is not enough space between the backrest and the wall of the tub.

- Ensure that the lifting rod is positioned properly in the ramp.

Ensure that the red locking lever is in the correct position (photo 9-10).



Correct

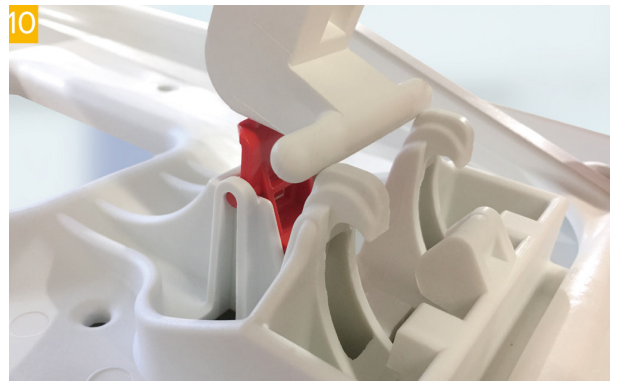

Incorrect

- Insert the manual control on the bath lift. To do this, place the jack socket on the spiral cable of the manual control on the jack until it noticeably clicks into place and the red ring on the jack is no longer visible. The bath lift is then ready for use (photo 11).

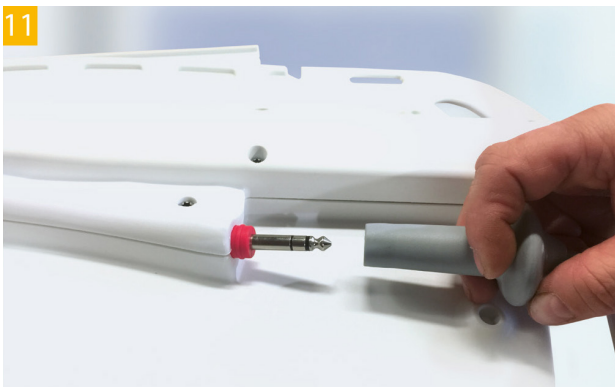

PUTTING ON/TAKING OFF COVERS

The covers can be easily put on and taken off.

To secure the cover, simply place the cover in the correct position on the backrest plate or on the seat surface and press the attachment buttons all the way into the respective holes of the backrest plate or seat surface and side flaps (photo 12 - 15).



Seat cover



Backrest cover



Seat cover



Backrest cover

The bath lift can also be used without a seat cover.

To remove the covers, pull the two attachment buttons out of the holes from below using two fingers.

THE MANUAL CONTROL

The capacity of the fully charged battery is sufficient for a maximum of 6 baths, depending on the weight of the user. During the bath, the indicator light on the manual control is lit and green.

When the charge status of the battery falls to a certain value, the colour of the light changes to yellow and slowly flashes. This now shows that approx. 1 more bath can be taken. Thereafter the battery should be charged according to the instructions. If the yellow phase of the battery is also used, the colour of the light may change from yellow to red and flash quickly. If this happens, the lift will only move upwards and thus ensure safe lifting. The battery must now be charged immediately according to the instructions using the power supply unit provided.

GREEN light: Lift ready to use.

YELLOW light: Lift partially operational with enough power for only 1 bath. Battery should be charged.

RED light: Lift no longer ready to use, can still only move upwards. Battery must be charged at once.

EMERGENCY STOP button (red): If you are ever in an emergency situation in which it is necessary to bring the bath lift to a stop, push the red EMERGENCY STOP button (photo 19).

To reactivate the bath lift, press the green power button once again. If no button is pushed, the manual control automatically switches off after 30 minutes. If you would like to switch off the bath lift yourself, press the red button on the manual control (indicator light goes out).

- Down button (blue)
- EMERGENCY STOP button (red)
- Indicator light (LED)
- Up button (yellow)
- Power button (green)



OPERATION DURING BATHING

- Before initial operation of the bath lift, ensure that the manual control is correctly connected to the bath lift via the plug connection. It is correctly connected when the red ring on the jack is no longer visible (photo 20).



- Press the power button (green) on the manual control. Now the indicator light is lit and green.
- Now press the up button (yellow). The backrest initially pivots into the upright position. Then the lift moves up to the end position and automatically switches off. If the button is released, the lift stops so that intermediate positions are also possible.
- Swing out the side flaps until they rest on the edge of the tub. Only raise the seat until the seat surface is at the same height as the edge of the tub and the side flaps form a horizontal surface.

Important: The side flaps must lie evenly on the edge of the tub.

- 5. Seat the person to be bathed on the bath lift.
-
- 6. To lower the bath lift, press the down button (blue). The lift first moves down to the end position. Then the backrest automatically pivots backwards. In the end position, the power unit switches off automatically. If the button is released, the lift stops so that intermediate positions are also possible.

Important! When the backrest touches the rear wall of the tub, release the blue button immediately.

- Seat the person to be bathed on the bath lift.
- To lower the bath lift, press the down button (blue). The lift first moves down to the end position. Then the backrest automatically pivots backwards. In the end position, the power unit switches off automatically. If the button is released, the lift stops so that intermediate positions are also possible.

Important! When the backrest touches the rear wall of the tub, release the blue button immediately.

- After the bath has ended, press the up button (yellow) on the manual control to bring the lift back to the correct height (max. upper end point). Ensure that the side flaps do not get caught on any existing tub grip handles.
- Assist the person in getting out via the side of the tub.

If the manual control is not used for 30 minutes, it automatically switches off. If you would like to switch the bath lift off yourself, press the red button on the manual control (indicator light goes out).



NOTE When raising and lowering the lift, lean against the backrest and rest your hands in your lap.

If the lift remains in the tub, the manual control with the integrated battery should now be unplugged and charged. This prevents the battery from accidentally draining.

TAKING THE LIFT OUT OF THE BATHTUB

First use the manual control to lower the bath lift all the way and allow the backrest to pivot all the way back until the power unit stops by itself in its end position (photo 21). In doing so, ensure that the backrest does not hit the wall of the tub. Then unplug the manual control.

- Fold the side flaps on the seat surface inwards.
- Fold the backrest forwards. To hold the lift, use the hand grips on the drive unit.



- You must ensure that the lifting rod is always fully retracted (photo 23).



Incorrect



Correct

- The drive unit can now be removed from the seat frame in the direction of the arrow.



NOTE The drive unit can be removed only at a particular angle. It can therefore no longer be removed from the seat unit when it is folded completely forward since it is then locked into place again. Bring the backrest into the angle as shown in photo 24 and then remove the drive unit from the seat frame in the direction of the arrow.

-
- Release both rear suction cups on the base plate by pulling the tabs. Then lift the base plate backwards which will cause the front suction cups to automatically vent and release. Now take the seat unit out of the bathtub.



MAINTENANCE AND CARE

Maintenance of the bath lift

The bath lift is equipped with maintenance-free bearings and bearing surfaces. Therefore no lubrication is required.

The entire bath lift should be periodically inspected (visual inspection by the user) at least every 6 months. This includes a visual inspection in particular of the load-bearing parts and the safety features, as well as all necessary function testing.

If this reveals defects, wear or other damage which jeopardize the safety of the lift, the bath lift must be taken out of service and the deficiencies must be corrected. Repairs must be performed by appropriate and suitably qualified persons who can properly perform repairs of this type based on their training, knowledge, and experience gained through practical work.

Have repairs performed only by the authorized dealer



ATTENTION The manual control may be opened only by the manufacturer of the bath lift!

CLEANING

The lift must be cleaned immediately after use (preferably by rinsing with hot water) in order to keep the bath lift in optimum condition. For cleaning, the bath lift must be thoroughly rinsed off after each bath. To clean the bath lift (without covers), use household cleaners without scouring agents, as well as commercially available disinfectants.

CARE OF THE COVERS

The material of the removable covers is hygienic due to the smooth surface and antibacterial properties.

Care of the covers requires regular cleaning either by hand or in the washing machine at 60°C. Use a non biological detergent without enzymes. Note that bath additives containing oil which you use during bathing can stain the cover. Failure to clean the covers regularly can also cause the covers to discolour.



NOTE Any discolouration of the covers is not covered by the warranty since these are expendable parts.

- The covers can be easily removed for cleaning.
- Do not dry the covers in the dryer; instead they should be hung to dry.
- In addition, it is recommended to use a commercially available disinfectant.
- Follow the manufacturer's instructions!

ASSEMBLY OF NEW CUSHION PLUGS FOR THE COVER

First guide the new plug from above through the hole in the cushion and then press on the underside of the disc for reinforcement (photo 25 - 26).

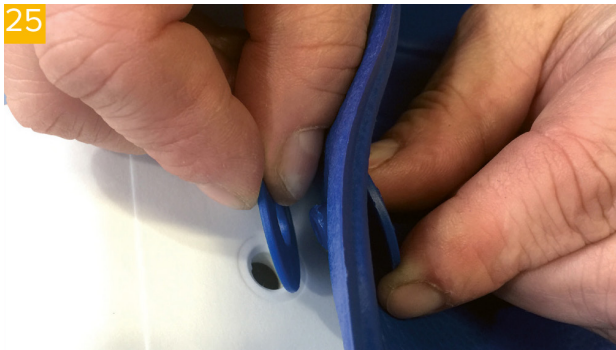

MAINTENANCE OF THE POWER SUPPLY UNIT

The power supply unit is maintenance-free. The housing should be cleaned only with solvent-free cleaners or a slightly dampened cloth. In doing so, ensure that no moisture penetrates the power supply unit. Before starting up again, it must be ensured that the power supply unit is completely dry. If necessary, the power supply unit must be placed in a dry, ventilated location for several hours without a power supply.



ATTENTION For cleaning, the power supply unit must be completely separated from the mains by unplugging it from the outlet.

CHARGING THE BATTERY

Charge the battery fully before each use. The voltage information on the power supply unit must be consistent with the voltage of your power supply.

-
- Insert the jack of the power supply unit into the jack socket on the spiral cable of the manual control until the jack clicks into place.
 - Plug the power supply unit into an outlet.
 - The red indicator light on the manual control is lit red until the battery is charged. Then it is lit and green. If the battery is to be fully charged, leave the battery connected to the power supply unit. The control system of the power supply unit ends the charging process after approx. 4 hours. This avoids overcharging the battery.
 - Unplug the power supply unit from the outlet.
 - Pull the jack of the power supply unit out of the jack socket on the manual control.

Important information: If the charging indicator does not light up after connecting the manual control, check the following points:

- Quality of the connections (jack fully inserted into the charging socket).
- Check manual control, spiral cable with jack socket, and charging cable for damage.



NOTE If the power supply unit is damaged, return it to the supplier for inspection.

TRANSPORT / MOBILE USE

In the case of mobile use, the following should additionally be borne in mind:

- The manual control on the bath lift must be unplugged and transported separately.
- During transport (for example, in a vehicle), always secure the bath lift against slipping.
- If the battery integrated in the manual control is exposed to low temperatures (such as in the winter during storage in a vehicle), allow the battery to warm up to room temperature and charge, if necessary.
- Be aware of product weights when lifting: the seat unit weighs approx. 5.5 kg and the drive unit (without manual control) weighs approx. 3.8 kg.



Transport as separate sections

The seat and drive unit can be easily carried by the two hand grips.



Transport in a locked condition

The bath lift can also be transported as a complete unit.

TECHNICAL DATA

Total length	830 mm
Total width	700 mm
Seat width	380 mm
Seat depth	420 mm
Total length of seat surface	570 mm
Seat height, min.	65 mm
Seat height, max.	480 mm
Backrest height	640 mm
Backrest width	320 - 360 mm
Backrest adjustment	10° - 50°
Base plate width	310 mm
Base plate length	560 mm
Max. load	140 kg
Total weight without manual control	9.3 kg
Total weight incl. manual control	9.7 kg

ENVIRONMENTAL CONDITIONS FOR OPERATION

Temperature	+10° - +50°
Relative air humidity	10 100%
Air pressure	700 hPa 1060 hPa

ENVIRONMENTAL CONDITIONS FOR TRANSPORT AND STORAGE

Temperature	-10°C+40°C
Relative air humidity	10 100%
Air pressure	700 hPa 1060 hPa

DISPOSAL

If you no longer need the product, please contact your specialist dealer or bring the product to your local disposal center.

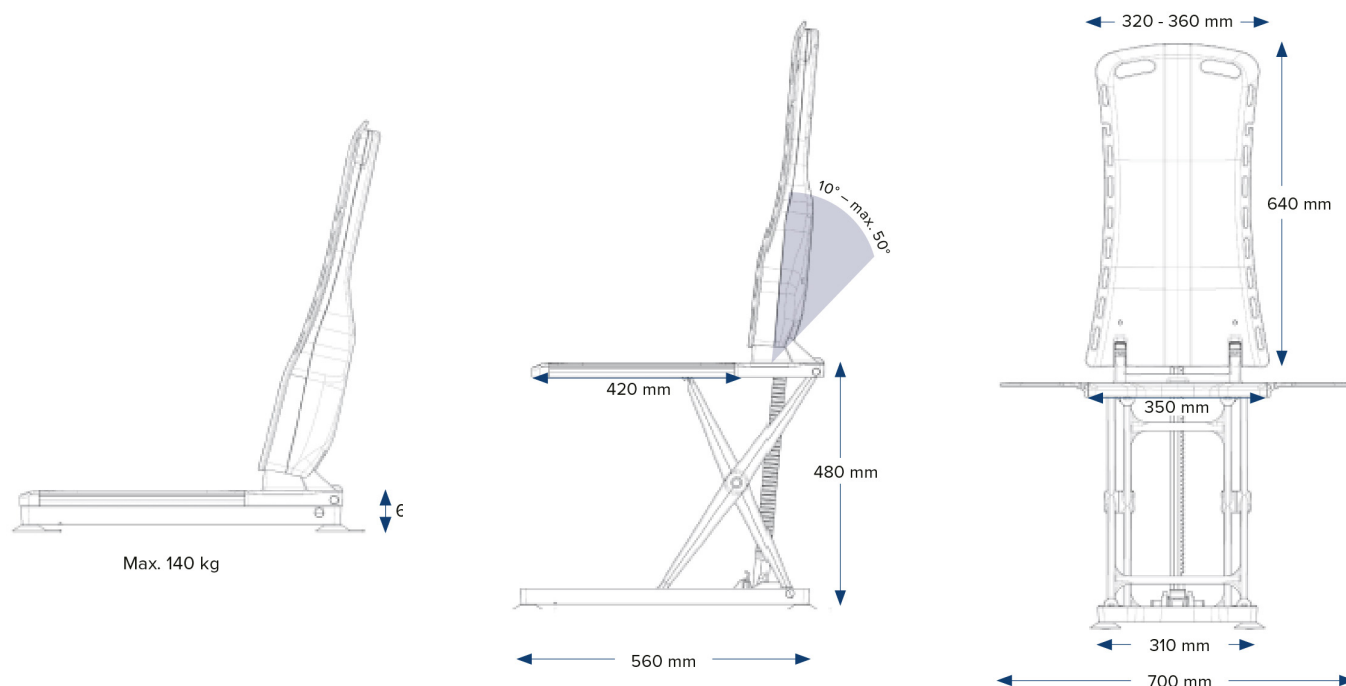

SIDE FLAP PROTECTORS

The Luxury Bath Lift side protectors can be used on baths that have grab handles on the inside of the bath that protrude and potentially get in the way of your bath lift.

To install the protectors, snap the hooked end over the grab handle of the bath and allow the long edge to hang down inside the bath.

When installed, the side flaps will stop the side panels of the bath lift from getting caught on the inside of the bath.

