

HOMPANY

Quick Start Guide

SmartVac 11

Cordless Vacuum
Cleaner

Hompany Support Team:
EN: support@hompany.top
EU: service@hompany.top

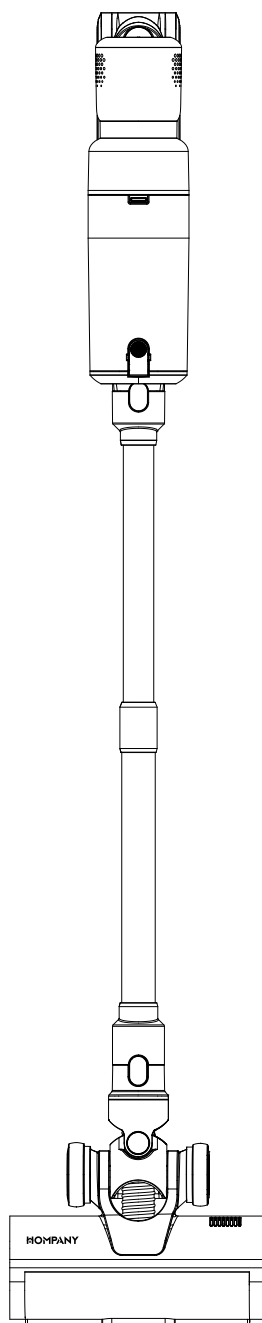

Installing Desired Cleaning Accessory

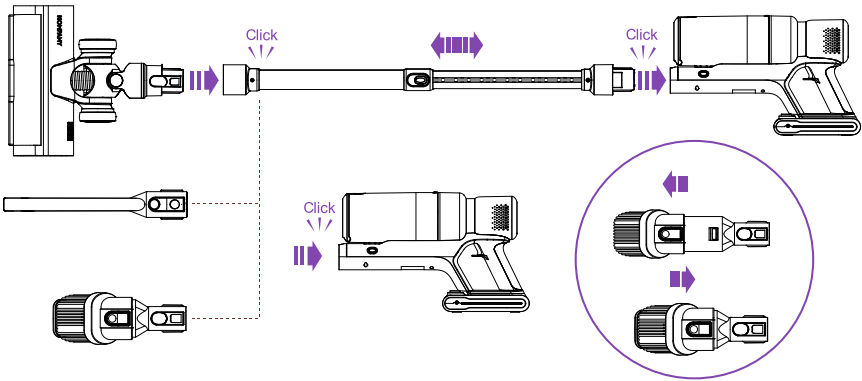

Power mode and speed switch

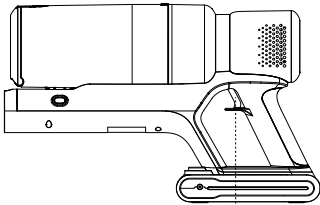

ON/OFF button

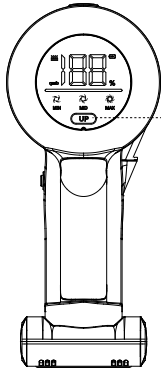

Switch Button

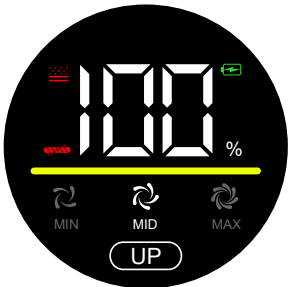

Boot into "MID" Mode

Touch the "UP" Key Set to "MAX" Mode

Touch the "UP" Key Again Switch to "MIN" Mode

Recharging on the storage wall-mount

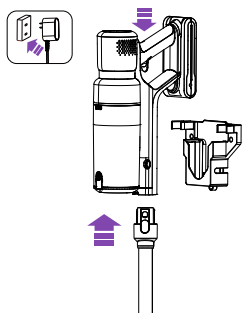

Charging separately

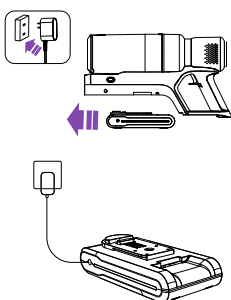

Power display

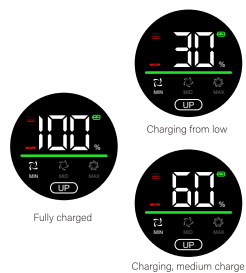

Empty the dust bin

1

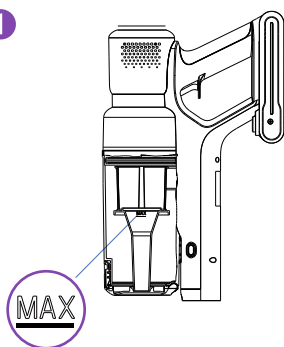

2

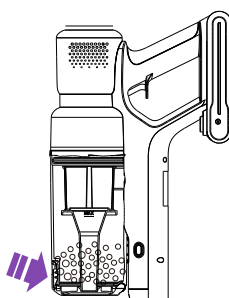

3

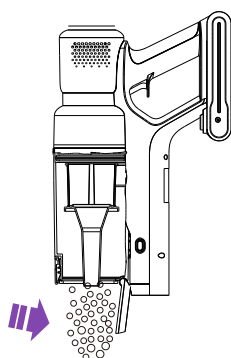

4

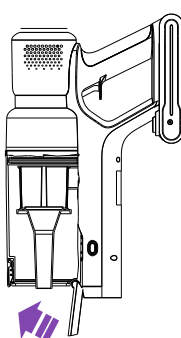

Clean the Electric Floor Brush

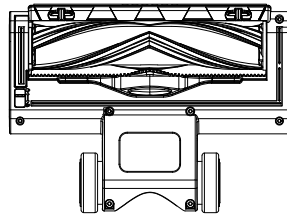
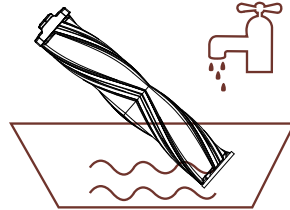
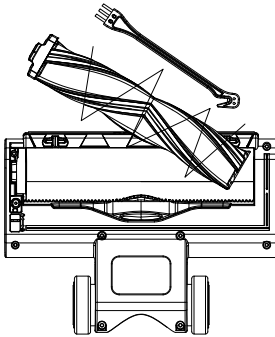
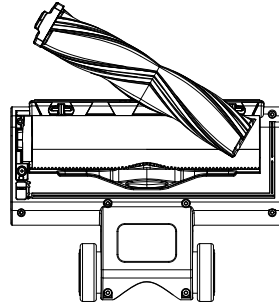
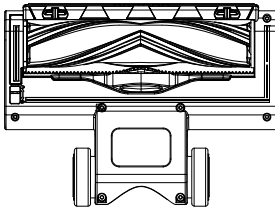

Dust Cup Cleaning



⚠ IMPORTANT!

Wash filters with cold water at least every month.

Ensure the filters are completely dry before refitting.

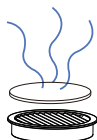
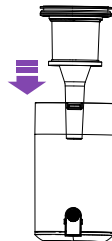
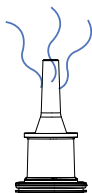
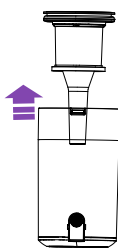

Remove the Dust Cup

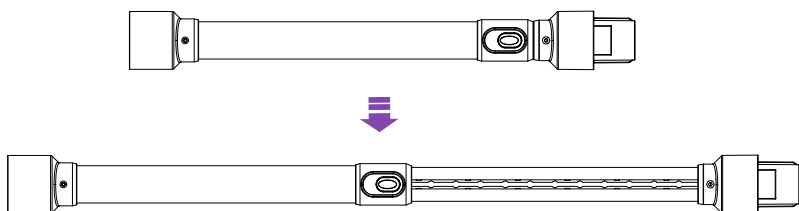
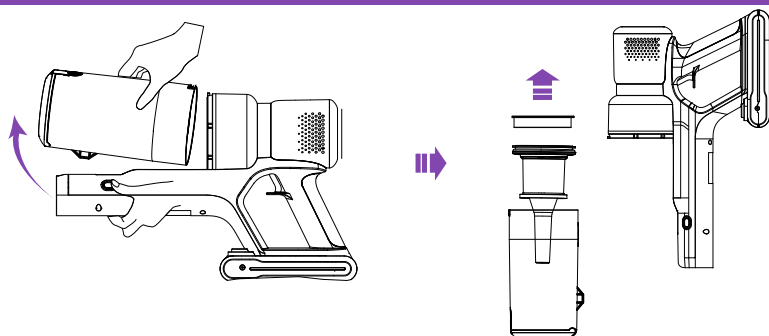

Prohibited operations

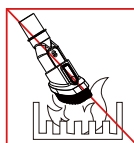

Do not use
SmartVac 11
near open flames.

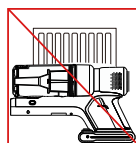

Do not store
SmartVac 11
near heat sources.

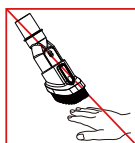

Do not put your hands
near the brush bar
when SmartVac 11
is running.

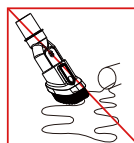

Not applicable for
picking up liquids.

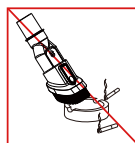

Not applicable for
picking up burning
objects.



Email to HOMPANY Official Customer Service:

EN: support@hompanty.top

EU: service@hompanty.top

We are always here to help you for any questions.



EN



EU