



MAKE A DIFFERENCE

Front Bumper

BXG.7204-S
(INSTALLATION INSTRUCTION)

ATTENTION • Please verify all parts are present and read instructions carefully before starting installation.
• Please feel free to contact your distributor if you have any kind of question about your purchase.

CONTENTS

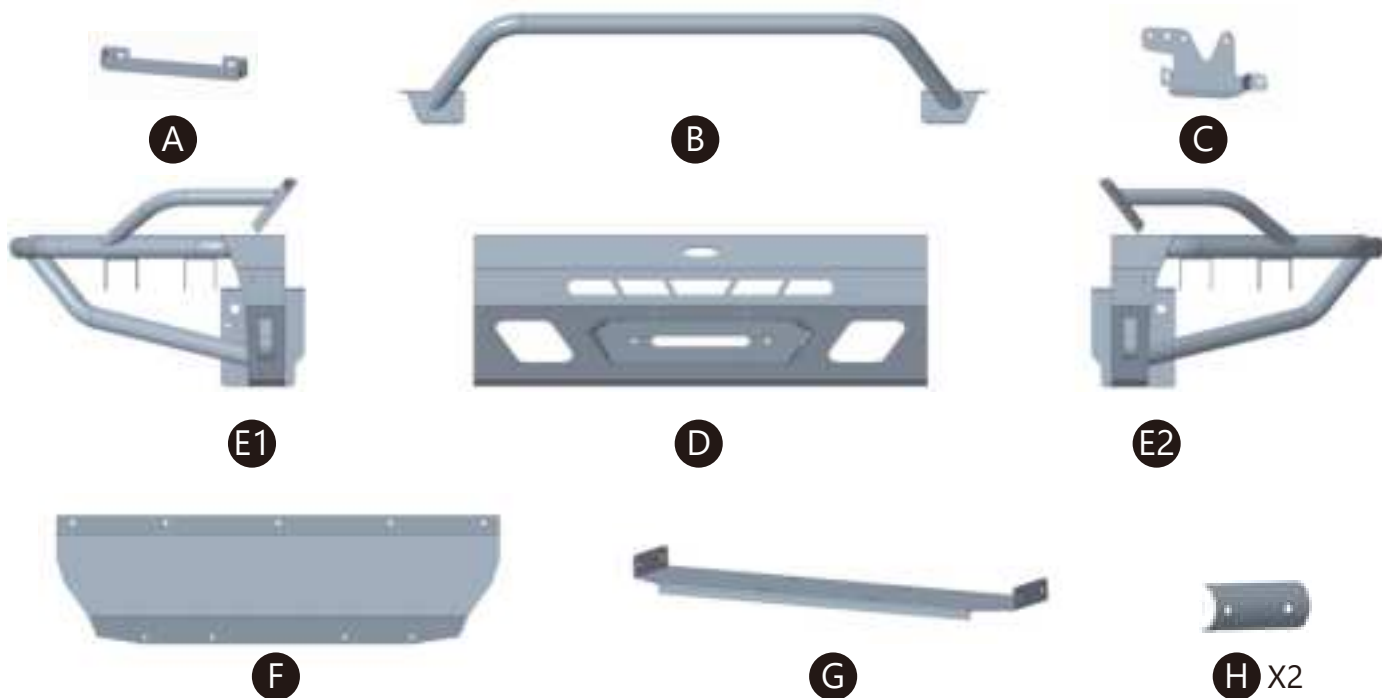

A: License Plate Bracket B: Bull Bar C: Hood Latch Assembly Bracket D: Main Body
E1&E2: Wings F: Skid Plate G: Winch Bracket H: Clamp Plates

Qty	Part Name	Size(mm)	Picture	Qty	Part Name	Size(mm)	Picture
10	Hex Bolt	M10×25		10	Flat Washer	M10×25×2	
8	Hex Flange Bolt	M10×20		23	Flat Washer	M8×20×1.5	
4	Button Bolt	M8×60		4	Flat Washer	M6×16×1.5	
15	Button Bolt	M8×20		2	Flat Washer	M6×16×1.5	
4	Button Bolt	M6×25		10	Flange Lock Nut	M8	
2	Button Bolt	M6×16		2	Flange Lock Nut	M6	
10	Split Lock Washer	D10		1	Rubber Strip Edge Trim	2300	
2	EVA						

2 TOOLS REQUIRED

◆ Drive Ratchet Handle

◆ 13mm, 17mm Wrench

◆ 4mm, 5mm Hex Bit Socket

◆ Marker Pen

◆ Tape Measure

◆ Cutting Machine

◆ Laser Level

◆ Masking Tape

To view online instruction, please scan the QR code.



3 INSTALLATION INSTRUCTION

Cutting the Factory Front Bumper

Important Note: We strongly recommend using a laser level to mark an accurate and straight cutting line. If you are not confident performing this step, please seek assistance from a professional installer or body shop to ensure the best result.

Step 1

Using a Laser Level to Mark the Cut Line:

1. Identify the four cutting points (1, 2, 3, 4) near the grille area on both sides of the bumper.
2. Set up a laser level on a tripod or stable surface in front of the vehicle.
3. Adjust the height of the laser so that the beam passes directly through cut points on the bumper.
4. Check from a distance to ensure the laser line is perfectly level and intersects both side marked areas.
5. Once aligned, use masking tape or a marker to trace along the laser beam on each side of the bumper.



Step 2

If you choose not to use a laser level and can accept potential variation in the cutting result, please refer to the two dimensions below for the side cuts. The other four cutting points are still applicable.

**Step 3**

Carefully cut the bumper along the marked lines using the appropriate tool. Be cautious to avoid damage or injury, and follow safe cutting practices. Clean up debris and smooth the cut edges for a clean finish. Attach the edge trim by pushing it over the cut edge, then trim it to fit.

- Cutting Machine



Step 4

Remove the lower plastic section of the factory bumper and the crash bar, locate the three installation positions.

**Step 5**

Open the hood and remove the upper and lower hood latch assembly bracket. Retain the factory bolts for reinstallation.

Before removal, confirm the latch alignment and lock position.

**Step 6**

Remove the latch assembly and retain the factory bolts.

**Step 7**

Install the latch assembly to the new bracket.

•(3) Factory Bolts



Step 8

Reinstall the new bracket to the factory position.
Ensure the latch alignment is correct before tightening the bolts.

- (2) Factory Bolts

**Step 9**

Secure the wings to the bumper, and **do not fully tighten to allow adjustability**. Repeat this step on the other side of the bumper.

- (6) M10×25 Hex Bolts

- (6) D10 Split Lock Washers

- (6) M10×25×2 Flat Washers

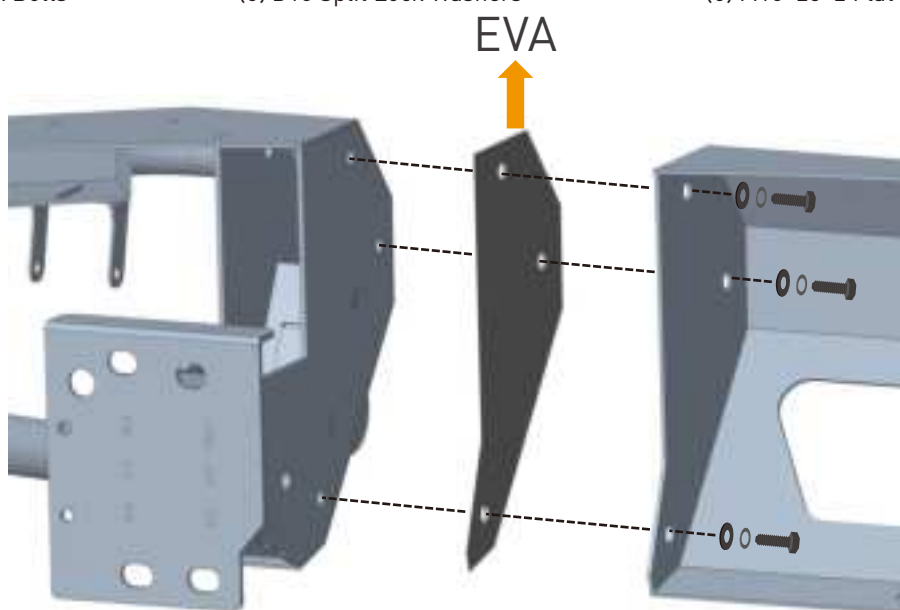
**Step 10**

Secure the license plate bracket to the bumper, and tighten the hardware.

- (2) M8×20 Bottom Bolts

- (2) M8×20×1.5 Flat Washers

- (2) M8 Flange Lock Nuts

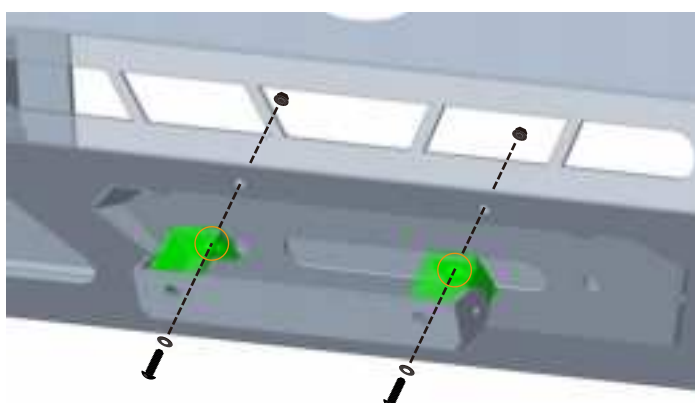

Secure the bull bar & the clamp plates to the bumper. Repeat this step on the other side of the bumper.

Tighten all hardware.

- (4) M8×60 Bottom Bolts
- (8) M8×20 Bottom Bolts

- (8) M8×20×1.5 Flat Washers
- (8) M8×20×1.5 Flat Washers

- (4) M8 Flange Lock Nuts
- (4) M8 Flange Lock Nuts

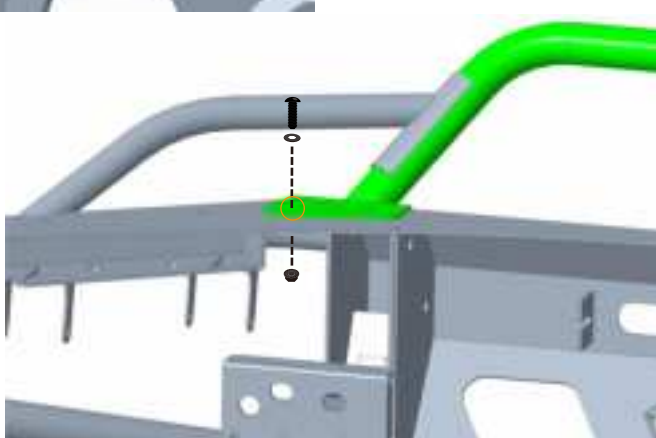
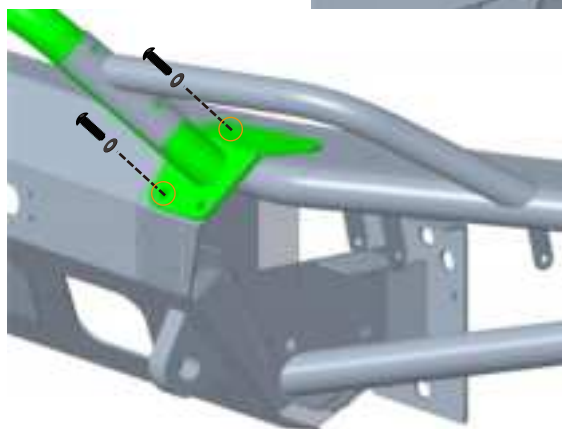
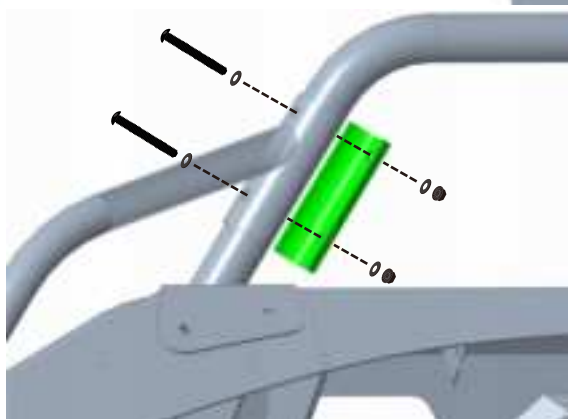
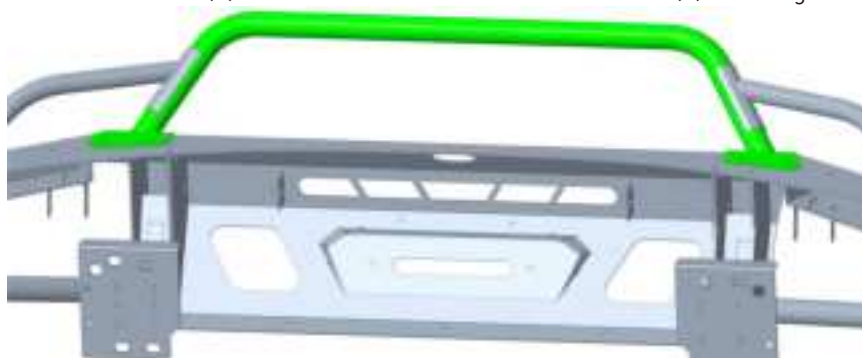

Secure the winch bracket to the bumper, and tighten the hardware.

- (4) M10×25 Hex Bolts

- (4) D10 Split Lock Washers

- (4) M10×25×2 Flat Washers

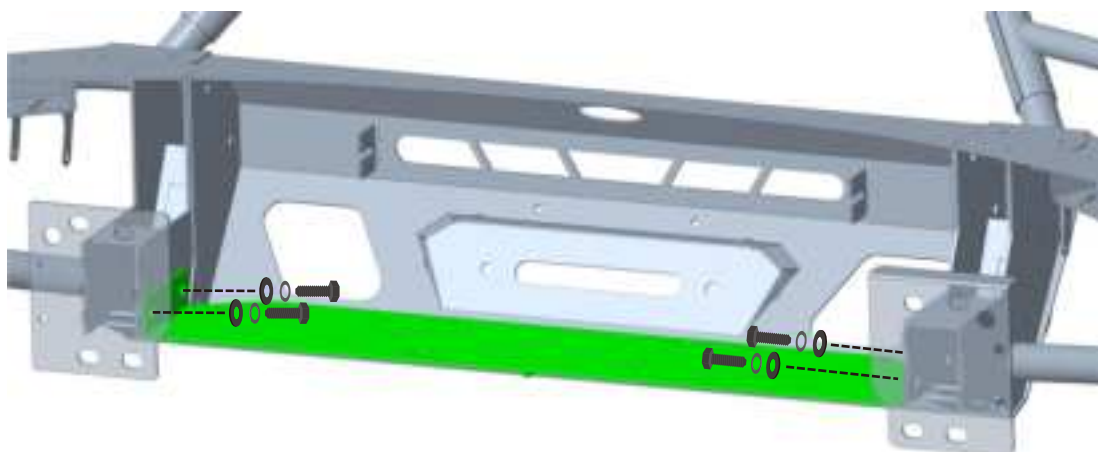

Step 13

Secure the bumper to the vehicle. **Adjust it to the desired position, then tighten all bolts.** Repeat this step on the other side of the vehicle.

- (8) M10×20 Hex Flange Bolts Or Factory Bolts

**Step 14**

Secure the skid plate to the bumper and vehicle, and tighten the hardware.

- (5) M8×20 Bottom Bolts
- (5) M8×20×1.5 Flat Washers
- (4) M6×25 Bottom Bolts
- (4) M6×16×1.5 Flat Washers

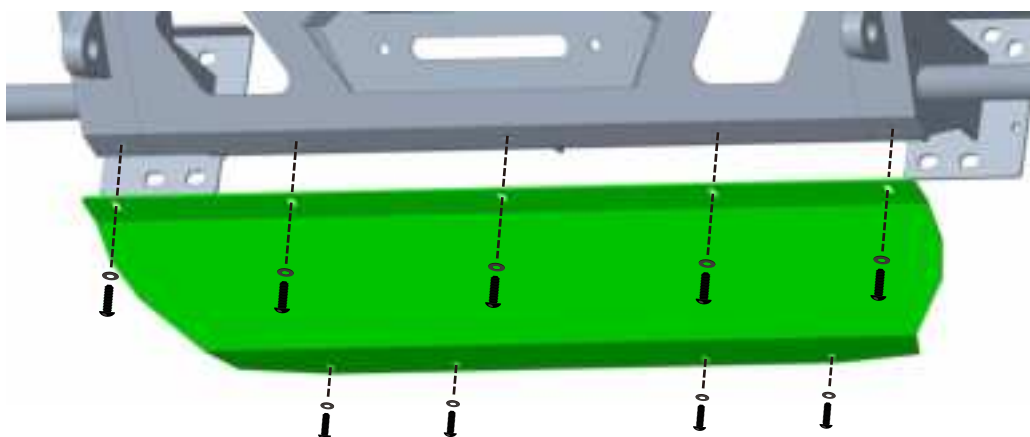
**Step 15**

The installation is complete. We hope you enjoy a wonderful off-road life with this quality Hooke Road product!

