

7-IN-1 WORKBENCH

All-in-One Household & DIY Work Station

Install Video YOUTUBE Search "LEADALLWAY 7 in 1 Workbench
Portable install video"



TECHNICAL SPECIFICATIONS

- ▶ Work platform size:
 - > 108.5 x 54.5 x 15.5 cm
 - > 42.7 x 21.5 x 6.1 Inch
- ▶ Work height:
 - > 52/78 cm
 - > 20.5/30.7 Inch

Loading capacity:

- ▶ Workbench /Saw Horse mode:
150Kgs / 330Lbs
- ▶ Scaffold / Platform mode -
250Kgs / 550Lbs
- ▶ Car Creeper & Dolly mode -
150Kgs / 330Lbs
- ▶ Hand Truck mode - 150Kgs /
330Lbs

Net weight: 13.5Kgs / 29.8Lbs



▲ WARNING!

Read carefully and understand all ASSEMBLY AND OPERATION INSTRUCTIONS before operating. Failure to follow the safety rules and other basic safety precautions may result in serious personal injury.

This machine is designed for certain applications only. The distributor cannot be responsible for issues arising from modification. We strongly recommend this machine not be modified and/or used for any application other than that for which it was designed. If you have any questions relative to a particular application, DO NOT use the machine until you have first contacted the distributor to determine if it can or should be performed on the product.

INTENDED USE:

The workbench is the ultimate 7-in-1 portable workbench, sawhorse, scaffold, platform, car creeper, dolly and hand truck. The item can be transformed easily between different modes by following the instruction manual. This product is intended for DIY and light trade use.

1/ GENERAL SAFETY RULES

- ▲ **WARNING:** Read and understand all instructions. Failure to follow all instructions listed below may result in serious injury.
- ▲ **CAUTION:** Do not allow persons to operate or assemble this workbench until they have read this manual and have developed a thorough understanding of how the unit works.
- ▲ **WARNING:** The warnings, cautions and instructions discussed in this instruction manual cannot cover all possible conditions or situations that could occur. It must be understood by the operator that common sense and caution are factors which cannot be built into this product, but must be applied by the operator.

SAVE THESE INSTRUCTIONS.

2/ IMPORTANT SAFETY CONSIDERATIONS

- **FAILURE TO FOLLOW THESE SAFETY PRECAUTIONS AND INSTRUCTIONS COULD RESULT IN DAMAGE TO THE PRODUCT AND/OR SERIOUS INJURY TO YOU!**
- Make sure all moving parts are free from interference.
- Keep hands clear of all moving parts.
- Ensure workbench is used in a dry place, protected from rain. The product is for INDOOR use only. Do not store or use it outdoors or in a moist environment.
- Keep work area well lit.
- Be aware of over balancing. When using this product in all modes, please keep your body or a heavy object in the centre or surface to avoid overbalance. Incorrect usage may cause it to turn over and result in personal injury.
- When transporting the workbench in a vehicle, always tie down to prevent movement and possible damage.
- Check to make sure that all fixing screws and knobs are tight and all legs are locked into position before operating the workbench.
- **DON'T USE SCAFFOLD/PLATFORM MODE WITH LEGS FULLY EXTENDED.** Always use this product on a stable, level surface. Failure to use properly or overload may result in serious personal injury.
- When using this product with power tools, please refer to the manufacturer's instructions for guidance on usage.
- The product must be used only for its prescribed purpose. Any use other than those mentioned in these instructions will be considered a case of misuse. The manufacturer shall not be liable for any damage or injury resulting from such cases of misuse.
- The manufacturer shall not be liable for any modifications made to the tool or for any damage resulting from such modifications.

3/ASSEMBLY

Your 7-in-1 workbench comes fully assembled, just take it out of the packaging and follow the simple set up steps, then it's ready to use.

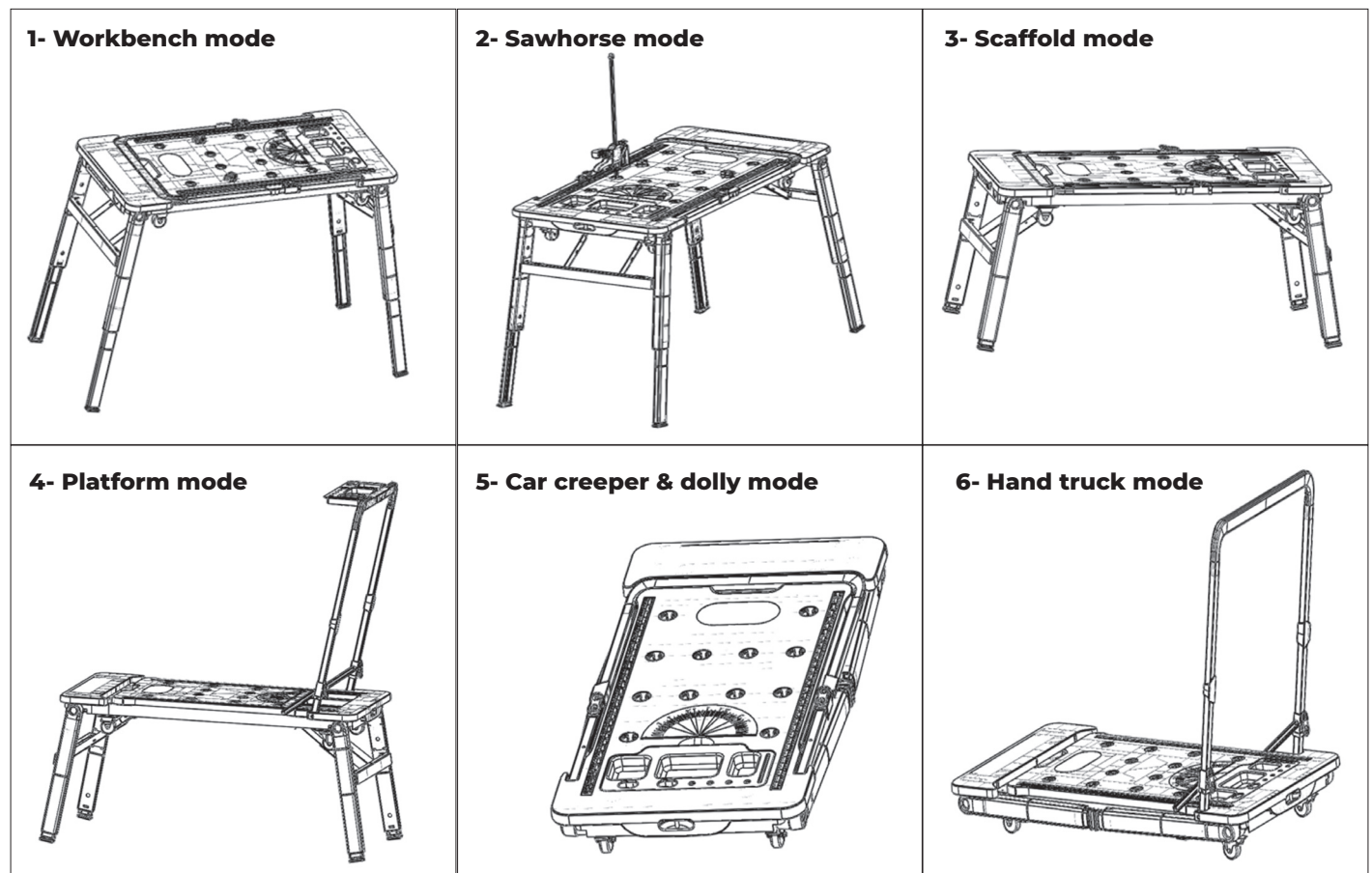

a/ Car Creeper & Dolly Mode

Please follow these steps to install wheels in the car creeper & dolly mode:

1. Find the wheels, gaskets and screws in the back of the workbench, then line up all the screws, gasket and wheels. Notice that the 2 universal wheels with brakes should be installed under the tool tray and the left 2 fixed wheels on the other side.
2. Put one gasket on the screw hole and secure the screw by using a screwdriver.
3. Rotate the wheel to fix the 4 screws, make sure the wheels are fully secured.
4. Follow steps 1-3 to assemble the other 3 wheels, then your car creeper is ready to go.
5. Connect a pulling rope to the towing holes, then the dolly is completed.

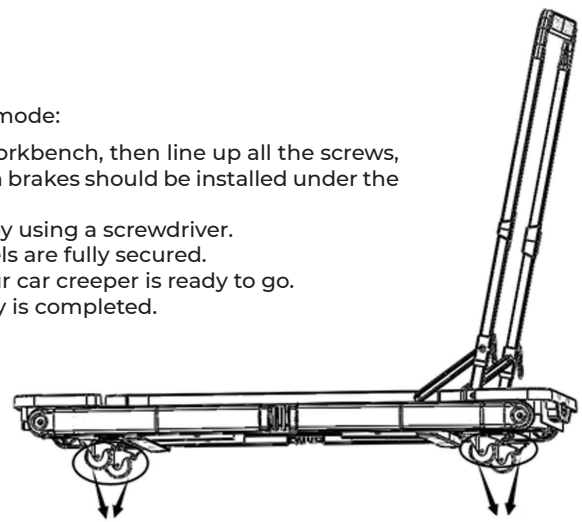

Fixed wheels

Universal wheels with brakes

TIP : How to install the wheels

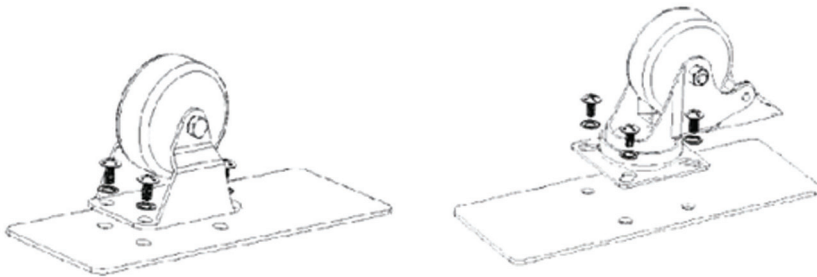

The 4 wheels are packed in the back of the workbench and need to be installed by the consumer after purchase. During installation, please be aware of the following:

1. Always use the gaskets which are provided in the carton. See the illustrations above.
2. There are 2 universal/steering wheels plus 2 fixed wheels in the set, and each set of wheels has their own position. Please refer to the illustration above.

Install Video YOUTUBE Search "LEADALLWAY 7 in 1 Workbench Portable install video"

b/ Hand truck mode

1. Pull the handle up from the car creeper mode until you can't move it any more, then a hand truck is ready.
2. Push the two buttons on the handle, it can be withdrawn.

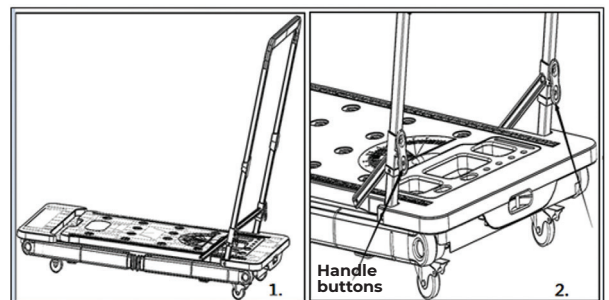

b/ Scaffold & Platform mode

1. Release all legs from their locking position, then rotate each pair of legs until you can't move them anymore.
2. Ensure the gusset brace is locked by pulling up it. Repeat for all the other gusset braces.
3. Pull the handle up until you can't move it any more, then release the tool tray from its locking position, put the tool tray on the top of the handle, forming a platform. THE LOADING CAPACITY FOR THE TOOL TRAY IS 2KGS (4.5LBS) IN THIS MODE.
4. Hang the hook on the handle, it can be used to hang tool bags while working on the platform.

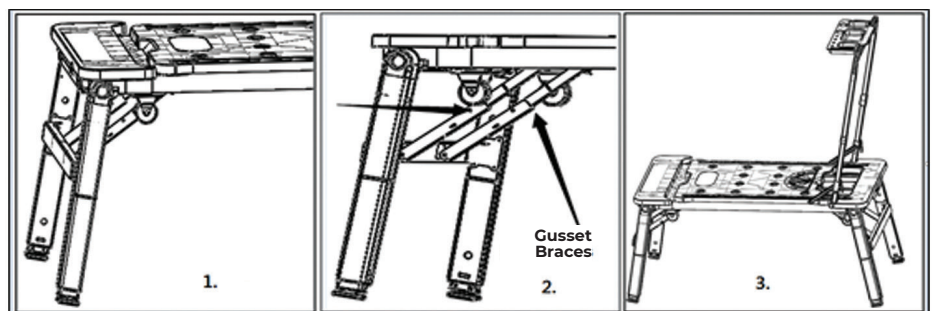

c/ Workbench & Sawhorse mode

1. Firstly, set up the legs by following the same steps as detailed within scaffold mode section.
2. Push the snap buttons on the side of each leg to release them, then pull the inner legs out to the workbench height. When legs are fully extended they will snap into place. Gently turn the workbench upright onto a stable, level surface.
3. Please follow below steps to connect with a quick clamp.
 - 1) Remove the small plastic part of your quick clamp
 - 2) Put the steel bar into our connector (Fig 2) and put a pin into the lock hole, make sure they are connected firmly(Fig 3);
 - 3) Put the connector into Sawhorse hole on the workbench surface and rotate at least 30 degrees (Fig4);
 - 4) With the help of the 2 vice pegs on the workbench, a sawhorse is completed.

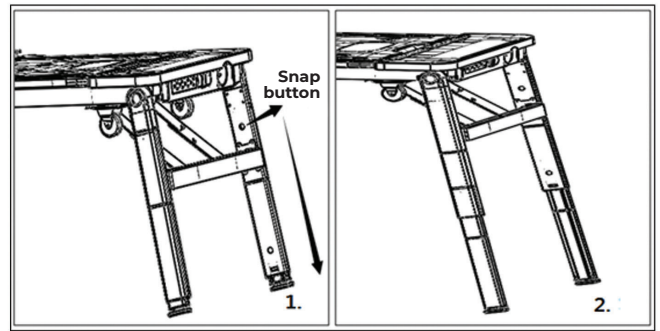

NOTE: DO NOT step on the workbench while the legs are fully extended.

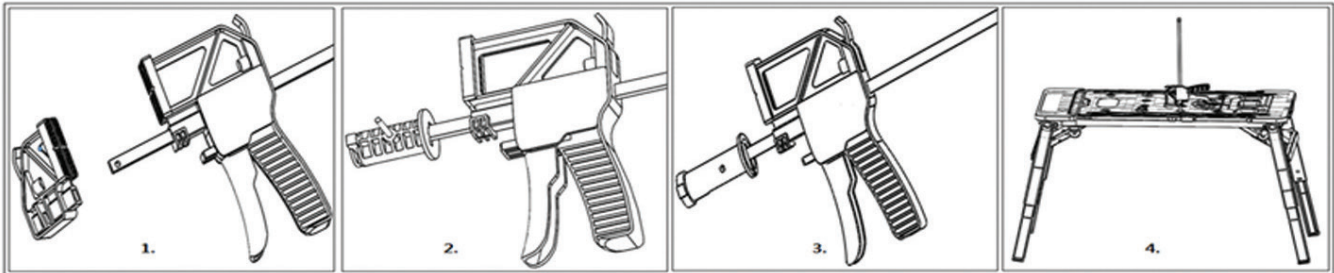

4/ MAINTENANCE

- Maintain your workbench. It is recommended that the general condition of any workbench be examined before it is used. Keep your workbench in good repair by adopting a program of conscientious repair and maintenance. Have necessary repairs made by qualified service personnel.
- Wipe away dirt and dust from the workbench on a regular basis.