

Multi function Gateway

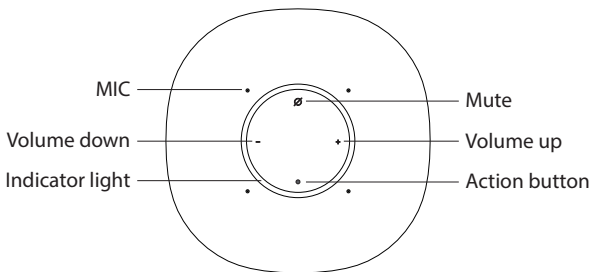

R4060

TOP



Note: the volume up/down button is only for adjusting Alexa sound.

Rear

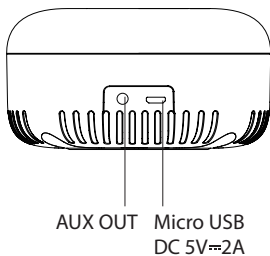

English

Package includes

1. Multifunction Gateway x 1
2. USB cable x 1
3. User manual x 1
4. Power Adatper x 1
5. IR Remote control x 1
6. AAA battery x 2

Introduction

The R4060 is a new generation, powerful, multifunction, smart home gateway. It features Alexa-built in, Zigbee gateway, Smart IR, Siren, bluetooth speaker.

Requirement to use

1. WOOX Security app
2. WLAN-enabled router: 2.4GHz (Separate band)

Set up the multifunction gateway with WOOX Security App

1. Download and install the app "WOOX Security" from Apple App Store or Google Play Store on your smartphone.
2. Open bluetooth on smartphone.
3. Enable bluetooth and location permission for WOOX Security app, so that the app can find gateway via bluetooth.
4. Launch the app "WOOX Security".
5. Create a new account or log in to your existing account.
6. Power on the gateway and ensure the its indicator light is quick flashing in orange. If the indicator light isn't flashing: hold and press the action button for 5 seconds until the indicator light starts to flash.
7. Tap "+" to add the device.
8. The gateway will appear on the app. If gateway does not appear, please check if the bluetooth and location permission of WOOX Security app are enabled in smartphone settings.

9. Select the gateway and continue.

10. Confirm the Wi-Fi network and password.

Note: only 2.4GHz WiFi is supported.

11. The app will now search for the device and register is to your account.

12. Enter the device name.

Note: The device name will also be used by Amazon Alexa and Google Home.

Function description

• Alexa built-in

Function: Alexa built-in devices let you instantly connect to Alexa to play music, control your smart home, get information, news, weather, and more using just your voice. e.g.: you can say "Alexa, arm the gateway in home mode".

How to control smart home device: To voice control smart home device that connected to gateway, you will need to link WOOX Security app account to Alexa. After login Alexa in app, it will check if your account is linked, if not, it will ask you to complete link process.

Change Alexa language: you can change the Alexa language in the left menu as below:

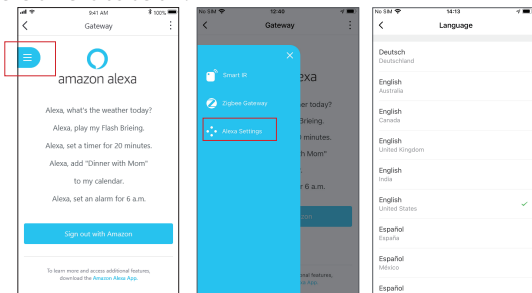

• Zigbee gateway

Function: Zigbee gateway is used to connect Zigbee products to WOOX Security app, you can connect up to 100 Zigbee products from a single gateway.

Security status: Gateway has 3 security status: home mode, away mode, and disarm mode. You can change the gateway status with WOOX Security app or voice control. In home/away mode, you can select specific product in the app to secure your home.

Manage Zigbee products: You can access zigbee gateway in the left menu as below. In zigbee gateway you can add Zigbee products and check message occurred by Zigbee products.

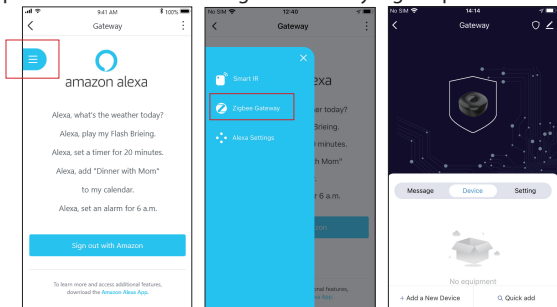

• Smart IR

Function: R4060 supports most of home entertainment devices with IR frequency at 38K Hz with multi-angle directions in 6 meters range. It works with over 8,000 devices from 2,000+ brands, including TV, VCR, DVD, Blu-ray, AV receiver, Audio/Amplifier, CD, TV Box, Media box, SAT/Cable, Projector, Soundbar, etc.

IR learnig is also supported if there is not available code. More important, you can control these devices via voice, e.g.: "Alexa, turn on the TV".

Add IR device in app: You can access Smart IR in the left menu as below.

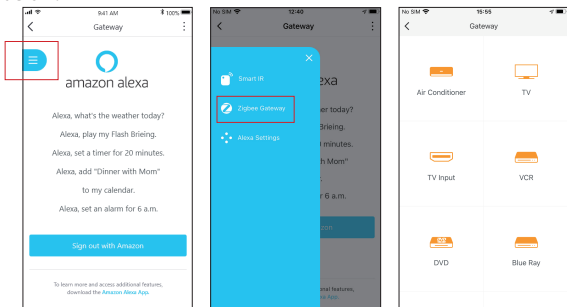

IR remote control: R4060 comes with a IR remote control accessory without IR codes inside. To use it, user need to download IR codes from cloud through gateway.

- Download IR codes from cloud to IR remote control: open smart IR menu in the app, click "Edit" in the right top corner, then click "Send to Smart IR Unit".

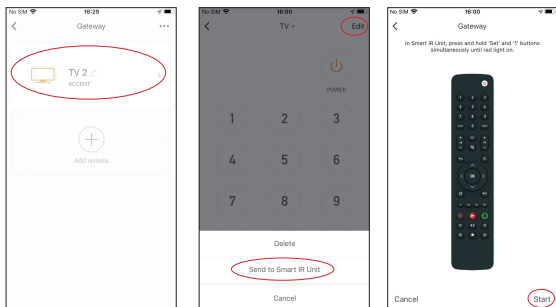

English

- Press and hold "Set" (SET) and "1" (1) buttons simultaneously until power button (POWER) light on in red.
- Select the category that you want to store in IR remote control, press "Poceed" to start downloading from gateway to IR remote control via RF 433.92MHz frequency. It supports to store 5 IR remote codes: TV, STB, DVD, MEDIA and SET&MEDIA.

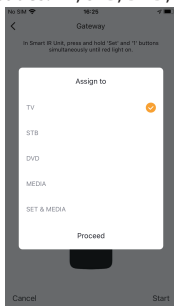

- After downloading success, select the corresponding category to control your device. e.g.: if you downloaded a TV codes to TV category, when control your TV off, you need press the "TV" button (TV) first, then press power button to turn off TV. If you downloaded TV codes to SET&MEDIA category, when control your TV off, you need press the "SET" button (SET) and "MEDIA" button (MEDIA) at the same time first, then press power button to turn off TV.

Note: you can use the IR remote control without gateway nearby.

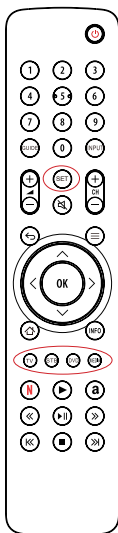

- Clear IR codes stored in IR remote control and reset to default: press and hold "SET" button (SET) and "0" button (0) at the same time for 3 seconds until power button light on in red, then press "OK" button to set to default, LED will flash twice once completed.
- Note:
 1. LED will flash 6 times if downloading failed.
 2. The IR remote control will exit downloading mode automatically if there is no action within 30s.

• Siren

Function: the siren function is built in firmware, once alarm is

English

triggered by app or Zigbee products, gateway will alert with 85dB sound, the sound will not stop until the alarm is cancelled.

• Bluetooth speaker

Function: With bluetooth inside, you can use it as a bluetooth speaker, it's bluetooth name is R4060.

Note: R4060 can not connect to other bluetooth speaker via bluetooth, only AUX is supported.

Technical data

Input: DC 5V/2A

Voice service: Alexa built-in

Wake up: Far-field wake up

Speaker: 3W

Output: AUX

Bluetooth: supported

Zigbee: Tuya Zigbee 3.0

Zigbee distance: indoor 20-30 meters

Siren: 85dB alarm sound

Wireless connection: 2.4GHz Wi-Fi & Zigbee 3.0

RF frequency: 433.92MHz

IR frequency: 38KHz

IR distance: Max. 6 meters

Dimension: 100x100x53.5mm

Working temperature: -10℃ -45℃

Working humidity: ≤85%RH

Caution:

This device complies with Part 15 of the FCC rules and Industry Canada license-exempt RSS standard(s). Operation is subject to the following two conditions: (1) this device may not cause harmful interference, and (2) this device must accept any interference received, including interference that may cause undesired operation.

The manufacturer is not responsible for any radio or TV interference caused by unauthorized modifications or change to this equipment. Such modifications or change could void the user's authority to operate the equipment.

This radio transmitter (identify the device by certification number or model number if Category II) has been approved by Industry Canada to operate with the antenna types listed below with the maximum permissible gain indicated. Antenna types not included in this list, having a gain greater than the maximum gain indicated for that type, are strictly prohibited for use with this device.

This equipment has been tested and found to comply with the limits for a Class B digital device, pursuant to part 15 of the FCC Rules. These limits are designed to provide reasonable protection against harmful interference in a residential installation. This equipment generates, uses and can radiate radio frequency energy and, if not installed and used in accordance with the instructions, may cause harmful interference to radio communications. However, there is no guarantee that interference will not occur in a particular installation. If this equipment does cause harmful interference to radio or television reception, which can be determined by turning the equipment off and on, the user is encouraged to try to correct the interference by one or more of the following measures:

- Reorient or relocate the receiving antenna.
- Increase the separation between the equipment and receiver.
- Connect the equipment into an outlet on a circuit different from that to which the receiver is connected.
- Consult the dealer or an experienced radio/TV technician for help.

The device has been evaluated to meet general RF exposure requirement.

To maintain compliance with FCC's RF exposure guidelines, this equipment should be installed and operated with a minimum distance of 20cm between the radiator and your body.