

User Manual Dishwasher

TXBD600

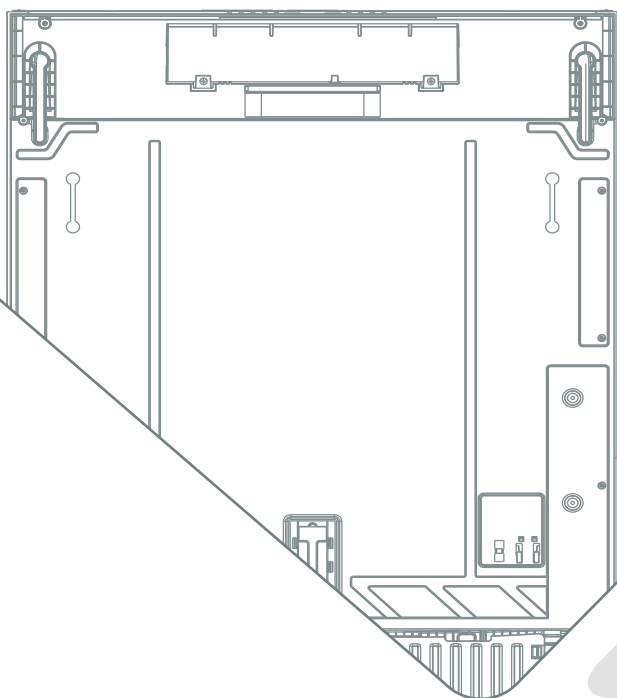

Thank you for purchasing a Teknix product

Please read these instructions carefully before using this appliance. The instructions contain important information which will help you get the best out of the appliance and ensure safe and proper installation, use and maintenance.

Keep this manual in a convenient place so you can always refer to it for the safe and proper use of the appliance.

If you sell the appliance, give it away, or leave it behind when you move house, make sure you also pass on this manual so that the new owner can become familiar with the appliance and safety warnings.

Safety and warnings	1
Installation instructions	4
Product description	20
Overview of programmes.....	22
Water softening system.....	24
Using rinse aid.....	26
Utensils.....	27
Loading utensils.....	28
Adding detergent.....	30
Before first Use.....	31
Daily Use.....	33
Care and cleaning.....	35
Troubleshooting.....	39
Recommended loading.....	43
Technical Data.....	44
Washing Programs.....	45
Usage Counter.....	46

Please read these instructions carefully before using this appliance. The instructions contain important information which will help you get the best out of the appliance and ensure safe and proper installation, use and maintenance.

⚠ WARNING Electrical shock hazard

Before installing the dishwasher, remove the house fuse or open the circuit breaker. This appliance must be earthed. In the event of a malfunction or breakdown, earthing will reduce the risk of electric shock by providing a path of least resistance for electric current. This appliance is equipped with a cord having an equipment earthing conductor and an earthing plug. The plug must be plugged into an appropriate outlet that is installed and earthed in accordance with all local codes and ordinances.

WARNING - Improper connection of the equipment earthing conductor can result in a risk of electric shock. Check with a qualified electrician or service representative if you are in doubt as to whether the appliance is properly earthed.

Do not modify the power supply plug provided with the appliance - if it will not fit the outlet, have a proper outlet installed by a qualified electrician. Do not use an extension cord, adapter plug or multiple outlet box.

Failure to follow this advice may result in electrical shock or death.

⚠ WARNING Cut Hazard

Take care - panel edges are sharp.

Failure to use caution could result in injury or cuts.

⚠ WARNING When using your dishwasher, follow basic precautions, including the following:

- Read all instructions before using the dishwasher.
- The information in this manual must be followed to minimise the risk of fire or explosion or to prevent property damage, personal injury or loss of life.
- Use the dishwasher only for its intended function as described in this user guide.
- This appliance is intended to be used in household and similar applications such as:
 - staff kitchen areas in shops, offices and other working environments;
 - farm houses;
 - by clients in hotels, motels and other residential type environments;
 - bed and breakfast type environments.

Safety and warnings

- Use only detergents or rinse aid recommended for use in a domestic dishwasher and keep them out of reach of children.
- Check that the detergent dispenser is empty after the completion of each wash program.
- When loading items to be washed, locate sharp items so that they are not likely to damage the dishwasher and load sharp knives with the handle up to reduce the risk of cut-type injuries.
- Do not touch the filter plate (the metal disc in the dishwasher base) during or immediately after use, as it may be hot from the heater plate underneath.
- Do not tamper with the controls.
- Do not abuse, sit in, stand on the door or dish rack of the dishwasher.
- Do not lean on the adjustable racks or use them to support your body weight.
- To reduce the risk of injury, do not allow children to play in or on the dishwasher.
- Remove the door to the washing compartment when removing an old dishwasher from service or discarding it.
- Some dishwasher detergents are strongly alkaline. They can be extremely dangerous if swallowed. Avoid contact with the skin and eyes and keep children away from the dishwasher when the door is open. Check that the detergent receptacle is empty after completion of the wash cycle.
- Certified residential dishwashers are not intended for licensed food establishments.

Maintenance safety instructions

- Disconnect the appliance from the power supply before any cleaning or maintenance.
- When disconnecting the appliance, pull the plug rather than the power supply cord or junction of cord to avoid damage.
- Do not repair or replace any part of the appliance or attempt any servicing unless specifically recommended in this user guide.
- Keep the floor around your appliance clean and dry to reduce the possibility of slipping.
- Keep the area around/underneath your appliance free from the accumulation of combustible materials, such as lint, paper, rags and chemicals.

Operational safety instructions

- Open the door very carefully if the dishwasher is in operation. There is a risk of being sprayed with hot water. Do not open the door fully until the spray arms have stopped rotating.
- The door should not be left in the open position as this could present a tripping hazard.
- The water inside the dishwasher is not suitable for drinking.
- The dishwasher must be used with the filter plate, drain filter and spray arm(s) in place. To identify what these parts are, see drawings in section “Care and Cleaning” of this user guide.
- Do not operate this dishwasher if it is damaged, malfunctioning, partially disassembled or has missing or broken parts, including a damaged power supply cord or plug.
- Household appliances are not intended to be played with by children. Children of less than 8 years old must be kept away from the appliance unless continuously supervised. This appliance can be used by children aged from 8 years and above, and persons with reduced physical, sensory or mental capabilities or lack of experience and knowledge, if they have been given supervision or instruction concerning the use of the appliance in a safe way and they understand the hazards involved.
- Cleaning and user maintenance shall not be done by children without supervision.
- Do not allow children to play inside, on or with this appliance or any discarded appliance.
- If a dishwasher cleaner is used, we would strongly recommend a wash program with detergent should be run immediately afterward, to prevent any damage to the dishwasher.
- The dishwasher is designed for washing normal household utensils. Items that are contaminated by petrol, paint, steel or iron debris, corrosive, acidic or alkaline chemicals are not to be washed in the dishwasher.
- If the dishwasher is not being used for long periods of time, turn the electricity and water supply to the dishwasher off.

Installation instructions

■ Parts supplied



Drain hose support (1)

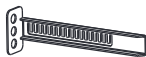

Brackets for toe kick (2)



Installing the fixings (1)



Instructions(1)
Installation Guide(1)
Energy and water consumption sticker(1)

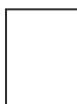

Moisture protection tape (1)



Inlet hose (1)



Salt funnel(1)



ST3.9 (9)



ST3.5 (6)



ST4.0 (4)

■ Prior to installation

Unpacking and handling

- Check packaging and dishwasher for signs of transport damage. If the dishwasher is in any way damaged, do not install it. Contact the dealer the dishwasher was purchased from.
- Disposal of packaging: some of the packaging is recyclable. Check the symbols and labels and recycle if possible.
- Never lift the dishwasher from the door handle or the top panel. Doing so may cause damage.
- Always be careful with the hoses and power cord at the back of the dishwasher. Careful handling will prevent damage and malfunction from squashing, kinking or cuts.
- While installing the dishwasher, check the drain hose is not restricted or kinked.

Connections and services

- Check that the power cord is long enough to reach the outlet. If it isn't, it must be replaced by a authorised technician. Extension cords or multi-outlet power boards should not be used to connect the dishwasher to the power supply.
- Check that the hoses are long enough to reach the services. If a hose needs extending, ensure that the extension hose is new and of equal quality and diameter to the one already fitted.
- The dishwasher should not be connected to a water system where the emperature exceeds 25°C.
- The dishwasher must not be connected to an undersink high-pressure "pushthrough" type hot water system, as damage to the system will result.

1 Product dimensions

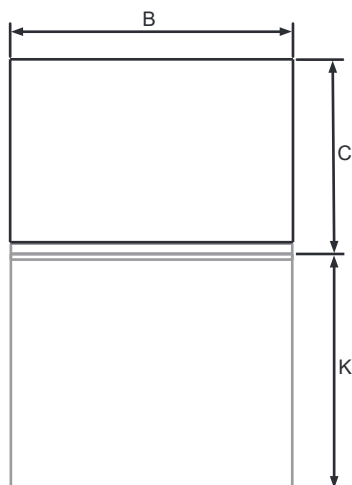

PLAN

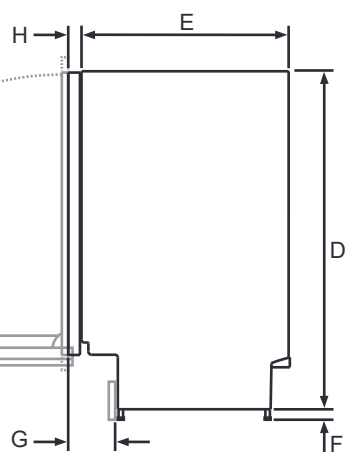

PROFILE

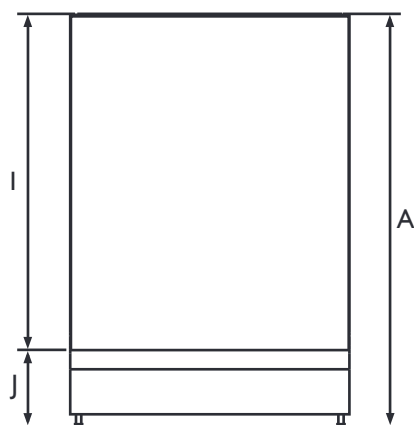

FRONT

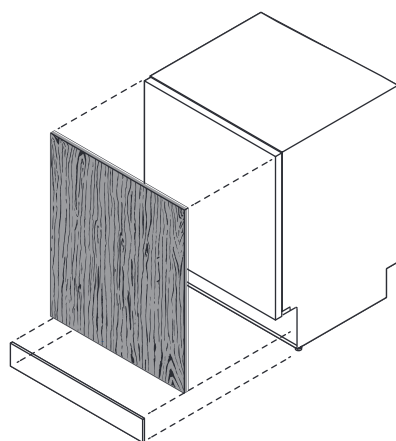

Installation instructions

Product dimensions	Std tub product unit : mm
A Overall height*	820-860
B Overall width **	597
C Overall depth**	554
D Height of chassis	820
E Depth of chassis	521
F Height of feet*	0-40
G Depth of toe kickrecess	120
H Depth of inner door**	33
I Height fom top of chassis to bottom of inner door	683
J Height from to bottom of inner door to floor*	138
K Depth of door opening**	639

* depending on adjustment of levelling feet.

** excluding custom panel and handle.

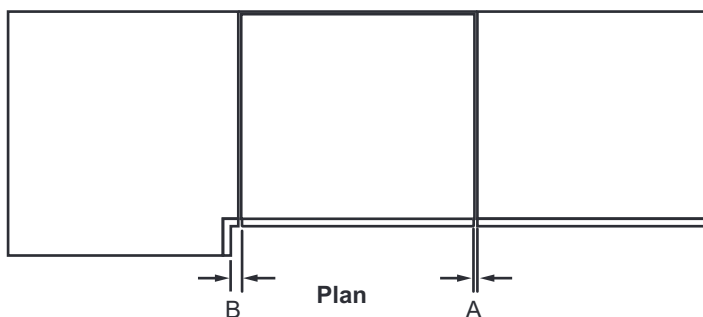

Cabinetry dimensions	unit : mm
Minimum clearance to adjacent cupboard door	2
Minimum clearance to corner cupboard	13

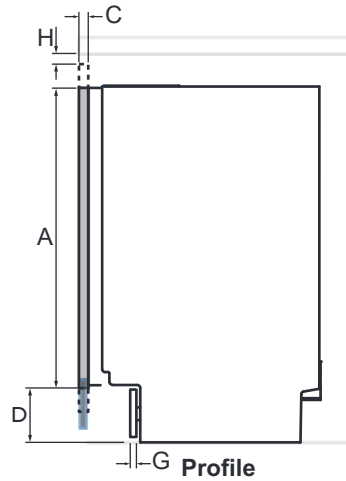
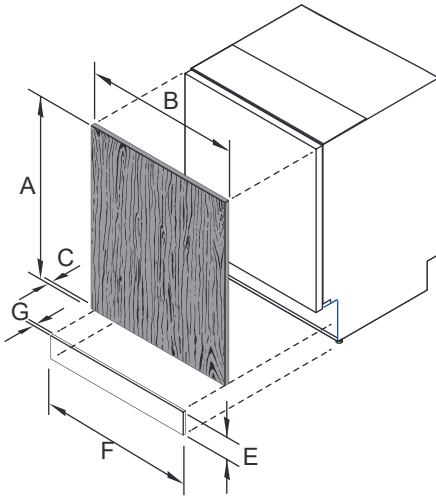

Custom panel considerations

A	Minimum height of custom door panel for full coverage of the inner door
B	Minimum door panel width
C	Door panel depth
D	Distance from base of door panel to floor
E	Toe kick panel height
F	Minimum width of custom toe kick panel *
G	Minimum toe kick panel depth **
H	Minimum clearance between top of door panel and benchtop
Weight of door panel (including handle)	

Std tub product unit:mm

677

596

16-25

65-200

65-200

596

16

2

4-9kg

- *
- ** if using supplied toe kick mounting screws. Panel can be fixed via screwing or gluing to the supplied mounting bracket.

Actual Product dimensions may vary by $\pm 2\text{mm}$

2 Cavity preparation

Preparing the product and cabinetry

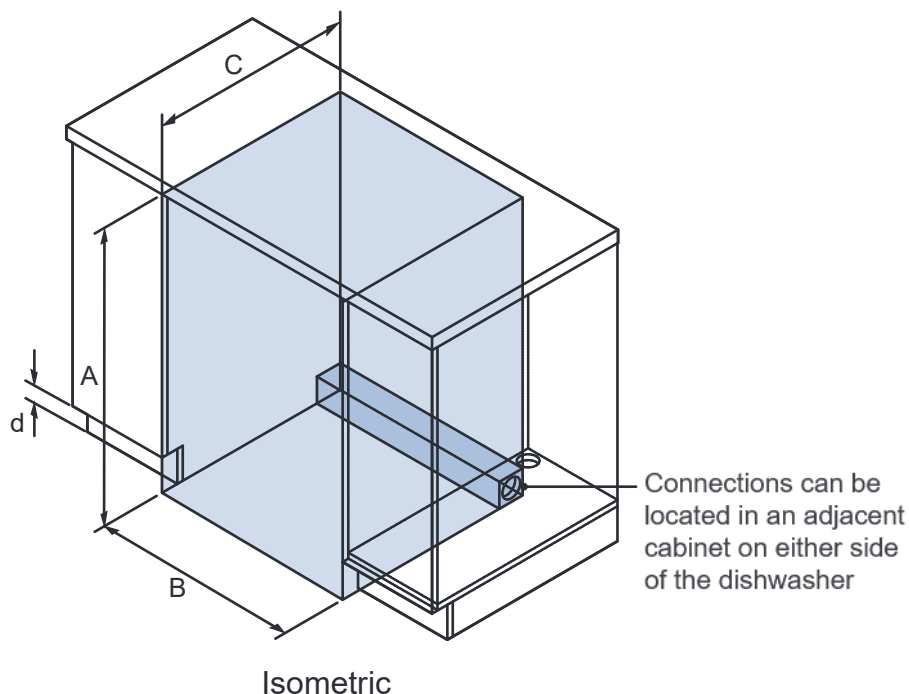

Cabinetry dimensions

unit: mm

A Minimum inside height*

820

B Minimum inside width

600

C Minimum overall depth **

580

D Height of toe kick area

65-200

* depending on adjustment of levelling feet

** including 19mm door panels on adjacent cabinetry

***For more information on service requirements, refer to 'Plumbing & electrical considerations' and 'Cabinetry preparation'.

IMPORTANT!

To prevent possible steam damage to the cabinetry, ensure that any bare wood surrounding the dishwasher is sealed with an oil-based paint or moisture-proof polyurethane.

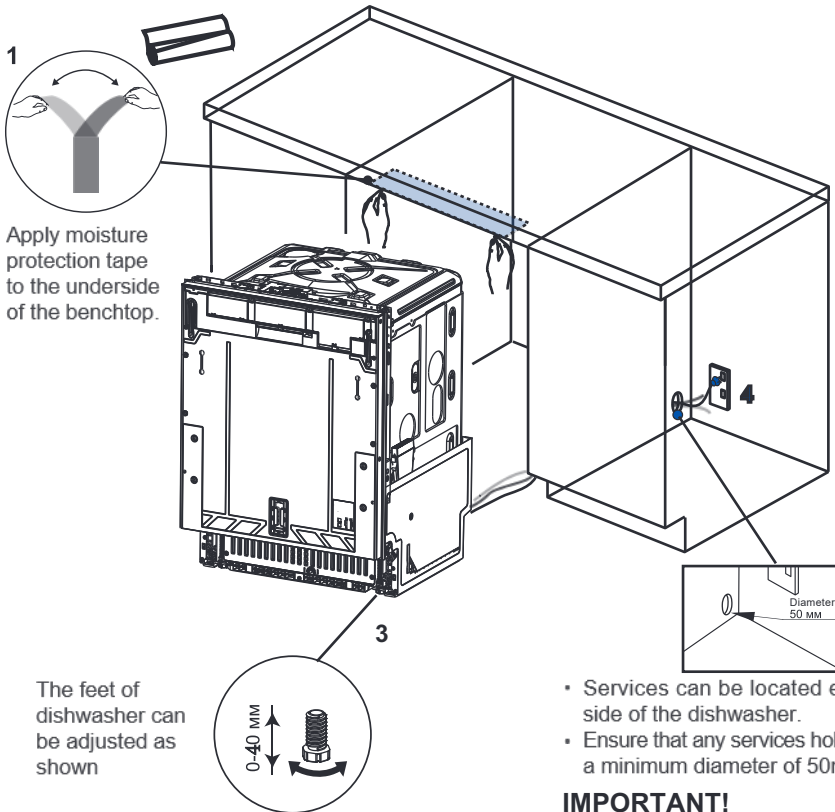

- Services can be located either side of the dishwasher.
- Ensure that any services hole has a minimum diameter of 50mm.

IMPORTANT!

The power outlet must be located in a cabinet adjacent to the dishwasher cavity.

Positioning and stabilising the dishwasher

- Do not lift the dishwasher from the door handle.
- As you push product in, pull through hoses and cord, ensuring they don't get kinked or twisted.
- Plastic spacers can now be inserted at the side of the dishwasher next to the hinge to improve stability see step 7 for details on fitting spacers
- After sliding the dishwasher into position, adjust back foot with a 6mm Allen key.
- The front feet can be adjusted manually also.
- We recommend that you adjust the feet so that the dishwasher sits securely under the bench top so that it doesn't tip.

4 Custom door panel preparation

Front panel material specifications

The front of the dishwasher can be fitted with a front panel with the following specifications: Adequately sealed to withstand moisture (50°C @ 80% RH). Because of it being a hot and wet environment generally, the back and sides of the panel should be completely sealed with a waterproof vapor barrier (ie polyurethane) to prevent damage to the panel.

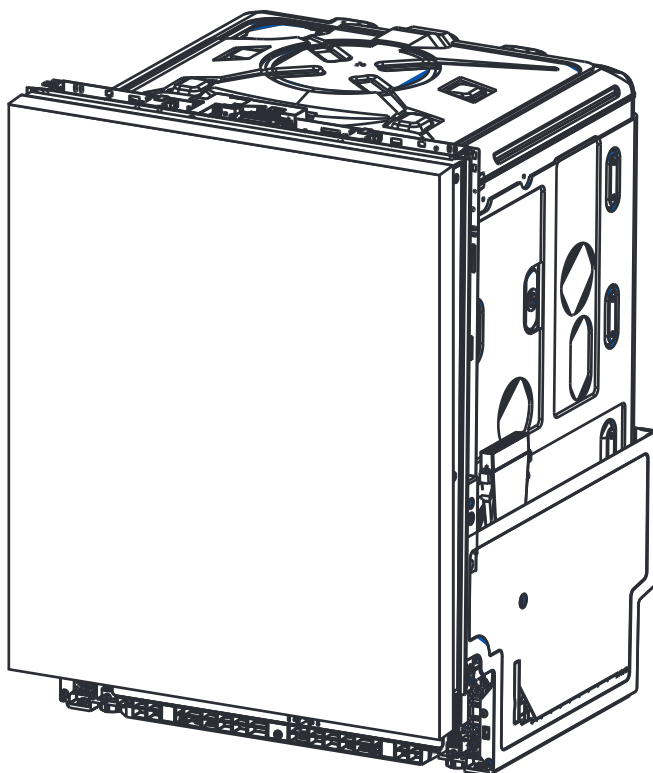

5 Attaching custom door panel

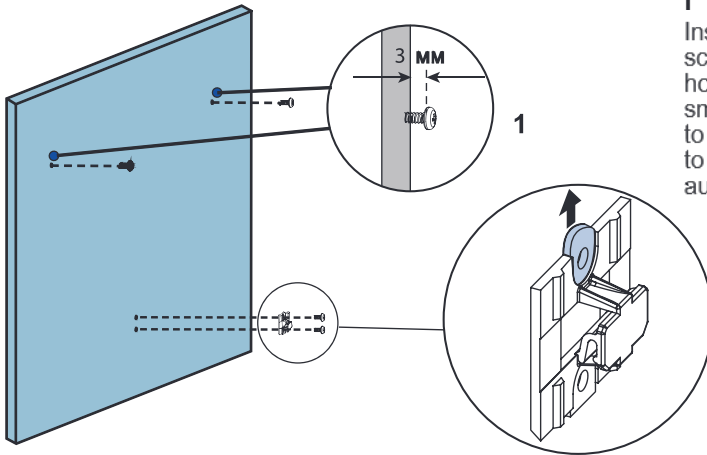

- 1**
Insert ST3.9 x 13mm screws through pilot holes and attach the small slider bracket to panel. (Please refer to the installation auxiliary page)

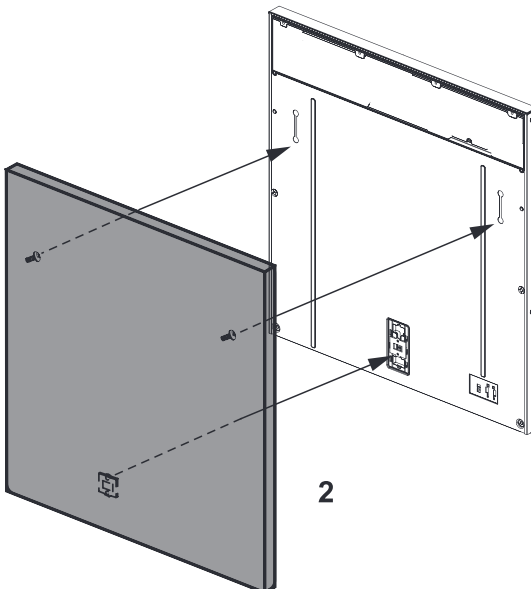

- 2**
Close the door of the dishwasher, then hang the custom panel onto the front of the door.