

# Sunco

Lighting made better.

User Manual  
**5/6" LED 12W  
Disk Downlight**

SKU: DL\_DK56-12W

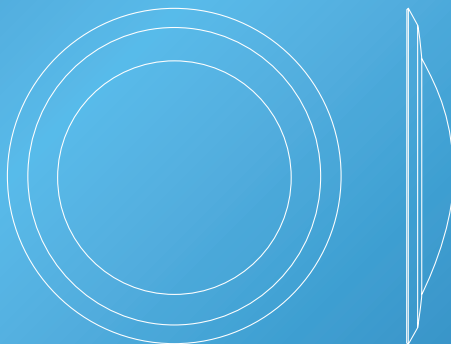

support@sunco.com  
(844) 334-9938



ETL CLASSIFIED



# What's in the Box?

## Disk Downlight

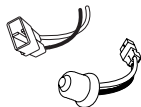
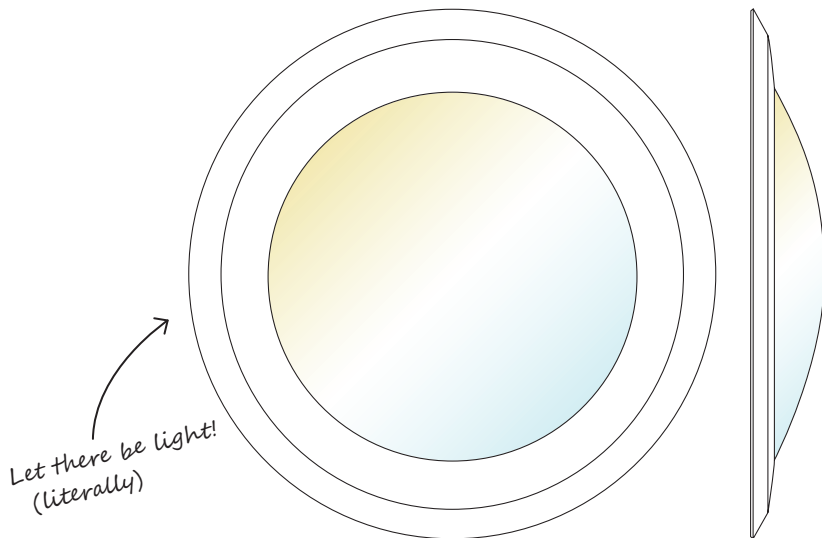

(a) **x1**

TP24/E26

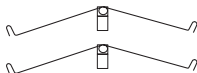

(b) **x2**

Spring Clips

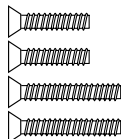

(c) **x4**

(Short / Long)  
Mounting Screws



(d) **x3**

Wire Nuts

# Before You Start

## Safety Information

### To reduce the risk of fire, electric shock, or physical injury:

- Turn off circuit breaker before installing this fixture.
- This product should be installed by a person familiar with the construction and operation of the product the hazards involved. Safety eyeglasses and gloves are recommended.
- Abide by related regional and local laws or regulations.
- Proper grounding is required to ensure safety.
- Do not alter, relocate, or remove wiring during installation.
- Do not make or alter any open holes in wiring enclosure or electrical components during installation.
- Check for shipping damage before installing. If the product is damaged, do not use it.
- Keep fixture away from corrosive substances.
- Suitable for damp locations at temperature ranging from -4°F to 104°F. Not for use where directly exposed to water.
- Clean the fixture regularly to ensure proper operation. Do not clean with harsh solvents.
- Use safety precautions and abide by regional and local laws or regulations.
- This product is not compatible with 3rd party sensors.
- This product is not compatible with photo controls.
- This product is not compatible with occupancy sensors.
- This product is not compatible with timing devices.

**This device complies with Part 15 of the FCC rules.**

**Operation is subject to the following two conditions:**

- 1) This device may not cause harmful interference.**
- 2) This device must accept any interference that may cause undesired operation. Please review all instructions carefully prior to installation.**

### **WARNING:**

Cancer & Reproductive Harm- [www.P65Warnings.ca.gov](http://www.P65Warnings.ca.gov)

## Quickstart Guide

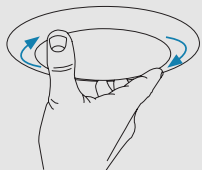

### Step 1

Remove the lens by twisting clockwise.

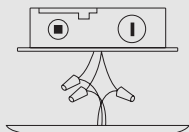

### Step 2

Connect supply & junction wires.

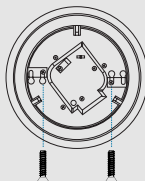

### Step 3

Attach fixture to junction box.

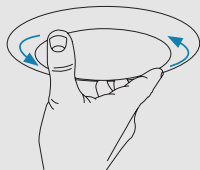

### Step 4

Twist lens counter clockwise.

# Installation Guide (Surface Mount)

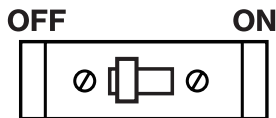

## STEP 1

- Turn off circuit breaker before installation.
- Remove the previous fixture.

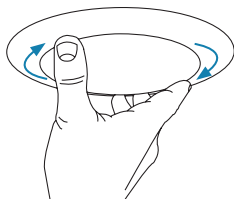

## STEP 2

Remove the lens by twisting clockwise.

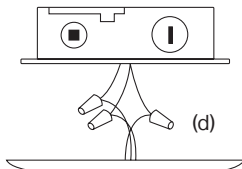

## STEP 3

- Connect the supply wires with junction box wires using provided wire nuts (d).
  - Black to Black (Live) • White to White (Neutral) • Green to Bare Copper (Ground)
- Tuck all wires inside the junction box.
  - White to White • Green to Green • Black to Black • Ground wire.

## Installation Guide (Cont.)

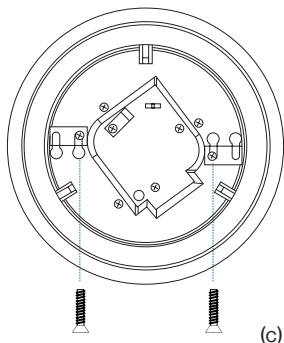

### STEP 4

- Tuck all wires inside the junction box.
- Determine appropriate mounting screw length (short or long) depending on the junction box size.
- Align mounting screws (c) with keyhole slots. Tighten screws until light fixture is installed securely into place.

**Note:** Do NOT over-tighten.

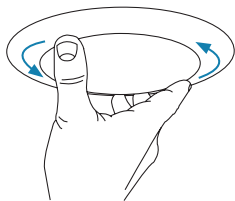

### STEP 5

- Once installed, insert lens back into place counterclockwise.
- Turn on circuit breaker to test light.

# Installation Guide (Retrofit Installation)

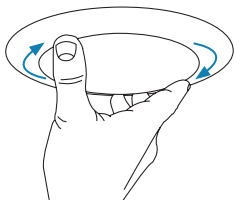

## STEP 1

a. Turn off circuit breaker before installation.

b. Remove the previous fixture.

**Note:** Light fixture may be hot! Allow time for fixture to cool after power is off.

c. Remove the lens by twisting clockwise.

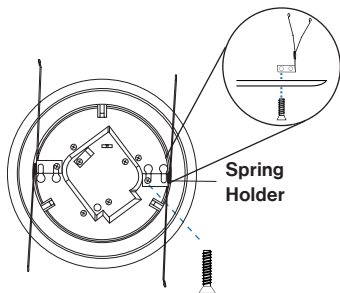

## STEP 2

a. Remove spring clips (B) from bag, then remove the screw attached to the spring clip.

b. Align spring clip (B) to selected keyhole slot, then tighten with screw from Step 2a on opposite end of keyhole slot.

**Note:** Make sure that both spring clip ears are pointing outwards for correct orientation.

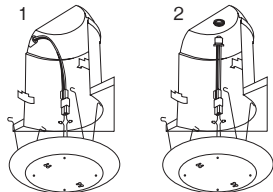

## STEP 3

a. Determine the type of connector available:

(1) TP24 Connector • (2) E26 Base

b. Connect light wires to the selected connector with provided wire nuts (d).

c. Connect disk light to connector or socket into recessed can.  
Attach ground wire to grounding screw inside can.

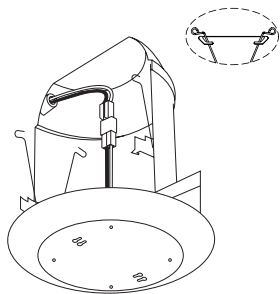

### STEP 4

- a. Push disk up into the can while pinching both spring clips into the can.
- b. Ensure the spring clips enter the hooks inside the can to secure disk into place.
- c. Push the light fixture into the can to install disk into ceiling.

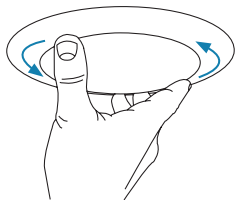

### STEP 5

- a. Once installed, insert lens back into place counterclockwise.
- b. Turn on circuit breaker to test light.

# Product Details

## Recommended Dimmers

Brand	Model
LEVITON	DW6HD-1BZ
LEVITON	DDL06-010-BLZ
LEVITON	DSL06-001-1LZ
LEVITON	IPL06-011-10Z
LEVITON	06674-002-10W
LEVITON	TSM10-012-1LW
TP LINK	Kasa Smart HS220

Scan for the full  
compatible dimmer list!



## Specifications

<b>Voltage</b>	120 V	<b>Average Lifetime</b>	50,000 Hours
<b>Wattage</b>	12 W	<b>Lumens</b>	850 lm
<b>Beam Angle</b>	113.8°	<b>Moisture Rating</b>	Damp Rated
<b>Efficacy</b>	70 lm/W	<b>CRI</b>	90+
<b>Power Factor</b>	0.7	<b>Usage</b>	Indoor
<b>Housing Material</b>	Fe+PC	<b>Amps</b>	130 mA
<b>Dimmable</b>	YES	<b>Warranty</b>	7 Years



# Common Troubleshooting

Feeling in the dark about an issue with your product? No worries! Our troubleshooting section is here to shed some light and provide you with easy-to-follow solutions for any problem.

If you still need some assistance, please feel free to contact us with any questions. Our team of lighting experts are happy to help brighten your day.

## Installation

Light isn't turning on.

Double check if fixture is properly connected and circuit breaker hasn't been tripped.

Light isn't bright enough.

Check proper wattage and for unobstructed fixture.

## Dimming

Light not dimming to lowest setting.

Ensure minimum dimmer load requirement is met.

Light not dimming smoothly.

Verify dimmer compatibility with fixture.

Light not compatible with dimmer switch.

Check light-dimmer compatibility. Consider purchasing compatible switch if necessary.

# Common Troubleshooting

## Flickering

Light is flickering when turning on.	Check that fixture wiring connections are secure.
Light flickering with other lights on the same circuit.	Check that the lights on the same circuit are not overloading the circuit.
Light flickering when turned on.	Verify fixture compatibility and that it is grounded.
Light flickering when dimmed.	Verify dimmer switch compatibility.

## Buzzing

Fixture buzzing with power outages.	Verify light is connected to surge protector securely.
Fixture buzzing with appliances or electronic devices.	Look for nearby interferences that can cause buzzing. Such as televisions, radios, computers, etc.
Fixture buzzing when dimmed.	Verify dimmer switch compatibility.

# Light Distribution Angle

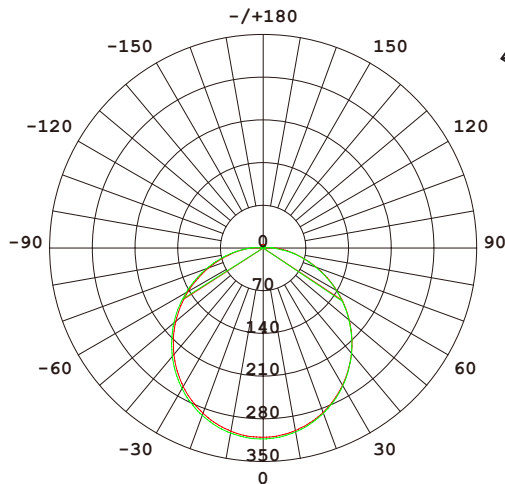

←  
*Not a lighting nerd?  
No worries, you can skip this page*

AVERAGE BEAM ANGLE (50%): 106.1°DEG

—	C0/180	106.2°
—	C90/270	106.0°

UNIT:cd    Luminous Intensity Distribution 1

Lighting distribution angle refers to the spread of light emitted from a light source. It is an important factor to consider when selecting a fixture or bulb, as it affects the way it will illuminate an area. There are two main types of lighting distribution angles:

A symmetric lighting distribution emits light evenly in all directions, creating a cone-shaped pattern that provides a pool of light. This type of lighting is ideal for general lighting and illuminating large areas. Common applications for symmetric lighting include general area illumination, security lighting, and perimeter lighting. Symmetric lighting is also used to a certain degree in up-lighting.

An asymmetric lighting distribution angle, also known as beam angle, creates a pattern that focuses light in a specific direction. This type of lighting is ideal for task lighting as it reduces glare and light spill in other areas. Common applications include task lighting in spaces such as landscape settings, retail stores, museums, and much more.

It is important to note that the lighting distribution angle can also be affected by other factors such as the reflector design of the light source, the type of lens used, and the distance between the light source and the surface being illuminated.

# Sunco

Lighting made better.

support@sunco.com  
(844) 334-9938

REV10