



# Instruction Manual

## Road Rescue Car Carrier





**VTech understands that a child's needs and abilities change as they grow and with that in mind we develop our toys to teach and entertain at just the right level...**

**vtech** 

**Toys that will stimulate their interest in different textures, sounds and colours**

**I am...**

...responding to colours, sounds and textures

...understanding cause and effect

...learning to touch, reach, grasp, sit-up, crawl and toddle

**Birth-36 months**



**Pre-School**

**Interactive toys to develop their imagination and encourage language development**

**I want...**

...to get ready for school by starting to learn the alphabet and counting

...my learning to be as fun, easy and exciting as can be

...to show my creativity with drawing and music so my whole brain develops

**3-6 years**

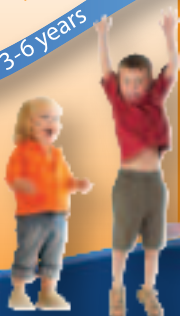

**Electronic Learning Computers**

**Cool, aspirational and inspiring computers for curriculum related learning**

**I need...**

...challenging activities that can keep pace with my growing mind

...intelligent technology that adapts to my level of learning

...National Curriculum based content to support what I'm learning at school

**4-10 years**



To learn more about this and other VTech® products, visit [www.vtech.co.uk](http://www.vtech.co.uk)



# INTRODUCTION

Thank you for purchasing the **Road Rescue Car Carrier**! Speedy cars have everything they need in one place with this car carrier. Load the cars with the handy ramp, give them a quick repair and travel in style to the next racing event.

Repair Centre



Race Ramp



Ramp  
Button

Music  
Button

3 Tool Buttons



Off/On Switch



Sports Car



Racing Car



# INCLUDED IN THE PACKAGE

- Road Rescue Car Carrier
- 2 Cars
- Sticker Sheet
- Quick Start Guide

## WARNING

All packing materials such as tape, plastic sheets, packaging locks, removable tags, cable ties, cords and packaging screws are not part of this toy and should be discarded for your child's safety.

## NOTE

Please save this Instruction Manual as it contains important information.

## Unlock the Packaging Locks:

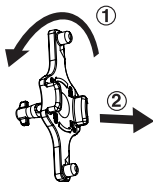
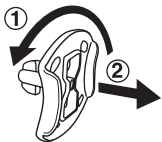

- ① Rotate the packaging locks 90 degrees anticlockwise.
- ② Pull out and discard the packaging locks.



# GETTING STARTED

## BATTERY REMOVAL AND INSTALLATION

1. Make sure the unit is turned **Off**.
2. Locate the battery cover on the bottom of the car carrier. Use a screwdriver to loosen the screw and then open the battery cover.
3. If present, remove old batteries by pulling up on one end of each battery.
4. Install 2 new AAA (AM-4/LR03) batteries following the diagram inside the battery box. (For best performance, alkaline batteries or fully charged Ni-MH rechargeable batteries are recommended).
5. Replace the battery cover and tighten the screw to secure.



### **WARNING:**

Adult assembly required for battery installation.

Keep batteries out of reach of children.



## **IMPORTANT: BATTERY INFORMATION**

- Insert batteries with the correct polarity (+ and -).
- Do not mix old and new batteries.
- Do not mix alkaline, standard (carbon-zinc) or rechargeable batteries.
- Only batteries of the same or equivalent type as recommended are to be used.
- Do not short-circuit the supply terminals.
- Remove batteries during long periods of non-use.
- Remove exhausted batteries from the toy.
- Dispose of batteries safely. Do not dispose of batteries in fire.

### **RECHARGEABLE BATTERIES:**

- Remove rechargeable batteries (if removable) from toy before charging.
- Rechargeable batteries are only to be charged under adult supervision.
- Do not charge non-rechargeable batteries.



## Disposal of batteries and product



The crossed-out wheeled bin symbols on products and batteries, or on their respective packaging, indicates they must not be disposed of in domestic waste as they contain substances that can be damaging to the environment and human health.



The chemical symbols Hg, Cd or Pb, where marked, indicate that the battery contains more than the specified value of mercury (Hg), cadmium (Cd) or lead (Pb) set out in the Batteries and Accumulators Regulation.

The solid bar indicates that the product was placed on the market after 13th August, 2005.

 Please dispose of your product and batteries responsibly.

In the UK, give this toy a second life by disposing of it at a small electricals collection point\* so all of its materials can be recycled.

Learn more at:

[www.vtech.co.uk/recycle](http://www.vtech.co.uk/recycle)

[www.vtech.com.au/sustainability](http://www.vtech.com.au/sustainability)

\* Visit [www.recyclenow.com](http://www.recyclenow.com) to see a list of collection points near you.



# LABEL APPLICATION

Please stick the labels to the vehicles as shown:

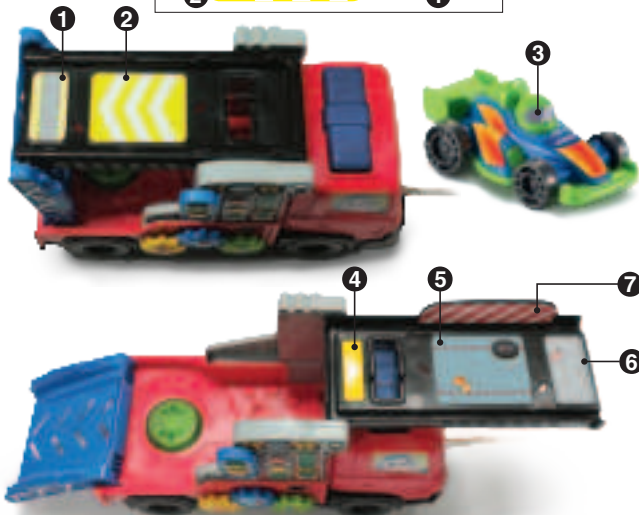
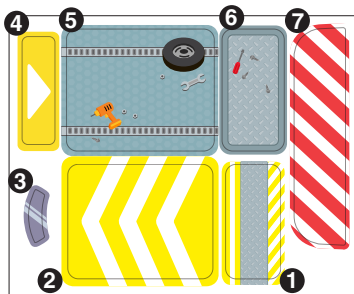



# PRODUCT FEATURES

## 1. Off/On Switch

To turn the unit **On**, slide the **Off/On Switch** to **On**  position. You will hear an opening tune, phrases and a playful song. To turn the unit **Off**, slide the **Off/On Switch** to the **Off** ● position.



## 2. Pull Cord

To convert the **Road Rescue Car Carrier** from a push toy to a pull toy, remove the pull cord from the battery compartment and thread it through the eyelet on the bottom of the car carrier. For your child's safety we suggest you store the pull cord in the compartment until your child is walking and to supervise your child when playing with the pull cord.

## 3. Automatic Shut-Off

To conserve battery life, the **Road Rescue Car Carrier** automatically powers off after 40 seconds of inactivity. You can reactivate the car carrier by pressing any button.

## NOTE

If the unit powers down or if the light fades out during play, please install a new set of batteries.



# ACTIVITIES

## 1. Tool Buttons

Press any **Tool Button** to discover the tool's name, hear tool sounds, enjoy playful phrases, and listen to music. Lights will flash along with the sounds.



## 2. Music Button

Press the **Music Button** or place and press on a vehicle on the back of the car carrier to hear playful phrases, fun sounds, and music.



## 3. Ramp

Flip the **Ramp** to create a repair platform. Enjoy fun sounds and phrases with flashing lights.





#### 4. **Ramp Button**

Push the **Ramp Button** to lower the ramp & trigger exciting sounds, phrases, and meet more fun characters. Lights will flash along with the sounds.





# MELODIES

1. Yankee Doodle
2. Glow Worm
3. MacNamara's Band
4. Skip to my Lou
5. Aiken Drum
6. Rockin' Robin
7. On Top of Old Smokey
8. Riddle Song
9. Take Me Out to the Ball Game
10. Toyland

# SONG LYRICS

## Song 1

With my super ramp,  
I load and transport cars!  
Driving on the road,  
Delivering near and far!

## Song 2

Spin, spin, spin goes the drill,  
Repairing cars with all of our skill!

## Song 3

Twisting and turning,  
With the screwdriver.  
We'll tighten and loosen the screws!

## Song 4

Tap, tap, tapping the nails,  
Use the hammer, to never fail!



## CARE & MAINTENANCE

1. Keep the unit clean by wiping it with a slightly damp cloth.
2. Keep the unit out of direct sunlight and away from any direct heat sources.
3. Remove the batteries if the unit will not be in use for an extended period of time.
4. Do not drop the unit on hard surfaces and do not expose the unit to moisture or water.

## TROUBLESHOOTING

If for some reason the unit stops working or malfunctions, please follow these steps:

1. Turn the unit **Off**.
2. Interrupt the power supply by removing the batteries.
3. Let the unit stand for a few minutes, then replace the batteries.
4. Turn the unit **On**. The unit should now be ready to use again.
5. If the unit still does not work, install a new set of batteries.

If the problem persists, please contact our Consumer Services Department, and a service representative will be happy to help you.



# CONSUMER SERVICES

Creating and developing **VTech®** products is accompanied by a responsibility that we at **VTech®** take very seriously. We make every effort to ensure the accuracy of the information, which forms the value of our products. However, errors sometimes can occur. It is important for you to know that we stand behind our products and encourage you to call our Consumer Services Department with any problems and/or suggestions that you might have. A service representative will be happy to help you.

## **UK Customers:**

Phone: 0330 678 0149 (from UK) or +44 330 678 0149 (outside UK)  
Website: [www.vtech.co.uk/support](http://www.vtech.co.uk/support)

## **Australian Customers:**

Phone: 1800 862 155  
Website: [support.vtech.com.au](http://support.vtech.com.au)

## **NZ Customers:**

Phone: 0800 400 785  
Website: [support.vtech.com.au](http://support.vtech.com.au)

# PRODUCT WARRANTY/ CONSUMER GUARANTEES

## **UK Customers:**

Read our complete warranty policy online at [vtech.co.uk/warranty](http://vtech.co.uk/warranty).

## **Australian Customers:**

**VTECH ELECTRONICS (AUSTRALIA) PTY LIMITED –  
CONSUMER GUARANTEES**

Under the Australian Consumer Law, a number of consumer guarantees apply to goods and services supplied by VTech Electronics (Australia) Pty Limited. Please refer to [vtech.com.au/consumerguarantees](http://vtech.com.au/consumerguarantees) for further information.



**Visit our website for more  
information about our products,  
downloads, resources and more.**

***[www.vtech.co.uk](http://www.vtech.co.uk)***  
***[www.vtech.com.au](http://www.vtech.com.au)***

