

INSTRUCTION MANUAL

Smart Camera

You will need Nous Smart Home App. Scan the QR code or download it from [direct link](#)



Register with your mobile number/E-mail then login



Register

China +86



Mobile number/e-mail address

Obtain verification code

☒ I agree with [Service Agreement](#) and [Privacy Policy](#)

Configuration

- Power on the device
- Open the Nouis Smart app
- Register if you are not already
- Tap “Add Device” or the icon “+” in the top right corner
- Choose “Smart Camera” in the Device type
- Make sure the indicator is flashing quickly(if not, please hold the reset button for 5 seconds untill camera resets) and click “next step”

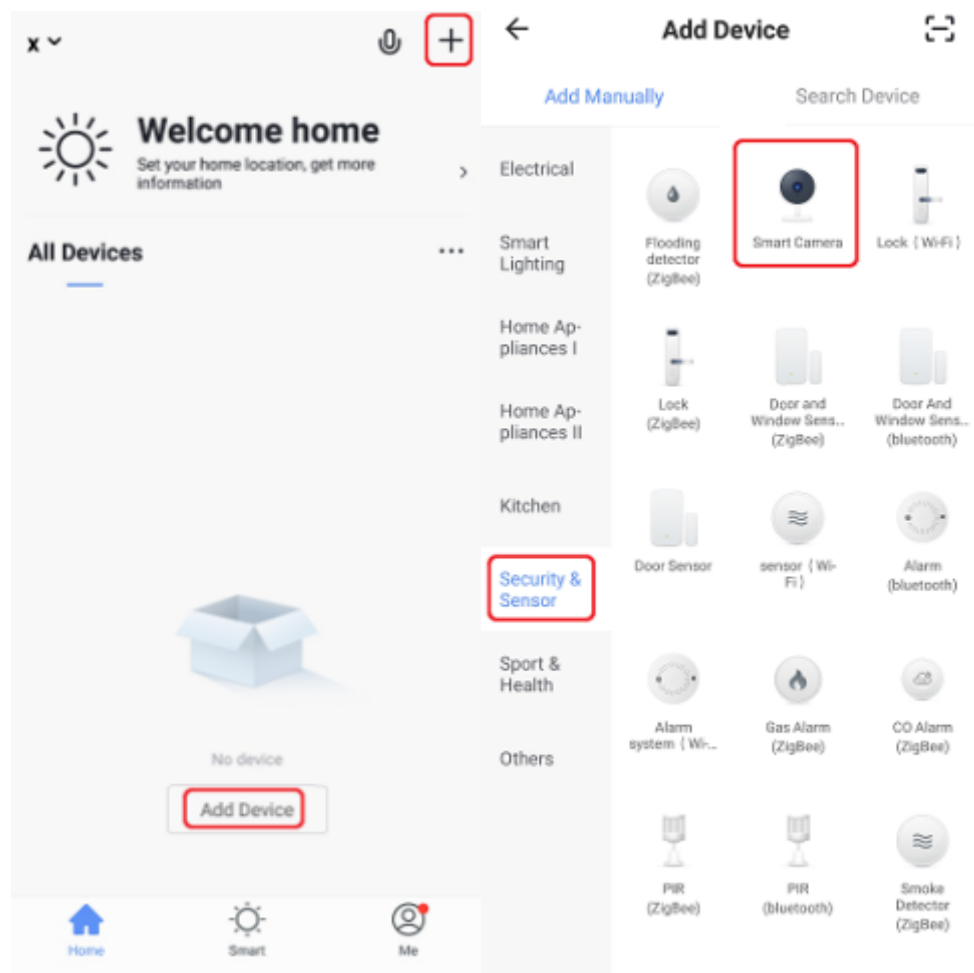

- Enter your WiFi password and Confirm it,
- When you tap Continue, the mobile phone will displays QR code,
- Hold the camera 15 to 20cm in front of the mobile phone untill the camera scan the QR code
- Click “heard the beep” and camera will start connenction

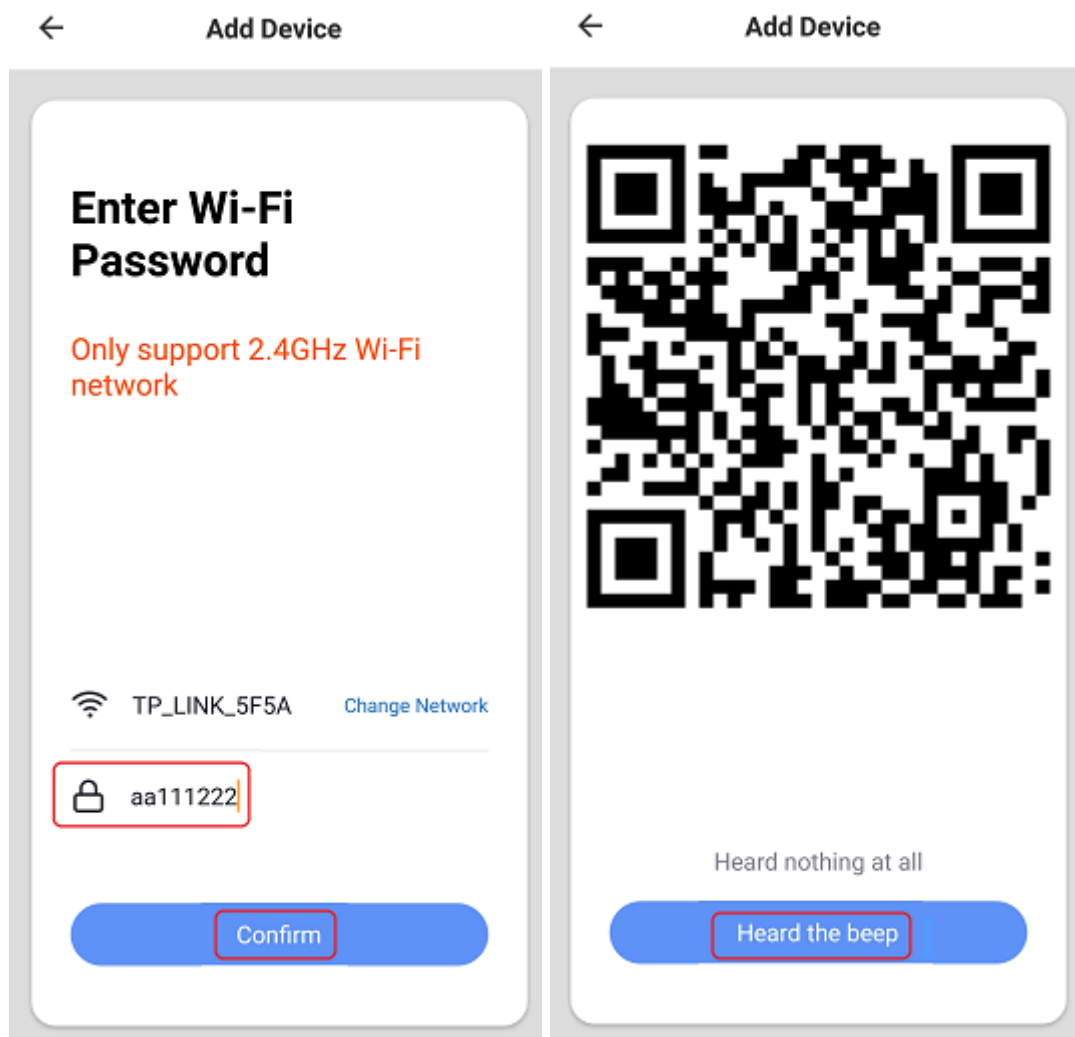

View the live stream

Choose a name for the device and click "Done" to view the live stream

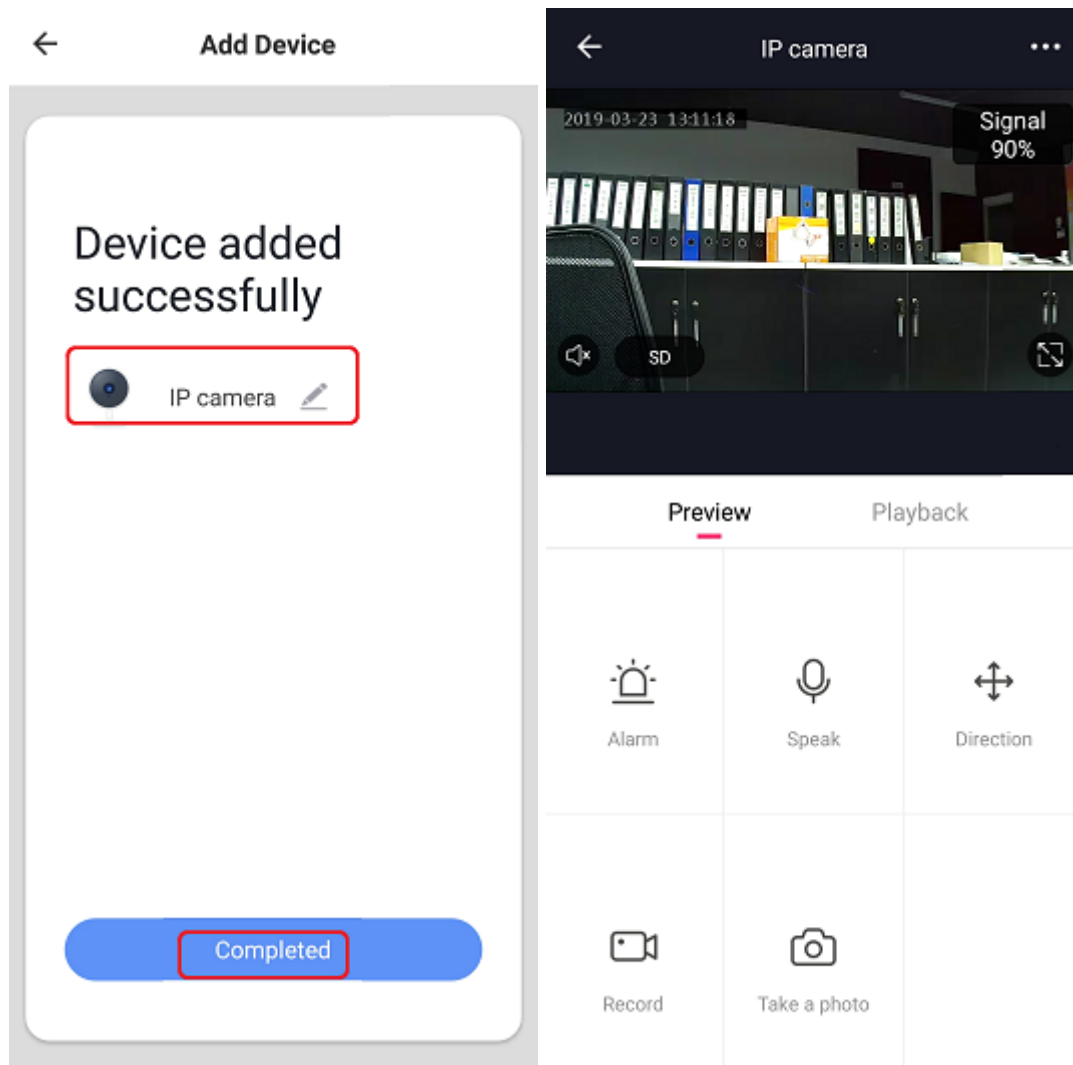

Acces from desktop

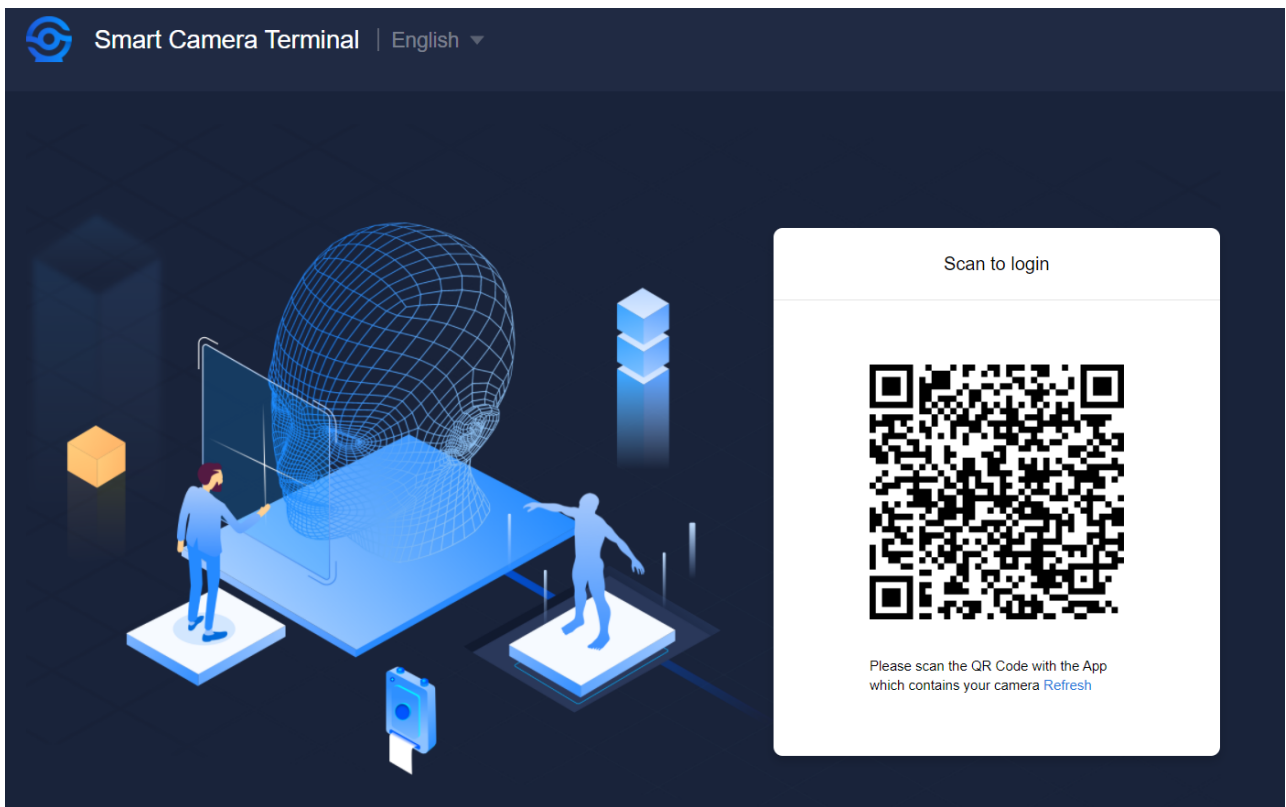

Go to this website: <https://ipc-eu.ismartlife.me/login>

Scan QR code from the screen and you will be able to watch live feed from your IP camera on desktop

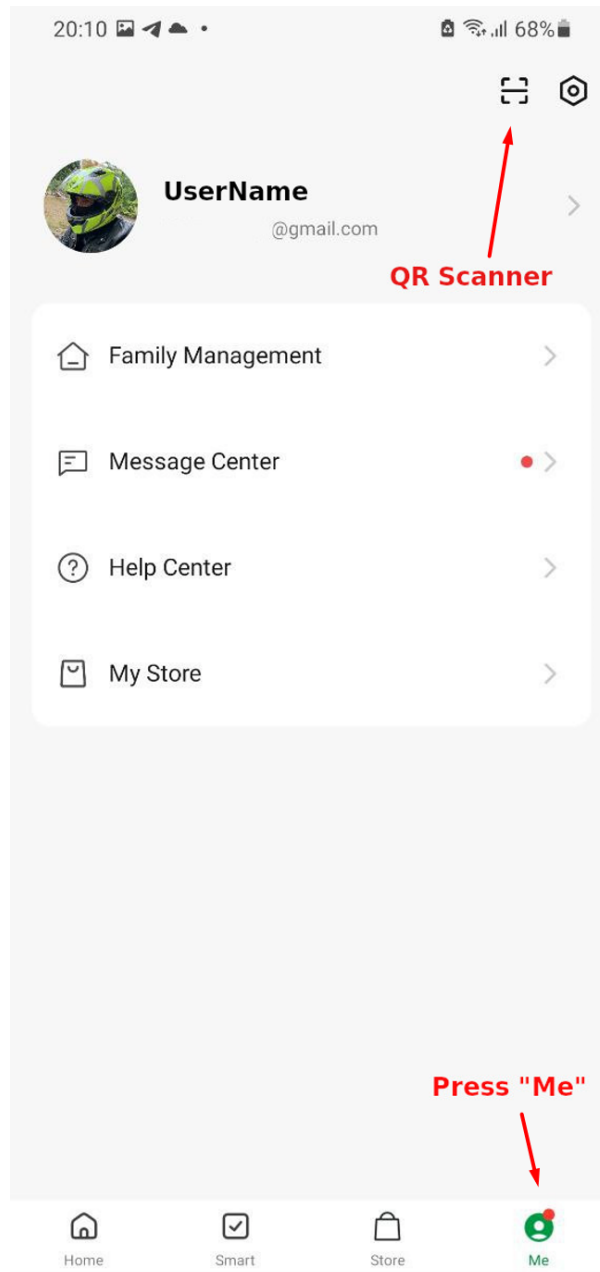

* This translation may be inaccurate because it was made with google translate service