

innex DC500

4K Visualizer / Document Camera

Quick Start Guide

Innex DC500 is a 2-in-1 document camera and webcam that features crystal clear 4K resolution, a noise-cancelling microphone, smart autofocus, and auto-rotation with its built-in G-sensor. It works out of the box with most UC software, such as Zoom, Google Meet, Microsoft Teams, Skype, and more. Ideao's complimentary software can help you enhance your lessons and presentations.

Download Ideao VisualCam and the IdeaoCam Chrome extension for digital zoom, snapshot, recording, annotation, Google account integration, and more.

For more information please visit:

Ideao VisualCam

<https://funtechinnovation.com/software/ideao-visualcam/>

IdeaoCam

<https://funtechinnovation.com/software/ideaocam/>

Package Contents

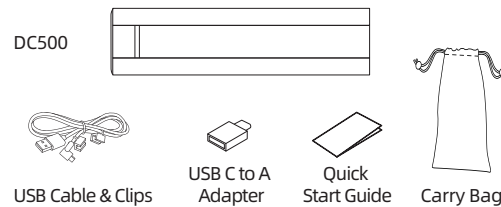

Getting started with DC500

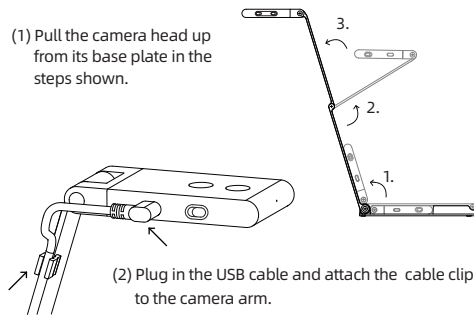

(3) Adjust the camera head until it is horizontal. Fully extend the arm to capture A3-sized content. After adjusting the camera to the desired position, press the focus button to trigger focus if auto-focus mode is off.

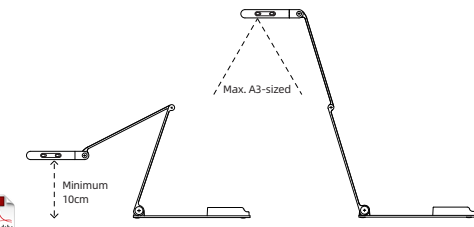

Auto Focus



Turn off Auto Focus mode when using the DC500 as a document camera for still objects such as document. When Auto Focus is off, auto focus is triggered only when the focus button "⊕" is pressed.

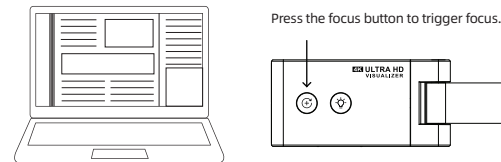

Turn on Auto focus mode when using the DC500 as a webcam. Always keep your face in focus. Or as a document camera that needs to capture dynamic movements.

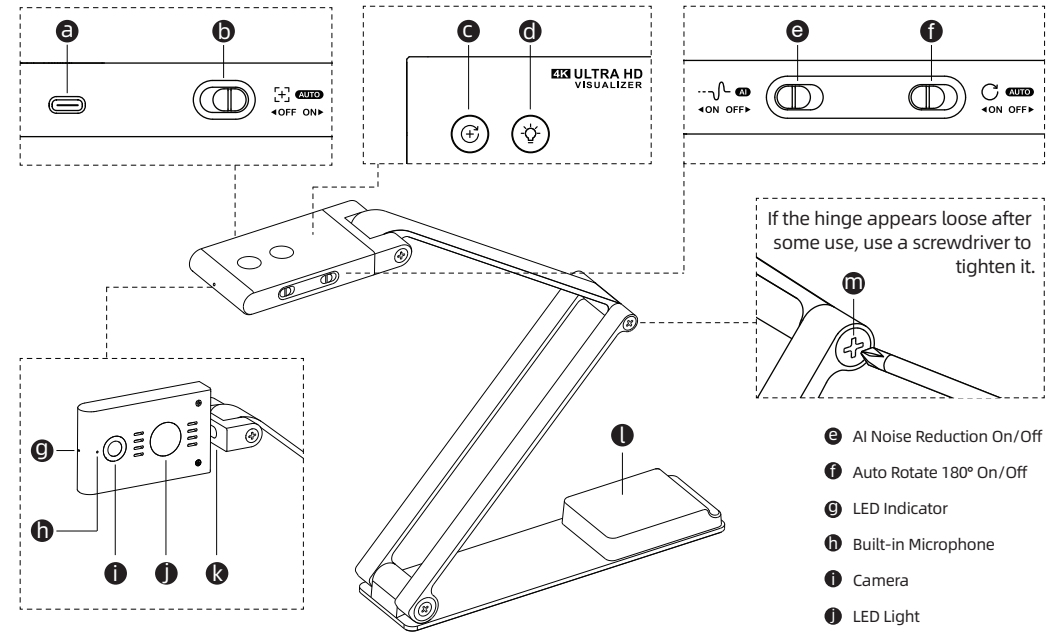
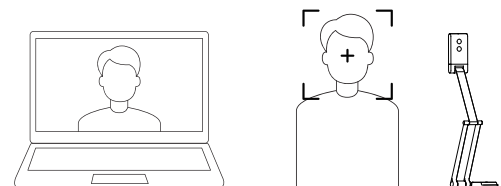

DC500 Overview

AI Noise Reduction

The AI-powered noise reduction mode is designed to filter out background noise, providing clear audio for effective communication and improving the quality of remote presentations and meetings.

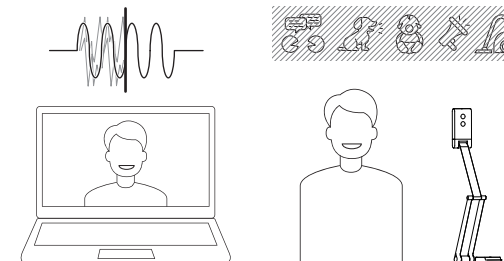
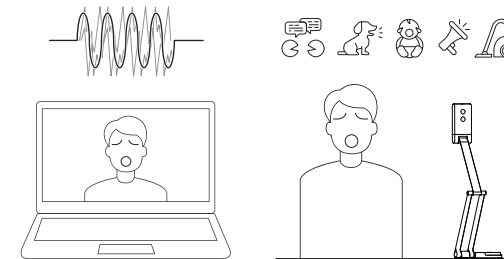

Auto Rotate 180°



When the Auto-Rotate mode is off, you can long press the button to trigger 180° rotation.

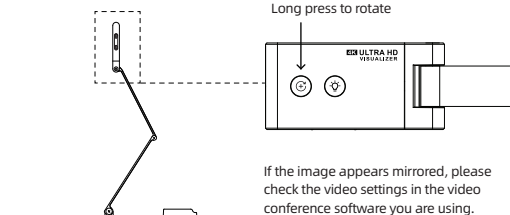

When the Auto-Rotate mode is on and you flip the camera head to the front-facing position, the Auto-Rotate mode will automatically rotate the view by 180°.

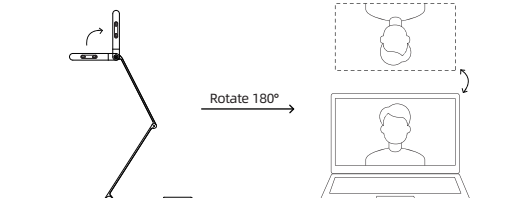

Caution

- Be careful not to pinch your fingers when moving the arm.
- Do not hold the arm or camera head when carrying the product.
- Avoid any impact to the camera head.

Specifications

Camera

Max. Output Resolution & Frame Rate	3840x2880 @15fps (To Capture A3 Image) 3840x2160 @30fps 1920x1080 @60fps
Video Compression	MJPEG / YUY2
Focus	Dual autofocus mode: On demand / Continuous
Minimum Focus Distance	10cm / 3.9"
Maximum Shooting Area	420x297mm / 16.5x11.7" (A3 size)
Viewing Angle	82°
Sensor	13 Megapixel 1/3" CMOS
F-Number	F2.2 ± 5%
G-Sensor	Yes
LED Lighting	Yes, 3 level
Pan / Tilt / Zoom	Yes, 10 digital zoom by software
Image Rotation	0° / 180° / Auto
Support Power Line Frequency	50/60 Hz

Micorphone

Built-in Microphone	Omnidirectional Microphone
Microphone Specifications	Sensitivity 5 94dB SPL @1KHz Min-29 Typ-26 Max-23 dBFS SNR 64dB
Voice Technology	Noise reduction and voice enhancement technology

Safety Information

Federal Communications Commission (FCC) Statement. This device complies with Part 15 of the FCC Rules. Operation is subject to the following two conditions: (1) this device may not cause harmful interference, and (2) this device must accept any interference received, including interference that may cause undesired operation.

This equipment has been tested and found to comply with the limits for a Class B digital device, pursuant to part 15 of the FCC Rules. These limits are designed to provide reasonable protection against harmful interference in a residential installation. This equipment generates, uses, and can radiate radio frequency energy and, if not installed and used in accordance with the instruction manual, may cause harmful interference to radio communications.

However, there is no guarantee that interference will not occur in a particular installation. If this equipment does cause harmful interference to radio or television reception, which can be determined by turning the equipment off and on, the user is encouraged to try to correct the interference by one or more of the following measures:

- Reorient or relocate the receiving antenna.
- Increase the separation between the equipment and receiver.
- Connect the equipment into an outlet on a circuit different from that to which the receiver is connected.
- Consult the dealer or an experienced radio/TV technician for help.



Precaution

Do not use/store the product in the following

- Near heat sources
- Near steam or greasy smoke
- Location with high humidity
- Sandy or dusty places

Others

Connectivity	USB Type C to Type A 2.0
Powered By	USB 2.0 5V/500mA
Protocol	UVC; UAC; Plug-and-play
Operating System	Windows 11, 10 macOS 10.15 or above Chrome OS
Product Dimensions	Extended (LxWxH): 397 x 51 x 337 mm / 15.6 x 2 x 13.3" Folded (LxWxH): 197 x 51 x 20 mm / 7.8 x 2 x 0.79"
Net Weight	409g/ 14.4 oz
Package Contents	DC500 Quick start guide , USB cable (USB Type C to A) , USB C to A Adapter Carry bag

Any changes or modifications not expressly approved by the party responsible for compliance could void the authority to operate equipment. This device and its antenna must not be co-located or operating in conjunction with any other antenna or transmitter. For product available in the USA/Canada market, only channel 1~11 can be operated. Selection of other channels is not possible.

UK

R&P

APEX CE SPECIALISTS LIMITED
89 PRINCESS STREET, MANCHESTER, M1 4HT, UK

EC

R&P

APEX CE SPECIALISTS LIMITED
UNIT 3D NORTH POINT HOUSE, NORTH POINT BUSINESS PARK,
NEW MALLOW ROAD, CORK, T23 AT2P, IRELAND

