

# INSTRUCTION MANUAL

Rev00(A)

---

**PIWFS02G**

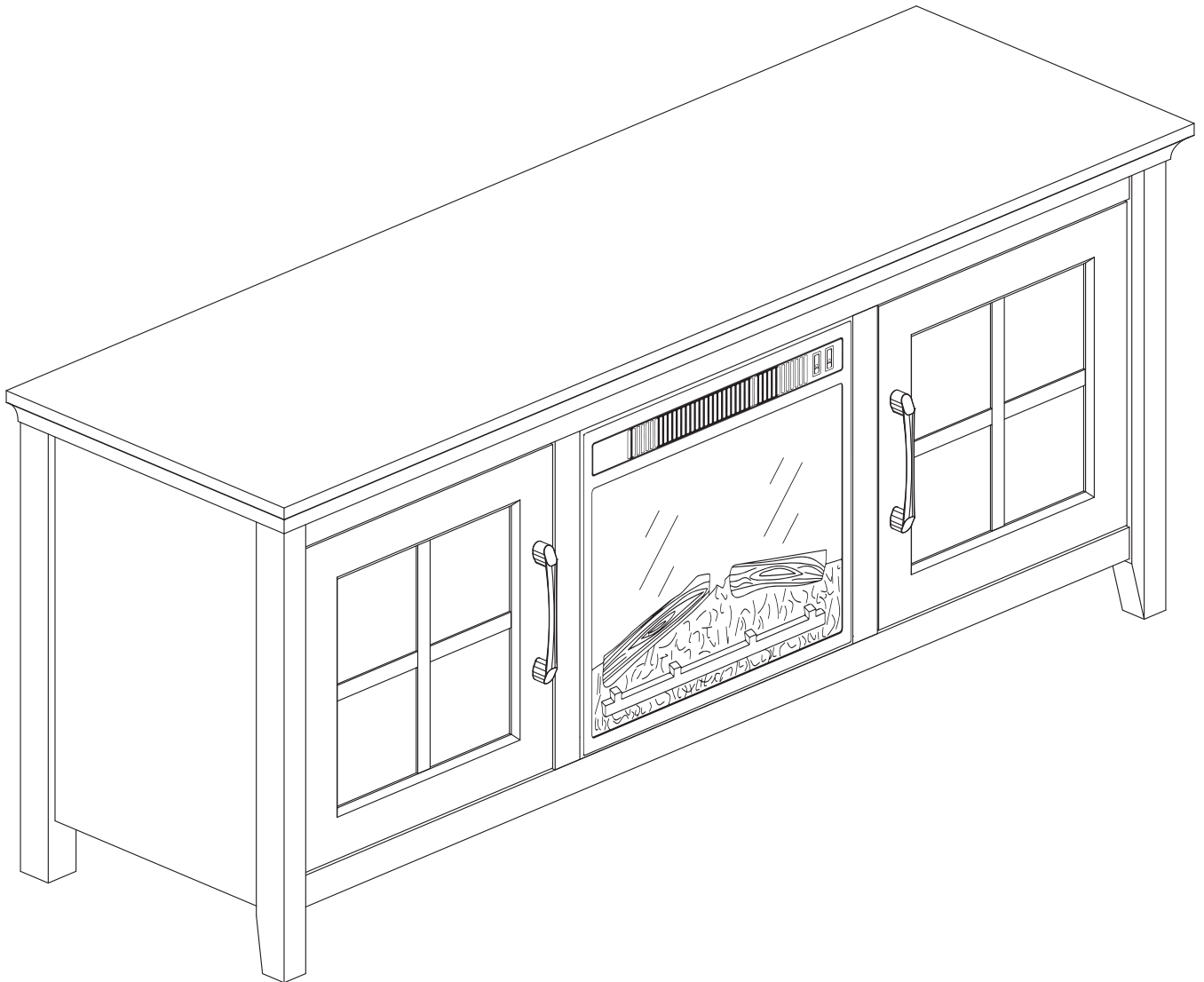

## Fireplace TV Stand



(US / CA) 1-800-556-9829

(UK) 44-808-196-3885



support@pipishell.net



www.pipishellav.com

---

## Important Safety Information

To assemble the product correctly, please read all instructions carefully before installation. If you have any questions or concerns, please contact our Technical Support at 1-800-556-9829 (US / CA), 44-808-196-3885 (UK) or Customer Service at support@pipishell.net.

This unit is not designed to be used with CRT TVs. Only use this stand with flat panel TVs and audio video equipment that meet the weight limits. Avoid the risk of personal injury or property damage. To ensure stability, place the TV in the center of the unit. The base of the TV must rest on the supporting surface of the unit without hanging over the edges.

To prevent the stand from tipping over, use the wall attachment device included with the product.

## Weight Restrictions

If your products weigh more than the listed maximum weights, this TV stand is not compatible with your system.

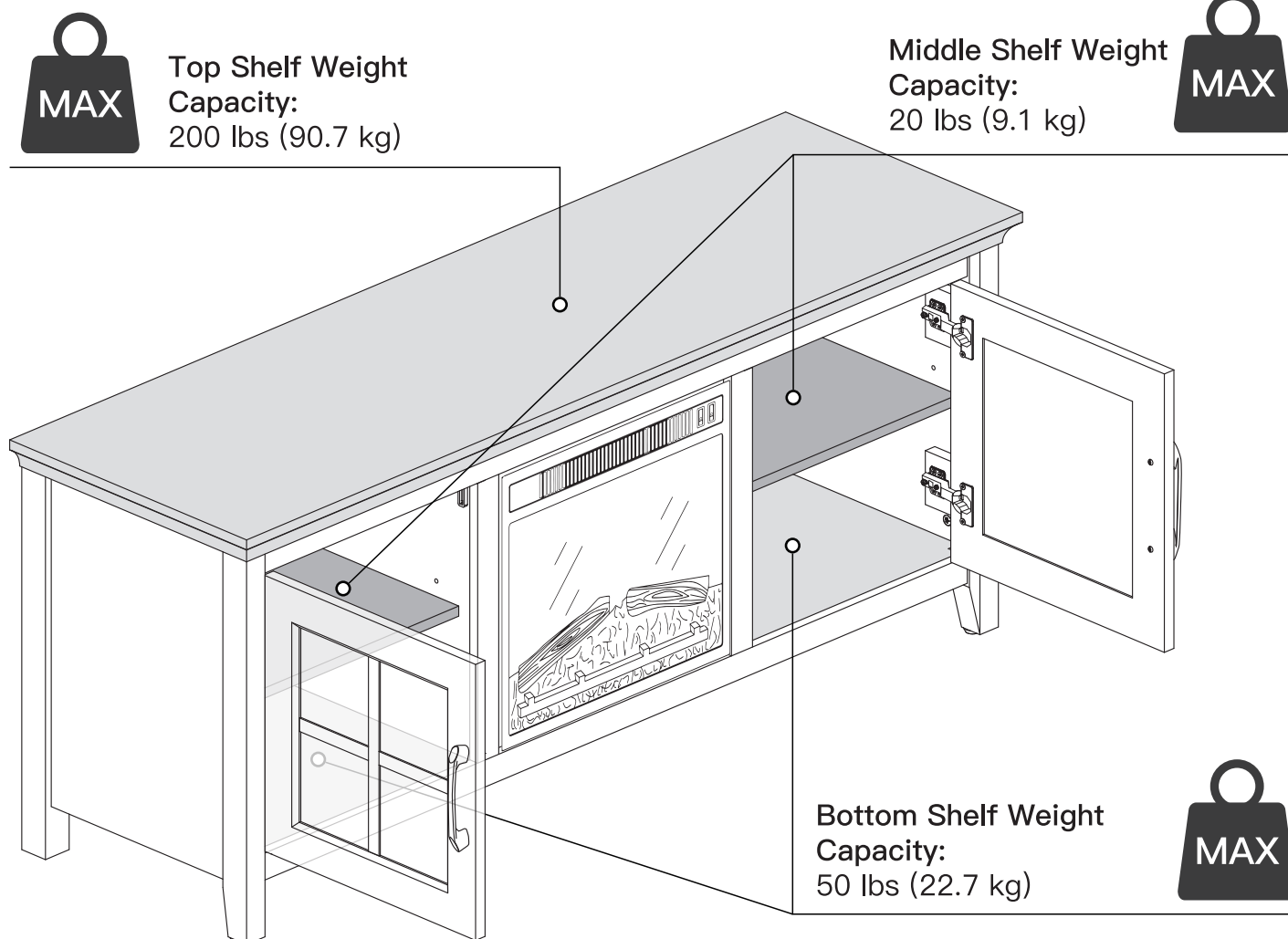

## Tools Needed (Not Included)

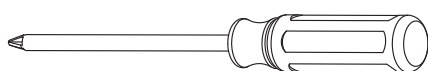

Phillips Screwdriver

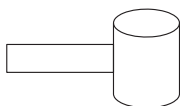

Rubber Mallet

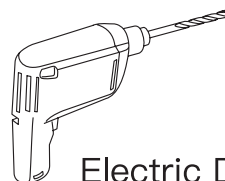

Electric Drill

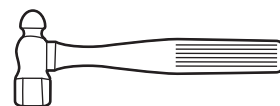

Hammer

## How the Assembly System Works

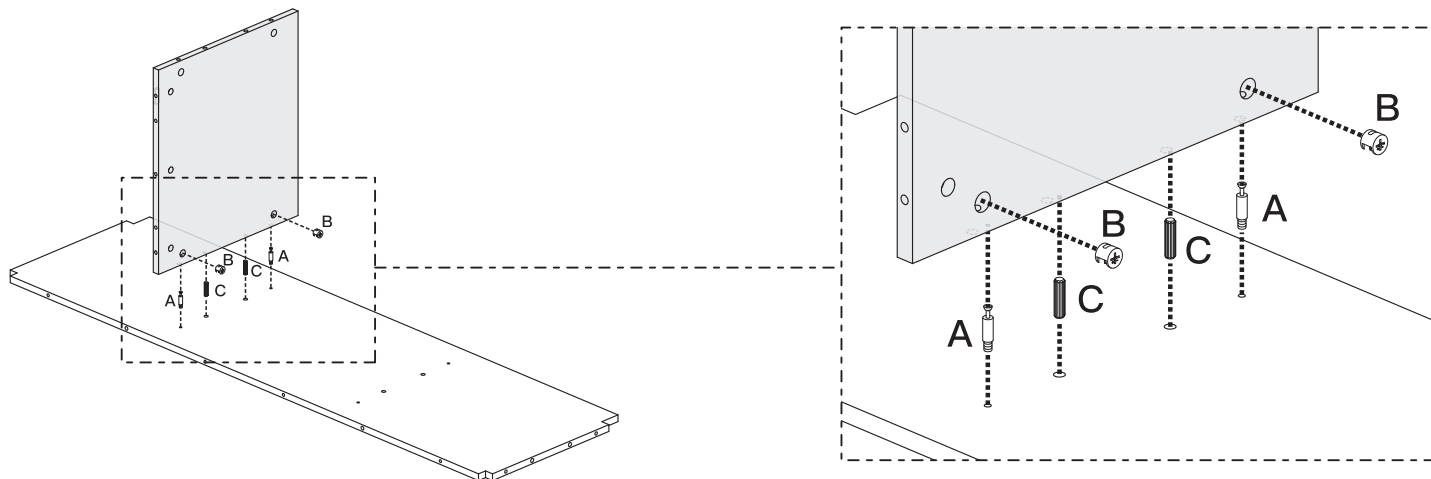

## How to Install Wood Dowel

Insert the wood dowel [C] at least half-way. IF NECESSARY, lightly tap the wood dowel with a self-supplied rubber mallet.

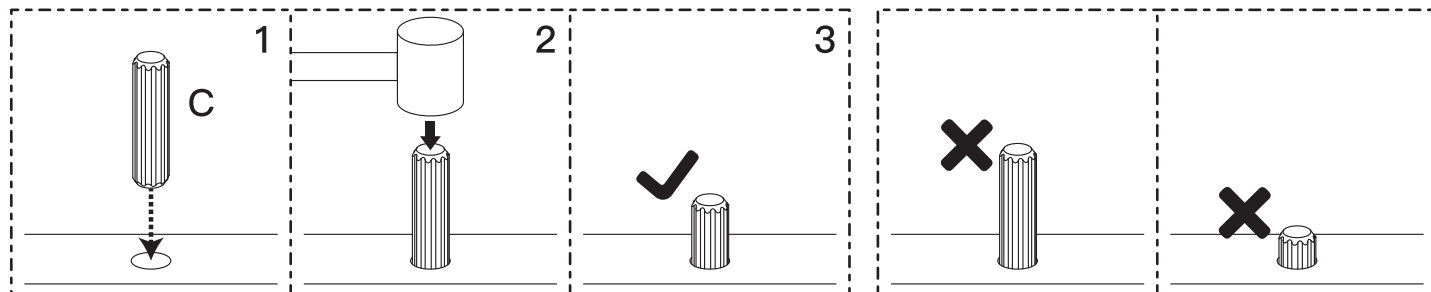

## Cam Lock System Operation

1. Screw the cam bolt [A] into the threaded insert on the panel.
2. Connect both panels together. Make sure cam bolt [A] goes into the small pre-drilled hole on the end of the panel.
3. Insert the cam lock [B] into the pre-drilled cam lock large hole on the panel. Make sure the open slot faces the head of the cam bolt [A].
4. Rotate the cam lock [B] clockwise with a self-supplied Phillips screwdriver to lock the cam bolt [A] in place.

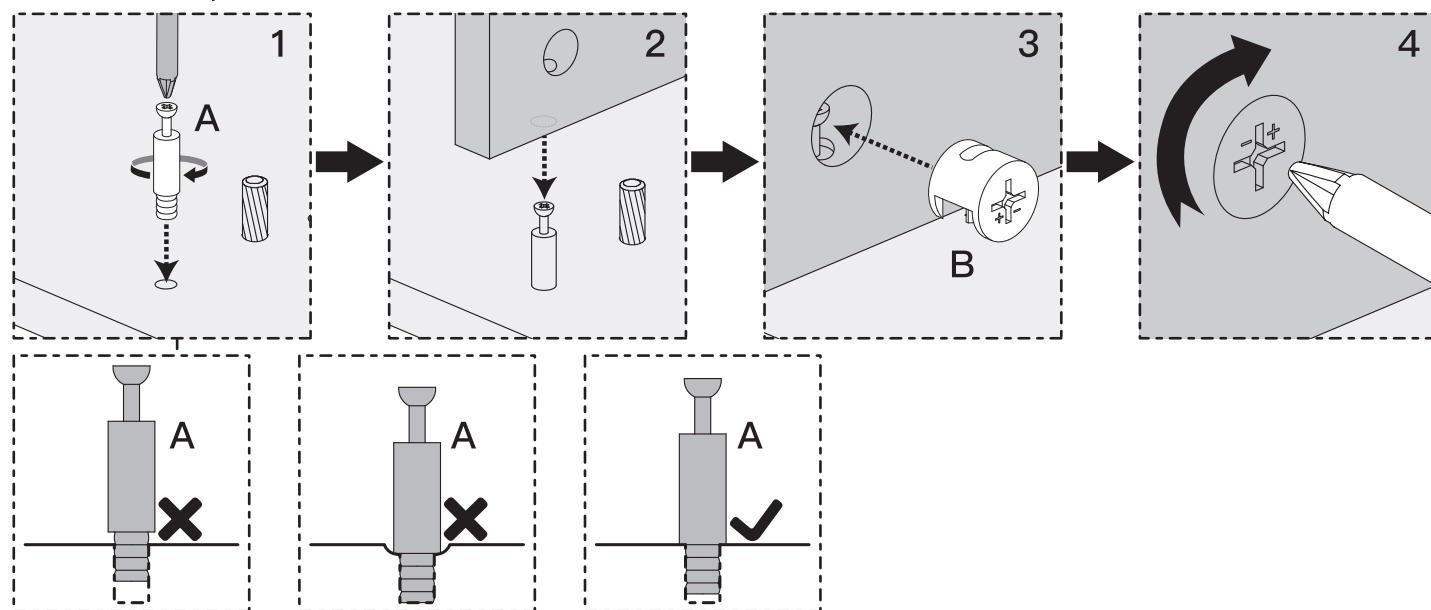

You are now ready to assemble the Fireplace TV Stand.

# Contents

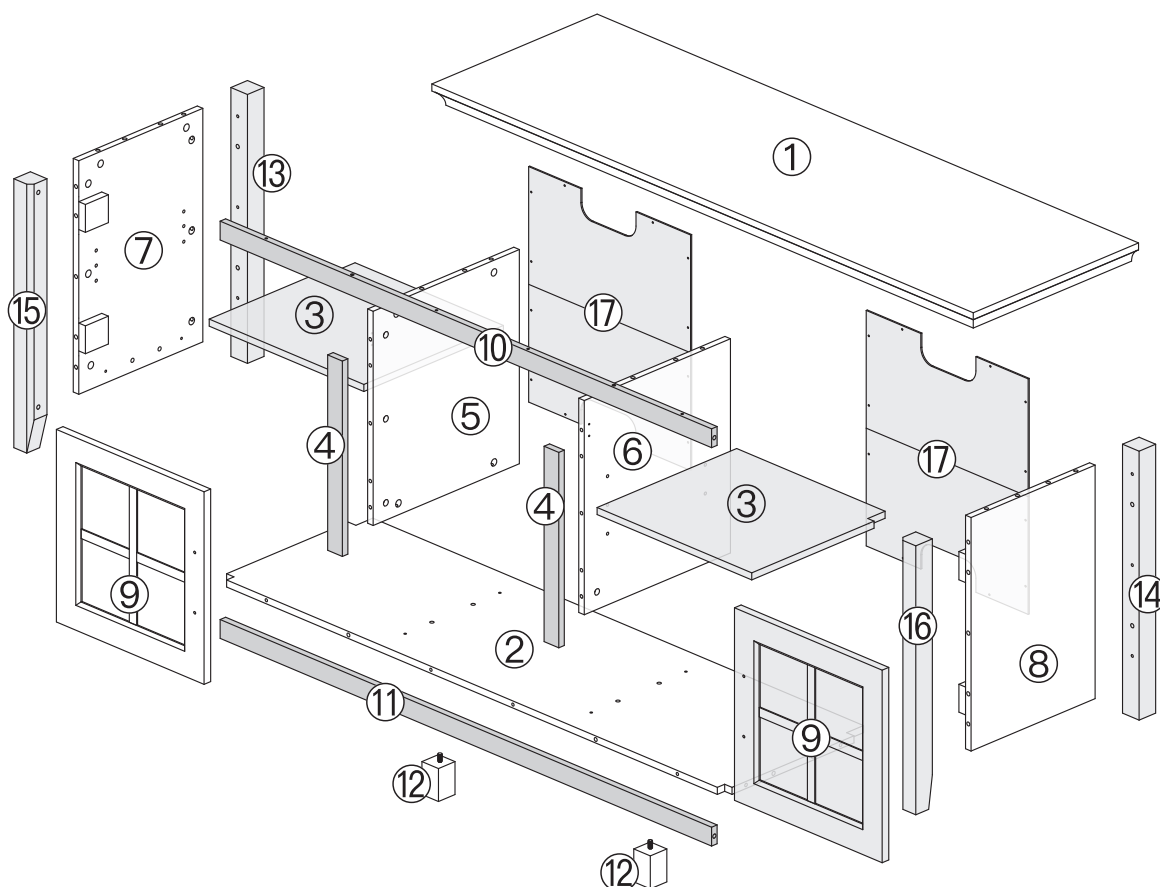

You may need assistance with this step.



Cam Bolt  
A x 38

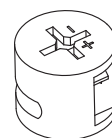

Cam Lock  
B x 38

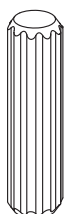

ø8\*30mm  
Wood Dowel  
C x 36

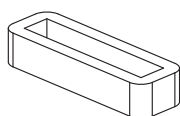

Door Stopper  
D x 2



3 x 12mm  
Screw  
E x 4

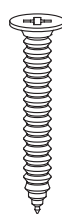

4 x 38mm  
Screw  
F x 4



3 x 12mm  
Screw  
G x 32



Shelf  
Support  
H x 8

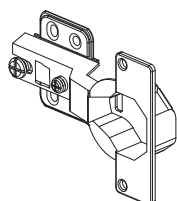

Door Hinge  
I x 4

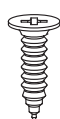

3.5 x 15mm  
Screw  
J x 24

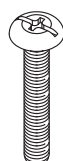

1/8" x 22mm  
Bolt  
K x 4

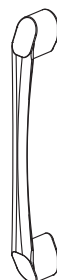

Door Handle  
L x 2

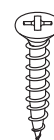

M x 2

STEP 1

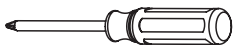
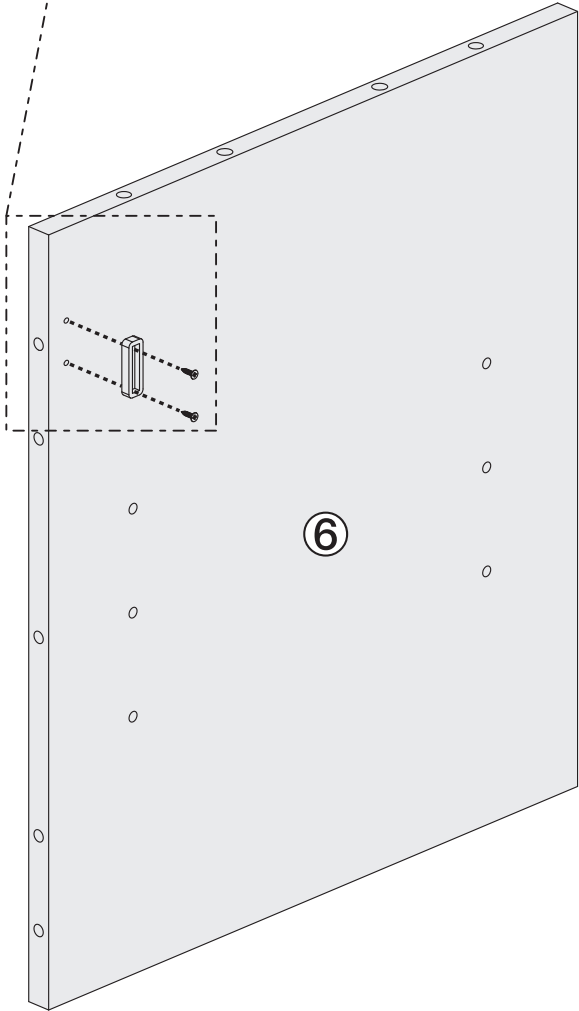
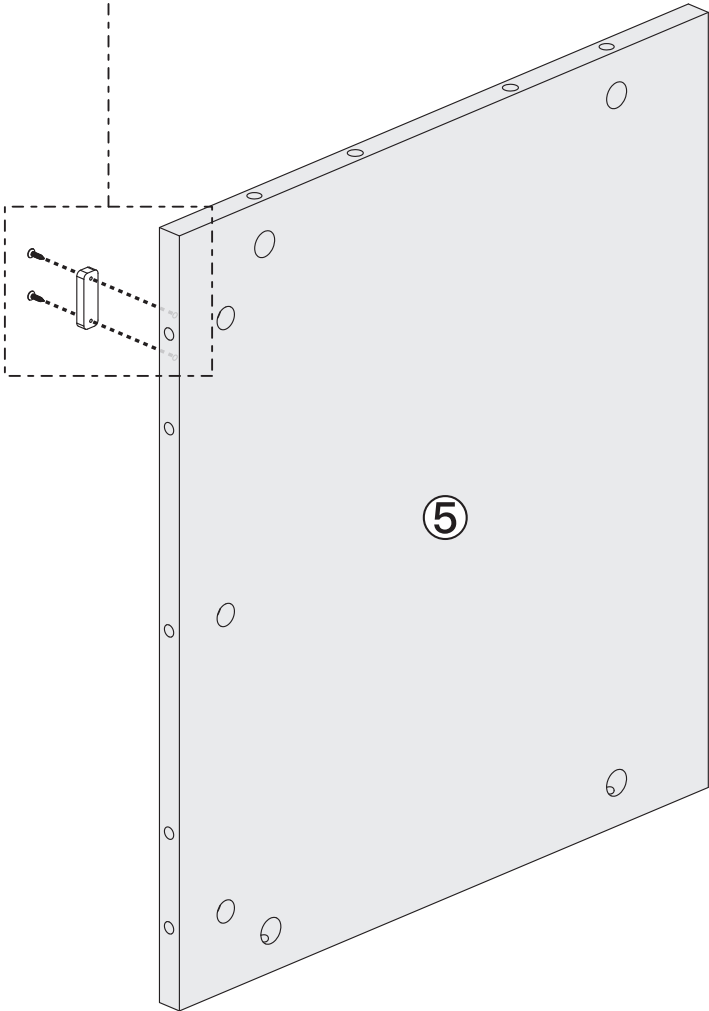
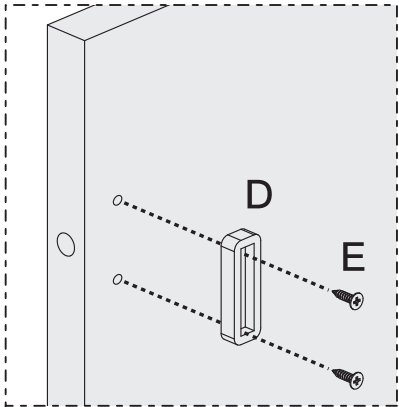
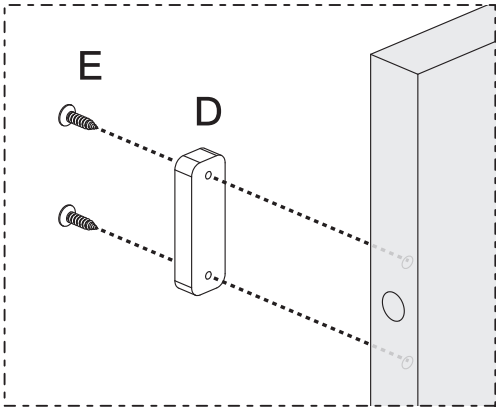

Phillips  
Screwdriver  
(Not Included)

D\*2 E\*4  
⑤\*1 ⑥\*1

## STEP 2

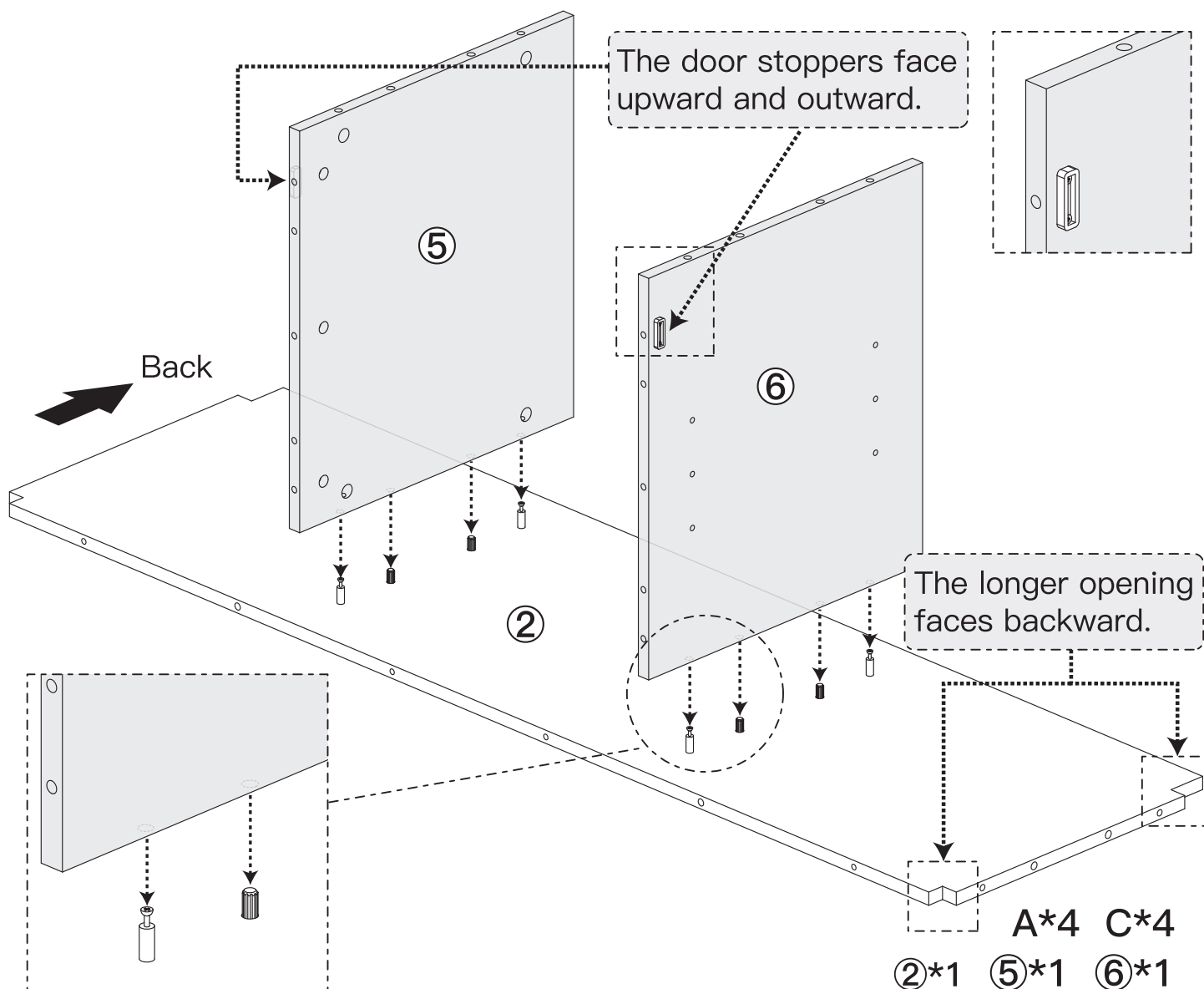
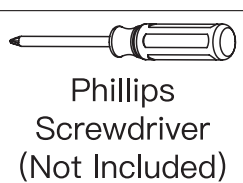
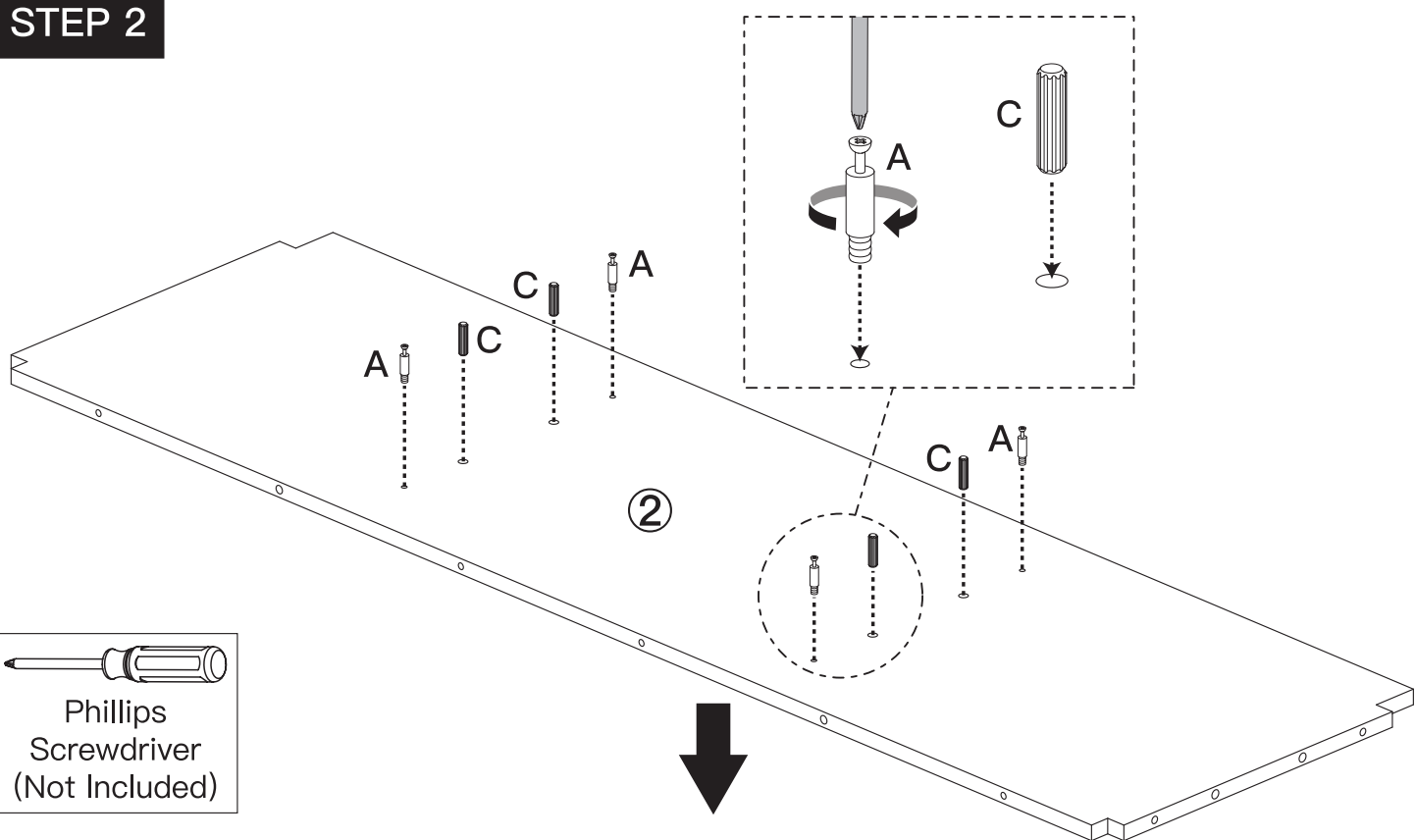

# STEP 3

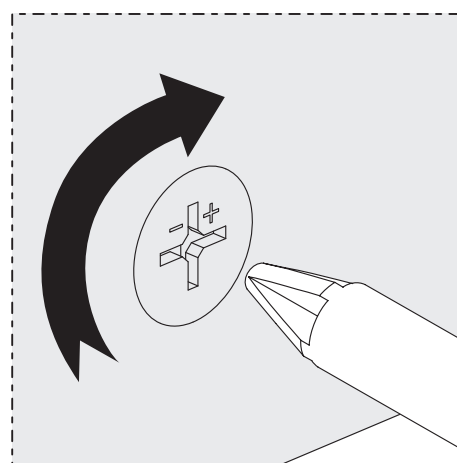
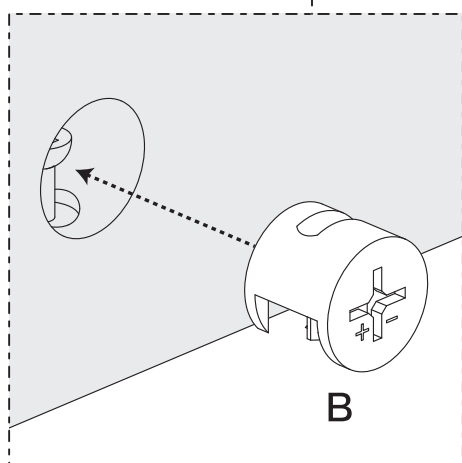
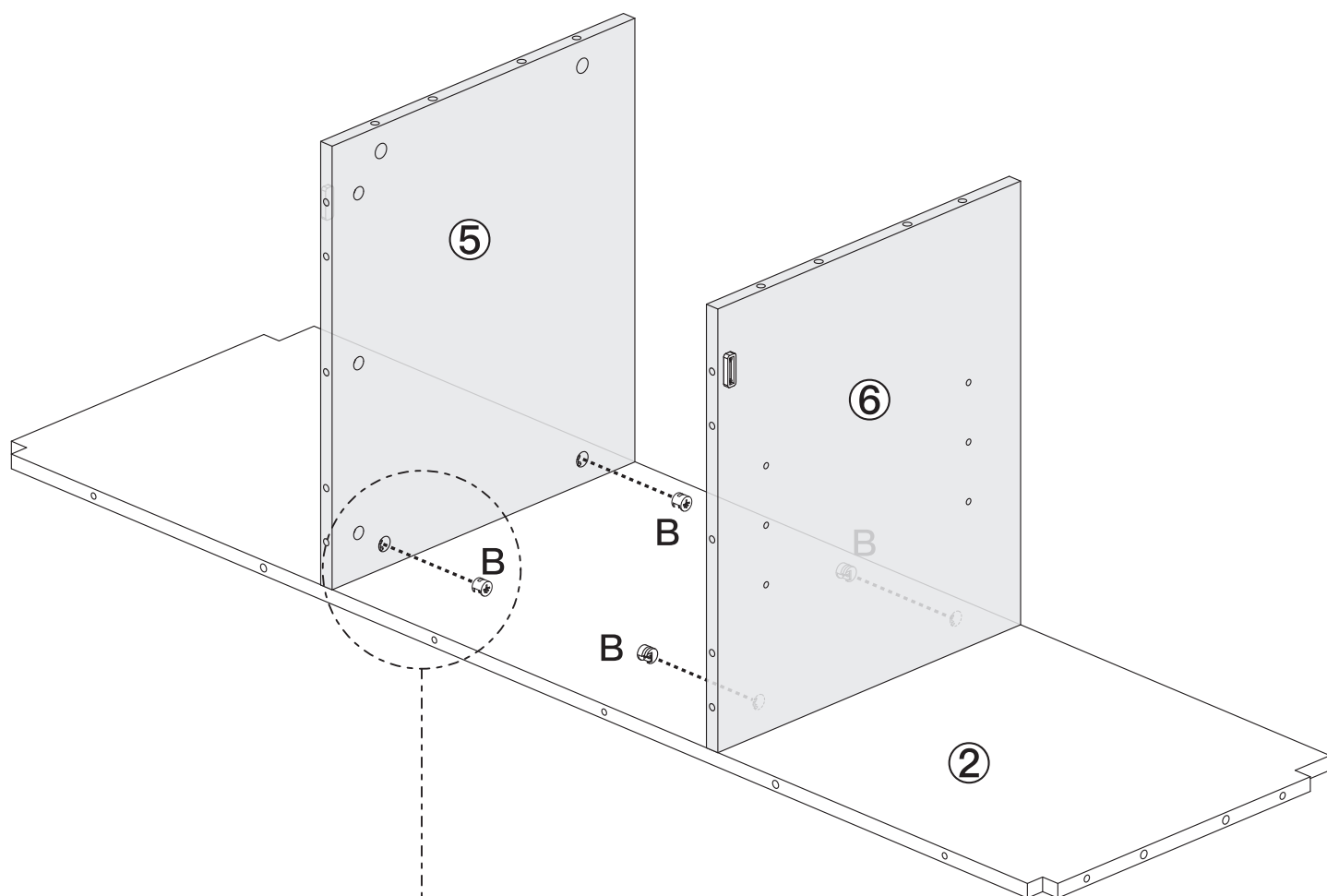

Phillips  
Screwdriver  
(Not Included)

B\*4

# STEP 4

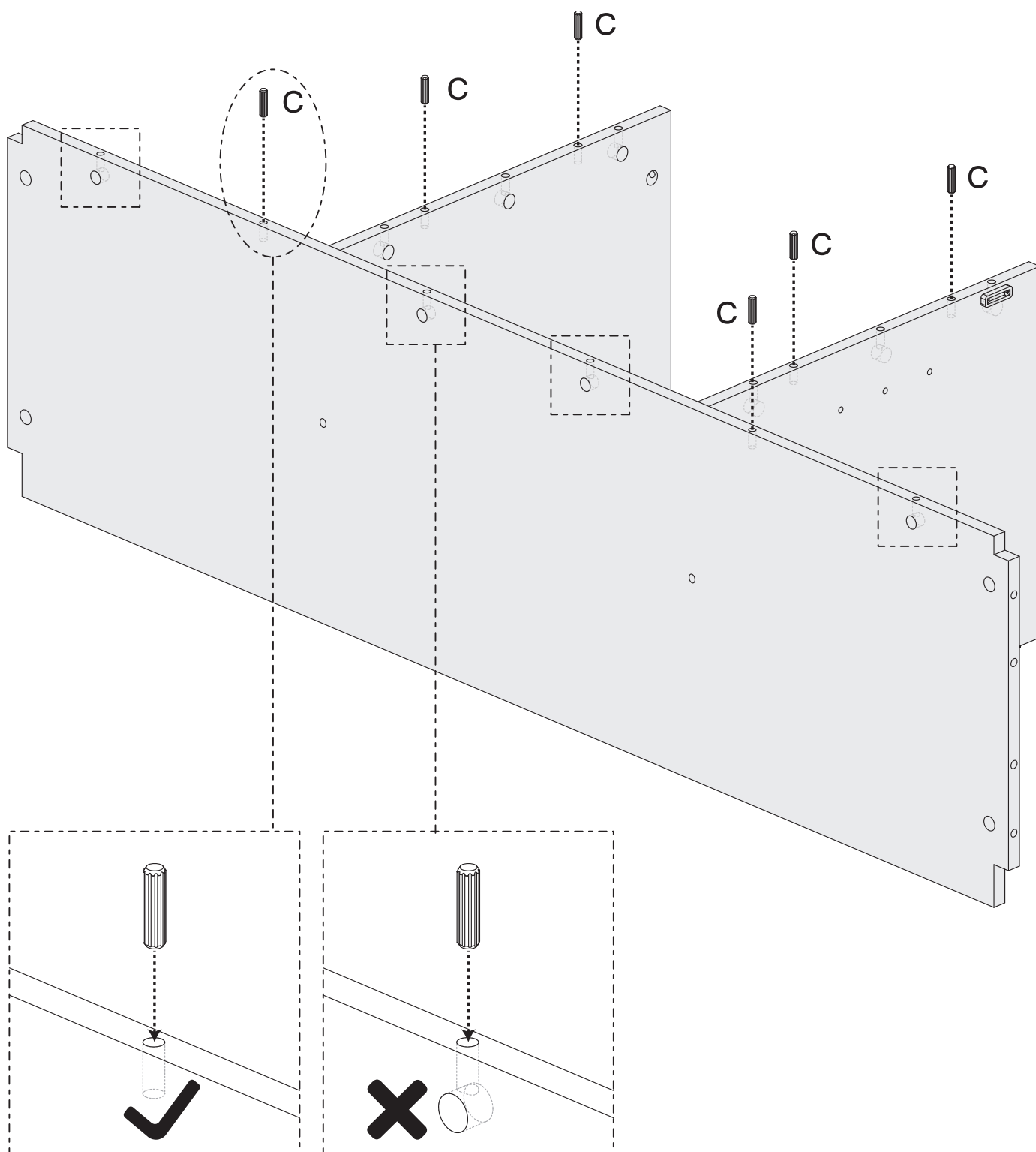

C\*6



# STEP 5

X 2

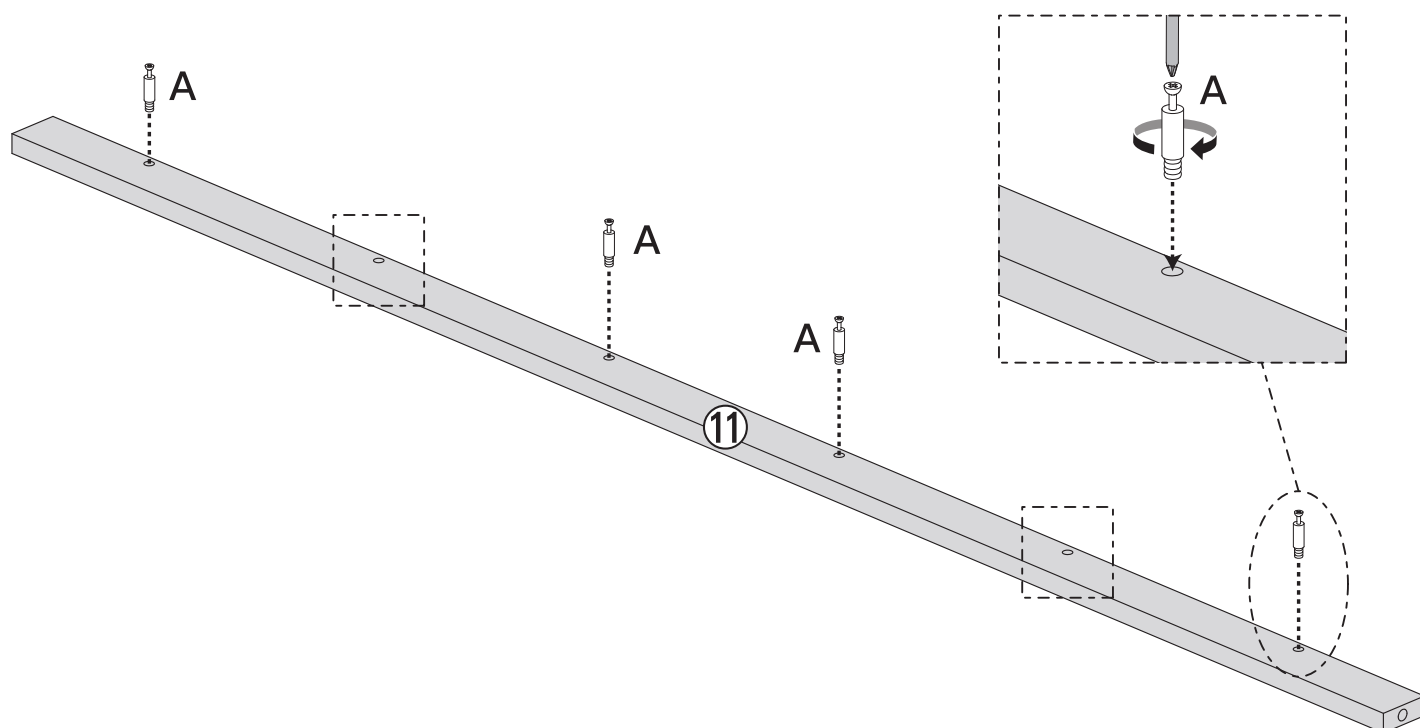
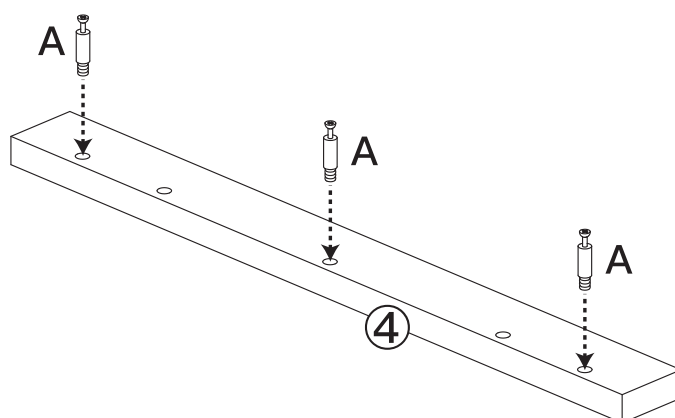

Phillips  
Screwdriver  
(Not Included)

A\*10  
④\*2 ⑪\*1

## STEP 6

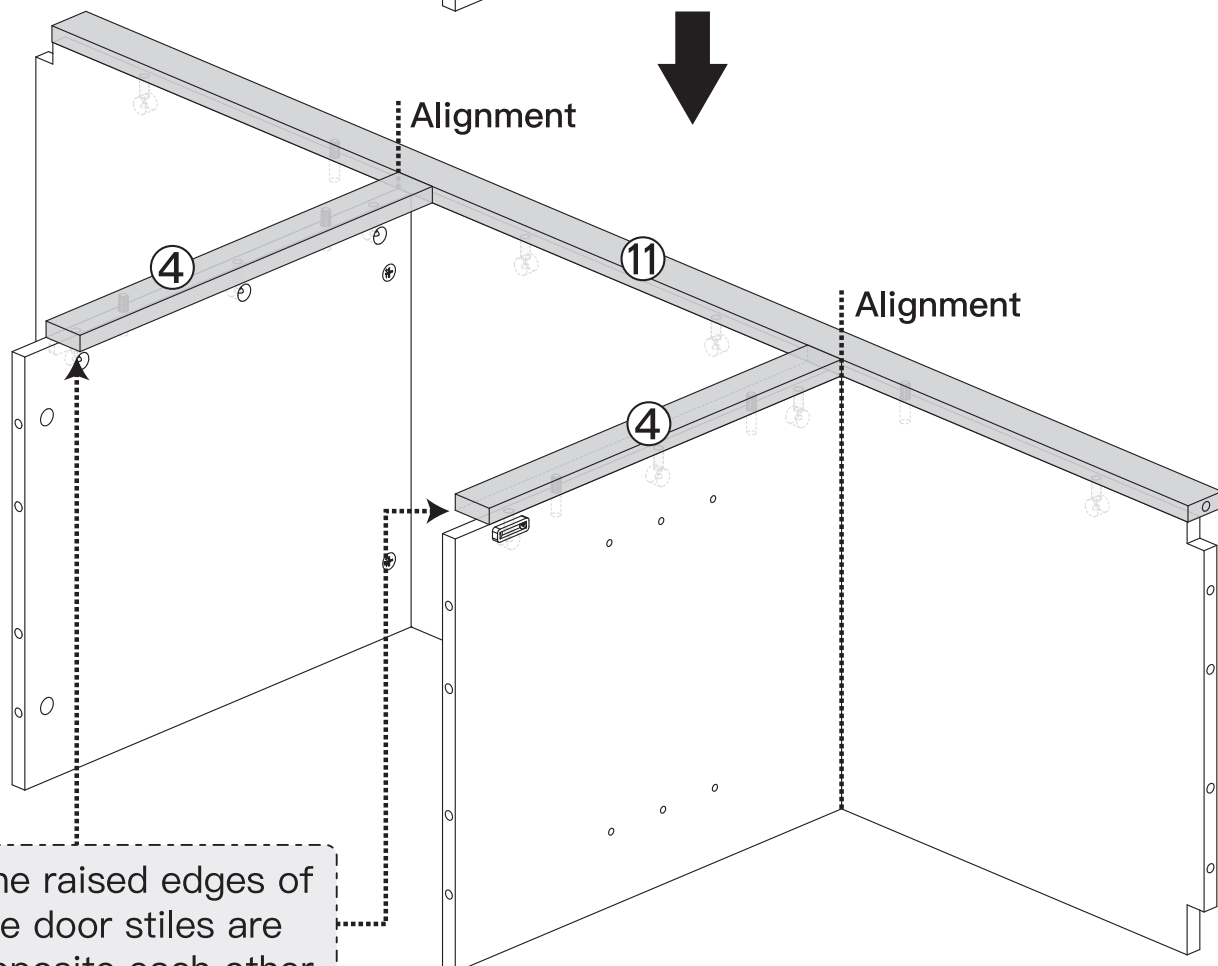
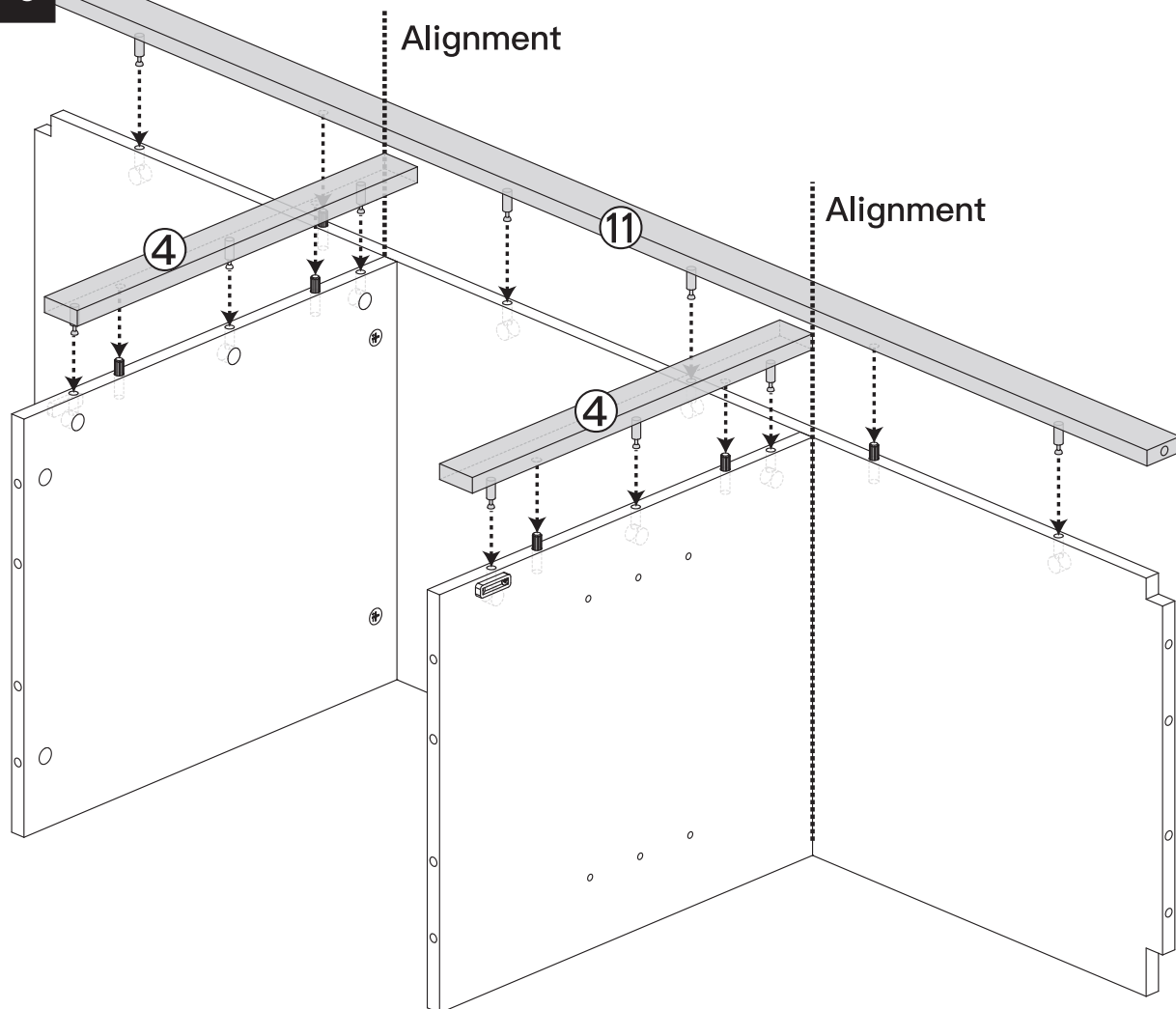

The raised edges of the door stiles are opposite each other.

# STEP 7

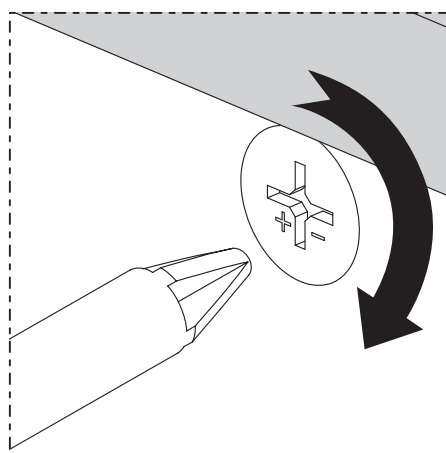
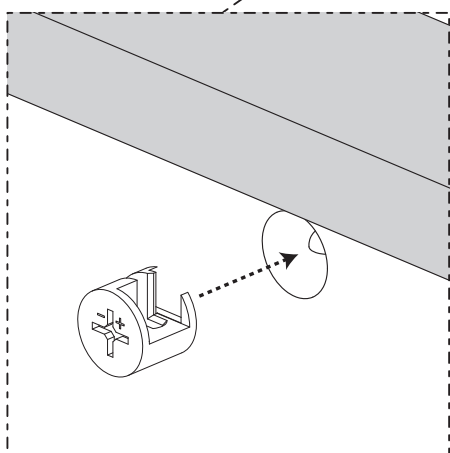
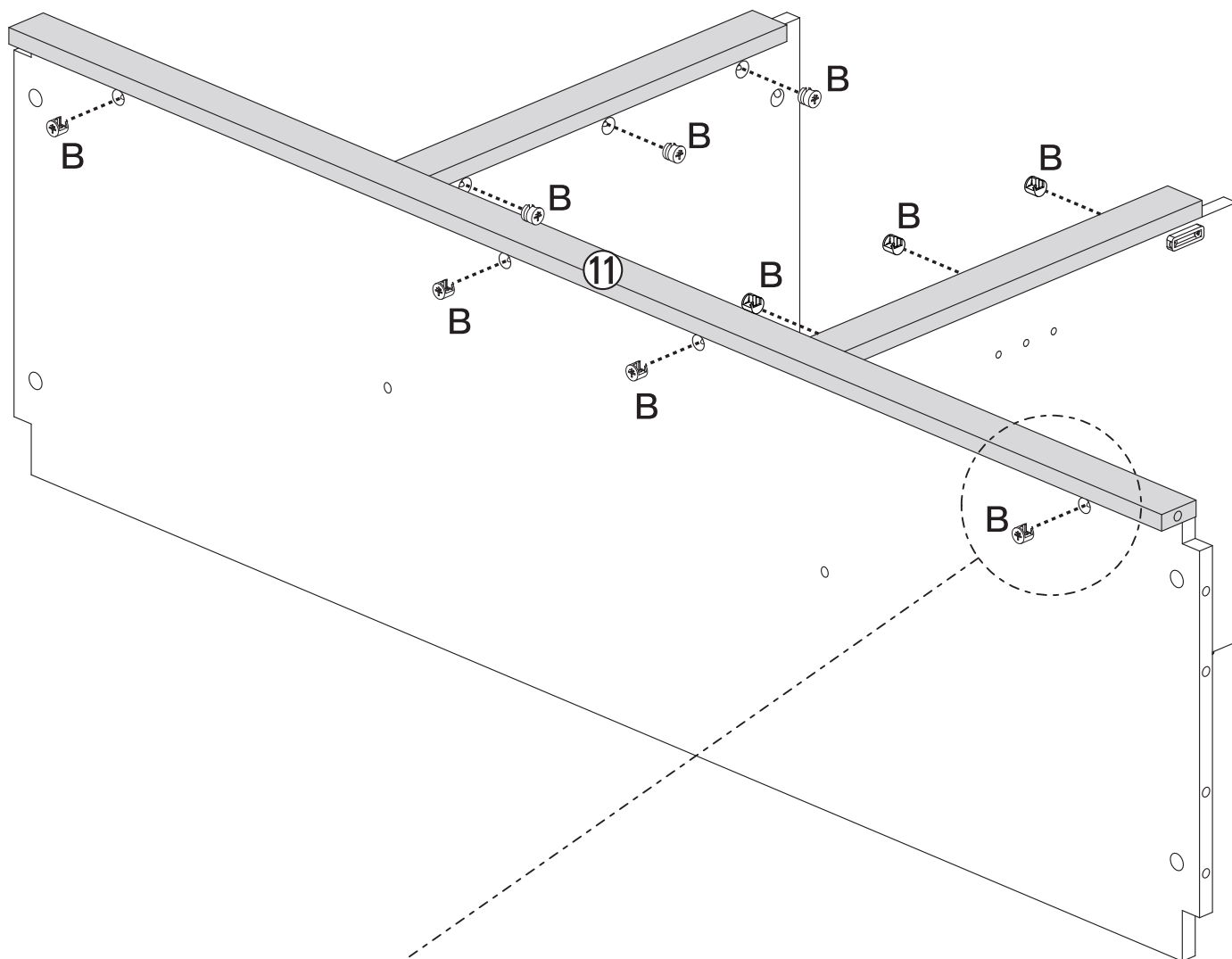

Phillips  
Screwdriver  
(Not Included)

B\*10

# STEP 8

The side with smaller holes faces backward.

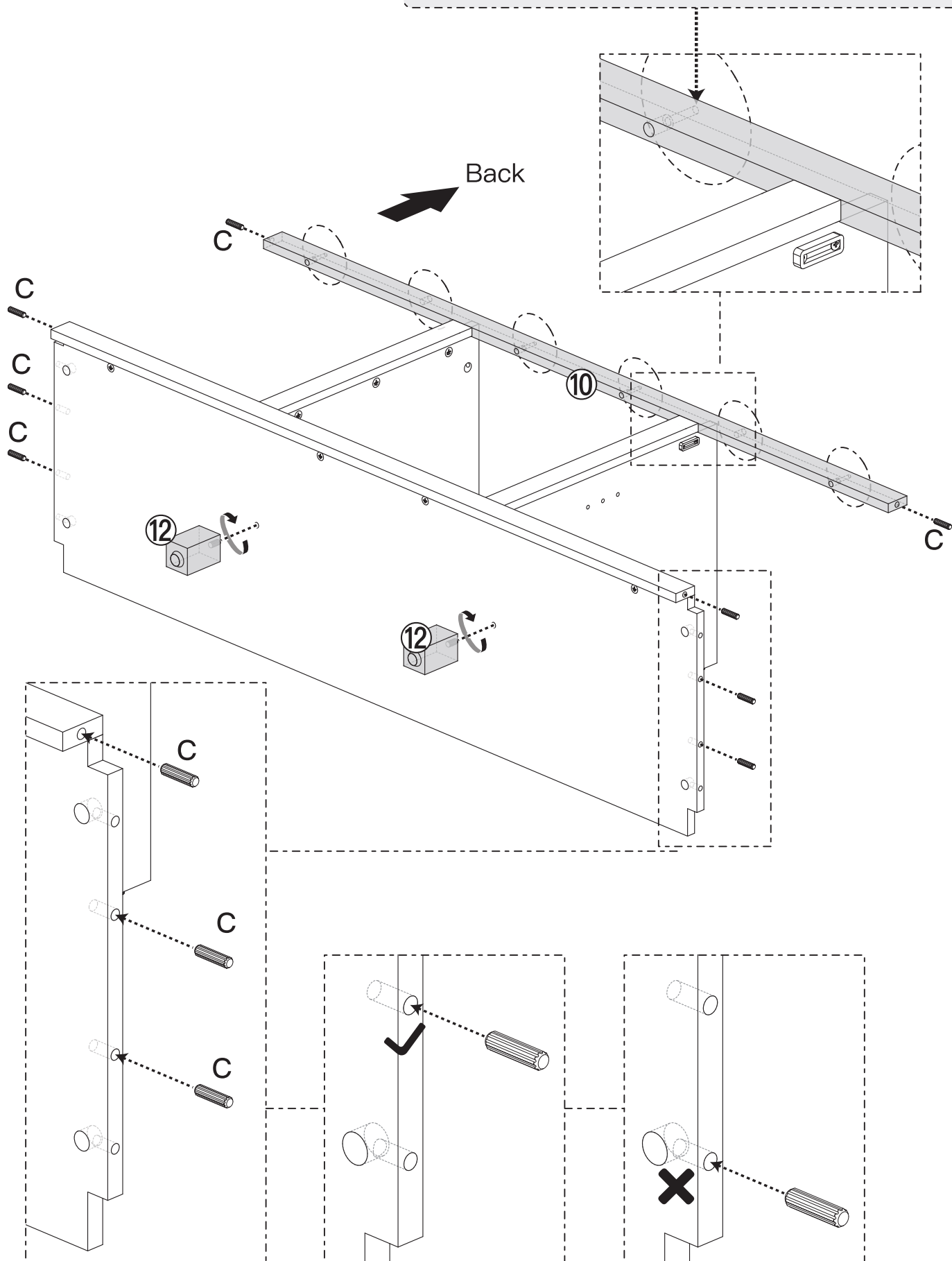

C\*8  
 10\*1 12\*2

# STEP 9

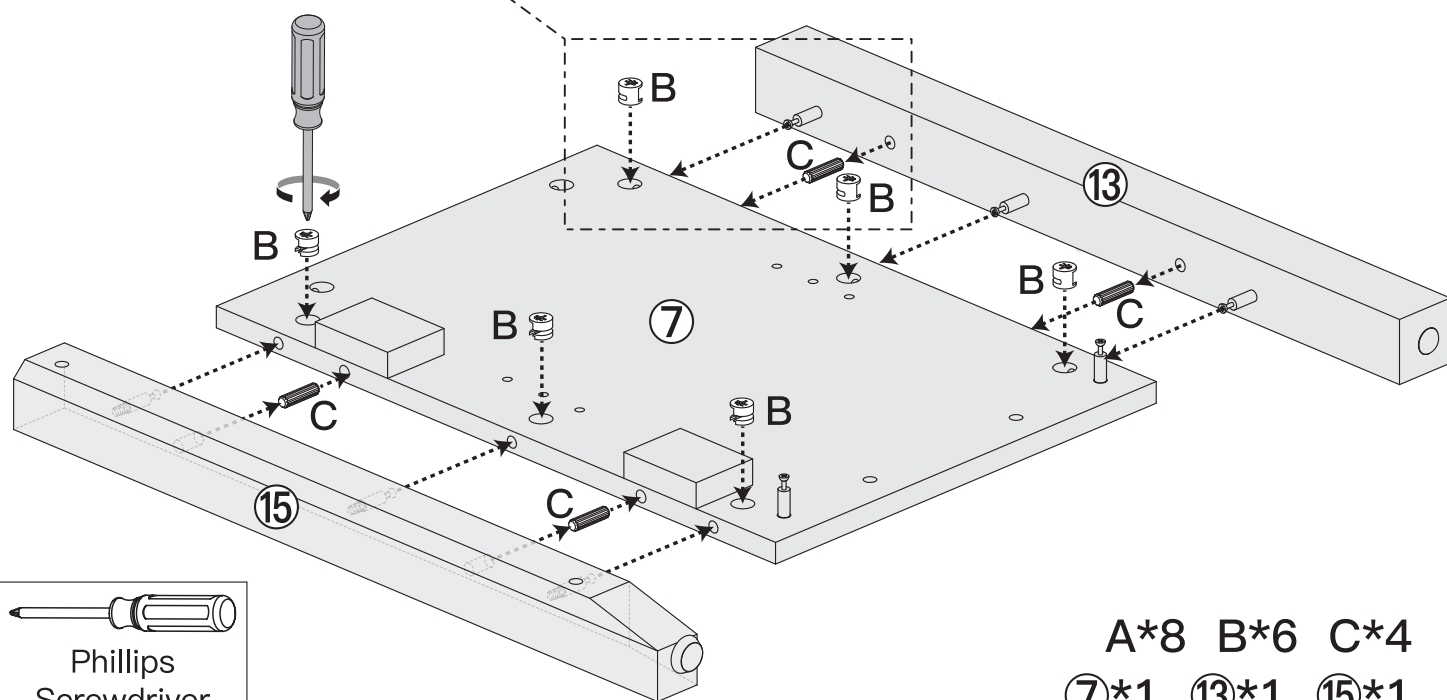
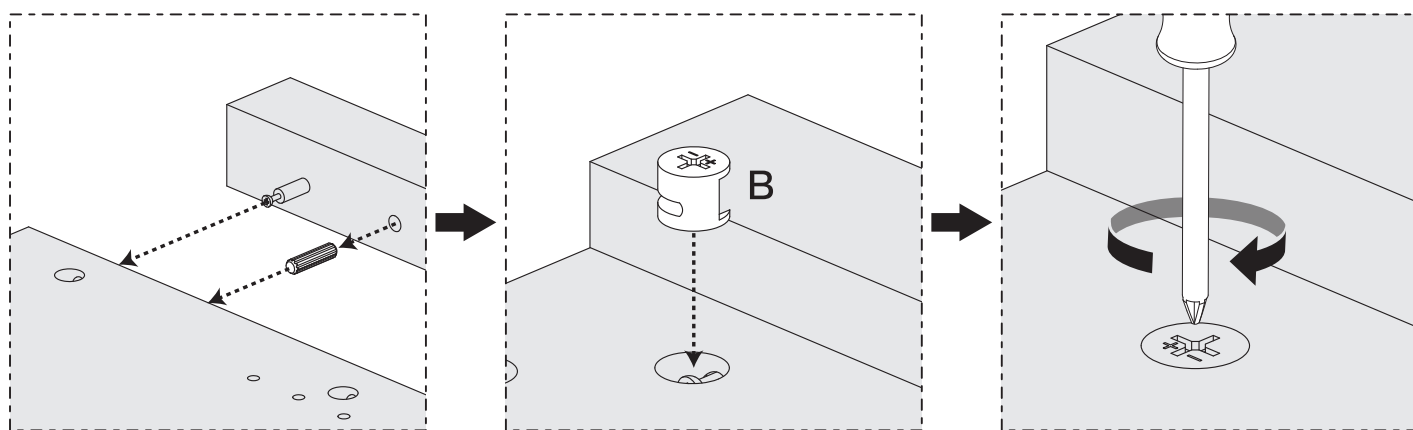
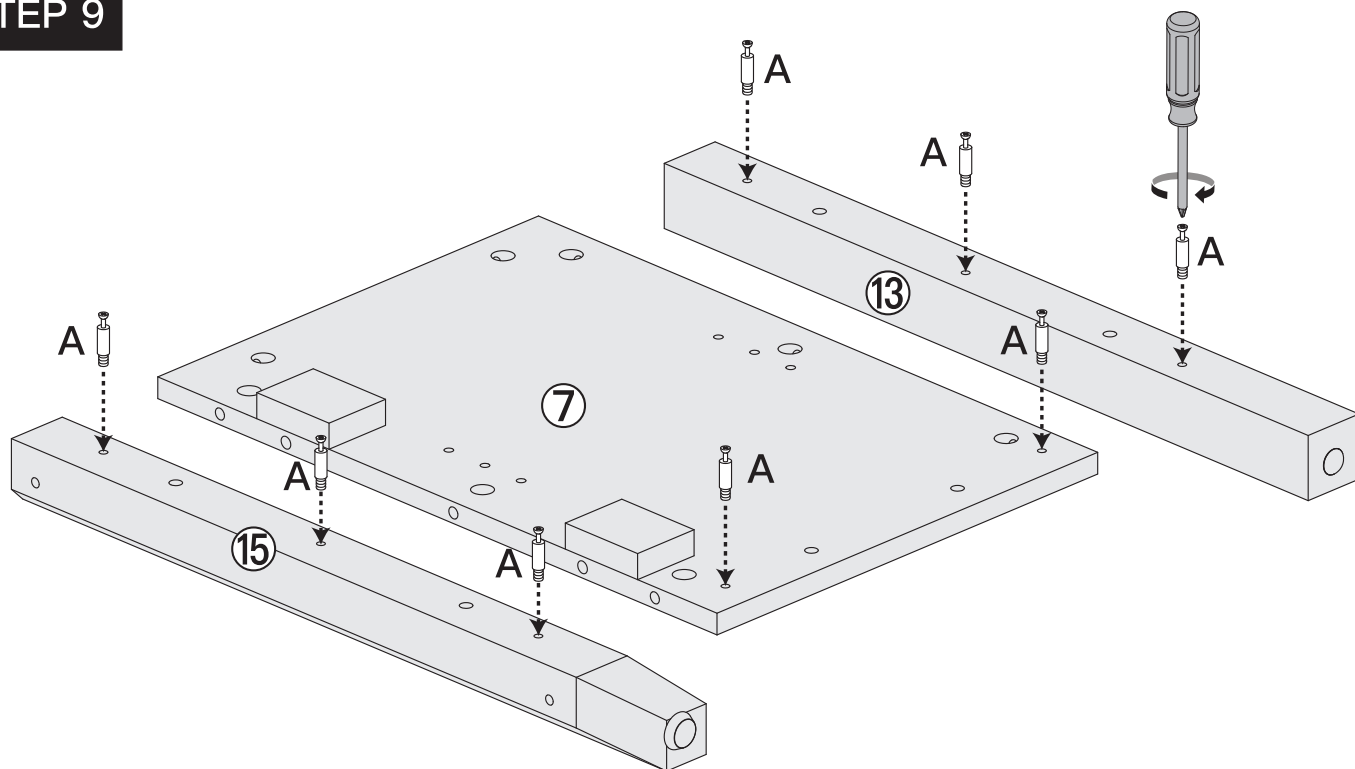

  
 Phillips  
 Screwdriver  
 (Not Included)

A\*8 B\*6 C\*4  
 7\*1 13\*1 15\*1

# STEP 10

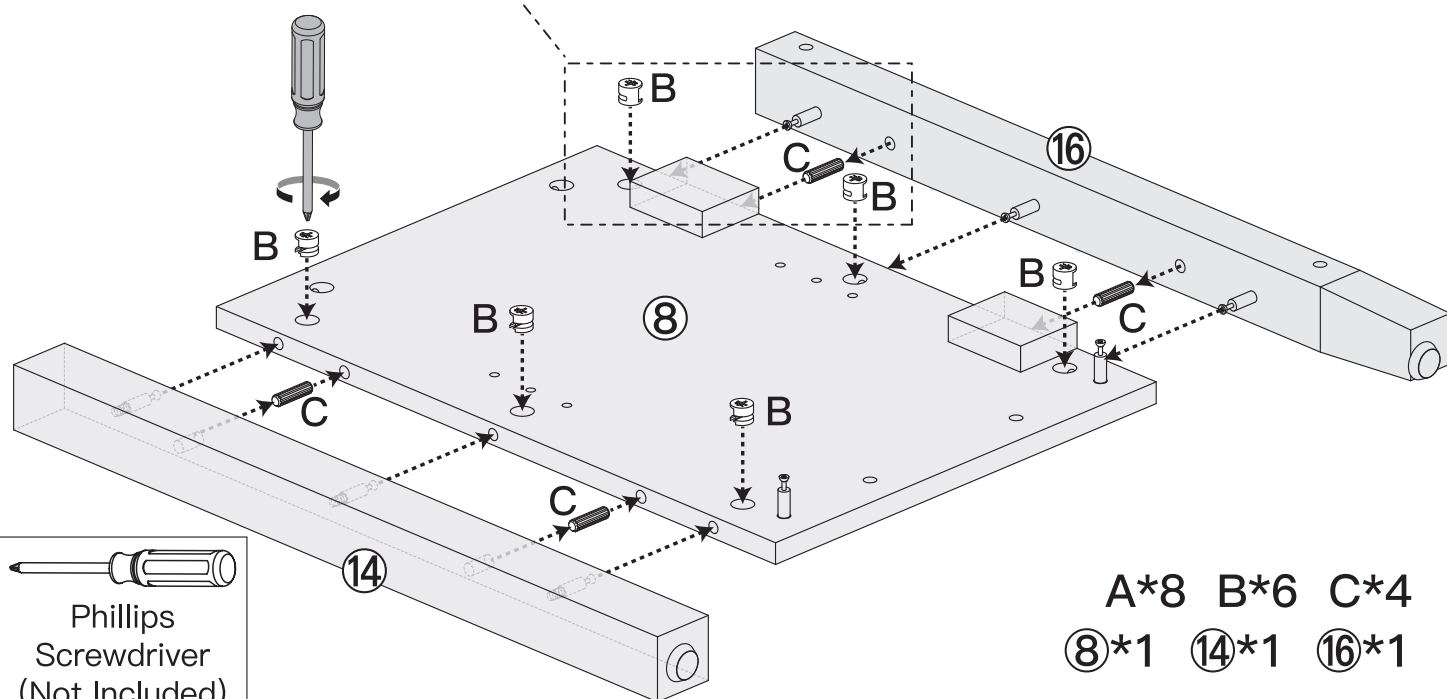
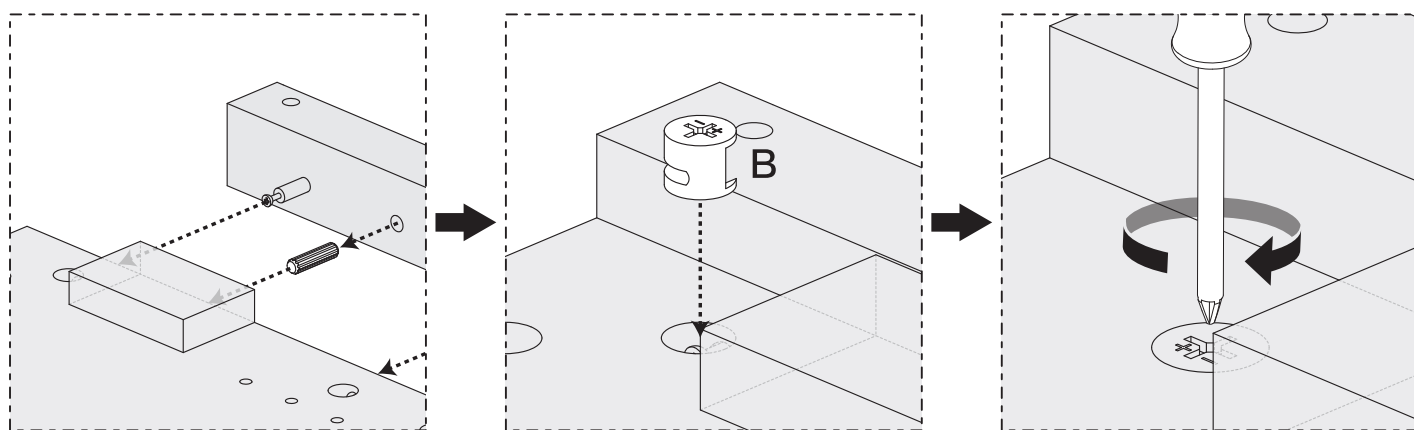
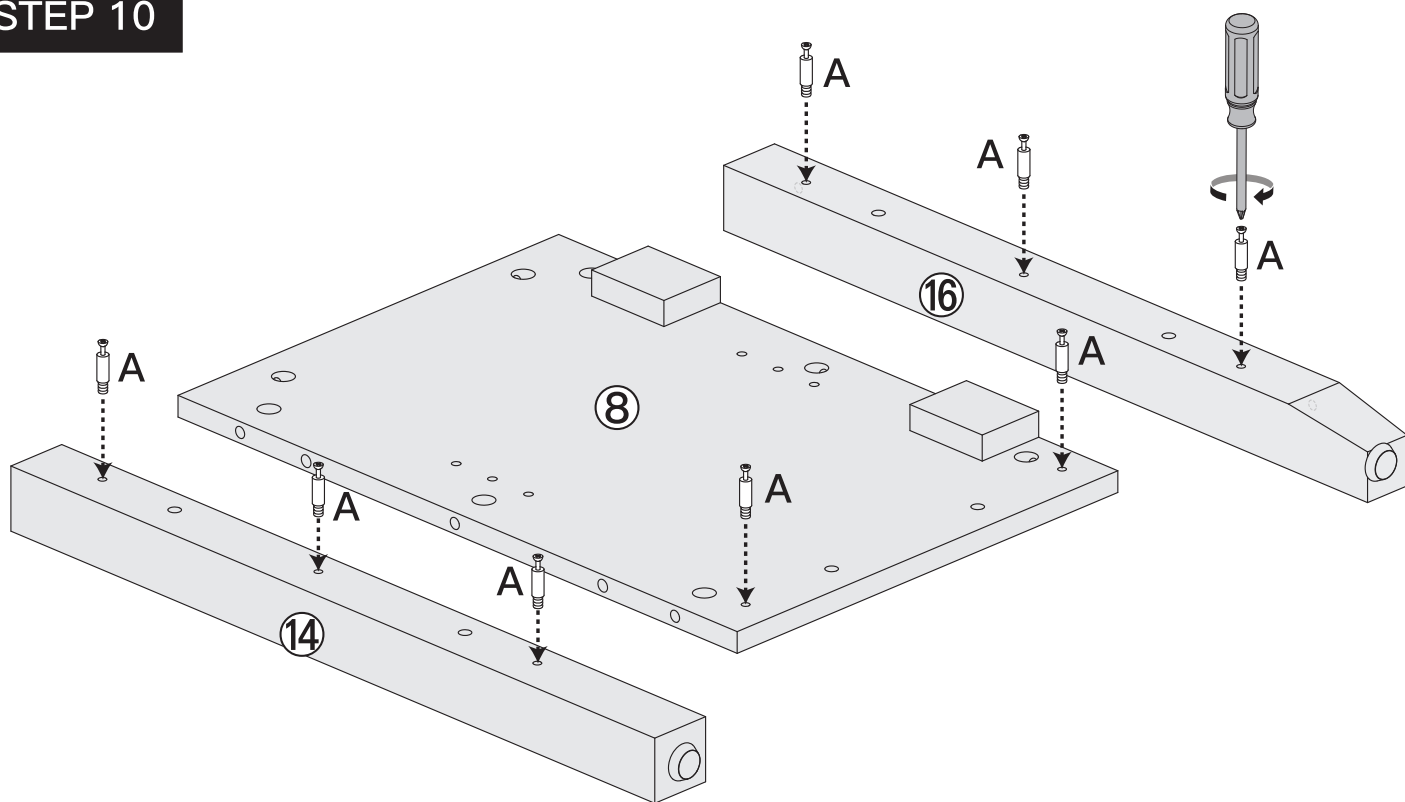

Phillips  
Screwdriver  
(Not Included)

A\*8 B\*6 C\*4  
⑧\*1 ⑭\*1 ⑰\*1

# STEP 11

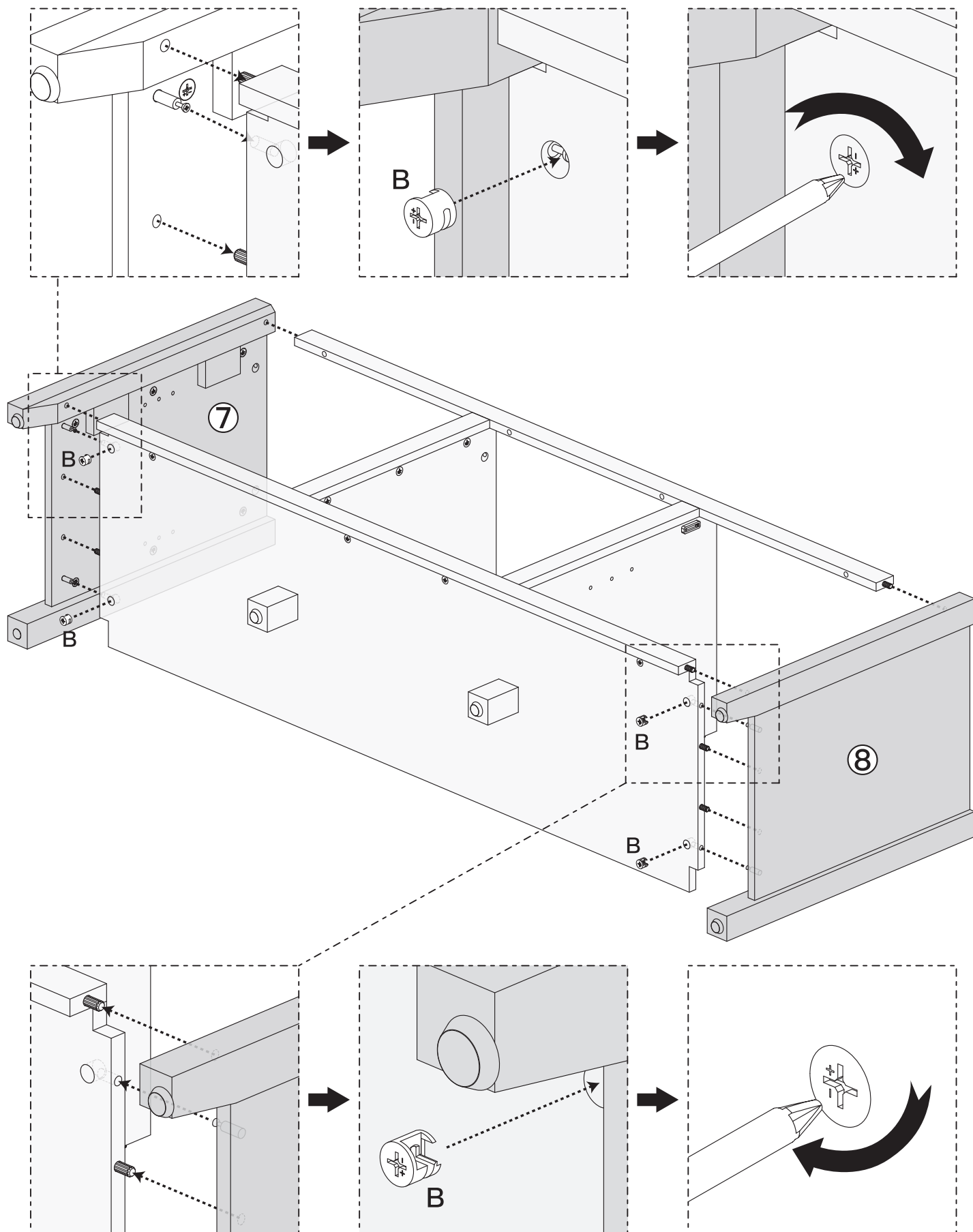

Phillips  
Screwdriver  
(Not Included)

B\*4

## STEP 12

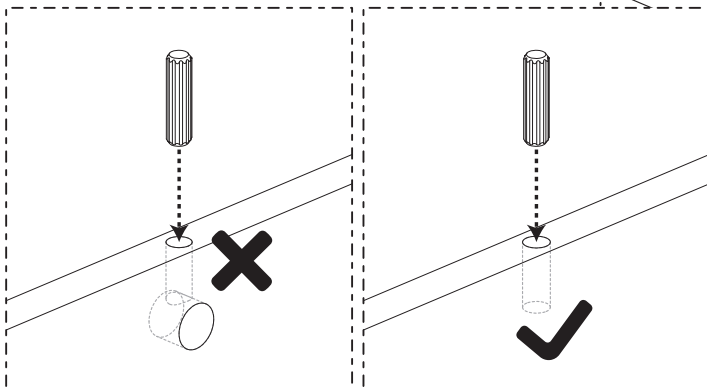
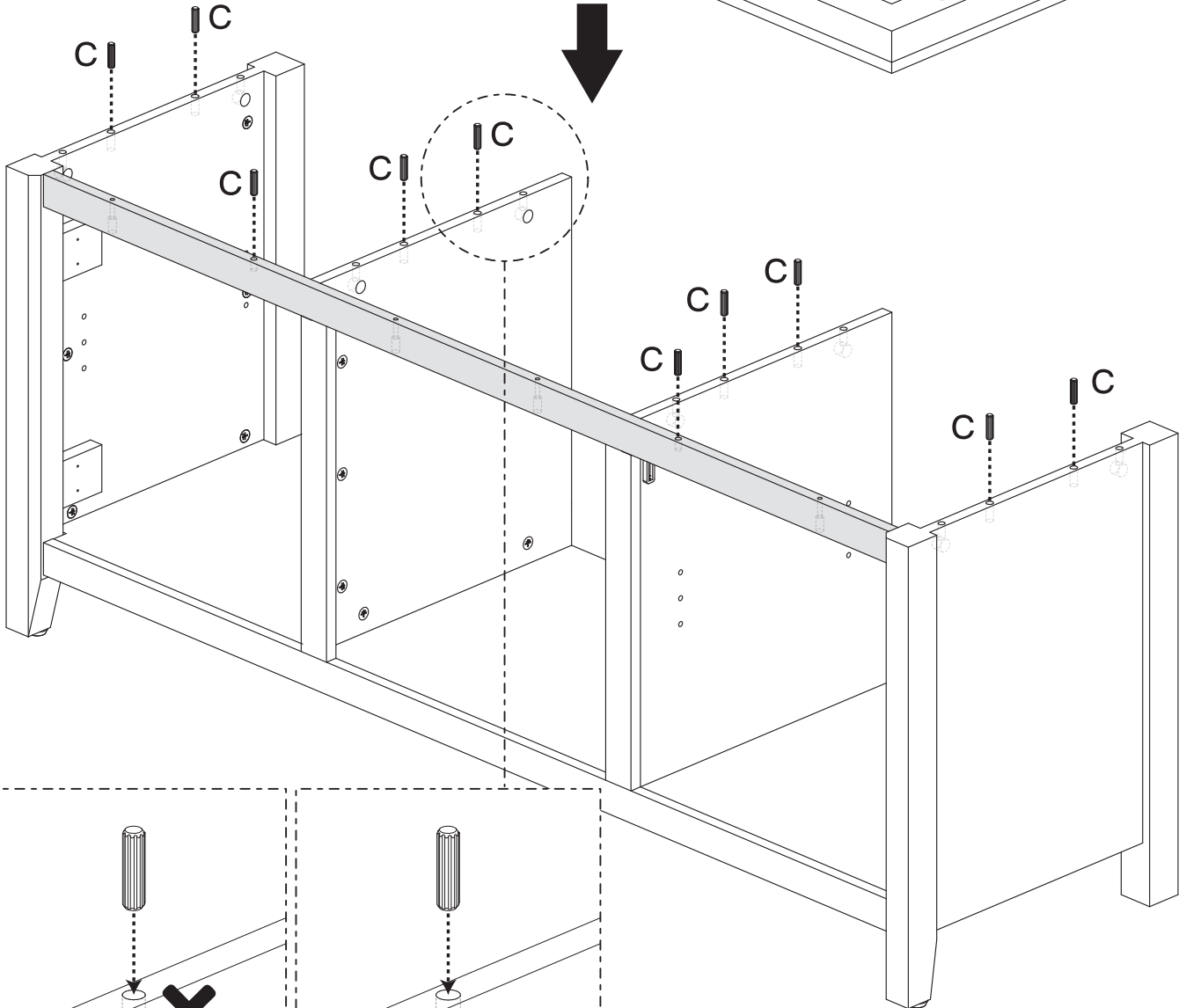
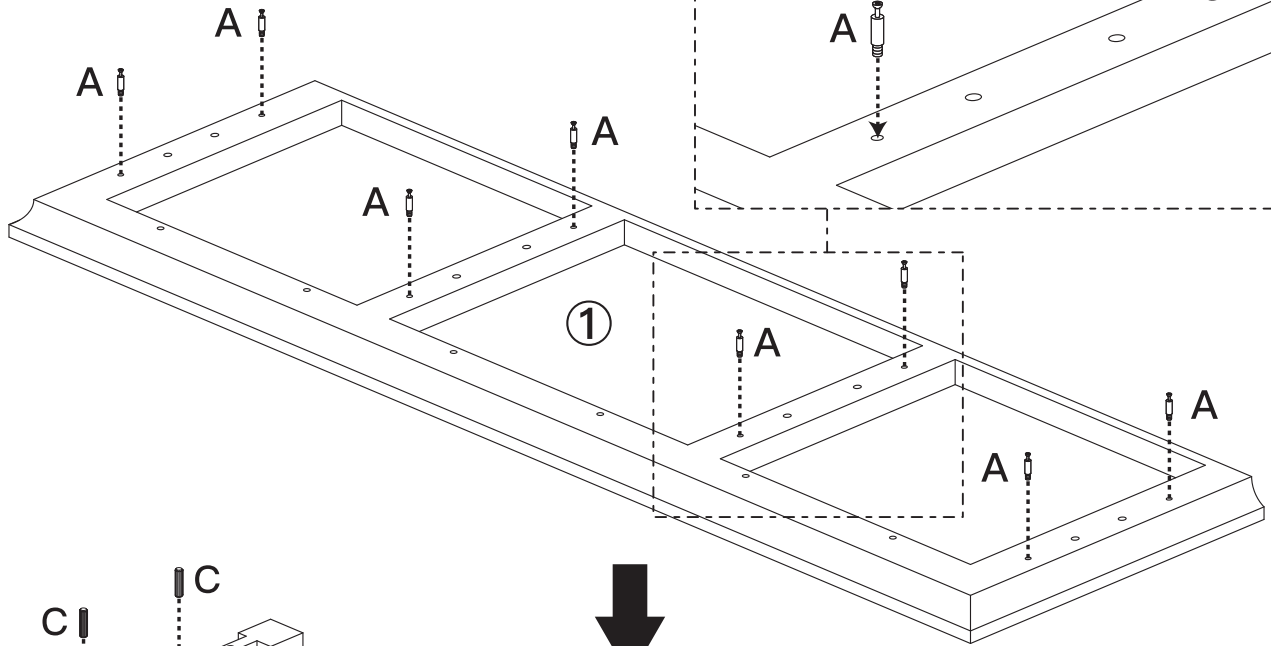
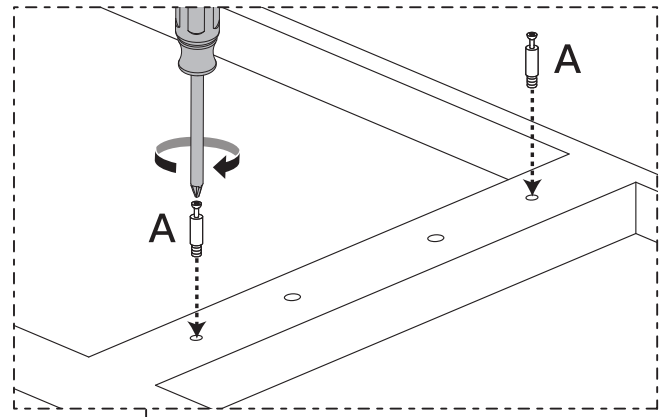
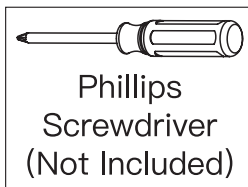

A\*8 C\*10  
①\*1



## STEP 13

Warm Tips: It is recommended to align the holes from side to side.

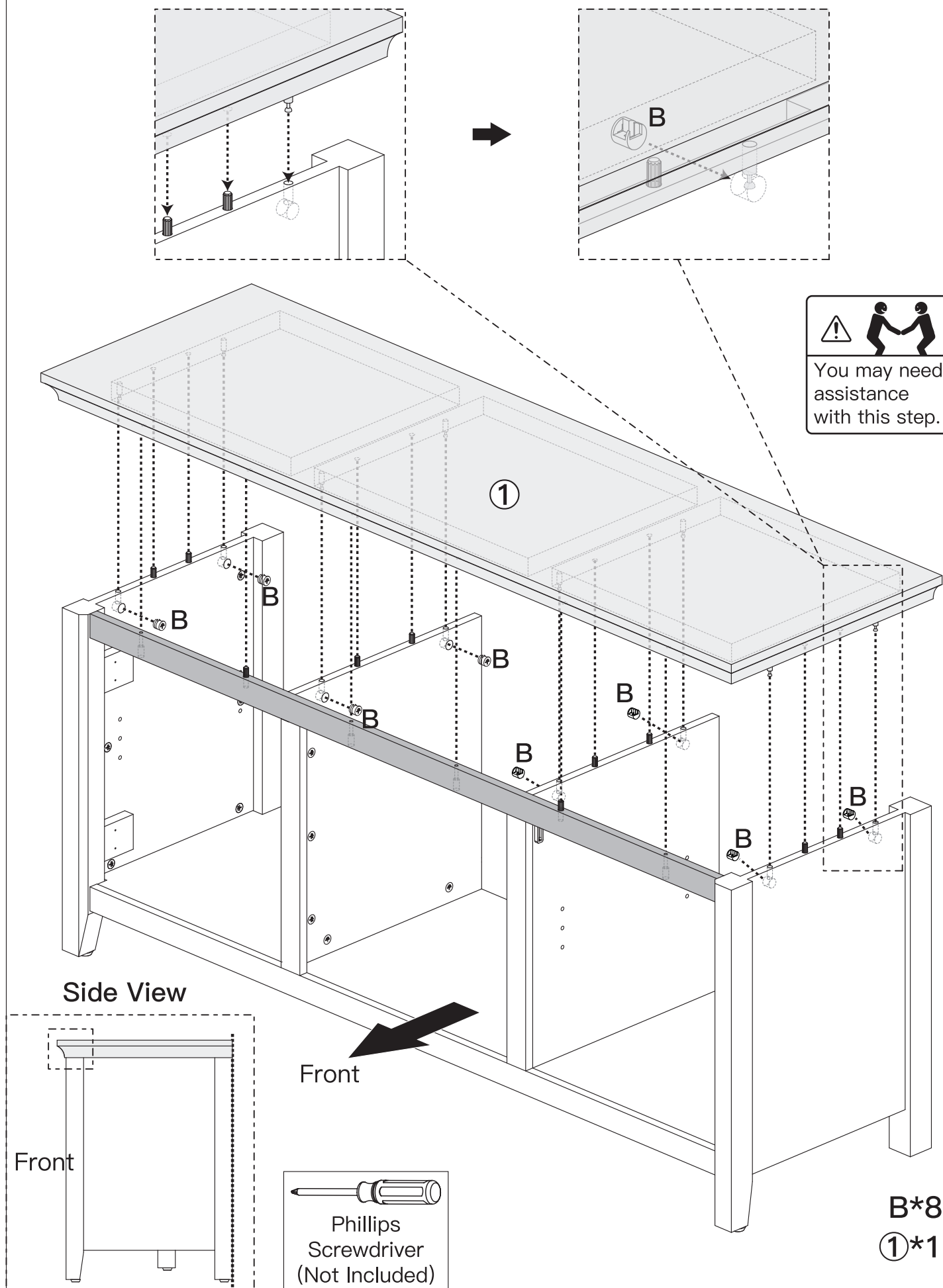

## STEP 14

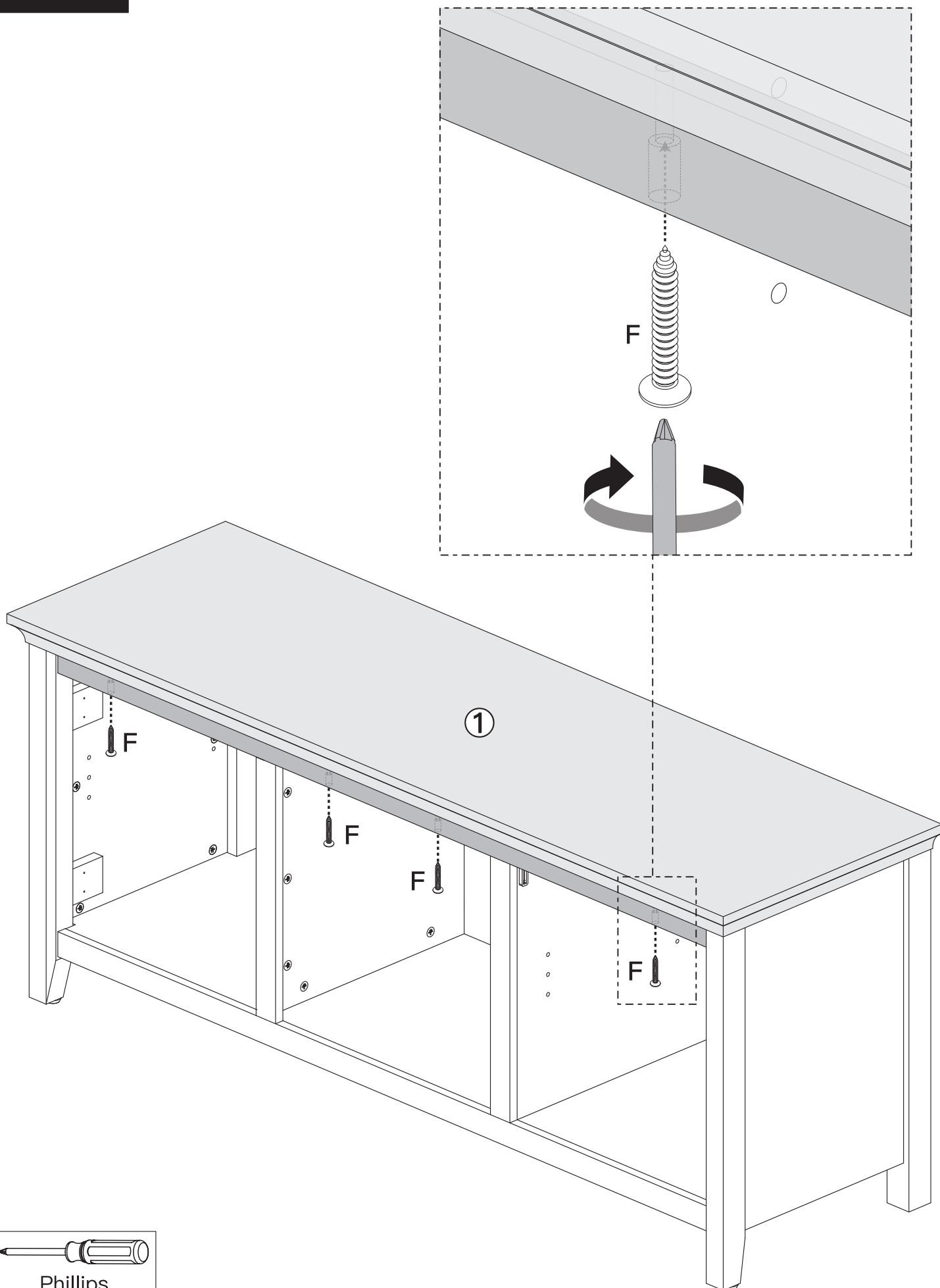

Phillips  
Screwdriver  
(Not Included)

F\*4

## STEP 15

**Warm Tips:** There are only 8 pilot holes on the top panel for locating the back panel on the back of the TV stand. We do not pre-drill pilot holes on the sides and bottom for you can screw the screws into with a screwdriver. It is recommended to attach the back panel ⑰ at the top panel ① first. Thread 2 screws through safety straps [M], back panel ⑰ and into top panel ①. Please remember not to fully tighten all the screws [G] until all of them are in correct position.

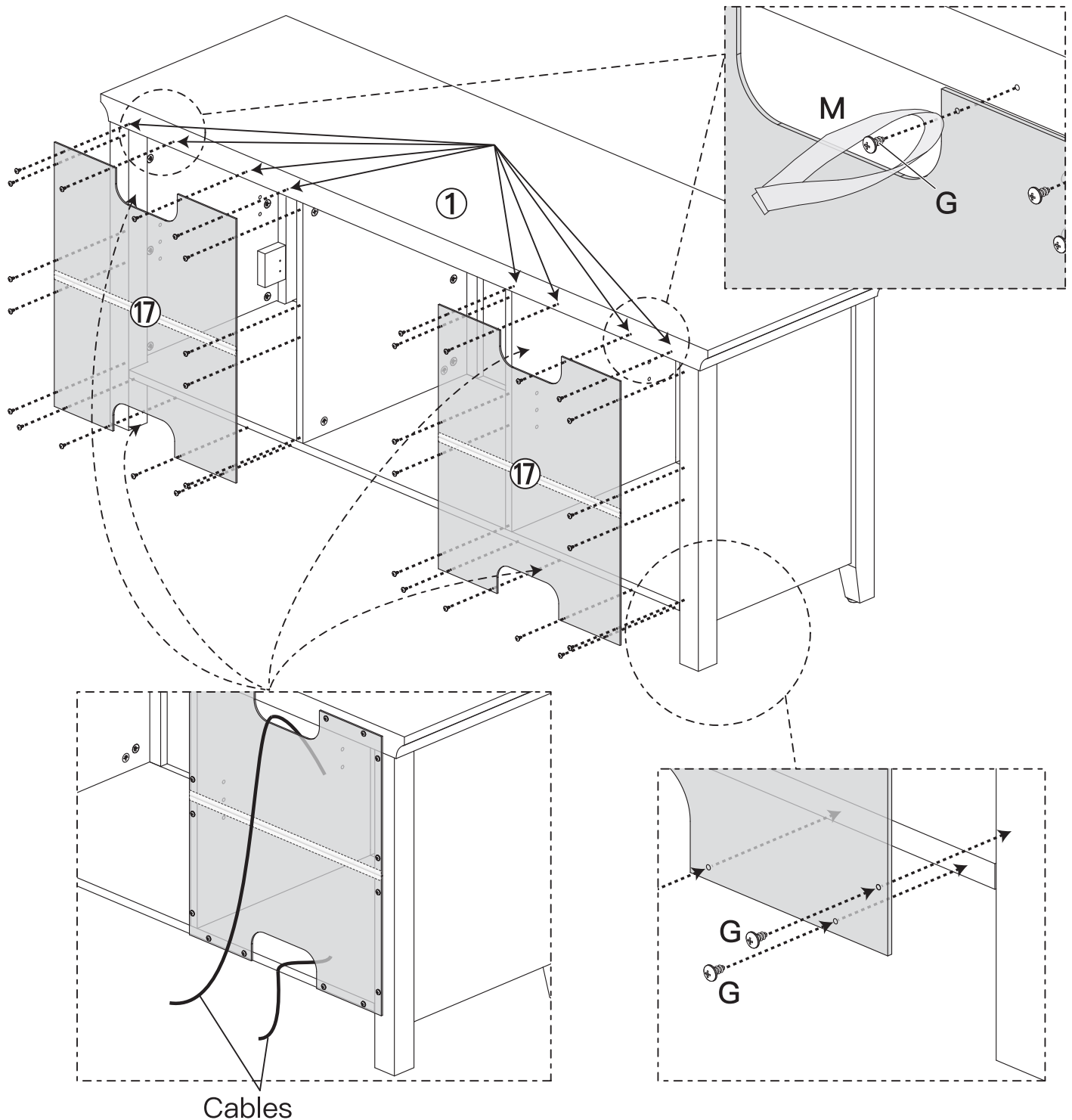

Cables

Tighten all cam locks and screws to make sure that all the parts are tight and have no gaps between the parts. This will help to keep the stand square.



Phillips  
Screwdriver  
(Not Included)

G\*32 M\*2

⑰\*2

## STEP 16

Insert four shelf supports [H] into the holes inside each side compartments. Rest the shelves ③ on the shelf supports [H].

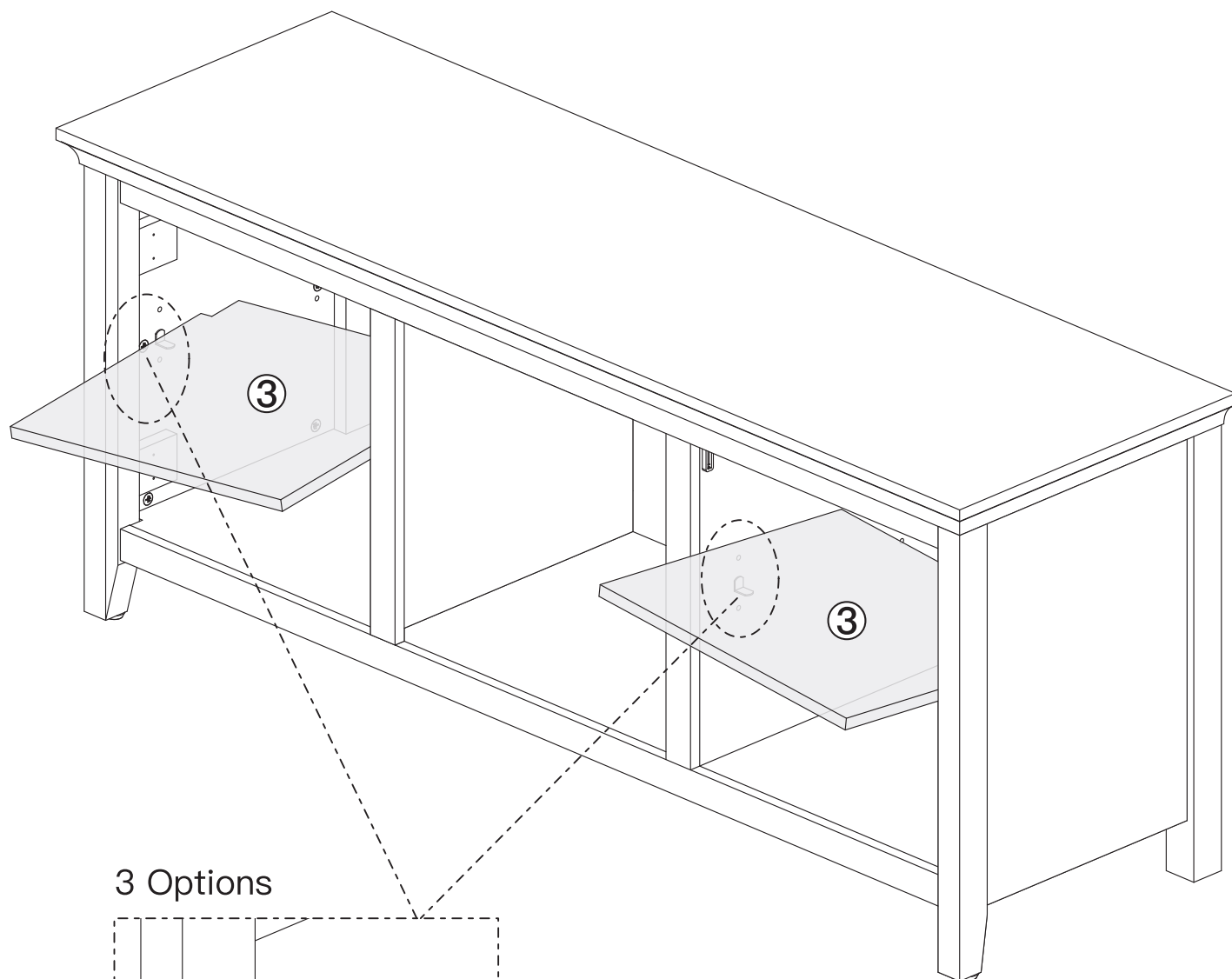

3 Options

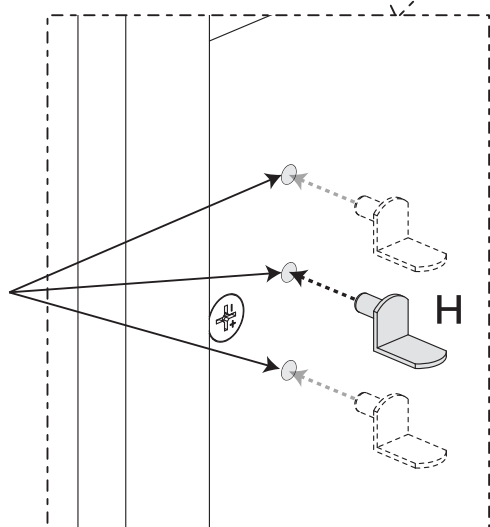

H\*8  
③\*2

# STEP 17

X 2

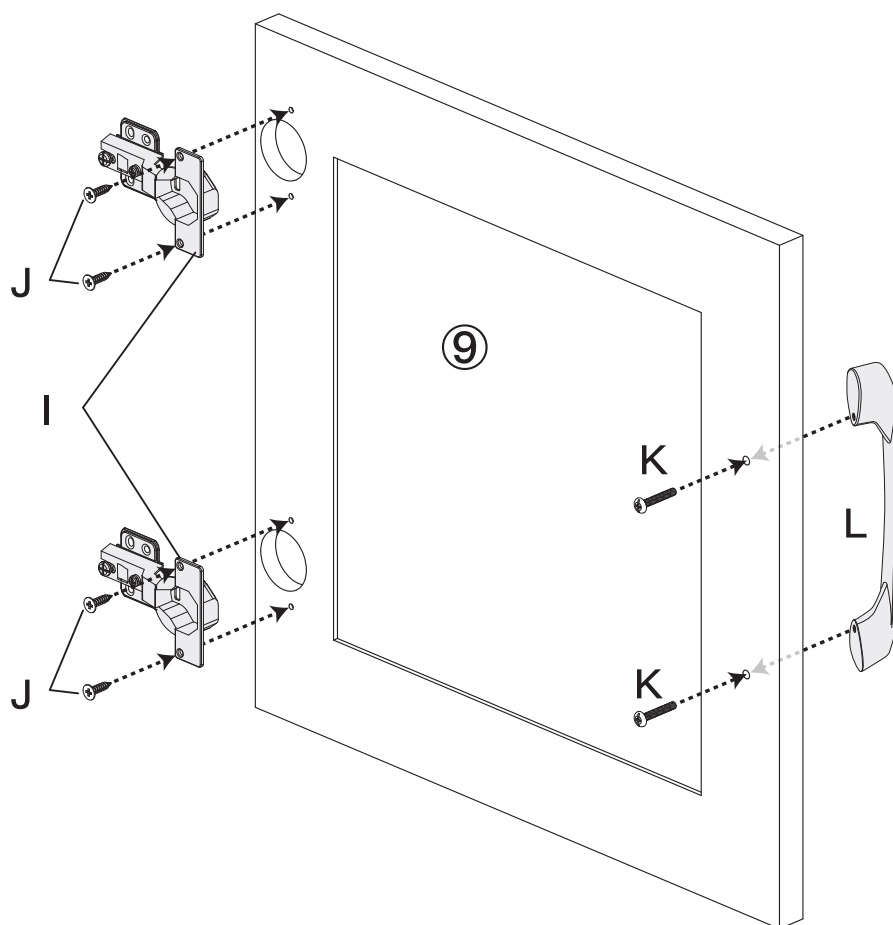

Phillips  
Screwdriver  
(Not Included)

I\*4 J\*8 K\*4 L\*2  
⑨\*2

## STEP 18

DO NO fully tighten the screws until the STEP 19 is finished.

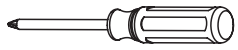

Phillips  
Screwdriver  
(Not Included)

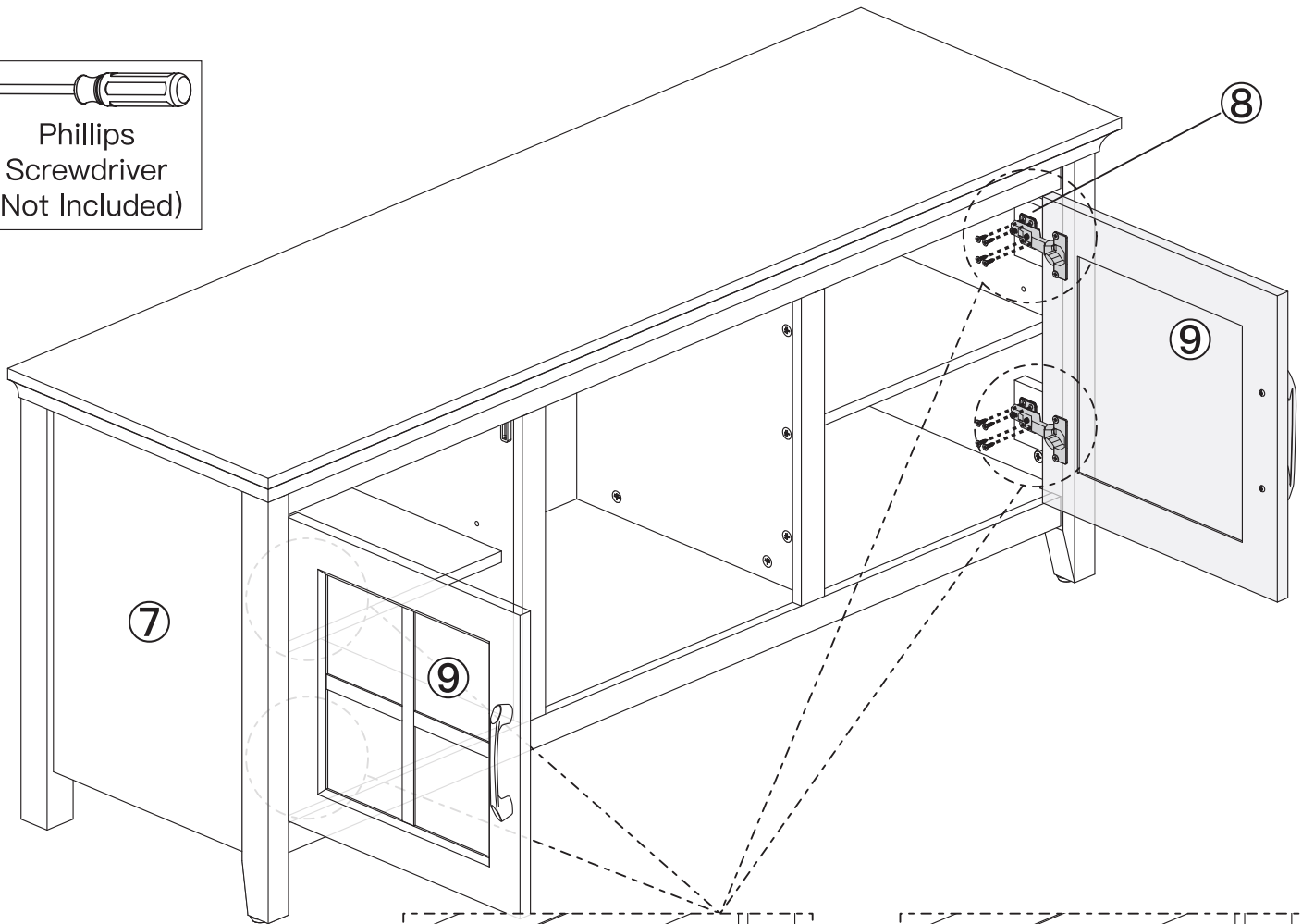

Pre-drilled holes for  
hinges

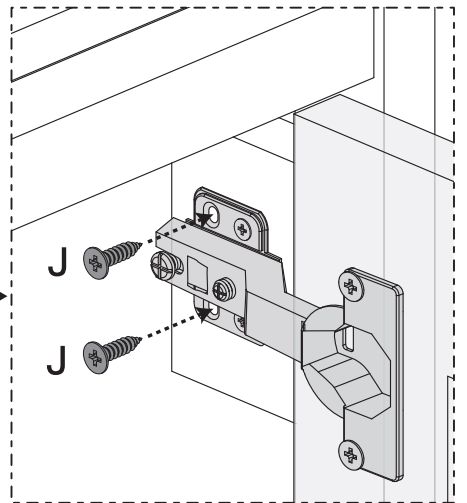
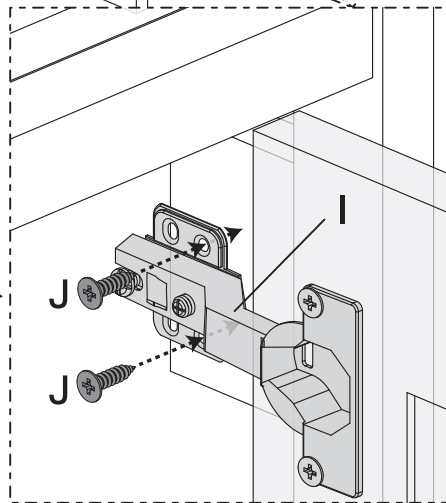
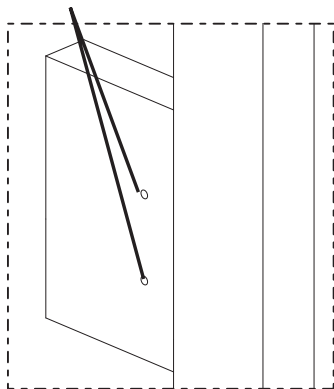

Note: There are only 2 locating holes for installing the hinge [I] on the panel.  
First, align the two vertical holes in the right of the hinge [I] with the 2 locating holes.

Then screw the 2 screws [J] in the holes.

Finally fasten the other 2 screws [J] in the panel (this may require more strength than you think).

**J\*16**

## STEP 19

The hinges may go out of alignment during shipping. Open and close the doors to make sure they are aligned correctly. If you find that the doors need to be adjusted, turn the appropriate screw, as illustrated.

Three-way adjustable hinge for perfectly aligned doors:

1. To adjust door up or down.
2. To adjust door forward or backward.
3. To adjust door right or left.

Turn the set screw [S] clockwise to narrow the gap between the door and side panel.

Turn the set screw [S] counterclockwise to enlarge the gap between the door and side panel.

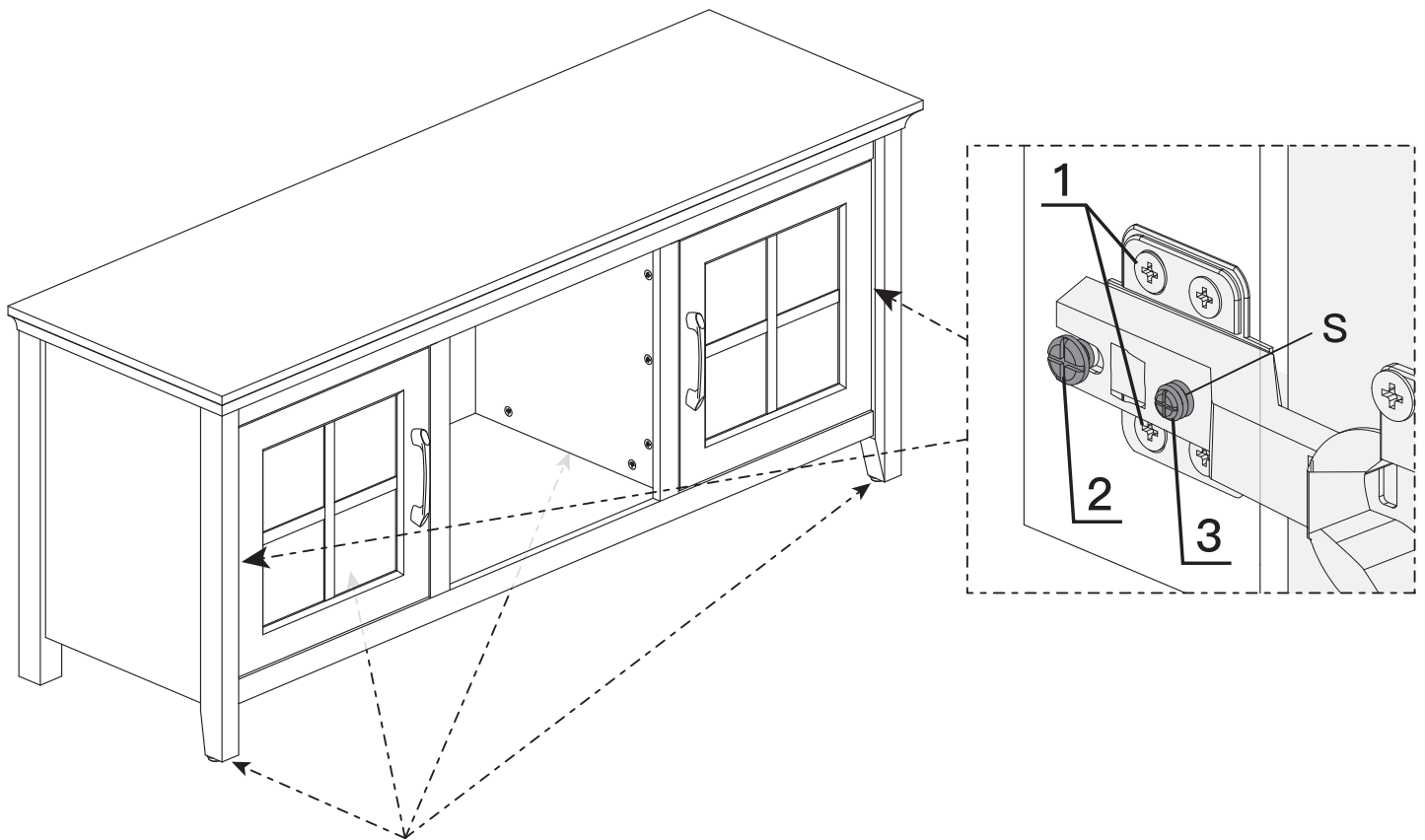

If the stand is not stable on the flat floor, please adjust the levelers on the two front legs and two center legs until the stand is stable.



Phillips  
Screwdriver  
(Not Included)

# STEP 20

## For Wood Studs

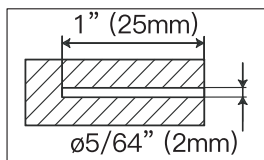
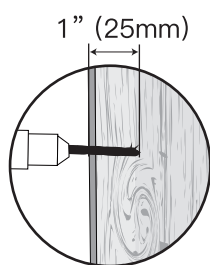
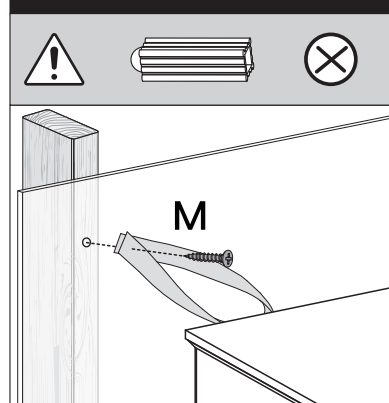

## For Solid Concrete, Concrete Block or Brick Wall

