



Technical Support and E-Warranty Certificate www.vevor.com/support

Laser Engraver User Manual

We continue to be committed to provide you tools with competitive price.

"Save Half", "Half Price" or any other similar expressions used by us only represents an estimate of savings you might benefit from buying certain tools with us compared to the major top brands and does not necessarily mean to cover all categories of tools offered by us. You are kindly reminded to verify carefully when you are placing an order with us if you are actually saving half in comparison with the top major brands.

**A7
5W**



**A7
10W**



**G3
20W**



NEED HELP? CONTACT US!

Have product questions? Need technical support? Please feel free to contact us:



CustomerService@vevor.com

This is the original instruction, please read all manual instructions carefully before operating. VEVOR reserves a clear interpretation of our user manual. The appearance of the product shall be subject to the product you received. Please forgive us that we won't inform you again if there are any technology or software updates on our product.

Part 4: Installation Steps

Step 1: Assemble the frame



Step 2: Install the X-axis assembly

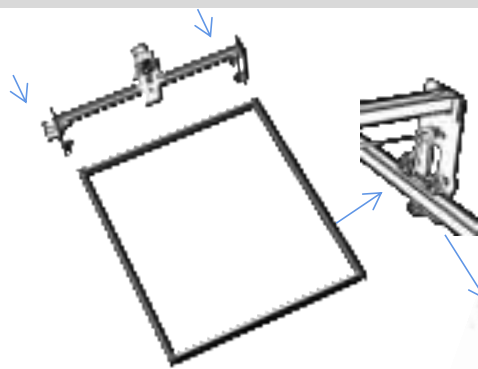

Step 3: Install the support foot assembly and the Y-axis tank chain

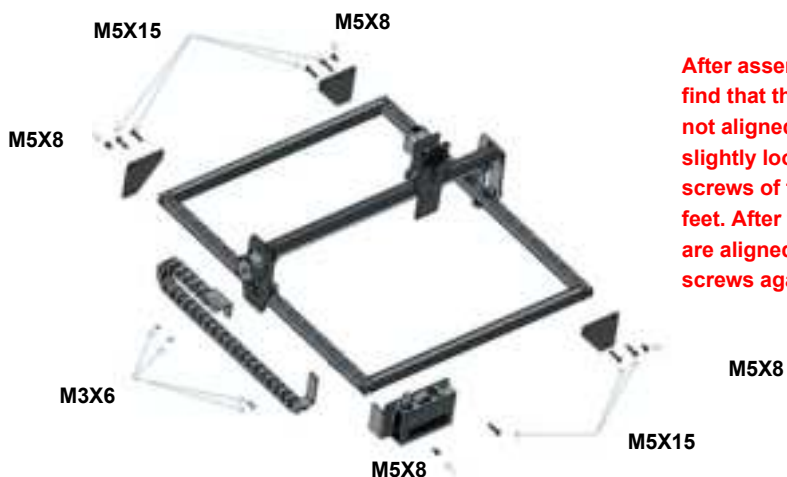

After assembly, if you find that the four feet are not aligned, please slightly loosen the screws of the support feet. After the four feet are aligned, tighten the screws again.

Step4: Install the X-axis tank chain

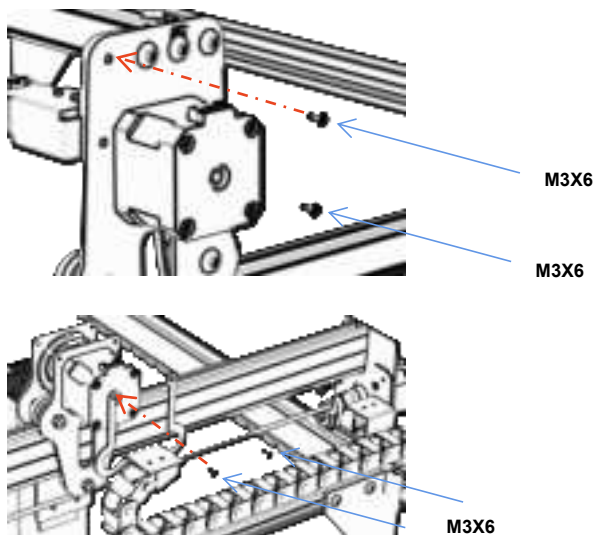

Step5: Install the timing belt

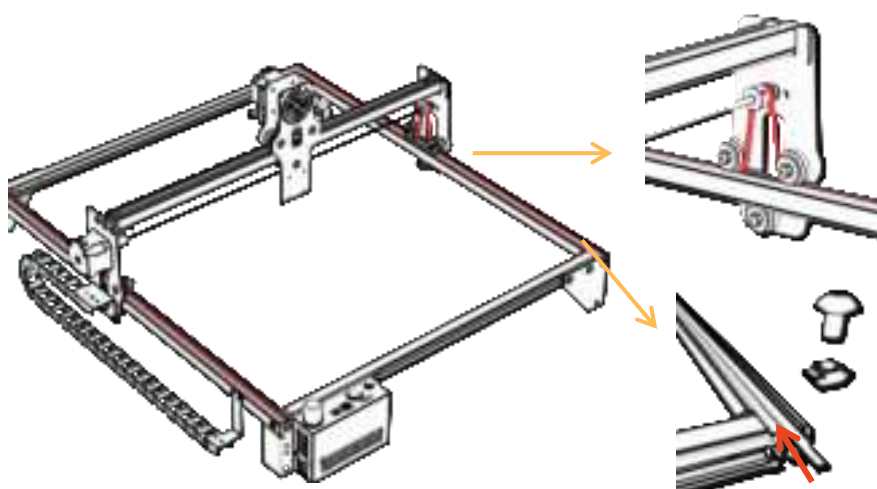

Using M5 × 6 T-shaped
combination nut locking with belt

Step 6.1: Step 6: Laser installation (for 5W and 10W models)

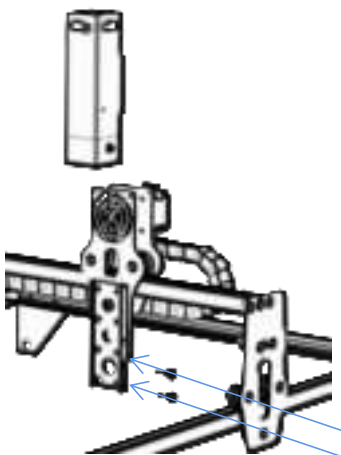

M4X12

Step 6.2: Mounting laser (for 20W)

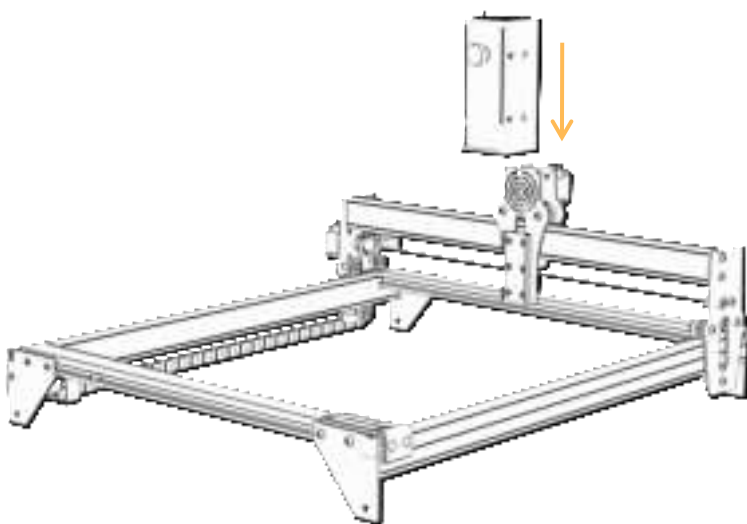

Step7: Install the cable

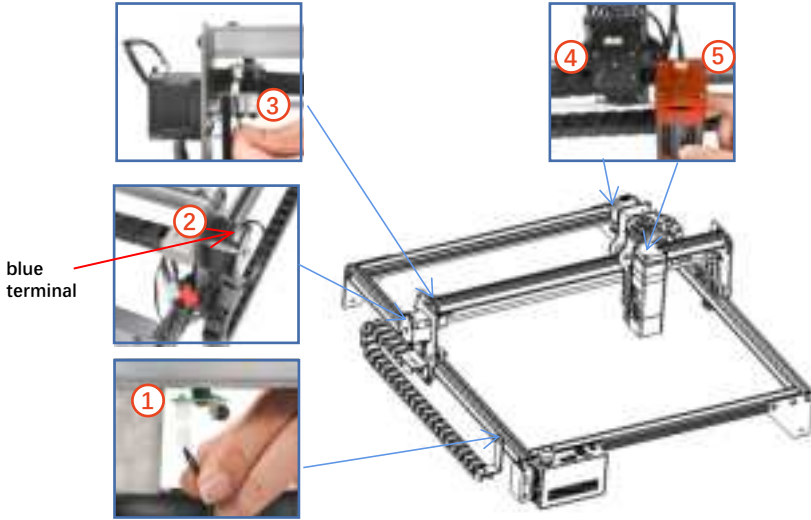

Step8: Adjust the eccentric wheel

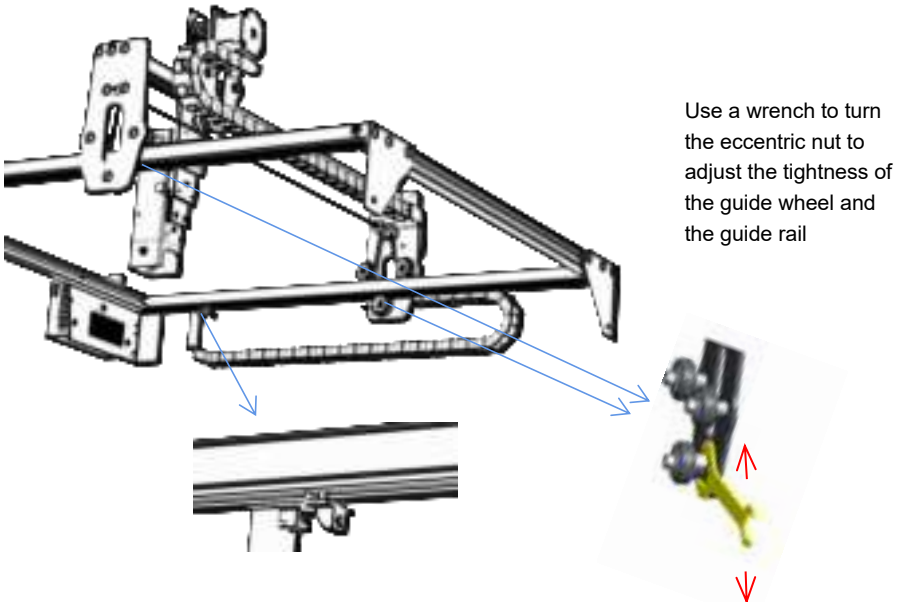

TIPS: How to determine the tightness of eccentric nuts?

Under the condition of ensuring that the bracket does not shake, you can lift one end of the machine to an angle of 45 degrees with the horizontal plane, and release the X-axis or Y-axis bracket from a high place. If the bracket can slide at a constant speed to the end, the tightness is suitable.