

# ZUOLOG INC

# INSTALLATION INSTRUCTIONS

HIGH EFFICIENCY

ONE PIECE

# TOILET

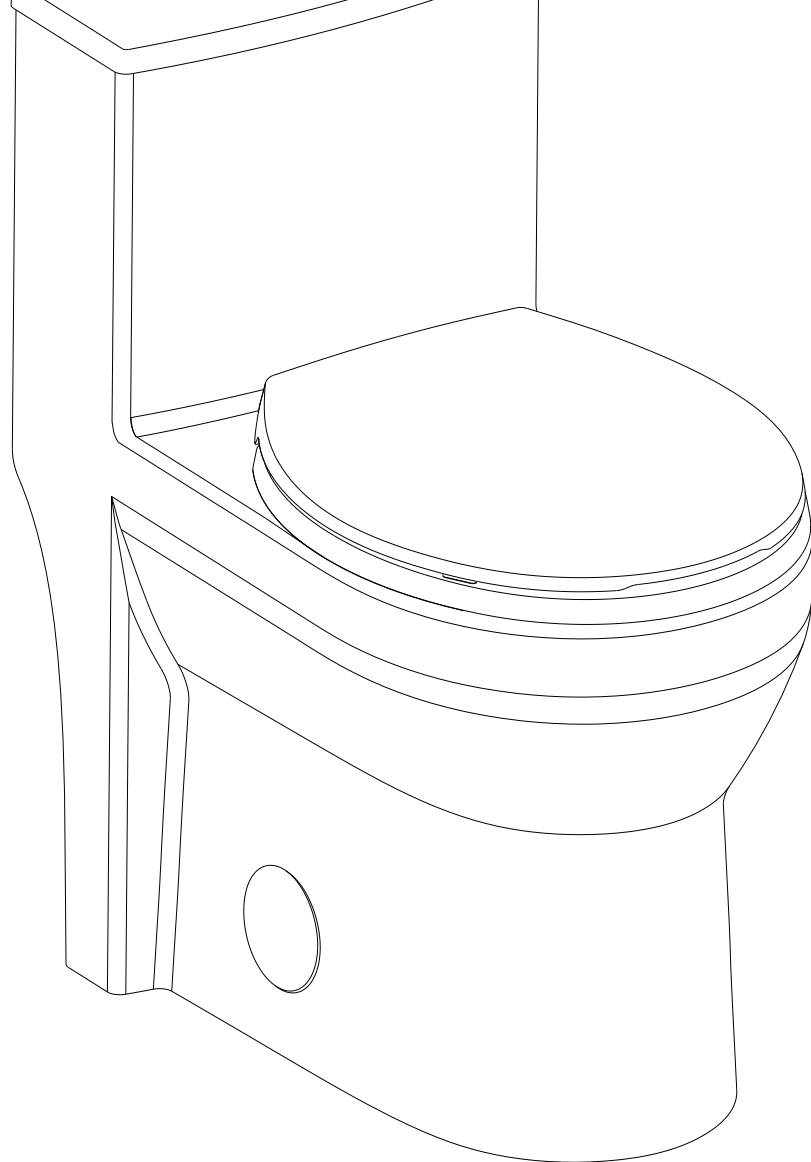

☎ 585 488 8279 @ jodie.j.spencer@outlook.com

## Trouble shooting:

Missing / Wrong / Broken parts and installation issues



Send email with your question, pic and order NO. to **support@idealhouse.vip**



Respond within 24 hours



Issue resolved



**READ ALL INSTRUCTIONS BEFORE UNPACKING THE PRODUCT**



INSTRUCTIONS THAT, IF IGNORED, COULD RESULT IN DEATH OR SERIOUS INJURY CAUSED BY INCORRECT HANDLING OR INSTALLATION OF THE PRODUCT. THESE INSTRUCTIONS MUST BE OBSERVED FOR SAFE INSTALLATION.

**ATTENTION !**



**2 PEOPLE ARE REQUIRED TO LIFT AND DURING ENTIRE INSTALLATION OF THIS PRODUCT**



**INSTALLATION OF THIS PRODUCT BY AN INEXPERIENCED INSTALLER MAY RESULT IN PERSONAL INJURY OR DEATH!**



We reserves the right to change, update, modify, alter, redesign this manual/product or its policies without prior notice!  
It is your responsibility to visit the website to download or contact customer service for the most updated version of the installation instructions.

We shall not be liable for any injuries or property damages in connection with this product during installation or use of this product!

- Limited warranty is void on any commercial installation.
- We are not responsible for local code compliance for this product.
- Building and plumbing codes may vary from state-to-state in accordance to your location.
- We are not responsible for providing any compliance certifications.
- We are not responsible to provide any type of certifications for this product.
- Under no circumstances we shall not be liable for any and all incidental damages sustained in connection with this product Neither manufacture, nor distributor, nor retailer is responsible for water damage or flood caused due to use of this product.
- Under no circumstances We shall not be liable for any and all fees, cost of installation/re-installation/removal, subsequent damage or transportation in case of the product defect.

## TOOLS REQUIRED FOR INSTALLATION



Silicone



Level



Tape Measure



Socket extension



Safety Glass



Putty Knife



Knife



Soft Cloth



Pencil / Marker



Channel Pliers



Wrench



Wrench

## Installation Instructions

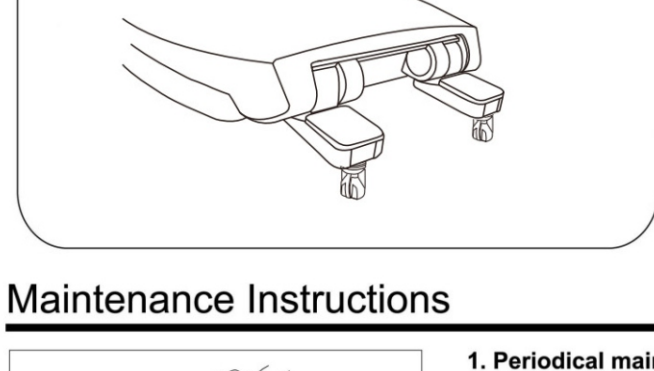
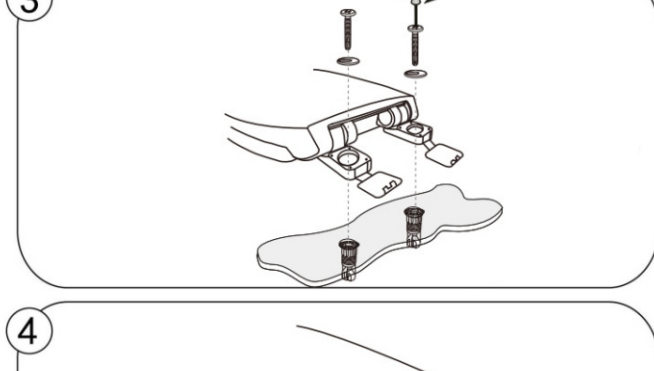
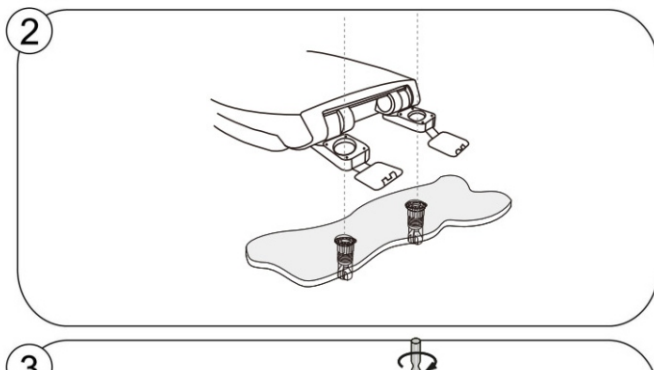
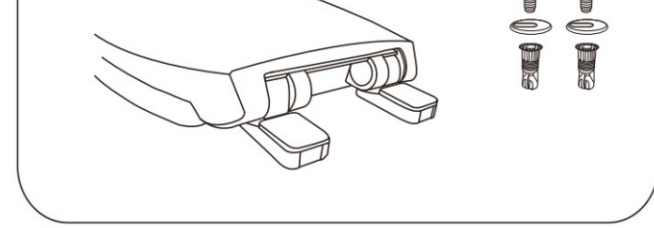

1. It comes with plastic install package:

2\*long bolt, 2\*stainless steel washer,

2\*Nylon expansion plug

2. Put the nylon pop plug into the toilet mounting hole.

Place the toilet seat onto the toilet bowl

with the hinge base overlapping the bolt

holes in the bowl.

3. Insert stainless steel gasket into hinge

mounting hole.insert the long bolts

through the mounting holes from the top.

Use a screwdriver to tighten the screws

4. Please check if it is installed properly,

check if it is already tight and not shaking.

If shaking occurs, you need to re-adjust the

position of the toilet seat mounting holes and

the position between the toilet, if the toilet

seat is completely consistent, it will not

loosen.

※ In the last step, if there is no problem, you

need to close the lid of the installation hole

on the toilet seat.

## Maintenance Instructions

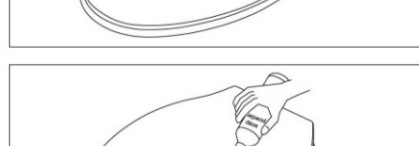

### 1. Periodical maintenance

•Wash the toilet seat with soft wet cloth.

•Dry with soft dry cloth.

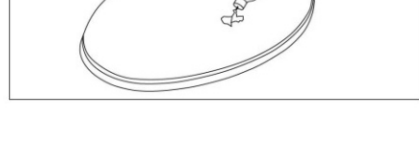

### 2. Removal of stains

•Use neutral detergent(e.g. soap powder) to wipe softly, then

dry with clean cloth.

•Do not use eradicator, abrasive powder, diluent, volatile oil,

acid or alkali liquid detergent and nylon brush to clean the

product, to avoid damage.

## Care Instructions:

Please read carefully the following maintenance manual in order to avoid component

damage or injury to the installer.

Keep the maintenance manual available for future maintenance or reference.



**PRECAUTIONS:** Follow all safety precautions to avoid personal injury or property damage.

## ⊘ "Prohibited acts"

		1. Do not open/close the seat cover using unnecessary force. (It might cause cracks or failure on performance)	
		2. Heavy loading may damage the seat cover and may cause a fall.	
		3. Do not use strong abrasive cleansers, which might cause damage to the surface	
		4. Clean the surface of the toilet seat with mild soap water.	
		5. Use a clean and soft cloth to wipe the toilet seat until it is completely dry	
		6. Keep children out of reach of the seat, to avoid personal injury.	
		7. Do not open/close the seat cover using unnecessary force. (It might cause cracks or failure on performance)	
		8. Do not expose the seat cover directly to sunlight. (It might cause color fading)	

## TOILET INSTALLATION

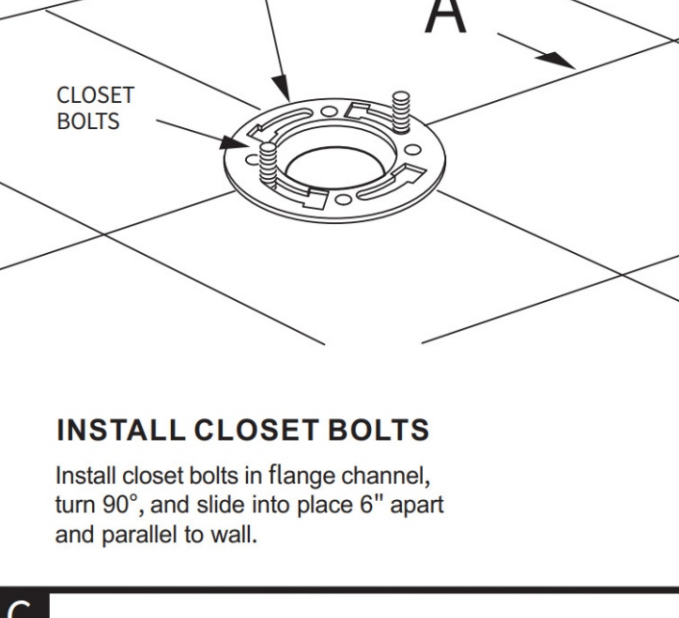

### INSTALL CLOSET BOLTS

Install closet bolts in flange channel, turn 90°, and slide into place 6" apart and parallel to wall.

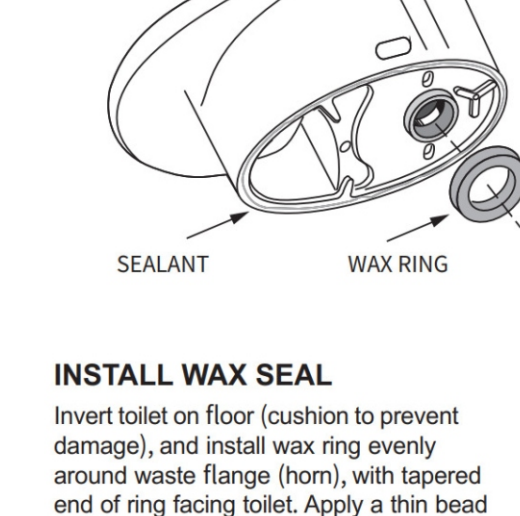

### INSTALL WAX SEAL

Invert toilet on floor (cushion to prevent damage), and install wax ring evenly around waste flange (horn), with tapered end of ring facing toilet. Apply a thin bead of sealant around toilet base.

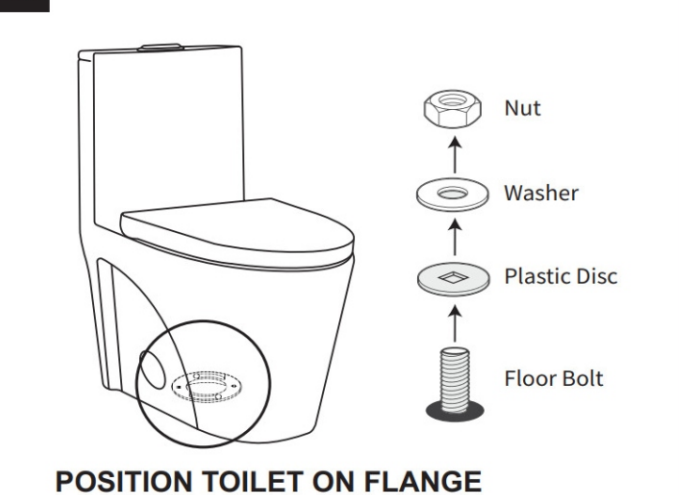

### POSITION TOILET ON FLANGE

\*Unplug floor waste opening and install toilet on closet flange so bolts project through mounting holes.

\*Loosely install retainer washers and nuts.

\*Position toilet squarely to wall and, with a rocking motion, press bowl down fully on wax ring and flange. Alternately tighten nuts until toilet is firmly seated on floor.

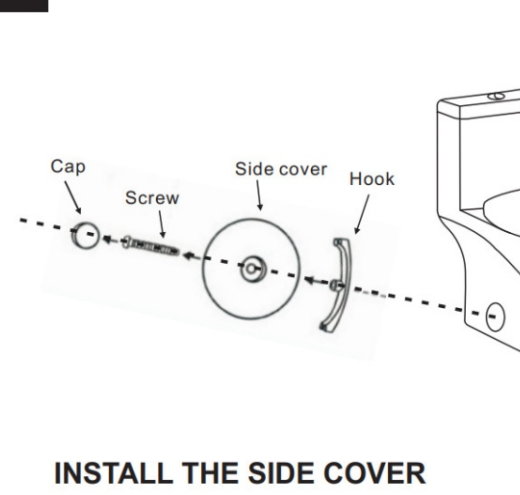

### INSTALL THE SIDE COVER

\*Adhere the side bolt covers to toilet.