

eufy

QUICK START GUIDE

eufy Indoor Cam E30



Setting Up the System

1. Download and install the eufy Security app, then sign in or create an account.



2. Follow the in-app instructions to add this device and complete the setup.

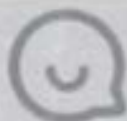

For online support, tutorial videos, FAQs, and more information, please visit <https://support.eufy.com/s/>



Scan the QR code to read the detailed user guide.



Important Safety Instructions

- The recommended temperature range for devices and accessories is 0°C to 40°C (32 °F to 104 °F).
- Unless specifically indicated that it is safe to do so in the user guide or instruction manual, do not use the device in an environment that exceeds the recommended low or high temperature.
- Unless specifically indicated that it is safe to do so in the user guide or instruction manual, avoid exposing your device to direct sunshine or excessively wet environments.
- For pluggable equipment, the socket outlet should be easily accessible.
- Use only the adaptor provided by the manufacturer. Using unauthorized adapters may cause danger and violate the authorized use of the device or the warranty article.

Child Safety

- **THIS DEVICE IS NOT A TOY.**
- **Choking Hazard:** This product contains (or comes with) small parts, plastic elements, cables, and parts that may cause choking hazards. Keep your camera and its accessories out of the reach of small children. Consult a physician immediately if small parts are swallowed.
- **Strangulation Hazard:** Children get strangled in cords. Keep cords out of the reach of children (more than 3 ft / 0.9 m away).

Notice

FCC Statement

This device complies with Part 15 of the FCC Rules. Operation is subject to the following two conditions: (1) this device may not cause harmful interference, and (2) this device must accept any interference received, including interference that may cause undesired operation.

Warning: Changes or modifications not expressly approved by the party responsible for compliance could void the user's authority to operate the equipment.

Note: This equipment has been tested and found to comply with the limits for a Class B digital device, pursuant to Part 15 of the FCC Rules. These limits are designed to provide reasonable protection against harmful interference in a residential installation.

This equipment generates uses and can radiate radio frequency energy and, if not installed and used in accordance with the instructions, may cause harmful interference to radio communications. However, there is no guarantee that interference will not occur in a particular installation. If this equipment does cause harmful interference to radio or television reception, which can be determined by turning the

equipment off and on, the user is encouraged to try to correct the interference by one or more of the following measures: (1) Reorient or relocate the receiving antenna. (2) Increase the separation between the equipment and receiver. (3) Connect the equipment into an outlet on a circuit different from that to which the receiver is connected. (4) Consult the dealer or an experienced radio/TV technician for help.

FCC Radio Frequency Exposure Statement

The device has been evaluated to meet general RF exposure requirements. The device can be used in fixed/mobile exposure condition. The min separation distance is 20cm.

Notice: Shielded cables

All connections to other computing devices must be made using shielded cables to maintain compliance with FCC regulations.

The following importer is the responsible party

Company Name: POWER MOBILE LIFE, LLC

Address: 10800 NE 8TH ST #900, BELLEVUE, WA, 98004, UNITED STATES

Telephone: 1-800-988-7973

IC Statement

This device complies with Industry Canada licence-exempt RSS standard(s). Operation is subject to the following two

conditions:

- (1) this device may not cause interference, and
- (2) this device must accept any interference, including interference that may cause undesired operation of the device.

Le présent appareil est conforme aux CNR d'Industrie Canada applicables aux appareils radio exempts de licence.

L'exploitation est autorisée aux deux conditions suivantes:

- (1) l'appareil ne doit pas produire de brouillage, et
- (2) l'utilisateur de l'appareil doit accepter tout brouillage radioélectrique subi, même si le brouillage est susceptible d'en compromettre le fonctionnement.

This Class B digital apparatus complies with Canadian ICES-003.

Cet appareil numérique de la classe B est conforme à la norme NMB-003 du Canada.

IC RF Statement

When using the product, maintain a distance of 20cm from the body to ensure compliance with RF exposure requirements.

Lors de l'utilisation du produit, maintenez une distance de 20 cm du corps afin de vous conformer aux exigences en matière d'exposition RF.



Your product is designed and manufactured with high-quality materials and components, which can be recycled and reused.



This symbol means the product must not be discarded as household waste and should be delivered to an appropriate collection facility for recycling.

Proper disposal and recycling help protect natural resources, human health, and the environment. For more information on the disposal and recycling of this product, contact your local municipality, disposal service, or the shop where you bought this product.

Use of the Works with Apple badge means that an accessory has been designed to work specifically with the technology identified in the badge and has been certified by the developer to meet Apple performance standards. Apple is not responsible for the operation of this device or its compliance with safety and regulatory standards.

Customer Service



12-month limited warranty



(US/Canada) +1 (800) 988 7973

(AU) +61 3 8331 4800

(UK) +44 (0) 1604 936200

(DE) +49 (0) 69 9579 7960

(中国) +86 400 0550 036

(日本) 03 4455 7823

(Egypt) +20 80000000826

(UAE) +971 8000320817

(Kuwait) +965 22069086

(KSA) +966 8008500030



support@eufy.com

service@myeufy.com.au (AU)



@EufyOfficial



@EufyOfficial



@EufyOfficial



Anker Innovations Limited. All rights reserved,
registered in the United States and other countries.

Anker Innovations Limited
Unit 56, 8th Floor, Tower 2, Admiralty Centre, 18
Harcourt Road, Hong Kong



Model: T8417
51005004962_V2

What's in the Box



Indoor Camera

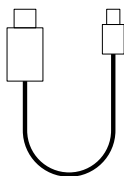

USB-C Charging Cable

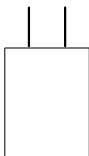

Power Adapter

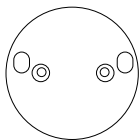

Mounting Bracket



Positioning Sticker

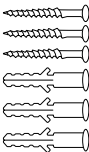

Screw Pack



Quick Start Guide

At a Glance

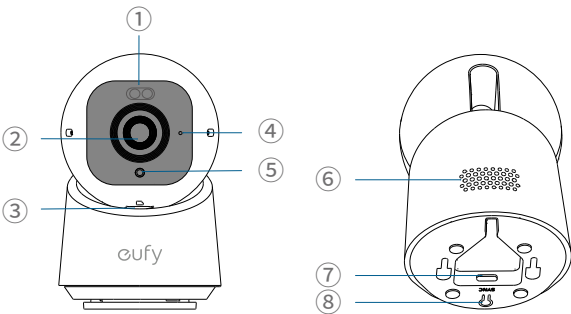

❶	Spotlight
❷	Lens
❸	microSD Card Slot <ul style="list-style-type: none">• Insert a microSD card* (not included) to store recordings*Use at least a Class 10 microSD card with a maximum of 128GB.
❹	Microphone
❺	LED Indicator
❻	Speaker
❼	Power Input
❽	SYNC Button

Setting up the System

1. Download and install the eufy Security app, then sign up or create an account.
 - The app version must be Android 4.9.3_435 / iOS4.9.35_1651 or later.



2. Connect the camera to a power source and wait until the status LED turns solid blue.

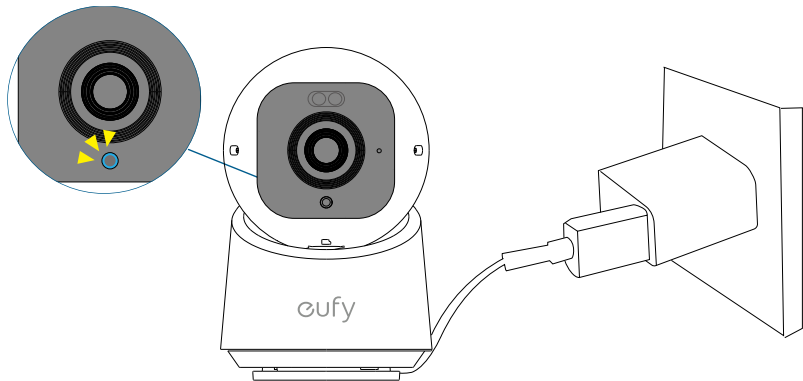

3. Select **Add Device** on the home screen of the app, then select **Wired Camera** > **Indoor Cam E30** in the device family, and follow the in-app instructions to add your camera.



LED Light Guide

	Solid Violet	System is initializing
	Solid Blue	Working normally or ready for setup
	Blinking Red	Not connected to the internet
	Solid Red	Recording or the live stream is being viewed
	Flashing Blue and Red	Firmware upgrade in progress *Keep the camera connected to a power source

Installing your Camera

Choose a Location

The camera can be placed on a table or shelf, or mounted on a wall or ceiling. Choose a location and height that achieves your desired view and is within reach of a power outlet.

- 💡 Keep the camera at least 0.7 ft (0.2 m) away from any objects or walls to avoid infrared reflections that can impact night vision performance.

Camera Field of View

On a Table or Shelf

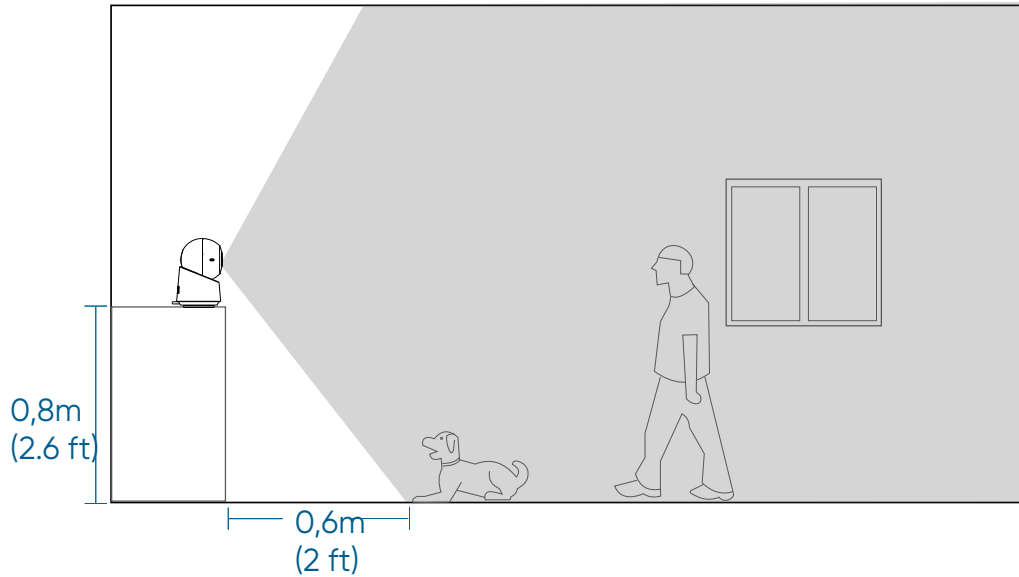

On the Wall

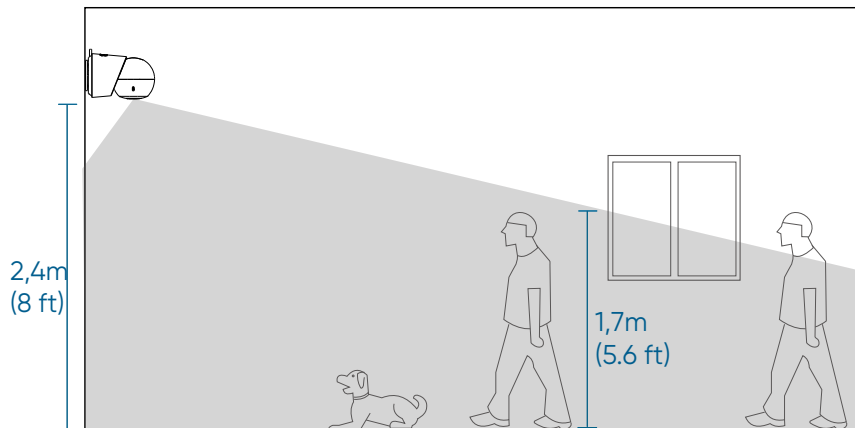

On the Ceiling

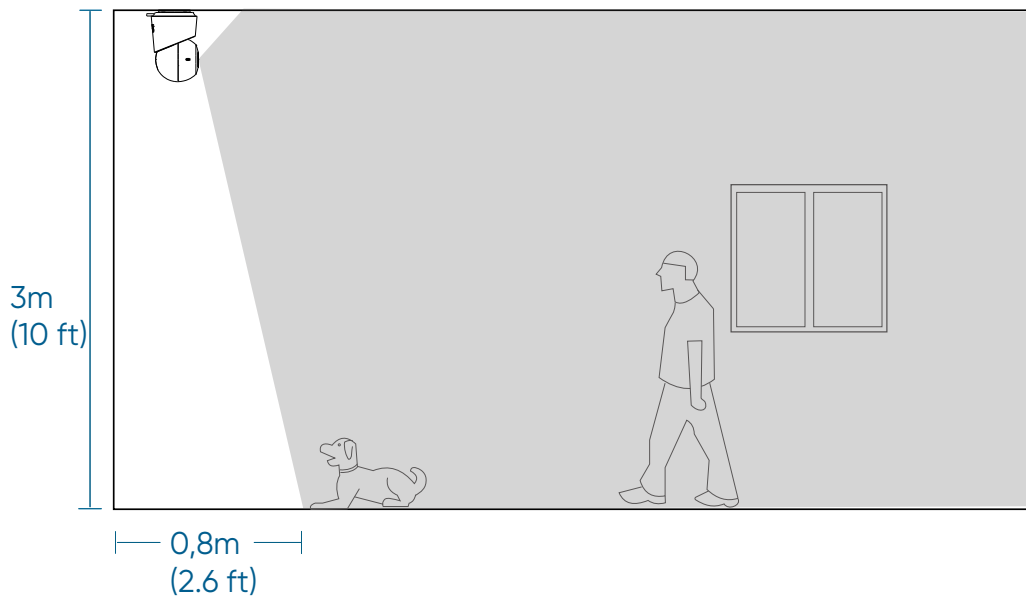

Mount on a Wall or Ceiling

 **Warning:** Disconnect the camera from the power outlet before mounting.

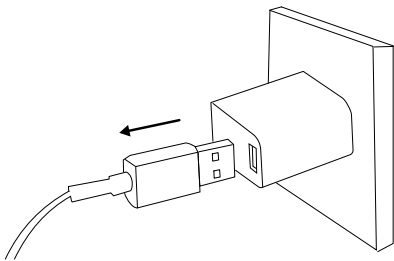

1. Mark the screw positions on the wall or ceiling with the positioning sticker and drill a pilot hole.

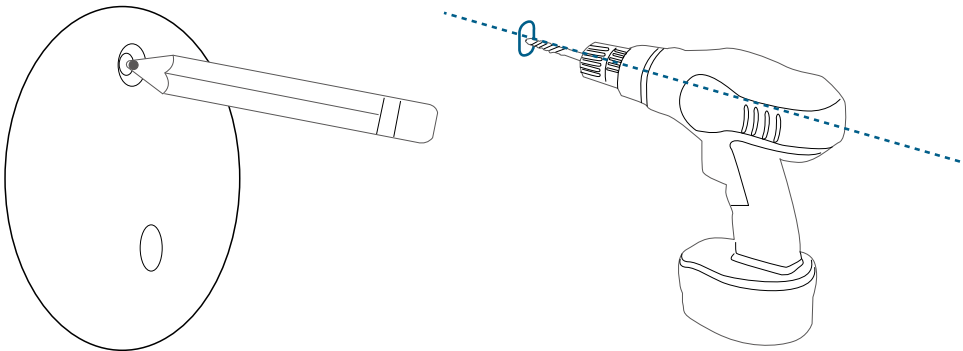

2. Hold the mounting plate on the wall and make sure the "UP" arrow is pointing, then secure the mounting plate on the wall or ceiling with the screws.

- On the Wall

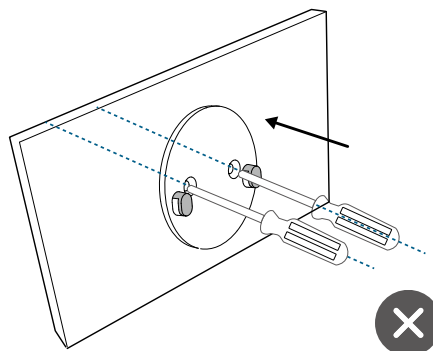
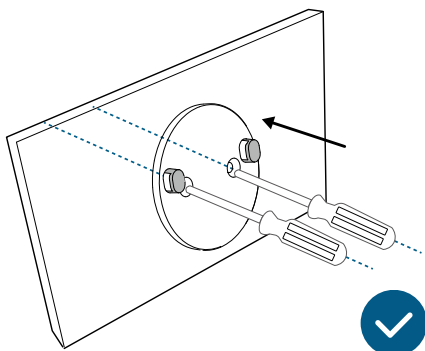

- On the Ceiling

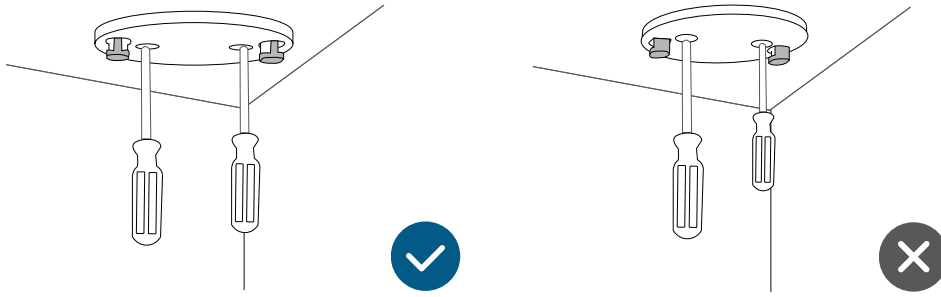

3. Unplug the camera. Connect the USB-C cable to the camera with the other end disconnected from a power source.

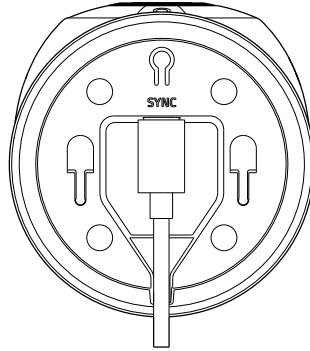
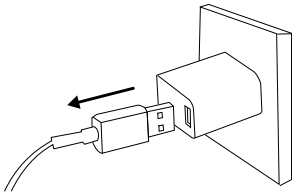

4. For wall mounting, place the cable into the cable channel of the mounting plate.

- Skip this step for ceiling installation.

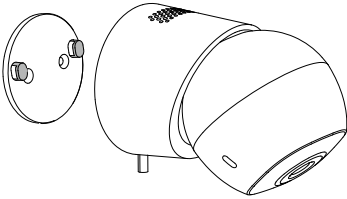

5. Slide the camera onto the mounting plate and make sure it is securely attached.

- On the Wall

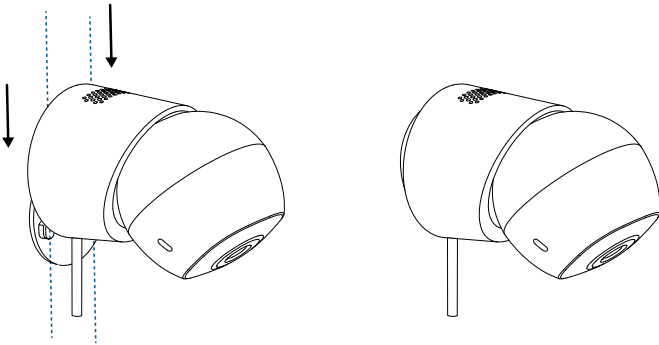

- On the Ceiling

