

V10

Wireless Sound Card Lavalier Microphone

Product Instruction Manual



Precautions

1. Do not leave this product in a high temperature and humid or rainy environment, please use it in a ventilated and dry place;
2. Do not open the back cover, if you need to repair, please contact the after-sales personnel; charger to charge both receiver and transmitter.
3. This product does not include a charger in the packaging, please use a 5V 1A If you need to charge them during use, it is recommended to use a mobile
4. This product is not waterproof, please ensure that the device should power bank to avoid current noise; not be exposed to water droplets or splashes.

Product description

«This is a wireless sound card microphone (Mini lavalier), two-way stereo low-latency wireless digital transmission, 48K sampling rate, high-quality audio;

- The wireless microphone supports stereo monitoring; please contact the after-sales team;
- Support Bluetooth and AUX accompaniment audio input;
- Support mobile phone live broadcast, support OTG digital stereo (requires mobile phone to support Type-C interface and support OTG function);
- Suitable for live broadcast, shooting Vlog, teaching, speech, conference and other purposes;
- Can be connected to various smart phones, tablets, notebooks and other devices via Bluetooth;
- Support wireless remote control, extremely convenient to control;
- Built-in professional DSP sound processor for reverberation and mixing processing;
- The sound card in this device is powered by a built-in 600mAh lithium battery, and the wireless microphone is powered by a built-in 500mAh lithium battery.

Product specifications

1. Support single wireless mic receiver

- Working distance: 10m (32ft).
- Audio frequency: 35Hz~20KHz stereo 48K sampling rate.
- Delaying: 23ms.
- Continuous Working time: 7 hours (500mAh polymer battery).
- Low battery reminder and automatic shutdown.

2. Receive bluetooth stereo accompaniment from smartphones, tablets or laptops.

- Working distance: 8m (26ft).
- Bluetooth 4.2, support A2DP.
- Automatically connect to the last bluetooth device.

3. Automatically connect to the last bluetooth device.

- 48K 16 bits high quality sampling.
- Digital vocal reverb effect processing, 2 reverb modes.
- Monitor volume independent adjustment.
- Supports simultaneous input of Bluetooth and AUX accompaniment.

4. Special features

- Support Wireless headset + wired headset dual live broadcasts.
- Director mode: The sound of the director can only be monitored by the wireless microphone and will not be live broadcasted.
- Support 8 special effect sound.
- Support ducking function (microphone first, if the microphone has sound input, the accompaniment will be automatically volume reduced)

Product content (Note: The picture is for reference only, please refer to the actual product)

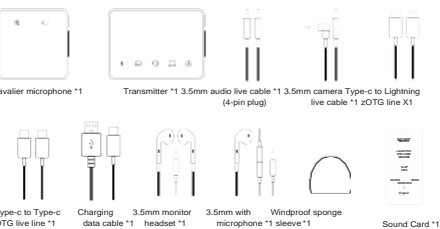

Battery management

- Charging input: USB charger 5V 1A Type-C interface
- Remote control power supply: CR2032 button battery

1. It is recommended to turn off the battery for charging. If you want to charge it when it is turned on, it is recommended to use a mobile power bank to avoid interference with the current sound. Sound card and wireless microphone takes 3.5 hours to be fully charged.
2. Use a 5V 1A USB charger or power bank for charging. When the sound card is inserted into the charger, the charging port's red light is on; when fully charged, the blue light is on;
3. After the sound card is fully charged, the continuous use time is about 7 hours. When the sound card is low in power, the voice broadcast is low, and the position of the charging port is red and blue to flash instead. It will automatically shut down after 2 minutes;
4. After the lavalier microphone is fully charged, the continuous use time is about 7 hours. After the power is turned on, the blue light of the battery is always on, indicating that the battery is normal. Blinking instead, it means low power, plug in the charger, the red light is always on, when it is fully charged, the blue light is always on, and the red light is off.

Sound card panel introduction

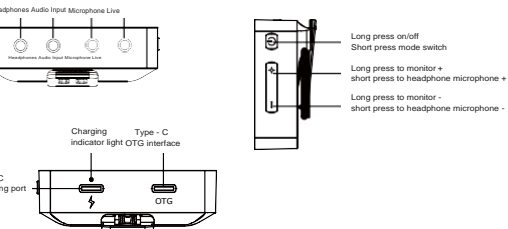

Lavalier microphone panel introduction

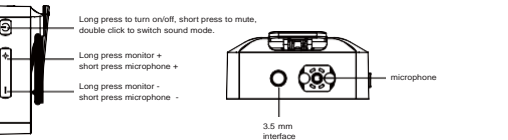

Steps to set up

- 1- Connect the device with a live cable (Type-C OTG live cable/Lightning OTG live cable/3.5mm live cable);
- 2- Long press the "power" button on the device to turn on
- 3- Press and hold the power button of the lavalier microphone to turn it on, the indicator will flash after booting, and the indicator will be always on after the device is successfully connected with phones or tablets. Insert 3.5mm monitor headphones into the 3.5mm headphone jack on top of the microphone as needed;
- 4- Use the buttons of the device or the wireless remote control to control the function and adjust the sound;
- 5- Insert a 3.5mm wired headset to the transmitter for live broadcast or direct broadcast according to the needs of live broadcast;
- 6- Connect the accompaniment input via AUX or Bluetooth as needed.

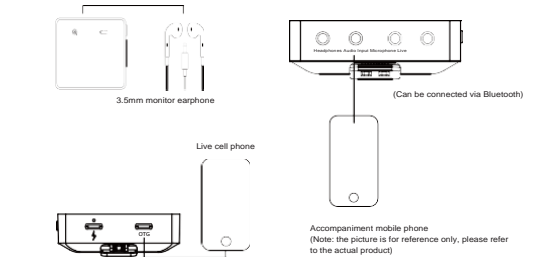

Live mode switch

Short press the power button of the sound card or the mode button of the remote control to switch the mode;
--An Apple mobile phone is plug and play, some Android mobile phones (OPPO VIVO brand) need to open the OTG function first in the setting interface
--When an Apple mobile phone is connected with OTG, the sound card can also be plugged into a charger or a power bank to charge the mobile phone at the same time. (It is recommended to use a mobile power supply to avoid current noise due to access to 220V mains)



Wired + wireless double live broadcast features:
the real-time sound of the wired headset can be heard in the wired headset, and the sound of the wired headset can be broadcast live at the same time



Director mode Features:
You can't hear the sound of the wired headset in the wired headset, and the wireless microphone can hear it but it will not be broadcast live



Features of computer live broadcast mode:
Can not hear the sound of the wired headset, can hear the wireless microphone but will not be broadcast live, and the OTG internal recording function is turned on

Bluetooth accompaniment function

A short press of the bluetooth icon button on the remote control, Enable bluetooth accompaniment, If the Bluetooth status indicator blinks slowly, the sound card is not connected yet.

- Turn on the bluetooth function of your phone, Search bluetooth device named G63 point connection, When the bluetooth status light of the sound card is steady on, the connection is successful.

- Play music from your phone to your sound card.



Status light function introduction



Lavalier microphone status light function introduction

1. If the status indicator blinks slowly, the collar microphone is not connected to the Mini sound card.
2. After the is turned on, the blue light is always on, indicating that the power is normal; the red and blue flashes alternately, indicating that the power is low;

Sound card status light function introduction

1. Director mode: switch to this mode, the indicator light is always on, otherwise it is off;
2. Wired + wireless live broadcast mode: switch to this mode, the indicator light is always on, otherwise it is off;
3. Director mode: switch to this mode, the indicator light is always on, otherwise it is off;
4. Computer mode: switch to this mode, the indicator light is always on, otherwise it is off;
5. Dodge mode: enter this mode, the indicator light is always on, otherwise it is off;
6. Power indicator: normal power, the blue light is always on; low power, red and blue flash alternately; plug in the charger, the charging port red light is always on, and the blue light is always on when fully charged.

Status light function introduction

Connect the OTG jack of the sound card and the live mobile phone with an OTG cable according to the connection diagram;
--An Apple mobile phone is plug and play, some Android mobile phones (OPPO VIVO brand) need to open the OTG function first in the setting interface
--When an Apple mobile phone is connected with OTG, the sound card can also be plugged into a charger or a power bank to charge the mobile phone at the same time. (It is recommended to use a mobile power supply to avoid current noise due to access to 220V mains)

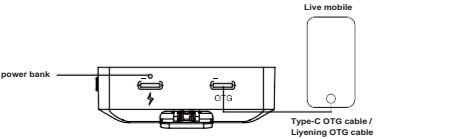

Status light function introduction

-- According to the connection diagram, use a 3.5mm headphone audio cable to connect the 3.5mm live interface of the host and the headphone interface of the live mobile phone;
-- Play the music of the mobile phone, which can be transmitted to the wireless headset and the wired headset connected to the host; Open the live broadcast software or the voice recorder that comes with the mobile phone, and test whether the sound output by the host can be received by the live broadcast mobile phone.

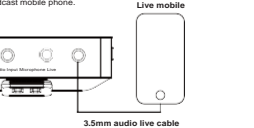

Status light function introduction

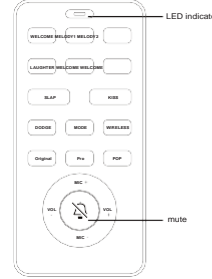

LED indicator

mute

Button Function Description

Microphone + Microphone volume up

Monitor + Monitor volume down

Microphone - Microphone volume down

Monitor + Monitor volume increase

Mute Mute the microphone

Warranty Card

Name:

Contact Number:

Problem Description:

Purchase time:

Contact Address:

Warranty

1. Within three months from the date of sale of the product, if there is a performance failure, the product itself and the outer packaging must be kept intact and free of scratches, and the product of the same model can be replaced (subject to inspection)but does not include man-made damage.
2. The product is guaranteed for one year from the date of sale, and the accessories are not covered by the warranty.
3. The warranty service is only valid under normal use.
4. All external damage, such as man-made damage, self-disassembly, unpacking, improper use, etc., are not covered by the warranty. Warranty needs to provide this card, if we fail to provide this card or alter this card, the company has the right to deal with it as non-warranty.

This device complies with part 15 of the FCC Rules.
Operation is subject to the following two conditions:
(1) This device may not cause harmful interference, and
(2) this device must accept any interference received, including interference that may cause undesired operation.

Note: This equipment has been tested and found to comply with the limits for a Class B digital device, pursuant to Part 15 of the FCC Rules. These limits are designed to provide reasonable protection against harmful interference in a residential installation. This equipment generates, uses and can radiate radio frequency energy and, if not installed and used in accordance with the instructions, may cause harmful interference to radio communications.

However, there is no guarantee that interference will not occur in a particular installation. If this equipment does cause harmful interference to radio or television reception, which can be determined by turning the equipment off and on, the user is encouraged to try to correct the interference by one or more of the following measures: Reorient or relocate the receiving antenna. Increase the separation between the equipment and receiver. Connect the equipment into an outlet on a circuit different from that to which the receiver is connected. Consult the dealer or an experienced radio/TV technician for help.

Warning: Changes or modifications to this unit not expressly approved by the part responsible for compliance could void the user's authority to operate the equipment.

FCC Radiation Exposure Statement
The device has been evaluated to meet general RF exposure requirement. The device can be used in portable exposure condition without restriction.

