

**CHEFMAN.**

# INSTACOFFEE LIFT

**SELECT MAX +**

## **USER GUIDE**

- Safety Instructions
- Features
- Operating Instructions
- Tips
- Cleaning and Maintenance
- Terms and Conditions
- Warranty Registration

RJ14-IC-LR

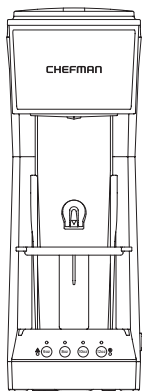



## COOKING FORWARD™

### Welcome!

Whether this is your first Chefman® appliance or you're already part of our family, we're happy to be brewing with you. With your new InstaCoffee Lift Select Max +, you can quickly make a cup of joe to enjoy at home or to take on the road. The unit features a convenient adjustable lift to prevent splattering when using smaller mugs, and can also fit larger travel mugs. Brew with pre-measured K-Cup® capsules\* or fill the reusable coffee filter with your favorite freshly ground coffee. Plus, with four brew sizes and a large 40-oz water reservoir, you can brew multiple cups before refilling the unit, saving you time on those busy mornings.

Because we want to make sure you get the best cup of coffee possible, we ask that you take a couple of minutes to read our directions, safety instructions, and warranty information.

From our kitchen to yours,  
**The Chefman® Team**



**READ ALL INSTRUCTIONS BEFORE USE**  
For your safety and continued enjoyment of this product, always read the instruction manual before using.

\*K-Cup® is a registered trademark of Keurig Green Mountain, Inc. The Chefman® InstaCoffee is not affiliated with or sponsored by Keurig Green Mountain, Inc.





## CONTENTS

- 4** Safety Instructions
- 8** Features
- 9** Operating Instructions
- 13** Tips
- 14** Cleaning and Maintenance
- 16** Terms and Conditions
- 18** Warranty Registration





# SAFETY INSTRUCTIONS

## IMPORTANT SAFEGUARDS

When using electrical appliances, basic safety precautions should always be followed, including the following:

1. Read all instructions.
2. Do not touch hot surfaces. Use caution when handling coffee and other hot liquids.
3. To protect against electric shock, and injury to persons, do not immerse cord or plug in water or other liquid.
4. Close supervision is necessary when any appliance is used by or near children.
5. Unplug from outlet when not in use and before cleaning. Allow to cool before putting on or taking off parts, and before cleaning the appliance.
6. Do not operate any appliance with a damaged cord or plug, or after the appliance malfunctions, or has been damaged in any manner. Contact Chefman® Customer Support for examination, repair, or adjustment.
7. The use of accessory attachments not recommended by Chefman® may result in fire, electric shock, or injury to persons.





# SAFETY INSTRUCTIONS

## IMPORTANT SAFEGUARDS

8. Do not use outdoors.
9. Do not let cord hang over edge of table or counter, or touch hot surfaces.
10. Do not place on or near a hot gas or electric burner, or in a heated oven.
11. To disconnect, turn any control to off, then remove plug from wall outlet.
12. Do not use appliance for other than intended use.
13. Scalding may occur if the lid is opened during the heating cycle.
14. Only use single-serve capsules intended for this appliance. If the capsule does not fit, do not force the capsule into the appliance.

**FOR HOUSEHOLD USE ONLY**  
**SAVE THESE INSTRUCTIONS**



# SAFETY INSTRUCTIONS

## IMPORTANT SAFEGUARDS

**WARNING:** This appliance has a polarized plug (one blade is wider than the other). To reduce the risk of electric shock, this plug will fit in a polarized outlet only one way. If the plug does not fit the outlet perfectly, reverse the plug. If it should still not fit, contact a qualified electrician. Do not modify the plug in any way.

### SHORT CORD INSTRUCTIONS

A short power-supply cord is provided to reduce the hazards of entanglement or tripping over a longer cord. Longer detachable power-supply cords or extension cords are available and may be used if care is exercised in their use. If a longer detachable power-supply extension cord is used:

1. The marked electrical rating of the extension cord should be at least as great as the electrical rating of the appliance.
2. The longer cord should be arranged so that it will not drape over the countertop or tabletop where it can be pulled on by children or tripped over.





# SAFETY INSTRUCTIONS

## IMPORTANT SAFEGUARDS

### POWER CORD SAFETY TIPS

1. Never pull or yank on cord or the appliance.
2. To insert plug, grasp it firmly and guide it into outlet.
3. To disconnect appliance, grasp plug and remove it from outlet.
4. Never use the product if the power cord shows signs of excessive wear. Contact Chefman® Customer Support for additional guidance and support.
5. Never wrap the cord tightly around the appliance, as this could place undue stress on the cord where it enters the appliance and cause it to fray and break.

**DO NOT OPERATE APPLIANCE IF THE POWER CORD SHOWS ANY DAMAGE OR IF APPLIANCE WORKS INTERMITTENTLY OR STOPS WORKING ENTIRELY.**

*California Proposition 65:  
(Applicable for California Residents only)*



**WARNING:**

Cancer and Reproductive Harm -  
[www.P65Warnings.ca.gov](http://www.P65Warnings.ca.gov).



**Do not place the appliance on a stovetop or any other heatable surface, even if stovetop is not on. Doing so is a fire hazard.**



## FEATURES

1. Lid Release Button (on top)
2. Brew Chamber Lid
3. Puncturing Needles (second needle located inside bottom of capsule receptacle, not shown)
4. Brew Chamber
5. Drip Spout
6. Movable Lift Button
7. Movable Lift
8. Removable Rubber Trivet
9. Overheat Warning Light
10. Brew Buttons/Indicator Lights (6, 8, 10, and 12 oz)
11. Low Water Warning Light
12. Power Button
13. 40-oz Removable Water Reservoir
14. Water Reservoir Lid
15. Removable Capsule Receptacle (for K-Cup® pods)
16. Large Reusable Coffee Filter

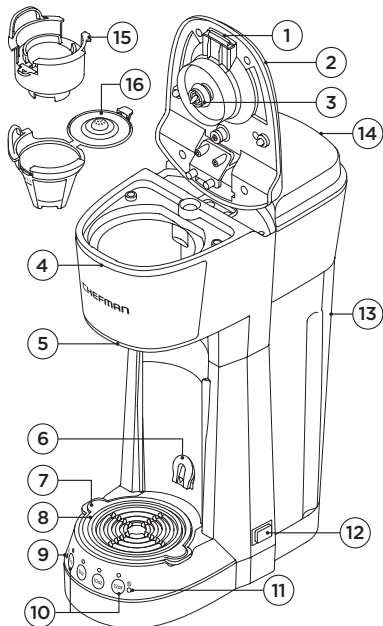





# OPERATING INSTRUCTIONS

## BEFORE FIRST USE

1. Remove all packing materials and stickers from the inside and outside of the unit. Be sure that all parts are included before throwing out packaging.
2. Gently wipe down the exterior with a damp cloth or paper towel. Never immerse the brewer, its base, cord, or plug in water or any other liquid. The electrical connections and the brew buttons must never come into contact with water or any other liquid.
3. Remove and hand wash the water reservoir and lid with warm, soapy water. Rinse and dry well before returning them to the unit.
4. Rinse the coffee filter with water. Wash the capsule receptacle with a sponge and warm, soapy water. Dry completely.
5. To rinse the brewer's internal parts of any manufacturing residue, we recommend "brewing" a plain, 12-oz cup of hot water with NO coffee. Follow the instructions starting on p. 10, but insert the empty capsule receptacle and select the 12 oz brew button.





# OPERATING INSTRUCTIONS

## HOW TO USE THE INSTACOFFEE

1. If not already plugged in, plug in the unit. Ensure the rubber trivet is set in place on the base.
2. Fill the water reservoir by either using a pitcher to fill it while on the unit or removing it from the unit to fill at the sink. Remove the reservoir lid and fill with cold water (preferably filtered or bottled) up to but not exceeding the MAX line. (If you wish to remove the reservoir to fill, lift it up and away from the unit. To replace, hold it above its position on the base and set it down until the bottom locks in and the side of the reservoir is flat against the unit.) Replace the reservoir lid.
3. To open the brew chamber, press the lid release button.  
**CAUTION:** When opening the lid and handling the capsule receptacle, be mindful of two small, sharp puncturing needles located above and inside the capsule receptacle that puncture the K-Cup®.
4. If using a K-Cup®, you must also use the capsule receptacle. Place the receptacle into the brew chamber. The looped handle should be positioned on the left, and the word “front” and the arrow below it (printed on the inner rim of the receptacle) should be positioned toward the front.
5. Insert the K-Cup® into the capsule receptacle. Press on the K-Cup® firmly until you hear it being punctured. **CAUTION:** Always use the capsule receptacle when brewing with K-Cups®; if the receptacle is not used, the K-Cup® may explode.





## OPERATING INSTRUCTIONS

6. If using ground coffee, you must also use the reusable coffee filter. Spoon the desired amount of coffee into the filter up to but not exceeding the MAX line on the filter. (The filter can hold up to 15 grams of ground coffee.)
7. Once filled, gently push the coffee filter's lid closed so it snaps into place. Place the filled coffee filter into the brew chamber so that the word "front" is facing the front of the unit. **NOTE:** Do not use the capsule receptacle if brewing with the reusable coffee filter.
8. Push the brew chamber lid down until it clicks into place.
9. If using a tall cup or travel mug, place it securely on the base with the movable lift in its lowest position. If using a shorter mug, you can bring it closer to the drip spout by raising the movable lift until it clicks into the upper position. Place the mug securely on the raised lift. **NOTE:** To lower the lift, press the arrow on the lift button and push the lift all the way down.
10. Press the power button on the side of the brewer to turn it on. The unit will enter Standby Mode with the four brew button lights illuminated blue.
11. Select your desired brew size (6, 8, 10, or 12 oz) by pressing the corresponding button. The indicator light for that button will turn red while the brewer heats up and dispenses hot coffee. **NOTE:** During the last 10 seconds of brewing, you will hear a whirring sound, which is a normal part of the brew cycle.



## OPERATING INSTRUCTIONS

12. When brewing is complete, carefully remove the filled mug from the base. **CAUTION:** The mug and coffee will be very hot.
13. Let the unit cool, then discard the used K-Cup® or coffee grounds.

### SAFETY FEATURES

#### Low Water Warning

When the water level in the reservoir drops too low, the Low Water warning light will illuminate in red. Should this occur, simply add more water to the reservoir. The unit will not allow you to continue brewing until water has been added. **NOTE:** Always make sure there is enough water in the reservoir to accommodate the brew size selected. If the water is above the low water sensor but not enough to complete a full brew cycle, the unit will start brewing until it detects low water and then automatically stop.

#### Overheat Protection

If the unit overheats, the Overheat warning light will illuminate in red and heating will automatically stop. In most cases, overheating is caused by too many consecutive brew cycles. Let the unit cool down (it will not allow you to continue brewing until it cools). Once cooled, the unit will return to Standby Mode and brewing can continue.





## TIPS

- For a stronger cup of coffee made with a K-Cup®, use a smaller brew size; for a weaker cup, use a larger brew size.
- For best results, rinse the reusable coffee filter and capsule receptacle after every use.
- If the unit is making a whining noise, one of the (hollow) needles may be clogged. To unclog, try the self-cleaning feature on p. 15. If still clogged, carefully poke with a paper clip or plastic toothpick to unclog. (Do not use a wooden toothpick, which could splinter or break).





## CLEANING AND MAINTENANCE

1. Make sure the unit is unplugged and cooled.
2. If a K-Cup® was used, remove the capsule receptacle with the K-Cup®. Discard the K-Cup®, then rinse the receptacle with water and dry completely.
3. If coffee grounds were used, remove the reusable coffee filter. Discard the grounds, then rinse the filter with water, and dry completely.  
**NOTE:** Be sure to discard brewed coffee grounds promptly. If they sit in the brew chamber or coffee filter for an extended period of time, they may begin to mold.
4. For fresh-tasting coffee, empty the water reservoir between uses. Wash the reservoir as needed with warm, soapy water. Rinse and dry well.
5. If necessary, rinse or wash the removable rubber trivet with a sponge and warm, soapy water.
6. Wipe down the base of the unit with a damp cloth or sponge, if needed. Dry completely. Never immerse the brewer or its plug in water.  
**NOTE:** The brewer and its accessories are NOT dishwasher safe.
7. Calcium buildup, caused over time by minerals commonly found in water, can adversely affect brewing. To decalcify the brewer, use the self-cleaning function described on p. 15, as needed.



## CLEANING AND MAINTENANCE

### SELF-CLEANING FEATURE

The brewer is equipped with a self-cleaning feature to prevent mineral buildup.

1. Empty the water reservoir completely.
2. In a heatproof 12-oz cup, combine 11 oz water and 1 oz white vinegar. Pour this mixture into the reservoir.
3. Insert the empty capsule receptacle into the brew chamber and close the lid.
4. Ensure the lift is in its lowest position. Place the 12-oz cup onto the rubber trivet.
5. If necessary, plug in the unit and press the power button.
6. Press and hold the 6 oz and 8 oz brew buttons for 5 seconds to activate self-cleaning. These two indicator lights will illuminate in blue when the cleaning cycle is underway (it will last approximately 1 minute).
7. When the cleaning cycle is complete, the unit will beep once and return to Standby Mode. Do not remove the mug from the base until the cycle has finished.
8. Carefully remove the filled mug from the base and discard the liquid.  
**CAUTION:** The mug and liquid will be very hot.
9. Rinse the water reservoir thoroughly and flush the vinegar/water mixture from the brewer by "brewing" two or three 12-oz cups of plain water.



## TERMS AND CONDITIONS

### Limited Warranty

RJ Brands, LLC d/b/a Chefman® offers a limited 1-year Warranty (the “Warranty”) available on sales through authorized distributors and retailers only. Please note that this Warranty becomes valid from the date of initial retail purchase and that the Warranty is non-transferable and applies only to the original purchaser.

This Warranty is void without proof of purchase within the United States and Canada. Please be aware that this Warranty supersedes all other warranties and constitutes the entire agreement between the consumer and Chefman®. Any changes to the Terms and Conditions of this Warranty must be in writing, signed by a representative of Chefman®. No other party has the right or ability to alter or change the Terms and Conditions of this Warranty.

We may ask you to please submit, via email, photos and/or video of the issue you are experiencing. This is to help us better assess the matter and possibly offer a quick fix. Photos and/or video may also be required to determine Warranty eligibility.

We encourage you to register your product. Registering can make the Warranty process easier and can keep you informed of any updates or recalls on your product. To register, follow the directions on the Chefman® Warranty Registration page in the Chefman® User Guide. Please retain your proof of purchase even after registering. In the event that you do not have proof of your purchase date, we may declare your Warranty void or we may, at our sole discretion, apply the date of manufacture as the purchase date for purposes of this Warranty.







## TERMS AND CONDITIONS

### Limited Warranty

#### WHAT THE WARRANTY COVERS

- **Manufacturer Defects** - Chefman® products are warranted against defects in material and workmanship, under normal household use, for a period of 1 year from the date of purchase when used in accordance with the directions listed in the Chefman® User Guide. If your product does not work as it should, please contact Customer Support at [support@chefman.com](mailto:support@chefman.com) so that we may assist you.

#### THIS WARRANTY DOES NOT COVER

- **Misuse** - Damage that occurs from neglectful or improper use of products, including, but not limited to, damage that occurs as a result of usage with incompatible voltage, regardless of whether the product was used with a converter or adapter. See Safety Instructions in the Chefman® User Guide for information on proper use of product;
- **Poor Maintenance** - General lack of proper care. We encourage you to take care of your Chefman® products so that you may continue to enjoy them. Please see Cleaning and Maintenance directions in the Chefman® User Guide for information on proper maintenance;
- **Commercial Use** - Damage that occurs from commercial use;
- **Normal Wear and Tear** - Damage or degradation expected to occur due to normal use over time;
- **Altered Products** - Damage that occurs from alterations or modifications by any entity other than Chefman® such as the removal of the rating label affixed to the product;
- **Catastrophic Events** - Damage that occurs from fire, floods, or natural disasters; or
- **Loss of Interest** - Claims of loss of interest or enjoyment.



# CHEFMAN® WARRANTY REGISTRATION

## What do I need to register my product?

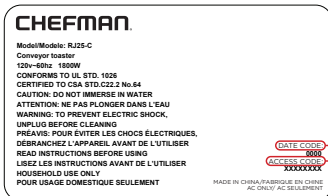

- Contact Information
- Model Number
- Proof of Purchase (online confirmation, receipt, gift receipt)
- Date Code
- Access Code

**NOTE:** Label depicted here is an example.

## How do I register my product?

All you need to do is fill out a simple Chefman® registration form. You can easily access the form in one of the two ways listed below:

1. Visit [Chefman.com/register](http://Chefman.com/register).
2. Scan the QR code to access site:





## CHEFMAN® WARRANTY REGISTRATION

### For product information

Please visit us at [Chefman.com](http://Chefman.com).

**EXCEPT WHERE SUCH LIABILITY IS REQUIRED BY LAW, THIS WARRANTY DOES NOT COVER, AND CHEFMAN® SHALL NOT BE LIABLE FOR, INCIDENTAL, INDIRECT, SPECIAL, OR CONSEQUENTIAL DAMAGES, INCLUDING WITHOUT LIMITATION, DAMAGE TO, OR LOSS OF USE OF THE PRODUCT, OR LOST SALES OR PROFITS OR DELAY OR FAILURE TO PERFORM THIS WARRANTY OBLIGATION. THE REMEDIES PROVIDED HEREIN ARE THE EXCLUSIVE REMEDIES UNDER THIS WARRANTY, WHETHER BASED ON CONTRACT, TORT OR OTHERWISE.**

Chefman® is a registered trademark of RJ Brands, LLC.  
Cooking Forward™ is a trademark of RJ Brands, LLC.



# CHEFMAN®



**CHEFMAN.COM | @MYCHEFMAN**

**©CHEFMAN 2023**

RJ14-IC-LR\_UG\_FINAL\_OTP\_041423

