



USER GUIDE

HANDY HEATER® PURE WARMTH™



Thank you for purchasing Handy Heater® Pure Warmth™ from JML. To get the best results from this product, please read these instructions in full before first use and retain for future reference.

SAVE THESE INSTRUCTIONS

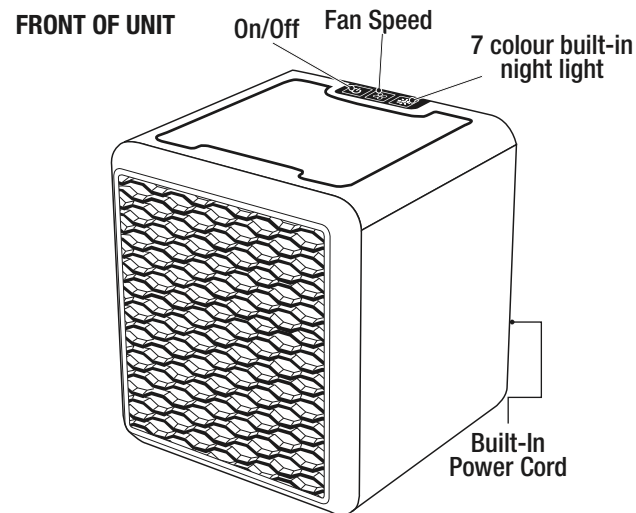

BACK OF UNIT

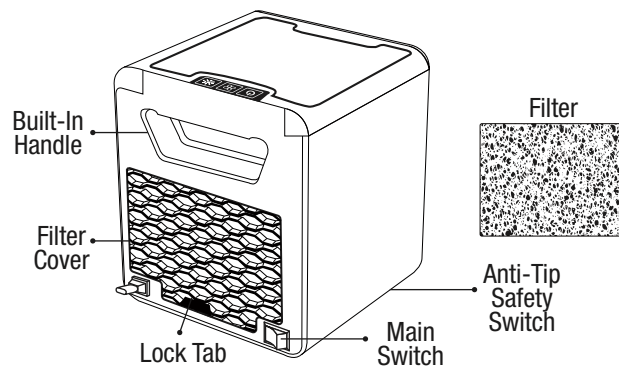

USING HANDY HEATER® PURE WARMTH™

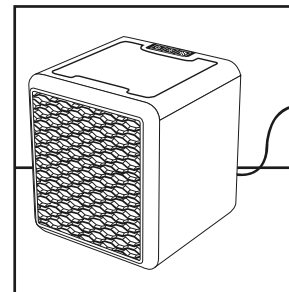

1. Place on flat, dry, even surface and plug power cord into outlet.

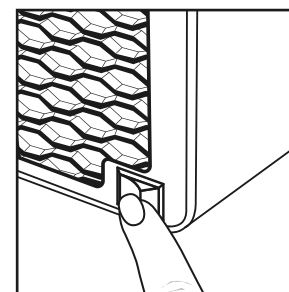

2. Power on the main unit using the switch at the back of the unit.

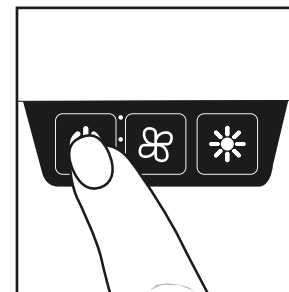

3. Press – Handy Heater® will default to HIGH speed.

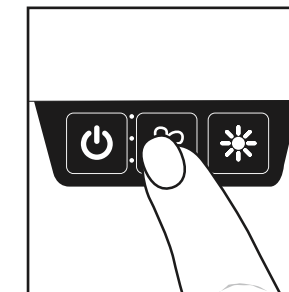

4. To adjust fan speed, press to choose HIGH, MEDIUM, or LOW.
High - 3 lights on
Medium - 2 lights on
Low - 1 light on

USING HANDY HEATER® PURE WARMTH™

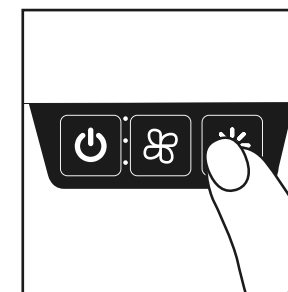

5. Mood light defaults to ON. To adjust colour, press until you find the preferred colour. Colour order: Orange, Green, Blue, Yellow, Purple, Teal, White, Cycle, Off.

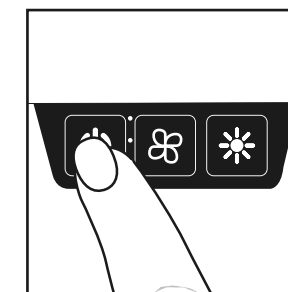

6. When done, press the to turn off.

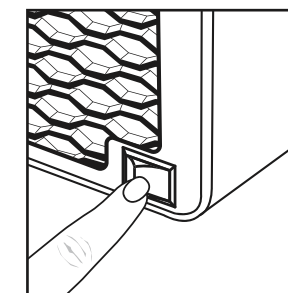

7. Turn off switch at the back of unit to shut the unit off completely. Keep in a cool, dry place until ready to use again.

CARE & CLEANING

Handy Heater® Pure Warmth™ is equipped with an air filter, located on the back of the unit. We recommend cleaning your filter every 3-6 months, based on frequency of use.

1. Find the back cover lock tab on the rear of the unit. Press in gently, and pull cover away from unit (See Fig 1).

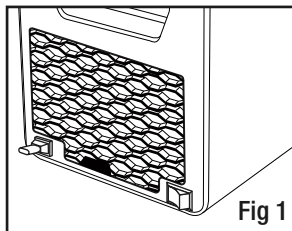

2. Remove filter from unit.

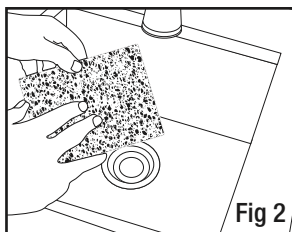

3. Rinse filter under running water until dirt/dust are no longer visible. Let air dry until completely dry. (See Fig 2)

4. Replace filter in unit and re-attach back cover, being sure lock tab snaps into place securely (See Fig 3).

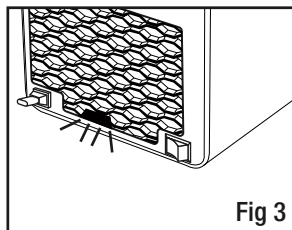

SAFETY FEATURES

Handy Heater® Pure Warmth™ has a built-in Anti-Tip switch on the underside of the unit. If the switch senses it is not on an even surface, the heating element will be disabled, and will not function until placed on an even surface again. This is a safety feature included to prevent overheating and fires, do not intentionally try to disable this feature.

WARNINGS

- Read all instructions before using this heater.
- This heater is hot when in use. To avoid burns, do not let bare skin touch hot surfaces. Always use the handle when moving this heater. Keep combustible materials, such as furniture, pillows, bedding, papers, clothes, and curtains at least 3 feet (0.9 m) from the front, sides and rear of the heater.
- Extreme caution is necessary when the heater is used near children or someone who is disabled.
- Do not leave the heater unattended while it is on. Always unplug heater when not in use.
- Do not operate heater with a damaged cord or plug, or after the heater malfunctions. If the heater is damaged in any manner, discard heater, or return it to an authorised service facility for examination and/or repair.
- Do not use outdoors.
- This heater is not intended for use in bathrooms or laundry areas. Never locate heater where it may fall into a bathtub or other water container.

WARNINGS

- DO not use the heater while sleeping.
- Do not run cord under carpeting. Do not cover cord with throw rugs, runners, or similar coverings. Do not route cord under furniture or appliances. Arrange cord away from traffic area and where it will not be tripped over.
- To disconnect heater, turn controls to off, then remove plug from outlet.
- Do not insert or allow foreign objects to enter any ventilation or exhaust opening as this may cause an electric shock or fire, or damage the heater.
- To prevent a possible fire, do not block air intakes or exhaust in any manner. Do not use on soft surfaces, like a bed, where openings may become blocked.
- A heater is hot and has arcing sparking parts inside. Do not use it in areas where gasoline, paint, or flammable liquids are used or stored.
- Use this heater only as described in this manual. Any use not recommended by the manufacturer may cause fire, electric shock, or injury to persons.
- Always plug heaters directly into a wall outlet/receptacle. Never use with an extension cord or relocatable power tap (outlet/power strip).

TECHNICAL

Power: 1200W
Voltage: 220-240v, AC \approx 50/60Hz

GUARANTEE

This product is unconditionally guaranteed for one year against all defects of workmanship and materials. This guarantee does not affect your statutory rights. If you have any problems or queries about this product please contact JML customer services.

DISPOSAL AND THE ENVIRONMENT



This product is covered by the waste electrical and electronic equipment (WEEE) regulations. It should not be discarded with normal household waste, but taken to your local collection centre for recycling. For further information, please contact your local authority or approved disposal agency.



Distributed in the UK by: JML, Unit 1 Eastside, Port of Tyne, South Shields, NE33 5SP.
Distributed in the EU by: JML GmbH, Rheinstraße 3, 63225 Langen, Germany.
Customer Services: UK: 0800 781 7831 (Freephone). ROI: 041-978 0003 (Local rate).
Email: info@JMLgroup.co.uk Web: www.JMLdirect.com
©JohnMillsLtd/VG/07.21/630/A. Made in China

