

# **Triple Monitor Desk Mount 2 Pneumatic Arms + 1 Fixed**

STAND-V300G Series  
Assembly Manual

---

Individual Product SKUs

STAND-V300G    STAND-V300GW



## WARNING



If you do not understand these directions, or if you have any doubts about the safety of the installation, please contact our product support team at 309-278-5303 or [help@vivo-us.com](mailto:help@vivo-us.com) for further assistance. Check carefully to make sure there are no missing or defective parts. Failure to report missing parts within 30 days may result in denial of free replacement. Improper installation may cause damage or serious injury. Do not use this product for any purpose that is not explicitly specified in this manual. Do not exceed weight capacity. We cannot be liable for damage or injury caused by improper mounting, incorrect assembly or inappropriate use.



### WARNING: CHOKING HAZARD

SMALL PARTS - NOT FOR CHILDREN UNDER 3 YEARS. ADULT SUPERVISION IS REQUIRED.



### DO NOT EXCEED WEIGHT CAPACITY

FAILURE TO DO SO MAY RESULT IN SERIOUS INJURY.

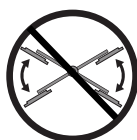

### TIPOVER WARNING

**SERIOUS OR FATAL CRUSHING INJURIES CAN OCCUR FROM TIPOVER.  
TO HELP PREVENT TIPOVER:**

- DO NOT EXTEND ARMS TOO FAR FORWARD OR BACKWARD
- NEVER ALLOW CHILDREN TO CLIMB, STAND, OR PLAY ON ANY PART OF MONITOR MOUNT
- USE TIPOVER RESTRAINT TO REDUCE (BUT NOT ELIMINATE) RISK OF TIPOVER

**ALWAYS EXERCISE CAUTION WHEN ADJUSTING THE PLACEMENT OF YOUR MONITORS.**

---

## Need Help? We're Here For You

*US-Based Customer Support from Trained Professionals*

**Monday-Friday from 7am-7pm CST**

**Saturday 8am-4pm CST**



### Email Us

[help@vivo-us.com](mailto:help@vivo-us.com)



### Chat with Live Agent

[www.vivo-us.com](http://www.vivo-us.com)



### Give Us a Call

309-278-5303 ext. 1



Assembly Video & Product Info

[www.vivo-us.com/products/stand-v300g](http://www.vivo-us.com/products/stand-v300g)

Package Contents



**A (x1)**  
Pole

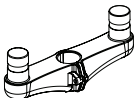

**B (x1)**  
Arm Bracket

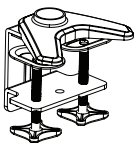

**C (x1)**  
Clamp



**D (x2)**  
Shaft Collar

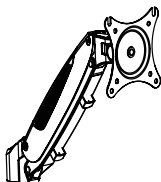

**E (x2)**  
VESA Arm

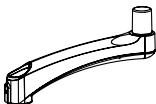

**F (x4)**  
Arm Extension

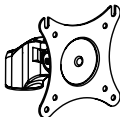

**G (x1)**  
VESA Plate



**H (x6)**  
Plastic Cover



**I (x2)**  
Cable Clip

Included Hardware & Tools

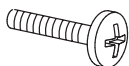

**M-A (x12)**  
M4x12mm  
Screw

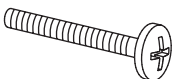

**M-B (x12)**  
M4x30mm  
Screw

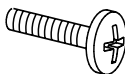

**M-C (x12)**  
M4x8mm  
Screw



**M-D (x12)**  
Spacer

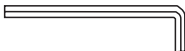

**T-A (x1)**  
3mm Allen  
Wrench

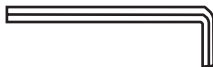

**T-B (x1)**  
5mm Allen  
Wrench

Tools Needed:



**Phillips  
Screwdriver**

Weight Capacity:



**Per Arm**

# Assembly Steps

## STEP 1

Thread Pole **(A)** onto Clamp **(C)**. Place onto edge of desktop and tighten both Clamp Bolts **(C1)** to secure.

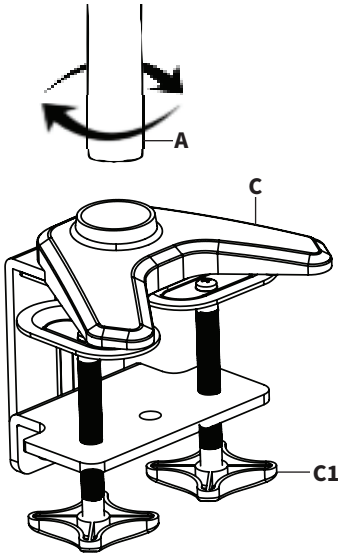

Secure Pole by tightening the set screw on the back of Clamp using 3mm Allen Wrench **(T-A)**.

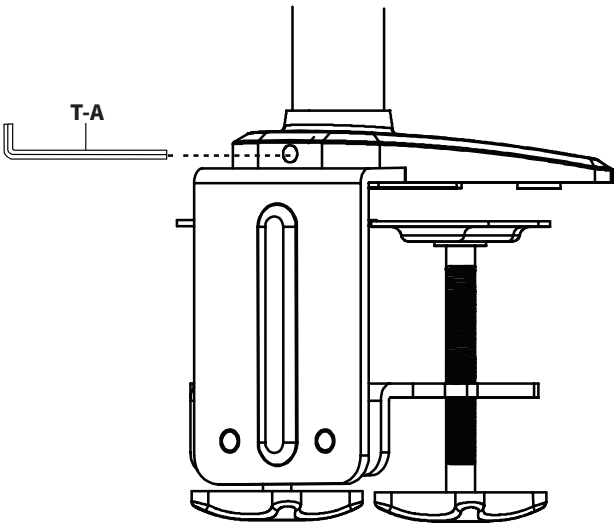

## STEP 2

Slide Shaft Collar (**D**) onto Pole (**A**) and secure by tightening the handle. Slide Arm Bracket (**B**) onto Pole so that it rests on the Shaft Collar. Secure by tightening the back screw using 5mm Allen Wrench (**T-B**).

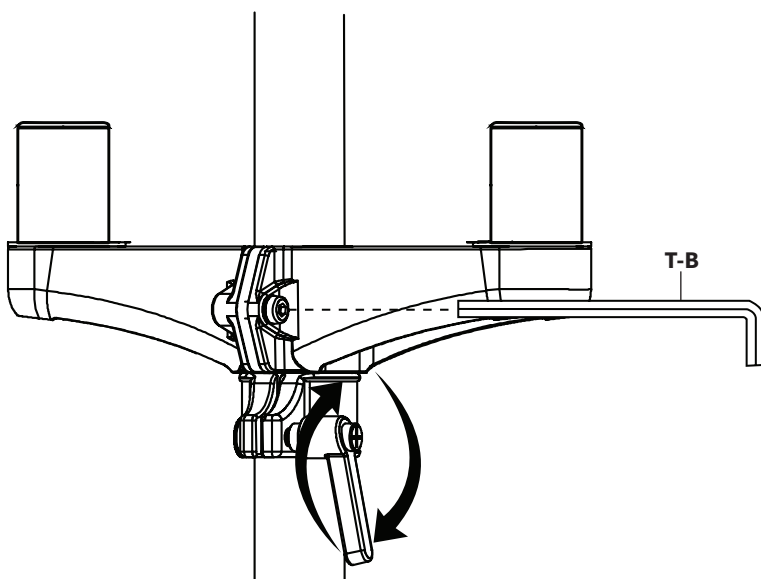
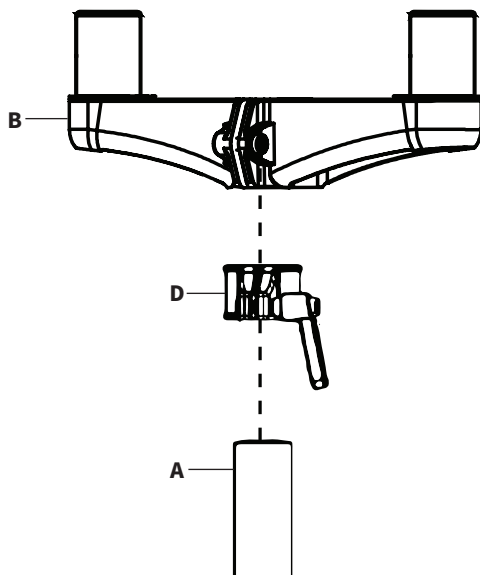

## STEP 3

Place two Arm Extensions (**F**) on both sides of Arm Bracket (**B**) as shown. Secure by tightening the set screw on the back of each Arm Extension using 3mm Allen Wrench (**T-A**). Slide another Shaft Collar (**D**) onto Pole (**A**) and secure by tightening the handle.

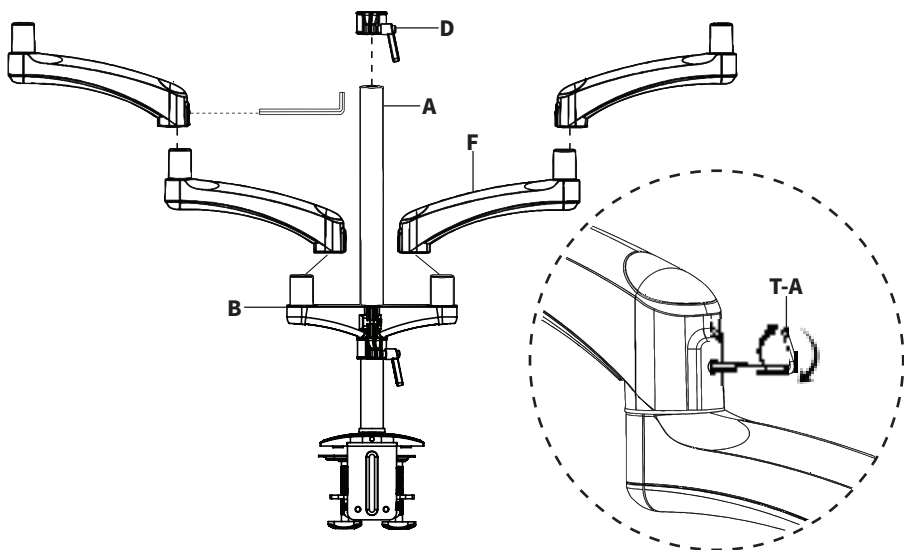

## STEP 4

Attach VESA Plate (**G**) your center monitor using the appropriate Screws (**M-A thru M-C**). Spacers (**M-D**) may be used if necessary.

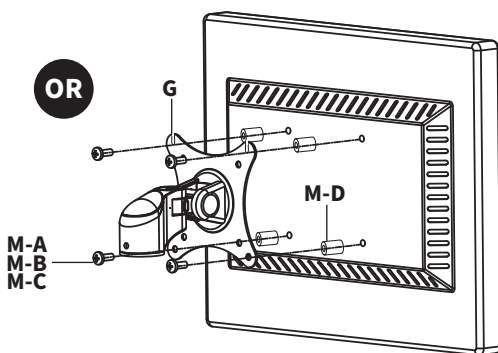
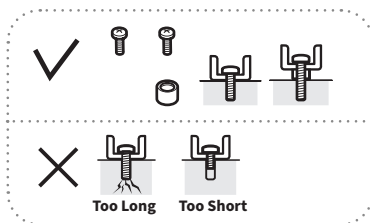
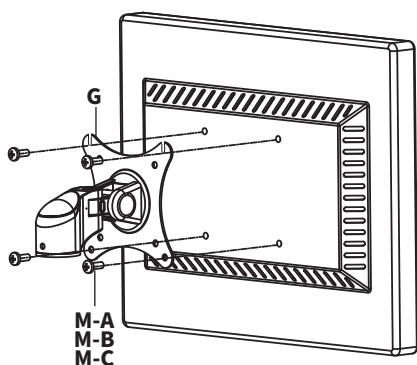

## STEP 5

Attach VESA Arms (**E**) to your side monitors using appropriate Screws (**M-A thru M-C**). Spacers (**M-D**) may be used if necessary.

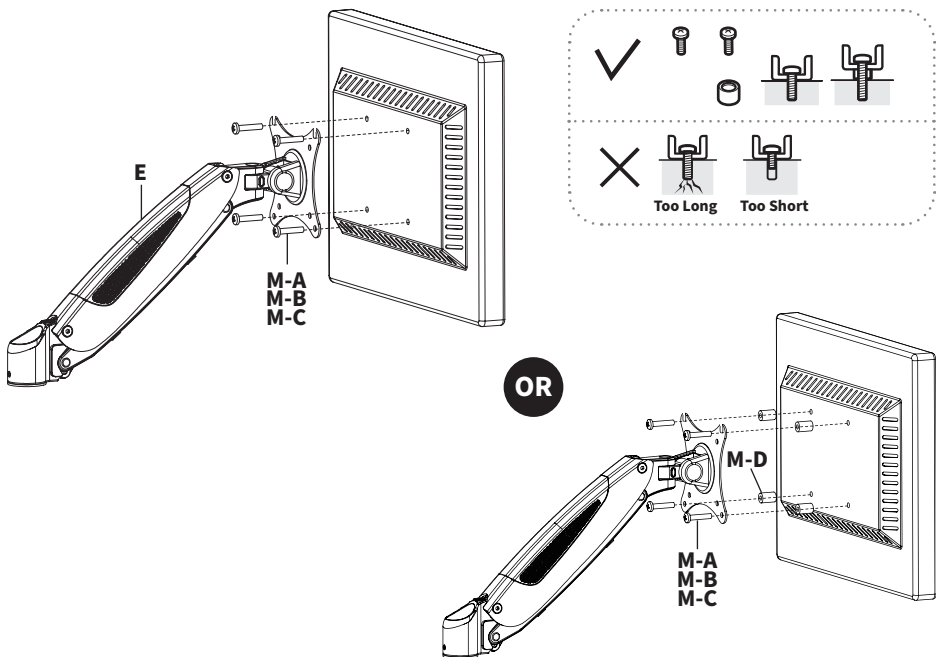

## STEP 6

Place monitors with VESA Arms (**E**) onto Arm Extensions (**F**). Slide monitor with VESA Plate (**G**) onto Pole (**A**). Secure by tightening the set screws on VESA Arms and VESA Plate using 3mm Allen Wrench (**T-A**).

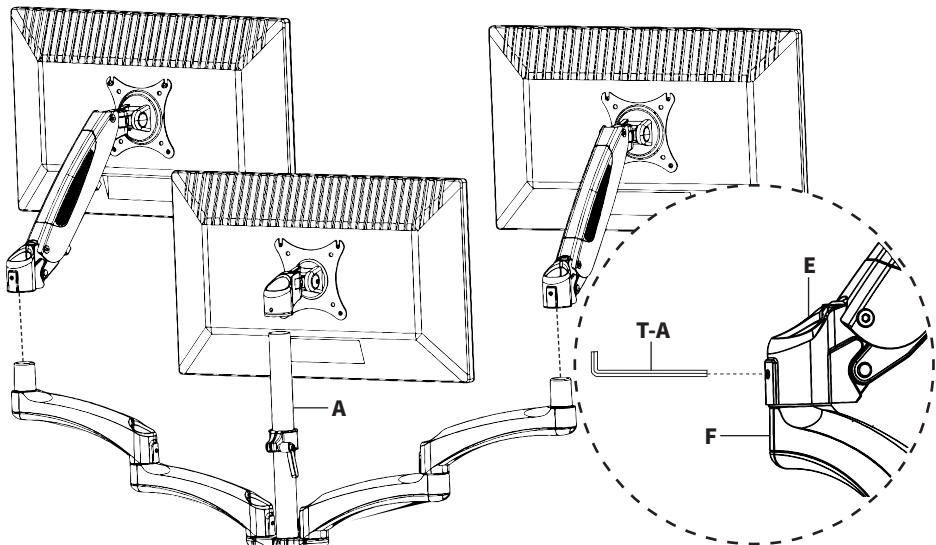

## STEP 7

Insert Plastic Covers (**H**) into VESA Arms (**E**) and Arm Extensions (**F**).

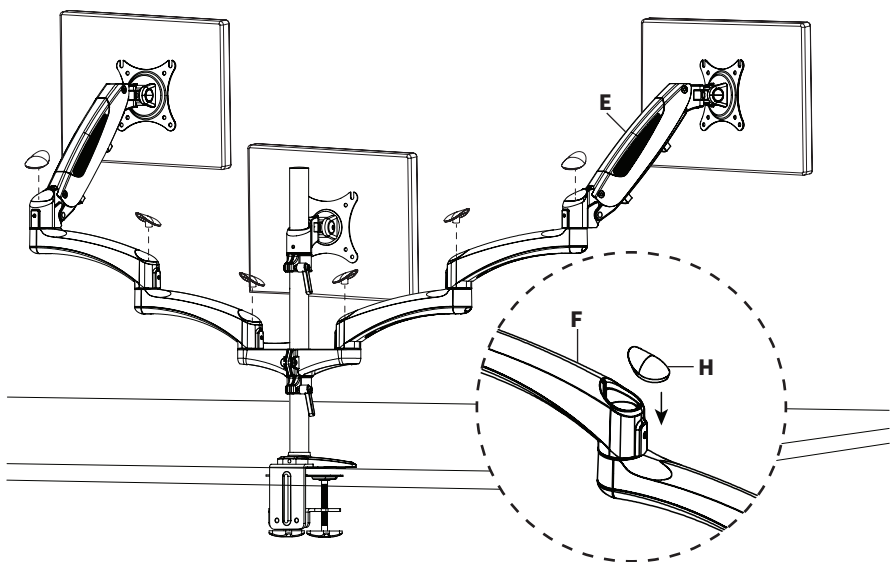

## STEP 8

Attach Cable Clips (**I**) to Pole (**A**). Manage cables using Cable Clips and the built-in channels leaving enough slack to allow full adjustment of arms.

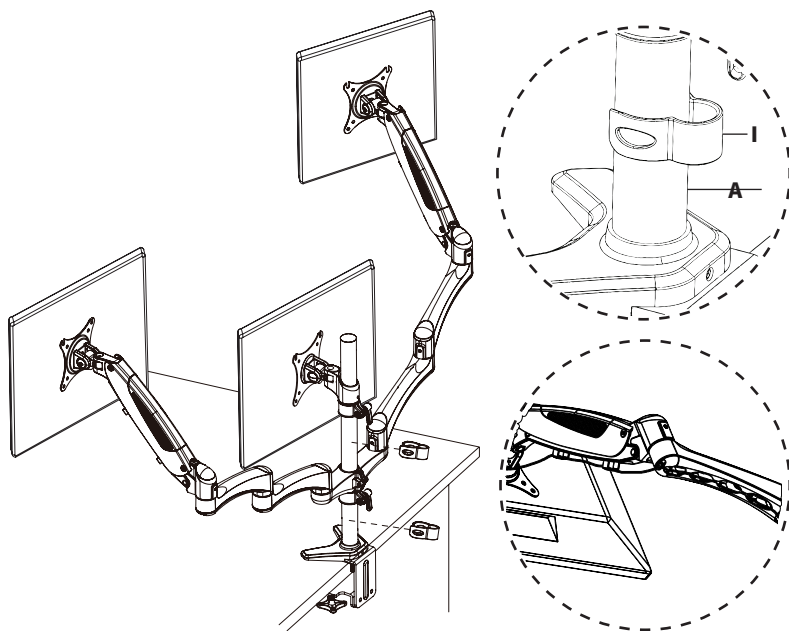

## Adjusting Side Monitor Height

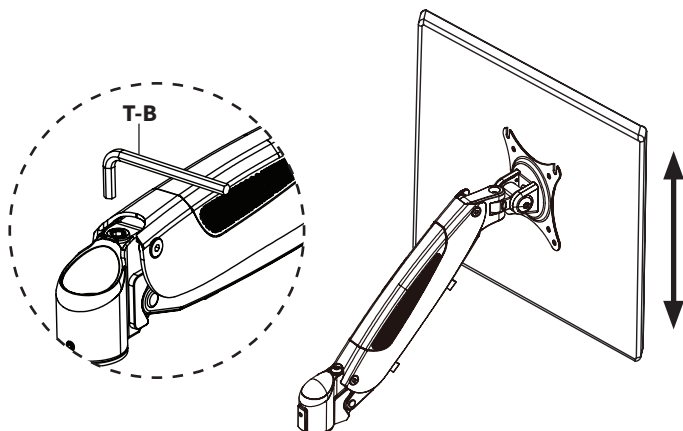

### 1 Position Mount Arm

Position the arm horizontally, as shown above, and firmly hold in place.

### 2 Insert 5mm Allen Wrench (T-B) Into Adjustment Screw

Insert the 5mm Allen Wrench (T-B) in to the adjustment screw on the back of the monitor arm.

### 3 Turn 10-20x to Set Monitor Height

Turn 5mm Allen Wrench (T-B) 10-20 times to obtain proper support for your monitor. Use the guide below to adjust the tension according to the amount of counterbalance needed to support the monitor.

## Tension Adjustment Guide

**Clockwise:**  
**Decrease Support**  
*[if monitor will not lower]*

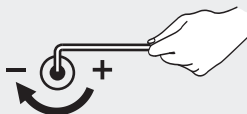

Turn the adjustment screw **clockwise** to **decrease** the support for your monitor, allowing it to be lowered.

**Counter-Clockwise**  
**Increase Support**  
*[if monitor will not raise]*

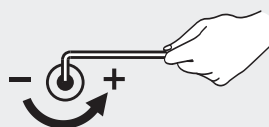

Turn the adjustment screw **counter-clockwise** to **increase** the support for your monitor, allowing it to be raised up.

**Note: Requires 10-20 Turns**

## Vertical Tilt Adjustment

To adjust the vertical tilt, loosen the side screw behind the monitor using 5mm Allen Wrench (**T-B**), adjust as desired and retighten.

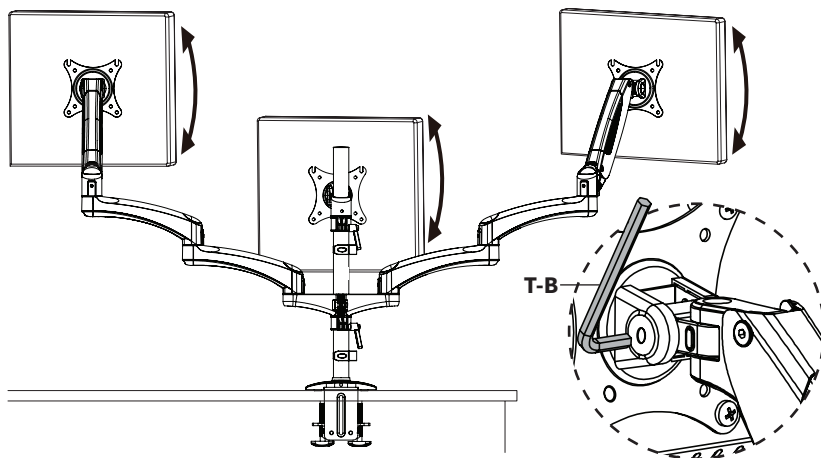

---

## Horizontal Tilt Adjustment

To adjust the horizontal tilt, loosen the top screw behind the monitor using 5mm Allen Wrench (**T-B**), adjust as desired and retighten.

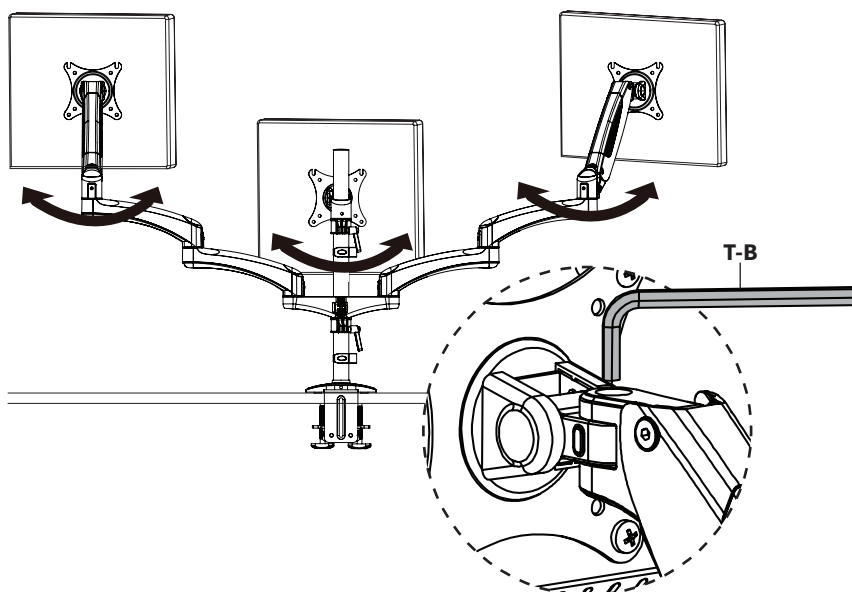

V·I·V·



Love Your New Setup?  
**Tag Us on Social!**



@ VIVO-us



@ vivo\_us



@VIVOus



VIVO



## Need Help? **We're Here For You**

Monday-Friday from 7am-7pm CST  
Saturday 8am-4pm CST



Email Us  
[help@vivo-us.com](mailto:help@vivo-us.com)



Chat with Live Agent  
[www.vivo-us.com](http://www.vivo-us.com)



Give Us a Call  
309-278-5303 ext. 1



VIVO-us



@vivo\_us



@VIVOus



VIVO