

Selfie Stick Manual

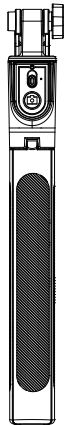

Products

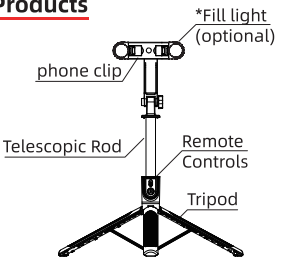

Caution

1. Don't store the product in a low-temperature, humid environment.
2. Don't place the product in a high-temperature environment such as exposure to sunlight or fire.
3. Don't use the product in restricted places to avoid violating public order.
4. This product contains batteries, please place it out of reach of infants and young children to prevent them from swallowing it accidentally.
5. The product picture and size are for reference only, please refer to the purchased style.

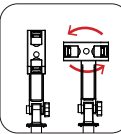

Rotate to switch

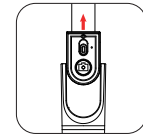

Detachable Remote

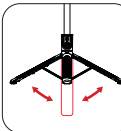

Open the tripod

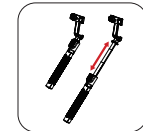

Extendable Pole

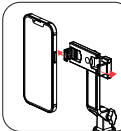

Phone Installation

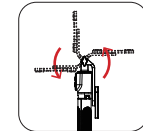

Angle Adjustment

Remote Control

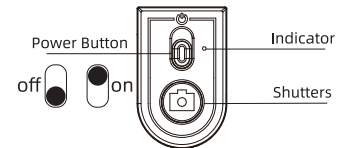

1. Turn the switch to the on position, the indicator light will be on.
 2. Open the Bluetooth settings on your cell phone and find the device name "Selfie" in the device list. Click on it to pair.
 3. In the system camera, click the photo button to take photos or record videos.
 4. Please turn off the power when you finish using it to minimize the power loss.
- Tips: This Bluetooth remote control is compatible with Android 4.3, IOS 5.0 and above.

5. This product has two different remote control styles, please refer to the actual style shall prevail

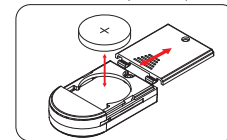

- ② Replaceable Battery Model*: Remove the battery by pushing up the battery cover of the remote control, put the new battery (CR2032) into the battery compartment with the positive pole facing out and close the cover.

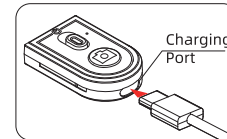

- ① Rechargeable model*: Please use the USB (5V) adapter to charge this product, the indicator light is always on when charging. When fully charged, the indicator light will turn off. Please remove the charger when charging is complete.

Fill light* (optional)

Style ①

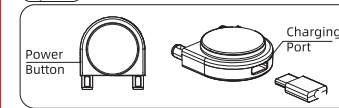

Style ②

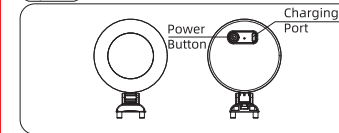

Style ③

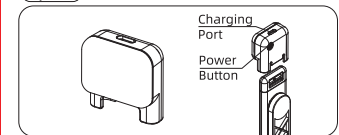

Fill light operation guide

1. Click the power button to switch on the power
 2. Click to switch the light type (three levels) until the power off, long press the power button to adjust the brightness of the light.
 3. Charging: Please use the USB (5V) adapter to charge the product, the indicator light is always on when charging. The indicator light is off when full.
- *This accessory is part of the model configuration, please purchase the model configuration shall prevail.

Fault Resolution

- The remote control will not turn on:
Connect the remote to the adapter for charging and try again.
- Cannot connect Bluetooth or cannot search for device:
Restart the phone and remote control and connect again.
- Cannot take photo/video after connection:
Set the volume button function to "Shutter" in the camera settings.
- ★ Some smartphone models have different settings, please refer to the manual of the phone model.



FCC Statement

This device complies with part 15 of the FCC Rules. Operation is subject to the following two conditions: (1) This device may not cause harmful interference, and (2) this device must accept any interference received, including interference that may cause undesired operation.

This equipment has been tested and found to comply with the limits for a Class B digital device, pursuant to part 15 of the FCC Rules. These limits are designed to provide reasonable protection against harmful interference in a residential installation. This equipment generates, uses and can radiate radio frequency energy and, if not installed and used in accordance with the instructions, may cause harmful interference to radio communications. However, there is no guarantee that interference will not occur in a particular installation. If this equipment does cause harmful interference to radio or television reception, which can be determined by turning the equipment off and on, the user is encouraged to try to correct the interference by one or more of the following measures:

- Reorient or relocate the receiving antenna.
- Increase the separation between the equipment and receiver.
- Connect the equipment into an outlet on a circuit different from that to which the receiver is connected.
- Consult the dealer or an experienced radio/TV technician for help.

Caution: Any changes or modifications to this device not explicitly approved by manufacturer could void your authority to operate this equipment.

RF Exposure Information

The device has been evaluated to meet general RF exposure requirement. The device can be used in portable exposure condition without restriction.