

USER MANUAL

V7 Sports Wireless Headphones

Customer Service

✉ Email: support@gnmn.tech

📞 WhatsApp: (+86) 1392 3490 475

🌐 Web: www.gnmn.tech

Packing List

Charging Case x1

User Manual x1

Ear Tips x3

USB-C Cable x1

Specifications

- Model Name: V7
- FCC ID: 2A8TA-V7
- Bluetooth Version: V5.3
- Support: A2DP/HFP/AVRCP/SPP/PBAP/BDR/BLE
- Transmission Range: 33feet Max (without obstacle)
- Input: DC 5V ⚡ 0.5A
- Charging Port: Type-C
- Music Time: 8H
- Phone Call Time: 6H
- Charging Time: about 2H
- Headphones Battery Capacity: 50mAh
- Charging Case Battery Capacity: 3.7V 500mAh / 1.85Wh

Product Overview

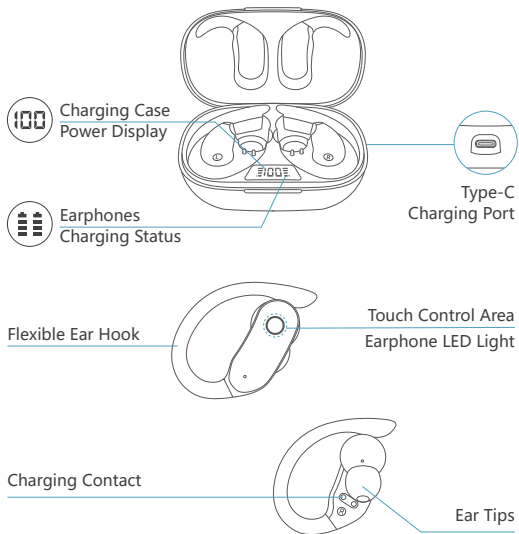

Caution

1. Please remove the protective film before use, otherwise the headphone will not be able to charge.

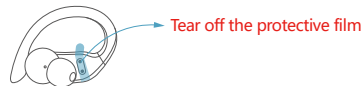

2. Choose suitable ear tips & Wear correctly to enhance sound quality.

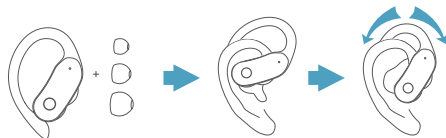

3. Please clean the magnet charging contact on earbud and charging pin on the charging case with alcohol wipes if the headphones can't be charged.

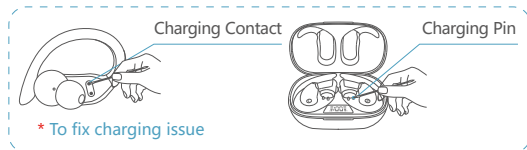

4. Please clean the protective grille of both earbuds if the sound becomes low.

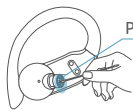

Protective Grille

* To make sound louder

How to Charge?

Charge by USB-C cable

Place earbuds into charging case properly, then use the included USB-C charging cable to connect the charging case, and plug the other end into power supply with a 5V/1A adapter (not included), they will start charging.

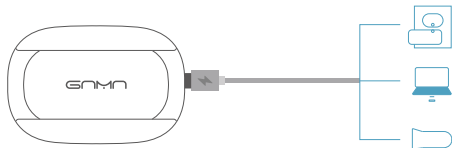



(* The USB-C charging cable is in the black paper box.)

Note:

1. If earbud's battery is lower than 10% (and the voltage is below 3.4V), you will hear voice prompt "battery low" three times and then "power off" in turns.
2. The fully charged charging case can recharge twins earbuds for 2-3 times without being plugged into power supply

LED Power Display

 Show the remaining battery percentage of charging case from 0-100. "0" means charging case need charging while "100" means the charging case is fully charged.

 Flash down and up when earbud is charging; Stop flashing when earbud is fully charged.

Earbud's LED light: Red light up means "being charged", Red light go off means "fully charged".

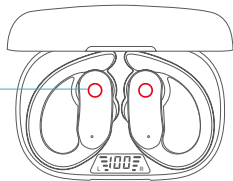

Power On/Off & Pairing

Automatically Power On/Off & Pairing

Prior to first use (or not in use for long time), please charge both earbuds and charging case fully.

1. Take twin earbuds out of charging case, they will automatically power on and enter pairing mode.

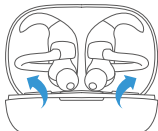

2. Activate the Bluetooth setting on your phone, search and connect "V7".



Note: If the earbuds are not connected to your device over 5minutes, the earbuds will power off automatically.

3. Put the earbuds back into charging case, they will disconnect & power off automatically.

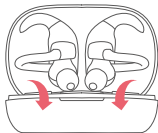

Manually Power On/Off

If the earbud is out of the charging case and power off, then press & hold it for 2s, it will power on.

Disconnect the Bluetooth with your device, press & hold either earbud for 5s, both earbuds will power off at the same time.

For Second Time Use

If the headphones have already connected with your device, and the Bluetooth setting of this device is on, in the second time using, when you take out the earbuds from the charging case, they will connect with your device automatically.

Pair with Other Device

V7 Sports Headphones Bluetooth has memory function, it usually auto connects with the last paired device.

Thus, if you want to pair them with other device, you should disconnect "V7" from the last paired device, AND forget the pairing record on the last device.

Then try to connect it to a new device, it should work properly.

Mono Mode (Only Left/Right Earbud is being Used)

You can use one earbud alone, leave another earbud in the charging case.

- When in Dual mode, put one earbud into the charging case.
- Or only take one earbud out of the charging case, then search & connect "V7" on your device.

Factory Restore Setting

When should I reset?

- When only one side play music.
- When you can't find "V7" on the device.
- When both earbuds fail to pair with each other or occur connection related issues.

How to reset?

- Delete "V7" record from the Bluetooth menu on your device and deactivate the Bluetooth setting.
- Make sure the charging case has power or being plugged into a power supply.
- Insert both earbuds into the charging case to get charged.
- Press and hold both earbuds for 8 secs at the same time to clean the pairing record with the last device.

(* During this period, both earbuds' LED will flash Red & Blue light once, then turn to Red light to get charge again.)

- Now turn on the Bluetooth setting on your device, search and connect the earbuds, they will work properly.

Note: If it still doesn't work, please repeat the steps to try again.

Multi-Function Operations



"L" or "R" Earbud



For Call

Answer/End Call	Quick Double- Tap L/R earbud
Reject Call	Long Press 2s on L/R earbud



Voice Assistance

Siri	Quick Triple- Tap on L/R earbud
------	---------------------------------

(* Must in non-music mode or standby mode)



Music Mode

Play/Pause	Quick Double- Click on L/R earbud
Next Song	Quick Triple- Click on R earbud
Previous Song	Quick Triple- Click on L earbud
Volume+	Long Press & Hold on R earbud
Volume -	Long Press & Hold on L earbud

(* In single mode, R Earbud only support next song and Volume+, L Earbud only support previous song and Volume-)

How to sync volume on Android?

To protect users from potential hearing damage, Android's limit on max volume is quite low for Bluetooth audio devices.

If you feel the volume is too low, please access developer options and enable absolute volume, so you'll be able to max the volume at your own volition and to the full capabilities of your Bluetooth earphones.

(Scan this QR code to watch a video to learn more details.)



Find Build Number Firstly

Android 4.1 and lower: the Developer options screen is available by default.

Android 4.2 and higher: the Developer options in Android phones are hidden, you must enable this screen through Build Number.

Android 7.1 and lower: Settings > About Phone > Build Number

Android 8.0.0 and Android 8.1.0: Settings > System > About Phone > Build Number

Android 9 and higher: Settings > About Phone > Build Number

Enable Developer Options

Locate the Build number and tap it about 7 times in succession to enable Developer options. You may also have to tap in your PIN for verification. Once developer options are activated, you will see a message that reads "You are now a developer".

Go back to the Settings pane, search Developer options as an entry. At the top of the Developer options screen, you can toggle the options as figure 1.

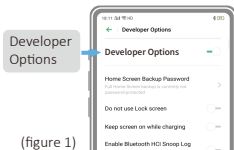

(figure 1)

Enable Absolute Volume

Scroll down until you reach the Networking section. Once there, enable (toggle ON) the absolute volume options as figure 2.

Note: These options in the figure 2 may be different from the device you're using. Typically, the choices depend on the type and model of the device you are working with.

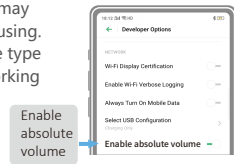

(figure 2)