



INSTRUCTION MANUAL

DRIP COFFEE MAKER



MODEL 300105LPM

PLEASE READ THE MANUAL CAREFULLY BEFORE OPERATING
YOUR PRODUCT AND RETAIN IT FOR FUTURE USE

IMPORTANT SAFEGUARDS

Before using the electrical appliance, the following basic precautions should always be followed:

1. Read all instructions.
2. Make sure that your outlet voltage corresponds to the voltage stated on the rating label of the coffee maker.
3. Do not operate any appliance with a damaged cord or plug, or in abnormal states. If its main cord is damaged, it must be replaced by the manufacturer, the nearest service agent or a qualified person.
4. To prevent from fire, electric shock and injury to persons do not immerse cord, plug, in water or other liquids.
5. Remove plug from wall outlet before cleaning and not in use. Allow appliance cool down completely before taking off, attaching components or cleaning.
6. The use of accessory is not recommended by the appliance manufacturer. It may cause fire, electric shock or person injury.
7. The container is designed for this appliance. It can not be used in other situations.
8. Do not clean container with cleansers, steel wool pads, or other abrasive materials.
9. Do not hang power cord over the edge of table

or counter, or touch hot surface.

10. Do not put coffee maker on hot surface or near fire to avoid damage.
11. To disconnect, remove plug from wall outlet. Always hold the plug and do not pull the cord.
12. Do not use appliance for other intended use and keep it dry.
13. Careful supervision is necessary when your appliance is being used near children.
14. Keep away from the steam.
15. To disconnect, turn the button to "Off" firstly, then remove plug from power supply.
16. Do not let the coffee maker operate without water.
17. Never use the appliance if the carafe appears any cracks. Only use the carafe with this appliance. and do carefully as the carafe is very fragile.
18. You may get scalded if you remove the cover during the operation.
19. Some parts of the appliance may get hot during operation, so do not touch with hands. Use handles or knobs only.
20. Never leave the empty carafe on a warming plate in case of cracks.
21. This appliance has been incorporated with a grounded plug. Please ensure the wall outlet in your house is well earthed.
22. Do not put the hot container on a hot or cold surface.
23. The appliance can be used by children aged

from 8 years old and above and persons with reduced physical, sensory or mental capabilities or lack of experience and knowledge if they have been given supervision or instruction concerning use of the appliance in a safe way and understand the hazards involved. Children shall not play with the appliance. Cleaning and user maintenance shall not be made by children unless they are older than 8 and supervised.

24. Keep the appliance and its cord out of reach of children less than 8 years old.
25. This appliance is intended to be used in household and similar situations such as:
- staff kitchen areas in shops, offices and other working places;
 - farm houses;
 - hotels, motels and other residential places;
26. Do not use the appliance outdoors.
27. Save these instructions.

CONTENTS

IMPORTANT SAFEGUARDS 1-3

SPECIFICATION 3

PRODUCT STRUCTURE DIAGRAM 4

BEFORE FIRST USE 5

OPERATION 5-6

CLEANING AND MAINTENANCE 6

REMOVING MINERAL DEPOSITS 6

SPECIFICATION

| | |
|------------------------|-----------|
| Model No. | 300105LPM |
| Voltage | 120V |
| Frequency | 60Hz |
| Power | 600W |
| Inner Chamber Capacity | 600ml |

PRODUCT STRUCTURE DIAGRAM

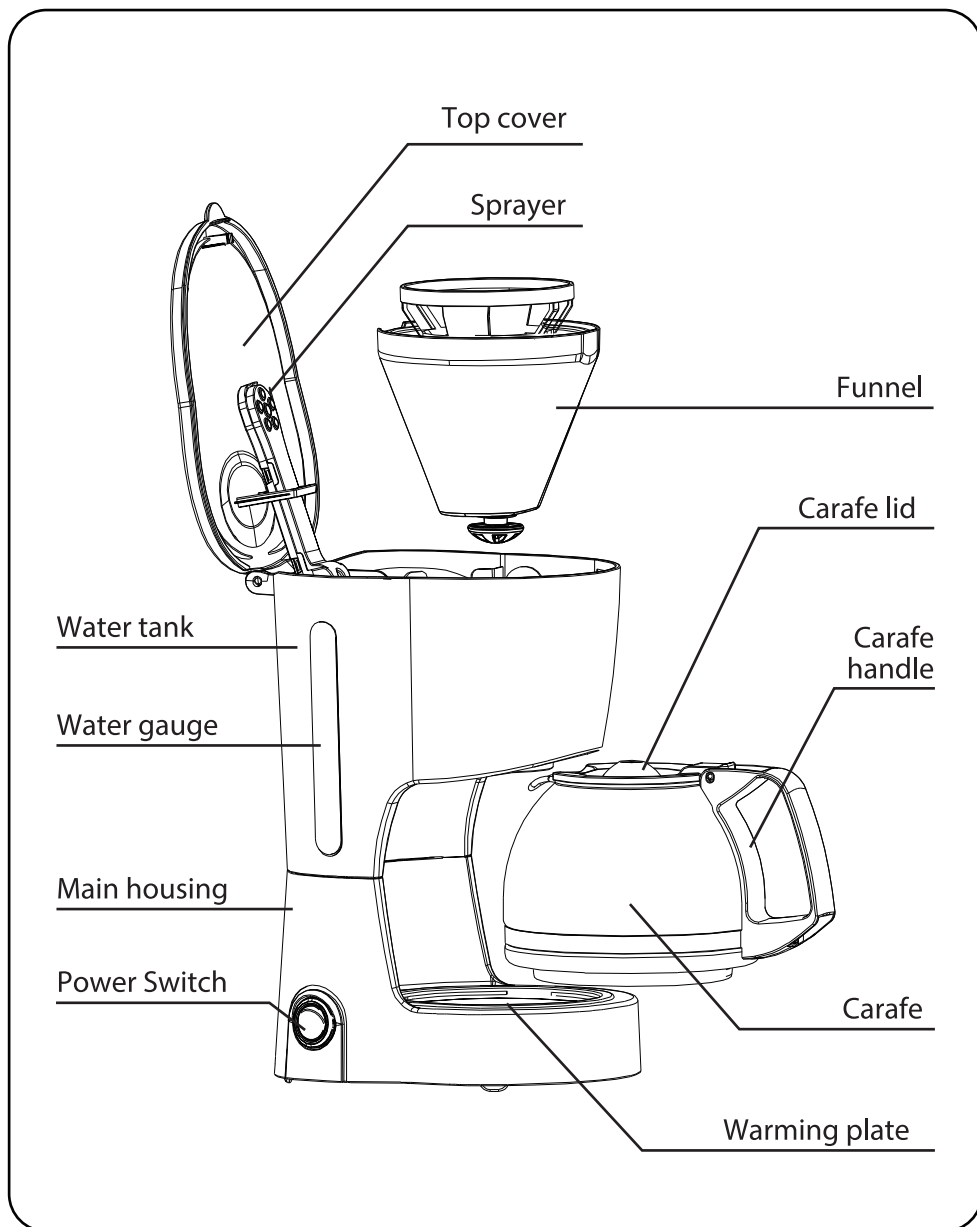

BEFORE FIRST USE

Check all the accessories are complete and the unit is not damaged. Add water into water tank to the MAX level and flush water for several times without coffee powder, then pour the water away. Clean all detachable parts thoroughly with water.

OPERATION

1. Open the top cover and fill the water tank with drinking water. The water must below the MAX level as indicated on the carafe. (figure 1)
2. Add coffee powder into filter. Usually you can make a cup of coffee with a spoonful coffee powder, also you may adjust according to personal taste. Then assemble the filter with coffee powder into the funnel, and make sure the funnel is fitted properly, otherwise the top cover can not be closed. Finally, close the top cover. (figure 2)
3. Put the carafe on the warming plate horizontally.
4. Plug the power cord into the power source.
5. Switch power button to "I" position to light the indicator. The appliance starts working.
6. The process can be stopped by pressing Power switch to "O" and will back to work once the Power switch is pressed to "I" position again.

NOTE You can take out carafe to pour coffee at any time. The appliance will stop dripping automatically. But the time must be within 30 seconds.

CAUTION DO NOT touch cover, warming plate or other parts when machine is working.

7. After the process finished, keep the coffee maker energizing, if you do

not want to drink immediately, it can keep the coffee warm in the warming plate. For a better taste, drink it before it cool down.

NOTE Please make sure the carafe is not empty when keeping warm in case of dry boiling.

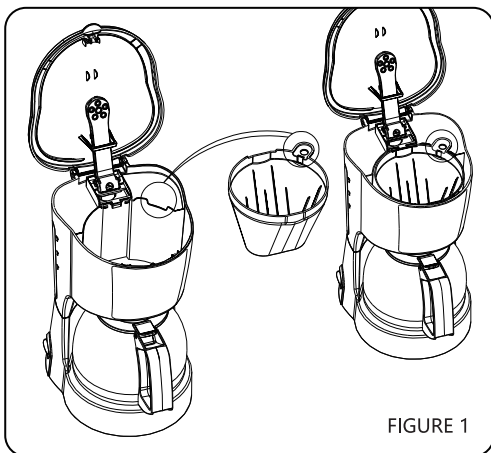

FIGURE 1

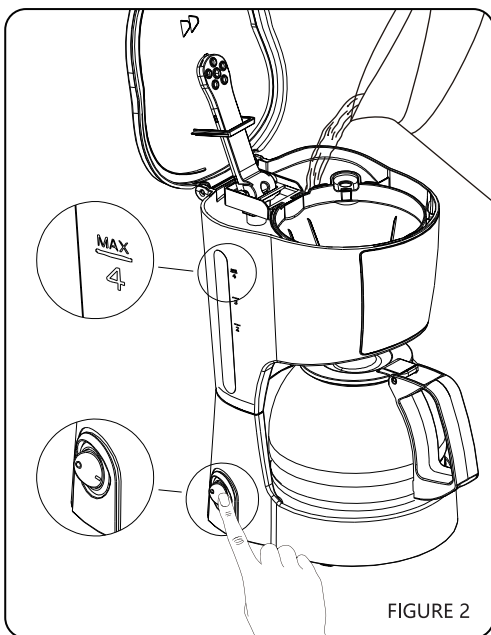

FIGURE 2

-
9. Take out the carafe to drink when the brewing finished (about one minute later after the coffee stops dripping out.)

NOTE The coffee you get is less than the water you added, as some water is absorbed into coffee powder.

10. Always turn the coffee maker off and disconnect the power supply when not in use.

NOTE Pay attention to pour the coffee

CLEANING AND MAINTENANCE

CAUTION Be sure to unplug the appliance before cleaning. To protect against electrical shock, keep the cord dry. After using, always make sure to unplug from wall outlet firstly.

1. Clean all the detachable parts after using.
2. Wipe the product's surface with a soft, wet cloth to remove stains.
3. Water may collect in the area above the funnel and drip into the product base during brewing. To control the dripping, wipe off it with a clean, dry cloth after use.
4. Use a wet cloth to gently wipe the warming plate. Never use abrasive cleaner to clean it.
5. Collect all parts and keep them for next time use.

REMOVING MINERAL DEPOSITS

To keep your coffee maker operating efficiently, you should clean away the mineral deposits left by the water regularly according to the water quality in your location and the frequency of use. If the mineral deposit is excessive, please clean as following steps:

1. Fill the tank with water and scale remover to the MAX level (the proportion of water and scale remover is 4:1, follow the instruction of scale remover. Please use "household scale remover" .
2. Make sure there is none coffee powder remains in the filter.
3. Press Power switch to "I" position. The indicator will be illuminated. The appliance will begin working.
4. Make about two cups of coffee each time.
5. Press the Power switch to "O" position to stop the unit immediately, make the scale remover stay in the container at least 15 minutes.
6. Restart the product and repeat the steps of 4-6 at least 3 times.
7. Then pour coffee (no coffee powder) out with tap water, repeat the steps of 4-6 for 3 times (it is not necessary to wait 15 minutes in step of 6), then brewing until there is no water left in the tank.

WARRANTY: 2 YEARS



AIGOSTAR INC
489 Yorbita Rd, City of Industry, CA 91744(UNIT A)

[HTTP://WWW.AIGOSTARUSA.COM](http://www.aigostarusa.com)

MADE IN CHINA