

2 Inside Assembly

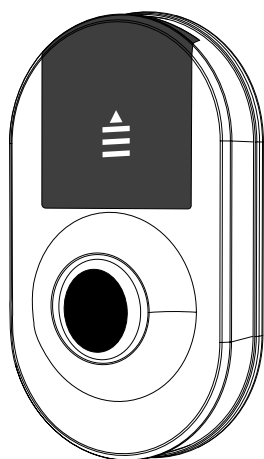

1 Outside Assembly with lever

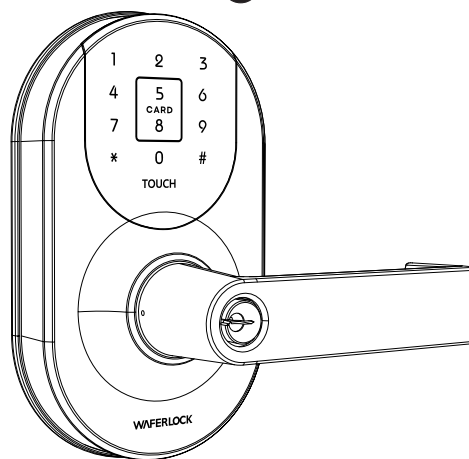

3 Inner Lever



8 M3 Screws (Black) X3



13 Keys

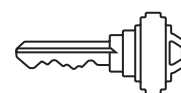

4 Backplate

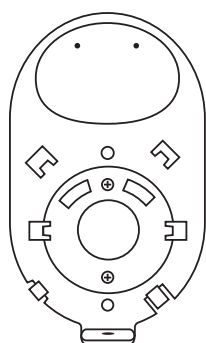

5 Rubber Gasket X1

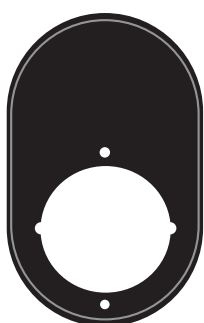

9 M3 Screw



14 Inner Lever Handle Set

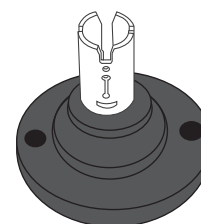

10 Mounting Screws

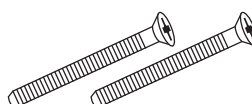

6 Strike

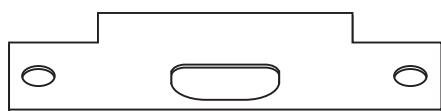

11 Fixing Screws for Latch Set X2



15 Dismantling Lever/Door Thickness Adjusting Tool

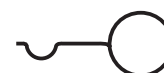

7 Latch

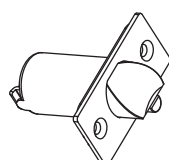

12 Fixing Screws for Strike Plate X2



16 Battery (AAA)



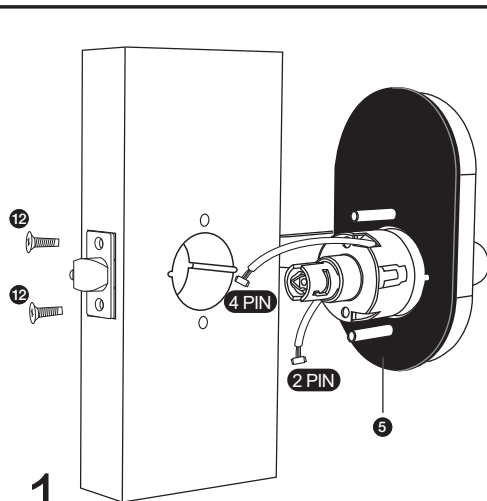

1

1. Install latch. The bevel must face toward the door stop.
2. Place outside assembly on rubber gasket.

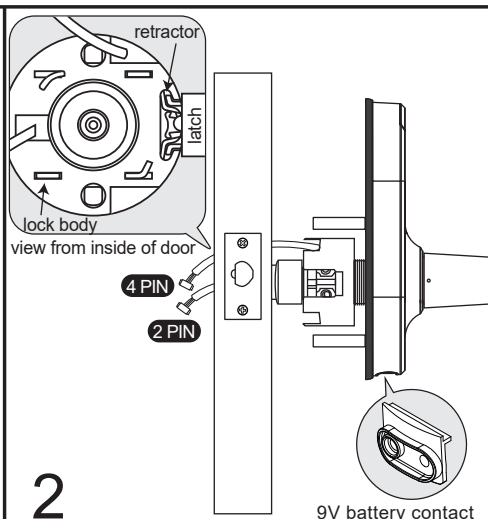

2

1. Attach the outside assembly to the door. Allow the cables hang through the hole on the other side.
2. Insert the outside assembly into door and be sure to properly engage the lock body with the latch by turning the spindle.

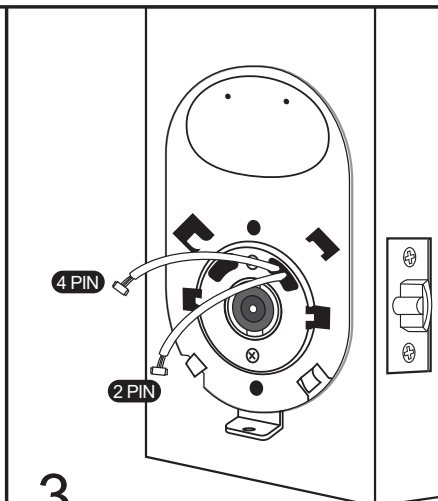

3

1. Take the backplate, gently thread the cables from the outside assembly through the hole located near the latch in the backplate.

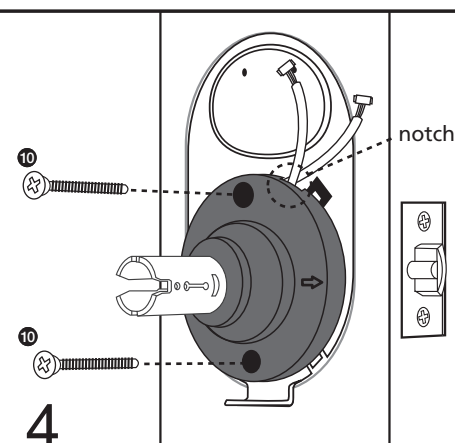

4

1. Place the inner lever set over spindle on the door with the embossed "arrow" to face the latch direction.
2. Tap the cables down the notch of the inner lever handle set to be sure the housing will not pinch or cut before fastening bolts.

IMPORTANT

The cables must come through notch and lie within the notch without pinched or cut.

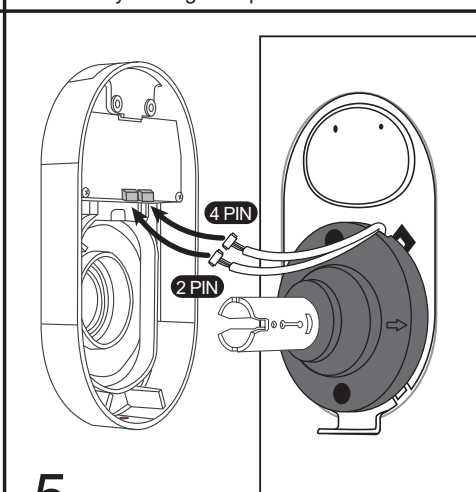

5

1. Well connect the cables to the connectors of inside assembly.

IMPORTANT

The cables must not be pinched or cut during the process.

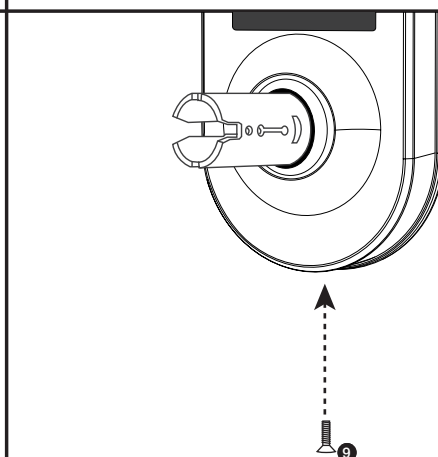

6

1. Install inside assembly and tighten the fixing screw from the bottom.

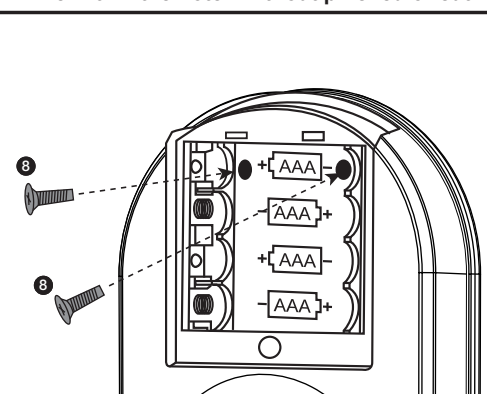

7

1. Tighten the fixing screws at the battery box of the inner unit.

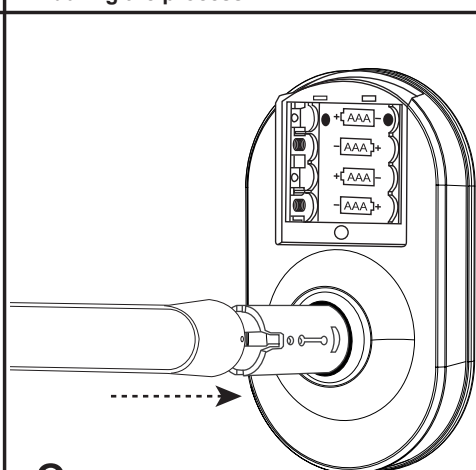

8

1. Install the inner lever and make sure the lever is fixed on the lever handle set.

* To remove the lever, utilize the dismantling Lever tool. Insert it into the lever hole and simultaneously pull the lever.

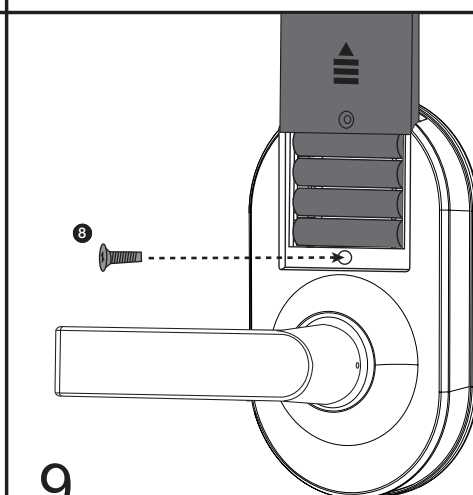

9

1. Insert batteries and slide the battery cover properly as the photo.
2. Tighten the M3 screw.