



MULTI-FUNCTION JUMP STARTER

MODEL

Epower-B05

User Manual



Jump Starter



Power bank



Car electronics



Torch

CATALOG

▲ ENGLISH	001-021
DEUTSCH	000-000
FRANÇAIS	000-000
POLSKI	000-000
ESPAÑOL	000-000
ITALIANO	000-000
ČEŠTINA	000-000

▲ PRODUCT DESCRIPTION

1. Please read this manual carefully and keep it properly before using this product for the first time. It will guide you to use it correctly and remind you of relevant precautions.
2. This product is a portable car jump starter + air compressor product. It can start a car whose battery (12V) is losing electricity, and has the function of inflating cars, motorcycles, bicycle tires and balls; it can also be used as a mobile power source for mobile phones, tablets, PSP, MP3/MP4, cameras, etc. Digital electronic products are charged/powered, and the products also have LED light functions (lighting mode, SOS mode, warning mode).
3. Note that this product is not a toy and children are forbidden to use it.

▲ PRODUCT FEATURES



Engine Start



Power Bank



LED Light



Air Inflation



Car Tires



Motorcycle Tires



Bicycle Tire



Ball Supplies

▲ PRODUCT DIAGRAM

1. Inflatable Tube Interface
2. LED Light
3. Type-C Charging Port
4. USB 5V/2.1A Output
5. USB 5V/9V/12V Output
6. Jumper Cable Connection Port
7. Digital Tube Display
8. Air Pressure Set " + " Button
9. " M " Button (Mode/Unit Switching)
10. Power Button
11. LED Light Button
12. Air Pressure Set " - " Button

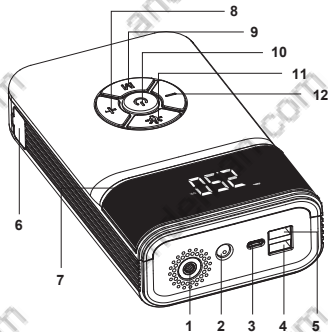

▲ CHARGE DIGITAL PRODUCTS



Plug the USB port of the charging cable into the product USB interface.

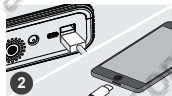

Insert the other end of the charging cable into the corresponding charging port of the mobile phone or digital device.



Press and hold the "Power" button for 2 seconds to turn on the power, and the USB power supply can be started.

▲ CAR JUMP START

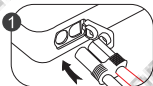

Remove the silicone plug and insert the EC5 connector of the jumper cable into the hole position.

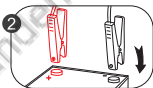

Connect the red clamp to the positive pole (+) and the black clamp to the negative pole (-) of the car battery.

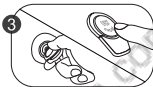

Ignition within 30 seconds:
Press the car start button or turn the ignition switch to the START position.

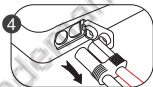

After successful startup, pull the plug of the wire clip from the product and remove the clip from the positive and negative terminals of the car battery.

Note: When starting the car, please make sure that the power of the product is above 50%.

▲ DETAILED INSTRUCTIONS FOR INFLATION FUNCTION

1. Charge The Product

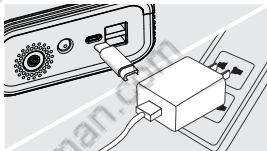

Please fully charge the product before using it for the first time.

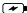
Charging: The units digit of the battery percentage value flashes (flashing once per second). the screen displays: 

Fully charged: Stop flashing and stop charging, turn off the screen after 10 seconds and enter sleep state.

Note: The charging process will not be able to use this product.

2. Power On/Off

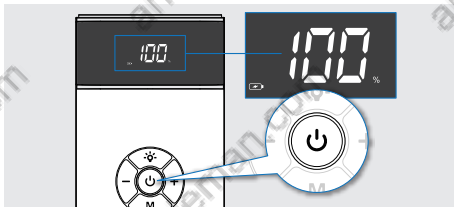

Press and hold the "Power" button for 2 seconds to turn on the device. At this time, the battery percentage and the "  " icon will be displayed on the screen, and the USB output function will be turned on at the same time. After booting, single press the "Power" button to switch between on/pause of inflation. Press and hold the "Power" button again for 2 seconds to shut down. (If the product is turned on without any operation within 30 seconds, it will also automatically shut down.)

3. Connect the Inflation Tube

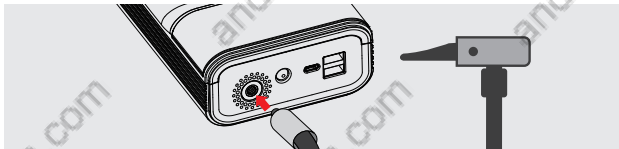

Bicycles, electric bicycles, motorcycles, and cars are usually directly connected by this air pipe.

4. Gas Nozzle / Gas Needle Mounting Method

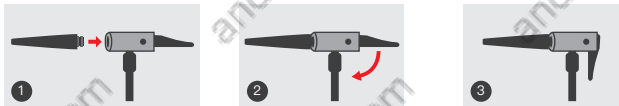

When inflating the air bed and swimming ring, please select a suitable air nozzle, and connect the air nozzle to the inflation tube before inflating.

4. Gas Nozzle / Gas Needle Mounting Method

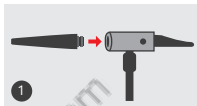

When inflating the air bed and swimming ring, please select a suitable air nozzle, and connect the air nozzle to the inflation tube before inflating.

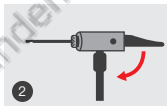
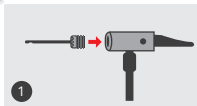

When inflating basketball, football and other balls, you need to use an air needle. Connect the air needle to the inflation tube before inflating.

5. Inflation Air Pressure

To ensure safety, before using this device for inflation, please know the air pressure value required by the inflated item (check the surface information of the inflated item or query the instruction manual of the inflated item) to avoid personal injury caused by over-inflation.

Common Items Recommended Inflatable Air Pressure Gauge

Category	Types	Recommended air pressure range
Car	Car tires	2.2-2.8 Bar (32-40psi)
Motorcycle	Motorcycle, electric Motorcycle tires	1.8-3.0 Bar (26-44psi)
Bike	Folding bicycle tires 12"14"16"bicycle tires 20"22"24"bicycle tires 26"27.5"29"bicycle tires	45-50psi 30-50psi 40-50psi 45-65psi
Ball	Basketball Football Volleyball Rugby	7-9psi 8-16psi 4-5psi 12-14psi

6. Preset Inflation Air Pressure

Mode Selection

Short press the "M" button to select the inflation mode: each time you press this button, you can switch between the four inflation modes of "car", "motorcycle", "bicycle" and "ball". (Long press this key to switch between PSI, BAR, KPA, Kg/cm² four air pressure units.)



Car mode: Default 36psi (approximately equal to 2.5bar)



Motorcycle mode: Default 35psi (approximately equal to 2.4bar)



Bicycle mode: Default 45psi (approximately equal to 3bar)



Ball mode: Default 8psi (approximately equal to 0.6bar)

After select the matching inflation mode, the screen displays the default setting value and flashes three times at a frequency of once per second, and then enters the air pressure detection state to detect the current air pressure value of the inflated object. (When the inflated object is not connected, the air pressure value will display "0".)

Adjust Presets

After selecting the inflation mode, short press the "+" key or "-" key to adjust the preset air pressure value; long press to quickly adjust the air pressure value.

After the setting is completed, the air pressure value flashes three times at a frequency of once per second, and then the setting is automatically confirmed.

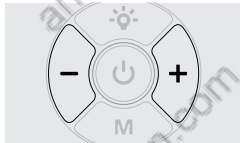

Caution:

1. When adjusting the preset air pressure value, the number flashes to indicate the target air pressure adjustment status, and the number is always on to indicate the real-time air pressure.
2. The default value will be restored after the mode is switched or restarted.
3. When inflating the swimming ring and air bed, just adjust to "ball mode".

7. Inflation Instructions



Turn on inflation: After the air pressure setting is completed, short press the "Power" button to start inflation, and the screen displays real-time air pressure changes during inflation.

Stop inflation: When the air pressure reaches the preset value, the air pump will automatically stop inflation. During the inflation process, you can also pause the inflation by short pressing the "Power" button.

Shut down: In the power-on state, press and hold the "Power" button for 2 seconds to shut down. In order to avoid accidental touch, it will automatically shut down if there is no operation within 30 seconds when it is turned on.

▲ SPECIAL REMINDER

- ① 75-80dB noise will be generated during inflation.
- ② The inflation air pressure of balloons, toy balls, swimming rings and other products is less than the range of the air pump, and the inflation cannot be automatically stopped at the preset air pressure. Please be careful when using it.
- ③ When the equipment continues to work for a long time, the temperature of the body and the gas tube will increase significantly. Please avoid touching the air tube with your hands for a long time. If the temperature is too high, please cool down before continuing to use it. Be careful of burns when disassembling the gas nozzle after use, there will be slight air leakage, please disassemble it quickly.
- ④ Increased pressure load and lower ambient temperature may cause the endurance of this device to deteriorate.
- ⑤ As the air pump generates a large amount of heat, please rest for at least 10 minutes after inflating for 10 minutes before using it.

8. Multifunctional Lighting



After the power is turned on, press the "LED light" button to turn on the lighting mode. Short press again in turn to switch to SOS distress light mode, warning light mode, and off.

▲ BASIC PARAMETERS

Brand	Andeman
Model	Epower-B05
Size	193 × 110 × 53mm
Inflation Pressure Range	0.2~10bar / 3~150psi
Operating Temperature	Charge: 0℃~45℃ , Discharge: -10℃~45℃
Storage Temperature	-10℃~50℃
Inflatable Tube Length	435mm(Including gas nozzle)
Battery Capacity	24000mAh(88.8Wh)
Working Noise	Less than 80dB away from 1 meter
Charging Input	Type-C 5V=3A
Charging Time	About 3.5 hours
USB Output 1	5V=3A, 9V=2A, 12V=1.5A
USB Output 2	5V/2.1A
Air Pressure Sensor Accuracy	±1psi
Start Car Voltage	12V
Peak Current	4000A

▲ PRECAUTIONS

Usage Notice

- This product is not a toy, and it is forbidden for children to use it; it is recommended for users over 16 years of age.
- When the product is used for the first time, charge the product for more than 3 hours.
- This product has a built-in non-removable lithium battery. It is forbidden to throw this product into a fire or throw it away at will. The lithium battery may catch fire, spontaneously ignite and explode due to overheating, impact or water. Please avoid exposure to the sun in the car, or exposed to high temperature environment.
- If the product is swollen, leaking or smells, please stop using it immediately.
- If the product has abnormal noise or high temperature during use, please stop using it and shut it down immediately.
- Please store or use in a dry and clean environment. Avoid dampness, heavy falls, water immersion and sand intrusion. The intrusion of sand and dust may cause damage to the product; this product is also not waterproof, and it is forbidden to wash in water.
- Please keep away from corrosive materials when storing this product, and the storage temperature should not be lower than -10°C or higher than 50°C . Too cold or too hot will shorten the life of the product and damage the built-in battery.
- Please keep this product charged at least once every 3 months.
- Do not disassemble the machine by yourself, otherwise it may cause a safety accident.

Inflation Notice

- The product has a built-in DC motor, which may generate electric sparks during operation. Please do not use it in an flammable and explosive environment.
- Before inflating, please confirm the required air pressure value of the inflated item to avoid personal injury caused by explosion caused by over-inflation.
- When setting the inflation air pressure value, please make sure that the measurement unit is selected correctly, otherwise it may cause accidents such as a tyre burst. Common unit conversion: 1bar=14.5psi, 1bar=100kPa.
- When inflating objects, please keep this product a safe distance from children.
- Do not bend or step on the inflation tube when inflating, and be sure to keep the airflow unobstructed.
- Operators are not allowed to leave the scene during inflation. Please observe the inflation process to prevent the inflation air pressure from being too high due to the unpreset air pressure.

Jump Start Notice

- This product can be used to start a 12V battery engine, but cannot be used to start a 24V battery engine.
- Be sure to use the cord clamp provided with the product to start the vehicle.
- It is forbidden to start the car when the power of the product is lower than 50%, otherwise it will cause damage to the product.
- Do not clamp the battery clamps at both ends, otherwise it may cause a safety accident.
- If a startup fails, please try again after at least 1 minute to avoid damage to the product.
- After starting the car, please wait at least 30 minutes before charging the product.

▲ PACKING LIST



Product ×1

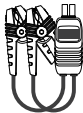

Jumper cable ×1



Guide ×1

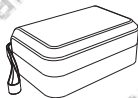

Storage bag ×1



Gas needle ×1



Gas nozzle ×2



Inflatable tube ×1



Charging cable ×1

Note: The illustrations of products, accessories, and display interface in this manual are all schematic diagrams and are for reference only. Since the product is iteratively upgraded from time to time, the actual product and the schematic diagram may be different, please refer to the actual product!

▲ TROUBLE SHOOTING

Problem	Elimination Method
Slow inflation	<ol style="list-style-type: none"> 1. Check whether the battery power is sufficient. 2. Check for air leaks in the trachea. 3. Check whether the connecting parts at both ends of the trachea are tightly installed. 4. Check whether the tires are flat.
Has been turned on, but cannot be inflated	<ol style="list-style-type: none"> 1. Check whether the battery power is sufficient. 2. Check whether the air pressure of the inflated item is higher than the preset value.
The inflation is normal, but the display pressure value is zero	Low-pressure inflated objects such as balloons are not within the measurable range of this device.
After installing the gas nozzle tightly, the power has been automatically turned off	It will automatically shut down if there is no operation within 30 seconds, just restart it.
There is air leakage when connecting the trachea	Install the trachea tightly.

▲ DISCLAIMER

1. The company does not assume any responsibility for problems caused by misoperation beyond the instructions.
2. If the product is damaged by disassembling and installing by oneself, our company will not bear any responsibility.
3. If the use of a mismatched charger causes problems, our company does not assume any responsibility.
4. The company does not assume any responsibility for products beyond the warranty period.



FCC statement:

This device complies with part 15 of the FCC Rules. Operation is subject to the following two conditions: (1) This device may not cause harmful interference, and (2) this device must accept any interference received, including interference that may cause undesired operation.

This equipment has been tested and found to comply with the limits for a Class B digital device, pursuant to part 15 of the FCC Rules. These limits are designed to provide reasonable protection against harmful interference in a residential installation. This equipment generates, uses and can radiate radio frequency energy and, if not installed and used in accordance with the instructions, may cause harmful interference to radio communications. However, there is no guarantee that interference will not occur in a particular installation. If this equipment does cause harmful interference to radio or television reception, which can be determined by turning the equipment off and on, the user is encouraged to try to correct the interference by one or more of the following measures:

- Reorient or relocate the receiving antenna.
- Increase the separation between the equipment and receiver.
- Connect the equipment into an outlet on a circuit different from that to which the receiver is connected.
- Consult the dealer or an experienced radio/TV technician for help.

Thank you for your support of our original **Audew** products, **Andeman** has upgraded the original products, launched a more efficient jump starter, and enriched the product line by adding car repair and maintenance products. We hope that this brand can bring you a one-stop shopping experience for auto supplies and meet the needs of all users for auto supplies.

Contact Us: andeman@andeman.com



EU importer: VISHTEC ltd
Address: 3 rd floor office 5, Plovdiv
2 Liuben Karavelov bul, 4002
Bulgaria
Email: compliance@vish-tec.com



UK Importer: VISHTEC UK Co., Ltd
Address: 275 ISLINGTON SUITE
1405 NEW NORTH ROAD
LONDON ENGLAND N1 7AA
Email: Vincent.feng@vish-tec.com



MADE IN CHINA