

PRODUCT WARNING

1. Do not lean diffuser during operation.
 2. Unplug from mains power when filling or cleaning.
 3. Do not empty water from the side which the air vent is located.
 4. This appliance is not intended for use by children.
 5. If the diffuser is accidentally knocked over during operation, water may enter the internal space. If so, please unplug the diffuser, empty any remaining water and allow to dry for 3 days.
- If any issues arise please contact your local retailer.

Water Pour Direction

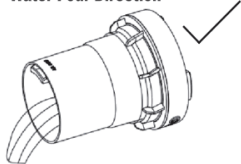

Pour water with indicated direction

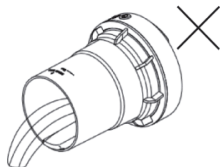

Wrong direction pouring may goes to air hole

AERIS Ultrasonic Aroma Diffuser

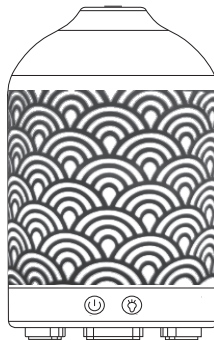

TABLE OF CONTENTS:

- A** Function
- B** Specifications
- C** Diffuser Setup
- D** Maintenance
- E** Troubleshooting
- F** Warranty



FUNCTION

With an innovative and unique design, the AERIS Ultrasonic Aroma Diffuser combines the DNA of both oriental and western cultures to bring you this fashionable diffuser.

Utilising the instantaneous benefits of ultrasonic vibrations, AERIS works silently in the background to break down your fragrance infused water into a microscopic mist that easily dissipates into the atmosphere. Leaving your mind, body and soul at peace.



SPECIFICATIONS

Product Name: AERIS Aroma Diffuser
Voltage: DC 24V
Power: 12 w
Water Capacity: 100 ml
Mist Output: 25 ml/h
Duration: 4 hrs [approx.]
8+ hrs intermittent mode
LED Effect: Colour Morphing
+ Selectable

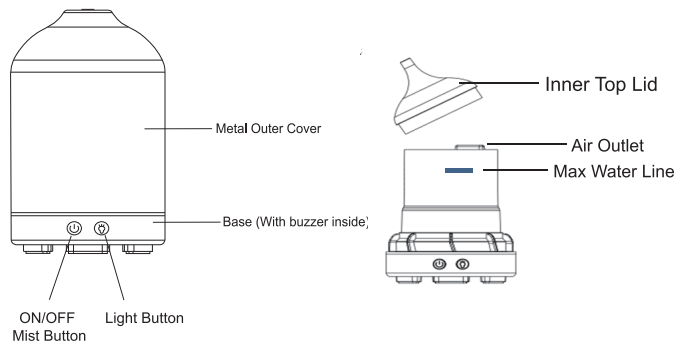

| Diffuser Operation | | | |
|--------------------|-------------------------------------|----------------------|------------------------|
| ⏻ On/Off Button | | 🌙 Night-light Effect | |
| First | Constant On | First | Colour Changing Mode |
| Second | Intermittent (30 sec on/30 sec off) | Second+ | Fixed Colour Mode |
| Third | Off | Tenth | Light Off |
| | | Hold | Turn Light Off Anytime |

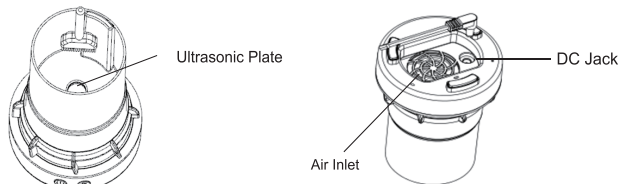



DIFFUSER SETUP

1. Place diffuser on a flat and even surface, clear of any loose or foreign objects.
2. Fill water tank to max level line - 100ml.
3. Add up to 2-5 drops of essential or fragranced oils.
4. Replace cover & connect power.
5. Press On/Off Button to turn diffuser on.
5. Press the Mist Button for desired mist output.
6. Press the Light Button for desired light effect.

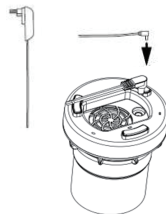

Connect Power
Cord

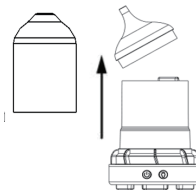

Lift & remove
covers from base

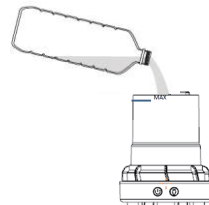

Fill with water up
to max level line



Add 3-6 drops of
your favourite oil

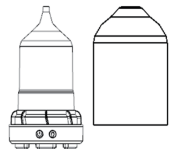

Replace outer and
inner cover

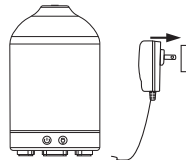

Plug in power
adaptor into outlet



MAINTENANCE

To keep your diffuser in great working order, we recommend that you clean once a week.

1. Turn off diffuser and unplug from power.
2. Remove cover.
3. Empty any remaining water from tank.
4. Wash with a 50/50 mix of vinegar and warm water.
5. Clean water tank and around ultrasonic pad with a clean, soft-cotton tip.
6. Replace cover and clean exterior with clean damp cloth.

We recommend that if not in use for a prolonged period, please remove any standing water

For further Diffuser Maintenance, please visit: www.alcyon.com.au



Unplug diffuser
from mains power

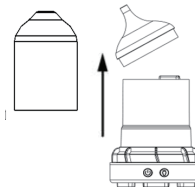

Lift & remove
cover



Empty any
remaining water



Wash with the
water/vinegar mix



Lightly wipe internals
with clean cloth

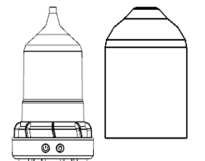

Replace cover and
wipe exterior



TROUBLESHOOTING

| Symptom | Possible Cause | Solution |
|---------|---|---|
| NO MIST | Power not connected | Plug in power adaptor and press mist button to activate |
| | Insufficient water | Fill tank with water |
| | Too much water (100ml+) | Tip out excess water |
| | The mist outlet blocked by water droplets or oil build-up | Clean outlet vent cotton tip |
| | Poor performance due to dirty | Clean ultrasonic pad |
| | Cover not seated or sealed properly against base unit | Reseat cover |



WARRANTY CARD

All Alcyon Ultrasonic Diffusers are covered by a limited one year warranty from date of purchase.

Date of purchase: ____ / ____ / ____
(please keep your receipt with Warranty Card as Proof of Purchase)

Should you be experiencing any issues with your diffusers, please visit www.alcyon.com.au or call 1300 882 332.
(please have your diffuser on hand when calling)

Terms and Conditions:

- A dated receipt is required as Proof of Purchase for warranty purposes.
- This warranty is for operational faults only, and does not cover issues such as breakages or faults arising from misuse.
- Any returned items from customers to Alcyon will be at the consumer's expense and must be accompanied with a RA (Return Authorisation) number issued by Alcyon. Unless a prior arrangement has been made.
- Any goods received without a RA number will not be accepted and returned to the sender.
- The determination of faults is at the discretion of Alcyon Australia, with the item to be either repaired or replaced.
- Return shipping from Alcyon to the customer is to be at Alcyon's expense.

Alcyon Australia
PO Box 50
LINFIELD NSW 2070

1300 882 332

info@alcyon.com.au
www.alcyon.com.au