



Gaming Headset Operating Instructions

ForceOne41



PS4/ PS5 Connection and Usage Instructions

1、Wired Connection

- ①: Turn on the PS console.
- ②: Connect one end of the provided audio cable to the 3.5mm port on the controller and the other end to the 3.5mm port on the headphones for use.

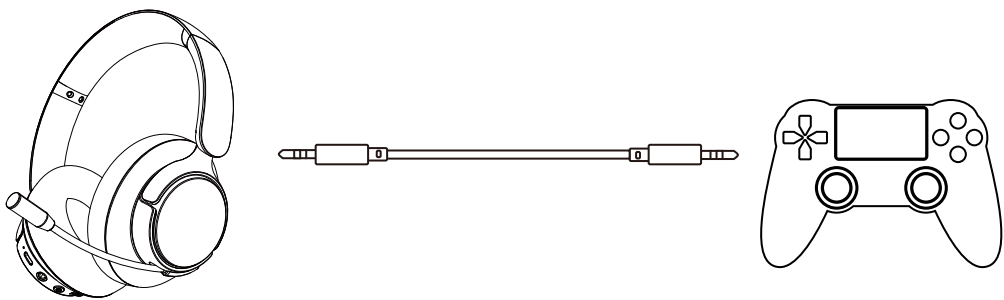

2、2.4G Connection

- ①: Turn on the PS console.
- ②: Switch the headphone mode toggle to 2.4G mode.
- ③: Insert the 2.4G dongle into the USB A port on the PS console.
- ④: Press and hold the headphone power button for 3 seconds to turn it on, with the blue light flashing for 1 second. After turning on, it will automatically connect, accompanied by a connection voice prompt. (Steps 2, 3, and 4 can be done in any order)

Warm Tip: When using headphones connected via 2.4G, it is recommended that customers connect the controller to the console using a wired connection for gaming to prevent potential signal interference that may affect the user's gaming experience.

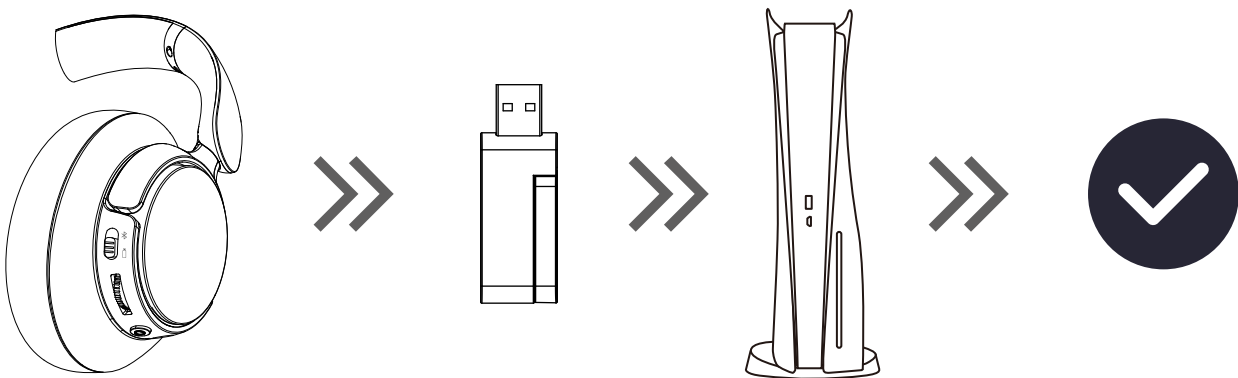



XBOX Connection and Usage Instructions

- ①: Xbox console is powered on, and the controller is already connected to the console.
- ②: Insert the audio cable into the Xbox controller, and connect the other end to the headphones to use.

Note: Non-original controllers may not be supported, specific inquiries should be directed to the controller seller.

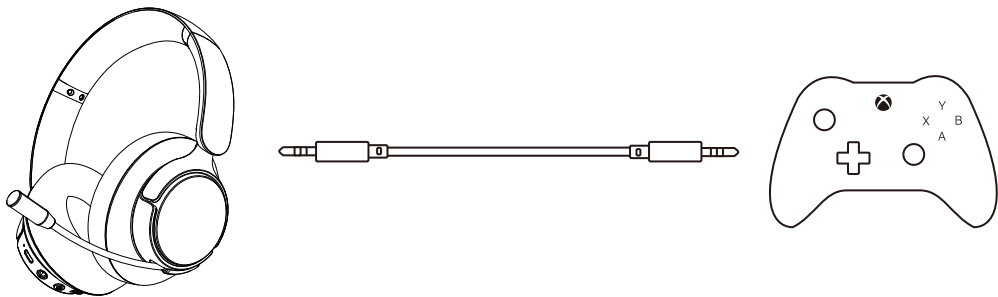

Nintendo Switch Connection and Usage Instructions



Tabletop Mode



Handheld Mode

1、2.4G Connection

- ①: Ensure the Switch remains powered on.
- ②: Switch the headphone mode toggle to 2.4G mode.
- ③: Press and hold the headphone power button for 3 seconds to turn it on, with the blue light flashing for 1 second.
- ④: Insert the 2.4G dongle's Type-C port into the Switch handheld console's C port, and it will automatically complete the connection.

Note: Can only be used in Tabletop Mode and Handheld Mode.

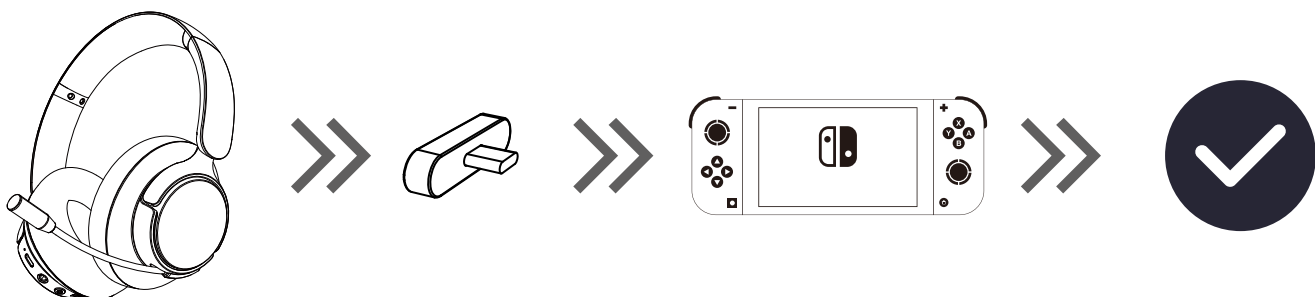

1、Wired Connection

- ①: Turn on the Switch.
 - ②: Connect the audio cable between the handheld console and the headphones.
- Note: Can only be used in Tabletop Mode and Handheld Mode.

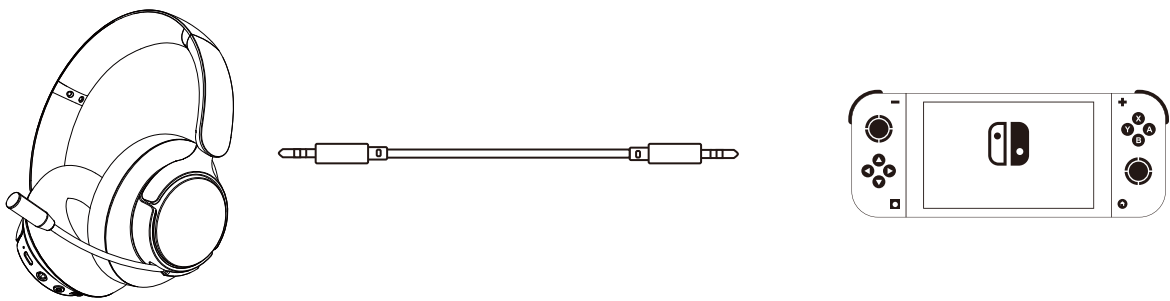

PC Connection and Usage Instructions

1、2.4G Connection

- ①: Ensure the PC remains powered on.
- ②: Switch the headphone mode toggle to 2.4G mode.
- ③: Press and hold the headphone power button for 3 seconds to turn it on, with the blue light flashing for 1 second.
- ④: Insert the 2.4G dongle into the computer's USB A port, and it will automatically complete the connection.

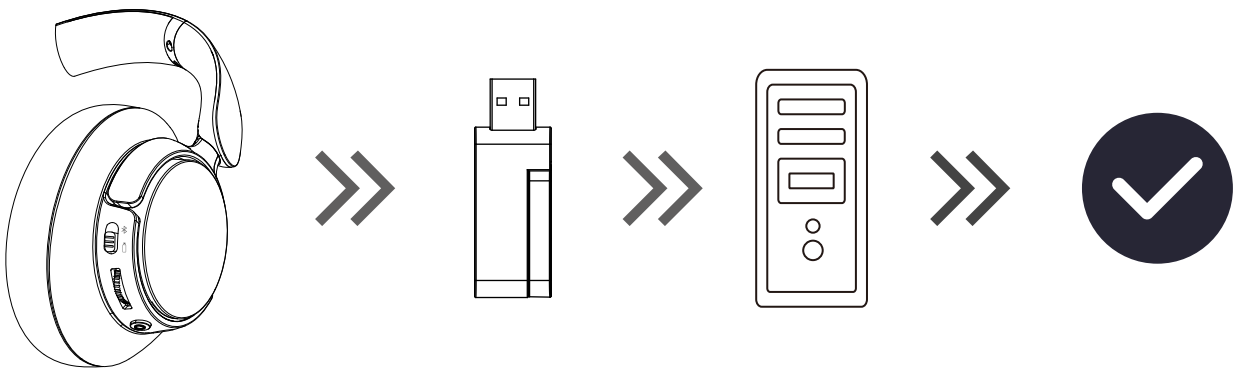

2、Bluetooth Connection

- ①: Switch the mode toggle to Bluetooth mode.
 - ②: Press and hold the power button for 3 seconds to turn it on - the blue light flashes for one second, followed by alternating red and blue lights.
 - ③: Turn on the Bluetooth on your computer and search for "FORCEONE41" to connect.
- Note: The computer needs to support Bluetooth features for this connection method.

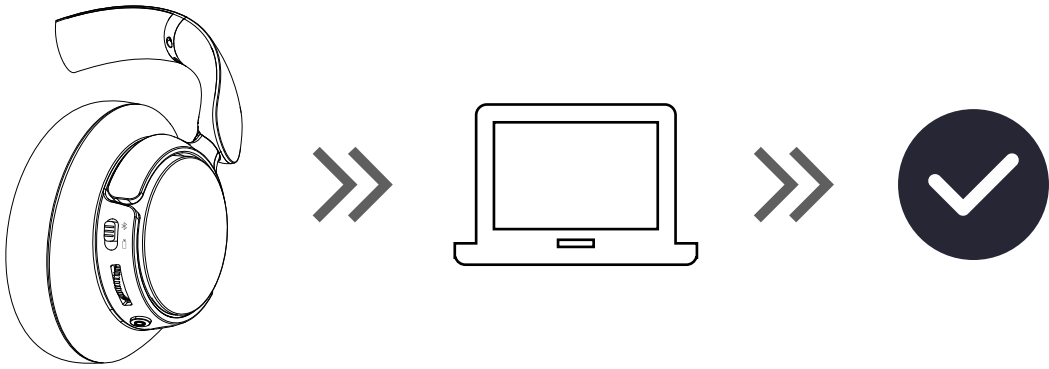

3、Wired Connection

