

volkano

Race Series



BLUETOOTH EARPHONES INSTRUCTION MANUAL

Please read and retain these instructions for future reference.

FEATURES:

- Bluetooth
- Walk and talk
- Comfort fit ear hooks

SPECIFICATIONS:

Bluetooth Wireless	: V4.1
Bluetooth Range	: 10m
Battery Capacity	: 100mAh
Charge Time	: 2 hrs
Play Time	: 4 hrs
Driver Size	: Ø10mm
Sensitivity	: 100dB ± 5dB

WHAT'S IN THE BOX:

- Volcano Race Bluetooth Earphones
- USB to micro USB charging cable
- Instruction Manual

IDENTIFYING PARTS ON DEVICE:

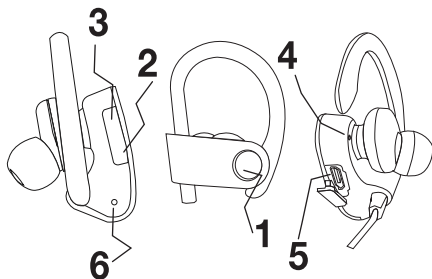

1. Multifunction Button Answer, end, reject call, Play, Pause, ON/OFF
2. Next song/Volume up
3. Previous song/Volume down
4. Microphone
5. USB Charging Port
6. Indicator Light

CHARGING

Please ensure that the battery is fully charged before using the device for the first time.

- Connect the provided micro USB charge cable to the DC 5V charging slot on the earphones, connect the other end of the USB to a wall charger or an available USB port on a compatible device.
- The red LED indicator light will display in a solid light.
- When the earphones are fully charged, the LED indicator light will turn off.
- The red LED indicator light will flash when the battery is low.

POWERING UP

- To switch on the device, press and hold the multifunction key for about 3 seconds until the red LED lights comes on and starts flashing.
- To switch off the device, press and hold the multifunction button for about 6 seconds until the red LED light comes on and goes off.

BLUETOOTH PAIRING AND PLAYING MUSIC

- Ensure that the earphones are off before pairing them for the first time.
- Press and hold the multifunction key for about 3 seconds until the red LED lights comes on and starts flashing.
- This means the earphones are now ready to pair with your Bluetooth device.
- Ensure that your device's Bluetooth is on. Search for the device "Race". Confirm pairing by selecting the device from the list.
- If prompted for a password, enter "0000" on your device.
- When successfully paired, the blue LED light will flash twice every 4 seconds.
- The device is now ready to make/receive calls and playback music.
- To play the next or previous track, press the volume up/ next track selection or volume down/previous track selection
- To adjust the volume, press and hold the volume up/ next track selection or volume down/previous track selection accordingly
- To play or stop the music, press the multifunction key.

CALLING FUNCTIONS:

Answering a call:

To answer an incoming call, press the multifunction button once. The earphones will answer the call.

Rejecting a call:

To reject an incoming call, press and hold down the multifunction button, or use your mobile phone to reject the call.

Hang up a call:

To end a call, press the multifunction button once or use your mobile phone to end the call.

Redial the last dialled call:

While in standby mode, double click the multifunction button, the earphones will redial the last number dialled.

ENVIRONMENTALLY FRIENDLY DISPOSAL



Do not dispose of electrical appliances as unsorted municipal waste, use separate collection facilities. Contact your local government for information regarding the collection systems available. If electrical appliances are disposed of in landfills or dumps, hazardous substances can leak into the groundwater and get into the food chain, damaging your health and well-being.

WARNING: CHOKING HAZARD.

This product contains small parts and is not suitable for children.

WARNING: Do not listen to loud music for extended periods of time, doing so may damage your hearing.