



Anker Innovations Limited. All rights reserved, registered in the United States and other countries.



Model: T8N00, T8E00, T8P00, T8P10
51005005531_V5



NVR Security System

Quick Start Guide

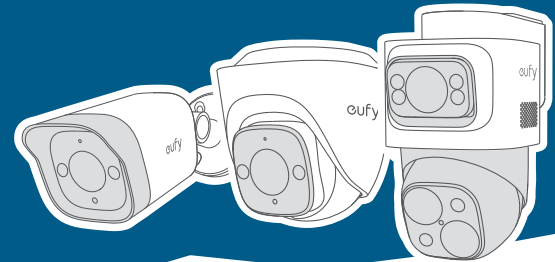

Video/User Guide/Support

The type and number of cameras vary by bundle package.

What's in the Box

Make sure everything is included. Anything missing? Please contact support@eufy.com.

For NVR Installation



Network Video Recorder S4
(with pre-installed 2TB hard drive)



Power Adapter



HDMI Cable



1m Ethernet Cable



USB Mouse

For PoE Cam S4 Installation



PoE Cam S4



Positioning Sticker



Screw Pack



Mounting Bracket



18m Ethernet Cable



Waterproof Cover Pack

For PoE Cam E41 Installation



PoE Cam E41



Positioning Sticker



Screw Pack



Mounting Bracket



18m Ethernet Cable



Waterproof Cover Pack

For PoE Cam E40 Installation

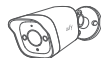

PoE Cam E40



Positioning Sticker



Screw Pack



18m Ethernet Cable



Waterproof Cover Pack

Tools/Devices You will Need



Phillips Screwdriver



Power Drill
13/16" (20.6 mm) & 1/4" (6.3 mm)



Hammer



Ladder



Monitor/TV



Router

At a Glance

NVR

Front

- ① Hard Drive LED
- ② Network LED
- ③ Power LED
- ④ QR Code

Back

- ① SYNC Button
- ② Reset Hole
- ③ Power Port
- ④ Audio Output Port
- ⑤ USB-C Port
- ⑥ USB-A Port
- ⑦ HDMI Port
- ⑧ LAN Port
- ⑨ PoE Ports
- ⑩ Grounding Screw

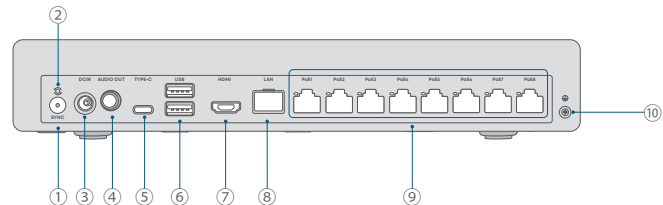

PoE Cam S4

- ① Mounting Base
- ②/⑩/⑫ Spotlight
- ③/④/⑧ Camera Lens
- ⑤ LED Indicator
- ⑥/⑨ Microphone
- ⑦ Warning Light
- ⑪ Speaker
- ⑬/⑭ Spring Screw
- ⑮ SD Card Slot
- ⑯ SYNC/Reset Button
- ⑰ Fusion Link Port
- ⑱ DC Connector
- ⑲ PoE Connector

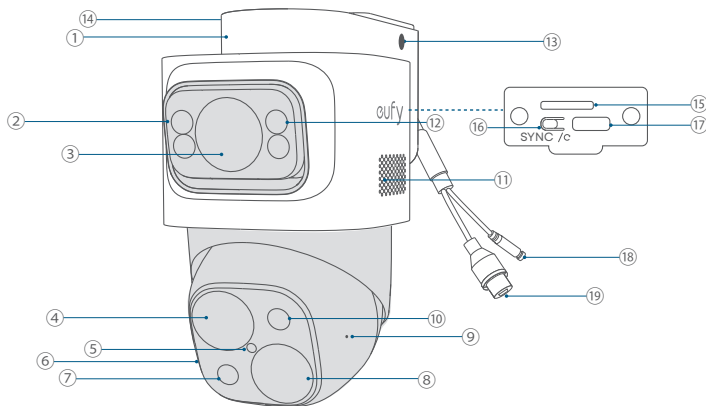

PoE Cam E41

- ① Mounting Base
- ② Microphone
- ③ Camera Lens
- ④ Spotlight
- ⑤ LED Indicator
- ⑥ Speaker
- ⑦ Warning Light
- ⑧ Cable Notch
- ⑨ SYNC/Reset Button
- ⑩ SD Card Slot
- ⑪ Fusion Link Port
- ⑫ PoE Connector
- ⑬ DC Connector

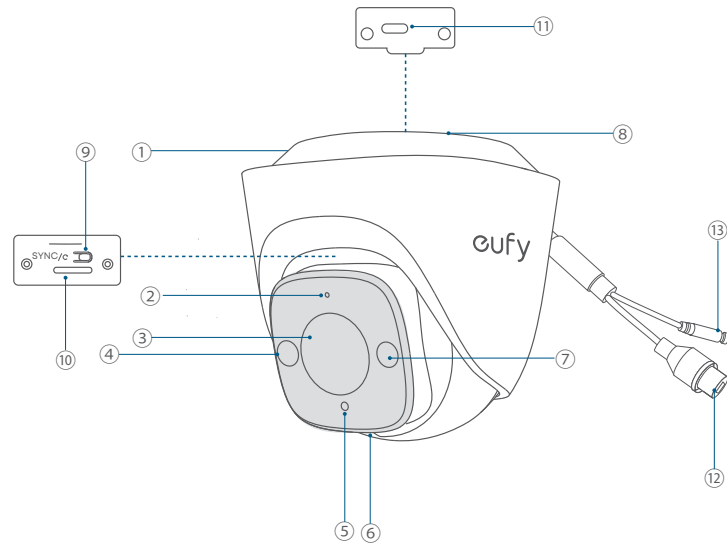

PoE Cam E40

- ① Microphone
- ② Camera Lens
- ③ Spotlight
- ④ LED Indicator
- ⑤ Warning Light
- ⑥ SYNC/Reset Button
- ⑦ SD Card Slot
- ⑧ Fusion Link Port
- ⑨ Camera Bottom Screw
- ⑩ Angle Adjustment Knob
- ⑪ Bracket Bottom Screw
- ⑫ Cable Notch
- ⑬ Mounting Bracket
- ⑭ PoE Connector
- ⑮ DC Connector
- ⑯ Speaker

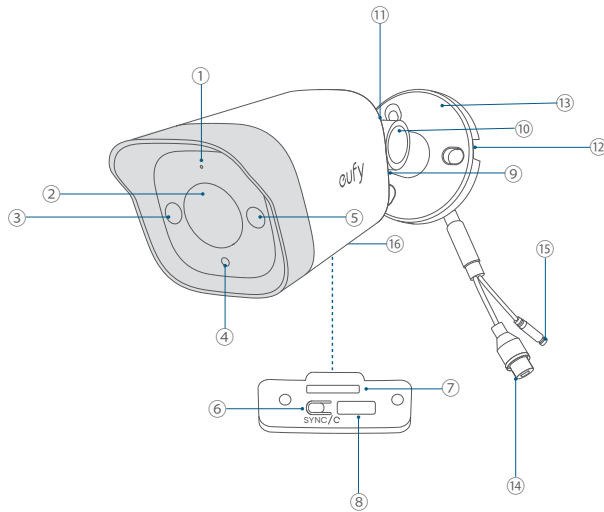

Getting Started

1 Connect the NVR Security System

1 Connect NVR to Your Router

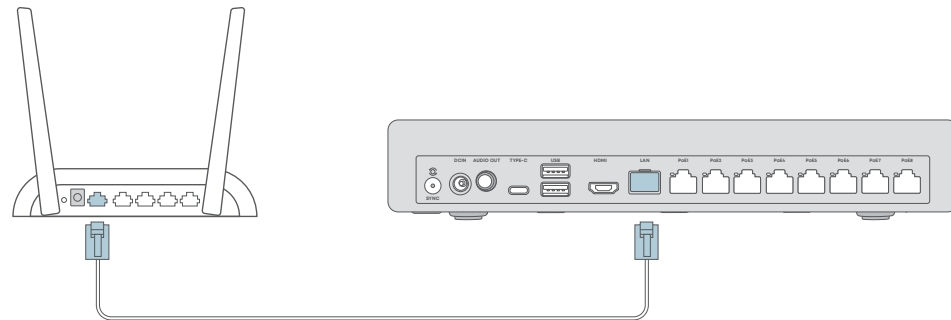

2 Connect Mouse and Monitor to NVR

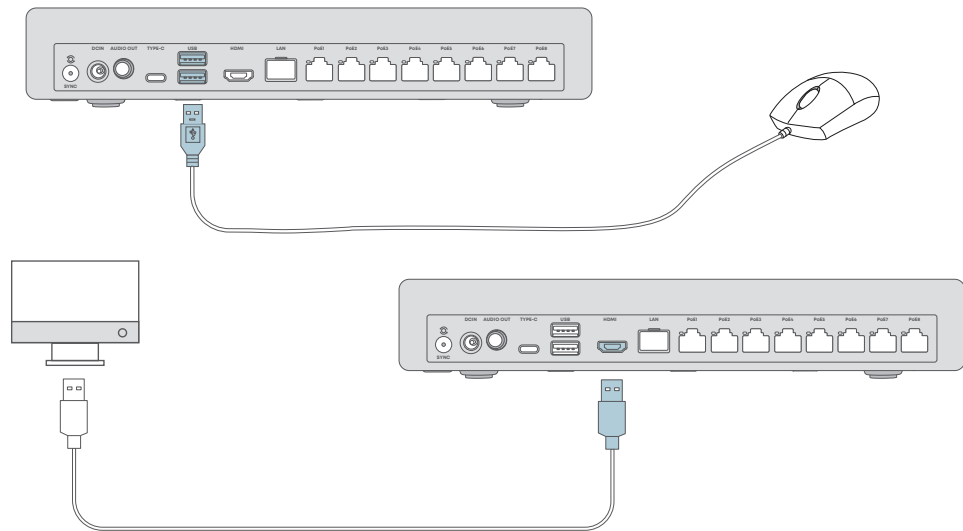

3 Connect Cameras to NVR

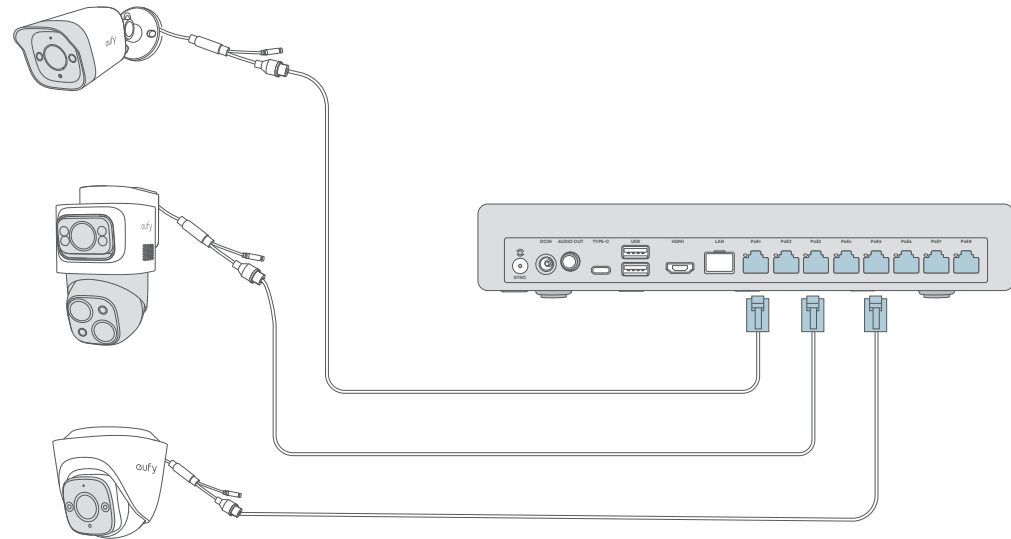

4 Connect to Power Supply

💡 Please leave a minimum clearance of 20 mm (0.78") on the left and right sides of the NVR for proper ventilation.

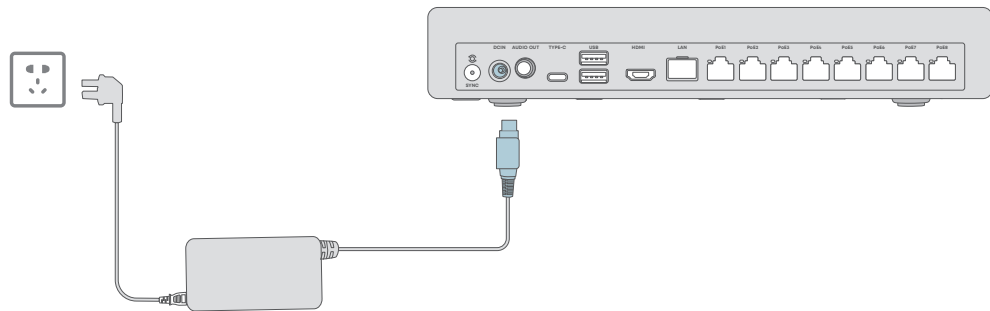

2 Set Up NVR Access

Option A - Set Up with Your Monitor/TV

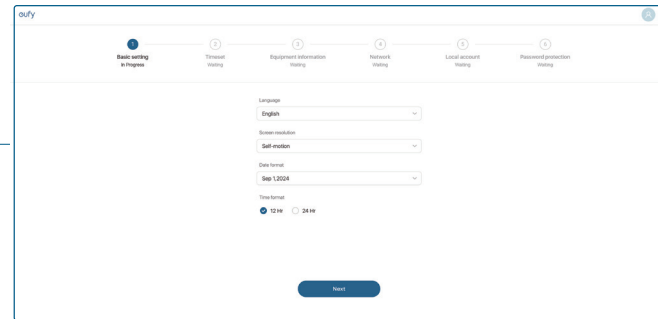
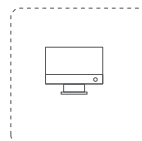

Option B - Connect NVR to the eufy App



① Download the eufy App



Follow in-app instructions to complete setup.



② Add NVR

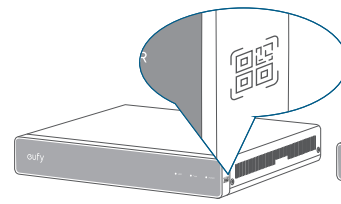

③ Scan QR Code

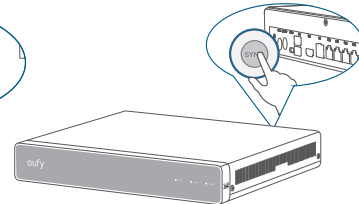

④ Sync NVR



⑤ Pair

3 Mount the Cameras

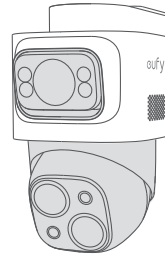

PoE Cam S4

Page 16

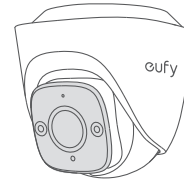

PoE Cam E41

Page 28

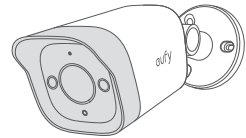

PoE Cam E40

Page 41

Mounting PoE Cam S4

Step 1. Get Items Ready

For PoE Cam S4 Installation



PoE Cam S4



Positioning Sticker



Screw Pack



Mounting Bracket



18m Ethernet Cable



Waterproof Cover Pack

Tools/Devices You will Need



Phillips Screwdriver



Power Drill
13/16" (20.6 mm) & 1/4" (6.3 mm)



Hammer



Ladder

Step 2. Choose a Location

Recommended Location:

- Height of 2 m to 3 m (7 ft to 10 ft)
- 20 m (65ft) Field of View (for Telephoto Lens)
- On the Ceiling or on a Wall

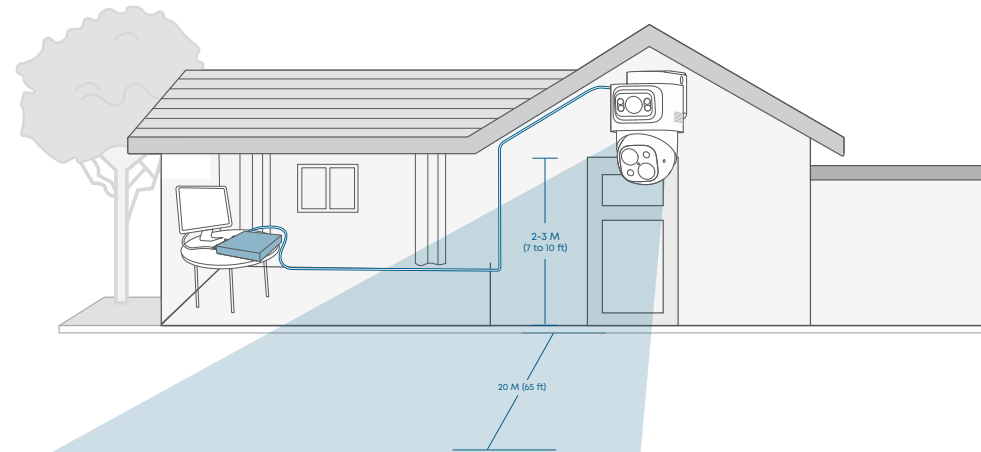

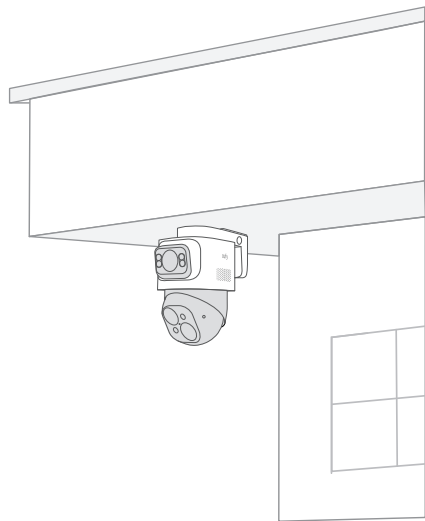

On the Ceiling

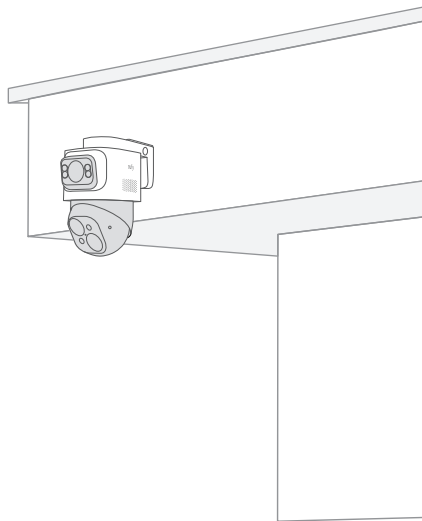

On the Wall

Step 3. Drill Cable Hole

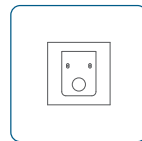

13/16" (20.6 mm)

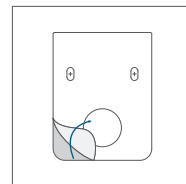

① Position

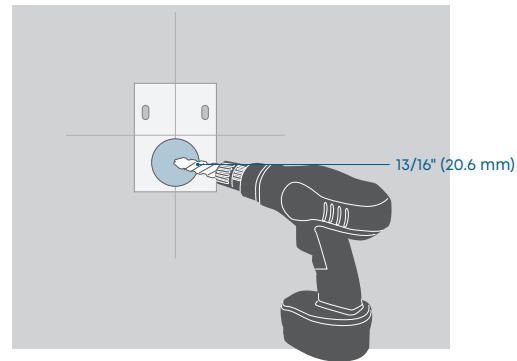

② Drill Holes

Step 4. Drill Screw Holes

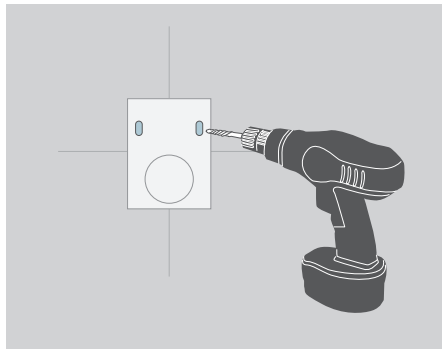
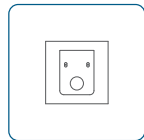

Step 5. Insert Anchors

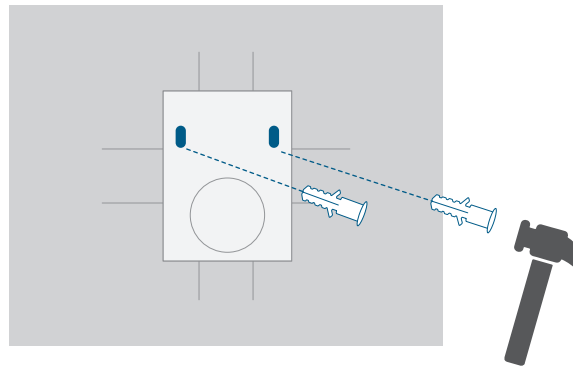
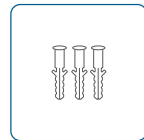

Step 6. Install the Mounting Bracket

This bracket can be installed either way —just attach the side with 3 holes to the wall/ceiling.

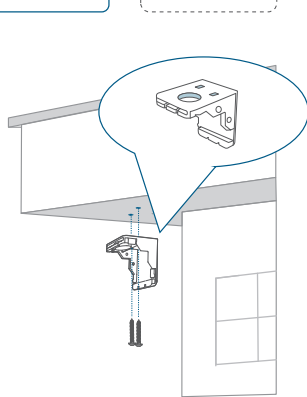
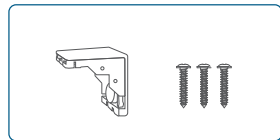

Ceiling Mounting

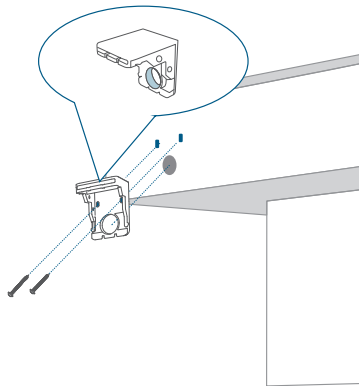

Wall Mounting

Step 7. Mount the Camera

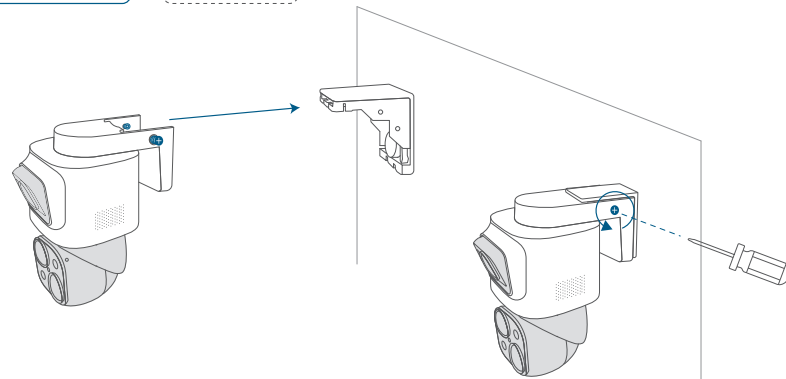
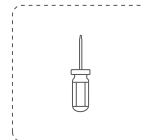
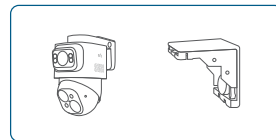

① Insert the Camera

② Lock the Spring Screws

Step 8. Connect Camera to the NVR

- 1 Connect the camera with the Ethernet cable.
- 2 Ensure the Ethernet cable is connected to the NVR.

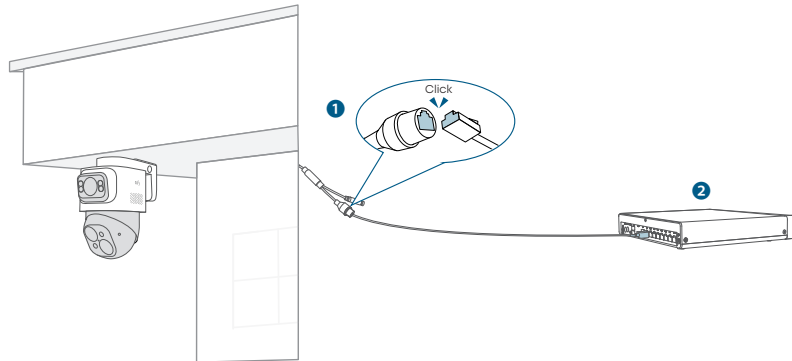
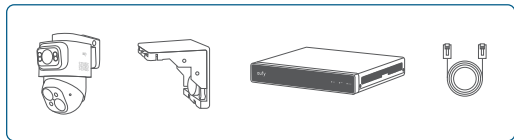

If the cable connector is exposed outside...

- 1 Route the cable through the cable notch.
- 2 Ensure the connector is positioned **downward** to prevent water intrusion.
- 3 Install the waterproof cover and connect the camera with the Ethernet cable ([next page](#)).
- 4 Ensure the Ethernet cable is connected to the NVR.

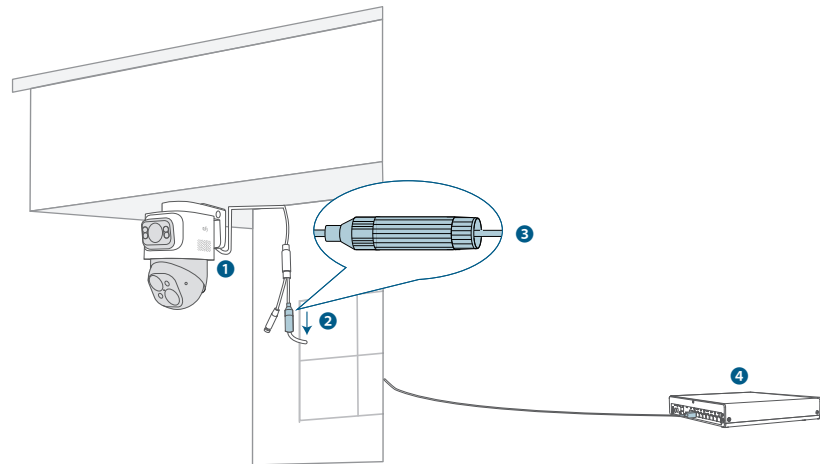

Waterproofing Cable Connectors

- 1 Ensure **A** is pre-installed on the PoE connector of the camera.
- 2 Route the Ethernet cable through these components in order: **B**, **C**, and **D**.
- 3 Plug the Ethernet cable into the camera PoE connector.
- 4 Attach **D** with the camera PoE connector, and twist to lock.
- 5 Insert **C** into **D**, and rotate **B** to secure it to **D**.

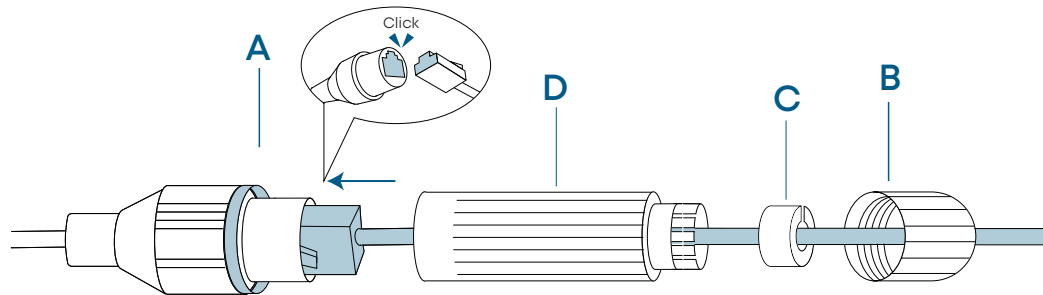

 The shape of the waterproof cover and the connector may vary slightly.

Step 9. Adjust the Camera Field of View

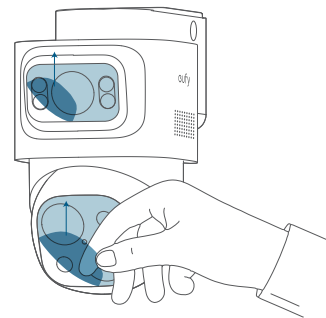
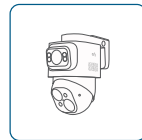

1 Remove the Protective Film

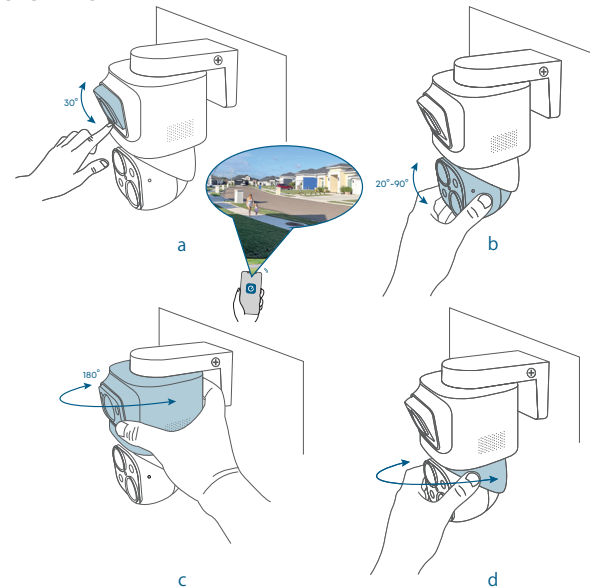

2

- Rotate the Camera to the Optimal Angle
- Check the Live Stream in the App

Mounting PoE Cam E41

Step 1. Get Items Ready

For PoE Cam E41 Installation



PoE Cam E41



Positioning Sticker



Screw Pack



Mounting Bracket



18m Ethernet Cable



Waterproof Cover Pack

Tools/Devices You will Need



Phillips Screwdriver



Power Drill
13/16" (20.6 mm) & 1/4" (6.3 mm)



Hammer



Ladder

Step 2. Choose a Location

Recommended Location:

- Height of 2 m to 3 m (7 ft to 10 ft)
- 12 m (39 ft) Field of View
- On the Ceiling or on a Wall

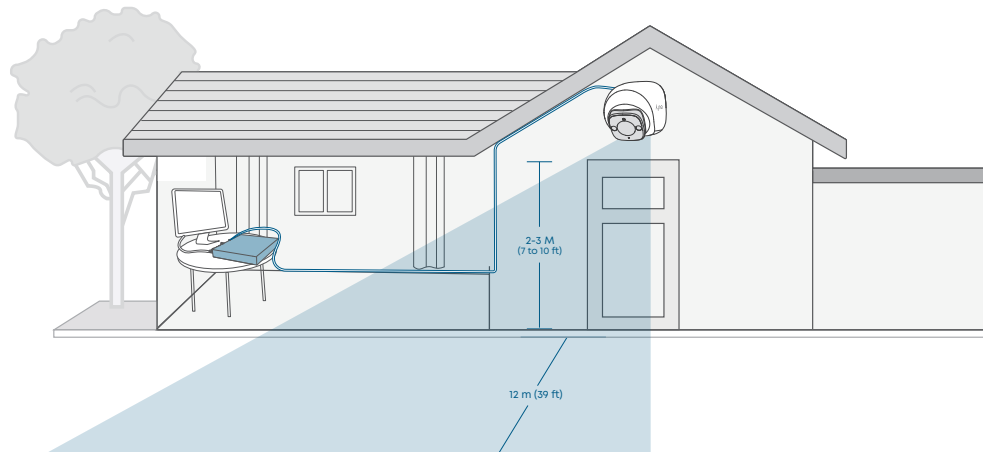

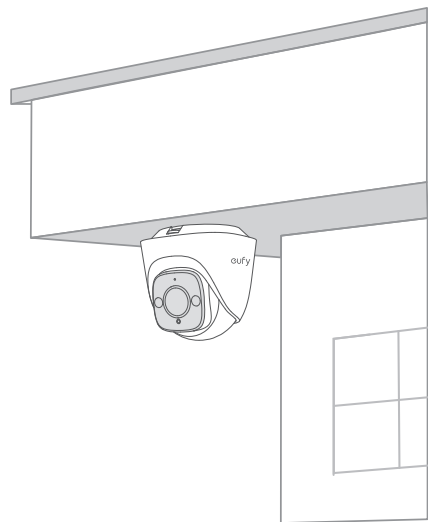

On the Ceiling

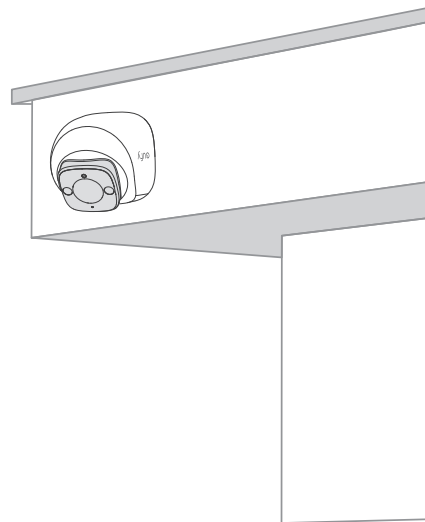

On the Wall

Step 3. Drill Cable Hole

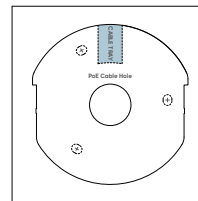
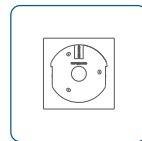

a

① Determine Cable Direction

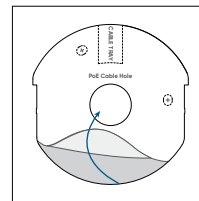

b

② Position

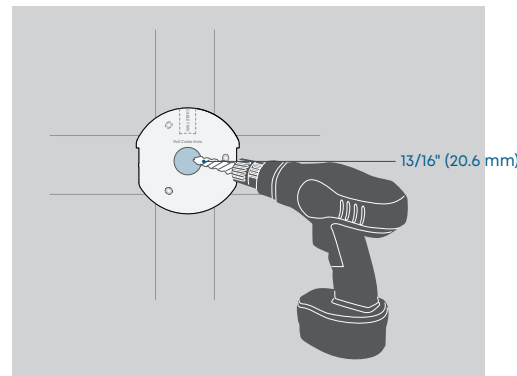

③ Drill Holes

Step 4. Drill Screw Holes

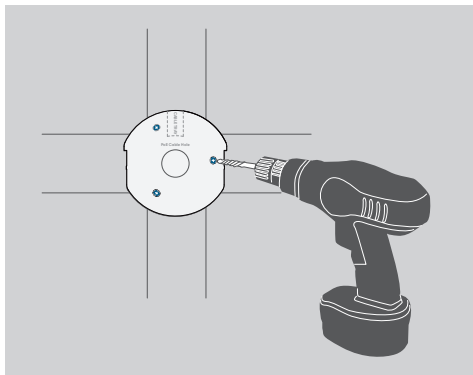
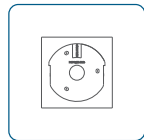

Step 5. Insert Anchors

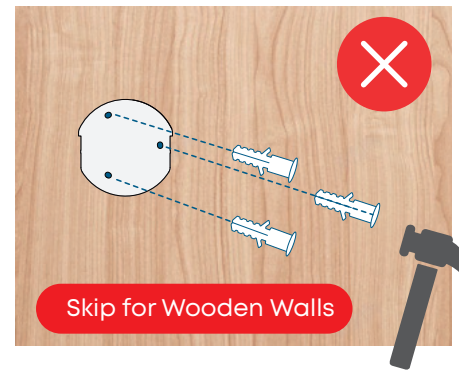
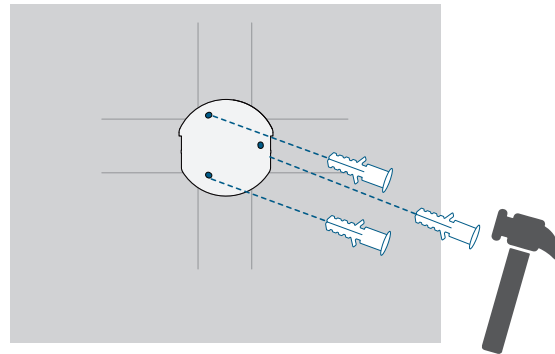
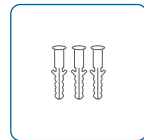

Step 6. Install the Mounting Bracket

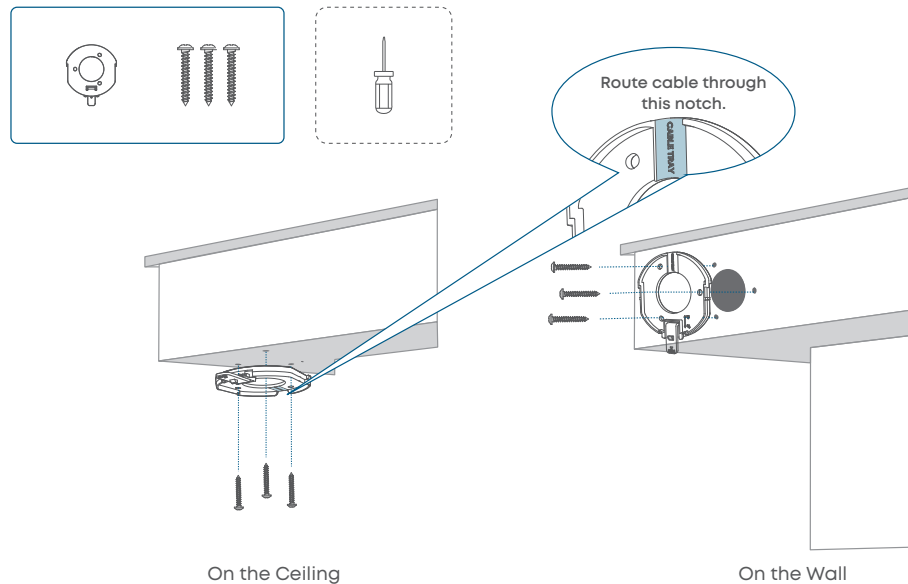

Step 7. Mount the Camera

Ceiling Mounting

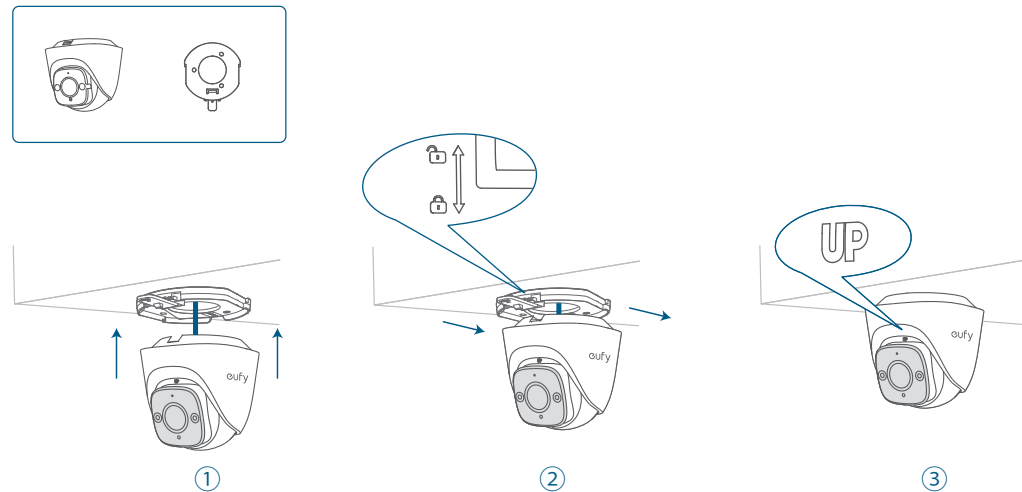

💡 Ensure the camera is ALWAYS positioned upright with the 'UP' mark facing upward; otherwise, the live stream image will appear upside down.

Wall Mounting

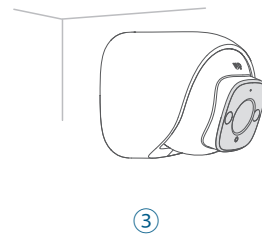
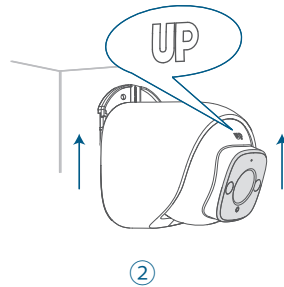
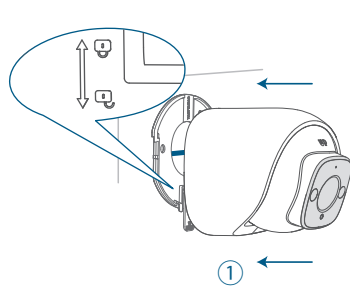
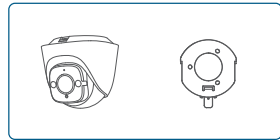

⚡ Ensure the camera is ALWAYS positioned upright with the 'UP' mark facing upward; otherwise, the live stream image will appear upside down.

Step 8. Connect Camera to the NVR

- 1 Connect the camera with the Ethernet cable.
- 2 Ensure the Ethernet cable is connected to the NVR.

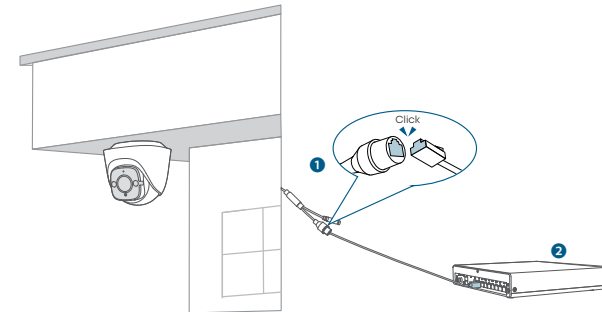
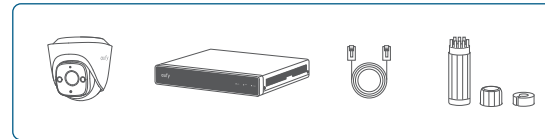

If the cable connector is exposed outside...

- 1 Route the cable through the cable notch.
- 2 Ensure the connector is positioned **downward** to prevent water intrusion.
- 3 Install the waterproof cover and connect the camera with the Ethernet cable ([next page](#)).
- 4 Ensure the Ethernet cable is connected to the NVR.

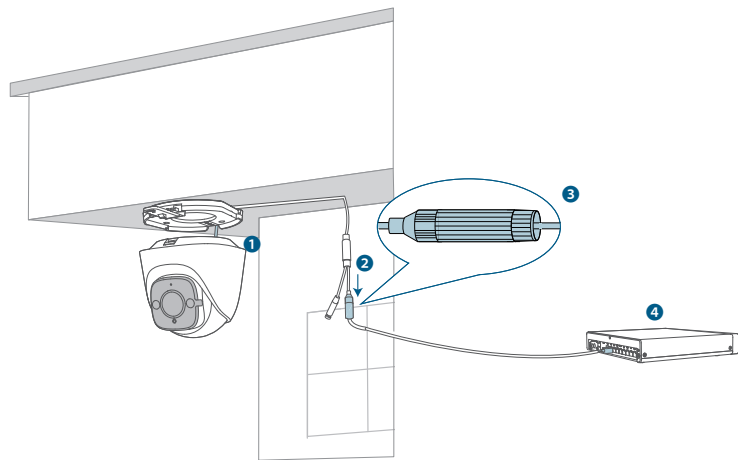

Waterproofing Cable Connectors

- 1 Ensure **A** is pre-installed on the PoE connector of the camera.
- 2 Route the Ethernet cable through these components in order: **B**, **C**, and **D**.
- 3 Plug the Ethernet cable into the camera PoE connector.
- 4 Attach **D** with the camera PoE connector, and twist to lock.
- 5 Insert **C** into **D**, and rotate **B** to secure it to **D**.

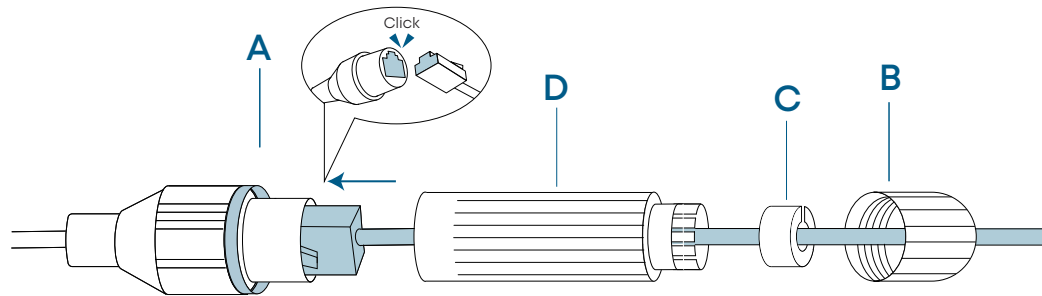

 The shape of the waterproof cover and the connector may vary slightly.

Step 9. Adjust the Camera Field of View

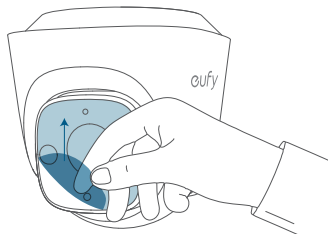
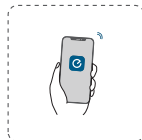
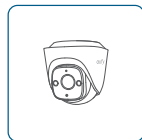

1 Remove the Protective Film

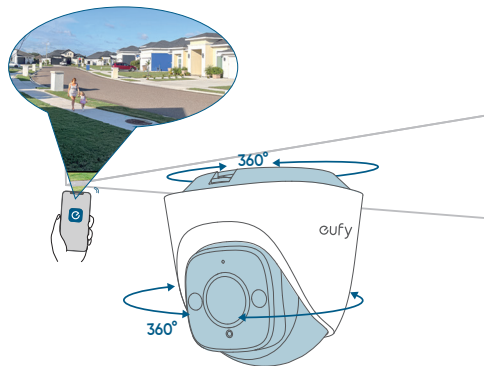

2 • Rotate the Camera to the Optimal Angle
• Check the Live Stream in the App

Mounting PoE Cam E40

Step 1. Get Items Ready

For PoE Cam E40 Installation



PoE Cam E40



Positioning Sticker



Screw Pack



18m Ethernet Cable



Waterproof Cover Pack

Tools/Devices You will Need



Phillips Screwdriver



Power Drill
13/16" (20.6 mm) & 1/4" (6.3 mm)



Hammer



Ladder

Step 2. Choose a Location

Recommended Location:

- Height of 2 m to 3 m (7 ft to 10 ft)
- 12 m (39 ft) Field of View
- On the Ceiling or on a Wall

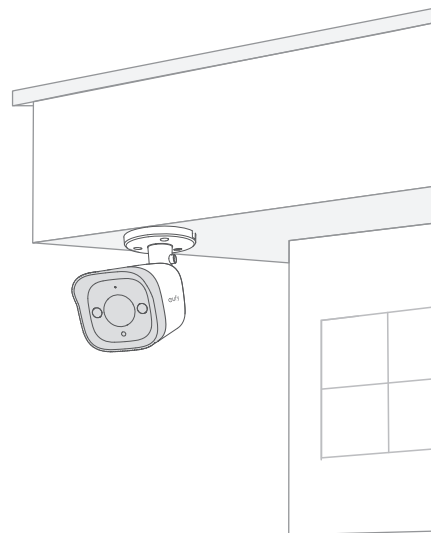
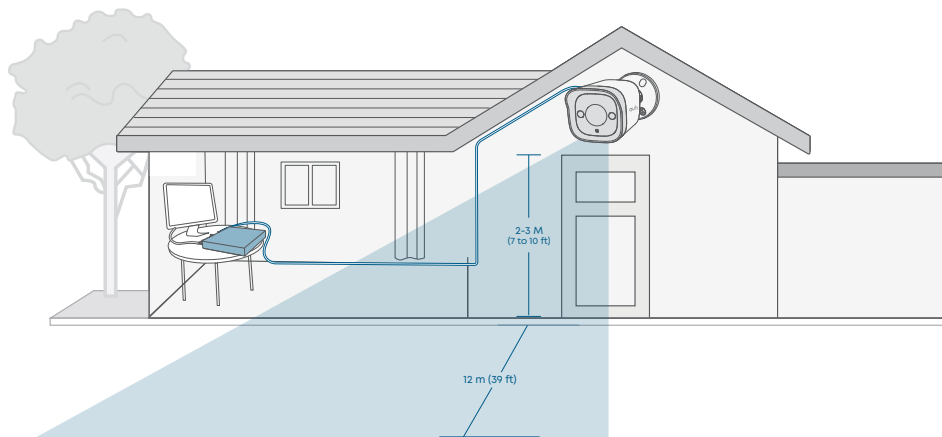

On the Ceiling

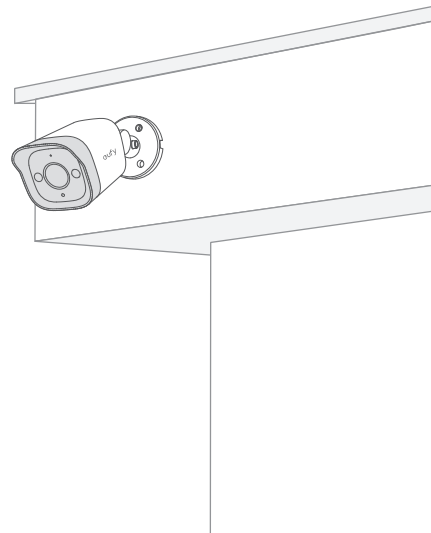

On the Wall

Step 3. Drill Cable Hole

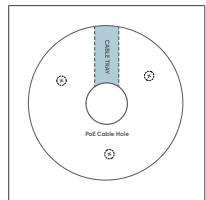
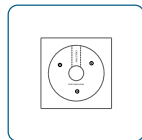

a

① Determine
Cable Direction

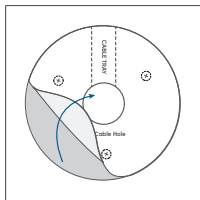

b

② Position

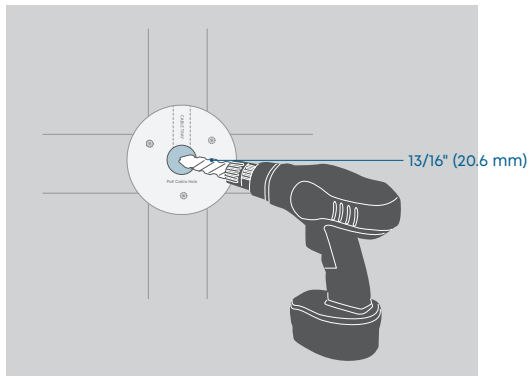

③ Drill Holes

Step 4. Drill Screw Holes

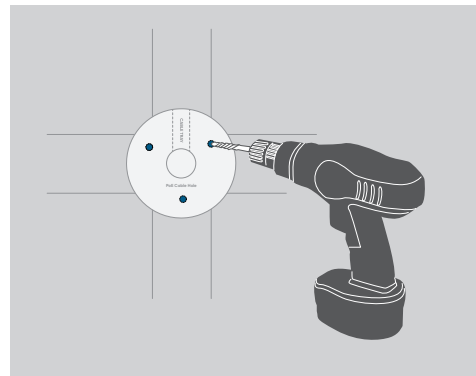
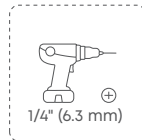
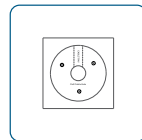

Step 5. Insert Anchors

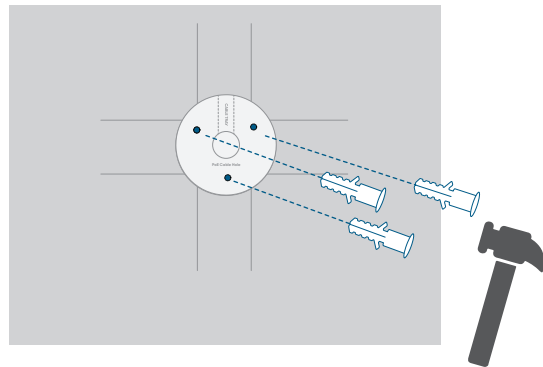
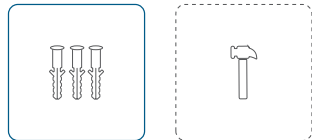

Step 6. Mount the Camera

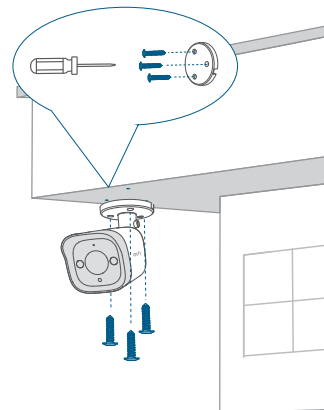

On the Ceiling

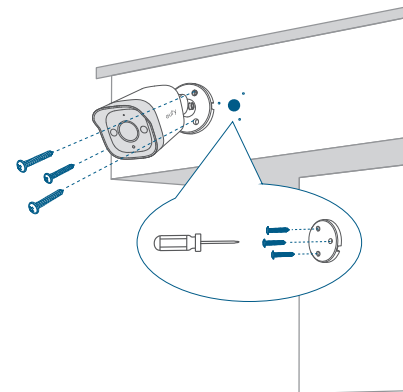

On the Wall

Step 7. Connect Camera to the NVR

- 1 Connect the camera with the Ethernet cable.
- 2 Ensure the Ethernet cable is connected to the NVR.

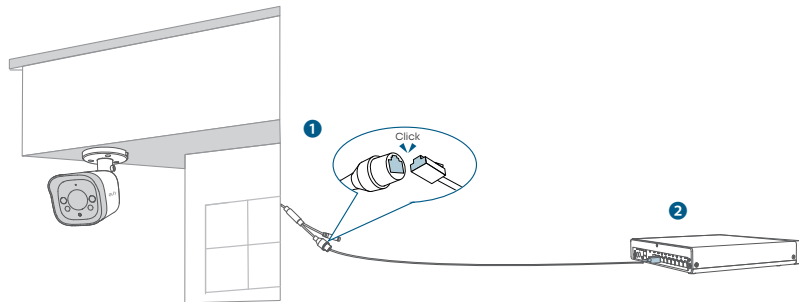
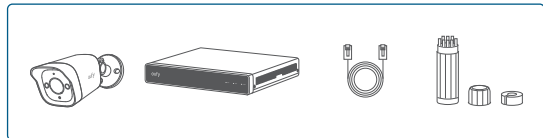

If the cable connector is exposed outside...

- 1 Route the cable through the cable notch.
- 2 Ensure the connector is positioned **downward** to prevent water intrusion.
- 3 Install the waterproof cover and connect the camera with the Ethernet cable ([next page](#)).
- 4 Ensure the Ethernet cable is connected to the NVR.

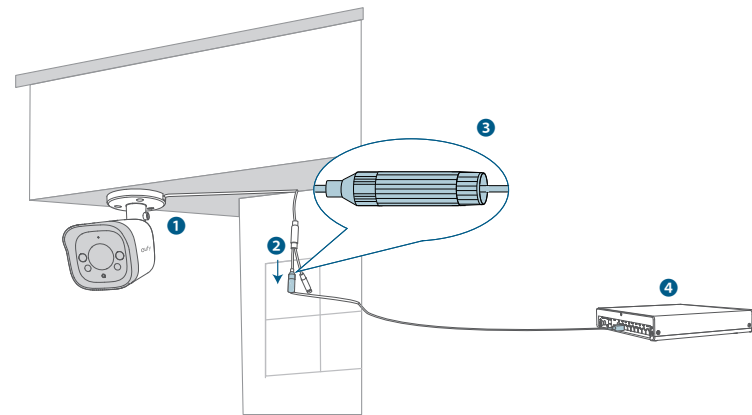

Waterproofing Cable Connectors

- 1 Ensure **A** is pre-installed on the PoE connector of the camera.
- 2 Route the Ethernet cable through these components in order: **B**, **C**, and **D**.
- 3 Plug the Ethernet cable into the camera PoE connector.
- 4 Attach **D** with the camera PoE connector, and twist to lock.
- 5 Insert **C** into **D**, and rotate **B** to secure it to **D**.

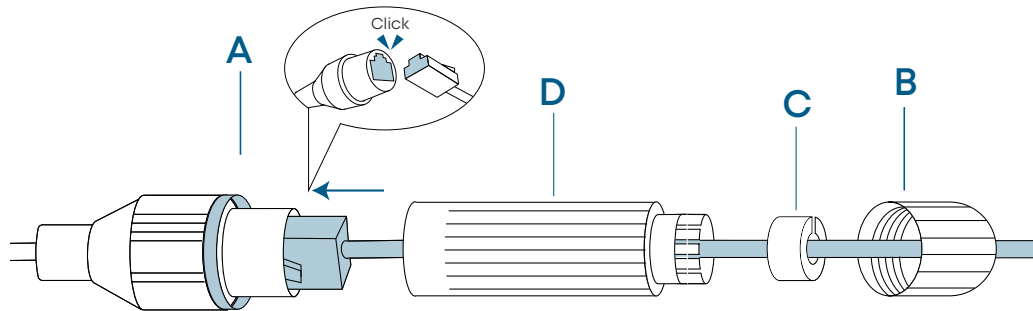

 The shape of the waterproof cover and the connector may vary slightly.

Step 8. Adjust the Camera Field of View

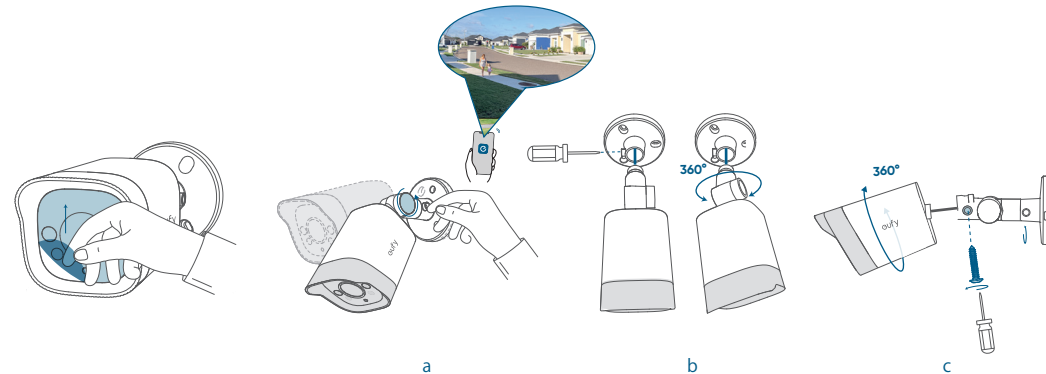
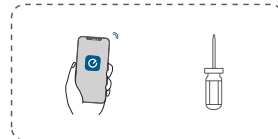
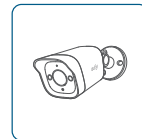

1 Remove the Protective Film

- 2
- Adjust the Knob or Screws to Get an Optimal Angle
 - Check the Live Stream in the App



Congratulations!

Now you're all set to use your NVR security system!

Important Safety Instructions

- The recommended temperature range for T8P00, T8P10, and their accessories is -30°C to 50°C (-22°F to 122°F).
- The recommended temperature range for T8E00 and their accessories is -30°C to 45°C (-22°F to 113°F).
- The recommended temperature range for T8N00 and accessories is -10°C to 40°C (14°F to 104°F).
- Unless specifically indicated that it is safe to do so in the user guide or instruction manual, do not use the devices in an environment that exceeds the recommended low or high temperature.
- Unless specifically indicated that it is safe to do so in the user guide or instruction manual, avoid exposing your devices to direct sunshine or excessively wet environments.
- Do not use the product in any way other than described herein in order to avoid personal injury or property damage.
- Users should comply with the laws and regulations of the corresponding countries and regions where the equipment is located (used), abide by professional ethics, pay attention to safety obligations, and strictly prohibit the use of our products or equipment for any illegal purposes. Our company will not be responsible for any violators' legal liability under any circumstances.
- For pluggable equipment, the socket outlet should be easily accessible.
- Use only the adapters provided by the manufacturer. Using unauthorized adapters may cause danger and violate the Terms of Use and warranty article.

Notice

FCC Statement

This device complies with Part 15 of the FCC Rules. Operation is subject to the following two conditions: (1) this device may not cause harmful interference, and (2) this device must accept any interference received, including interference that may cause undesired operation.

Warning: Changes or modifications not expressly approved by the party responsible for compliance could void the user's authority to operate the equipment.

Note: This equipment has been tested and found to comply with the limits for a Class B digital device, pursuant to Part 15 of the FCC Rules. These limits are designed to provide reasonable protection against harmful interference in a residential installation.

This equipment generates uses and can radiate radio frequency energy and, if not installed and used in accordance with the instructions, may cause harmful interference to radio communications. However, there is no guarantee that interference will not occur in a particular installation. If this equipment does cause harmful interference to radio or television reception, which can be determined by turning the equipment off and on, the user is encouraged to try to correct the interference by one or more of the following measures: (1) Reorient or relocate the receiving antenna. (2) Increase the separation between the equipment and receiver. (3) Connect the equipment into an outlet on a circuit different from that to which the receiver is connected. (4) Consult the dealer or an experienced radio/TV technician for help.

The following importer is the responsible party

Company Name: POWER MOBILE LIFE, LLC

Address: 10800 NE 8TH ST #900, BELLEVUE, WA, 98004, UNITED STATES

Telephone: 1-800-988-7973

IC Statement

This device complies with Industry Canada licence-exempt RSS standard(s). Operation is subject to the following two conditions:

(1) this device may not cause interference, and

(2) this device must accept any interference, including interference that may cause undesired operation of the device.

This Class B digital apparatus complies with Canadian ICES-003.

HDMI™

HIGH-DEFINITION MULTIMEDIA INTERFACE

The Adopted Trademarks HDMI, HDMI High-Definition Multimedia Interface, HDMI trade dress and the HDMI Logos are trademarks or registered trademarks of HDMI Licensing Administrator, Inc. in the United States and other countries.

⚠ WARNING

- **INGESTION HAZARD:** This product contains a button cell or coin battery.
- **DEATH** or serious injury can occur if ingested.
- A swallowed button cell or coin battery can cause **Internal Chemical Burns** in as little as **2 hours**.
- **KEEP** new and used batteries **OUT OF REACH of CHILDREN**
- **Seek immediate medical attention** if a battery is suspected to be swallowed or inserted inside any part of the body.



a) Remove and immediately recycle or dispose of used batteries according to local regulations and keep away from children. Do NOT dispose of batteries in household trash or incinerate.

b) Even used batteries may cause severe injury or death.

c) Call a local poison control center for treatment information.

d) The compatible battery type CR2032 3V.

e) Non-rechargeable batteries are not to be recharged.

f) Do not force discharge, recharge, disassemble, heat above 45°C (113°F) or incinerate. Doing so may result in injury due to venting, leakage or explosion resulting in chemical burns.

g) The product contains non-replaceable battery.

Warranty

Type	Warranty Period
Network Video Recorder	36 Months
PoE Camera	36 Months
Hard Disk Drive / Mounting Bracket	24 Months
Power Adapter	18 Months
AC Cable / USB Mouse / Ethernet Cable / HDMI Cable / Waterproof Cover Pack	12 Months
Other Accessories	No Warranty

For more information about the warranty policy, please visit

https://www.eufy.com/policies/refund-policy?ref=navimenu_10_1_2_copy.

Customer Service



(US/Canada) +1 (800) 988 7973



support@eufy.com
support.au.eufy.com (AU)



Australian and New Zealand customers, please scan the QR code for the warranty information.

Anker Innovations Limited
Unit 56, 8th Floor, Tower 2, Admiralty Centre, 18 Harcourt Road, Hong Kong



@EufyOfficial



@EufyOfficial



@EufyOfficial