



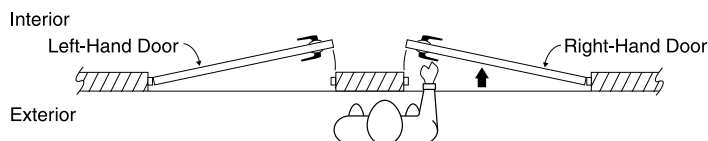

Table of Contents

	<p>Ordering InformationA1</p> <p>General Information.....A3</p>
	<p>■ New Products.....B5</p>
	<p>■ Kwikset Signature SeriesC19</p> <p>HandlesetsC20</p> <p>LeversC21-22</p> <p>KnobsC23-24</p> <p>Combo Packs.....C25</p> <p>DeadboltsC26</p>
	<p>■ KwiksetD27</p> <p>HandlesetsD28</p> <p>LeversD29</p> <p>KnobsD30-31</p> <p>Combo Packs.....D32</p> <p>Project PacksD33</p> <p>DeadboltsD34</p>
	<p>■ Electronic Locks.....E35</p> <p>DeadboltsE35</p> <p>LeversE35</p>
	<p>■ Light Commerical.....F37</p> <p>Key Control DeadboltF37</p>
	<p>■ Parts & Accessories</p> <p>Latches.....G39</p> <p>Rekeying Kit & Parts.....G40</p> <p>138 Installation Kit & Replacement PartsG41</p> <p>Pocket Door Hardware.....G42</p> <p>Trims.....G43</p> <p>■ Functions & Measurements</p> <p>Kwikset Signature Series.....H45</p> <p>KwiksetH46</p> <p>NotesH47</p>

HANDING

To determine the handing of a door, face the **OUTSIDE** of a door. If the hinge is on the left side of the door, the door is left-handed (LH). If the hinge is on the right side of the door, the door is right-handed (RH).



Note: Handing only required for Dummy Kwikset Signature Series levers.

FINISHES

US	Description	BHMA	US	Description	BHMA
L03	Lifetime Polished Brass	605E	26D	Satin Chrome	626
3	Polished Brass	605	502	Rustic Pewter	
5	Antique Brass	609	501	Rustic Bronze	
11P	Venetian Bronze	510	514	Iron Black	
15	Satin Nickel	619			

KEYING

Code	Option
K4, K6	Keyed Alike (4 Locksets, 6 Locksets)

BACKSET

Backset is the length from center edge of door to center of the 2¹/₈" (54mm) diameter hole. 2³/₈" or 2³/₄" in most cases.

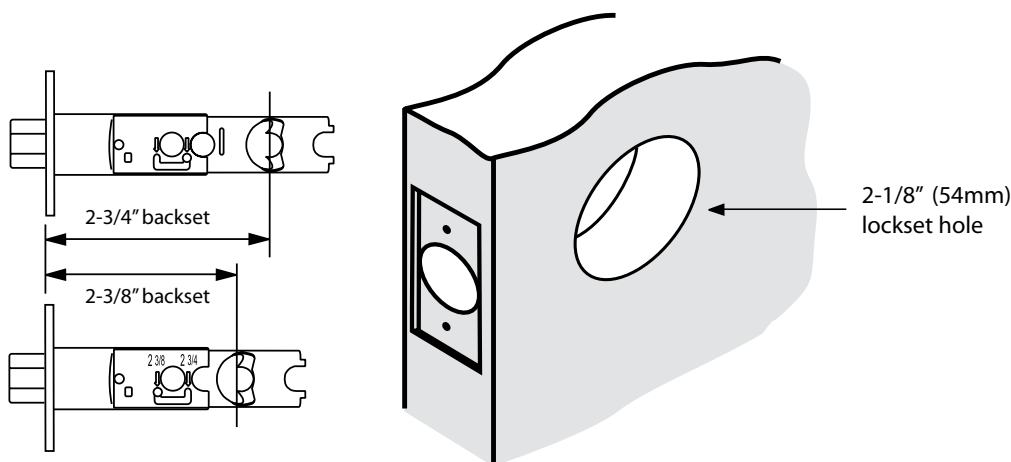

FUNCTIONS

Model	Description	Model	Description
200/720	Passage/Hall & Closet	488/788	Half Dummy Trim, Surface Mounted
300/730	Privacy/Bed & Bath	553/687/800	Single Cylinder Handlesets
400/740	Keyed Entry Knob	660/816/980	Single Cylinder Deadbolts
405/740	Keyed Entry Lever	665/985	Double Cylinder Deadbolts
		907/909	Electronic Deadbolts
		911	Electronic Levers

TERMS AND CONDITIONS OF SALE

Standard terms are 2% prompt payment discount for payment within 25 days from date of invoice; net 30 days from the date of invoice. Kwikset® reserves the right to charge and recover on invoices which are not paid within the above terms, a service charge of 1-1/2% a month for each month or fraction thereof during which the invoice remains unpaid, said service charge, however, not to exceed the highest applicable legal rate of interest. All orders, whether solicited or written by our sales representatives or forwarded by our customers are deemed to be mere offers to purchase in accordance with these Terms and Conditions of Sale until actually accepted by us at our home office in Lake Forest, CA. We reserve the right to refuse any order as well as the right to sell or not sell to any firm at our sole discretion. The acceptance of an order is expressly made conditional upon your assent to these Terms and Conditions of Sale. We object to the inclusion of any different or additional terms or conditions, even if the same are included in your order, a contract of sale will result upon the Terms and Conditions of Sale stated herein only.

All sales are final.

PRICES

Pricing based on full-case quantities only; orders for less than full case will be automatically adjusted up to the next full-case quantity. All prices are subject to change without notice and are not guaranteed. All taxes, duties or other charges are the responsibility of the customer.

CLAIMS

Price claims must be submitted in writing to Kwikset, 19701 DaVinci, Lake Forest, CA 92610 within 30 days from the date of invoice.

CHANGES OR CANCELLATIONS

Beyond 5 working days of our acknowledgment date no changes can be made. Additions to an order will be handled as a separate order and must meet applicable minimum order requirements. Order cancellation on regular stock items only, or any portion thereof is allowed only upon prior written consent from Kwikset, and the payment of cancellation charges deemed appropriate.

MINIMUM CHARGE

No order will be invoiced for less than \$100.00 net plus shipping charges except for lock accessory parts.

MINIMUM ANNUAL SALES VOLUME

The company reserves the right to discontinue direct sales to any customer who does not meet the minimum annual sales volume requirement. The current annual requirement is \$50,000.00. Your annual purchases are determined by accepted, non-cancelled, and shipped orders received during each calendar year. Kwikset reserves the right to change any or all minimum annual sales volume requirements at any time. Any customer who does not meet the annual

sales volume requirements may continue to purchase Kwikset products through a Kwikset distributor.

RETURNS

Defective merchandise returned to our factories requires prior written authorization from a Kwikset Sales Rep or the Sales Office. A factory return authorization must accompany the returned shipment. The return authorization must include an itemized listing of the merchandise and an explanation stating the reason for return.

There will be a 20% product restocking fee on all returned merchandise.

FREIGHT

All goods are invoiced FOB our factory. Upon delivery of shipments to the carrier, title to, and the risk of loss or damage in transit for such shipments, passes to our customer. Kwikset's standard policy is to pay freight charges on all shipments of 300 locks (Accessories: 300 lbs.) to a single destination in the continental U.S., by carrier and route of our choice. Shipments less than these quantities will not be shipped on a prepaid basis.

If higher freight charges are incurred from customers specifying a carrier or route of their choice the additional cost will be added to that customer's invoice.

DELIVERY CONDITIONS

Shipping schedules are our best estimates, and cannot be guaranteed. Kwikset is not responsible for any direct or consequential loss or damage resulting from an inability or delay in meeting shipping schedules.

PRODUCT WARRANTY

Warranties cover the original residential user of Kwikset Products against defects in material and workmanship as long as the original user occupies the residential premises upon which the Product was originally installed. This warranty DOES NOT COVER abused or misused products or non-commercial products used in commercial applications. Upon return of a defective Product to Kwikset Corporation, Kwikset shall either replace the Product or refund the purchase price, at our discretion. If a covered defect occurs, call 1-800-327-LOCK (5625) in the U.S. and Canada or return it to Kwikset Corporation, Consumer Services, 19701 DaVinci, Lake Forest, California 92610. A finish deterioration occurring from the use of paints, solvents, or other chemicals is not a defect in the finish and is not covered by this warranty. Kwikset is not liable for incidental or consequential damages. Some states do not allow the exclusion or limitation of incidental or consequential damages, so the above exclusion may not apply to you. This warranty gives you specific legal rights and you may also have other rights that vary from state to state.

PATENT INDEMNITY

We agree to defend any suit or proceeding brought against our customer so far as based on claim that our products, or any part thereof, made solely to our specifications and furnished to our customer constitute an infringement of any U.S. patent, if notified promptly in writing and given authority, information and assistance at our expense for the defense of same, and we shall pay all damages and costs awarded therein against our customer. In case our products, or any part thereof, is in such suit held to constitute infringement and

their use is enjoined, we will, at our expense and discretion, either procure for our customer the right to continue using the products or replace same with non-infringing products, or modify them so they become non-infringing, or remove such products and refund the purchase price (less depreciation, prorated from the purchase date). The foregoing states our entire liability for patent infringement by our products or any part thereof.

STANDARDS

Kwikset meets or exceeds the testing requirements specified for each product grade or rating.

- American National Standards Institute (ANSI)
- Builders Hardware Manufacturers Association (BHMA)
- Underwriters Laboratories, Inc. (UL)
- ADA (Americans with Disabilities Act)

MISCELLANEOUS

Substitution of non-Kwikset components/parts, and any alteration or modification of factory parts, and other lock manufacturer's parts may result in door hardware which does not function properly or will fail and will void all warranties.

Kwikset reserves the right to revise or modify products, product information, or pricing without notice. Product specifications and pricing reflect available information at the time of printing. Kwikset is not responsible for typographic or printing errors.





INTRODUCING

AUSTIN

Simple yet rugged, Austin's rustic style brings a new level of charm and appeal to any space, whether in the city or country.

The Austin family includes a handleset, deadbolt and lever.

- Decorative Deadbolt Swing Cover on Handleset
- SmartKey® Re-key Technology with BumpGuard™ Protection
- ANSI/BHMA Grade 2 Security



Kwikset

AUSTIN

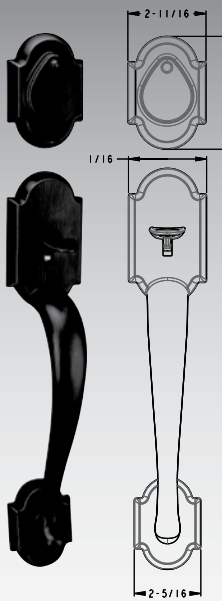

800 Austin
Handleset

Handleset Specifications:

Door Prep	Deadbolt: Cross Bore 2-1/8" or 1-1/2". Edge Bore 1". Latch Face 1" x 2-1/4". Handle: Cross Bore 2-1/8". Edge Bore 1". Latch Face 1" x 2-1/4".
Backset	Deadbolt: Adjustable to 2-3/8" or 2-3/4". Handle: Adjustable to 2-3/8" or 2-3/4".
Door Thickness	1-3/4" doors standard. 2-1/4" doors optional
Cylinder	SmartKey
Faceplates	1" x 2-1/4". Specify round corner, square corner or drive-in
Strikes	Deadbolt: 1-1/4" x 3-5/8". Specify round corner or square corner. Handle: 2-1/4" full lip. Specify round corner or square corner. Other options available.
Bolt	Deadbolt: 1" steel. Handle: 1/2" throw.
UL	Optional 1/3 hour fire rating for all functions except 802



980 Austin
Deadbolt

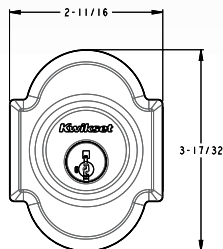

Deadbolt Specifications:

Door Prep	Crossbore 2-1/8". Edge Bore 1". Latch Face 1" x 2-1/4"
Backset	Adjustable to 2-3/8" or 2-3/4"
Door Thickness	1-3/8" - 1-3/4" standard. 1-7/8" - 2-1/4" optional.
Cylinder	SmartKey.
Faceplates	1" x 2-1/4". Specify round corner, square corner, or drive-in.
Strikes	1-1/4" x 3-5/8". Specify round corner or square corner. Other options available.
Bolt	1" throw. Steel.
ADA	Interior turn piece meets 4.13.9 ADA requirements.



720 Austin
Lever

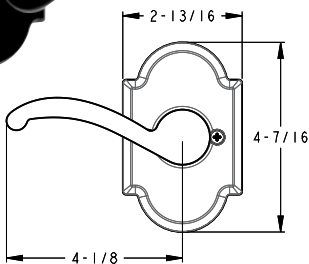

Lever Specifications:

Door Prep	Cross Bore 2-1/8". Edge Bore 1".
Backset	Adjustable 2-3/8" or 2-3/4".
Door Thickness	1-3/8" to 1-3/4" standard.
Cylinder	SmartKey
Faceplates	1" x 2-1/4". Specify round corner or square corner or drive-in latch.
Strikes	2-1/4" full lip. Specify round corner or square corner. Other options available.
Bolt	1/2" throw.
Door Handling	Reversible for right or left hand doors.
ADA	720 function satisfies section 4.13.9 ADA requirements.

Available Finishes:



11P
Venetian
Bronze



15
Satin
Nickel

Kwikset

SMARTKEY
RE-KEY TECHNOLOGY

19701 DaVinci • Lake Forest, CA 92610 • www.kwikset.com • 1-800-327-LOCK
© 2012 Kwikset Corporation, Lake Forest, CA 92610

THE BEST SECURITY IS SMART SECURITY.

7/12 17870C

Introducing MONTARA™

2-Point Locking for Increased Security

Enjoy increased security and easy fit with the Montara handleset. 2 points of locking, on the deadbolt and the handleset, provide double the security. And the Easy Fit Technology allows for convenient installation, adjusting to fit the bottom hole in your door.

- 2-Point Locking for Increased Security
- New Easy Fit Technology for easy installation
- SmartKey® Re-Key Technology with BumpGuard™ Protection
- ANSI/BHMA Grade 2 Certified Security



Kwikset

MONTARA™

Specifications:

Door Prep	Cross Bore 2 1/8". Edge Bore 1".
Backset	Adjustable to 2 3/8" or 2 3/4"
Door Thickness	1 3/4" standard
Cylinder	SmartKey®
Faceplates	1" x 2 1/4". Specify round corner, square corner or drive-in.
Strikes	2 1/4" full lip standard. Specify round corner, square corner. Other options available.
Bolt	1/2" throw.
Door Handing	Reversible for right or left-handed doors. Specify handing only on dummy and handleset interiors only.
ANSI/BHMA	Grade 2 Certified.

Dimensions:

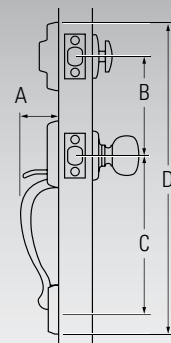

Design	A	B	C	D
Montara	2-19/32"	5-1/2"	9-1/8"	17-13/16"

Finishes:



11P
Venetian
Bronze

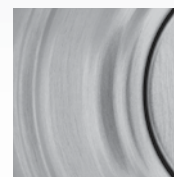

15
Satin
Nickel



3
Polished
Brass



featuring BumpGuard™

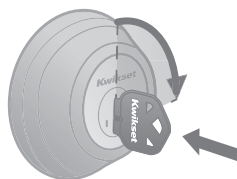

1 Insert functioning key & turn 1/4 turn clockwise.

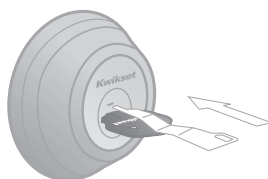

2 Insert & remove the SmartKey learn tool. Remove functioning key.



3 Insert new key & turn 1/2 turn counter-clockwise. Done. Your lock is now re-keyed!



! You must have your functioning key & the learn tool for the system to work.



SMART. SIMPLE. SECURE.

SMARTKEY® RE-KEY TECHNOLOGY

The Lock You Can Re-key in Seconds

Re-key your locks, quickly & securely, without the extra hassle & cost of removing the lock from the door. SmartKey locks are incredibly secure & have passed the most stringent lock picking standards. Our patented BumpGuard™ technology provides superior lock bumping protection, while our high-security Grade 1 deadbolt is able to withstand the power typically associated with forced entries.

- Re-key in seconds—save time & money
- Available in all Kwikset keyed-entry products
- Pick Resistant—passes the most stringent lock picking standard, UL437, par 11.6
- 980 Series Deadbolt Certified ANSI/BHMA Grade 1 Security—the highest level of residential security available in the industry
- BumpGuard™ for protection against lock bumping



SmartKey® Signature Series™ deadbolts have earned the prestigious Best Buy rating from *Consumers Digest*.

kwikset.com/smartkey

KEY CONTROL™ DEADBOLT

The Smart Alternative to Master Keying

Re-keying & managing a traditional master key system is labor intensive, time consuming & costly. With the first & only two cylinder Key Control Deadbolt, either cylinder can be re-keyed in seconds, without removing the lock from the door.

FEATURING 



kwikset.com/keycontrol

THE BEST SECURITY IS SMART SECURITY.



BUMPGUARD™

SmartKey's patented side locking bar technology replaces the traditional pin-and-tumbler design and provides improved security against lock bumping.

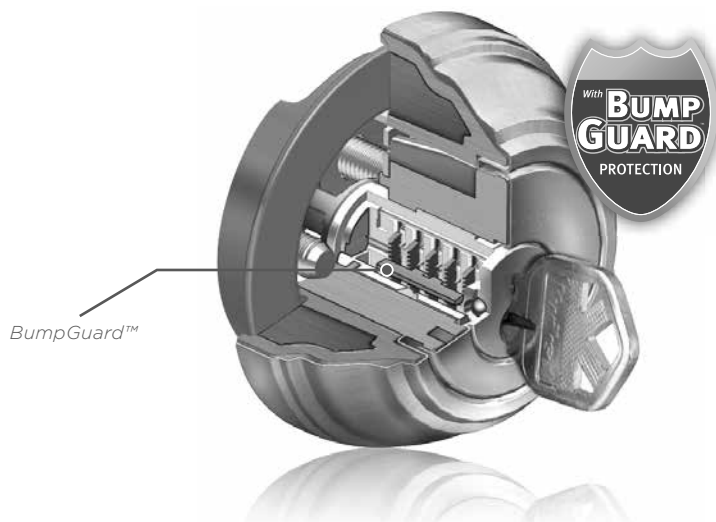

RE-KEY IN 3 SIMPLE STEPS

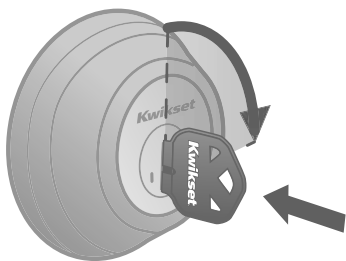

1 Insert functioning key & turn 1/4 turn clockwise.

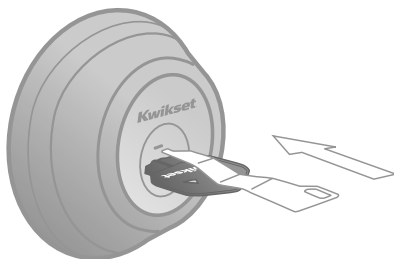

2 Insert & remove the SmartKey learn tool. Remove functioning key.

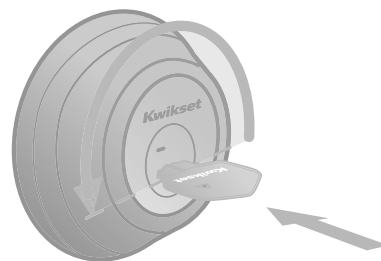

3 Insert new key & turn 1/2 turn counter-clockwise. Done. *Your lock is now re-keyed!*



Functioning Key



SmartKey Learn Tool



New Key



You must have your functioning key & the learn tool for the system to work.

Reset Cradle

A tool used to reset the cylinder if the original key has been lost or to repair a SmartKey® cylinder that has been programmed incorrectly.



Kwikset

kwikset.com
1-800-327-LOCK (5625)

Kwikset

KEY CONTROL™ DEADBOLT

FEATURING  **SMARTKEY**
RE-KEY TECHNOLOGY

PROVIDING ONE-KEY CONTROL FOR MULTI-FAMILY APPLICATIONS

Key Control

- Top concealed cylinder provides one-key control for the property manager
- Lower exposed cylinder allows unique user keys for the tenant
- Re-key your user or control cylinder at any time in seconds
- Maintain key control throughout tenant and employee turnover

Increased Efficiency

- Re-key the lock without removing from the door
- Save time & money by re-keying yourself



Perfect for multi-family dwellings, student housing, assisted living & rental properties.

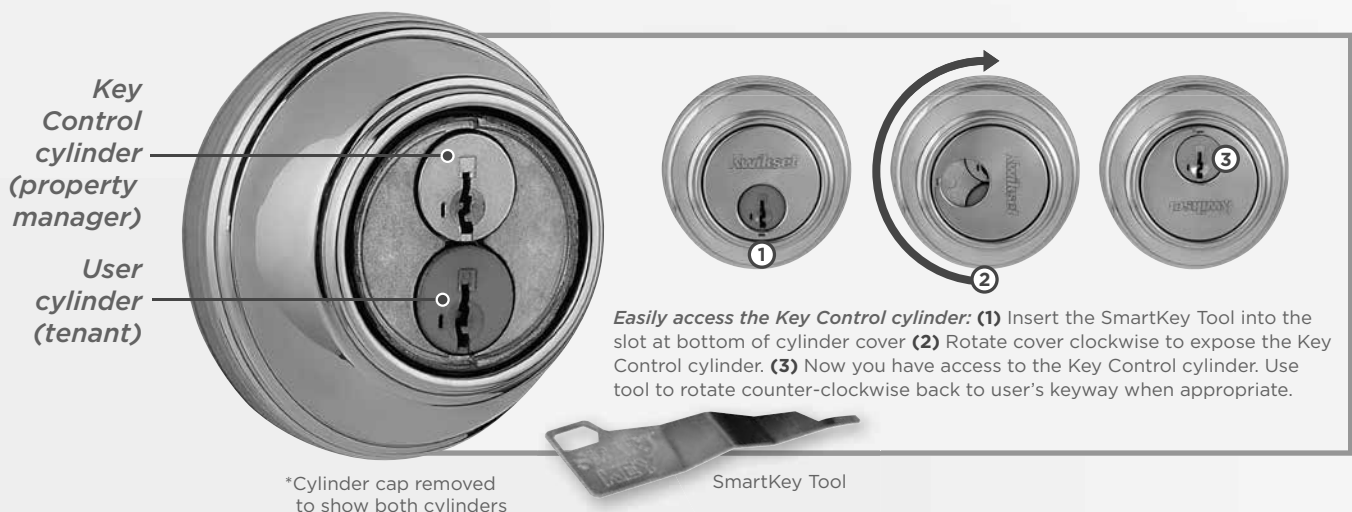

Signature Series

THE SMART ALTERNATIVE TO MASTER KEYING

BOTH CYLINDERS FEATURE SMARTKEY® RE-KEY TECHNOLOGY

- ①a Concealed Key Control cylinder has a unique patented keyway to provide increased security. Simply rotate the cylinder cap to expose the cylinder for use.
- ①b User cylinder utilizes the traditional Kwikset keyway and keys.
- ①c Gear assembly enables both cylinders to lock or retract the deadbolt latch.

CERTIFIED GRADE 2 ANSI/BHMA SECURITY

BUMPGUARD™

- ②a Patented side locking bar technology offers improved security by protecting against lock bumping, an attack on conventional pin & tumbler locks.

DRILL RESISTANCE-

- ②b Cylinder uses two steel balls inserted into the front of the key face to resist attacks from drilling.

PICK RESISTANCE-

- ②c Superior SmartKey withstands the highest level of UL pick testing, the UL 437, Par. 11.6.

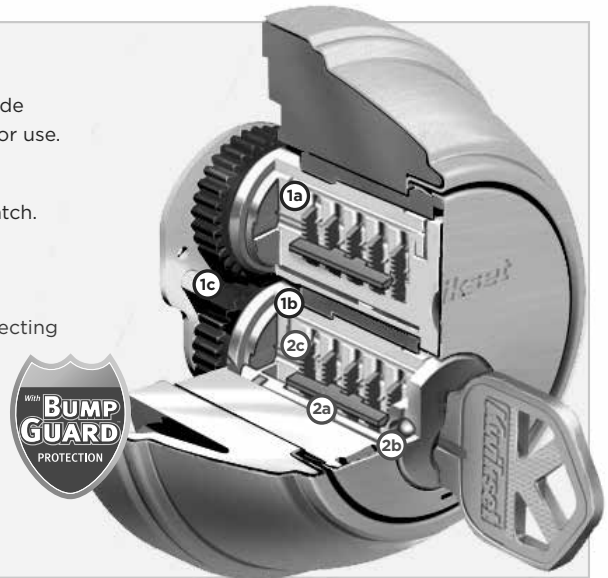

SPECIFICATIONS:

Standard Door Prep	Cross Bore 2-1/8". Edge Bore 1" Latch Face 1" x 2-1/4"
Door Thickness	1-3/4"
Cylinder	2 SmartKey® cylinders: 1 standard Kwikset for users, 1 unique patented keyway for 1-Key Control
Faceplate	1" x 2-1/4"
Strike	1-1/4" x 3-5/8"
Bolt	1" throw
ANSI/BHMA	Grade 2 Certified
ADA	Interior turn piece meets 4.13.9 ADA
UL	Meets UL 3 hour fire rating for 817 UL Optional 1/3 hour UL fire rating for all functions

FINISHES:



3
Polished
Brass

5
Antique
Brass

11P
Venetian
Bronze

15
Satin
Nickel

26D
Brushed
Chrome

FUNCTIONS:

	816 Key Control Deadbolt 817 UL Key Control Deadbolt Deadbolt operated by key outside and thumb turn inside.
--	--

DIMENSIONS:

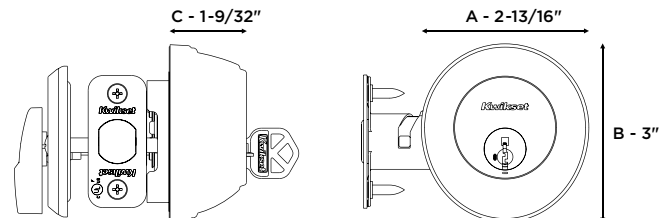

EASILY RE-KEY IN 3 SIMPLE STEPS:



- 1 Insert functioning key & turn 1/4 turn clockwise.



- 2 Insert & remove the SmartKey learn tool. Remove functioning key.



- 3 Insert new key and turn 1/2 turn counter-clockwise. Your lock is now re-keyed!

You must have your functioning key & your SmartKey tool for the system to work.



SmartKey Tool

Functioning Key

Kwikset SMARTCODE[®]

TOUCHPAD ELECTRONIC DEADBOLT

New Style
SMARTCODE[™]



Includes
Back-Lit Keypad
Increase Visibility



Signature Series

NO MORE WORRYING ABOUT KEYS!

- **Keyless entry deadbolt** - the ultimate in convenience & security.
- **One touch locking** with a motorized deadbolt.
- **Two customizable access codes** - one code for the family, one code for temporary access.
- **Includes SmartKey[®]** re-key technology for increased peace of mind.

EASY TO INSTALL, PROGRAM AND USE.

- **Installs in a minute** with just a screwdriver - no hard wiring required.
 - 4 AA batteries (not included)
- **Fits standard doors** (1 3/8" - 2") - no new screw holes required.
- **Quick Reference Guide** located under the interior cover.

FEATURING

 **SMARTKEY[™]**
RE-KEY TECHNOLOGY

SMARTCODE™ TOUCHPAD ELECTRONIC DEADBOLT

Specifications:

Function	Single Cylinder Deadbolt
Door Prep	2-1/8" diameter face hole & 1" diameter
Backset	Adjustable 2-3/8" or 2-3/4"
Door Thickness	1 3/8" - 2" automatic adjustment
Cylinder	SmartKey® Re-key Technology
Faceplates	1" x 2-1/4" round corner standard
Strikes	Round corner strike 2-3/4" x 2-1/8"
Latch	Round corner adjustable 2-3/8" x 2-3/4"
Bolt	1" throw, steel deadbolt
Door Handing	Reversible
Batteries	4AA Required

Dimensions:

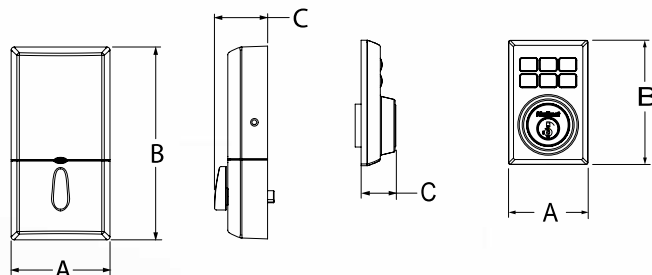

Design	A	B	C
SmartCode™ Outer Trim	2-23/32"	4-1/4"	1-3/16"
SmartCode™ Inner Trim	3-9/32"	6-13/32"	1-3/4"

FEATURING



Finishes:



26
Polished
Chrome



26D
Satin
Chrome

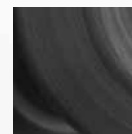

11P
Venetian
Bronze



15
Satin
Nickel



Kwikset®

19701 DaVinci • Lake Forest, CA 92610
www.kwikset.com • 1-800-327-LOCK

Kwikset®



Signature Series

New Contemporary Designs

We are proud to announce the launch of the new contemporary style as part of our Kwikset Signature Series line. With five additional products, the contemporary family provides a modern approach to security door hardware.

Features & Benefits

- Features SmartKey® Re-key Technology with BumpGuard™ protection
- Available in a variety of finishes - Satin Nickel & Polished Chrome
- Lifetime Finish & Mechanical Warranty



THE BEST SECURITY IS SMART SECURITY.

Kwikset

Signature Series



Tavaris™
Handleset

Handleset Specifications:

Door Prep	Deadbolt: Cross Bore 2-1/8" or 1-1/2". Edge Bore 1". Latch Face 1" x 2-1/4". Handle: Cross Bore 2-1/8". Edge Bore 1". Latch Face 1" x 2-1/4".
Backset	Deadbolt: Adjustable to 2-3/8" or 2-3/4". Handle: Adjustable to 2-3/8" or 2-3/4".
Door Thickness	1-3/4" doors standard. 2-1/4" doors optional
Cylinder	SmartKey
Faceplates	1" x 2-1/4". Specify round corner, square corner or drive-in
Strikes	Deadbolt: 1-1/4" x 3-5/8". Specify round corner or square corner. Handle: 2-1/4" full lip. Specify round corner or square corner. Other options available.
Bolt	Deadbolt: 1" steel. Handle: 1/2" throw.
UL	Optional 1/3 hour fire rating for all functions except 802



993 RDT
Round
Deadbolt

Deadbolt Specifications:

Door Prep	Crossbore 2-1/8". Edge Bore 1". Latch Face 1" x 2-1/4"
Backset	Adjustable to 2-3/8" or 2-3/4"
Door Thickness	1-3/8" - 1-3/4" standard. 1-7/8" - 2-1/4" optional.
Cylinder	SmartKey.
Faceplates	1" x 2-1/4". Specify round corner, square corner, or drive-in.
Strikes	1-1/4" x 3-5/8". Specify round corner or square corner. Other options available.
Bolt	1" throw. Steel.
ANSI/BHMA	Grade 2 Certified
ADA	Interior turn piece meets 4.13.9 ADA requirements.
UL	1/3 hour fire rating for 996 and 997



Katara™
with Round Rose Lever

Lever Specifications:

Door Prep	Cross Bore 2-1/8". Edge Bore 1".
Backset	Adjustable 2-3/8" or 2-3/4".
Door Thickness	1-3/8" to 1-3/4" standard.
Cylinder	SmartKey
Faceplates	1" x 2-1/4". Specify round corner or square corner or drive-in latch.
Strikes	2-1/4" full lip. Specify round corner or square corner. Other options available.
Bolt	1/2" throw.
Door Handling	Reversible for right or left hand doors.
ANSI/BHMA	Grade 2 Certified
ADA	720 function satisfies section 4.13.9 ADA requirements.
UL	3 hour fire rating for 725, 735, 745 Optional 1/3 hour fire rating for all functions

Available Finishes:



15
Satin
Nickel



26
Polished
Chrome



INTRODUCING THE SMART SECURITY APP

The Kwikset Smart Security App was designed to educate users on Kwikset's broad array of products while facilitating the decision making process when purchasing door hardware.



Now available for iPhone, iPad and Android.



Visit Kwikset.com/SmartSecurityTool for more info.

Kwikset

THE BEST SECURITY IS SMART SECURITY.

INTRODUCING THE SMART SECURITY APP

House Pack Project Selector

Determine the different types of door hardware needed for a particular project and select quantities of each type.

Product Demonstrations

Interact with Kwikset's innovative products. This tool includes product demonstrations of the Kwikset SmartKey® Re-key Technology, Key Control™ Deadbolt, SmartCode™ Keyless Entry and the SmartKey Reset Cradle, along with a video overview of our Home Connect technology.

Image Gallery

View Kwikset's core product portfolio. With this tool, users can view each product in every available finish.

Re-key Savings Calculator

Quickly and accurately assess the time and cost savings achieved in the re-keying process when using Kwikset SmartKey or Key Control Deadbolt instead of a traditional pin and tumbler lock.



Kwikset



SUPERIOR SECURITY FEATURES

- ANSI/BHMA Grade 1 Certified 980/985 Deadbolt
- SmartKey® Re-Key Technology with BumpGuard™ Technology to Protect Against Lock Bumping*

ELEGANT STYLES AND FINISHES

- Unique Rustic Finishes

WARRANTY

- Lifetime Mechanical
- Lifetime Finish

*Lock Bumping - an attack technique using specially cut keys that can defeat conventional pin & tumbler locks.

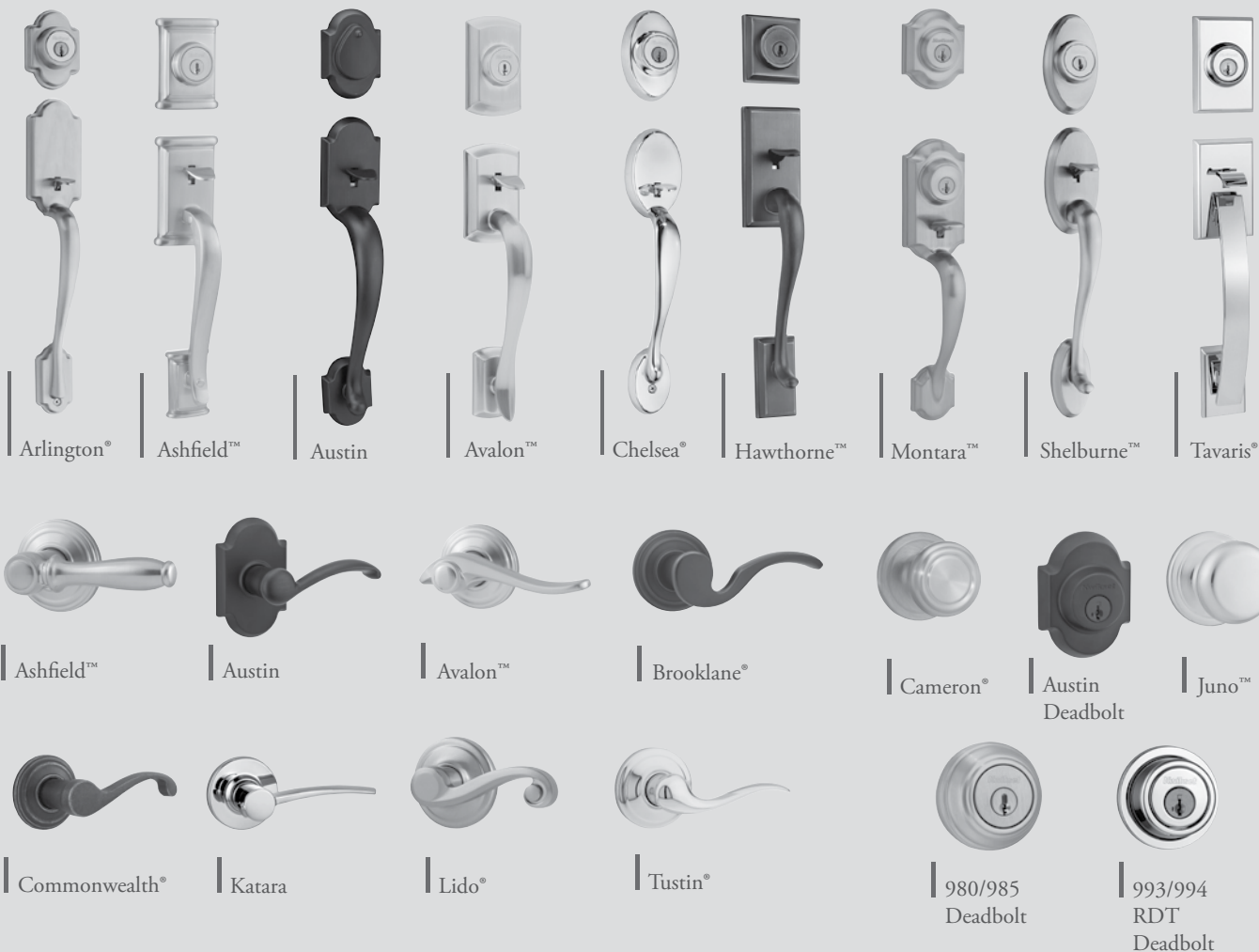

HANDLESETS - All Keyed products below have SmartKey only

MFG Pro#	Function	Finish							Case Qty.	Price
Arlington® Handleset		3	L03	5	11P	15	501	502		
98001-096	800ANXLL - Arlington X Lido		•						2	\$212.00
98001-122	800ANXC - Arlington X Copa			•					2	\$176.50
98001-095	800ANXLL - Arlington X Lido			•					2	\$201.50
98001-123	800ANXLL - Arlington X Lido				•				2	\$241.50
98001-094	800ANXLL - Arlington X Lido					•			2	\$232.00
98001-138	800ANXTNL - Arlington X Tustin					•			2	\$232.50
Ashfield™ Handleset		3	L03	5	11P	15	501	502	Case Qty.	Price
98001-098	800ADHXADL - Ashfield X Ashfield				•				2	\$291.00
98001-099	800ADHXADL - Ashfield X Ashfield						•		2	\$291.00
98001-119	800ADHXCHL - Ashfield X Commonwealth						•		2	\$291.00
98001-100	800ADHXADL - Ashfield X Ashfield							•	2	\$291.00
98001-136	800ADHXJ - Ashfield X Juno							•	2	\$266.50
Austin Handleset - NEW		3	L03	5	11P	15	501	502	Case Qty.	
98001-378	800AUHXAUL 15 SMT CP					•			2	\$298.00
98001-379	800AUHXAUL 11P SMT CP				•				2	\$298.00
Avalon™ Handleset		3	L03	5	11P	15	501	502	Case Qty.	
98001-101	800AVHXAVL - Avalon X Avalon					•			2	\$278.50
98001-141	800AVHXAVL Avalon x Avalon							•	2	\$291.00
Chelsea® Handleset		3	L03	5	11P	15	501	502	Case Qty.	Price
98001-125	800CEXCN - Chelsea X Cameron		•						2	\$185.50
98001-196	800CEXJ - Chelsea X Juno		•						2	\$168.50
98001-142	800CEXC - Chelsea X Copa		•						2	\$186.00
98001-126	800CEXLL - Chelsea X Lido		•						2	\$212.00
98001-143	800CEXTNL - Chelsea X Tustin				•				2	\$241.50
98001-124	800CEXCN - Chelsea X Cameron					•			2	\$203.00
98001-144	800CEXTNL - Chelsea X Tustin					•			2	\$232.50
Hawthorne™ Handleset		3	L03	5	11P	15	501	502	Case Qty.	Price
98001-104	800HEXJ - Hawthorne X Juno				•				2	\$266.50
98001-145	800HEXL - Hawthorne X Laurel				•				2	\$273.00
98001-128	800HEXCN - Hawthorne X Cameron					•			2	\$266.50
98001-137	800HEXJ - Hawthorne X Juno							•	2	\$266.50
Montara™ Handleset - NEW		3	L03	5	11P	15	501	502	Case Qty.	Price
95530-017	553MNXJ - Montara X Juno	•							2	\$295.00
95530-018	553MNXJ - Montara X Juno					•			2	\$316.00
95530-019	553MNXJ - Montara X Juno				•				2	\$316.00
Shelburne™ Handleset		3	L03	5	11P	15	501	502	Case Qty.	Price
98001-106	800SEXTNL - Shelburne X Tustin		•						2	\$273.00
98001-102	800SEXJ - Shelburne X Juno			•					2	\$254.50
98001-134	800SEXLL - Shelburne X Lido			•					2	\$259.00
98001-133	800SEXLL - Shelburne X Lido				•				2	\$273.00
98001-105	800SEXJ - Shelburne X Juno					•			2	\$254.50
98001-146	800SEXBRL - Shelburne X Brooklane					•			2	\$273.00
9800 -107	800SEXTNL - Shelburne X Tustin					•			2	\$273.00
98001-131	800SEXAVL - Shelburne X Avalon					•			2	\$273.00
98001-132	800SEXCHL - Shelburne X Commonwealth							•	2	\$273.00
Tavaris® Handleset		3	L03	5	11P	15	501	502	Case Qty.	Price
98001-376	800TVHXKTL Tavaris X Katara					•			2	\$241.50
98001-377	800TVHXKTL Tavaris X Katara						•		2	\$241.50



ASHFIELD™



AUSTIN



AVALON™



BROOKLANE®

LEVERS - All Keyed levers below have SmartKey only

MFG Pro#	Function	Finish							Case Qty.	Keying	Price
Ashfield™ Lever		3	L03	5	11P	15	501	502			
97200-671	720ADL - Hall/Closet				•				4		\$57.00
97300-696	730ADL - Bed/Bath				•				4		\$60.50
97402-533	740ADL - Entry				•				4	K4	\$99.00
97880-698	788ADL - Inactive				•				4		\$27.00
97200-670	720ADL - Hall/Closet						•		4		\$57.00
97300-695	730ADL - Bed/Bath						•		4		\$60.50
97402-532	740ADL - Entry						•		4	K4	\$99.00
97880-713	788ADL - Inactive						•		4		\$27.00
97200-669	720ADL - Hall/Closet							•	4		\$57.00
97300-694	730ADL - Bed/Bath							•	4		\$60.50
97402-531	740ADL - Entry							•	4	K4	\$99.00
97880-694	788ADL - Inactive							•	4		\$27.00
Austin Lever - NEW		3	L03	5	11P	15	501	502	Case Qty.	Keying	Price
97200-771	720AUL - Passage					•			4		\$58.00
97300-807	730AUL - Privacy					•			4		\$62.00
97402-711	740AUL SMT - Entry					•			4		\$106.00
97200-772	720AUL - Passage				•				4		\$58.00
97300-808	730AUL - Privacy				•				4		\$62.00
97402-712	740AUL SMT - Entry				•				4		\$106.00
Avalon™ Lever		3	L03	5	11P	15	501	502	Case Qty.	Keying	Price
97200-668	720AVL - Hall/Closet					•			4		\$54.00
97300-693	730AVL - Bed/Bath					•			4		\$56.50
97402-535	740AVL - Entry					•			4	K4	\$92.50
97880-692	788AVL - LH Inactive					•			4		\$25.50
97880-693	788AVL - RH Inactive					•			4		\$25.50
Brooklane® Lever		3	L03	5	11P	15	501	502	Case Qty.	Keying	Price
97200-691	720BRL - Hall/Closet				•				4		\$57.00
97300-716	730BRL - Bed/Bath				•				4		\$60.50
97402-561	740BRL - Entry				•				4	K4	\$99.00
97880-706	788BRL - LH Inactive				•				4		\$27.00
97880-707	788BRL - RH Inactive				•				4		\$27.00
97200-692	720BRL - Hall/Closet					•			4		\$54.00
97300-717	730BRL - Bed/Bath					•			4		\$56.50
97402-562	740BRL - Entry					•			4	K4	\$92.50
97880-702	788BRL - LH Inactive					•			4		\$25.50
97880-703	788BRL - RH Inactive					•			4		\$25.50



COMMONWEALTH*



LIDO*



KATARA



TUSTIN*

LEVERS - All Keyed levers below have SmartKey only

MFG Pro#	Function	Finish							Case Qty.	Keying	Price
Commonwealth® Lever		3	L03	5	11P	15	501	502			
97200-681	720CHL - Hall/Closet						•		4		\$57.00
97300-706	730CHL - Bed/Bath						•		4		\$60.50
97402-551	740CHL - Entry						•		4	K4	\$99.00
97880-734	788CHL - LH Inactive						•		4		\$27.00
97880-735	788CHL - RH Inactive						•		4		\$27.00
Katara Lever		3	L03	5	11P	15	501	502	Case Qty.	Keying	Price
97200-769	720KTL - Hall/Closet					•			4		\$54.00
97300-805	730KTL - Bed/Bath					•			4		\$57.00
97402-709	740KTL - Keyed Entry					•			4	K4	\$100.00
97880-853	788KTL LH - Inactive					•			4		\$24.50
97880-855	788KTL RH - Inactive					•			4		\$24.50
97200-770	720KTL - Hall/Closet						•		4		\$54.00
97300-806	730KTL - Bed/Bath						•		4		\$57.00
97402-710	740KTL - Keyed Entry						•		4	K4	\$100.00
97880-854	788KTL LH - Inactive						•		4		\$24.50
97880-856	788KTL RH - Inactive						•		4		\$24.50
Lido® Lever		3	L03	5	11P	15	501	502	Case Qty.	Keying	Price
97200-664	720LL - Hall/Closet	•							4		\$37.00
97300-689	730LL - Bed/Bath	•							4		\$39.00
97402-536	740LL - Keyed Entry	•							4	K4	\$69.50
97880-682	788LL LH - Inactive	•							4		\$16.50
97880-683	788LL RH - Inactive	•							4		\$16.50
97200-666	720LL - Hall/Closet			•					4		\$38.00
97300-691	730LL - Bed/Bath			•					4		\$40.50
97402-537	740LL - Keyed Entry			•					4	K4	\$70.50
97880-686	788LL LH - Inactive			•					4		\$17.50
97880-687	788LL RH - Inactive			•					4		\$17.50
97200-683	720LL - Hall/Closet				•				4		\$50.50
97300-708	730LL - Bed/Bath				•				4		\$54.50
97402-553	740LL - Keyed Entry				•				4	K4	\$85.00
97880-688	788LL LH - Inactive				•				4		\$21.50
97880-689	788LL RH - Inactive				•				4		\$21.50
97200-665	720LL - Hall/Closet					•			4		\$42.50
97300-690	730LL - Bed/Bath					•			4		\$45.00
97402-538	740LL - Keyed Entry					•			4	K4	\$79.00
97880-680	788LL LH - Inactive					•			4		\$19.00
97880-681	788LL RH - Inactive					•			4		\$19.00
Tustin® Lever		3	L03	5	11P	15	501	502	Case Qty.	Keying	Price
97200-663	720TNL - Hall/Closet	•							4		\$37.00
97300-688	730TNL - Bed/Bath	•							4		\$39.00
97402-539	740TNL - Keyed Entry	•							4	K4	\$69.50
97880-672	788TNL LH - Inactive	•							4		\$16.50
97880-675	788TNL RH - Inactive	•							4		\$16.50
97200-662	720TNL - Hall/Closet				•				4		\$50.50
97300-687	730TNL - Bed/Bath				•				4		\$54.50
97402-541	740TNL - Keyed Entry				•				4	K4	\$85.00
97880-678	788TNL LH - Inactive				•				4		\$21.50
97880-679	788TNL RH - Inactive				•				4		\$21.50
97200-661	720TNL - Hall/Closet					•			4		\$42.50
97300-686	730TNL - Bed/Bath					•			4		\$45.00
97402-540	740TNL - Keyed Entry					•			4	K4	\$79.00
97880-673	788TNL LH - Inactive					•			4		\$19.00
97880-676	788TNL RH - Inactive					•			4		\$19.00



CAMERON®

KNOBS - All Keyed products below have SmartKey only

MFG Pro#	Function	Finish							Case Qty.	Keying	Price
Cameron® Knob		3	L03	5	11P	15	501	502			
97200-685	720CN - Hall/Closet	•							4		\$23.00
97300-710	730CN - Bed/Bath	•							4		\$25.00
97402-555	740CN - Entry	•							4	K4	\$44.00
97880-714	788CN - Inactive	•							4		\$12.00
97200-695	720CN - Hall/Closet				•				4		\$34.00
97300-720	730CN - Bed/Bath				•				4		\$35.50
97402-566	740CN - Entry				•				4	K4	\$51.50
97880-745	788CN - Inactive				•				4		\$15.00
97200-684	720CN - Hall/Closet					•			4		\$26.50
97300-709	730CN - Bed/Bath					•			4		\$29.00
97402-554	740CN - Entry					•			4	K4	\$50.00
97880-715	788CN - Inactive					•			4		\$13.00



JUNO™

KNOBS - All Keyed products below have SmartKey only

MFG Pro#	Function	Finish							Case Qty.	Keying	Price
Juno™ Knob		3	L03	5	11P	15	501	502			
97200-672	720J - Hall/Closet	•							4		\$24.00
97300-697	730J - Bed/Bath	•							4		\$26.50
97402-542	740J - Entry	•							4	K4	\$43.50
97880-666	788J - Inactive	•							4		\$12.50
97200-673	720J - Hall/Closet			•					4		\$25.50
97300-698	730J - Bed/Bath			•					4		\$29.00
97402-543	740J - Entry			•					4	K4	\$46.00
97880-667	788J - Inactive			•					4		\$13.00
97200-675	720J - Hall/Closet				•				4		\$36.00
97300-700	730J - Bed/Bath				•				4		\$37.00
97402-545	740J - Entry				•				4	K4	\$50.50
97880-669	788J - Inactive				•				4		\$15.50
97200-674	720J - Hall/Closet					•			4		\$27.50
97300-699	730J - Bed/Bath					•			4		\$30.50
97402-544	740J - Entry					•			4	K4	\$49.00
97880-668	788J - Inactive					•			4		\$14.00
97200-676	720J - Hall/Closet						•		4		\$41.50
97300-701	730J - Bed/Bath						•		4		\$42.50
97402-546	740J - Entry						•		4	K4	\$55.50
97880-670	788J - Inactive						•		4		\$18.00



JUNO™
COMBO PACK



LIDO®
COMBO PACK



CAMERON®
COMBO PACK



TUSTIN®
COMBO PACK

COMBO PACKS - All combo packs include 980 deadbolt & keyed entry

MFG Pro#	Function	Finish						Case Qty.	Keying	Price
991 Combo Pack - Cameron Knob with Single Cylinder Deadbolt		3	L03	5	11P	15	502			
99910-045	991CN - Single Cylinder	•						4	K4	\$84.50
99910-044	991CN - Single Cylinder					•		4	K4	\$95.50
991 Combo Pack - Lido Lever with Single Cylinder Deadbolt		3	L03	5	11P	15	502			
99910-039	991LL - Single Cylinder	•						4	K4	\$110.50
99910-047	991LL - Single Cylinder				•			4	K4	\$131.50
99910-038	991LL - Single Cylinder					•		4	K4	\$124.50
991 Combo Pack - Tustin Lever with Single Cylinder Deadbolt		3	L03	5	11P	15	502			
99910-048	991TNL - Single Cylinder	•						4	K4	\$110.50
99910-041	991TNL - Single Cylinder				•			4	K4	\$131.50
99910-040	991TNL - Single Cylinder					•		4	K4	\$124.50
991 Combo Pack - Juno Knob with Single Cylinder Deadbolt		3	L03	5	11P	15	502			
99910-032	991J - Single Cylinder	•						4	K4	\$89.50
99910-033	991J - Single Cylinder			•				4	K4	\$72.00
99910-035	991J - Single Cylinder				•			4	K4	\$113.00
99910-034	991J - Single Cylinder					•		4	K4	\$108.50
992 Combo Pack - Juno Knob with Double Cylinder Deadbolt		3	L03	5	11P	15	502			
99920-005	992J - Double Cylinder	•						4	K4	\$99.50
99920-006	992J - Double Cylinder					•		4	K4	\$118.50



980 DEADBOLT



985 DEADBOLT



AUSTIN DEADBOLT

NEW!



993/994 RDT DEADBOLT

DEADBOLTS - All deadbolts have SmartKey

MFG Pro#	Function	Finish							Case Qty.	Keying	Price
Single Cylinder Deadbolt		3	L03	5	11P	15	501	502			
99800-087	980 - Single Cylinder	•							4	K4	\$54.00
99800-088	980 - Single Cylinder			•					4	K4	\$59.00
99800-089	980 - Single Cylinder				•				4	K4	\$62.50
99800-090	980 - Single Cylinder					•			4	K4	\$59.50
99800-092	980 - Single Cylinder						•		4	K4	\$62.50
99800-093	980 - Single Cylinder							•	4	K4	\$62.50
Double Cylinder Deadbolt		3	L03	5	11P	15	501	502			
99850-055	985 - Double Cylinder	•							4	K4	\$72.50
99850-057	985 - Double Cylinder				•				4	K4	\$87.00
99850-058	985 - Double Cylinder					•			4	K4	\$83.00
Austin Deadbolt		3	L03	5	11P	15	501	502			
99800-110	980AUD SMT - Single Cylinder					•			4		\$65.00
99800-111	980AUD SMT - Single Cylinder				•				4		\$65.00
99850-066	985AUD SMT - Double Cylinder					•			4		\$92.50
99850-067	985AUD SMT - Double Cylinder				•				4		\$92.50
Contemporary Single Cylinder Deadbolt		3	L03	5	11P	15	501	502			
99930-016	993 RDT - Single Cylinder					•			4	K4	\$62.50
99930-017	993 RDT - Single Cylinder						•		4	K4	\$62.50
Contemporary Double Cylinder Deadbolt		3	L03	5	11P	15	501	502			
99940-013	994 RDT - Double Cylinder					•			4	K4	\$89.00
99940-014	994 RDT - Double Cylinder						•		4	K4	\$89.00



TRUSTED SECURITY

- ANSI/BHMA Grade 3
- Easy Installation
- Handlesets Now Feature SmartKey® Re-key Technology with Bumpguard™ Protection*
- Most Recognized Style

WARRANTY

- Lifetime Mechanical
- Lifetime Finish

*Lock Bumping - an attack technique using specially cut keys that can defeat conventional pin & tumbler locks.



Balboa



Delta®



Dorian®

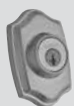

Belleview™



Dakota™



660/665 Deadbolt



Cove™



Polo®



Tylo®





BELLEVUE™



DAKOTA

HANDLESETS - All handlesets below have SmartKey only

MFG Pro#	Function	Finish					Case Qty.	Price
Bellevue™ Handleset		3	5	11P	15	26D		
96870-098	687BWXT - Bellevue X Tylo X SMT		•				2	\$125.50
96870-100	687BWXC - Bellevue X Cove SMT			•			2	\$129.50
96870-099	687BWXP - Bellevue X Polo SMT				•		2	\$129.50
Dakota™ Handleset		3	5	11P	15	26D		
96870-088	687DAXP - Dakota X Polo SMT	•					2	\$119.50
96870-091	687DAXT - Dakota X Tylo SMT	•					2	\$119.50
96870-087	687DAXT - Dakota X Tylo SMT		•				2	\$125.50
96870-090	687DAXP - Dakota X Polo SMT				•		2	\$129.50
96870-089	687DAXT - Dakota X Tylo SMT					•	2	\$125.50

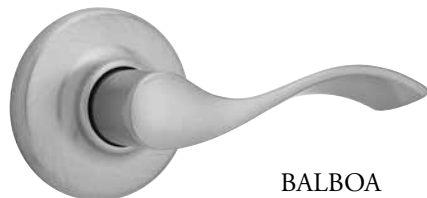

BALBOA

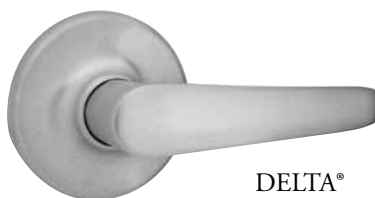

DELTA®



DORIAN®

LEVERS

MFG Pro#	Function	Finish					Case Qty.	Keying	Price
Balboa Lever		3	5	11P	15	26D			
92001-405	200BL - Hall/Closet				•		6		\$34.00
93001-638	300BL - Bed/Bath				•		6		\$36.00
94050-428	405BL - Entry				•		6	K6	\$58.00
94880-495	488BL LH - Inactive				•		4		\$15.00
94880-496	488BL RH - Inactive				•		4		\$15.00
Delta® Lever		3	5	11P	15	26D			
92001-287	200DL - Hall/Closet	•					6		\$29.80
93001-512	300DL - Bed/Bath	•					6		\$31.60
94050-351	405DL - Entry	•					6	K6	\$49.30
94880-432	488DL - Inactive	•					4		\$12.10
92001-290	200DL - Hall/Closet					•	6		\$31.70
93001-515	300DL - Bed/Bath					•	6		\$33.60
94050-354	405DL - Entry					•	6	K6	\$51.50
94880-435	488DL - Inactive					•	4		\$13.80
Dorian® Lever		3	5	11P	15	26D			
92001-291	200DNL - Hall/Closet	•					6		\$29.80
93001-516	300DNL - Bed/Bath	•					6		\$31.60
94050-355	405DNL - Entry	•					6	K6	\$49.30
94880-436	488DNL - Inactive	•					4		\$12.10
92001-293	200DNL - Hall/Closet				•		6		\$31.70
93001-518	300DNL - Bed/Bath				•		6		\$33.60
94050-357	405DNL - Entry				•		6	K6	\$51.50
94880-438	488DNL - Inactive				•		4		\$13.80



COVE™



POLO®

KNOBS

MFG Pro#	Function	Finish					Case Qty.	Keying	Price
Cove™ Knob		3	5	11P	15	26D			
92001-397	200CV - Hall/Closet			•			6		\$22.70
93001-630	300CV - Bed/Bath			•			6		\$24.10
94002-541	400CV - Entry			•			6	K6	\$29.80
94880-488	488CV - Inactive			•			4		\$10.60
Polo® Knob		3	5	11P	15	26D			
92001-276	200P - Hall/Closet	•					6		\$16.40
93001-500	300P - Bed/Bath	•					6		\$18.10
94002-432	400P - Entry	•					6	K6	\$24.10
94880-367	488P - Inactive	•					4		\$7.40
92001-277	200P - Hall/Closet		•				6		\$18.40
93001-501	300P - Bed/Bath		•				6		\$20.10
94002-435	400P - Entry		•				6	K6	\$25.80
94880-368	488P - Inactive		•				4		\$8.20
92001-398	200P - Hall/Closet			•			6		\$19.40
93001-631	300P - Bed/Bath			•			6		\$21.10
94002-542	400P - Entry			•			6	K6	\$26.80
94880-489	488P - Inactive			•			4		\$9.60
92001-272	200P - Hall/Closet				•		6		\$18.40
93001-496	300P - Bed/Bath				•		6		\$20.10
94002-502	400P - Entry				•		6	K6	\$25.80
94880-399	488P - Inactive				•		4		\$9.10



POLO®



TYLO®

KNOBS

MFG Pro#	Function	Finish					Case Qty.	Keying	Price
Polo® Knob Continued		3	5	11P	15	26D			
92001-275	200P - Hall/Closet					•	6		\$16.70
93001-499	300P - Bed/Bath					•	6		\$18.50
94002-429	400P - Entry					•	6	K6	\$24.50
94880-369	488P - Inactive					•	4		\$7.60
Tylo® Knobs		3	5	11P	15	26D			
92001-280	200T - Hall/Closet	•					6		\$14.40
93001-504	300T - Bed/Bath	•					6		\$16.00
94002-444	400T - Entry	•					6	K6	\$21.80
94880-363	488T - Inactive	•					4		\$6.60
92001-281	200T - Hall/Closet		•				6		\$16.10
93001-506	300T - Bed/Bath		•				6		\$17.50
94002-447	400T - Entry		•				6	K6	\$23.40
94880-364	488T - Inactive		•				4		\$7.60
92001-279	200T - Hall/Closet					•	6		\$14.70
93001-503	300T - Bed/Bath					•	6		\$16.20
94002-441	400T - Entry					•	6	K6	\$22.50
94880-365	488T - Inactive					•	4		\$6.70



COMBO PACK ENTRY KNOB/LEVER WITH DEADBOLT

COMBO PACKS - All combo packs include 660 or 665 deadbolt & keyed entry

MFG Pro#	Function	Finish					Case Qty.	Keying	Price
690 Combo Pack - Cove™ Knob with Single Cylinder Deadbolt		3	5	11P	15	26D			
96900-332	690CV			•			6	K6	\$53.80
690 Combo Pack - Polo® Knob with Single Cylinder Deadbolt		3	5	11P	15	26D			
96900-250	690P	•					6	K6	\$49.60
96900-251	690P		•				6	K6	\$53.60
96900-333	690P			•			6	K6	\$50.90
96900-320	690P				•		6	K6	\$51.60
96900-295	690P					•	6	K6	\$49.60
690 Combo Pack - Tylo® Knob with Single Cylinder Deadbolt		3	5	11P	15	26D			
96900-253	690T	•					6	K6	\$47.40
96900-254	690T		•				6	K6	\$51.20
96900-252	690T					•	6	K6	\$48.50
690 Combo Pack - Delta® Lever with Single Cylinder Deadbolt		3	5	11P	15	26D			
96900-312	690DL					•	6	K6	\$74.60
695 Combo Pack - Polo® Knob with Double Cylinder Deadbolt		3	5	11P	15	26D			
96950-160	695P	•					6	K6	\$56.80
96950-161	695P		•				6	K6	\$60.80
695 Combo Pack - Tylo® Knob with Double Cylinder Deadbolt		3	5	11P	15	26D			
96950-163	695T	•					6	K6	\$54.40
96950-164	695T		•				6	K6	\$58.30
96950-162	695T					•	6	K6	\$55.30
Pre-Pack - Special Orders Only		3	5	11P	15	26D			
91860-037	186 690T	•					36	K6	\$47.40
91860-039	186 690T		•				36	K6	\$51.20
91860-038	186 690T					•	36	K6	\$48.50



242 PROJECT PACK



243 PROJECT PACK

PROJECT PACKS - All 242 project packs include 660 deadbolt & keyed entry

MFG Pro#	Function	Finish					Case Qty.	Keying	Price
Project Pack - 2 Keyed Tylo® Knobs with 2 Single Cylinder Deadbolts		3	5	11P	15	26D			
92420-031	242T	•					6	K2	\$94.70
92420-032	242T		•				6	K2	\$102.30
92420-036	242T					•	6	K2	\$97.00
Project Pack - 2 Keyed Tylo® Knobs		3	5	11P	15	26D	Case Qty.	Keying	Price
92430-022	243T	•					6	K2	\$43.60
92430-023	243T		•				6	K2	\$46.80



660 SINGLE CYLINDER



663 ONE SIDED DEADBOLT



665 DOUBLE CYLINDER



MOBILE HOME LOCKS

DEADBOLTS

MFG Pro#	Function	Finish					Case Qty.	Keying	Price
Single Cylinder Deadbolt		3	5	11P	15	26D			
96600-419	660 - Single Cylinder	•					6	K6	\$23.70
96600-420	660 - Single Cylinder		•				6	K6	\$25.80
96600-590	660 - Single Cylinder			•			6	K6	\$26.80
96600-564	660 - Single Cylinder				•		6	K6	\$25.80
96600-418	660 - Single Cylinder					•	6	K6	\$24.20
One-Sided Deadbolt		3	5	11P	15	26D	Case Qty.	Keying	Price
96630-059	663 - One Sided Deadbolt - RCL RCS	•					4		\$11.30
96630-061	663 - One Sided Deadbolt - RCL RCS		•				4		\$12.10
Double Cylinder Deadbolt		3	5	11P	15	26D	Case Qty.	Keying	Price
96650-390	665 - Double Cylinder	•					6	K6	\$30.50
96650-391	665 - Double Cylinder		•				6	K6	\$32.50
96650-438	665 - Double Cylinder				•		6	K6	\$32.50
96650-389	665 - Double Cylinder					•	6	K6	\$31.10
Mobile Home Locks		3	5	11P	15	26D	Case Qty.	Keying	Price
92001-271	200M - Hall/Closet	•					6		\$14.10
93001-495	300M - Bed/Bath	•					6		\$15.50
94002-503	400M - Entry	•					6	K6	\$21.10
92001-270	200M - Hall/Closet					•	6		\$14.30
93001-494	300M - Bed/Bath					•	6		\$15.80
94002-504	400M - Entry					•	6	K6	\$21.50
96600-565	660M - Mobile Home	•					6	K6	\$22.40
96600-566	660M - Mobile Home					•	6	K6	\$22.80



FEATURES

- Lock Your Door with the Touch of a Button
- Customizable Access Codes for Increased Security
- Back-Lit Keypad for Increased Visibility
- Customizable Automatic Door Locking After 30 Seconds for Peace Of Mind
- Installs In Minutes with Just a Screwdriver - No Hard Wiring Required
- Fits Standard Doors (1 3/8" - 1 3/4") with No Screw Holes Required
- SmartCode™ Lever Ideal for - Small/Home Office, Utility/Storage Room, Interior Garage/Side Door
- SmartCode™ Deadbolts Replace any Deadbolt for Keyless Entry Convenience

WARRANTY

- 1 Year Electronic Warranty
- Lifetime Finish & Mechanical Warranty



907 PowerBolt®



909 SmartCode™ Deadbolt



909 CNT SmartCode™ Deadbolt



911 SmartCode™ Lever

ELECTRONIC LOCKS

MFG Pro#	Function	Finish							Case Qty.	Keying	Price
Powerbolt®		3	L03	5	11P	15	26	26D			
99070-007	907 - Powerbolt®		•						2		\$139.75
99070-008	907 - Powerbolt®					•			2		\$143.00
99070-009	907 - Powerbolt®				•				2		\$143.00
SmartCode™ Deadbolt		3	L03	5	11P	15	26	26D			
99090-001	909 - SmartCode™ Deadbolt		•						2		\$227.25
99090-003	909 - SmartCode™ Deadbolt				•				2		\$233.50
99090-002	909 - SmartCode™ Deadbolt					•			2		\$233.50
99090-007	909 - CNT SmartCode™ Deadbolt					•			2		\$233.50
99090-008	909 - CNT SmartCode™ Deadbolt						•		2		\$233.50
99090-009	909 - CNT SmartCode™ Deadbolt						•		2		\$233.50
99090-013	909 - CNT SmartCode™ Deadbolt				•				2		\$233.50
SmartCode™ Lever		3	L03	5	11P	15	26	26D			
99110-004	911 - SmartCode™ Lever		•						2		\$250.00
99110-005	911 - SmartCode™ Lever					•			2		\$263.75
99110-006	911 - SmartCode™ Lever				•				2		\$263.75

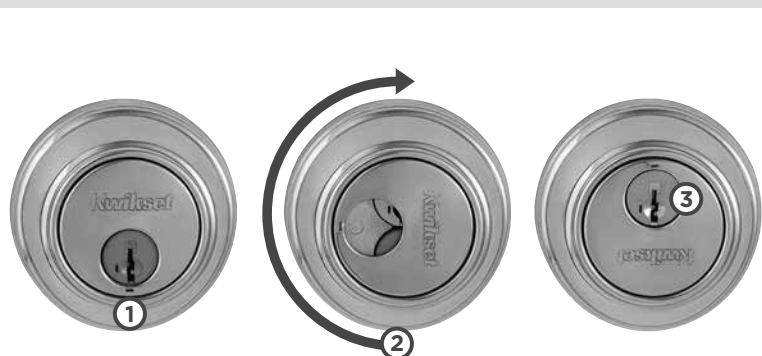

Easily access the Key Control cylinder: (1) Insert the SmartKey Tool into the slot at bottom of cylinder cover (2) Rotate cover clockwise to expose the Key Control cylinder. (3) Now you have access to the Key Control cylinder. Use tool to rotate counter-clockwise back to user's keyway when appropriate.

FEATURES

- Two Separate Cylinders, Tenant & Property Manager, Allow for More Tenant Key Cuts Than a Traditional Master Key System
- New Proprietary Keyway Adds Security
- Property Manager Cylinder is Concealed When Not in Use to Avoid Tenant Confusion
- With Smartkey®, Re-Key the Lock Without Removing From the Door



KEY CONTROL DEADBOLT

LIGHT COMMERCIAL								
MFG Pro#	Function	Finish					Case Qty.	Price
Key Control Deadbolt		3	5	11P	15	26D		
98160-007	816 - Key Control Deadbolt	•					6	\$61.00
98160-006	816 - Key Control Deadbolt					•	6	\$69.00
98160-008	816 - Key Control Deadbolt				•		6	\$69.00



RE-KEY TECHNOLOGY: EASY AS 1-2-3

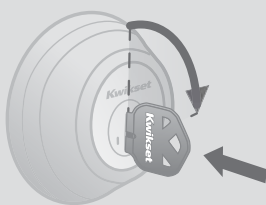

1 Insert functioning key & turn 1/4 turn clockwise.

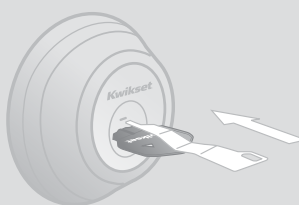

2 Insert & remove the SmartKey learn tool. Remove functioning key.



3 Insert new key & turn 1/2 turn counter-clockwise. Done. *Your lock is now re-keyed!*



Functioning Key



SmartKey Learn Tool



New Key

! You must have your functioning key & the learn tool for the system to work.

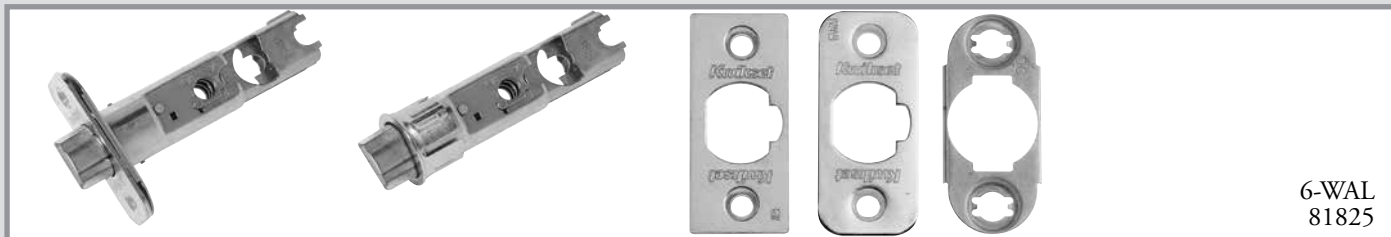

6-WAL
81825

PARTS

MFG Pro#	Function		Finish						Case Qty.	Price
Plain Latches		NA	3	L03	5	11P	15	26/26D		
81826	19843 6WAL PL		•		•			•	6	\$7.50
Dead Latches		NA	3	L03	5	11P	15	26/26D	Case Qty.	Price
83014-015	Security - 5" Deadlatch, 1" Front		•						6	\$13.00
81825	19841 6WAL DL		•		•			•	6	\$10.35
Deadbolt Latches		NA	3	L03	5	11P	15	26/26D	Case Qty.	Price
83146-001	11776 CP, RCAL DB LTCH		•						6	\$12.00
Mobile Home Conversion Kits		NA	3	L03	5	11P	15	26/26D	Case Qty.	Price
80340-001	12077 CP, DB, RFL, CNV Kit	•							6	\$10.45
83228-001	22827 CP, DL, 2WAL, DI 3/26 CNV Kit	•							6	\$9.15
83229-001	12003 CP, PI, 7/8RF, 3/26 CNV Kit	•							6	\$6.50
Strikes		NA	3	L03	5	11P	15	26/26D	Case Qty.	Price
83437	3437-01 CP, STRK, SQ CNR FULL LIP		•		•			•	6	\$3.40
83222-026	3222-01 3 CP STRK, DB		•						6	\$4.10

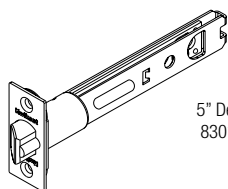

5" Deadlatch
83014-015

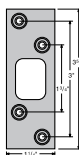

Deadbolt
Square Corner Strike
83222-026



Full Lip
Square Corner Strike
83437

PARTS



REKEYING KIT

KEYING

MFG Pro #	Description	Qty Per Pack	Price each
92720-001	272 Rekeying Kit	1	\$216.15
83108-001	#1 Master Pin .023"	100	\$0.12
83110-001	#2 Master Pin .046"	100	\$0.12
83112-001	#3 Master Pin .069"	100	\$0.12
83113-001	#4 Master Pin .092"	100	\$0.12
83114-001	#5 Master Pin .115"	100	\$0.12
83125-001	#6 Master Pin .138"	100	\$0.12
83100-001	#1 Bottom Pin .172"	100	\$0.12
83101-001	#2 Bottom Pin .195"	100	\$0.12
83103-001	#3 Bottom Pin .218"	100	\$0.12
83105-001	#4 Bottom Pin .241"	100	\$0.12
83106-001	#5 Bottom Pin .264"	100	\$0.12
83107-001	#6 Bottom Pin .287"	100	\$0.12
81858-001	Regular Top Pin .180"	100	\$0.12
83117-001	PK Top Pin .160"	100	\$0.12

KEYING

MFG Pro #	Description	Qty Per Pack	Price each
80370-001	Regular Anti-Pick Top Pin .180"	100	\$0.30
80369-001	PK Anti-Pick Top Pin .160"	100	\$0.30
84345-001	Knob Plug Retainer	100	\$0.14
84215-001	Deadlock Plug Retainer	100	\$0.14
87619-001	Knob Control Lug (Locking Bar)	100	\$0.30
87809-001	Deadlock Control Lug (Locking Bar)	100	\$0.55
80371-001	Low Profile Deadbolt Spring Cover	100	\$1.00
85757-001	Spring Cover (5-Pin)	50	\$0.90
83561-001	Spring Cover (6-Pin)	50	\$0.90
87632-001	Spring	100	\$0.45
82208-001	PK Balls	100	\$0.12
81777-001	Tumbler Spring	100	\$0.12
81467-003	Cylinder Removal Tool	1	\$1.55
80152-001	Plug Follower	1	\$6.40
80049-001	Key Gauge	1	\$5.95

SmartKey KEYING

MFG Pro #	Description	Case Qty.	Price
83262-001	Rekeying Kit CP SMT KW	6	\$12.45
83260-001	83260 SMT Reset Cradle	1	\$37.40



SMARTKEY SERVICE PARTS



83262-001



83260-001

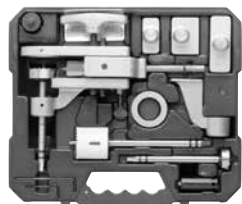

Drill not included

138 INSTALLATION KIT

138 INSTALLATION KIT & REPLACEMENT PARTS

MFG Pro#	Function	Quantity Per Pack	Master Pack Quantity	Price
138 Installation Kit & Replacement Parts				
91380-001	138 Installation Kit	1	1	\$553.50
89900-001	Jig with Wood Arm Guide	1	1	\$263.80
89901-001	Wood Door In-Line Guide Arm	1	1	\$58.30
89902-001	Metal Door In-Line Guide Arm	1	1	\$58.30
Drill Bits		Quantity Per Pack	Master Pack Quantity	Price
89903-001	1" Spade Bit	1	3	\$19.50
89904-001	2-1/8" Multi Spur Bit	1	3	\$85.80
89905-001	1-1/2" Multi Spur Bit	1	3	\$71.30
89906-001	2-1/8" Hole Saw Bit	1	3	\$17.95
89907-001	Hole Saw Mandrel	1	1	\$17.95
89908-001	Snap Rings	6	3	\$11.45
Mortise Tools		Quantity Per Pack	Master Pack Quantity	Price
89909-001	Full Lip Strike Mortise Tool	1	3	\$32.35
89910-001	Full Lip Round Corner Strike Blades	3	3	\$9.70
89911-001	Full Lip Square Corner Strike Blades	3	3	\$9.70
89912-001	Latch Mortise Tool	1	3	\$34.10
89913-001	Latch Round Corner Blades	3	3	\$11.45
89914-001	Latch Square Corner Blades	3	3	\$11.45
89915-001	Security Strike Mortise Tool	1	1	\$35.65
89916-001	Security Square Corner Blades	3	3	\$13.20
89917-001	Security Round Corner Blades	3	3	\$13.20
Miscellaneous Parts		Quantity Per Pack	Master Pack Quantity	Price
89918-001	Quick Bit Changer	1	1	\$22.80
89919-001	Strike Locator	1	1	\$5.20
89920-001	Strike Locator Tip	3	1	\$6.95
89921-001	Kit Box	1	1	\$29.15
89922-001	Jig Bushing	3	1	\$22.35
89923-001	1-1/2" Adapter Ring	1	1	\$10.25
89924-001	663 Boring Depth Stop	1	1	\$3.30
89925-001	Boring Template	1	1	\$3.00
89926-001	1/8" Hex Ring	1	1	\$0.90
91300-001	Wood Door Installation Kit	1	3	\$28.50



334 PASSAGE

335 PRIVACY



NOTCH POCKET DOOR LOCKS



DESIGNER ROSES

ROUND POCKET DOOR LOCK

MFG Pro#	Function	Finish						Case Qty.	Price
Round Pocket Door Lock		3	L03	5	11P	15	26D		
93340-023	334 - Passage	•						6	\$22.80
93350-023	335 - Privacy	•						6	\$25.30
93340-024	334 - Passage					•		6	\$22.80
93350-024	335 - Privacy					•		6	\$25.30

NOTCH POCKET DOOR LOCK

MFG Pro#	Function	Finish						Case Qty.	Price
Notch Pocket Door Lock		3	L03	5	11P	15	26D		
93320-019	332 - Passage Lock	•						12	\$22.15
93330-017	333 - Privacy Lock	•						12	\$24.65
93320-021	332 - Passage Lock			•				12	\$23.80
93330-019	333 - Privacy Lock			•				12	\$26.30

DESIGNER ROSES

MFG Pro#	Function	Finish							Case Qty.	Price
Oval Rose		3	L03	5	11P	15	26D	514		
83318-001	Designer Rose for Reversible Levers				•				12 sets	\$20.00
83318-002	Designer Rose for Reversible Levers					•			12 sets	\$20.00
83318-006	Designer Rose for Reversible Levers							•	12 sets	\$21.50
Arched Rose										
83319-001	Designer Rose for for Reversible Levers				•				12 sets	\$20.00
83319-002	Designer Rose for Reversible Levers					•			12 sets	\$20.00
83319-006	Designer Rose for Reversible Levers							•	12 sets	\$21.50

NOTES:

- Ordered as separate accessory with any Kwikset Signature Series Reversible Lever.
- Must order in full case quantity.
- Boxpack Package Only.



Handle Trim
Model 239



Trim Rosette
Model 288



Round Trim
Rosette
Model 293

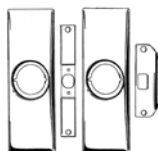

Modernization Kit
Model 214

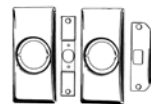

Modernization Kit
Model 215



Combo Trim
Escutcheon
Model 262

TRIMS

TRIMS										
Part #	Function	Finish						Dimensions	Case Qty.	Price
Trims		3	L03	5	11P	15	26D			
92140-001	Large Modernization Kit	•						3-1/2" x 10-1/2"	10	\$62.05
92150-001	Small Modernization Kit	•						3-3/8" x 7-1/4"	10	\$43.45
92390-022	Curved Colonial Handle	•							4	\$55.35
92390-009	Curved Colonial Handle BP			•					4	\$58.65
92390-021	Curved Colonial Handle BP					•			4	\$56.10
92490-001	Medium Rectangular Rosette	•						3-3/8" x 7-1/4"	5	\$19.50
92620-001	Vertical Combo	•						3-1/2" x 8-1/2"	5	\$29.05
92620-006	Vertical Combo			•				3-1/2" x 8-1/2"	5	\$33.20
92620-015	Vertical Combo					•		3-1/2" x 8-1/2"	5	\$32.35
92630-001	Large Vertical Combo	•						3-1/2" x 10-1/2"	5	\$29.05
92880-001	Small Rectangular Rosette	•						3-15/16" x 4-7/32"	5	\$18.70
92930-012	Round Rosette	•						3-13/16"	4	\$14.10
92930-013	Round Rosette			•				3-13/16"	4	\$15.95
92930-011	Round Rosette					•		3-13/16"	4	\$14.85
92930-014	Round Rosette					•		3-13/16"	4	\$14.85

KWIKSET SIGNATURE SERIES HANDLESET FUNCTIONS

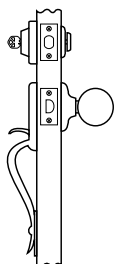

Model

800

Function

Handleset with Single
Cylinder Deadbolt

Description

Latchbolt operated by
thumbpiece outside and
grip inside. Deadbolt
operated by key outside
and thumbturn inside.

KWIKSET SIGNATURE SERIES KNOB & LEVER FUNCTIONS

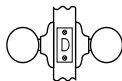

Passage/Hall/Closet: Both knobs
always free.

720 F75

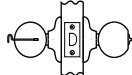

Privacy/Bed/Bath: Both knobs locked
or unlocked by turnbutton inside. Outside
knob unlocked by emergency key.

730 F76

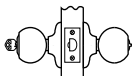

Entry: Both knobs locked or unlocked by
key outside or turnbutton inside.

740 F82



Half Dummy Trim, Surface Mounted:

For doors where only a pull is required.

No operation.

788

KWIKSET SIGNATURE SERIES DEADBOLT FUNCTIONS



Single Cylinder: Deadbolt
operated by key outside and
thumbturn inside.

980 E0151



Double Cylinder: Deadbolt
operated by key both sides.

985 E0141

Note: ANSI/BHMA functions are listed in italics.

KWIKSET SIGNATURE SERIES HANDLESET FUNCTIONS

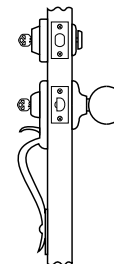

Model

553

Function

Handleset with Single
Cylinder Deadbolt

Description

Latch bolt operated by thumb
piece outside and grip inside,
except when both are locked
by key outside or turn button
inside. Deadbolt operated by
key outside or thumb
turn inside.

Kwikset Signature Series Packaging Dimensions

	Unit Height	Unit Width	Unit Length	Unit Weight	Master Height	Master Width	Master Length	Cubic Ft.	Master Weight	Case Qty
Knobs	10	5	3	1.6	10.7	7.2	12.7	0.57	7.1	4
Levers	10	6.5	3	2.3	11	5.8	13.5	0.5	10.5	4
Deadbolts	9	4.5	3	2.5	9.25	5.25	12.25	0.53	10.3	4
Knob Combo	9.37	8	3	4.7	9.75	8.75	12.25	1.49	19.3	4
Lever Combo	9.37	9	3	4.8	9.75	9.75	12.25	1.49	19.3	4
Handlesets	21.8	8	5.5	10.3	12.5	9	22.3	0.31	20.6	2
Inactive Knobs	8.8	3.5	3.3	0.3	9.3	13.3	4.4	0.31	1.3	4
Inactive Levers	8.8	3.5	3.3	0.3	9.3	13.3	4.4	0.31	1.3	4

Note: All dimensions in inches. All weights in pounds and based on maximum weights of each function.

KWIKSET HANDLESET FUNCTIONS

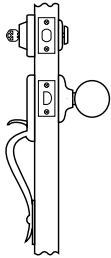

Model

687 Dakota
687 Belleview

Function

Sectional Handleset
with Single Cylinder
Deadbolt

Description

Latchbolt operated by
thumbpiece outside
and grip inside.
Deadbolt operated
by key outside and
thumbturn inside.

KWIKSET KNOB & LEVER FUNCTIONS

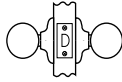

Passage/Hall/Closet: Both knobs
always free.
200 F75

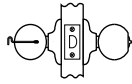

Privacy/Bed/Bath: Both knobs or levers locked
or unlocked by turnbutton inside. Outside
knob unlocked by emergency key. **300 F76**

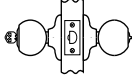

Entry: Both knobs or levers locked or unlocked by
key outside or turnbutton inside.
400 F82 - 2 knobs
405 F82 - 2 levers



Half Dummy Trim, Surface Mounted:
For doors where only a pull is required.
No operation.
488

KWIKSET DEADBOLT FUNCTIONS



Single Cylinder: Deadbolt operated by key
outside and thumbturn inside.
660/660M E0153

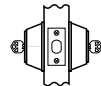

Double Cylinder: Deadbolt operated by
key both sides.
665 E0143



Thumbturn Only: Deadbolt operated by
thumbturn one side. No trim on other side.
663 E0193

Note: ANSI/BHMA functions are listed in italics.

Kwikset Packaging Dimensions

	Unit Carton Height	Unit Carton Width	Unit Carton Depth	Unit Carton Weight	Master Carton Height	Master Carton Width	Master Carton Depth	Cubic Ft.	Master Carton Weight	Case Count
Knobs	6.5	8	3	1.4	6.875	17.187	8.5	0.581	8.4	6
Levers	10.125	7.5	3	2.13	11	3.625	19.875	1.09	14	6
Deadbolts	6.5	2.906	5.375	1.235	6.688	17.438	6.25	0.422	7.41	6
Combo Packs	10.5	7.875	3.25	2.5	11.4	8.875	18.125	1.061	15	6
Belleview	21	8.125	5.5	4.5	12.5	9	21.625	1.408	9	2
Dakota	21	8.125	5.5	6	12.5	9	21.625	1.408	12	2
Inactive Knobs	8.75	3.5	3.125	0.93	9.313	13.313	4.375	0.314	3.72	4
243	10.5	7.75	3	2.5	11.4	8.875	18.125	1.061	15	6
242	11.125	12.75	2.875	5	13.063	18.75	13.813	1.958	30	6
Inactive Levers	8.75	3	3.5	0.93	9.313	13.313	4.375	0.314	3.72	4

Note: All dimensions in inches. All weights in pounds and based on maximum weights of each function.

