



LINKchef

Model SJ-051

MASTER SERIES WHOLE SLOW JUICER



HOW TO ASSEMBLY?

Before beginning assembly: Ensure the machine is placed on a flat countertop, is unplugged, and the power switch is turned off.



STEP 1:
Press the silicone valve to close it properly and tightly.



STEP 2:
Place the squeezing bowl on the power base steadily.



STEP 3:
Insert screw, rotate to bottom.



STEP 4:
Open the lid.



STEP 5:
Rotate the bowl clockwise until the latch is fully engaged in the slot.



STEP 6:
Load prepared fruits or veggies into the feed chute.



STEP 7:
Close the lid.



STEP 8:
Plug in the power supply and turn the button to "ON".

Warning: Make sure all parts are installed correctly before turning on the power, otherwise the unit will not start.

Thank you for purchasing the LINKchef Slow Juicer. Please read these instructions carefully before using this product for the first time.

IMPORTANT SAFETY INSTRUCTIONS :

1. Make sure that the power supply is 120V~60Hz
2. This appliance is intended for household use only and should not be used outdoors or for purposes other than its intended use.
3. Use the appliance only as described in this manual.
4. To avoid electric shock, do not immerse the appliance, cord or plug in water.
5. This is not a toy and should not be used by children without supervision.
6. Unplug the appliance when not in use, during assembly or disassembly and before cleaning.
7. Prohibited: Do not operate the machine without load or overload.
8. Do not touch or move any moving parts during operation. moving parts during operation.
9. Use only the pusher to insert fruit or vegetables into the chute. Do not use fingers, spoons or chopsticks.
10. Keep the appliance away from explosion hazards, hot ovens or hot surfaces.

11. Only operate the device on a flat surface.
12. Avoid letting the cable hang over the edge of a table or similar surface.
13. Hold the plug firmly to disconnect it from the socket.
14. If any part of the product structure is damaged (especially the safety system and the power cord), please stop using it and contact the LINKchef after-sales service immediately. We will actively investigate the cause and help solve these problems.
15. Children aged 8 years and older must use this product under the supervision of their parents.
16. Persons with reduced physical, sensory or mental capabilities or mental abilities or lack of experience or knowledge should only use the product after reading the instructions and the operating instructions or if they are supervised and are aware of the dangers.
17. Keep the appliance and its cord out of the reach of children under from children under the age of 8.
18. Never leave the appliance unattended when it is connected to a power connected to a power source.
19. If the power cord is damaged, the appliance should be disposed of or the cord should be replaced by the manufacturer, its service agent or a similarly qualified person in order to avoid danger avoid hazards.

PARTS OVERVIEW

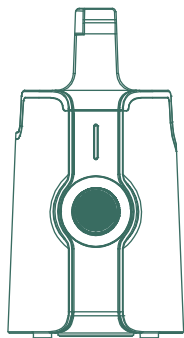

Motor Base

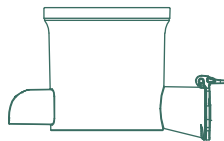

Juicing Bowl



Feeding Cup

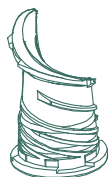

Squeezing Auger

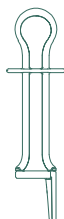

Pusher



Cleaning Brush

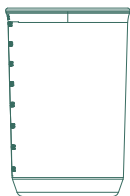

Juice Cup



Pulp Container

FIRST INSTRUCTIONS FOR USE

1. Remove all packing materials, plastic bags, and labels.
2. Ensure the appliance is connected to a 120V~60Hz power supply.
3. Clean the juice bowl, feed cup, press auger, pusher, juice cup, and pulp container with water.
(NOTE: DO NOT IMMERSE THE MOTOR BASE UNIT IN WATER.)
- 4. Follow the assembly instructions to set up the juicer and ensure all parts are dry.**
5. Plug in the power cord to a power source. The appliance is now ready for use.

INSTALLATION INSTRUCTIONS - ASSEMBLY

Before assembling the juicer, make sure the appliance is unplugged and the switch is set to the center position (OFF mode).

1. Place the juice bowl on the motor base and align the spouts and axle properly (Fig. 1).
2. Press the pressing auger firmly into the center of the bowl and ensure it touches the bottom. If it doesn't, the lid will not close properly (Fig. 2).
3. Open the lid closure first, then position the filling cup to align the "▲" with the "☞", and turn it clockwise until it clicks into place. Ensure that the "▲" on the shaft aligns with the locking graphic "🔒" on the juice bowl.(Fig. 3)

NOTE: THE LID OF THE FILLING CUP IS OPEN!!!

4. Place the juice cup and pulp container under the corresponding spouts (Fig. 4).

Place the juicing bowl

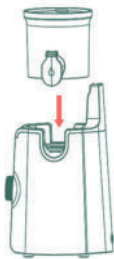

Fig.1

Push the squeezing auger



Fig. 2

Position the feeding cup



Fig. 3

OPERATING INSTRUCTIONS

1. Check and ensure that all parts are correctly fitted in their intended positions.
2. Confirm that the juice cup and the pulp container are positioned.
3. Make sure that the cover of the juice outlet is closed.
4. First open the cover (Fig. 4) and then turn the filler cup clockwise to lock it (Fig. 5).
5. Place whole vegetables/fruit in the filler cup, then press firmly on the lid to make sure that it is firmly attached to the cup (Fig. 6).
6. Turn the switch clockwise to start the juicing process.
7. Use a pusher to feed the fruit/vegetables into the machine(Fig. 7).

Open the cover
trigger first



Fig. 4

Twist the feeding
cup CLOCKWISE

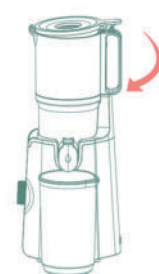

Fig. 5

Press down
the handle



Fig. 6



Fig. 7

8. CAUTION: Only use the pusher to press down the fruit. The use of other tools can damage the appliance.



9. If the fruit is stuck in the pressing bowl, please hold the switch counter-clockwise to reverse the function immediately.

10. The 4.35 inches feeding funnel allows you to add whole ingredients and shorten the preparation time.

11. The 1.77 inches small filling funnel allows you to use a pusher to remove guide stuck fruits or vegetables, and to insert thinner ingredients.

OPERATING INSTRUCTIONS

ADVANTAGES OF THE DRIP-STOP LID:

1. To stop dripping at the end of juicing.
2. To mix the juice with different fruits and vegetables.
3. It is recommended to close the lid of the juice outlet during juicing to prevent the juice from oxidizing. When the juice in the juice container reaches the maximum filling level open the lid slowly to avoid a sudden leakage of large quantities of juice.

USE TIPS:

1. Remove hard pips or seeds before pressing to avoid.
2. Please let the juicer run for 30 seconds after the last ingredient the last ingredient has been added.

For mixed juices, open the lid and place the fruits and vegetables together in the juicer and vegetables together in the juicer, then start the juicer.

NOTE:

1. If the juicer overheats, it will stop automatically to protect the machine. In this case, please switch the juicer to “OFF”. Wait 30 minutes until it has cooled down, before switching it on again.
2. We recommend only using a few ingredients such as robust, fibrous, overly soft or starchy fruits. excessively soft or starchy fruits and vegetables at the same time, as they at the same time, as they have the potential to block the stainless to block the stainless steel juicer filter.

CLEANING & MAINTENANCE

DISASSEMBLY INSTRUCTIONS

1. Open the cover.
2. Turn the filler cup to unlock it and remove it.
3. Unscrew the screw and remove the juice container.
(If it is difficult to remove the auger juicer, you can use the reverse function to remove it easily. Reverse function to loosen it slightly before disassembling the juicer. Disassemble the juicer).
4. The rubber stopper under the juice container can be pulled out to make it easier to clean the pulp more easily.

IMPORTANT: For best performance, clean the individual parts of the slow juicer immediately after each use to prevent pulp sticks to the components and is difficult to remove.

CLEANING DATA

1. Switch off the juicer and unplug it.
2. Wash the disassembled parts with water.

If the sieve is clogged with pulp, please use the cleaning brush supplied to remove the residue.

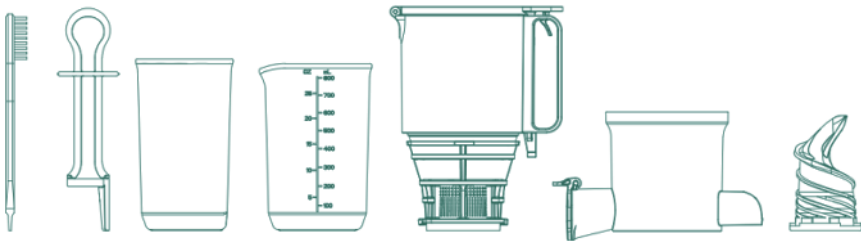

CLEANING & MAINTENANCE

CAUTION:

- Avoid water contact with the motor base, the power cable and the mains plug.
- Do not use an iron wire brush, abrasive or sharp objects to clean the appliance.
- It is recommended to wipe with a soft damp cloth.
- Dishwasher safe (excessive cleaning temperatures are not recommended).

3. please pull out the silicone valve under the juice container.

(As shown in the picture), pull out the silicone valve and use a cleaning brush to remove the pulp easily.

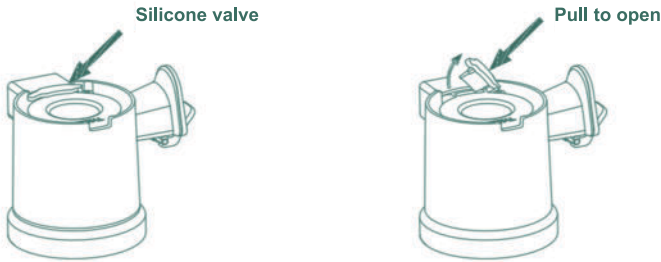

Note:

1. After cleaning, press firmly on the silicone valve under the juice container to seal it.
2. The silicone used in the LINKchef Slow Press is baby grade silicone, heat resistant and tested safe. You can therefore use it without hesitation.

CLEANING & MAINTENANCE

4. To clean the sealing ring in the center of the juice bowl, please follow these steps:

a. Turn the juice bowl upside down to make it easier to handle.

Press the sealing ring out with your thumb and clean it with water.

b. Make sure that the small ribbed surface is facing upwards. Make sure that the groove of the sealing ring fits well into the juice bowl. fits snugly into the juice chute.

c. The large flat surface of the sealing ring is on the inside, while the small and ribbed side is outside the juice bowl.



5. Do not immerse the power base in water for cleaning, wipe it with a damp cloth.

6. Dry the parts thoroughly after cleaning and store them in a dry, cool place.

STORAGE

1. Follow the cleaning instructions to maintain the appliance well before storing it.
2. Organize the power cord set neatly.
3. Keep the appliance out of the reach of children
4. Store the appliance and accessories in a dry, cool place
5. Make sure that the appliance and the parts are dry before storing it.

USEFUL TIPS

Article	Warning	Reason
1	Not suitable for ice cubes.	Ice cubes are too hard and can damage the press parts.
2	Ingredients with long fibers should be cut into manageable sizes.	Food with long fibers tends to become entangled and block the spout.
3	It is recommended to use only a few ingredients at once, such as tough such as tough, fibrous, overly soft or moderately soft or starchy fruits and fruit and vegetables.	They have the potential to clog the stainless steel juicer filter.
4	Remember to remove the peel, seeds and pips from fruit. remove them.	Hard kernels or seeds can damage the pressing parts, and peels can block the fruit pulp clog the fruit pulp outlet.
5	Do not use any other accessories to press the fruit press down the fruit. Use only use the supplied pusher.	The use of unsuitable toolstools such as pusher can damage the juicer and cause injury.
6	Each juicing cycle should not exceed 15 minutes.	Continuous operation beyond the recommended time can damage the motor.
7	Never insert a spoon or chopsticks or chopsticks into the opening of the chute, the juice and juice and pulp outlets.	It can cause commercial clogging and damage the juicer.

ERROR SEARCH

Error	Cause	Solutions
The juicer suddenly stops.	Too many ingredients are put into the juicer.	Turn the switch counterclockwise to "OFF" to stop the juicer, remove some of the fruit, put the lid back on, and switch the juicer to "REV" to start the reverse function.
	The size of the whole fruits or vegetables is too large.	Ingredients with very long fibers or very large fruits should be cut into manageable sizes.
The juice yield is low or the juice flows out of the main housing.	The bowl and the silicone valve are not correctly inserted.	Make sure that the bowl and the silicone valve are properly installed.
Abnormal noises.	Parts cause noises during juicing.	This is a normal process caused by the processing of fruits and vegetables during juicing.
The chute and the sieve cannot be opened.	There are too many fruit residues in the bowl.	First, rinse off the excess fruit residues. Then, use the pointed side of the cleaning brush to remove residues from the grooves of the auger. Rinse again and slowly pull out the press screw.
	Hard food is stuck.	
The juice or fruit pulp does not flow smoothly when pouring.	Too much juice or fruit pulp remains in the stainless steel auger or the sealing ring.	Clean the juice cup, auger, and sealing ring, and continue the juicing process.
The container and accessories are discolored after use.	Discolored parts are due to the natural color of certain fruits/vegetables.	This is a natural color and unavoidable.

PARAMETERS

Voltage:	120V/60Hz
Power:	200W
Juice cup capacity:	800 ml
Pulp holder capacity:	700 ml

Appliance weight:	2.85 kg
-------------------	---------

Important notes:

1. This appliance is intended for domestic use only.
2. Commercial users are not covered by the standard warranty according to the warranty conditions.
3. Foam often forms when juicing fruit and is typically caused by natural components of the fruit (such as saponins) and air introduced during blending. While foam is unavoidable, it does not affect the taste or nutritional value of the juice.
4. The working mechanism of the juicer is based on the low-temperature screw press technology, which squeezes fruit over a large area, similar to squeezing a towel, to slowly squeeze out the juice without damaging the cells. The juice is squeezed out slowly without damaging the cell structure of the fruit and preserving the nutrients.
5. During operation, the motor must drive the auger to squeeze the food, so the cup may wobble slightly on the base. Cup may wobble slightly on the base when processing hard foods. This is a normal process as more pressure is needed to press.
6. Register now to activate your lifetime warranty. Don't forget to enter your order number.

Brand: LINKChef

Manufacturer: zhongshanshibojietongdianzishangmaoyouxiangongsi

Address: No.80, Suiming Road, Suicheng Dorf Dongfeng Stadt,
Zhongshan City,GuangdongProvince, 528425, China

Contact information: E-mail: support@link-chef.com.cn





LINKchef

Voltage:	120V~60Hz
Power:	200W
Juicing cup capacity:	800ML
Pulp container capacity:	700ML
Bare weight:	2.85KG

CUSTOMER SERVICE

Email: support@link-chef.com.cn

FOLLOW ME TO GET MORE PRODUCT INFORMATION



 Facebook



 Instagram



 TikTok



 Pinterest