



# **Quick Start Guide**

## **O4DM**



# Welcome

Thank you for purchasing this network camera!

This owner's manual is designed to be a reference tool for your system.

Please read this manual carefully before operating the unit and retain it for future reference.

Should you require any technical assistance, contact Speco Technologies Tech Support at 1-800-645-5516

## Important Safeguards and Warning

### 1. Electrical safety

All installation and operation here should conform to local electrical safety codes.

Use a certified/listed 12VDC/24VAC Class 2 power supply or adequate PoE switch.

Please note: The product must be grounded to reduce the risk of electric shock.

Improper handling and/or installation could run the risk of fire or electrical shock.

### 2. Environment

Do not expose the unit to heavy stress, violent vibration or long-term exposure to water and humidity during transportation, storage, and/or installation.

Do not install near sources of heat.

Only install the product in environments inside the specification operating temperature and humidity range.

Do not install the camera near power lines, radar equipment or other electromagnetic radiation.

Do not block any ventilation openings if any.

Use all the weatherproofing hardware requirement to minimize weather intrusion.

### 3. Operation and Daily Maintenance

Please shut down the device and then unplug the power cable before you begin any maintenance work.

Do not touch the CMOS sensor optic component. You can use a blower to clean the dust on the lens surface.

Always use the dry soft cloth to clean the device. If there is too much dust, use a cloth

dampened with a small quantity of neutral detergent. Finally use the dry cloth to clean the device.

Please use a professional optical cleaning method to clean the enclosure. Improper enclosure cleaning (such as using cloth) may result in poor IR functionality and/or IR reflection. The grounding holes of the product are recommended to be grounded to further enhance the reliability of the camera.

Dome cover is an optical device, please don't touch or wipe cover surface directly during installation and use, please refer to the following methods if dirt is found:

Stained with dirt: Use oil-free soft brush or hair dryer to remove it gently.

Stained with grease or fingerprint: Use oil-free cotton cloth or paper soaked with alcohol or detergent to wipe from the lens center outward. Change the cloth and wipe several times if it is not clean enough.

## **Warning**

This camera should be installed by qualified personnel only.

All the examination and repair work should be done by qualified personnel.

Any unauthorized changes or modifications could void the warranty.

## **Statement**

This guide is for reference only.

Product, manuals and specifications may be modified without prior notice. Speco Technologies reserves the right to modify these without notice and without incurring any obligation.

Speco Technologies is not liable for any loss caused by improper operation.

### **Note:**

Before installation, check the package and make sure that all components are included. Contact your rep or Speco customer service department immediately if something is broken or missing in the package.

# **1 Package**



Camera



Quick start guide



Tapping screw×4  
Machine screw×1



Plastic screw  
anchor × 4



CD



Drill template



L-wrench



CVBS&DC  
IN cable



Terminal for 12VDC  
C/24VAC power

## 2 Overview

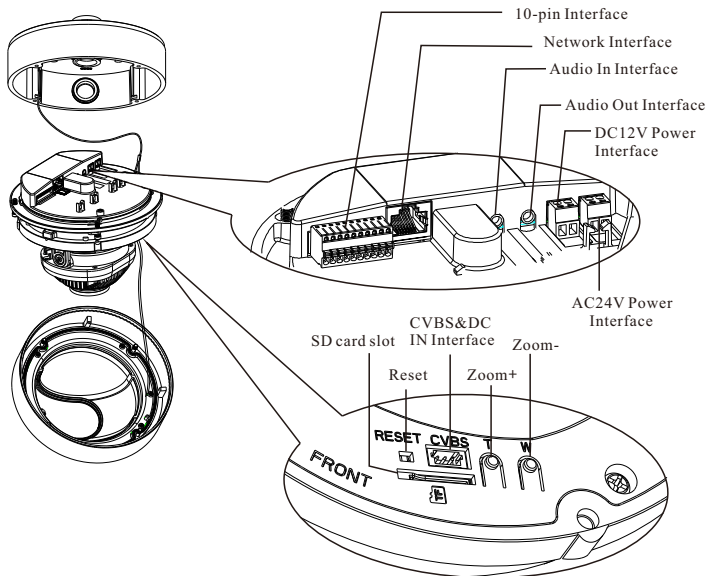



## 10-pin Interface:

PWR		VO		RS 485		ALM-I		ALM-O	
GND	12V+	GND	CVBS	D-	D+	GND	INA	NO	COM
DC12V Output (200mA)		CVBS Output		RS 485 Interface		Alarm Input		Alarm Output	

**Reset:** Press **Reset** button for about 10s when the camera is powering on to restore the default settings.

## 3 Installation

Please make sure that the wall or ceiling is strong enough to withstand 3 times the weight of the camera. Please install the camera in a dry environment

**DO NOT** remove the protective film until the installation is complete.

The installation steps are as follows.

- ① Open the trim ring from the gap indicated and then unscrew the dome cover. Install a micro SD card (optional) as shown below. After that, loosen the spring screws and then move the base of the camera clockwise to separate the junction box from the camera.

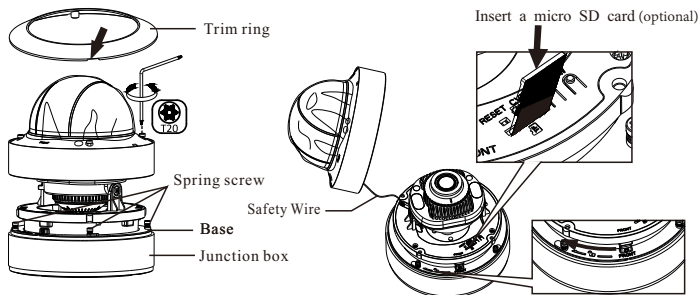

② Drill the screw holes and the cable hole according to the drill template.

③ Connect the earth wire.

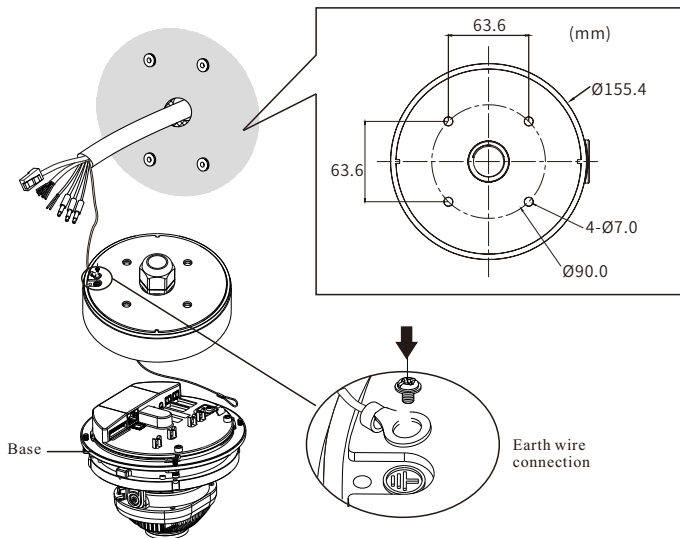

④ Mount the junction box to the wall or ceiling.

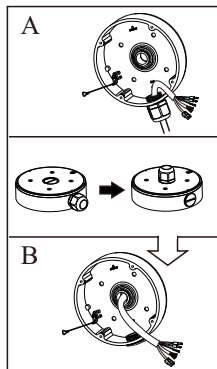
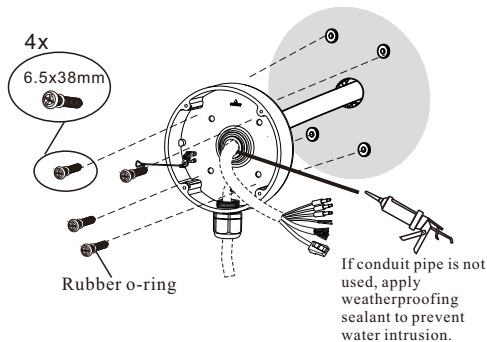

⑤ Connect the cables.

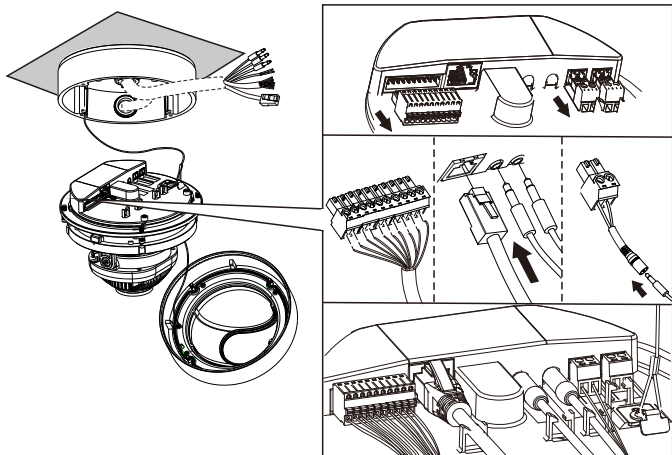

⑥ Coil up these cables and then install the camera onto the junction box by turning the base clockwise and tightening the spring screws.

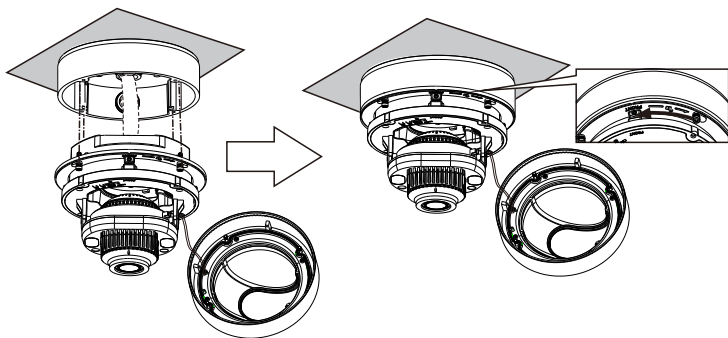

- ⑦ Three-axis adjustment-Before adjustment, preview the image of the camera on a monitor. Loosen the lock screw to adjust view angle of the camera. After that, tighten the lock screw.
- ⑧ Press T/W to obtain an optimum image.

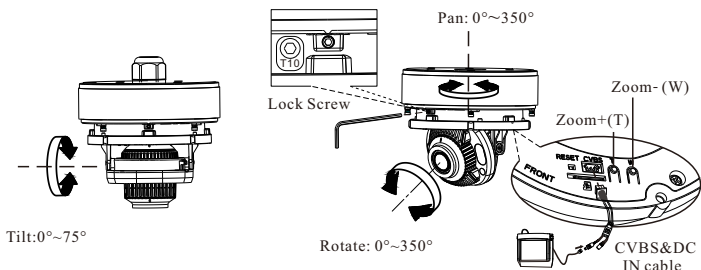

- ⑨ Install the dome cover back to the camera with the screws. Then put the trim ring onto the camera.

Note: Ensure that no wires or material interferes the weatherproofing seal, or water intrusion may occur.

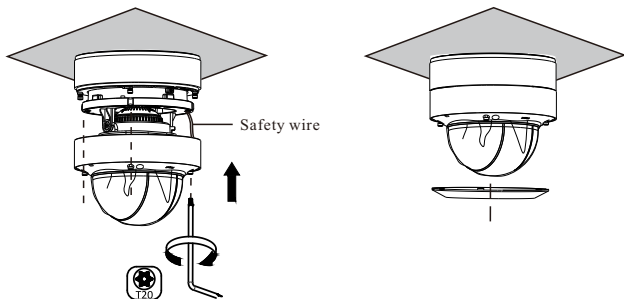

- ⑩ Peel off the protective film to finish the installation.

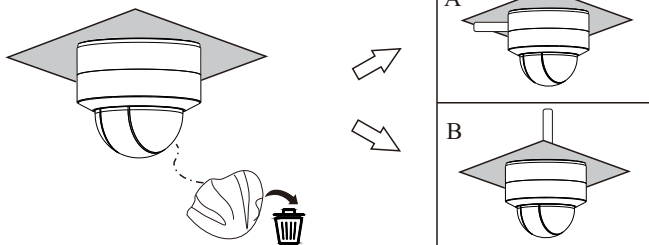

## 4 Web Operation and Login

IP Scanner can search for the device on the local network.

### • Operation

- ① Make sure that the camera and the PC are connected to the same local network. The camera is set to DHCP by default.
- ② Install IP Scanner from the CD and run it after installation.  
Or download from <https://www.specotech.com/ip-scanner/>

SecureGuard IP Scanner							
Refresh	Open Web Page	Login...	IP	Restart	Factory Default	Information	About
Status	Model Name	Name	IP Address	MAC Address	Wireless IP Address	Zero Config IP	
Online		O4DM	192.168.17.251	5C:F2:07:24:68:B9	n/a	n/a	

③ In the device list, you can view the IP address, model number, and MAC address of each device. Select the applicable device and double click to open up the web viewer. You can also manually enter the IP address in the address bar of the web browser.

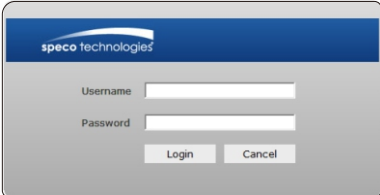
The image shows a web-based login interface for Speco Technologies. At the top, there is a blue header bar with the 'speco technologies' logo in white. Below the header, the background is a light gray. There are two input fields: 'Username' and 'Password', each with a white text box. Below the 'Password' field, there are two buttons: 'Login' and 'Cancel', both with a light gray background and black text.

The login interface is shown above. Default user name is admin and password is 1234. After logging in, follow directions to install applicable plugins if prompted.