

CREALITY

Create reality, achieve dreams

K1 Max

K1 Max



# 3D Printer User Manual

V1.4



Thank you for choosing our products. For the best experience, please read this User Manual carefully and strictly follow the instructions to operate the printer. Our teams will always be ready to provide you with the best services. Please contact us via the phone number or e-mail address provided at the end of this User Manual when you encounter any problem with the printer. For a better experience in using our products, you can also learn how to use the printer in the following ways: Accompanied instructions: you can find the relevant instructions and videos in the USB flash disk.

You can also visit our official website (<https://www.creality.com>) to find information regarding software, hardware, contact information, device instructions, device warranty information, and more.

## NOTES

- 1 Do not use the printer in any way other than described herein in order to avoid personal injury or property damage;
- 2 Do not place the printer near any heat source or flammable or explosive objects. We suggest placing it in a well-ventilated, cool and dustless environment;
- 3 Do not expose the printer to a violent vibration or any other unstable environment, as this may cause poor print quality;
- 4 Please use recommended filaments to avoid clogging of the extrusion head and causing damage to the machine;
- 5 Do not use the power cable of other products during installation. Always use a grounded three-prong power outlet, which accompanies the printer;
- 6 Do not touch the nozzle and the heated bed during operation to avoid burns or personal injury;
- 7 Do not wear gloves or wraps while operating the machine to prevent entrapment of movable parts that could cause crushing and cutting injuries to bodily parts;
- 8 Use the provided tools to clean the filament from the extruder in time taking advantage of the residual temperature after printing. Do not touch the extruder directly when cleaning, otherwise it may cause burns;
- 9 Clean the printer frequently. Clean the printer body with a dry cloth regularly after powering off the printer, wipe away dust, bonded print filament and foreign objects on the guide rails;
- 10 Children under 10 years old should not use the printer without supervision, otherwise it may cause personal injury;
- 11 Users should comply with the laws and regulations of the corresponding countries and regions where the equipment is located (used), abide by professional ethics, pay attention to safety obligations, and strictly prohibit the use of our products or equipment for any illegal purposes; Creality will not be responsible for any violators' legal liability under any circumstance;
- 12 Tip: Do not plug in or unplug wires on a charged basis.

|  |              |
|--|--------------|
| <b>1. About the Device</b>             | <b>01-03</b> |
| 1.1 About the Printer                  | 01-01        |
| 1.2 Device Specifications              | 02-02        |
| 1.3 Packing List                       | 03-03        |
| <b>2. Unboxing</b>                     | <b>04-07</b> |
| 2.1 Unboxing Steps                     | 04-04        |
| 2.2 Install the Product                | 05-06        |
| 2.3 Power-on guide                     | 07-07        |
| <b>3. About the User Interface</b>     | <b>08-10</b> |
| 3.1 Main、Tune                          | 08-08        |
| 3.2 Files                              | 09-09        |
| 3.3 Settings、Support                   | 10-10        |
| <b>4 First Printing</b>                | <b>11-15</b> |
| 4.1 Local Printing                     | 11-11        |
| 4.2 LAN Printing                       | 12-13        |
| 4.3 CrealityCloud printing             | 14-15        |
| <b>5. Functional Specification</b>     | <b>16-22</b> |
| 5.1 Retract                            | 16-17        |
| 5.2 Change filament                    | 18-19        |
| 5.3 Calibration                        | 20-20        |
| 5.4 AI function                        | 21-21        |
| 5.5 Self-check                         | 21-21        |
| 5.6 Network Settings                   | 22-22        |
| <b>6. Tips and Routine Maintenance</b> | <b>23-26</b> |
| 6.1 Precautions for printing           | 23-24        |
| 6.2 Maintenance Items                  | 25-25        |
| 6.3 Installation of Damping Pads       | 26-26        |

# 1. About the Device

## 1.1 About the Printer

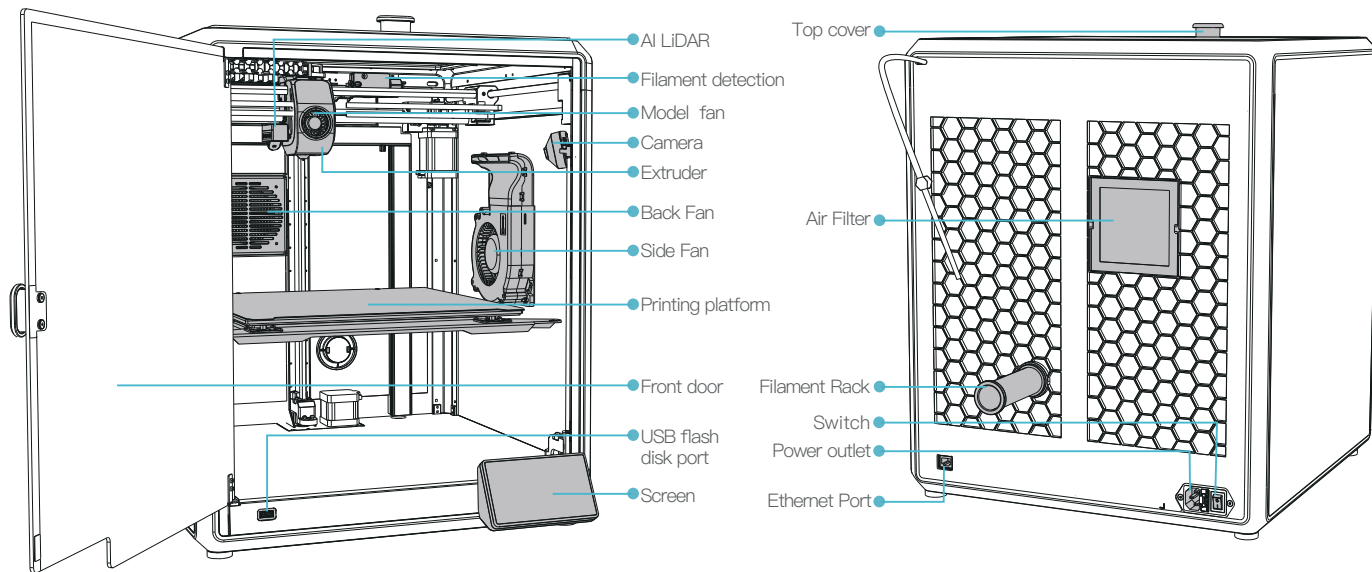

## 1. About the Device



### 1.2 Device Specifications

| Basic Parameters        |   |
|-------------------------|---|
| Product Model           | K1 Max  |
| Dimensions              | 435*462*526mm                                       |
| Max. Build Dimensions   | 300*300*300mm                                       |
| Print Technology        | FDM   |
| Rated Voltage           | 100–240V~, 50/60Hz                                  |
| Rated Power             | 1000W   |
| Ambient temperature     | 10°C–30°C / 50°F–86°F                               |
| Extruder                | Sprite Direct Drive                                 |
| Supported Filament      | PLA/ABS/Carbon/PETG/PET/TPU95A                      |
| Max. Nozzle Temperature | 300°C   |
| Screen                  | 4.3 inch touch screen                               |
| Printing Method         | USB Flash Disk/LAN Printing/Creality Cloud Printing |
| Connection              | USB flash disk/WIFI/Ethernet                        |
| Power Loss Recovery     | Yes   |
| Filament Detection      | Yes   |
| Auto leveling           | Yes   |
| Camera                  | Yes   |
| AI LiDAR                | Yes   |

# 1. About the Device

## 1.3 Packing List

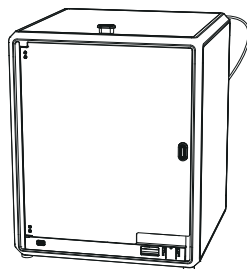

1 Printer



2 Screen

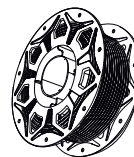

3 Filament



### Tool Box List

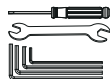

4 Wrench and Screwdriver x1



5 Blade x1

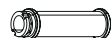

6 Filament Rack x1

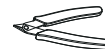

7 Cutting plier x1



8 1.2mm nozzle cleaner x1



9 USB flash disk x1



10 Power Cable x1



11 M6 socket spanner x1



12 Damping Pads x4



13 Belt tensioning screw M3x12 x2



14 Quick Guide x1



15 After-sales Services Card x1

\* Tips: the above accessories are for reference only. Please refer to the physical accessories!

## 2. Unboxing

### 2.1 Unpacking Steps

Take the packing cotton and tools in the order as shown in figure.

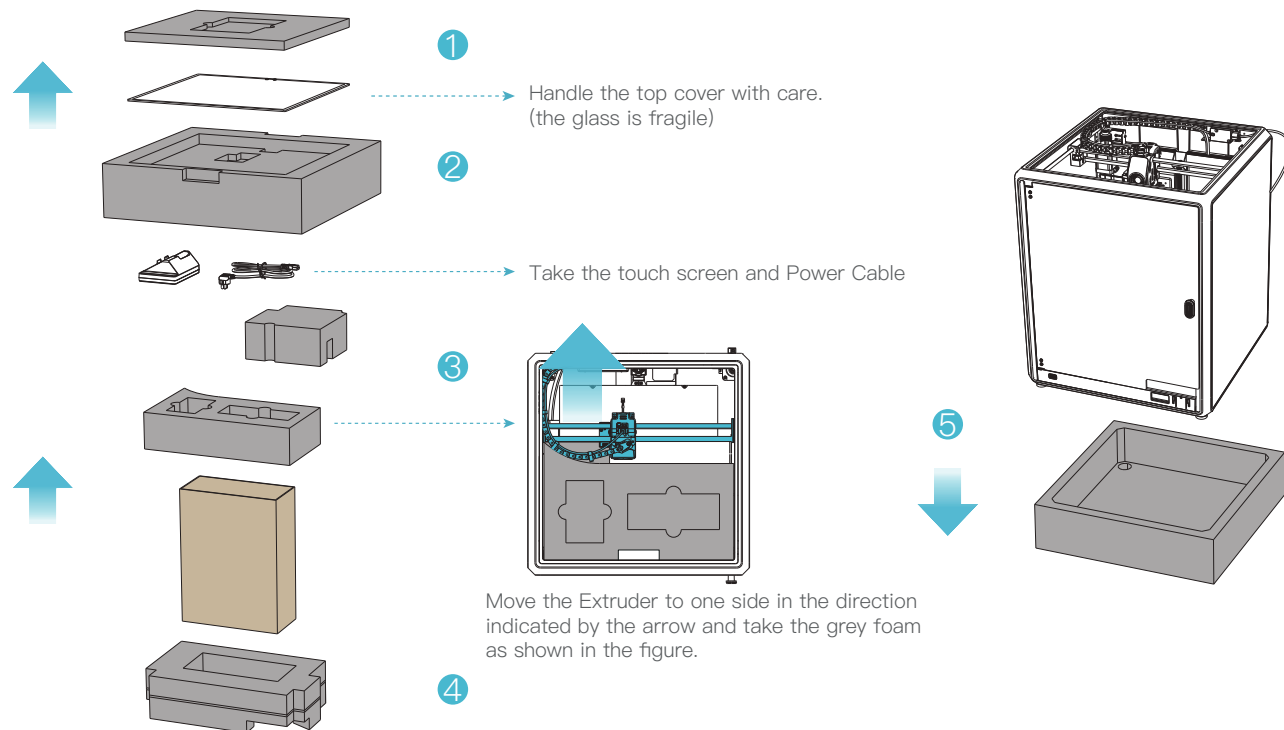

## 2. Unboxing

### 2.2 Install the Product

① Install the door handle on the front door as shown in the diagram.

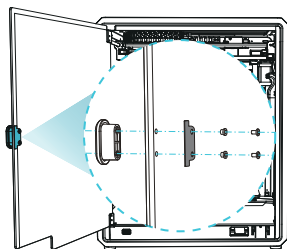

② Connect the touch screen to the flat cable extended from the base according to Figure A. Then snap the touch screen into the slot in the baseplate, as shown in Figure B. (The direction is as shown in the figure; otherwise, the screen interface may be damaged.)

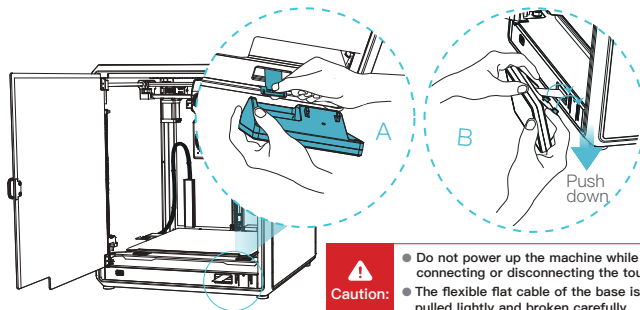

③ A: Connection and power on.  
B: Install the material barrel.

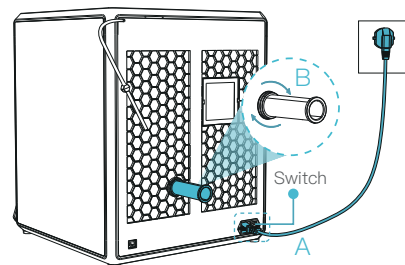

④ Load filaments. (Insert the filaments into the deepest part of Teflon tube until it cannot be moved.)

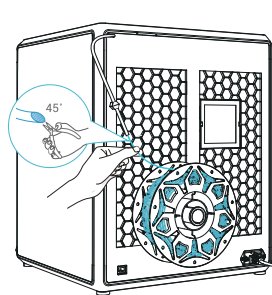

Note: Keep the Extrusion switch off before printing.

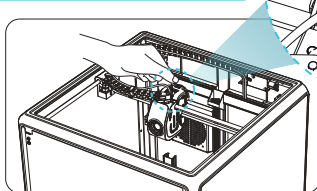

⑤ Install the top cover.  
(Put the top cover gently on the top of the machine.)

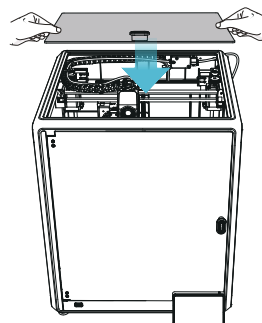

**Caution:**

1. When printing low-temperature filaments such as PLA and flexible filaments, remove the clear top cover if the room temperature exceeds 30°C.
2. When printing high melting-point filaments such as non-PLA and non-flexible filaments, be sure to keep the forming chamber temperature with the clear top cover closed to avoid cracking of the mould.



## 2. Unboxing

### 2.2 Install the Product

⑥ Select a language and click “Next”, Remove three screws a, b and c according to position indicated by the yellow arrow. click “OK” on the screen.

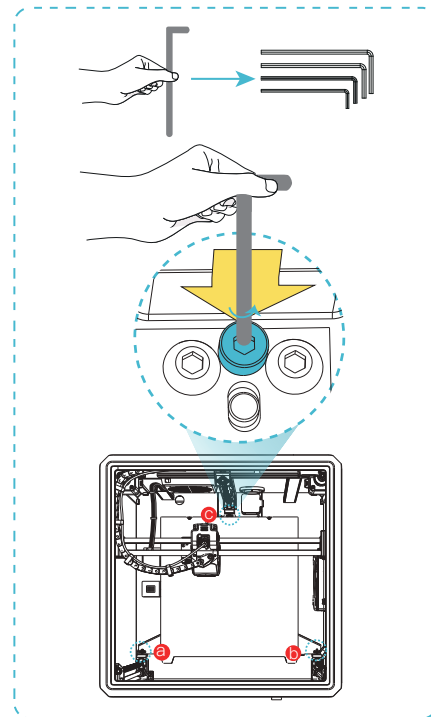

⑦ Keep the blue cube in the figure clean of debris and then click “OK”.

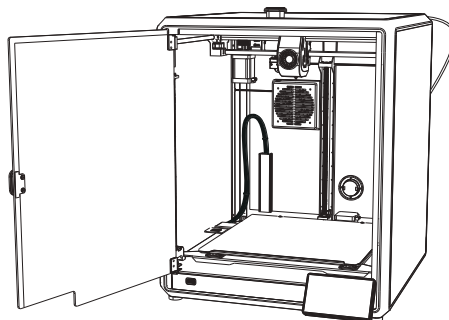

## 2. Unboxing

### 2.3 Power-on guide



① Network Settings



② Time Zone Settings



③ Creality Cloud binding

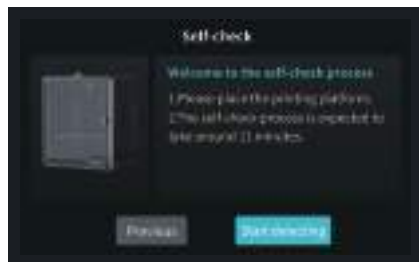

④ Self-check



⑤ Self-checking

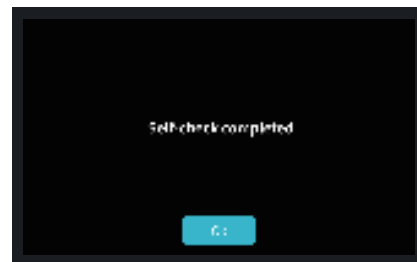

⑥ Self-check completed



Note: The current interface is for reference only. Due to the continuous upgrading of functions, it shall be subject to the latest firmware UI published on the official website.

### 3. About the User Interface

#### 3.1 Main、Tune



Parameters can be manually set

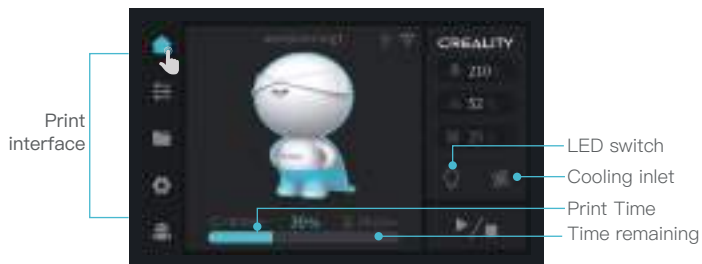

Note: The current interface is for reference only. Due to the continuous upgrading of functions, it shall be subject to the latest firmware UI published on the official website.



Tune

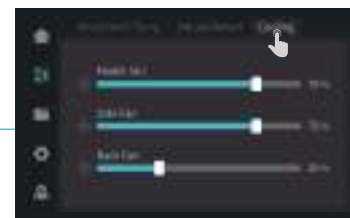

### 3. About the User Interface

#### 3.2 File



① Local file



② Printing

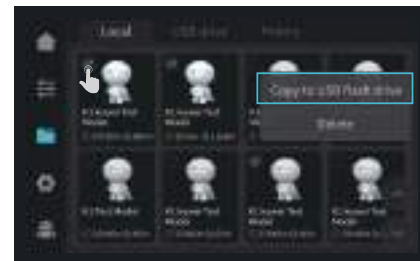

③ Press and hold on the model to multi-select and copy it to a USB flash drive

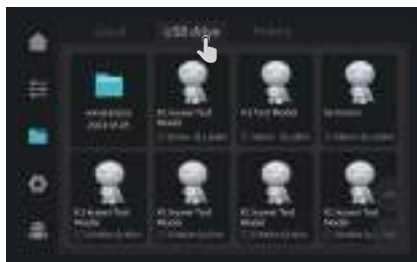

④ USB flash drive file

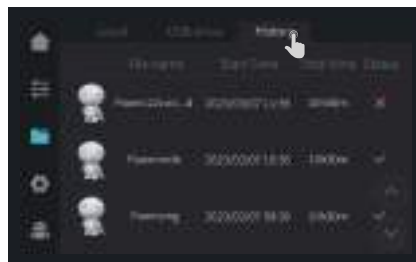

⑤ History



Note: The current interface is for reference only. Due to the continuous upgrading of functions, it shall be subject to the latest firmware UI published on the official website.

### 3. About the User Interface

#### 3.3 Settings、Support



System settings

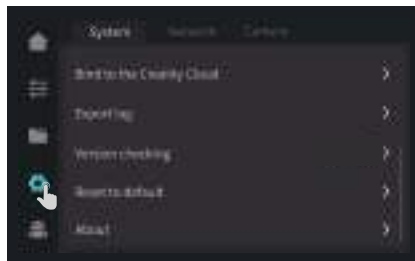

System settings

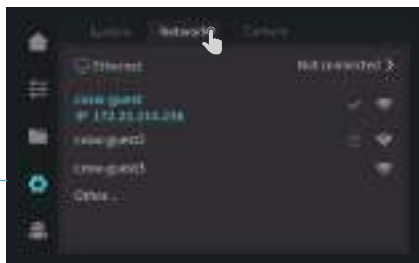

Network settings



Note: The current interface is for reference only. Due to the continuous upgrading of functions, it shall be subject to the latest firmware UI published on the official website.

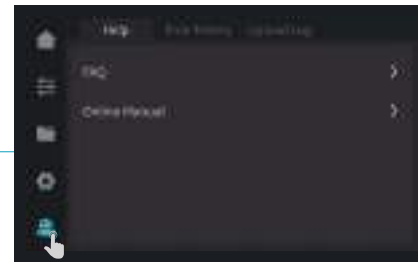

Help



Error history

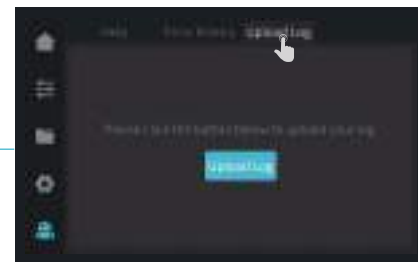

Upload Log

## 4. First Printing

### 4.1 Local Printing



① Local model



② Select to print



③ Printing



Note: The current interface is for reference only. Due to the continuous upgrading of functions, it shall be subject to the latest firmware UI published on the official website.



Note: Keep the Extrusion switch off before printing.

## 4. First Printing

### 4.2 LAN Printing

#### Creality Print



① Download at ([www.crealitycloud.com](http://www.crealitycloud.com)) or find the software on a USB flash drive and install it.



Tips: the computer must be in the same local area network as the printer



② Choose a language and region



③ Choose a Printer

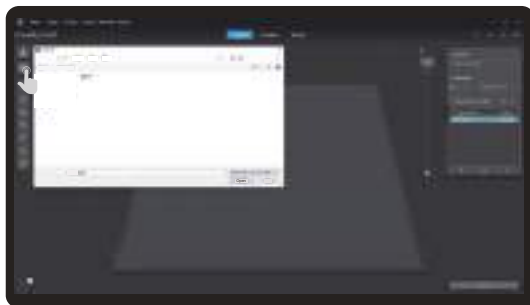

④ Click on "Import Model" and select the model file



⑤ Open the model and click on "Slice"



Note: The current interface is for reference only. Due to the continuous upgrading of functions, it shall be subject to the latest firmware UI published on the official website.

## 4. First Printing

### 4.2 LAN Printing



⑥ Selection of LAN printing

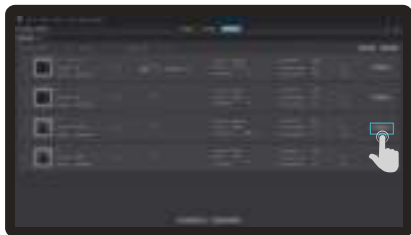

⑧ Device List



⑨ Device Details





## 4. First Printing

### 4.3 CrealityCloud printing



1. Scan the QR code and download the app

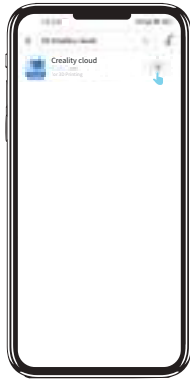

2. Download



3. Sign up for an account



4. Log in

## 4. First Printing

### 4.3 CrealtyCloud printing



5. Add a new device



6. Add a device

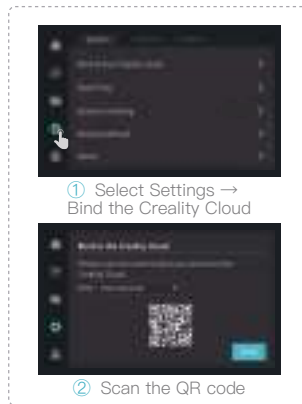

7. Select model on the homepage



8. Slice

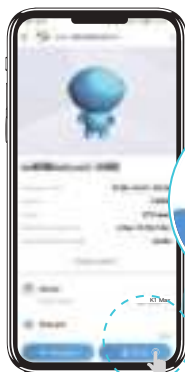

9. Print



10. Select a device



11. Printing