

eufy

SECURITY

QUICK START GUIDE

eufy Security SoloCam C210

KURZANLEITUNG

GUÍA DE INICIO RÁPIDO

GUIDE DE DÉMARRAGE RAPIDE

GUIDA RAPIDA

SNELSTARTGIDS

GUIA DE INÍCIO RÁPIDO

HIZLI BAŞLANGIÇ KILAVUZU

クイックスタートガイド

빠른 시작 안내

دليل البدء السريع

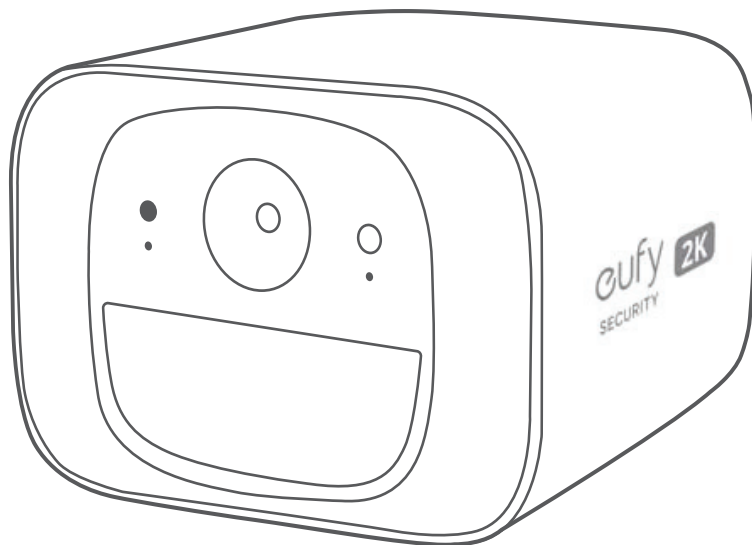

AT A GLANCE

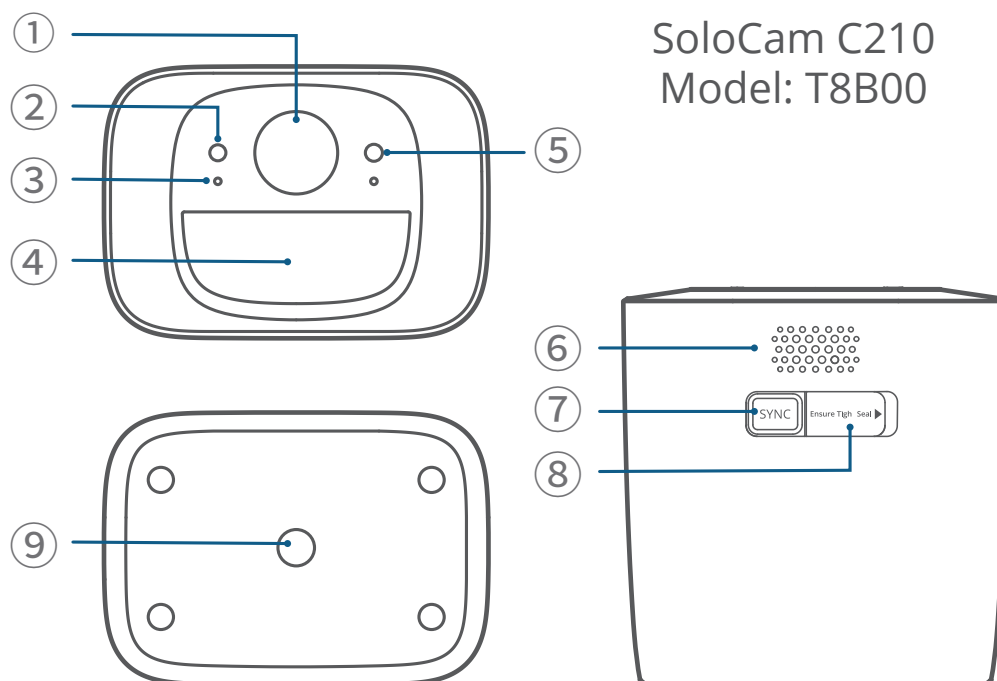

SoloCam C210
Model: T8B00

- | | |
|-------------------------|---|
| ① Camera Lens | ⑥ Speaker |
| ② Light Sensor | ⑦ SYNC Button |
| ③ Microphone | ⑧ USB-C Charging Port
(with Sealing Cap) |
| ④ Photosensitive Sensor | ⑨ Mounting Hole |
| ⑤ LED Indicator | |

CHARGING YOUR SOLOCAM

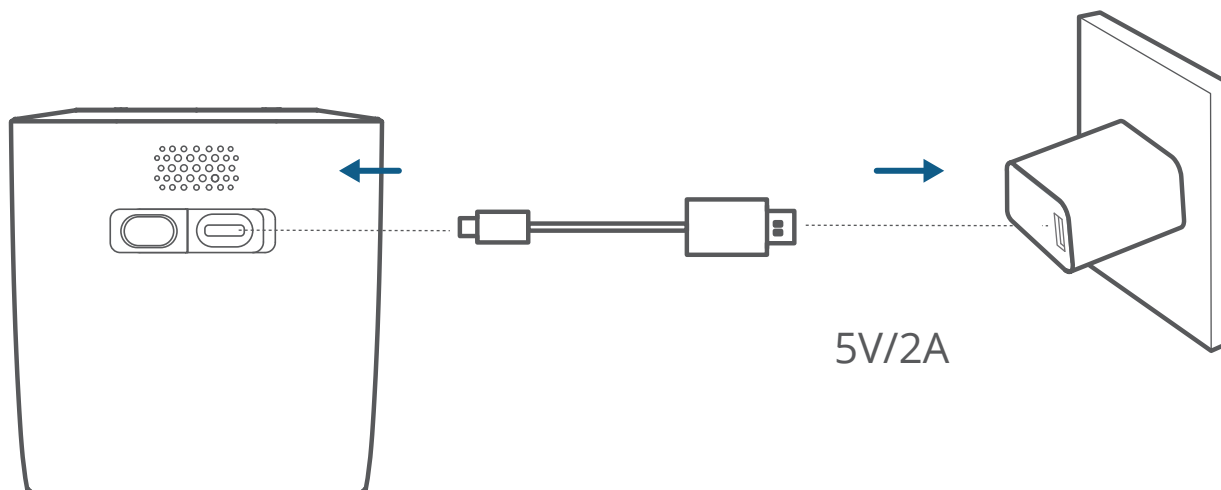

Charging	Solid Blue
Fully Charged	Off
Charging Time	4.5 Hours

SETTING UP THE SYSTEM

1. Download and install the eufy Security app, then sign in or create an account.



2. Follow the in-app instructions to add the camera to the device list.

MOUNTING YOUR SOLOCAM

Select a Location

This camera can be mounted on a wall. Select a location where you can get the desired view.

We recommend mounting the camera 7-10 ft (2-3 m) above the ground to achieve up to 26 ft of motion detection range.

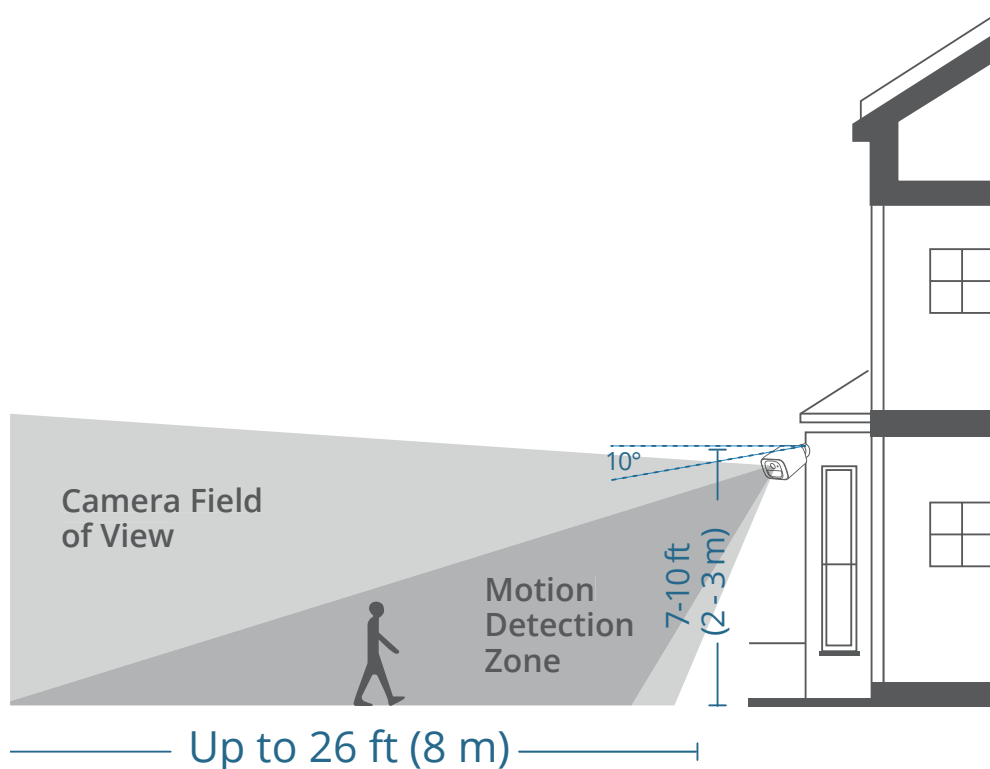

Mount the Camera

This camera can be mounted both outdoors and indoors.

1. Loosen the cover of the mounting bracket by turning it counterclockwise and disassemble the mounting bracket.

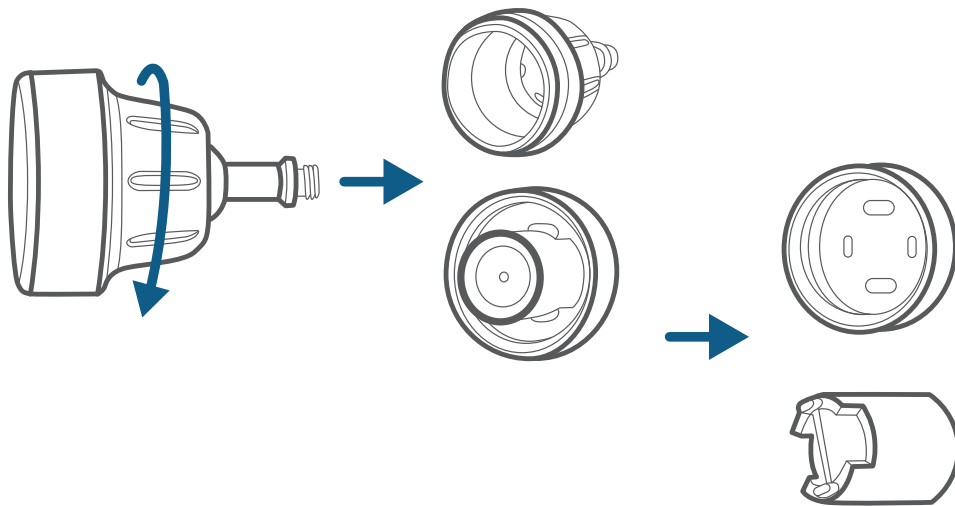

2. For walls that are made out of hard materials, such as stucco, brick, or concrete, drill holes with a 15/64 inch (5.95mm) drill bit, then insert the anchors into the holes.

- For soft surfaces such as wood, skip this step.

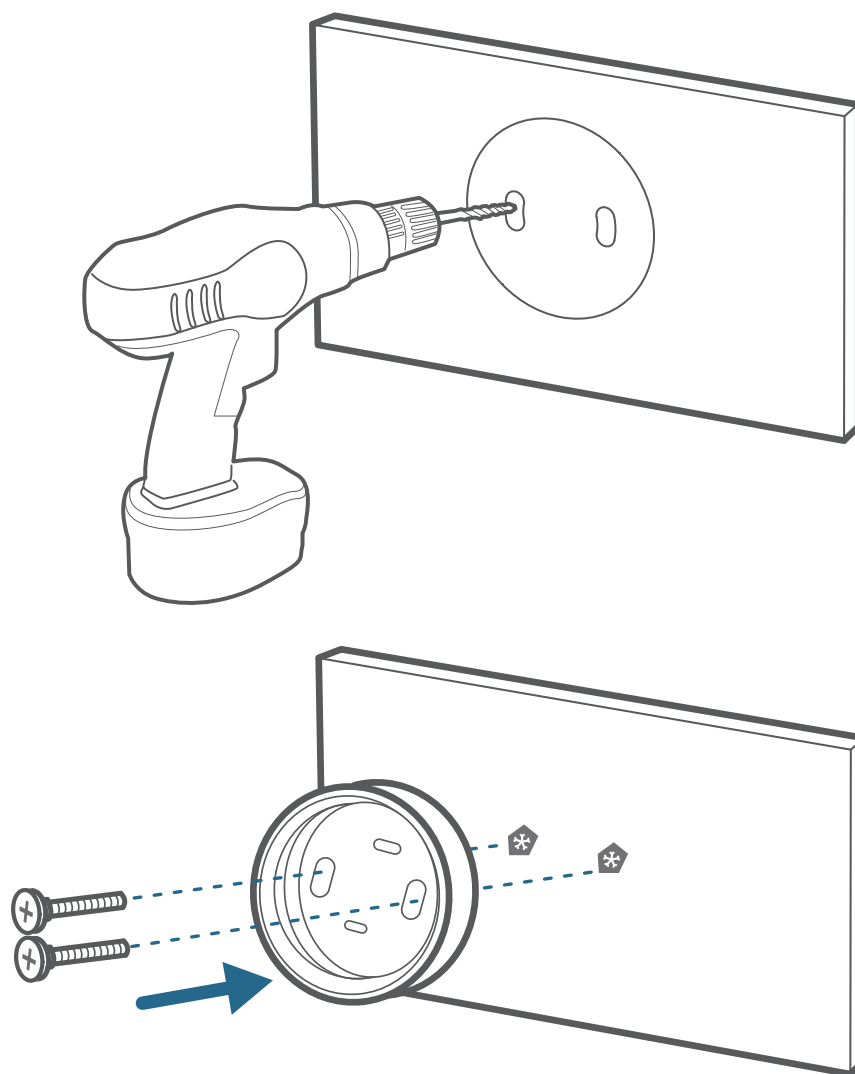

3. Firmly screw the base of the mount onto the wall.
Reassemble the mounting bracket.

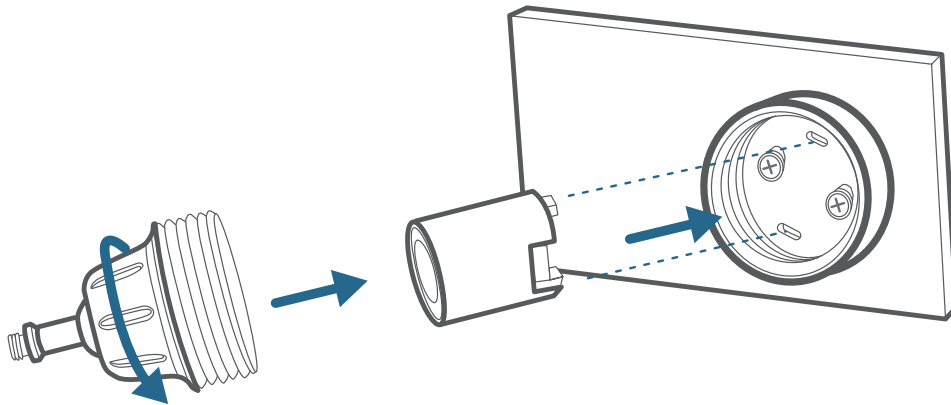

4. Screw the camera onto the mounting bracket.
Position the camera to achieve the desired view,
checking it using the live stream in the eufy Security
app.

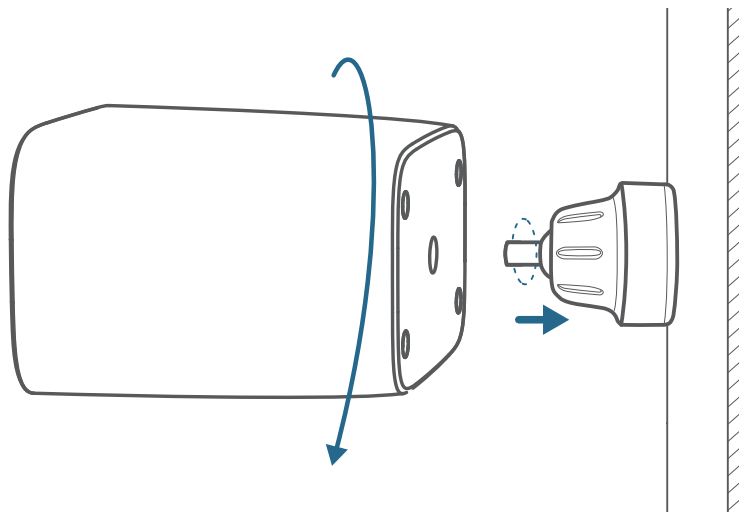



The SoloCam C210 can also be installed on the ceiling. Follow the steps above to install it. For troubleshooting, check Help on the eufy Security app. Refer to the app page for LED indicator status.

SAFETY

- The suitable temperature for devices and accessories is -20°C to 50°C (Charging temperature is 0°C to 40°C).
- Unless specifically indicated that it is safe to do so in the user guide or instruction manual, do not use this device in an environment that exceeds the recommended low or high temperature.
- Unless specifically indicated that it is safe to do so in the user guide or instruction manual, avoid exposing your device to direct sunshine or excessively wet environments.
- It is recommended to supply the device in an environment with a temperature that ranges from 5°C to 25°C.
- When supplying power, place the device in an environment that has a normal room temperature and good ventilation.



CAUTION!

THERE IS A RISK OF EXPLOSION IF AN INCORRECT BATTERY TYPE IS USED.

DISPOSE OF USED BATTERIES ACCORDING TO THEIR INSTRUCTIONS.

Warning:

- Replacing a battery with an incorrect type may bypass safeguards and create danger;
- Disposal of a battery in a fire or other source of significant heat, or by crushing, or cutting, may result in an explosion as well as leakage of flammable liquids and gases;
- Leaving a battery in an extremely hot environment may result in an explosion as well as leakage of flammable liquids and gases;
- A battery subjected to extremely low air pressure may result in an explosion as well as leakage of flammable liquids and gases.

NOTICE

 This product complies with the radio interference requirements of the European Community.

Hereby, Anker Innovations Limited declares that this device is in compliance with the essential requirements and other relevant provisions of Directive 2014/53/EU. For the declaration of conformity, visit the Web site: <https://uk.eufylife.com/>.

RF exposure information: The Maximum Permissible Exposure (MPE) level has been calculated based on a distance of $d=20$ cm between the device and the human body. To maintain compliance with RF exposure requirement, use product that maintain a 20cm distance between the device and human body.

Wi-Fi Operating Frequency Range: 2412~2472MHz;

Wi-Fi Max Output Power: 19.10 dBm

The following importer is the responsible party (contact for EU matters only)

Anker Innovations Deutschland GmbH | Georg-Muche-Strasse 3,
80807 Munich, Germany

 This product complies with the radio interference requirements of the United Kingdom.

This product complies with the radio interference requirements of the United Kingdom.

Hereby, Anker Innovations Limited declares that this product is in compliance with Radio Equipment Regulations 2017(SI2017/1206). The full text of the UK declaration of conformity is available at the following internet address: <https://uk.eufylife.com>.

Anker Technology (UK) Limited I GNR8, 49 Clarendon Road, Watford, Hertfordshire, WD17 1HP, United Kingdom



Your product is designed and manufactured with high-quality materials and components, which can be recycled and reused.



This symbol means the product must not be discarded as household waste and should be delivered to an appropriate collection facility for recycling. Proper disposal and recycling help protect natural resources, human health, and the environment. For more information on the disposal and recycling of this product, contact your local municipality, disposal service, or the shop where you bought this product.

CUSTOMER SERVICE

Kundenservice | Servicio de atención al cliente | Service client | Servizio clienti | Klantenservice | Serviço de Apoio ao Cliente | Müşteri Hizmetleri | カスタマーサポート | 고객 서비스 | خدمة العملاء



12-month limited warranty | 12 Monate eingeschränkte Garantie | Garantía limitada de 12 meses | Garantie limitée de 12 mois | Garanzia limitata di 12 mesi | 12 maanden beperkte garantie | 12 meses de garantia limitada | 12 aylık sınırlı garanti | 通常保証 18 ヶ月 (延長あり) | 12 개월 제한 보증 | أرش 12 قتمل دودحم نامض



(US) +1 (800) 988-7973
(UK) +44 (0) 1604 936200
(DE) +49 (0) 69 9579 7960
(中国) +86 400 0550 036
(日本) 03 4455 7823
(AU) +61 3 8331 4800
(Egypt) +20 8000000826
(UAE) +971 8000320817
(Kuwait) +965 22069086
(Saudi Arabia) +966 8008500030



support@eufy.com

Anker Innovations Limited

Room 1318-19, Hollywood Plaza, 610 Nathan Road, Mongkok,
Kowloon, Hong Kong



@EufyOfficial



@EufyOfficial



@EufyOfficial



Anker Innovations Limited. All rights reserved. eufy Security and eufy Security Logo are trademarks of Anker Innovations Limited, registered in the United States and other countries. All other trademarks are the property of their respective owners.

PAP 22
Raccolta Carta

51005004028 V1