

# ACTIVESHOP®

## Instructions for use

Marathon Handy 700/702 milling machine

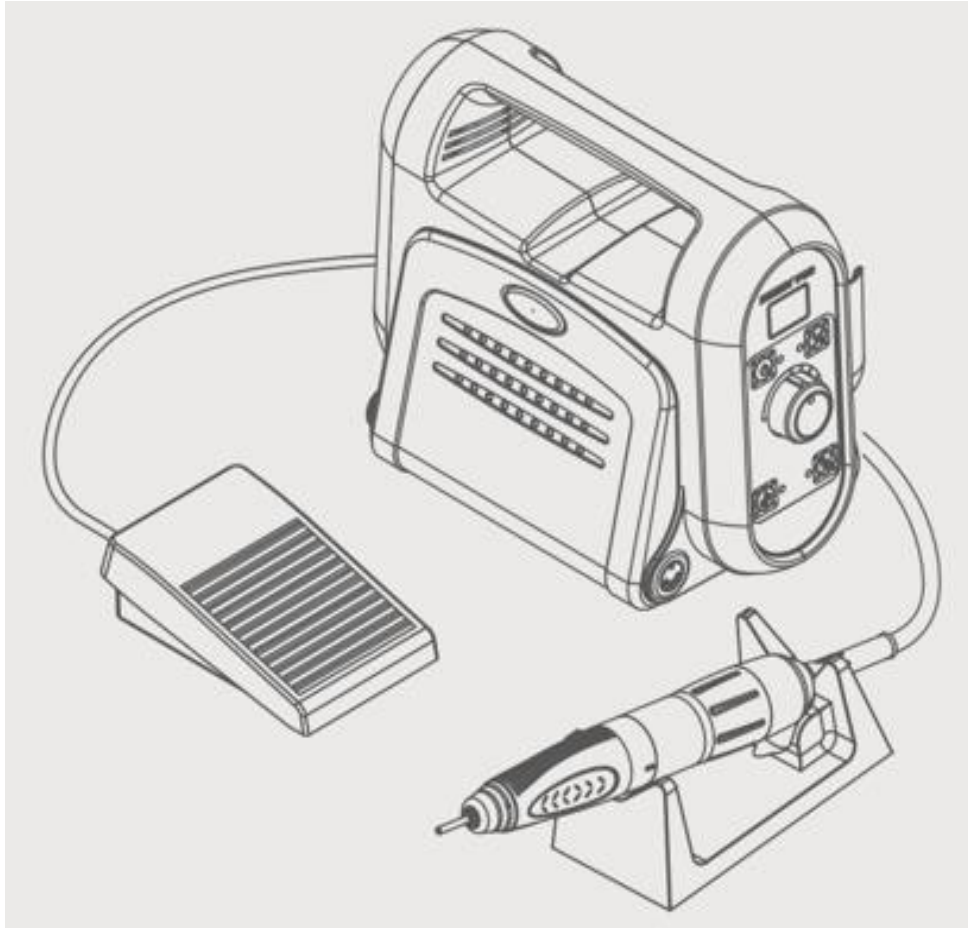

Importer:  
ACTIVESHOP SP. Z O.O.  
ul. Graniczna 8b, building  
DC2A 54-610 Wrocław,  
Poland  
[www.activeshop.com.pl](http://www.activeshop.com.pl)  
Rev. A/09/2023



Prosthetic milling machine offers high power (100W) and quiet operation. It provides high speed. The milling machine is equipped with a noise reduction system to reduce noise by 20%, compared to other models. The design of the base is ergonomic, with a practical carrying handle.

#### Technical data:

- power supply: 200-240 V/50-60Hz
- ergonomic housing
- right and left-hand rotation
- on/off switch and speed control in the base
- stepless speed adjustment from 1000 to 50 thousand for Handy 700 model (1000 to 45 thousand for Handy 702 model)
- twist-lock handle (change of cutter with one movement)
- magnetic strip for cutters
- AUTO CRUISE function (sets a constant desired speed)
- self-diagnosis function (supervises correct operation)
- the set is sold only with a brushless head (Handy 700)

#### Construction scheme

Head with brushless motor

Head with brush motor

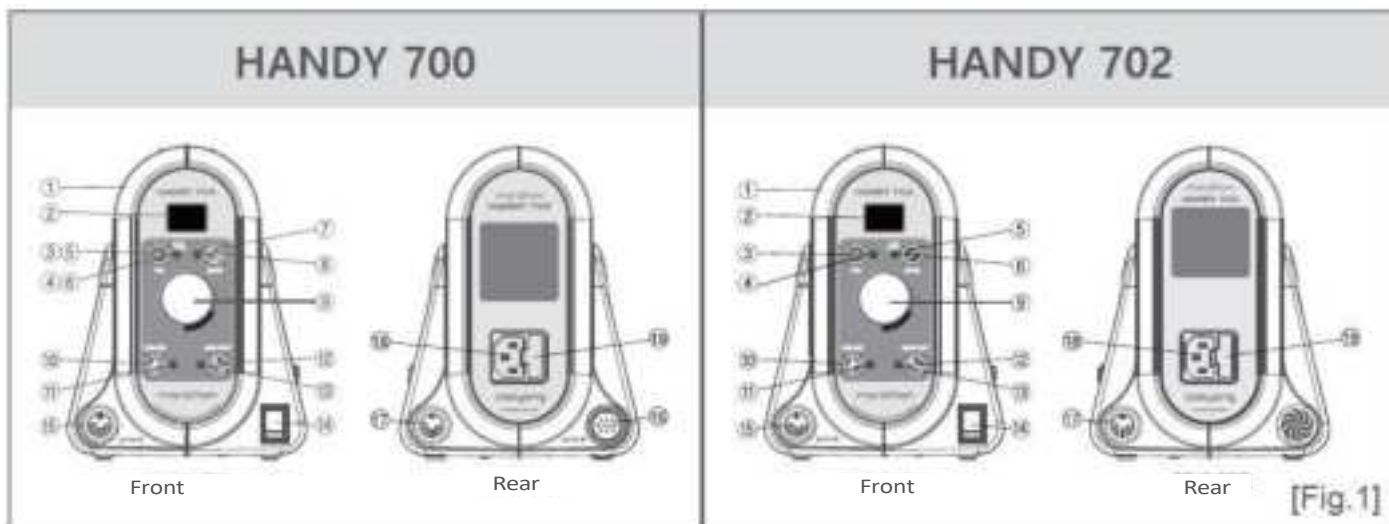

- |                                    |                            |  |
|------------------------------------|----------------------------|--|
| 1. Control unit                    | 12. Hand/leg switch        | 25. Kit head holder Kit head               |
| 2. Speed display                   | 13. Hand/leg selection LED | cable                                      |
| 3. Switch                          | 14. Power switch           | 26. Head stand                             |
| 4. Engine running light            | (power light)              | 27. Head stand                             |
| 5. Cruise control switch           | 15. DC motor connector     | 28. Head wrench                            |
| 6. Cruise control LED              | 16. Kit head connector     | 29. Nut wrench                             |
| 7. Engine selector switch          | 17. Foot switch connector  | 30. Head wrench                            |
|                                    | 18. Power connector        | 31. Foot switch                            |
| 8. Engine selection LED            | 19. Fuse holder            | 32. Cable                      foot switch |
| 9. Speed control knob              | 20. Test cutter            | 33. Power cable                            |
| 10. Left/right direction selection | 21. Cutter holding grip    |  |
| switch                             | 22. Optional head holder   |  |
| 11. Left/right direction selection | 23. Optional head cable    |  |
| LED                                |                            |  |

### Complete set

- Control unit, power cable
- Head, screw, washer
- Head stand (optional)
- Foot switch (optional)
- Tools (optional)



### Power input

Check the electrical system nameplate (AC100-120V, 50/60Hz or AC200-240V, 50/60Hz) located on the back of the control unit. [Fig.4]



### CAUTION!

- Never connect or disconnect the power cord with wet hands to avoid electric shock.
- Use only a grounded AC outlet.

### Installation and electrical connection

#### CAUTION!

The control unit should rest on a flat, stable surface. Avoid blocking the openings ventilation holes in the bottom of the housing.

Use the control unit in places with temperatures in the range of 0 to 40°C. Avoid excessively dusty, hot or humid places.

1. Attach the head bracket (27) to the right side of the control unit with a screw and washer. [Fig. 7] (optional)
2. For Handy 702: Connect the head cable (25) to connector (15), which is located on the front of the control unit. [Fig.8]
3. For Handy 700: Connect the BLDC motor cable (23) to the BLDC motor connector (16) located at the rear of the control unit, and then tighten the connector nut. [Fig.9]
4. Connect the foot switch cable (32) to the foot switch connector (17) located at the rear of the control unit.
5. Connect the power cable to the power connector at the rear of the control unit. (Fig. 9)

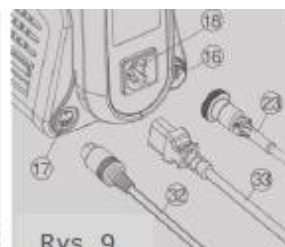

### WARNING

- Before connecting the power cord, make s u r e that all wires are properly and securely connected and that the power switch is turned off.

## Operating Instructions

- 1) Turn off the power supply.
- 2) Plug the power cord into an electrical outlet. ⑧
- 3) Set the speed control knob to the lowest position. 4) Turn on the power supply. ⑭
- 5) Handy 700: Select head A (optional head) or B (set head) by pressing motor selection switch ⑦. **The head selection LED lights orange for the kit head.**
- 6) Select the direction of rotation by pressing the left/right selection switch ⑩.

## Operation in manual mode

- 1) Press the hand/leg switch ⑫ to "HAND." The hand/leg selection LED ⑬ will turn green.
- 2) Press the motor operation switch ③ to start the motor. The motor operation LED ④ will light up green.
- 3) Set the speed control knob ⑨ to the desired speed.
- 4) The motor stops when the motor operation switch ③ is pressed again. The motor operation light ④ is turned off.

## Foot mode operation



- 1) Press the hand/leg switch ⑫ to "FOOT." The hand/leg selection LED ⑬ lights up orange, the LED on the head ④ lights up green.
- 2) Set the speed control knob ⑨ to the desired maximum speed.
- 3) Press the foot switch ⑪ to start the engine.



## Cruise control mode

When the foot switch is used, the Auto Cruise function allows you to maintain speed when you remove pressure from the foot switch. Activate by pressing the switch auto cruise ⑤ and holding down the foot switch with equal pressure for 2 seconds. Deactivate by pressing the foot switch.

## NOTE

Do not exceed the maximum operating speed of the control unit, because its operation at too high a speed can cause damage to the head, as well as personal injury.

Before turning off the power switch, it is essential to make sure that the motor is stopped. When the unit is not in use, unplug the power cord for maximum safety.

## Handling the micromotor tip

### Inserting or removing the cutter

The cutter can be replaced by turning the head holder clockwise. After replacing the cutter, the head holder must be turned counterclockwise to be held securely. [Fig. 13]

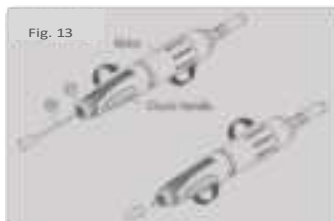

## NOTE

Use only recommended cutters.

Always remove dirt before replacing cutters.

After replacing the cutter, make sure the collet is securely fastened before starting the engine.

DO NOT try to adjust the head chuck while the motor is running to prevent damage to the machine. When the micromotor tip is not in use, it is recommended to leave the cutter in the chuck.

Always place the head on the head stand (26) or head stand (27) when not in use. Take special care not to drop it on the floor.

Thoroughly clean the collet and cutter holder before reassembling. Clean at least once a week to extend the life.

When disassembling, take special care to keep the handle and motor free of dirt. The spindle and motor should only be disassembled by a qualified repair facility.

### Permissible rotational speed

The table shows the maximum rotational speed (Rotation Speed (RPM)) of conventional cutters. The allowable speed may vary slightly depending on materials or cutter types.

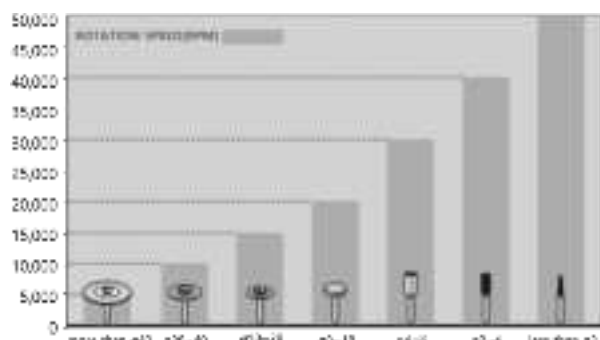

Make sure you do not exceed the maximum RPM specified by the manufacturer or distributor of the cutter you are using. Large cutters, even running below the maximum rated speed, may begin to vibrate. Speed should be reduced immediately to prevent damage to the cutter, head or operator.

Always use a good quality cutter.

Remember to insert the cutter shank all the way in until it touches the back of the collet holder.

Then tighten the collet. If the cutter is used when it is not fully inserted, it is very dangerous, because vibration can cause it to slide out and damage the head.

### Technical data Error code

Error code	Status	Cause
"1E"	Motor sensor error	One or more Hall sensors are defective. Motor cable is disconnected or damaged. The motor cable is damaged.
"2E"	Motor lock error	Twist-lock handle is open. The head is mechanically damaged. The head is electrically damaged.
"4E"	Overvoltage detection error	1 The circuit of the control unit is defective.
"5E"	Overheating error	The control unit has been excessively operated under heavy load for too long. The control unit has been exposed to an excessively hot environment. The air openings are blocked. The temperature sensor is defective.

"6E"	Overdrive error	1 The unit was operating under a heavy load load or was suddenly stopped after startup.
------	-----------------	---

### Troubleshooting

Problem		Checkpoints	Actions
The power light is not on.		Make sure the power cord is properly connected to the outlet and the control unit.	Connect the power cord correctly.
The motor does not operate.	"1E" is displayed.	Check that the motor cable is properly connected.	Connect the motor cable correctly. If the same error is constantly displayed, Replace the motor cable.
	"2E" is displayed.	Check whether the collet holder is open.	If it is open, close the collet chuck.
	"4E" is displayed.	The circuit of the control unit is defective.	Return the unit for repair.

The motor does not work.	"5E" is displayed.	Check whether the control unit has not been used for a long time with a heavy load.	Restart the control unit after it has been stopped for about 10 minutes.
		Check that the temperature of the work area is not too high.	If it is too warm, move the control unit to a place where the internal temperature is 0~40 .°C
		Check that the air opening is not blocked.	Unblock the air opening.
		The temperature sensor is defective.	Send the unit for service.
	"6E" is displayed.	Check that the control unit has not been used excessively under heavy load conditions.	Press the auto cruise control switch or turn off, then turn on, then press the head switch. If the same error is still displayed, send the device for service.
		Check whether the collet chuck is open.	If it is open, tighten it by turning the head handle.
		Check whether the shaft of the tip of the micromotor can rotate freely.	If it cannot be rotated with the closed chuck, the base of the micromotor tip is defective. Send device for service.
The foot switch does not work.	Make sure the foot switch cable is properly connected.		Connect the foot switch cable correctly.
	The hand/feet switch is set to "HAND".		Set the hand/feet switch to " FOOT".
The head overheats during operation.	Ball bearings are damaged.		Send the device for service.
The head vibrates excessively and is extremely noisy.	Make sure the collet is free of dirt.		Clean the collet thoroughly.
	The rotational speed is too high.		Reduce the rotational speed. Refer to the table "Permissible rotational speed."
	Check whether the cutter shaft is in good condition.		Replace it with a new one.
	Make sure the ball bearings are in good condition.		Send the unit for service.

## Specifications

### Control unit

Model name	Input	Weight	Size	Head type
HANDY 700	AC 100~120V 50/60Hz	2,7 kg	137(szer.)x232(dł.)x180(wys.)	Brushless motor
HANDY 702	AC 200~240V 50/60Hz	1,9 kg		Brush motor



## **NOTE!**

Change the cutter after turning off the milling machine with the switch. Turning the speed control potentiometer to the minimum does not turn off the milling machine, but only reduces its speed to the minimum (invisible to the naked eye). Changing the cutter on the switched-on milling machine at minimum RPM can cause overheating of the head, and consequently damage (not covered by the warranty).

## **CAUTION!!!**

Do not soak the heads. Do not disinfect with excessive amounts of liquid. Water or disinfectant liquid (non-alcoholic) getting inside the head, may damage it. Before possible disinfection, remove dust from the head.

It is recommended to maintain the head with dedicated fluids.

## **SAFETY MEASURES**

1. The device is a professional equipment for use in beauty parlors. Operation of the device only by qualified cosmetic personnel allows you to avoid undesirable consequences during the procedure.
2. Do not disassemble the device or attempt to use it for purposes other than those indicated in this manual. All service work and repairs must be performed only by an authorized service technician (ACTIVESHOP Sp. z o.o. company).
3. Do not install or operate the device near liquids, wet places or with wet hands - so that no liquids get into the device.
4. Immediately unplug the device from the outlet and contact an authorized service provided by ACTIVESHOP Ltd. in the following cases: a) liquid has entered the device, b) the device emits a strange odor, smoke or makes strange sounds, c) the power cord has been damaged, d) the device has been knocked over or its housing has been damaged.
5. Do not lay any objects on the cables. Do not install the device where someone may step on the power cord.
6. For safety purposes, unplug the power cord from the outlet each time you finish working with the device.
7. Do not insert anything into the opening of the device. If a foreign object gets into the hole, remove the cord from the outlet and contact the distributor or manufacturer.
8. Do not place the device on an unstable cart, shelf or vehicle. If dropped, the device may be damaged.
9. In order to guarantee the established useful life of the device, it is recommended to keep an interval of one minute before pressing the power button again (between switching on and off and vice versa).
10. The power supply must comply with the specifications on the nameplate. Otherwise, there is a risk of incorrect operation of the device its damage and even burning.

## **CAUTION:**

1. In the event of damage to the power cord or other malfunctions, contact an authorized service center - this will avoid danger.
2. This device can be used by children at least 8 years of age and by people with reduced physical and mental capabilities and those with inexperience and lack of familiarity with the equipment, if supervision or instruction on how to use the equipment in a safe manner is provided, so that the associated risks are understood.
3. The equipment is not intended for play by children. Do not allow children to play with the equipment.
4. Do not leave the equipment unsupervised when children or persons without sufficient knowledge of the use of the equipment are near it.
5. This electrical appliance is not a toy. Incorrect use or contact with the electrical appliance may pose a health risk or lead to death, so use and store the appliance out of the reach of children.



### **DISPOSAL OF THE DEVICE**

Dispose of used electrical appliances, fixtures and packaging to raw material reprocessing centers in accordance with environmental protection principles. Do not dispose of electrical appliances in household waste containers. Follow the rules for discarding this type of equipment. In order to protect the environment in accordance with Directive 2012/19/EC

concerning waste electrical and electronic equipment

used electrical and electronic equipment should be collected separately, and then handed over to collection centers for used electronic and electrical equipment.

At the end of their useful life, as well as old devices contain full-value recyclable components, so they should be handed over for recycling. Therefore, they should be handed over to appropriate collection points, as well as they can also be handed over to ACTIVESHOP Ltd.

### **STORAGE AND TRANSPORT**

The device should be transported at a temperature in the range of (-) 20°C to (+) 40°C only in its original packaging. Store the device in a well-ventilated room and a relative humidity of no more than 90%. Operating temperature from (+) 10°C to (+) 40°C. During storage and transportation processes, the device must not be thrown or dropped, exposed to mechanical shocks or atmospheric agents.