

***MAGICSHINE***

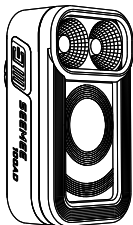

# **SEEMEE 100AD**

## USER MANUAL



## **WARNING!**



1. To prevent inadvertent switching on, please keep the light unit in lockout mode before transport or storage.
2. DO NOT disassemble, modify, remanufacture, puncture, or damage the device or batteries.

## **IN THE BOX**



USB-C  
charging cable



SEEMEE 100AD    Saddle mount    Seat post mount

## QUICK GUIDE

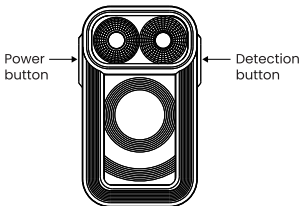

## PELOTONSYNC FLASH MODE

When two or more SEEMEE 100AD taillights come close and flash in the same pattern, they automatically switch to PelotonSync Flash mode. Click the power button to exit PelotonSync Flash mode and switch to other modes. (Note: Taillights in detection alert flash mode cannot simultaneously enter PelotonSync Flash mode.)

## DETECTION ALERT FUNCTION

### DETECTION ALERT FUNCTION ON/OFF:

1. When the taillight is on, the detection alert function is activated by default.
2. The detection alert function can be turned on or off separately. Click the detection button to turn it on, and the blue indicator is constantly on. Click the button again to turn it off, and the blue indicator will no light up.

### Note:

1. When the detection alert function is activated, the taillight automatically detects approaching vehicles within 25 meters from behind and alerts with a rapid 100-lumen flash. The taillight will return to the previous lighting mode when no vehicle is detected within range.
2. If both detection alert flash mode and PelotonSync Flash mode are activated, the taillight enters detection alert flash mode when detecting a vehicle. As the vehicle comes within 5 meters, the taillight switches to PelotonSync Flash mode.

## **POWER BUTTON INSTRUCTIONS**

### **ON/OFF:**

Press and hold the power button for 1 second to turn the taillight on/off.

### **CHANGE MODE:**

When the taillight is on, click the power button to cycle through Low→High→Night Flash→Day Flash→Eco Flash→Low...

### **LOCKOUT:**

When the taillight is off, press and hold the power button for 3 seconds to enter lockout mode.

### **UNLOCK:**

In lockout mode, press and hold the power button for 3 seconds or charge the taillight.

### **MEMORY FUNCTION:**

When the taillight is turned on again, it will automatically turn to the last selected lighting mode.

## **FTR LIGHTSYNC CONTROL FUNCTION:**

After the remote control is successfully paired with the front and tail lights, press and hold the "○" or "□" button on the remote for 1 second to turn on/off the front and tail lights simultaneously.

Note: 1. The front and tail lights to be paired should support the FTR LightSync Control function, and the remote control cannot be paired separately with a tail light. 2. The remote control and front lights are sold separately. 3. To pair the remote control with the front and tail lights, please refer to the instructions for the MJ-6558 remote control.

## **LOW POWER MODE:**

When the remaining battery power is below 10%, the taillight will change to Eco Flash mode. During this period, the detection alert function is deactivated.

## OUTPUT / RUNTIME

LOW	12LM	7h
HIGH	30LM	3.5h
NIGHT FLASH	12-30LM	6.5h
DAY FLASH	0-100LM	9h
ECO FLASH	0-6-0-6-20LM	18h
DETECTION ALERT FLASH	30-100LM	/

\*All data are measured in accordance with ANSI/NEMA FL 1-2009. The test was conducted at a temperature of 25°C and a wind speed of 25 km/h. The runtime may vary depending on external temperature and ventilation conditions, and these deviations may affect the result of testing.

\*The stated runtime of each mode excludes the detection alert function. When the detection alert function is activated, the runtime will vary depending on the flashing frequency of the detection alert.

## CHARGING / BATTERY INDICATOR

Standard charging time approx. 1.5 hours (5V 1A)

**Charging:** Flashing red

**Fully charged:** Constant green

## BATTERY INDICATOR

When the taillight is off, click the power button to display the remaining battery level for 3 seconds.

100%-21%: Constant green

20%-11%: Constant red

10%-1%: Flashing red



## HOW TO INSTALL

### 1. INSTALL ON SEAT POST

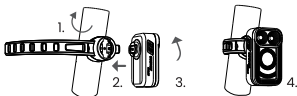

### 2. INSTALL UNDER SADDLE

