



## Quick Start Guide

WiFi 6 Outdoor Mesh Router/AP/Repeater



[www.wavlink.com/en\\_us/AERIAL-HD6](http://www.wavlink.com/en_us/AERIAL-HD6)  
Scan the QR code or load the link for Quick Start Guide downloading

AERIAL HD6



WAVLINK (@WavlinkOfficial)  
WAVLINK SUPPORT (@WavlinkTechSupport)

### Hardware Overview

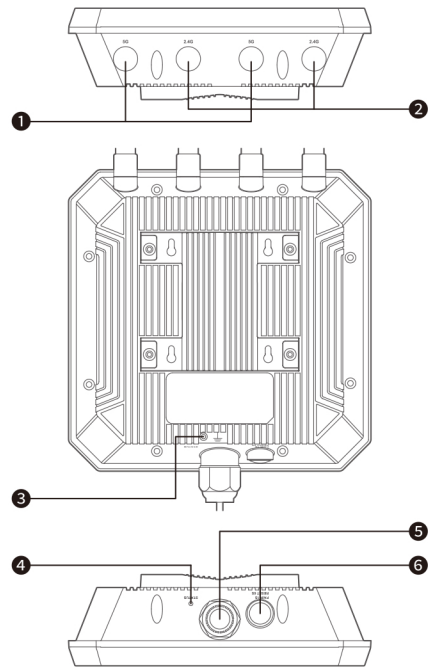

- 1 5G Antenna
- 2 2.4G Antenna
- 3 Grounding Terminal
- 4 Status LED
- 5 WAN/LAN Port (PoE)
- 6 Pair/Reset Button

01

### Reset Button

Press and hold for 6 seconds to restore the device to default settings.

### Pair Button

Press and hold for 1 second to pair with the existing EasyMesh Wi-Fi system.

### Default Parameters

2.4G SSID: WAVLINK-AX\_XXXX Default Login Password: admin  
5G SSID: WAVLINK-AX\_5G\_XXXX Official Website: [www.wavlink.com](http://www.wavlink.com)  
Default IP: 192.168.10.1 Technical Support: [support@wavlink.com](mailto:support@wavlink.com)  
Login: <http://waplogin.link>

### LED Indicator

Mode	LED Status	Description
Router mode	Slow blinking	No Internet/The device is in pair.
	Solid on	The device has connected to the Internet.
Repeater mode	Slow blinking	The device has connected to the upstream router but no access to the Internet.
	Solid on	The device has connected to the upstream router and the Internet has been connected.
	Fast blinking	The device has not connected to the upstream router.
Agent mode	Slow blinking	The device has connected to the upstream router but no access to the Internet.
	Solid on	The device has connected to the upstream router and the Internet has been connected.
	Fast blinking	The device has not connected to the upstream router.
AP mode	Solid on	The device has connected/disconnected to the Internet.

02

### Installation

#### 1. Assembly

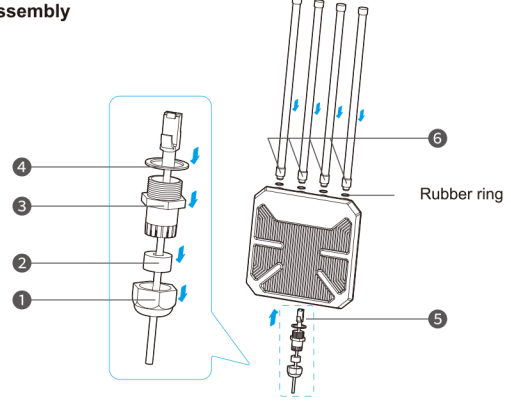

- Pass the RJ45 cable through the waterproof connector cover.
- Screw the waterproof seal into the waterproof connector bracket.
- Pass the RJ45 cable through the waterproof connector bracket, and screw the waterproof connector bracket into the cover.
- Put the waterproof sealing ring on the waterproof connector bracket.
- Connect the RJ45 cable to WAN/LAN port.
- Screw the connecting cable into the 2.4G and 5G antenna connector and screw up the connector.

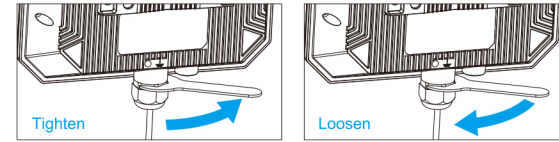

Note: Turn the wrench counterclockwise during assembly to tighten the bracket; Turn the wrench clockwise to loosen the bracket during disassembly.

03

#### 2. Installation

- Fix the device to the post with cable ties, or fix the device to the wall with screws, then follow the assembly step to install.

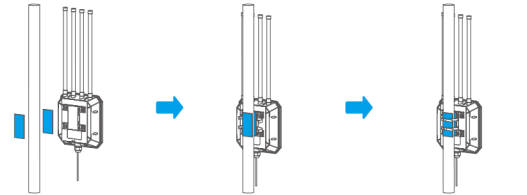

Step 1: Stick two silicone pads on the bracket and post respectively.

Step 2: Thread the cable ties through the fixing point of the bracket.

Step 3: Fix the product to the post with cable ties.

Note: If it is installed in an area where lightning occurs frequently, we recommend you to install the device via a ground connection to strengthen the lightning protection function.

#### 2.2 Connection

- Passive PoE
- (1) Wired(For Router/ AP Mode)

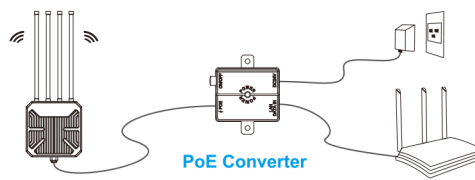

04

#### (2) Wireless(For Repeater/Mesh Agent Mode)

- Connect the "PoE" port of the PoE converter with an Ethernet cable to the WAN/LAN port of the device.
- Connect the "LAN DATA IN" port of the PoE converter via another Ethernet cable to a "LAN" port on your router. If you choose to connect to the superior wirelessly, please ignore this step.
- Plug the power plug into the "DC IN(37-57V)" port of the PoE converter, and then plug the power adapter into a power outlet.

#### 2.2.2 Active PoE (For AP/Router Mode)

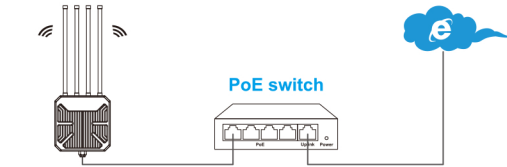

#### Attention:

- Make sure you are using a certified CAT5e/CAT6 Ethernet cable with RJ45 connectors.
- Make sure the Ethernet cable length is less than 100 meters(328 feet).
- If it is fixed on the post, the length of the post must be less than the length of the cable ties.

05

### Configuration

#### 1. Connecting to PC

##### 1.1 Via Wireless

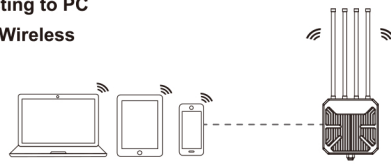

- Disconnect the Ethernet cable from your computer (if you have one).
- Turn on your WiFi, find the SSID of this product on your wireless devices(smartphone, tablet computer, laptop, et.) and place a connection.



##### 1.2 Via Cable

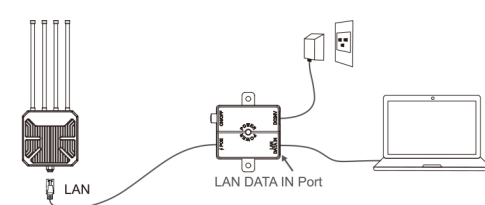

06

- Connect the Ethernet cable to your PC/Laptop and the LAN DATA IN port of your PoE converter, then you can start the configuration of the device.

If you are using the AP/Router function of this device, please connect the LAN DATA IN Port to the LAN port of the upper router after finishing 4.1 and 4.4.

- When the router is connected to your devices at its first time, the login page will pop up, you also can enter 192.168.10.1 or [waplogin.link](http://waplogin.link) into the address bar of browser of your PC/laptop or phone. The default password is admin.



- Select your Country/Region and Time Zone. For your network security, we suggest that you set a new login password, and click Next.

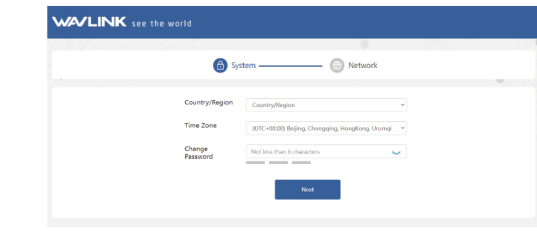

Note: The three colored bars in "Change Password" area indicates the strength of the login password.

07

#### 4. Mode Selection

This product has 4 modes.

##### 4.1 AP Mode

- The system selects AP mode by default SSID, there is no need to select the AP mode manually. Click on "Next".
- Connect the WAN/LAN port of this product to the higher-level. Then you can change the SSID or use the default one, the encryption mode recommended is WPA2-PSK. For your network security, please create a new password according to the rule. Then click on "Save" and wait for the setting process to complete.

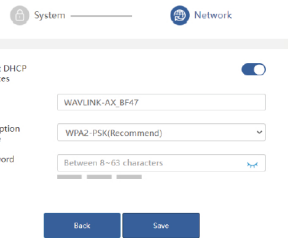

##### 4.2 EasyMesh Agent Mode

If you have a router that supports EasyMesh function, then you can build a mesh system with this mode. Please configure according to the following steps:

- Log in to 192.168.10.1 or [waplogin.link](http://waplogin.link).
- Click "Switch Mode", please choose "EasyMesh Agent Mode".
- Click on the "Save" button.
- Enter the Pair Key for this device in the mesh network of the main router, or you can separately keep pressing the Pair button on the main router and sub-router for 1 second.



Note: If you are not sure how to start, please ask manufacturer for help.

08

#### 4.3 Repeater Mode

- Click "Switch Mode" and select Repeater Mode.
- After scanning, please make sure the Wi-Fi you want to select is listed, and click "Next", if it isn't, please click "Rescan".

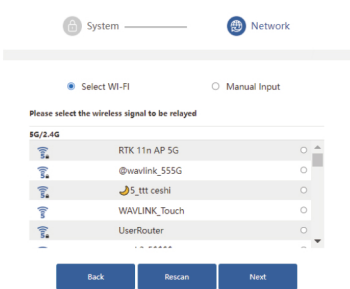

- Enter the password for the wireless network of your selected. Set the wireless network encryption mode and password for this device. Click "Save".

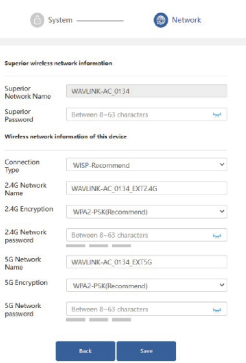

09

#### Manual Input:

- Manually add the wireless network you want to relay, enter the device information, and click "Next".

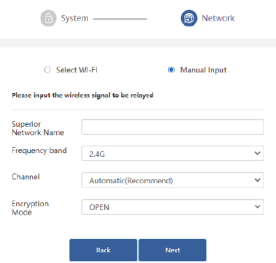

- Set the wireless network encryption mode and password for this device. Click "Save".

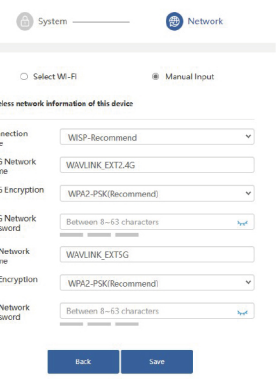

10

#### 4.4 Mesh Router Mode

- Click on "Switch Mode", then choose "Mesh Router Mode".
- Before configuring, please make sure your upper router has connected to the WAN/LAN port of this product. The system will guide you to select the WAN Type. As for the Encryption Mode, we recommend you to select WPA2-PSK. For your network security, we suggest you create a Password.

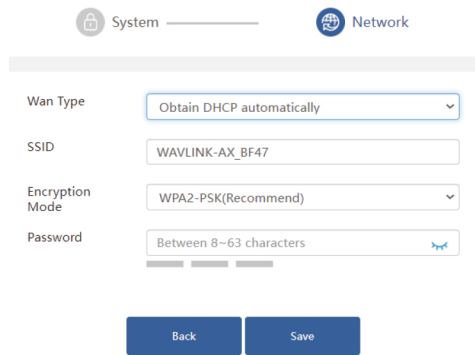

#### Which WAN Type am I supposed to choose?

If you use DSL line and you are only provided an account name and a password by your ISP, choose PPPoE. If you use cable TV or fiber cable, choose DHCP(Dynamic IP). If you are provided information such as IP address, Subnet Mask and Default Gateway, choose Static IP.

### Wi-Fi Password Management

When you need to change your Wi-Fi password, please click on "Wireless".

11

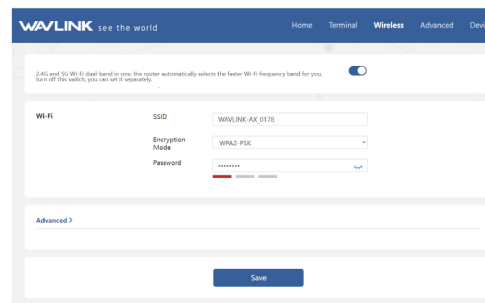

### Firmware Upgrade

If you need to update firmware, please proceed as the following steps:

#### Option I

- Download the latest firmware file on Wavlink website ([www.wavlink.com->SUPPORT->Firmware](http://www.wavlink.com->SUPPORT->Firmware)).
- Extract the firmware from the downloaded file.
- Log in to [waplogin.link](http://waplogin.link) or 192.168.10.1, then choose "Advanced" and select "Firmware Update".

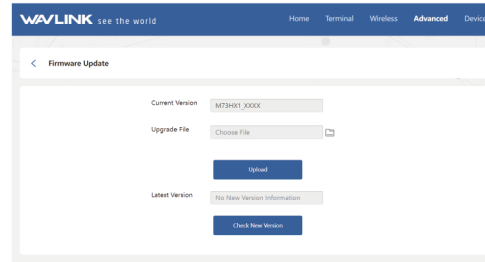

12

- Click on the firmware file to locate the firmware file.
- Click on "Upload" and choose "Apply", and wait for the firmware upgrade process to complete.

#### Option II

- Log in to 192.168.10.1 or [waplogin.link](http://waplogin.link), then choose "Advanced" and select "Firmware Update".
- Click on "Check New Version" to find the latest version.
- Click on "Download and Upgrade", and wait for the firmware upgrade process to complete.

Note: After updating firmware, please Reset The Device And Clear Your Browser Cache.



### More Mesh Devices

Generally, a mesh router device supports up to 7(including the existing device). Therefore, if you need to add more mesh devices to build up a stable network in your home, you simply need to pair the new mesh devices with the existing network.

- Log in to [waplogin.link](http://waplogin.link) or 192.168.10.1.
- "Advanced" -> "Mesh Network".
- You can add extra devices by entering their "Pair Key", and the sub-routers must be Mesh Agent Mode. You also can add extra devices by separately keeping pressing the Pair button for 1 second on the main router and sub-router after setting the sub-router as EasyMesh Agent Mode.

13

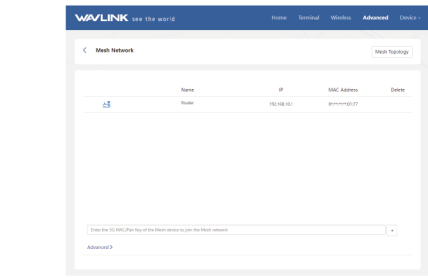

### FAQ

#### Q1. Why doesn't the login page appear after entering <http://waplogin.link>?

- If your computer is wirelessly connected, please verify that you have connected to the device's SSID. If your computer is connected via an Ethernet cable, please verify that the connection is stable.
- Make sure your computer is set to obtain an IP address automatically.
- Use the IP address to log in to the page. The default IP is 192.168.10.1. If the device is connected to the host Wi-Fi, please go to the router's DHCP client list to obtain the device's current IP address.
- If the problem still exists, please reset the device again.

#### Q2. How do I restore the device to its factory default settings?

- While the device is powered on, press and hold the Reset Button until all the LEDs turn on momentarily.

#### Q3. What should I do if the LED does not change to solid after completing?

- You may have entered the incorrect Wi-Fi password of your host Wi-Fi during the configuration. Please log into the device's web-based interface to check the password and try again.
- Reset the device and go through the configuration again.

14

### GNU General Public License Notice

This product includes software codes developed by third parties. These software codes are subject to either the GNU General Public License (GPL), Version 2, June 1991 or the GNU Lesser General Public License (LGPL), Version 2.1, February 1999. You can copy, distribute, and/or modify in accordance with the terms and conditions of GPL or LGPL.

The source code should be complete, if you want us to provide any additional source code files under GNU General Public License (GPL), please contact us in these matters. We are committed to meeting the requirements of the GNU General Public License (GPL). You are welcome to contact our local office to get the corresponding software and licenses. Please inform us of your contact details (full address) and the product code. We will send you a software package with the software and license for free.

The respective programs are distributed WITHOUT ANY WARRANTY; without even the implied warranty of MERCHANTABILITY or FITNESS FOR A PARTICULAR PURPOSE.

Please refer to the GNU General Public License website for further information.

<http://www.gnu.org/licenses/old-licenses/gpl-2.0.html>

<http://www.gnu.org/licenses/lgpl.html>

#### WEEE Directive & Product Disposal

At the end of its serviceable life, this product should not be treated as household or general waste. It should be handed over to the applicable collection point for the recycling of electrical and electronic equipment, or returned to the supplier for disposal.

15