



MASINGO

It's a karaoke

party

all night long

Karaoke Machine *Lento X5*

# USER MANUAL

# MASiNGO

## Performer's Manual



Karaoke Machine - Lento X5

# ***Congratulations!***

## **You've just taken your party game up a notch**

---

Whether you're celebrating with a few friends or with the whole gang—in the comfort of your home or in a big event space—your parties will be peppier with this beautifully-designed, comprehensive **Lento X5 - Karaoke Machine** from Masingo.

Choose from Bluetooth, AUX, FM, USB, or MicroSD and get the music going—or just connect to your TV. Sing out some show tunes with grandma, blast out some big hits with your pals, or serenade your sweetheart. Use the invigorating LED lights to set the stage as you belt out your best into one of our top-quality karaoke microphones. You can even adjust your volume and vocal effects to enhance your performance. No matter what your skill level, this box of magic is sure to delight vocalists of all ages—from 5 to 125.

Need to send out some announcements during your big bash? No problem! This portable, multi-functional machine doubles as a punchy PA system. Simply turn off the music and speak into the mic for volume-adjustable, crystal-clear announcements.

When all is said and sung, just turn off the machine. In no time at all, you'll be ready for an encore.

**Sing on!**

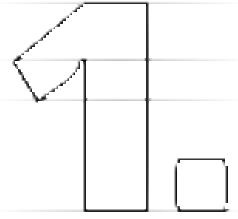

# ***It's the whole package!***

## Parts & features

### What's included...

- |   |                                  |
|---|----------------------------------|
| 1x Masingo Karaoke Machine              | 1x Collapsible mic stand (6 pcs) |
| 2x Wireless microphones                 | 1X Mic pole                      |
| 1x Carry straps                         | 1X Triangular bracket            |
| 1x Device holder (2 pcs)                | 2X Bendable mic arms             |
| 1x Micro-USB charging cable             | 2X Mic clips                     |
| 1x USB charger plug                     | 1x Disco ball (7 pcs)            |
| 1x 3.5 mm AUX cable                     | 1X Disco ball                    |
| 1x 3.5 mm AUX - RCA cable               | 1X Disco ball clasp              |
| 1x 15V2A charging cable                 | 2X Side screws                   |
| 1x Large cable clip for disco ball wire | 1X Stand clip screw              |
| 1x Small cable clip for disco ball wire | 1X Stand clip                    |
| 1x Machine remote control               | 1X Power plug                    |
| 1x Disco ball remote control            | 1x Performer's manual            |

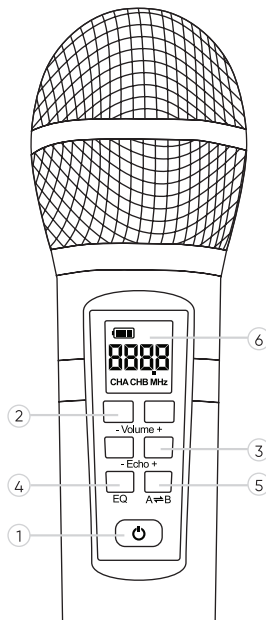

1. On/Off
2. Volume +/-
3. Echo +/-
4. Equalizer
5. A-B (frequency)
6. LED Display

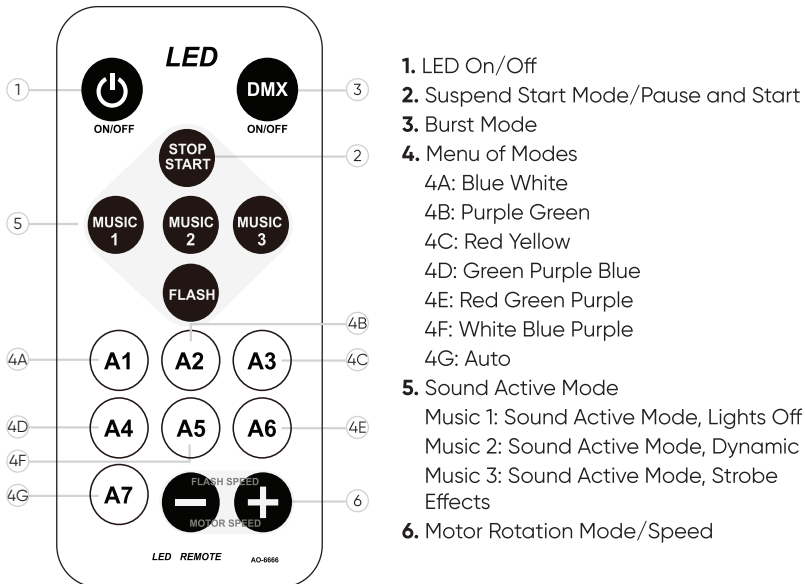
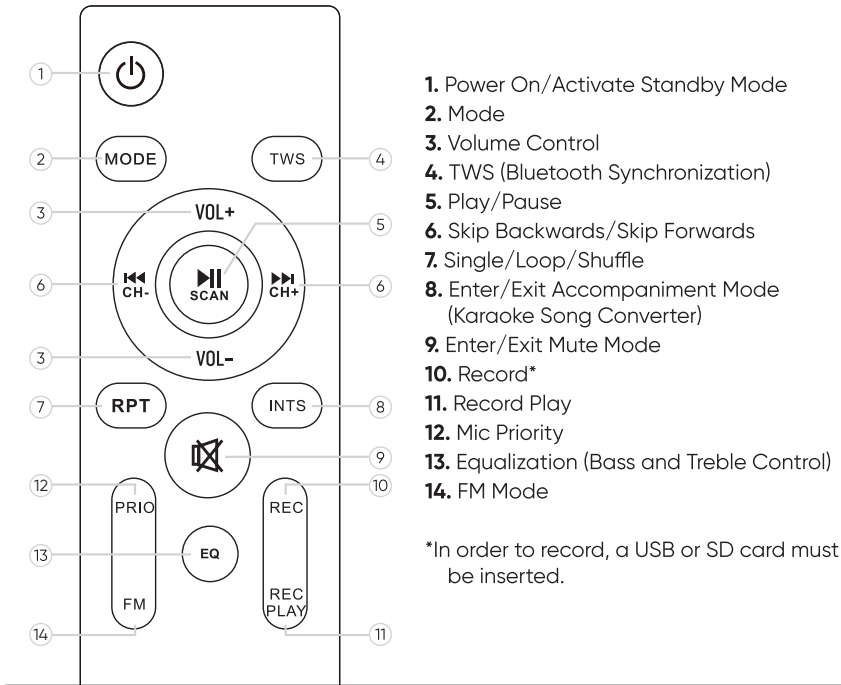

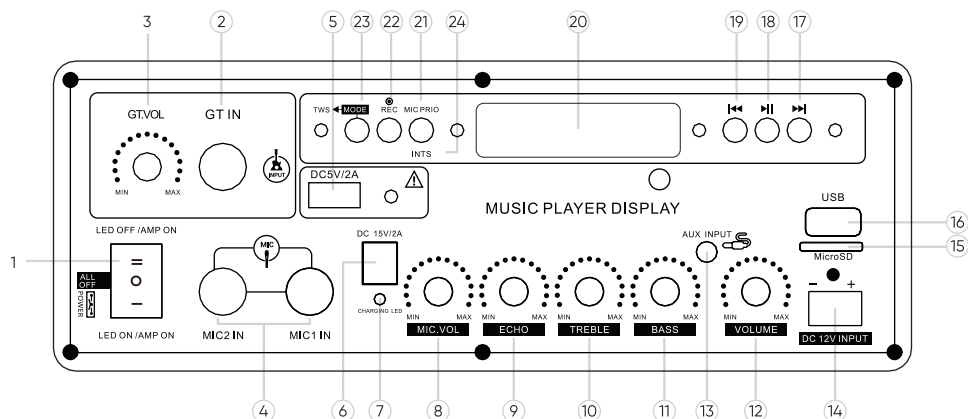

- |   |  |
|---|--|
| <b>1.</b> Main Power On/Off, LED On/Off, and Amp Power On/Off | <b>12.</b> Music Volume                      |
| <b>2.</b> Guitar Input  | <b>13.</b> AUX Input                         |
| <b>3.</b> Guitar Volume                                       | <b>14.</b> DC12V Car Battery Input           |
| <b>4.</b> External Mic Input                                  | <b>15.</b> TF MicroSD Card                   |
| <b>5.</b> DC5V/2A Disco Ball/External Charger Input           | <b>16.</b> USB Port                          |
| <b>6.</b> DC15V/2A Machine Charger Input                      | <b>17.</b> ◀                                 |
| <b>7.</b> Charging Light Indicator                            | <b>18.</b> ▶                                 |
| <b>8.</b> Mic Volume  | <b>19.</b> ▶                                 |
| <b>9.</b> Music Echo  | <b>20.</b> Music Player Display              |
| <b>10.</b> Music Treble                                       | <b>21.</b> Mic Priority                      |
| <b>11.</b> Music Bass   | <b>22.</b> Record                            |
|   | <b>23.</b> Mode and TWS Pairing              |
|   | <b>24.</b> Accompany: Karaoke Song Converter |

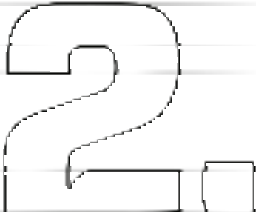

## ***Take note:*** Review before using

---

1. Keep this manual for any future reference.
2. Adhere to all warnings.
3. Keep ventilation openings clear; do not block any of this machine's vents/openings.
4. Install and set up the machine according to the manufacturer's instructions provided in this manual.
5. Do not install near any heat sources (i.e. radiators, heat registers, stoves, amplifiers, or any other objects that produce heat).
6. Protect the machine's power cord. Prevent the power cord from being walked on or pinched – particularly at the plugs, convenience receptacles, and the point from which they come out of the machine.
7. Unplug the machine during lightning storms or when unused for long periods of time.
8. Refer all technical services to qualified personnel. Servicing is required when the machine has been damaged in any way, such as damage to the power-supply cord or plug, contact with liquid, exposure to moisture or rain, failing to operate normally, if the machine has been dropped, etc.
9. Do not force the SD card into its slot. It can only be inserted in one direction. If the card does not insert in easily, remove it and try reinserting in the opposite direction.
10. To maintain peak performance and battery longevity, fully charge the karaoke machine at least once every three months.
11. To prevent interference, do not hold the microphone too close to the karaoke machine speakers.
12. The optimal distance of the wireless microphone is 30 meters (approx. 98 feet) from the karaoke machine speakers.
13. Fully charge the karaoke machine before storing for a long period of time. Microphone wireless range and sound quality might be affected by low battery.

[Review before using]



## 3

***Let's Begin...*****Machine assembly**

The entire karaoke machine can easily be assembled and disassembled so that you can pack it up and take it on the go in just a few minutes!

## Microphone Stand

**Microphone Stand Parts:**

1

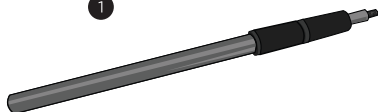

Microphone Pole

2



Triangular Bracket

3



Two Bendable Arms

4

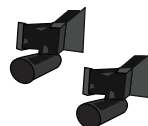

Two Microphone Clips



## How to Assemble the Microphone Stand:

1.

Begin with inserting the microphone pole ❶ into the large hole on the top right of the karaoke machine.



2.

Next, connect the triangular bracket ❷ to the top end of the microphone pole ❶.



3.

Connect both bendable arms ❸ to the triangular bracket ❷ on the microphone pole.

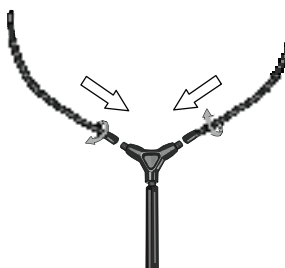

**4.**

Attach both microphone clips **4** to each of the bendable arms **3** by twisting them tightly into place.

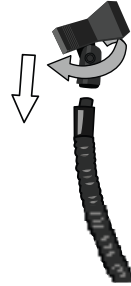
**5.**

Place the microphones into the microphone clips **4**.

**6.**

Adjust the height of the microphone pole **1** as desired by twisting the two knobs on the pole.

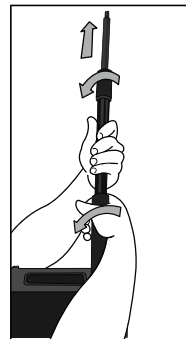

# Device Holder

## Device Holder Parts:

1



2



## How to Assemble the Device Holder:

1.

Begin with inserting the ball at the end of part 2 into the protruding piece on the back side of part 1 and twist to tighten it in place.

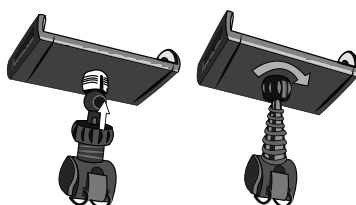

2.

Attach the now-constructed device holder by holding it in place at the position and height you desire on the microphone pole. After placing the round claw piece on part 2 around the pole, shut its clasp to tighten and fasten it.



[Machine assembly]



# Disco Ball

## Disco Ball Parts:

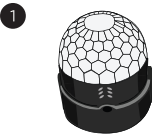

Disco Ball



Disco Ball Clasp



2X Side Screws

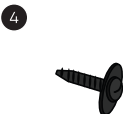

Pole Clip Screw



Stand Clip

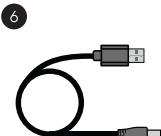

Power Plug

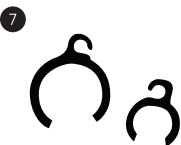

Wire Clips



## How to Assemble the Disco Ball:

1.

To attach the disco ball, screw the pole clip screw ④ through the disco ball clasp ② and the hole on the stand clip ⑤

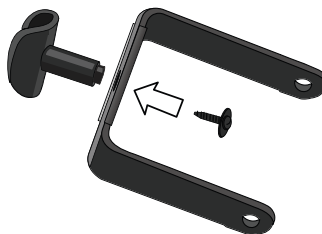

2.

Screw on both sides of the disco ball ① to the disco ball clasp ② with a side screw ③ on each side and tighten them so that the disco ball sits securely in place.

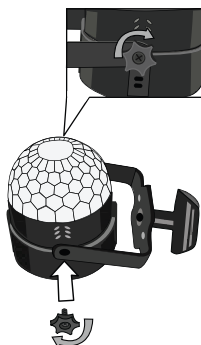

3.

Now that the entire holder is constructed, attach it to the microphone pole by clipping the entire contraption on via the disco ball stand clip ⑤.



**4.**

Plug in the DC5V/2A cable (power plug) ⑥ to its port on the machine and feed the wire through the large and small wire clips ⑦ that can be attached to the microphone pole.

The larger clip should be attached to the wider pole and the smaller clip should be attached to the narrower pole of the microphone stand.

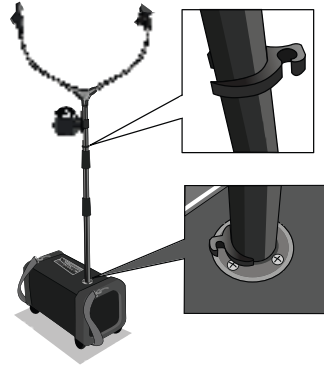
**5.**

The wire should neatly climb up the microphone pole and connect to the disco ball.

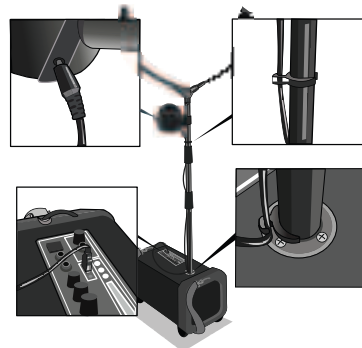

## Disassembly & Transport

- To disassemble the machine, remove all detachable components (e.g. disco ball, device holder, microphone stand) and place them in a suitable bag.
- Using the shoulder straps provided, clip both ends to the sides of the main machine where there are bands to clip the strap into.
- The main machine can now easily be carried with the shoulder strap. All detachable components should be carried separately.



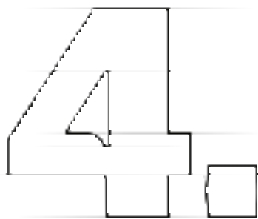

## ***Ready, set, sing!*** Quick start guide

---

**#1** Charge the machine and microphones before each use.

**#2** Turn the machine and microphones on.

**#3** Choose your preferred playback setting and begin blasting your favorite tunes.

**#4** Connect your device to display song lyrics.

**#5** Rock on!

**Note:** See the detailed “Usage Guide” section of this manual for more information on how to operate your machine.



Do not turn on the microphones while they are charging.



Use caution when charging microphones in docks while machine is unplugged. Battery will deplete quickly.



Clean and store the machine after each use.



Check the machine for damage before each use.



Do not use the machine with attachments not approved by the manufacturer.



Keep the machine away from heat, steam & water.



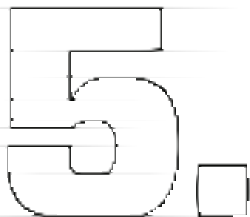

## ***Never miss a note*** Detailed usage guide

---

### **Machine**

#### **How to charge the machine**

Connect the charging cable into the **DC15V/2A** port on the machine and plug the other end into a polarized outlet. Be sure to charge fully before each use. The indicator light on the top back of the machine will turn on to indicate charging and power.

---

#### **How to turn the machine and LED lights on**

Turn on the **Power** switch on the machine's function board by toggling it to the right to turn the machine on with the LED lights or to the left to turn on the machine without the LED lights.

The LED lights referred to are the ones on the machine itself. If the disco ball is plugged in, it will turn on regardless of whether or not the machine's LED lights are on.

---

#### **How to use TWS (True Wireless Stereo Mode) to connect another machine**

TWS mode allows for more than one **Masingo Lento X5 Karaoke Machine** to be connected simultaneously. Once you have two of the same models in close proximity to each other, select the Bluetooth mode using the **Mode** button. Once in Bluetooth mode, hold down on the button for a longer period of time until both machines have entered the Bluetooth synchronization mode and are linked to each other. To turn off this mode, press any button.

Please note that TWS mode allows for a range of up to 32 feet from one machine to another in order to connect and work.

### How to connect to an external battery source

To connect the machine to an external charging source such as your car battery, plug in a compatible cable to your car and into the **DC12V Input** on the machine.

---

### How to record audio

To record, first insert a USB or MicroSD card into the machine's **USB** or **MicroSD** slots respectively. Once entered, click the **REC** (Record) button on the machine or the machine's remote control.

To stop recording, press the **REC** button again. The recorded audio should start playing as soon as the **REC** button has been clicked to stop recording.

---

### How to charge a phone/tablet

To connect your device for charging only, plug a compatible USB cable into the **DC5V/2A** port and into your device. Note that this port is also used to power the disco ball cable.

## Microphones

### How to charge the microphones

Plug the MicroUSB and wall plug that are included into the bottom of the microphone and an outlet. Be sure to charge fully before each use. While charging, the top bar of the battery icon on the display will flash, then stop flashing when the battery is full.

---

### How to turn the microphones on

Turn on microphones using the power button on the handle. They will automatically connect to the machine.

**Note:** Microphones will automatically turn off after 15 minutes of no use.

### How to set up the microphone

The A-B button controls both the microphone's channel and the microphone's frequency band.

**IMPORTANT:** When using both microphones simultaneously, each microphone must be set to a different frequency band (that is, one must be set to CHA while the other one is set to CHB). If both microphones are set to the same frequency band, the microphone audio may cut in and out.

**Changing the Frequency Band:** The frequency band is represented by the letters CHA or CHB in the bottom left corner of the LED display. To change the microphone's frequency band, hold the A-B button for one second until the desired band is reached. One microphone **MUST** be set to CHA while the other **MUST** be set to CHB.

**Changing the Microphone Channel:** Channel is represented on the microphone LED screen as a number from CH1 to CH8. To cycle through possible channels, click the A-B button until the desired channel is reached. Unlike frequency bands, having both mics on the same numbered channel will not negatively impact performance.

---

### How to customize your microphone vocal mix

To adjust the volume of your singing over the music, click the **Volume +/-** buttons up or down until it reaches your preferred volume.

To modify the reverb effect on your singing, click the **Echo +/-** buttons up or down as desired. Use the **EQ** button to choose between 5 different equalizer selections.

---

### How to use PA and Mic Priority mode

When there is no music playing, the machine will automatically start PA Mode. Simply use the microphones as directed above.

The Mic Priority mode automatically lowers the volume of the music to an almost inaudible level when someone begins speaking into the microphone.

To turn on/off Mic Priority mode while audio is playing from the machine, press the **Mic Prio** button on the machine or the **Prio** button on the machine's remote control. The music's volume will return to normal as soon as the person stops speaking into the microphone.

## Remote Control

### How to use the power button on the machine's remote control

Press the power button to activate standby or "sleep" mode. Press it again to exit standby mode.

Please note that the remote's front and rear panels have sensors with a range of up to 13 feet and an angle of up to 60 degrees. The remote must be pointed at the machine in order to use it.

### How to use TWS (True Wireless Stereo Mode) to connect another machine from the remote control

Once in Bluetooth mode, press **TWS** on the remote control. To exit, press the **Mode** button.

### How to use Mute mode on the remote control

Press  to mute. Press it again to unmute.

### How to use RPT (Repeat Mode) feature on the remote control

Repeatedly press the **RPT** button to select whether the music should play a song repeatedly on loop or shuffle between songs randomly.

### How to use INTS feature on the remote control

Karaoke mode allows you to instantaneously convert a song into a karaoke version by muting the vocals. In order to do so,

1. Connect your device via Bluetooth as instructed in the "How to connect to Bluetooth" section.
2. Press the "Karaoke Mode" button on the machine's function board until the song's vocals are muted. To restore vocals, simply press the "Karaoke Mode" button again.



### How to adjust music style (EQ/Equalizer) on the remote control

Press the **EQ** button repeatedly to adjust the treble and bass levels of the music.

## Music

### How to set up playback

Your machine has 6 different playback options: Bluetooth, SD, AUX, FM, USB, and PA. Each has its own hook up location (diagram in the "Contents/Parts" Section) and set up method (see the "Music" subsections below). Refer to the aforementioned sections for more information on how to set up your preferred playback mode.

If desired, you can also place your phone or tablet in the device mount provided and attach it to the microphone stand where you can display your song lyrics.

### How to connect to Bluetooth

Playing music from your device

Once the machine is on, press **Mode** until the display screen indicates that you are in Bluetooth mode. In order to connect to a device via Bluetooth, simply search for the machine name ("Masingo") under your playback device's Bluetooth connection settings and click to connect.

Note that the machine will automatically connect to the audio source it successfully connected to initially if both are in the same vicinity with Bluetooth turned on. To pair the machine to a new device, make sure the machine is not connected to the original device by turning off the device's Bluetooth mode. Then, proceed to turn on the Bluetooth function on the new device you want to pair and follow the instructions above to connect to the machine.

### How to use SD mode

Playing music from an SD card

Plug your MicroSD card into the **TF** slot on the machine. Playback will begin immediately. Use operation instructions in the "Music" subsection below to adjust settings.

---

### How to use AUX Mode

To use AUX mode, plug the AUX or AUX-RCA cable into the **AUX input** on the machine and plug the other end into the **AUX input** on your device. Next, press the **Mode** button on the machine until **LINE** appears on the display screen, indicating that you are now in AUX mode.

---

### How to use USB Mode

To use the **USB port**, plug a USB stick into the designated slot on the top of the machine. Your music will begin playing automatically.

---

### How to connect to FM mode

Playing music from an FM radio station

Click the **Mode** control button on the function board of the machine until **FM** appears on the display screen.

Once the FM mode has been activated, press and hold the **⏮** for the machine to begin seeking and storing all of your local radio station channels.

After the scanning is complete, switch through the channels by clicking **⏮** or **⏭** to select the radio station of your choice.

---

### How to use multiple playback modes

To use playback modes interchangeably, simply activate each mode according to the instructions above, then click the **Mode** button to switch between the inputs.

### How to customize your music

To adjust the machine's music volume, rotate the main **Volume** knob.

To adjust the bass and treble levels of the music, rotate the knobs that say **Bass** and **Treble** accordingly.

To adjust the microphone volume, rotate the **MIC.VOL** knob.

To adjust the microphone's echo level, rotate the **Echo** knob.

To skip back or forward in your song list, press the **⏮** and **⏭** buttons as needed.

---

### How to connect a guitar to the machine

Plug a guitar cable into the **GT IN** (Guitar Input) jack on the machine and into the guitar.

To adjust the guitar's volume on the machine's speakers, simply rotate the **GT.VOL** (Guitar Volume) knob to set it to your desired volume level.

## Maintenance

### How to clean

Turn the machine and microphones off and unplug from the wall and from the machine speaker.

Gently wipe the outside of the machine using a clean, dry cloth. Keep all vents, buttons, and openings free of lint and dirt. Do not immerse the machine in water and do not use any harsh cleaners.

---

### How to store

Charge the machine and microphones so that they are ready for next use.

Make sure that the machine is clean and dry. Bind the unplugged cord gently with an electrician-approved fastener. Do not wrap the cord around the machine.

Store the machine in a cool, dry place away from damaging elements.

For best results, clean and store the machine after each use.

**Please refer to Section 3 for detailed instructions on how to disassemble and reassemble the machine properly for storage.**

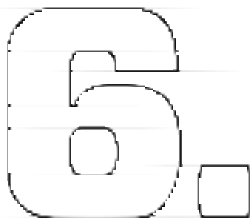

# *When things go flat*

## Troubleshooting

Problem	Solution
Battery icon on the microphone screen is blinking  OR  Microphone will not turn on	The microphone battery is low or depleted.  Charge before use.
Machine will not turn on	The battery is depleted. Be sure to charge the machine after each use.
The disco ball lights are not working	Make sure that the disco ball is properly plugged into the correct USB slot labeled DC5V/2A.
Machine is not playing microphone vocals	Ensure that each microphone is on a separate frequency band. This is represented by CHA or CHB in the bottom left corner of the microphone LED screen. (To switch channels, hold down the A-B button for one second). Microphones will not work properly unless one mic is set to CHA while the other mic is set to CHB.  After 15 minutes of inactivity, the microphones will turn off.





<p>Bluetooth is connected but no sound is coming from the machine</p>	<p>Check that the volume on both the machine and audio source is raised.</p> <p>If the issue persists, turn off the karaoke machine, restart it, and re-pair the machine to the audio source following the instructions on how to use Bluetooth mode.</p>
<p>The music is not playing when speaking into the microphone</p>	<p>Check to see whether or not the Mic Priority setting is turned on. If it is, it will automatically lower the volume of the music playing in order to focus on the microphone's output. Click the Mic Priority button and your music and mic audio will begin blasting through the speakers again simultaneously.</p>

If any of these issues persist or if any part of the machine becomes damaged, discontinue use and consult a licensed electrician for repair. Do not attempt to modify or repair the machine yourself. You can also contact our customer service department (see back cover).

### FCC:

This device complies with part 15 of the FCC Rules. Operation is subject to the following two conditions: (1) This device may not cause harmful interference, and (2) this device must accept any interference received, including interference that may cause undesired operation.

**We're here for you.**

If you encounter any issues with your machine or have any questions or comments, please feel free to contact us. Have your warranty information on hand for faster service.

90-DAY  
LIMITED  
WARRANTY



844-262-7464



support@masingo.net



www.masingo.net

***Love your new machine?***  
**We want to hear about it!**

