

2x1 Triple Monitor DP KVM Switch Docking

iDock D23



User Manual



Package Contents

Before you start the installation of the product, please check the package contents:

- Switch Docking x 1
- Power Adapter (DC 12V 3A) x 1
- USB 3.0 Type-A to Type-B Cable x 2
- DP 1.4a Cable x 6
- User Manual x 1

Features

- 2 in 1 triple-monitor KVM switcher:
 - Each input group support three independent DP input channels, which can be connected to three DP output ports of the PC and extended to three external monitors.
 - Each monitor has independent channel, which can support different resolution.
- Supports 8K resolution and high refresh rate - supports the standards of DP 1.4a HBR3 and DP 2.0 UHBR13.5, and supports the following resolutions:
 - 8K@60Hz/30Hz
 - 4K@165Hz/144Hz/120Hz/60Hz
 - 3440x1440@144Hz/120Hz/60Hz (UWQHD)
 - 2560x1440@165Hz/144Hz/120Hz/60Hz
 - 1080P@240Hz/165Hz/144Hz/120Hz/60Hz
- Supports 1.5m input cable and 3m output cable.
Note: please use the cables certified by DP 2.0 and DP1.4a.
- Supports multiple DP features:
 - MST - Supports DP MST, each DP port can be connected with multiple DP monitors.
 - HDR - Supports all HDR formats.
 - VRR - Supports VRR variable refresh rate.
- Multiple Peripherals interfaces:
 - Three USB 3.0 type-A ports with 5Gbps data transmission rate per port, one of the three ports supports 1.5A current output, and the other two ports share 2A current output.
 - One USB 2.0 port with 480Mbps data transmission rate, and one USB 1.1 port for keyboard (for hotkey switching).
 - Provides one headset (3.5mm TRRS) port.
 - One USB-C port, supports for USB-C (5V/1.5A power output) data

transmission.

- One CTL port, supports for connecting an extended button control device (need to purchase separately) for button control.
- One SDXC card slot (maximum: 2TB) with the maximum transmission rate of 104MB/s.
- One LAN port, support for 1Gb Ethernet performance.
- Supports new generation PC automatic wake-up function – automatically wake up the PC in standby mode when switching.
- Fast switching time of 2-3s, based on the virtual interaction function.
- New compatibility Hotkey design – fully pass-through mode and newly upgraded hotkey algorithm:
 - All key values are passed-through and compatible with various types of keyboards on the market.
 - Specially optimized hotkey algorithm for complex gaming keyboards and macro defined keyboards.
- Supports multiple control options, including button switch, and hotkey switch.
- Provides six high grade DP 1.4a cables, which can support transmitting 8K signals, and provides two USB 3.0 cables, which can support transmitting 5Gbps signals.

Panel

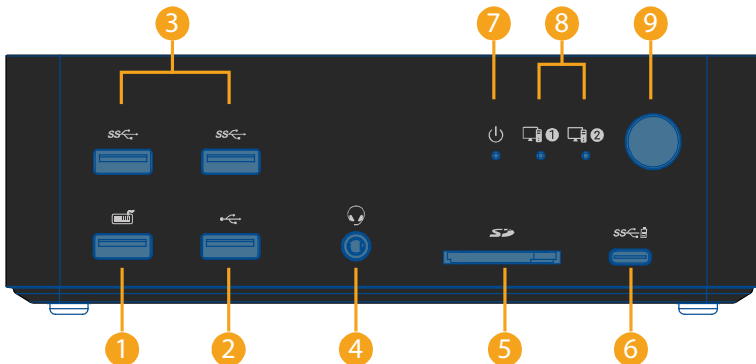

1. USB-A (USB 1.1) | 2. USB-A (USB 2.0) | 3. USB-A (USB 3.0) | 4. 3.5mm composite headphone jack | 5. SDXC card slot | 6. USB-C | 7. Power (LED) | 8. Input Channel (LED) | 9. Button (Switch)

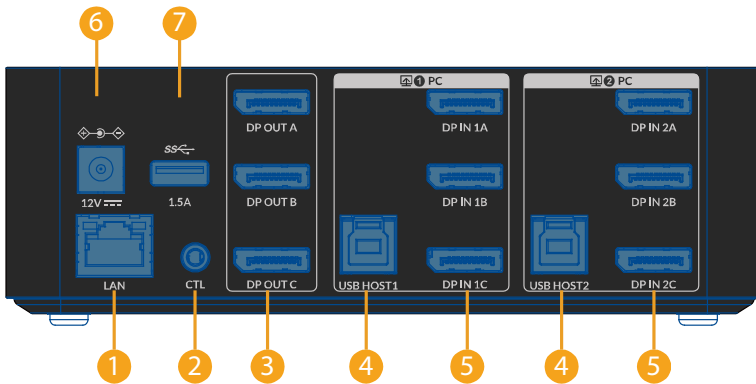

1. LAN | 2. CTL | 3. DP OUT (A&B&C) | 4. USB HOST (1&2) | 5. DP IN (1A/1B/1C & DP IN 2A/2B/2C) | 6. Power In (DC 12V) | 7. USB-A (USB 3.0)

Application

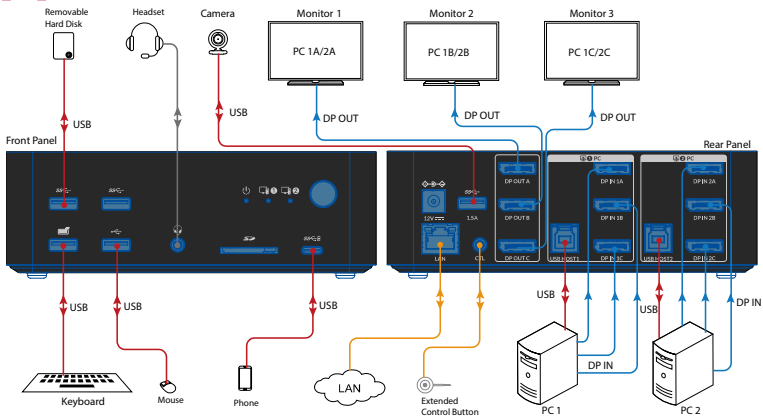

When switch input source to group 1 or group 2:

- The connected USB devices, headset and SD card can be connected to Host PC 1 or PC 2. Their switching follows the source selection.
- When switch to group 1, the display connected to DP OUT A, DP OUT B and DP OUT C will output video from DP IN 1A, DP IN 1B and DP IN 1C respectively. When switch to group 2, the display connected to DP OUT A, DP OUT B and DP OUT C will output video from DP IN 2A, DP IN 2B and DP IN 2C respectively.

Note: Please note that all USB-A ports, USB-C ports, headphone jacks, and SD slot switching will follow the DP video output switching. Additionally, the product has two USB-to-Ethernet modules that are built

into the two USB-B ports, which means that both computers can be connected to the network through USB-B cables, regardless of whether the computer is selected or not. The network should be connected to the LAN port.

Button Control

Users can choose to use front panel button or extended control button to do basic switching operations. Connect the switcher as required and power on all the attached devices. Press the front panel button or press the extended control button to switch sources between Group 1 and Group 2.

Hotkey Function

One USB 1.1 port on front panel of the switcher supports keyboard Hotkey function. This function is enabled by default, and can be set to disabled/enabled through combined keys on the connected keyboard.

Supported Hotkey: **Tab (default), Caps Lock**

Key Operation	Function
Hold down “Ctrl” (“Left”) + “Alt” + “Shift” keys and then press “[” key	Enable hotkey.
Hold down “Ctrl” (“Left”) + “Alt” + “Shift” keys and then press “]” key	Disable hotkey.
Press the “Hotkey” twice quickly	Switch to this hotkey.
Hold down “Hotkey” and then press “1” key	Switch to input group 1.
Hold down “Hotkey” and then press “2” key	Switch to input group 2.
Hold down “Hotkey” and then press “Left” key	Switch to previous input group (Cycle group 2->1).
Hold “Hotkey” and then press “Right”	Switch to next input group (Cycle group 1->2).

For example:

If you want to use the “Caps Lock” as a hotkey, please ensure the hotkey function is enabled, and press the “Caps Lock” key twice quickly to switch the hotkey to it, and other hotkeys are invalid. If you need to use other hotkeys, please repeat the above steps.

Specifications

Technical	
Video Signal	DP in/out supports DP 1.4a and DP 2.0 standards, up to 8K@60Hz
Peripheral and	USB-C x1: Up to 5Gb/s, 1.5A power output.

Technical	
Expansion	USB-A x5: <ul style="list-style-type: none"> • Three USB 3.0 ports, up to 5Gb/s, two of them share 2A current output, and one supports 1.5A current output; • One USB 2.0 port, up to 480Mb/s; • One USB 1.1 port, for keyboard connection. SDXC card: Up to 104MB/s, maximum support 2TB. LAN: RJ-45 connector, support for 1Gb Ethernet performance.
Input/Output Resolution Supported	VESA: 800 x 600 ⁶ , 1024 x 768 ⁶ , 1280 x 768 ⁶ , 1280 x 800 ⁶ , 1280 x 960 ⁶ , 1280 x 1024 ⁶ , 1360 x 768 ⁶ , 1366 x 768 ⁶ , 1440 x 900 ⁶ , 1600 x 900 ⁶ , 1600 x 1200 ⁶ , 1680 x 1050 ⁶ , 1920 x 1200 ⁶ , 2048 x 1152 ⁶ , 2560 x 1440 ^{6,7,8,9,10} , 3440 x 1440 ^{6,7,8,9,10} CTA: 1280x720P ^{5,6} , 1920x1080P ^{1,2,3,4,5,6,7,8,9,10,11} , 3840x2160P ^{1,2,3,4,5,6,7,8,9,10} , 4096x2160P ^{1,2,3,4,5,6,7,8,9,10} , 5120x2880 ^{1,2,3,5,6} , 7680x4320 ^{1,2,3,6} 1 = at 24 (23.98) Hz, 2 = at 25 Hz, 3 = at 30 (29.97) Hz, 4 = at 48 Hz, 5 = at 50 Hz, 6 = 60 (59.94) Hz, 7 = at 100Hz, 8 = at 120Hz, 9 = 144Hz, 10 = 165Hz, 11 = 240Hz
HDR Format Supported	All HDR formats, including HDR 10, HLG, HDR 10+ and Dolby Vision
Audio Format Supported	DP: Fully supports audio formats in DP 1.4a specification, including PCM 2.0/5.1/7.1, Dolby TrueHD, Dolby Atmos, DTS-HD Master Audio and DTS:X Headset: Stereo
Max Data Rate	13.5Gbps per channel

General	
Operating Temperature	0°C to + 45°C (32 to + 113 °F)
Storage Temperature	-20 to +70°C (-4 to + 158 °F)
Humidity	20% to 90%, non-condensing
Power Consumption	31.25W (max)
Device Dimensions (W x H x D)	168mm x 55mm x 110mm/ 6.61" x 2.17" x 4.33"
Product Weight	0.75kg/1.65lbs

