

VISSANI™

814100507

USE AND CARE GUIDE

PORTABLE AIR CONDITIONER



Please read this manual carefully before operating your unit and retain for future reference.

Safety Information

To prevent injury to the user or other people and property damage, the instructions shown here must be followed. Incorrect operation due to ignoring of instructions may cause harm or damage. The level of risk is shown by the following indications.

WARNING: This symbol indicates a hazardous situation which, if not avoided, could result in death or serious injury.

CAUTION: This symbol indicates a hazardous situation, which, if not avoided, could result in minor or moderate injury.

CAUTION:

- This appliance is not intended for use by persons (including children) with reduced physical, sensory or mental capabilities or lack of experience and knowledge, unless they have been given supervision or instruction concerning use of the appliance by a person responsible for their safety.
- Children should be supervised to ensure that they do not play with the air conditioner.
- The appliance shall be installed in accordance with national wiring regulations.
- Do not operate your air conditioner in a humid room such as a bathroom or laundryroom.
- Be sure the air conditioner has been securely and correctly installed according to the installation instructions in this manual. Save this manual for possible future use in removing or installing this unit.
- Plug in power cord plug properly. Otherwise, it may cause electric shock or fire due to excess heat generation.
- Do not modify power cord length or share the outlet with other appliances as it may cause electric shock or fire due to overheating.
- Always ensure effective grounding. Incorrect grounding may cause electric shock.
- Unplug the unit if you notice unusual sounds, smells, or smoke coming from it. A damaged product may cause fire and electric shock.
- Ventilate room before operating the air conditioner if there is a gas leakage from another appliance.
- Do not operate or stop the unit by inserting or pulling out the power cord plug.
- Do not operate with wet hands or in very humid environments. It may cause electric shock.
- Do not allow water to come into contact with any electric parts. It may cause failure or electric shock.
- Do not use the socket if it is loose or damaged. It may cause fire and electric shock.
- Do not use or keep the power cord close to heating appliances. It may cause fire and electric shock.
- Do not use any devices or materials for installation that are not recommended in this manual.
- Do not disassemble or modify unit. It may cause failure and electric shock.
- Do not damage or use an alternate power cord. It may cause fire and electric shock. If the power cord is damaged, it must be replaced. Contact a service center or a similarly qualified person in order to avoid a hazard.
- Do not direct airflow straight into persons to avoid possible health hazard.
- Do not open the unit during operation. It may cause electric shock.
- Do not use the power cord near flammable gas or combustibles, such as gasoline, benzene, thinner, etc. It may cause an explosion or fire.
- Do not let children hang on the air conditioner or bracket. A serious injury may occur.
- Avoid fire hazard or electric shock. Do not use an extension cord or an adaptor plug. Do not remove any prongs from the power cord.
- Be sure the air conditioner is properly grounded. To minimize shock and fire hazards, proper grounding is important. The power cord is equipped with a three-prong grounding plug for protection against shock hazards.
- Your air conditioner must be used in a properly grounded wall receptacle. If the wall receptacle you intend to use is not adequately grounded or protected by a time delay fuse or circuit breaker, have a qualified electrician install the proper receptacle. Ensure the receptacle is accessible after the unit installation.
- Be sure the electrical service is adequate for the model you have chosen. This information can be found on the serial plate, which is located on the side of the cabinet and behind the grille.
- When the air filter is to be removed, do not touch the metal parts of the unit. It may cause injury.
- When the unit needs cleaning, switch off, and turn off the circuit breaker.
- Do not clean unit when power is on as it may cause fire, electric shock or injury.
- Do not place obstacles around air inlets or inside of air outlet. It may cause failure or accident.
- Clean with a soft cloth only. Do not use strong detergents that contain wax or thinners as it may damage the product.
- Use caution when unpacking and installing. Sharp edges could cause injury.
- Do not clean the air conditioner with water.
- Water may enter the unit and degrade the insulation which could lead to electric shock.
- Do not put a pet or house plant where it will be exposed to direct air flow. This could injure the pet or harm the plant.
- Hold the plug by the head of the power plug when taking it out. Otherwise, it may cause electric shock and damage.
- Ensure that the installation is properly secured to prevent the product from potentially falling.
- Do not place heavy objects on the power cord and ensure that the cord is not compressed. Otherwise, there is danger of fire or electric shock.
- If water is spilled on the unit, turn off the unit and switch off the circuit breaker. Isolate supply by taking the power-plug out and contact a qualified service technician.
- Do not use near gas stove or other gas burning appliances, as air flow may affect gas combustion.
- Do not use for any purpose other than room comfort.
- Do not use this air conditioner to preserve precision devices, food, pets, plants, and art objects. It may cause deterioration.
- Turn off the main power switch if the unit is not to be used for an extended time.
- Always insert the filters securely. Clean filter once every two weeks. Operation without filters may cause failure.
- Do not drink water drained from the air conditioner.

CAUTION: Risk of fire/flammable materials. (Required for R32/R290 units only)

IMPORTANT: Read this manual carefully before installing or operating your new air conditioning unit. Make sure to save this manual for future reference.

Explanation of symbols displayed on the unit:		
	WARNING	This symbol shows that this appliance used a flammable refrigerant. If the refrigerant is leaked and exposed to an external ignition source, there is a risk of fire.
	CAUTION	This symbol shows that the operation manual should be read carefully.
	CAUTION	This symbol shows that service personnel should be handling this equipment with reference to the installation manual.
	CAUTION	This symbol shows that information is available such as the operating manual or installation manual.

WARNING: (for using R32 refrigerant only)

- Do not try to accelerate the defrosting process or methods of cleaning that are not recommended by the manufacturer.
- The appliance shall be stored in a room without a continuously operating ignition source (for example, open flames or an operating gas appliance) or an ignition source (for example, an operating electric heater) close to the appliance. The appliance shall also be stored in a room without ignition sources.
- Do not pierce or burn.
- Be aware that the refrigerants may not contain an odor.
- Keep ventilation openings clear of obstruction.
- Unit is only to be serviced by a Vissani authorized service, please contact a service center.
- Flammable refrigerant R32 is used within air conditioner. Please follow the instructions carefully to handle, install, clean, and service the air conditioner to avoid damage or hazard. Do not dispose of air conditioner in regular trash. Contact qualified agency for proper disposal.
- No open fire or devices that generate spark/arcing shall be around the air conditioner to avoid causing ignition of the flammable refrigerant used. Please follow the instructions carefully to store or maintain the air conditioner to prevent mechanical damage from occurring.

Pre-Installation

TOOLS REQUIRED (TOOLS NOT INCLUDED)



HARDWARE INCLUDED

NOTE: Hardware not shown to actual size.

Part	Description
AA	Unit Adaptor
BB	Exhaust Hose
CC	Window Slider Adaptor
DD	Foam Seal B (Non-adhesive)
EE	Security Bracket and Screws
FF	Window Slider A
GG	Window Slider B
HH	Foam Seal A (Adhesive)
II	Drain Hose
JJ	Bolt
KK	Remote Control (only for remote control models)

Accessory type and quantity may vary depending on the model.

PACKAGE CONTENTS

Part	Description	
A	Control Panel	
B	Remote Signal Receptor	
C	Horizontal Louver Control	
D	Vertical Louver Control	
E	Panel	
F	Caster	
G	Handle (both sides)	
H	Air Filter	
I	Upper Air Intake	
J	Drain Outlet	
K	Air Outlet	
L	Lower Air Intake	
M	Bottom Tray Drain Outlet	

DESIGN NOTICE

In order to ensure the optimal performance of our products, the design specifications of the unit and remote control are subject to change without prior notice.

AMBIENT TEMPERATURE RANGE FOR OPERATION

MODE	Temperature Range
Cool	17-35°C (62-95°F)
Dry	13-35°C (55-95°F)

EXHAUST HOSE INSTALLATION

The exhaust hose and adaptor must be installed or removed in accordance with the usage mode. For COOL, or AUTO mode exhaust hose must be installed. For FAN, or DRY mode exhaust hose must be removed.

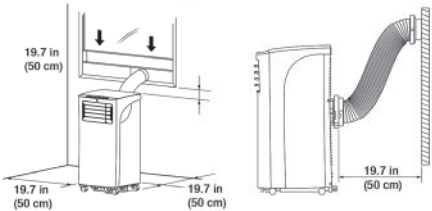

The images shown in this manual are for illustrative purposes only and may be subject to change.

Your installation location should meet the following requirements:

- Make sure that you install your unit on an even surface to minimize noise and vibration.
- The unit must be installed near a grounded plug, and the Collectin Tray Drain (found on the back of the unit) must be accessible.
- The unit should be located at least 12 in. (30 cm) from the nearest wall to ensure proper air conditioning. The horizontal lower blade should be at least 19.7 in. (50 cm) away from obstacles.
- DO NOT cover the Intakes, Outlets or Remote Signal Receptor of the unit, as this could cause damage to the unit.

ENERGY RATING INFORMATION

The energy rating and noise information for this unit is based on the standard installation using an un-extended exhaust duct without window slider adaptor (as shown in the Installation section of this manual). At the same time, the unit must be operate on the COOL MODE and HIGH FAN SPEED by remote controller.

HOW TO STAY COOL WITH A NEW PORTABLE AIR CONDITIONER(FOR THE MODELS THAT COMPLY WITH THE REQUIREMENTS OF DEPARTMENT OF ENERGY IN US)

Because of a new federal test procedure for Portable Air Conditioners, you may notice that the cooling capacity claims on portable air conditioner packaging are significantly lower than that of models produced prior to 2017. This is due to changes in the test procedure, not to the portable air conditioners themselves.

WHAT SHOULD I LOOK FOR FIRST WHEN PURCHASING A PORTABLE AIR CONDITIONER?

The right air conditioner helps you cool a room efficiently. An undersized unit won't cool adequately while one that's too large will not remove enough humidity, leaving the air feeling damp. To find the proper air conditioner, determine the square footage of the room you want to cool by multiplying the room length by its width. You also need to know the air conditioner's BTU (British Thermal Unit) rating, which indicates the amount of heat it can remove from a room. A higher number means more cooling power for a larger room. (Be sure you are comparing only newer models to each other- older models may appear to have a higher capacity, but are actually the same). Be sure to "size up" if your portable air conditioner will be placed in a very sunny room, in a kitchen, or in a room with high ceilings. After you've found the right cooling capacity or your room, you can look at other features.

WHY IS THE COOLING CAPACITY LOWER ON NEWER MODELS THAN ON OLDER UNITS?

Federal regulations require manufacturers to calculate cooling capacity based on a specific test procedure, which was changed just this year. Models manufactured before 2017 were tested under a different procedure and cooling capacity is measured differently than in prior years' models. So, while the BTUs may be lower, the actual cooling capacity of the air conditioners has not changed.

WHAT IS SACC ?

SACC is the representative value of Seasonally Adjusted Cooling Capacity, in BTU/H, as determined in accordance with the Department of Energy (DOE) test procedure at title 10 Code of Federal Regulations (CFR) 430, subpart B, appendix CC and applicable sampling plans.

Installation

1 Prepare the Exhaust Hose assembly

- Press the exhaust hose (BB) (or extended exhaust hose) into the window slider adaptor (CC) (or wall exhaust adaptor) and unit adaptor (AA). Clamp automatically by elastic buckles of the adaptors.

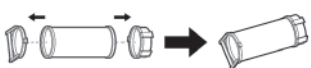

2 Install the Exhaust hose assembly to the unit

- Push the Exhaust hose (BB) into the air outlet opening of the unit along the arrow direction.

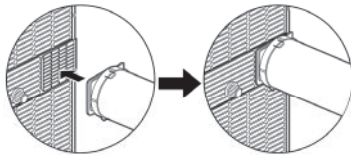

3 Preparing the Adjustable Window Slider

- Choose the window sliders according to the size of your window. Sometimes, it needs to be cut short to meet the window size, please take extra care to cut it properly.
- Use bolts to fasten the window sliders (FF and GG) once they are adjusted to the proper length.



4 Install Adhesive Foam Seal

- Cut the adhesive Foam Seal A (HH) strips to the proper lengths, and attach them to the window sash and frame as shown.

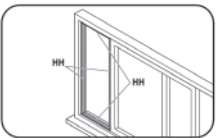
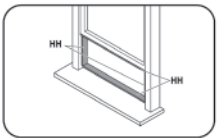

5 Install Window Slider

- Insert the window slider (FF and GG) assembly into the window opening.

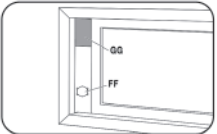
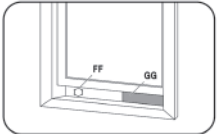

6 Cut Foam to Length

- Cut the non-adhesive Foam Seal B (DD) strip to match the width (or height) of the window. Insert the seal between the glass and the window frame to prevent air and insects from getting into the room.

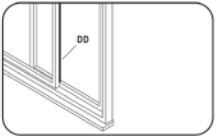
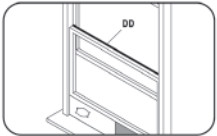

7 Install Security Bracket (optional)

- Install the security bracket (EE) with 2 screws as shown.

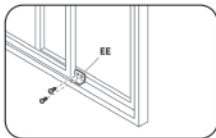
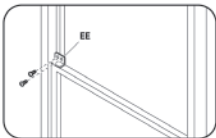

8 Install Window Slider Adaptor

- Insert the window slider adaptor (CC) into the hole of the window slider (FF).



NOTE: To ensure proper function, DO NOT overextend or bend the hose. Make sure that there is no obstacle around the air outlet of the exhaust hose (in the range of 500mm) in order to the exhaust system works properly. All the illustrations in this manual are for explanation purpose only. Your air conditioner may be slightly different. The actual shape shall prevail.



Operation

NOTE: The following control panels are for explanation purpose only. The control panel of the unit you purchased may be slightly different according to the models. Your machine may not contain some indicators or buttons. The actual shape shall prevail.

1 Using the Control Panel

MODE
CONSTANT FAN (Press 3s)
Fan ●
Dry ●
Constant Fan ●

MODE button
Selects the appropriate operating mode. Each time you press the button, a mode is selected in a sequence that goes from COOL, DRY, and FAN. The mode indicator light illuminates under the different mode setting.

NOTE: On above modes, the unit operates the auto fan speed automatically.

Up (+) and Down (-) buttons
Used to adjust (increasing/decreasing) temperature settings in 1°C / 2°F (or 1°F) increments in a range of 17°C / 62°F to 30°C / 88°F (or 86°F).

NOTE: The control is capable of displaying temperature in degrees Fahrenheit or degrees Celsius. To convert from one to the other, press and hold the Up and Down buttons at the same time for 3 seconds.

DRY operation

- Press the "MODE" button until the "DRY" indicator light comes on.
- The fan speed or the temperature cannot be adjusted. The fan motor operates at LOW speed.

NOTE: Keep windows and doors closed for the best dehumidifying effect.

FAN operation

- Press the "MODE" button until the "FAN" indicator light comes on.
- Press the "FAN SPEED" button on the remote control to choose the fan speed. The temperature can not be adjusted.
- Do not put the duct to window.

LED display
Shows the set temperature while on cool, heat or auto mode. While on DRY and FAN modes, it shows the room temperature.

Shows Error codes:

- E0-EEPROM error.
- E1-Room temperature sensor error.
- E2-Evaporator temperature sensor error.
- E3-Condenser temperature sensor error (on some models).
- E4-Display panel communication error.
- EC-Refrigerant leakage detection malfunction (on some models).

Shows protection code:

- P1-Bottom tray is full--Connect the drain hose and drain the collected water away.

If protection repeats, contact a service center.

NOTE: When one of the above malfunctions occurs, turn off the unit, and check for any obstructions. Restart the unit, if the malfunction is still present, turn off the unit and unplug the power cord. Contact a service center or a similar qualified person for service.

Power button
Power switch on/off

Power indicator light
 Either Timer or Wireless indicator light
 Timer indicator light (only set by remote controller)

NOTE: The actual descriptions of control panel and their locations may vary depending on the model.

2 Constant Fan operation(On some models)

- ❑ In Cooling or Dry mode, press the MODE button for 3 seconds to turn on or off the constant fan function. When the function is turned on, the constant fan light will illuminate, identifying that the fan runs continuously for cooling. When this function is turned off, the constant fan light will go out, identifying the running fan cycle and compressor is stopped.

3 I SENSE feature

- ❑ This feature can be activated from the remote control ONLY. The remote control serves as a remote thermostat allowing for the precise temperature control at its location. To activate the I SENSE feature, point the remote control towards the unit and press the I SENSE button. The remote control will send this signal to the air conditioner until the I SENSE button is pressed again. If the unit does not receive the I SENSE signal during any 7 minutes interval, the unit will exit the I SENSE mode.

 **NOTE:** This feature is unavailable in FAN or DRY mode.

4 Auto-Restart

- ❑ If the unit turns off unexpectedly due to the power cut, it will restart with the previous function setting automatically when the power resumes.
- ❑ WAIT 3 MINUTES BEFORE RESUMING OPERATION
- ❑ After the unit has stopped, it can not be restarted in the first 3 minutes. This is to protect the unit. Operation will automatically start after 3 minutes.

5 Water Drainage

- ❑ During dehumidifying modes, remove the drain plug from the back of the unit, install the drain connector (5/8" universal female mender) with 3/4" hose (locally purchased). For the models without drain connector, just attach the drain hose to the hole. Place the open end of the hose directly over the drain in your basement floor.

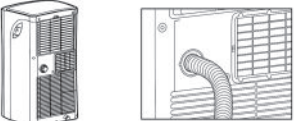

- ❑ When the water level of the bottom tray reaches a predetermined level, the unit beeps 8 times, the digital display area shows "P1". At this time the air conditioning/dehumidification process will immediately stop. However, the fan motor will continue to operate (this is normal). Carefully move the unit to a drain location, remove the bottom drain plug and let the water drain. Reinstall the bottom drain plug and restart the machine until the "P1" symbol disappears. If the error repeats, call for service.

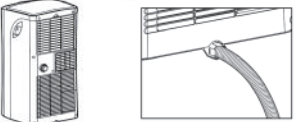

 **NOTE:** Be sure to reinstall the bottom drain plug firmly to prevent leakage before using the unit.

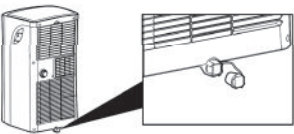

Using the Remote Control

Model	RG51H2(1)/CEFU1-M
Rated Voltage	3.0V (Dry batteries R03/LR03×2)
Signal Receiving Range	8m
Environment	23°F~140°F (-5°C~60°C)

NOTE: The remote control vary depend of model. The buttons on the remote control may have a different name or location than the remote control shows in this manual.

Before you begin using your new air conditioner, make sure to familiarize yourself with the remote control. The following are brief instructions to the remote control itself. For instructions on how to operate your air conditioner, refer to the How to Use Basic Functions section of this manual.

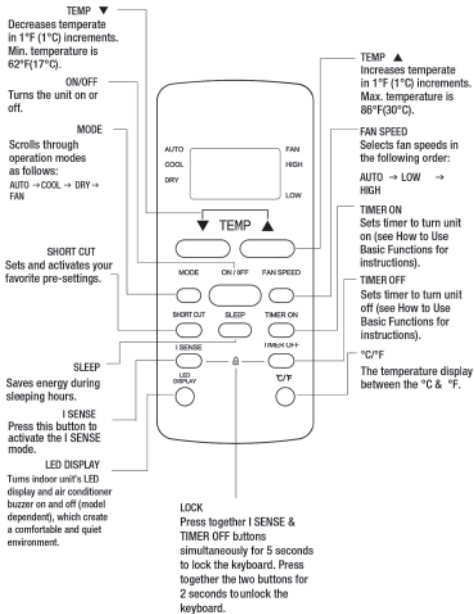

1 Using Cool Mode

 **IMPORTANT:** Before operation, please ensure the unit is plugged in and power is available.

- ❑ Press the MODE button to select COOL mode.
- ❑ Set your desired temperature using the TEMP ▼ or TEMP ▲ button.
- ❑ Press FAN button to select the fan speed: AUTO, LOW or HIGH.
- ❑ Press the ON/OFF button to start the unit.

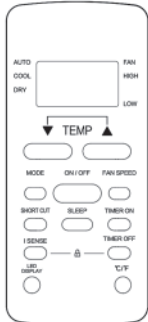

SETTING TEMPERATURE

The operating temperature range for units is 62-86°F (17-30°C). You can increase or decrease the set temperature 1 °F (1°C) increments.

3 Using Fan Mode

- ❑ Press the MODE button to select FAN mode.
- ❑ Press FAN button to select the fan speed: AUTO, LOW, or HIGH.
- ❑ Press the ON/OFF button to start the unit.

 **NOTE:** You can't set temperature in FAN mode. As a result, your remote control's LCD screen will not display temperature.

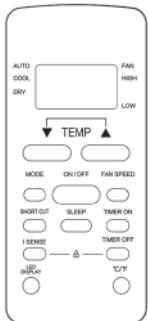

2 Using Auto Mode

- ❑ In AUTO mode, the unit will automatically select the COOL, FAN, or HEAT operation based on the set temperature.
- ❑ Press the MODE button to select AUTO.
- ❑ Set your desired temperature using the TEMP ▼ or TEMP ▲ button.
- ❑ Press the ON/OFF button to start the unit.

 **NOTE:** FAN SPEED can't be set in AUTO mode.

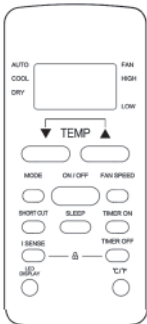

4 Using Dry Mode

- ❑ Press the MODE button to select DRY.
- ❑ Set your desired temperature using the TEMP ▼ or TEMP ▲ button.
- ❑ Press the ON/OFF button to start the unit.

 **NOTE:** FAN SPEED cannot be changed in DRY mode.

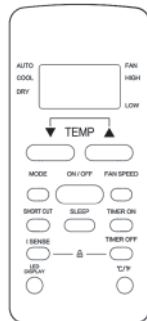

5 Using the Timer

- ❑ Use the time to set the amount of time after which the unit will automatically turn on/off.

TIMER ON setting

- ❑ Press TIMER ON button to initiate the ON time sequence.
- ❑ Press TEMP up or down button for multiple times to set the desired time to turn on the unit.
- ❑ Point remote to unit and wait 1sec, the TIMER ON will be activated.

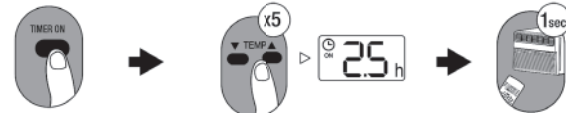

TIMER OFF setting

- ❑ Press TIMER OFF button to initiate the OFF time sequence.
- ❑ Press TEMP up or down button for multiple times to set the desired time to turn off the unit.
- ❑ Point remote to unit and wait 1 sec, the TIMER OFF will be activated.



NOTE:

- ❑ When setting the TIMER ON or TIMER OFF, the time will increase by 30 minutes increments with each press, up to 10 hours. After 10 hours and up to 24, it will increase in 1 hour increments. (For example, press 5 times to get 2.5h, and press 10 times to get 5h) The timer will revert to 0.0 after 24 hours.
- ❑ Cancel either function by setting its timer to 0.0h.

The images shown in this manual are for illustrative purposes only and may be subject to change.

5 Using the Time (continued)

EXAMPLE

- ❑ Keep in mind that the time periods you set for both functions refer to hours after the current time.
- ❑ If current timer is 1:00 PM, to set the timer as above steps, the unit will turn on 2.5h later (3:30 PM) and turn off at 6:00 PM.

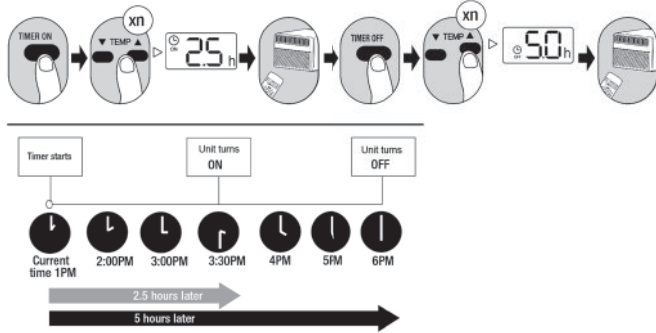

6 Using I SENSE

- ❑ Press I SENSE button.
- ❑ When the I SENSE function is activated, the remote display is the actual temperature at its location. The remote control will send this signal to the air conditioner in 3 minute intervals until press the I SENSE button again.



7 Using the °C/°F button

- ❑ Press this button to alternate the temperature display between the °C & °F.



8 Using the LED Display

- ❑ Press the LED Display button to turn on and turn off the display on the indoor unit.



9 Using the Short Cut setting

- ❑ Used to restore the current settings or resume previous settings.
- ❑ Push this button when remote controller is on, the system will automatically revert back to the previous settings including operating mode, setting temperature, fan speed level and sleep feature (if activated). If pushing more than 2 seconds, the system will automatically restore the current operation settings including operating mode, setting temperature, fan speed level and sleep feature (if activated).



10 Using the Sleep Function

- ❑ The SLEEP function is used to decrease energy use while you sleep (and don't need the same temperature settings to stay comfortable). This function can only be activated with the remote control.
- ❑ The sleep function is not available in Fan or Dry mode. Please refer to the OWNER'S MANUAL for more details.

11 Inserting and Replacing Batteries

- ❑ Put the batteries in the remote control before use.
- ❑ Slide the back cover from the remote control downward, exposing the battery compartment.
- ❑ Insert the batteries, paying attention to match up the (+) and (-) ends of the batteries with the symbols inside the battery compartment.
- ❑ Slide the battery cover back into place.

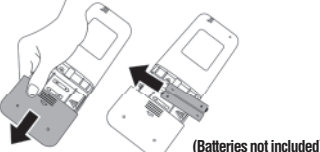

NOTE: For optimum product performance:

- ❑ Do not mix old and new batteries, or batteries of different types.
- ❑ Do not leave batteries in the remote control if you don't plan on using the device for more than 2 months.

 **NOTE:** Do not dispose of batteries as unsorted municipal waste. Refer to local laws for proper disposal of batteries.

Tips for using remote control

- ❑ The remote control must be used within 8 meters of the unit.
- ❑ The unit will beep when remote signal is received.
- ❑ Curtains, other materials and direct sunlight can interfere with the infrared signal receiver.
- ❑ Remove batteries if the remote will not be used more than 2 months.

NOTE: The device could comply with the local national regulations.

- ❑ In Canada, it should comply with CAN ICES-3(B)/NMB-3(B).
- ❑ In USA, this device complies with part 15 of the FCC Rules. Operation is subject to the following two conditions:
 - ❑ This device may not cause harmful interference, and
 - ❑ This device must accept any interference received, including interference that may cause undesired operation.

This equipment has been tested and found to comply with the limits for a Class B digital device, pursuant to part 15 of the FCC Rules. These limits are designed to provide reasonable protection against harmful interference in a residential installation. This equipment generates, uses and can radiate radio frequency energy and, if not installed and used in accordance with the instructions, may cause harmful interference to radio communications. However, there is no guarantee that interference will not occur in a particular installation. If this equipment does cause harmful interference to radio or television reception, which can be determined by turning the equipment off and on, the user is encouraged to try to correct the interference by one or more of the following measures:

- ❑ Reorient or relocate the receiving antenna. Increase the separation between the equipment and receiver.
- ❑ Connect the equipment into an outlet on a circuit different from that to which the receiver is connected.
- ❑ Consult the dealer or an experienced radio/TV technician for help.
- ❑ Changes or modifications not approved by the party responsible for compliance could void user's authority to operate the equipment.

Supplier's Declaration of Conformity 47 CFR § 2.1077 Compliance Information. FCC Compliance Statement (products subject to Part 15)

This device complies with Part 15 of the FCC Rules. Operation is subject to the following two conditions: (1) This device may not cause harmful interference, and (2) this device must accept any interference received, including interference that may cause undesired operation.

Maintenance

SAFETY PRECAUTIONS

- ❑ Always unplug the unit before cleaning or servicing.
- ❑ DO NOT use flammable liquids or chemicals to clean the unit.
- ❑ DO NOT wash the unit under running water. Doing so causes electrical danger.
- ❑ DO NOT operate the machine if the power supply was damaged during cleaning. A damaged power cord must be replaced.

Care and Cleaning

AIR FILTER CLEANING

 **CAUTION:** DO NOT operate the unit without filter because dirt and lint will clog it and reduce performance.

Maintenance Tips

- ❑ Be sure to clean the air filter every 2 weeks for optimal performance.
- ❑ The water collection tray should be drained immediately after P1 error occurs, and before storage to prevent mold.
- ❑ In households with animals, you will have to periodically wipe down the grill to prevent blocked airflow due to animal hair.

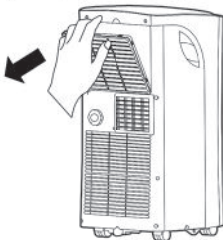

UNIT CLEANING

Clean the unit using a damp, lint-free cloth and mild detergent. Dry the unit with a dry, lint-free cloth.

STORE THE UNIT WHEN NOT IN USE

- ❑ Drain the unit's water collection tray according to the instructions in the following section.
- ❑ Run the appliance on FAN mode for 12 hours in a warm room to dry it and prevent mold.
- ❑ Turn off the appliance and unplug it.
- ❑ Clean the air filter according to the instructions in the previous section. Reinstall the clean, dry filter before storing.
- ❑ Remove the batteries from the remote control.

 **NOTE:** Be sure to store the unit in a cool, dark place. Exposure to direct sunshine or extreme heat can shorten the lifespan of the unit.

 **NOTE:** The cabinet and front may be dusted with an oil-free cloth or washed with a cloth dampened in a solution of warm water and mild liquid dishwashing detergent. Rinse thoroughly and wipe dry. Never use harsh cleansers, wax or polish on the cabinet front. Be sure to wring excess water from the cloth before wiping around the controls. Excess water in or around the controls may cause damage to the unit.

Troubleshooting

Problem	Possible Causes	Solution
Unit does not turn on when pressing ON/OFF button	P1 Protection Code	❑ The Water Collection Tray is full. Turn off the unit, drain the water from the Water Collection Tray and restart the unit.
	In COOL mode: room temperature is lower than the set temperature	❑ Reset the temperature
	EO EEPROM error	❑ Contact a service center or a similar qualified person for service.
Unit does not cool well	The air filter is blocked with dust or animal hair	❑ Turn off the unit and clean the filter according to instructions
	Exhaust hose is not connected or is blocked	❑ Turn off the unit, disconnect the hose, check for blockage and reconnect the hose
	The unit is low on refrigerant	❑ Call a service technician to inspect the unit and top off refrigerant
	Temperature setting is too high	❑ Decrease the set temperature
	The windows and doors in the room are open	❑ Make sure all windows and doors are closed
The unit is noisy and vibrates too much	The room area is too large	❑ Double-check the cooling area
	There are heat sources inside the room	❑ Remove the heat sources if possible
	The ground is not level	❑ Place the unit on a flat, level surface
The unit makes a gurgling sound	The air filter is blocked with dust or animal hair	❑ Turn off the unit and clean the filter according to instructions
	This sound is caused by the flow of refrigerant inside the unit	❑ This is normal

PRINTED IN MEXICO
Elbrd: J.M / SHNMDL: VAP09R1AWT_B
SC: 09-12-2025 / OBPB: 16120300A28600

8 1 4 1 0 0 5 0 7

