

## WIFI WATER TIMER WITH GATEWAY SET

# QUICK START GUIDE

 This Smart Hose Timer works with 2.4GHz WiFi network only.

### 01 Open RainPoint Home App

- **For Existing RainPoint app User**  
Simply log into your account and skip to step 02.

If the Gateway (model # HWG023WBRF) is already added in your device list on Home app, please skip to step 03.

- **For New User**

Search "RainPoint Home" on App Store or Google Play. Or scan the QR code below to download the app. Create an account to begin the setup.



iOS



Android

### 02 Connect to Wi-Fi Network

- Plug the Gateway into an indoor outlet and the power indicator will turn solid blue.

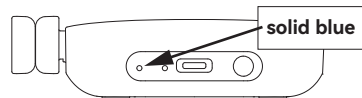

- Avoid to keep the Gateway on the floor or in a cupboard which might reduce the signal.

- Go to app's Home page, tap "Add Device" or  icon and select "HWG023WBRF".

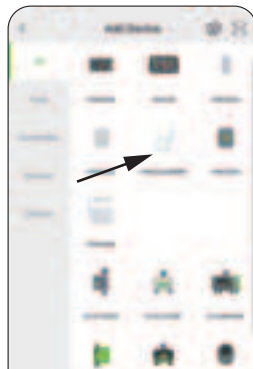
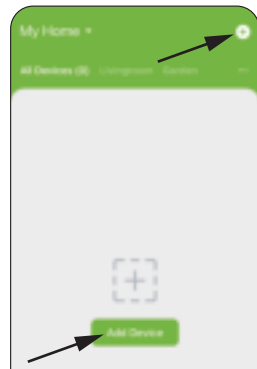

Or tap  icon on Add Device page and scan QR code below.



HWG023WBRF

- Follow in-app instructions to complete the connection. Once the Gateway is connected to Wi-Fi successfully, the indicator will turn solid blue.

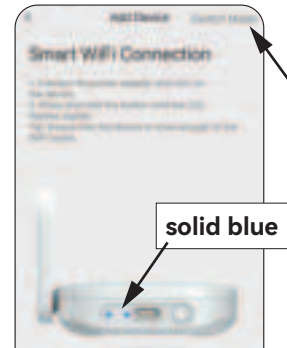

**Note:** If failed to connect the smart WiFi connection mode, please refer to user manual and try AP connection mode.

### 03 Add WiFi Water Timer

- Select Gateway device on app home page, tap "Add Device" on Gateway home page and select "HTV145FRF".

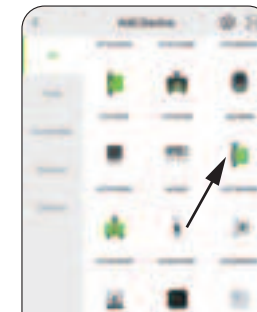
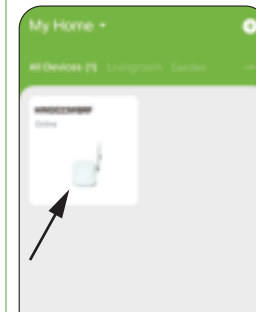

Or tap  icon on Add Device page and scan QR code either below or the one on the timer.



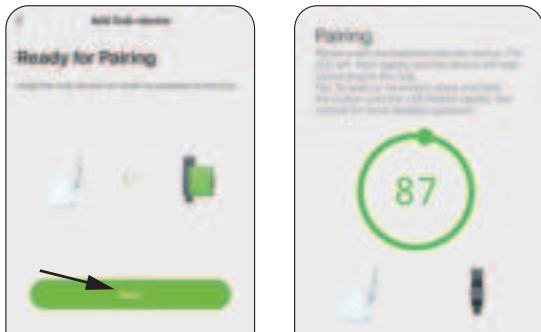

HTV145FRF

- b. Tap **Next** and move onto Pairing page.

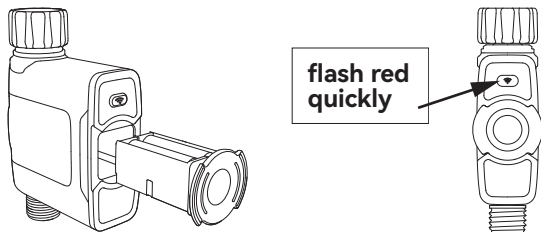

- c. **Insert 4 new AA batteries** (NOT Included). Then press and hold the device button until the RED light flashes rapidly, indicating that the device is in pairing mode.



 If automatic pairing fails, press and hold the **Operation Button** until the red indicator light flashes quickly to reactivate pairing mode manually.

## 04 Water Timer Installation

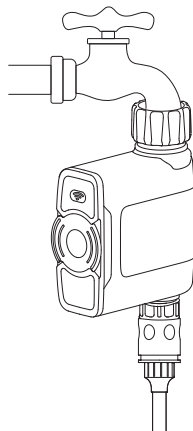

### NOTE:

- Install your water timer as vertically to the ground as possible. Avoid material fatigue and Inaccurate water flow measurement caused by horizontal or angled connections.
- For better signal connection with the Wi-Fi Gateway, please do not place the timer in an underground valve box.

## 05 Timer Quick Test

- Install batteries and screw the timer into your spigot by hand. Tighten until snug.
- Keep the spigot fully closed.
- Press the button and you can hear a click sound indicating that the valve is open for manual watering. After a few seconds, press the button again and you will hear a click sound indicating that the valve is closed.
- Test:** Turn on the faucet a little bit. Press the button to check if the water flows out or shuts off as expected.

## Troubleshooting

Problem	Possible Reason	Solution
Gateway is disconnected or offline.	<ul style="list-style-type: none"><li>Unstable WiFi network.</li><li>Long distance from the Gateway.</li><li>Timer not in pairing state.</li></ul>	<ul style="list-style-type: none"><li>Check if the WiFi network devices are working properly.</li><li>Keep close to Gateways and routers when connecting the timer.</li><li>Re-pair the timer: Press and hold Operation Button until the red light flashes rapidly to indicate pairing. (Or remove the device from the home page and reconnect.)</li></ul>
Water leakage from the timer inlet	Pipe is not tightly inserted or not fully inserted.	<ul style="list-style-type: none"><li>Re-screw the timer to make sure the threaded joint between the water inlet and the spigot is properly tightened.</li><li>Use the included sealing tape to improve the seal at the threaded joint.</li></ul>

## Warranty

**RainPoint** provides 1-year limited warranty on this product against manufacturing defects in materials and workmanship. You can get an extra two years of extended warranty by registering your product on our website. [www.rainpointonline.com](http://www.rainpointonline.com)

## Need Help?

If you encounter any issues during setup, please feel free to email our customer support team.

 Email: [support@rainpointonline.com](mailto:support@rainpointonline.com)

## Join Us For More Offers

Here are some gardening tips and tricks, as well as a lot of inspiration to help us become better gardeners.

 Facebook: [@Rainpointglobal](https://www.facebook.com/Rainpointglobal)

 YouTube: [RainPoint](https://www.youtube.com/RainPoint)

 Support: <https://www.rainpointonline.com/pages/support>

