

SIZE:93\*134MM

ANTI-GRAVITY HUMIDIFIER

Instruction Manual



Please use purified water

Do not use alcohol essential oil aromatherapy,etc

Thank you for choosing this product. In order to give full play to the product functions, Please read this manual carefully before use. And please keep it securely for easy reference.

IMPORTANT POINTS TO NOTE

In order to ensure the quality of the product, before leaving the factory will be solid water test, after receiving the product has a small amount of water droplets residue, is a normal phenomenon.

The shape and spacing of each water droplet in the product are different, and it is normal that the water droplet produced by each product is different. As the gas in the water pipe is not exhausted, it is normal for the water droplet to have a delay (water droplet does not form) when starting the machine, and the delay is about 30s-60s. Left and right, the water will form naturally, please be patient.

If the water in the tank is dried, the power will be automatically cut off in the case of no water.

PRODUCT SCHEMATIC DIAGRAM

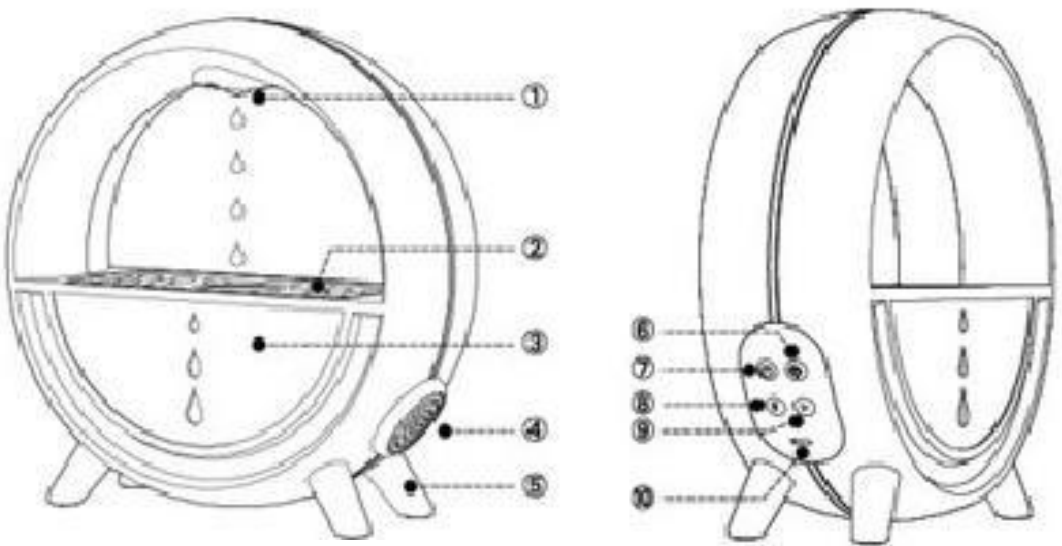

- ① Water Outlet
- ② Fog Outlet
- ③ Water Tanks
- ④ Loudspeaker
- ⑤ Base

- ⑥ Light Button
- ⑦ Power Button
- ⑧ Bluetooth Button
- ⑨ Play/Pause Button
- ⑩ Power Port

TECHNICAL PARAMETERS

Name: Anti-gravity Humidifier	Model: C919
Water Tank Capacity: 350 ml	Size: 235 × 238 × 80 mm
Running Time: 3 Hours	Color: White
Rated Power: 5W	Weight: 1000g
Rated Voltage: 5V	Material: Abs + Silica Gel
Power Supply: 5V-2A	Fog Quantity: 10-15 ml/h

PRODUCT OPERATION INSTRUCTIONS

Unscrew the top cover, fill the tank with pure water, standard water level of 300mL is the best.

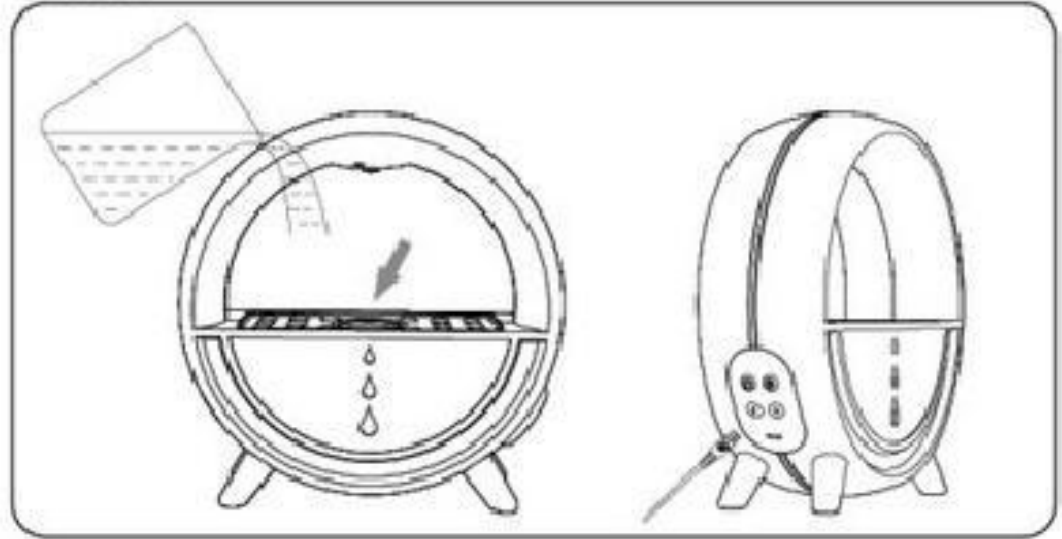

Power Button: Press and hold for 3 seconds to turn on or off the humidifier and the ambient light, and the humidifier starts to pump water and spray.

Light Button: After power on, short press to open the colorful light, press a change of a colour, red, yellow, blue, purple, white, green, orange. And then press the 7 colour mixing. Long press the light button to adjust the brightness, long press first slowly dim, adjust to the darkest time, re-long press will slowly brighten, mixing mode double click to fix the colour, fixed the current colour.

enter the search pairing state, the machine model (C919), click the connection to successfully pair.

Play/Pause Button: Short press to play or pause, double click twice to switch to the next song.

CONTENT LIST

Anti Gravity Humidifier \*1

User Manual\*1

COMMON FAILURES AND TROUBLESHOOTING

Malfunction	Reason	Solution
Can not start	Wrong power adapter	Use a 5V-2A power adapter before turningit on again
Can not generate nistor substantially little mist	There may be dirt in the atomizer piece that is clogging the hole at the bottom of theatomization piece	Use a cotton swab dipped in white vinerar to gently wipe the atomizationpiece to clean the dirt,and replace a new ultrasonic atomization piece
Can not fron water drops	Not sufficient water in the water tank	Fill water into the tank until it reaches the water line
	Delayed start-up empty pump	Restart again
	Wrong power adapter	Use a 5V-2A power adapter before turningit on again
LED does not ight up	Motherboard buned out	Contact after-sales service
	Cable not connected properly	Reconnect the cable or changethe power adapter
Button can not be pressed	The button is jammed	Contact after-sales service
Button malfunction	Motherboard burned out	Contact after-sales service

AFTER-SALES SERVICE CARD

Product Name: \_\_\_\_\_

Date of Purchase; \_\_\_\_\_

Name: \_\_\_\_\_

Contact Address:

Distributor Address: \_\_\_\_\_

Distributor Name; \_\_\_\_\_

Distributor Contact Number:\_\_\_\_\_

Weimplement paid services for the following situations:

Users modify or install other functions the damage caused by therepair and disassembly of the faulty machine; Improper transportation and storage by the user or failure to follow the instructions damage caused by required use; The warranty certificate is altered; Without warranty certificate and valid invoice or major parts Exceeding the corresponding warranty period.

Tips:

- 1.This product warranty card is the only proof of product warranty. Please keep it properly
2. he relevant product warranty regulations shall be subject to the terms of After-sales Service

FCC Statement

Changes or modifications not expressly approved by the party responsible for compliance could void the user's authority to operate the equipment.  
This equipment has been tested and found to comply with the limits for a Class B digital device, pursuant to Part 15 of the FCC Rules.  
These limits are designed to provide reasonable protection against harmful interference in a residential installation. This equipment generates uses and can radiate radio frequency energy and, if not installed and used in accordance with theinstructions, may cause harmful interference to radio communications. However, there is no guarantee that interference will not occur in a particular installation. If this equipment does cause harmful interference to radio or television reception, which can be determined by turning the equipment off and on, the user is encouraged to try to correct the interference by one or more of the following measures:  
-- Reorient or relocate the receiving antenna.  
-- Increase the separation between the equipment and receiver.  
-- Connect the equipment into an outlet on a circuit different from that to which the receiver is connected.  
-- Consult the dealer or an experienced radio/TV technician for help  
This device complies with part 15 of the FCC rules. Operation is subject to the following two conditions (1)this device may not cause harmful interference, and (2) this device must accept any interference received, including interference that may cause undesired operation.

This device complies with Part 15 of the FCC Rules.  
Operation is subject to the following two conditions:  
(1) This device may not cause harmful interference, and  
(2) This device must accept any interference received, including interference that may cause undesired operation.

TECHNOLOGY CHANGES LIFE