

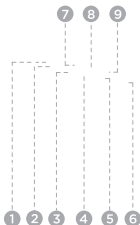

PORTABLE BLUETOOTH SPEAKER

- Speaker --- 1pc
- USB-C Cable --- 1pc
- AUX IN Cable --- 1pc
- User Manual --- 1pc
- Quick Start Guide --- 1pc



1. Volume Down
2. Charging Indicator
3. Power On/Off
4. Bluetooth
5. Sound Mode
6. Volume Up
7. Previous Song

8. Play/Pause
9. Next Song
10. MIC IN
11. RESET
12. AUX IN
13. USB IN (Audio)
14. USB-C





Blinking red

Charging



Solid red

Fully charged



Don't plug the cable in when your speaker and the charging port are not completely dry. Leave your speaker in a dry area with some airflow to let the port air dry naturally.

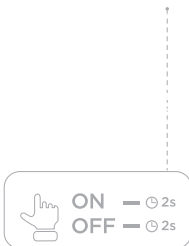

Press and hold the Power button for 2 seconds to power on.

Press and hold the Power button again for 2 seconds to power off.



Press for two seconds

Power on



All lights on



Press for two seconds

Power off



All lights off

The speaker switches off when audio has stopped or buttons have not been pressed for 15 minutes.

- When first used and turned on, the speaker will automatically enter a waiting mode for connection.
- If the Bluetooth device is already connected, press " > " button to disconnect the current connection and connect with other devices.
- The speaker will automatically enter pairing mode if it is not connected to a Bluetooth device.

When pairing, enable the Bluetooth function of the phone and search for " " to connect. When the connection is successful, you will hear a prompt tone and the Bluetooth indicator will turn from breathing to the color state and echo the logo light effect.

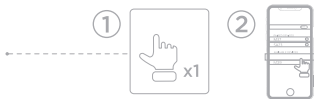

Press for two seconds

Automatically enter Bluetooth pairing mode after turning on



White light breathing flash

Bluetooth pairing



Enter the color state and echo the logo light effect

Bluetooth connected

Connect a device to the AUX IN jack with an audio cable.





Plug a USB storage device that contains playable audio contents into the USB port of the speaker.

- The speaker switches to the USB source automatically.
- Audio playback will start automatically.



1. Make sure the speakers are not connected to the mobile phone.

2. Double-click the "  " button on any speaker. The speakers are automatically paired. After pairing, the main speaker Bluetooth indicator will breathing flashing, and the secondary speaker Bluetooth indicator will enter the color state and echo the logo light effect.

3. Enable the Bluetooth function on the phone, search for "  " to connect. After the successful connection, you will hear a prompt tone, the Bluetooth indicator light on the main speaker will become the color state and echo the logo light effect, and the Bluetooth indicator light on the secondary speaker will remain the color state and echo the logo light effect.

4. Exit TWS mode: Double-click the "  " button on speaker, and the speaker will automatically exit TWS mode.

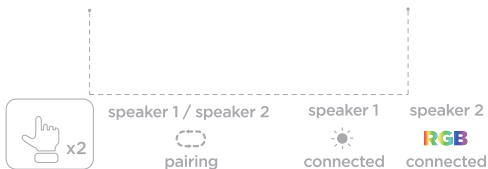

White indicator light flashes in a loop

TWS pairing



White light breathing flash (speaker 1)

TWS connected



Enter the color state and echo the logo light effect (speaker 2)

Connect to microphone (not included).



Press the reset button once.





Long press for 2 seconds

Turn on/off

Single click

Mode switching

Single click

Bluetooth connection/disconnect



Double click

TWS connection/disconnect

Press and hold for 5 seconds

Clear Bluetooth pairing list



Single click

Sound mode switching



Single click

Play/pause (AUX IN mode mute)



Single click

Volume up

Press and hold

Quickly turn up the volume



Single click

Volume down

Press and hold

Quickly turn down the volume



Single click

Previous song



Single click

Next song

1. It is not recommended to replace the battery privately.
2. The battery (battery pack or battery pack combination) must not be exposed to sunshine, fire or similar overheated environments.

BUGANi Corporation (“BUGANi”) warrants your product against defects in materials and workmanship when purchased directly from BUGANi or a BUGANi authorized reseller. This warranty is extended only to the original end-use purchaser or the person receiving the product as a gift and shall not be extended to any other person or transferee. The warranty is valid from the date of retail purchase for a period of 1 year. BUGANi will provide the Warranty Services in accordance with the relevant laws and regulations of local government.

This warranty does not cover defects or damage arising from improper use or maintenance, normal wear and tear, commercial use, accident or external causes. Unauthorized repair, modification or customization of your product voids this warranty.

For warranty service on covered defects during the warranty period, contact BUGANi using the contact information at worldwide. Prior to providing warranty service, BUGANi may require you to provide proof of purchase details, including but not limited to a receipt or sales invoice.

Changes or modifications not expressly approved by the party responsible for compliance could void the user's authority to operate the equipment.

This equipment has been tested and found to comply with the limits for a Class B digital device, pursuant to part 15 of the FCC Rules.

These limits are designed to provide reasonable protection against harmful interference in a residential installation. This equipment generates uses and can radiate radio frequency energy and, if not installed and used in accordance with the instructions, may cause harmful interference to radio communications. However, there is no guarantee that interference will not occur in a particular installation. If this equipment does cause harmful interference to radio or television reception which can be determined by turning the equipment off and on, the user is encouraged to try to correct the interference by one or more of the following measures:

- Reorient or relocate the receiving antenna.
- Increase the separation between the equipment and the receiver.
- Connect the equipment to an outlet on a circuit different from that to which the receiver is connected.
- Consult the dealer or an experienced radio / TV technician for help.

Changes or modifications not expressly approved by the party responsible for compliance could void the user's authority to operate the equipment.

This device complies with Part 15 of the FCC Rules. Operation is subject to the following two conditions:

- (1) This device may not cause harmful interference, and
- (2) This device must accept any interference received. Including interference that may cause undesired operation.

The device has been evaluated to meet general RF exposure requirement. The device can be used in portable exposure condition without restriction.

FCC ID: 2BGTK-BS12302

Radio Standards Specification RSS-Gen, issue 5

- English:

This device contains licence-exempt transmitter(s)/receiver(s) that comply with Innovation, Science and Economic Development Canada's licence-exempt RSS(s). Operation is subject to the following two conditions:

This device may not cause interference.

This device must accept any interference, including interference that may cause undesired operation of the device.

RF exposure statement:

The device has been evaluated to meet general RF exposure requirement. The device can be used in portable exposure condition without restriction.

- French:

Cet appareil contient des émetteurs / récepteurs exemptés de licence conformes aux RSS (RSS) d'Innovation, Sciences et Développement économique Canada. Le fonctionnement est soumis aux deux conditions suivantes:

Cet appareil ne doit pas causer d'interférences.

Cet appareil doit accepter toutes les interférences, y compris celles susceptibles de provoquer un fonctionnement indésirable de l'appareil.

Déclaration d'exposition RF:

L'appareil a été évalué pour répondre aux exigences générales d'exposition aux RF. L'appareil peut être utilisé dans des conditions d'exposition portable sans restriction.

IC: 32554-BS12302

For more information, please visit www.bugani-global.com